

## MINI PROJECTOR USER MANUAL - Functions

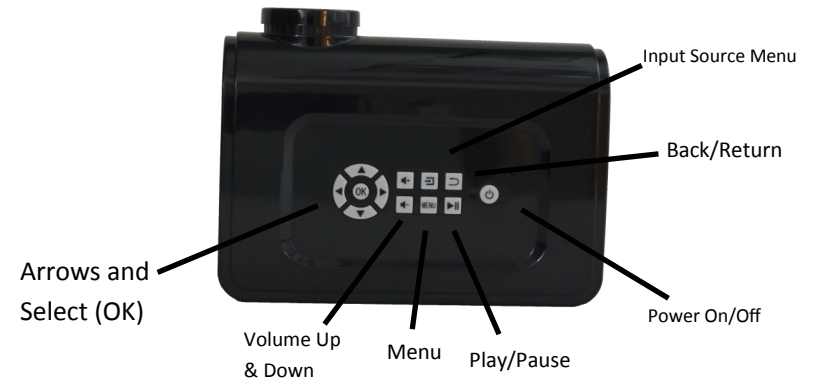
Button function



Left arrow moves Left.  
Right arrow moves Right.  
Up arrow moves Up.  
Down arrow moves Down.  
Volume Up/Down  
Menu: Operate multiple functions.  
Source: Choose input signal source.  
Power Button: Power on/off projector.

**Image 1**

## MINI PROJECTOR USER MANUAL - Projector Ports



**Image 2**



## MINI PROJECTOR USER MANUAL - Set Up

Power on/off

Plug the provided adaptor into the DC adaptor port (Image 2)

Power on: Press the power button on the projector or remote control once, the projector starts working.

Power off: Press the power button on the projector or remote control once, the projector is off.

Focusing

Put the projector at a certain place within the proper distance from the screen.

To focus, twist the lens on the front of the camera, left or right in order to adjust the focus and sharpen the image. The projector must be ON in order to focus properly.

Changing the Input Source

Press "SOURCE" button on the remote control to get the source menu, repeat pressing "source" button to move the cursor to the input signal source you need, the press "OK" button to confirm Or press "Source" button on the projector to get the source menu, then press the "OK" (Image 3)

**Image 3**

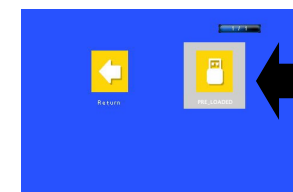


## MINI PROJECTOR USER MANUAL - Set Up Continued

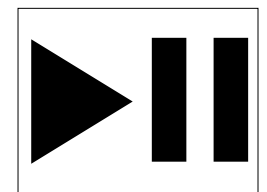
1. Select Multimedia Icon (Image 4), then press OK on your remote or projector.
2. Select Preload Icon (Image 5), then press OK on your remote or projector.
3. To play all videos, press play (Image 6) on the remote or projector; to select specific videos, highlight the videos and press OK on the remote or projector and a small checkmark will appear. After a few seconds of non-activity, a small preview video will appear. To exit out of preview mode, simply move using the arrow keys or press play and the videos will enter full screen format.
4. Once the playlist has been played, they will automatically repeat until the option is changed or the unit is turned off. Remark: You can press 'Repeat' button to select Repeat On/Repeat All/None.



**Image 4**

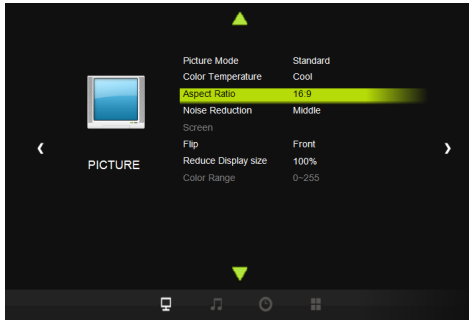


**Image 5**



**Image 6**

# MINI PROJECTOR USER MANUAL - Additional Settings



Press "MENU" key to enter the main menu, Then press ◀ or ▶

Press "▲ or ▼" key to select the sub-menu, then adjust the parameters as per your need, then press the "OK" key to continue.

Function of Sub-menu

### Image Sub-menu

Available Adjustment: picture mode, color temperature, aspect ratio, noise reduction, flip, reduce, display size

### Sound Sub-menu

Available adjustment: sound mode, balance, auto volume, surround sound

### Time Sub-menu:

Available adjustment: Sleep Timer

### Option Sub-menu

Available adjustment: OSD language, restore factory setting, blending, OSD duration, software update (USB)

## MINI PROJECTOR USER MANUAL - Features

### Product Feature

The LED lamp life can be up to 50,000 hours, also displays beautiful colors.

Multi-function interface: HD/USB

Manual focus adjustment, viewing picture is from 20 to 100 inches.

Small dimensions and light weight, easy to carry and store.

Low power consumption, ultra quiet isolation.

Additional Video effects and accessories are available for purchase off our website, TotalHomeFX.com

You can also like us on Facebook and Subscribe to our Youtube page!



## Specifications

Model	Mini projector	Image system	LCD
Native Resolution	480*320	Support Resolution	Max 1920*1080
Lamp	LED	Input voltage	DC 12V/2A
Language	English, 23 languages	Brightness	60lumen
Contrast	1,000:1	Lens	F=90
Image size	20-100inch	Projection distance	1.2-3.6 m
Color	18000K	Projection mode	Front projection
Power waster	25W	Speaker	2.0W*1
Weight	0.27KG	Size	170*115*70mm
Operation mode	Manual/Remote control	Working temp	-10~38°C
Output	Headphone	Input	HD/USB

## MINI PROJECTOR USER MANUAL - Remarks and Information

### Remarks

Notice: please read the manual carefully before operating projector.

1. To ensure stable power supply, please use standard power cord which has ground wire.
2. Please use the power supply and cable indicated on the projector or the manual.
3. The projector should be kept away from cloth, sofa or anything that may block the ventilation scoop. And keep way from flammable and explosive materials.
4. Please do not disassemble by yourself, otherwise we will not provide free warranty service.
5. To protect your eye, do not watch directly at the lens when projector working.
6. The projector should be kept away from water or water splash, and the product shall not be placed around vases, cups and other liquid items.
7. To prevent electric shock, please don't put the projector under the rain or moisture.
8. We strongly suggest you power off projector when playing for 6 or more hours at a time.
9. Please use the original foam and other cushioning materials when transport projector.
10. If the projector does not work, please contact the retailer for additional troubleshooting.

For Customer Service; Please call 888-476-7100, Monday through Friday 8am to 5pm CST.  
For after hours, please fill out a Service Request at; [www.totalhomefx.com/contact-us](http://www.totalhomefx.com/contact-us)

NOTE: This equipment has been tested and found to comply with the limits for Class B digital device, pursuant to Part 15 of the FCC Rules. These limits are designed to provide reasonable protection against harmful interference in a residential installation. This equipment generates, uses and can radiate radio frequency energy and, if not installed and used in accordance with the instructions, may cause harmful interference to radio communications.

"Warning: Changes or modifications to this unit not expressly approved by the party responsible for compliance could void the user's authority to operate the equipment."

### Kit Includes:

Projector with Pre-loaded videos	1Pc
Remote	1Pc
AC Adaptor	1Pc
Nylon Screen	1Pc
Foam Mounting Tape	8 Pcs
Tripod	1Pc



1-888-476-7100

610 Academy Dr

Northbrook, IL 60062

[www.TotalHomeFX.com](http://www.TotalHomeFX.com)

<https://www.facebook.com/Total-Home-FX>

## Free Manuals Download Website

<http://myh66.com>

<http://usermanuals.us>

<http://www.somanuals.com>

<http://www.4manuals.cc>

<http://www.manual-lib.com>

<http://www.404manual.com>

<http://www.luxmanual.com>

<http://aubethermostatmanual.com>

Golf course search by state

<http://golfingnear.com>

Email search by domain

<http://emailbydomain.com>

Auto manuals search

<http://auto.somanuals.com>

TV manuals search

<http://tv.somanuals.com>