

using the knife sharpener

- 1 With the can opener sideways on, place the knife into one of the recesses.
- 2 Press the lever down and gradually draw it towards yourself. Then place the knife in the other recess and repeat. Take care not to allow the knife to cut into the body of the can opener.
- 3 Repeat this cycle several times in order to sharpen the knife satisfactorily.
- 4 The grinding wheel may jam if too much pressure is applied on the knife. Lift the knife slightly to release the wheel.

NOTE: Knives without a serrated edge, preferably carbon steel are most suitable for sharpening.

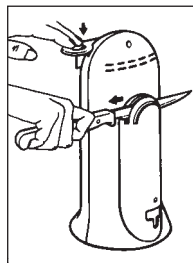

care and cleaning

- Disconnect the appliance by switching off and removing the plug from the power supply.
- Lift the lever fully and withdraw the assembly from the can opener.
- Wash the lever in hot sudsy water and dry thoroughly. Dishwashing is not advised.
- Replace the lever in the body
- Wipe over the body with a damp cloth and dry thoroughly.

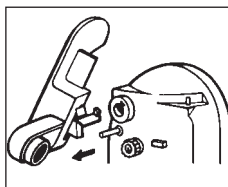

service & customer care

- If the cord is damaged it must, for safety reasons, be replaced by KENWOOD or an authorised KENWOOD repairer.

If you need help with:

- using your can opener or
 - servicing or repairs (in or out of guarantee)
- ☎ call Kenwood customer care on **023 9239 2333**. **Have your model number ready** - it's on the underside of your can opener.
- **spares and attachments**
- ☎ call 0870 2413653.
- **other countries**
- Contact the shop where you bought your can opener.

- Designed and engineered by Kenwood in the UK.
- Made in China.



IMPORTANT INFORMATION FOR CORRECT DISPOSAL OF THE PRODUCT IN ACCORDANCE WITH EC DIRECTIVE 2002/96/EC.

At the end of its working life, the product must not be disposed of as urban waste.

It must be taken to a special local authority differentiated waste collection centre or to a dealer providing this service.

Disposing of a household appliance separately avoids possible negative consequences for the environment and health deriving from inappropriate disposal and enables the constituent materials to be recovered to obtain significant savings in energy and resources. As a reminder of the need to dispose of household appliances separately, the product is marked with a crossed-out wheeled dustbin.



Head Office Address:
Kenwood Limited, New Lane, Havant, Hampshire PO9 2NH, UK
www.kenwoodworld.com

Designed and engineered by Kenwood in the UK

Made in China

guarantee (UK only)

If your can opener goes wrong within one year from the date you bought it, we will repair or replace it free of charge provided:

- you have not misused, neglected or damaged it;
- it has not been modified (unless by Kenwood);
- it is not second-hand;
- it has not been used commercially;
- you have not fitted a plug incorrectly; and
- **you supply your receipt to show when you bought it.**

This guarantee does not affect your statutory rights.

KENWOOD

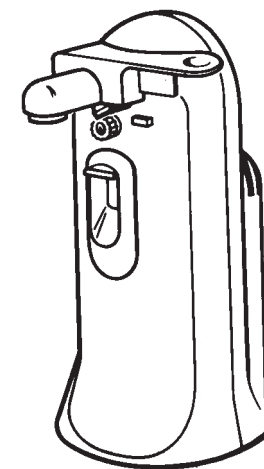

CO606

85576/7

know your table top can opener

Your Kenwood Can Opener can be used to open a variety of domestic can shapes and sizes. In addition the CO606 incorporates a bottle opener and a knife sharpening facility.

before using your Kenwood appliance

- Read these instructions carefully and retain for future reference.
- Remove all packaging and any labels.

safety

- Do not immerse appliance, cord or plug in water or other liquid.
- Never use a damaged appliance. Get it checked or repaired: see 'service and customer care'.
- Unplug the appliance from the mains supply
 - before cleaning
 - immediately after use.
- This appliance is not intended for use by persons (including children) with reduced physical, sensory or mental capabilities, or lack of experience and knowledge, unless they have been given supervision or instruction concerning use of the appliance by a person responsible for their safety.
- Children should be supervised to ensure that they do not play with the appliance.
- Only use the appliance for its intended domestic use. Kenwood will not accept any liability if the appliance is subject to improper use, or failure to comply with these instructions.

before plugging in

- Make sure your electricity supply is the same as the one shown on the underside of your can opener.

Important – UK only

- The wires in the cord are coloured as follows:
Blue = Neutral, Brown = Live.
- The appliance must be protected by a 3A approved (BS1362) fuse.

Note:

- For non-rewireable plugs the fuse cover MUST be refitted when replacing the fuse. If the fuse cover is lost then the plug must not be used until a replacement can be obtained. The correct fuse cover is identified by colour and a replacement may be obtained from your Kenwood Authorised Repairer (see Service).
- If a non-rewireable plug is cut off it must be DESTROYED IMMEDIATELY. An electric shock hazard may arise if an unwanted non-rewireable plug is inadvertently inserted into a 13A socket outlet.
- This appliance conforms to EC directive 2004/108/EC on Electromagnetic Compatibility and EC regulation no. 1935/2004 of 27/10/2004 on materials intended for contact with food.

key

- ① bottle opener
- ② drive wheel
- ③ magnet
- ④ lever
- ⑤ cutter blade
- ⑥ guide pin
- ⑦ knife sharpener
- ⑧ cord stowage

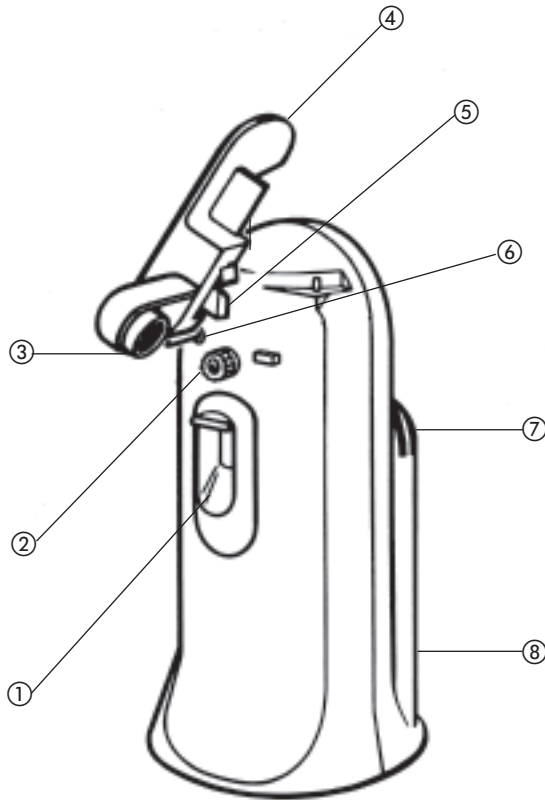

using your table top can opener

- 1 Ensure that the lever is in position with the magnet housing fully located (Fig. 1 and 2).
- 2 Plug the appliance into the power supply.
- 3 Lift the lever to the open position.
- 4 Hold the can with the top rim resting under the metal guide pin and the can resting on the drive wheel (Fig. 3).
- 5 Press the lever lightly down to start the motor. The self-starting blade will then pierce the can and commence cutting.
- 6 The can will be held fixed in position with the magnet resting against the lid. Large or wide cans may require extra support from the user.
- 7 Once the can is open, the motor will automatically stop, retaining the can and lid safely in place.
- 8 To remove, lift the lever whilst holding the can.
- 9 With the exception of aluminium cans, the lid will be retained by the magnet.
- 10 For tidiness, any unwanted length of cord can be stowed inside the appliance.

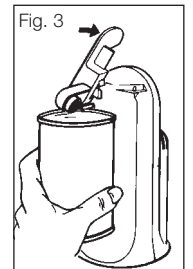
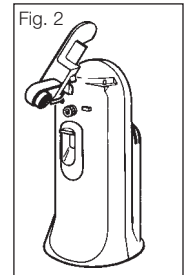
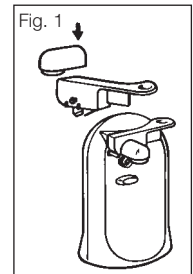

using the bottle opener

When opening tall bottles, the unit should be used towards the edge of a work top.

- 1 Position the bottle with the cap under the front rim of the bottle opener.
- 2 Push down the bottle to remove the cap whilst steadying the unit with one hand.

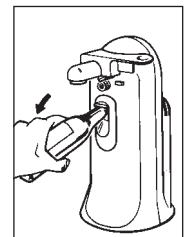

Free Manuals Download Website

<http://myh66.com>

<http://usermanuals.us>

<http://www.somanuals.com>

<http://www.4manuals.cc>

<http://www.manual-lib.com>

<http://www.404manual.com>

<http://www.luxmanual.com>

<http://aubethermostatmanual.com>

Golf course search by state

<http://golfingnear.com>

Email search by domain

<http://emailbydomain.com>

Auto manuals search

<http://auto.somanuals.com>

TV manuals search

<http://tv.somanuals.com>