

LIMITED WARRANTY AND LIMITATION OF LIABILITY

Decko Products warrants this product free from material and/or manufacturing defects for one year from date of purchase (three years on select cast iron pumps). As the sole and exclusive remedy for a breach of this limited warranty, if the product is found by Decko Products to be defective, Decko Products, at its option, will refund the purchase price or replace the product with an equivalent product if it is returned to the place of purchase or returned postpaid to Decko Products, ATTN: Warranty Dept., 2301 Traffic St. NE, Minneapolis, MN 55413, with proof of purchase. Any disassembly, modification, or abuse of this product voids this limited warranty. This product is not designed for pumping flammable or corrosive fluids, and use of this product to pump such materials also voids this limited warranty.

DECKO PRODUCTS DISCLAIMS ALL OTHER
EXPRESS OR IMPLIED WARRANTIES,
INCLUDING WARRANTIES OF
MERCHANTABILITY OR FITNESS FOR A PARTICULAR PURPOSE.

IMPORTANT NOTICE: Some commercial and residential insurance policies extend coverage for damages incurred by product failure. In most cases, you will need to have possession of the product to support your claim. In the case where you need to retain possession of the product to support a damage claim you submit to your insurance company, Decko Products will exchange the unit or refund the original price once the claim is settled with the insurer.



2301 Traffic St. NE
Minneapolis, MN 55413
1-800-495-9278
www.superiorpump.com



OWNER'S MANUAL

INSTALLATION AND OPERATION INSTRUCTIONS FOR SUBMERSIBLE UTILITY PUMPS

Models:

**91025, 91026, 91250, 91255,
91251, 91257, 91330, 91335,
91331, 91337, 91501, 91505**



If for any reason you have questions concerning your new Superior Pump, call us toll free at 1-800-495-9278, or contact us on the web at www.superiorpumpco.com

Carefully read and understand all of the Warnings and installation instructions in this manual. Failure to follow these instructions could lead to serious bodily injury and/or property damage. Retain these instructions for future reference.

This pump has been manufactured with your needs in mind. Properly installed in the right application, your new Superior Pump will give you years of carefree performance.

DANGER ⚠ Water and electricity can be dangerous if certain precautions are not adhered to. This pump is designed to operate perfectly safe in a water environment; however, improper use and installation can result in personal harm from electrical shock. Please pay attention to the following warnings.

WARNING ⚠ Never touch any electrical device, including this pump, when it is touching water, in water, or even in a moist environment. Always unplug (disconnect the electricity) when working on or installing the unit.

WARNING ⚠ **RISK OF ELECTRICAL SHOCK.** This pump is supplied with a grounding conductor and grounding-type attachment plug. To reduce the risk of electrical shock, be certain that it is connected only to a properly grounded, grounding-type receptacle.

WARNING ⚠ Do not use the power cord or discharge hose to carry or handle the pump. Doing so may cause damage to the power cord or discharge hose. Use the carrying handle supplied with the pump.

WARNING ⚠ Always use a grounded outlet to attach the plug. A three-prong mating type receptacle is needed for safe use. This should be in accordance with the National Electric Code and any additional codes or laws required by your local government.

NOTICE ⚠ It is strongly recommended to use a ground fault interrupt device on any electrical appliance, including this pump, when used in a wet or moist environment. This GFCI (ground fault circuit interrupter) should be listed by Underwriters Laboratories (UL). This is required by many local codes and enforcement agencies. It is strongly recommended by Superior Pump as it provides a much safer installation and will greatly reduce possible injury from electrical shock.

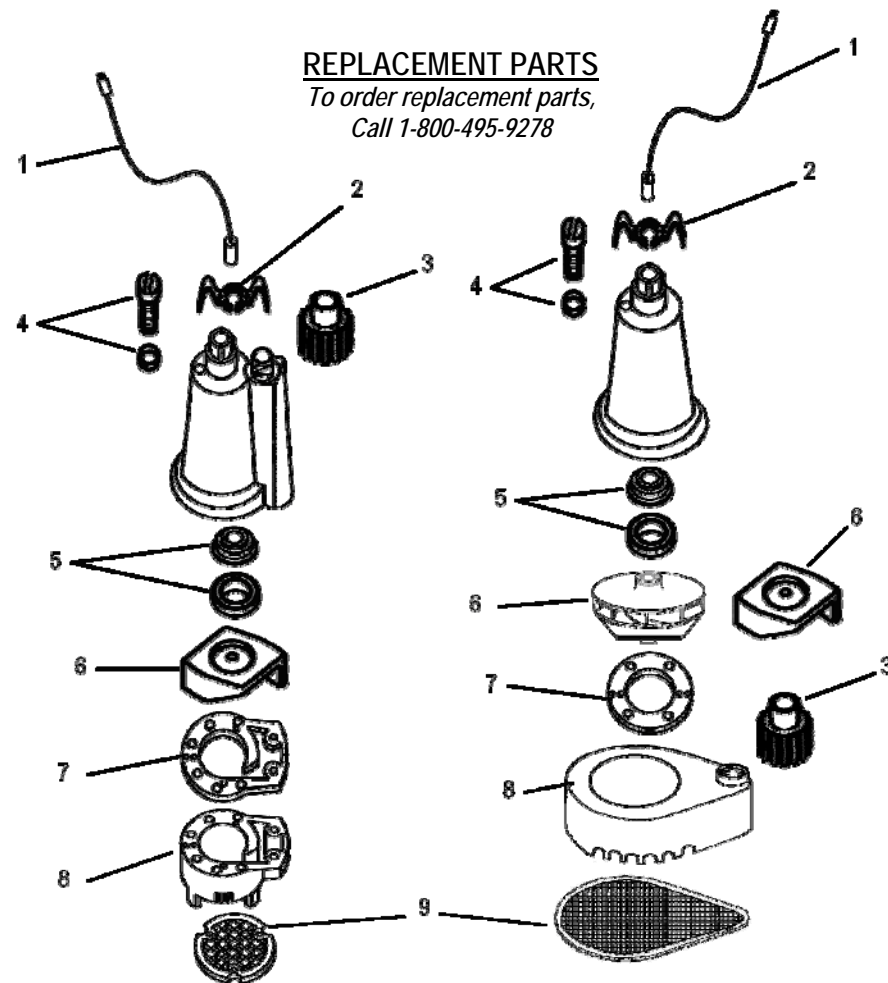

		Part # for Models:						
Ref. #	Description	91025	91026	91257			91337	91501
		91250	91255	91251	91330	91335	91331	91505
1	Power Cord	99008	99009		99008	99009		
2	Handle	99050	99050	99051	99050	99050	99051	99051
3	Garden Hose Adapter	99006	99006	99093	99006	99006	99093	
4	Oil Fill Plug with O-ring	99056	99056	99056	99056	99056	99056	99056
5	Shaft Seal	99057	99057	99057	99057	99057	99057	99057
6	Impeller	99060	99060	99087	99065	99065	99096	99070
7	Gasket	99062	99062	99088	99062	99062	99088	99064
8	Base	99067	99067	99078	99069	99069	99078	99071
9	Intake Screen	99073	99073	99076	99073	99073	99076	99074

DANGER ⚠ Do not use this unit to pump chemicals, flammable liquids, sewage or corrosive liquids. You could injure yourself and the pump will fail. Pumping these types of liquids voids the warranty. Superior Pump and other pump companies manufacture pumps for these types of liquids. Make sure you purchase a pump designed for your specific needs. This pump will handle fluids with the same characteristics as water. If you have any questions call us at 1-800-495-9278 or contact us on the web at www.superiorpumpco.com

WARNING ⚠ Your pump has thermal over-load protection built in. It is not recommended for pumping liquids over 120° F. The thermal overload protector will automatically shut down the pump in an overheat situation. It will then reset itself once the pump cools down. The pump will then work again. This overload is designed as a safety device and it will fail after repeated use. Normal operation is for fluids between 32° F & 120° F.

DO NOT RUN THE PUMP DRY. The pump depends on water for cooling and lubrication. Operating the pump without water may cause the motor to overheat or cause damage to parts of the pump. It may also shorten the life of your pump.

NOTICE ⚠
EXTENSION CORDS

For best performance, it is recommended to connect the power cord directly to the grounded GFCI outlet. If the use of an extension cord is necessary, always use a grounded waterproof type cord. Never use longer than a 25-ft. cord that is lighter than 14/3 gauge.

DANGER ⚠ Keep all electrical connections away from wet and moist environments. Wet connections can cause electrical shock resulting in personal injury.

USES
Your Superior Pump is designed to give you reliable performance and long life. It is designed to move water from one place to another. It is great for wet basements, roofs, ponds or waterfalls.

WARNING ⚠ ALWAYS DISCONNECT THE POWER SOURCE BEFORE ATTEMPTING TO INSTALL, SERVICE OR PERFORM MAINTENANCE ON THE PUMP. FAILURE TO DO SO MAY RESULT IN FATAL ELECTRICAL SHOCK.

INSTALLATION/OPERATION

1. Place the pump on a hard surface in the water. Do not set the pump directly in mud or sand. This may cause the intake screen to clog or damage to your pump.
2. The water level must be at least 1" deep for the pump to operate.
3. Plug the power cord into a grounded 120-volt AC outlet. The pump will start to operate as soon as the cord is plugged in.
4. The pump will remove water down to the following levels:
Models
91025, 91026, 91250, 91255 - pumps down to ¼" of the surface
91251, 91257, 91330, 91331, 91335, 91337 - pumps down to ½" of the surface
91501, 91505 - pumps down to 1" of the surface
5. The pump should be turned off once the water reaches these levels.
6. Do not let the pump run dry. The pump depends on water for cooling and lubrication. Operating the pump without water may cause the motor to overheat or cause damage to parts of the pump. It may also shorten the life of your pump.

Anything that will pass through the intake screen holes will pass through the pump without causing damage. The intake screen on the pump removes easily for cleaning. The units can also be back-flushed using the garden hose adapter.

NOTE: This pump has a built in anti-airlock device. Leakage is normal from this device.

TROUBLESHOOTING

PROBLEM	POSSIBLE CAUSES	HOW TO CORRECT
If the pump does not start or run	▪ Pump is not plugged in, switch or breaker is off	▪ Plug pump in or turn on switch/breaker
	▪ Check for blown fuses or tripped circuit breakers or tripped GFCI outlets	▪ Replace fuse, reset breaker, reset GFCI outlet
	▪ Motor thermal protector tripped	▪ Allow pump to cool. Pump will reset
If the pump runs but moves little or no water	▪ Clogged intake screen	▪ Clean or replace screen
	▪ Clogged discharge hose/pipe	▪ Remove clog
	▪ Frozen discharge hose/pipe	▪ Allow hose/pipe to thaw
	▪ Pump is air locked	▪ Clean out airlock hole with a paper clip or pipe cleaner
	▪ Low line voltage	▪ Check wire size and increase if necessary
	▪ Worn, damaged or clogged pump parts	▪ Inspect for wear, damage or clog and clean or replace if necessary
	▪ Discharge head exceeds pump capacity	▪ If pumping height is over 25', the pump will not move water. See performance chart

NOTICE ⚠ Height and/or piping restriction will reduce the pump output performance. See the performance chart below to insure you have the proper pump for your application. Whenever possible use the same or larger size pipe than the pump discharge for optimum performance. Reducing the pipe size will not harm your pump; it will just reduce the output.

PERFORMANCES

<i>Model</i>	<i>Discharge Height Above Pumping Level</i>					
	0'	5'	10'	15'	20'	25'
	Gallons per Minute					
91025, 91026	26	21	14	10	7	1
91250, 91251, 91255, 91257	30	22	20	16	9	2
91330, 91335	40	34	28	22	12	2
91331, 91337	46	36	30	25	12	1
91501, 91505	70	66	58	48	25	10

SPECIFICATIONS

<i>Model</i>	<i>91025 91026</i>	<i>91250 91255</i>	<i>91251 91257</i>	<i>91330 91335</i>	<i>91331 91337</i>	<i>91501 91505</i>
HP	1/5	1/4	1/4	1/3	1/3	1/2
Amps	3.6	3.8	3.8	4.1	4.1	7.6
Solids Handling	1/8"	1/8"	3/8"	1/8"	3/8"	1/2"
Warranty (Years)	1	1	3	1	3	3
Discharge Size	1 1/4"	1 1/4"	1 1/2"	1 1/4"	1 1/2"	1 1/2"

Power supply requirements..... 120V, 60 Hz

Motor..... Continuous Duty, Capacitor Start,
Thermally Protected

Liquid Temperature Range..... 32° F - 120° F (0° C - 49° C)

Circuit Requirements..... 15 amp

Free Manuals Download Website

<http://myh66.com>

<http://usermanuals.us>

<http://www.somanuals.com>

<http://www.4manuals.cc>

<http://www.manual-lib.com>

<http://www.404manual.com>

<http://www.luxmanual.com>

<http://aubethermostatmanual.com>

Golf course search by state

<http://golfingnear.com>

Email search by domain

<http://emailbydomain.com>

Auto manuals search

<http://auto.somanuals.com>

TV manuals search

<http://tv.somanuals.com>