

Bolt™

Inspiration strikes

CYCLONE | DR

Bolt PP-400DR Dual Outlet
Power Pack with Removable Battery

User's Manual





Copyright © 2013 Gradus Group.

Bolt and other names of Bolt products are trademarks of Gradus Group. Other product and corporate names mentioned herein are trademarks of their respective holders. All photos are for illustrative purposes only.



Introduction

Thank you for choosing Bolt, and congratulations on the purchase of your Bolt PP-400DR Power Pack for Portable Flash. This rechargeable large-capacity lithium-ion battery pack will supply up to 1400 flashes (depending on flash unit and power setting) and fast recycling times for one or two portable flashes at the same time. It's compatible with most on-camera flashes, including Nikon, Canon, Sony, Bolt, Sunpak, Vivitar, and Metz.

This Bolt Cyclone DR includes one removable and interchangeable battery pack—the PP-400BP (additional PP-400BP batteries are available separately). When the battery begins to lose power, it can be removed in just a few seconds and replaced with a new, fully charged PP-400BP battery—you can extend your shoot as long as you need to, without worrying about recharging.

The Bolt Cyclone DR features a microcontroller unit (MCU) circuit design with integrated software and hardware protection for more efficient energy use as well as heat-resistant lightweight construction.

Overview

- 1 Socket cover
- 2 Cable locking mechanism
- 3 Socket #1
- 4 Socket #2
- 5 Belt clip
- 6 Charging port
- 7 Battery pack
- 8 Battery pack lock
- 9 Control unit
- 10 Shoulder strap
- 11 Strap quick release
- 12 LED battery level indicator
- 13 Status indicator for Socket #1
- 14 Power button
- 15 Status indicator for Socket #2
- 16 AC battery charger

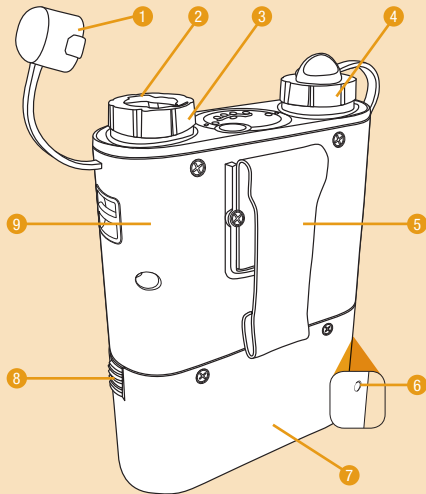

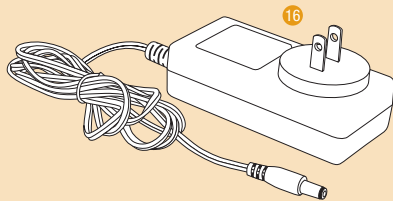
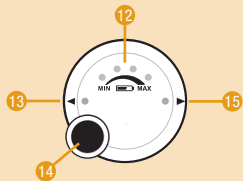
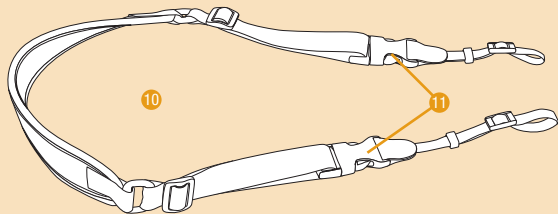

Warnings



- Do not disassemble or attempt to service this product yourself. Doing so will void the warranty, and Bolt will not be responsible for any damage. There are high-voltage components inside. Contact can produce a dangerous electric shock.
- Keep out of reach of children.
- Do not touch the metal part of the multifunction socket.
- This product is not water resistant. Keep it away from water and all flammable gases or liquids.
- Do not store or use this product at temperatures above 104°F (40°C).
- Do not connect this product to a charger other than the included unit.
- To avoid overheating and damaging your flash unit, please wait for at least 10 minutes after 40 continuous full-power flashes.
- Make sure the unit is powered off when plugging it in to a power source.
- Use only the correct, recommended voltage.
- Handle the unit with care.
- Clean the unit with a soft, dry cloth.

- Use only parts provided by the manufacturer.
- Please read and follow these instructions and keep this manual in a safe place.
- Make sure the item is intact and that there are no missing parts.

Charging the Cyclone DR

To charge your Cyclone DR with the included charger:

1. Plug the charger unit into an AC outlet.
2. Plug the charger cable into the charging port on the battery.
3. The charger indicator turning red indicates that the battery is being charged.
4. The charger indicator turning green indicates that the battery is fully charged.

Tip:

If you own two PP-400BP batteries, you can remove one battery from the power pack and charge it using the AC charger while using the second battery to power the Cyclone DR.

To get the maximum capacity from your Cyclone DR:

Charge your Cyclone DR shortly before use to ensure that the pack retains the maximum charge. Charge your Cyclone DR at a moderate room temperature, and avoid storing it in hot or cold environments between charging and use.

Note: When charging the pack outside of the United States, plug adapters (available separately) may be used to plug the charger into any 100-240 V AC power outlet.

Reading the indicator lights while charging:

The Status LED remains off during charging. The AC charger's indicator light will be red during charging. When the battery is fully charged, its light will turn green.

To check the battery level while the unit is charging, press the power button. The battery level will be displayed on the LED battery level indicator for approximately two seconds.

Checking the Cyclone DR's charge level:

When the Cyclone DR is not charging and is not connected to a flash unit, its level of charge can be checked by pressing the power button. The battery LEDs will illuminate to indicate the level of charge, as follows:



Battery LED 1 on: 25% or lower charge level

Battery LEDs 1-2 on: 25%-50% charge level

Battery LEDs 1-3 on: 50%-75% charge level

Battery LEDs 1-4 on: 75% or higher charge level

When Battery LED 1 is blinking, the Cyclone DR will disable power output—the battery needs immediate charging before it can operate again.

If the Cyclone DR is in use continuously for 12 hours, its automatic power-off function will cause it to power off automatically.

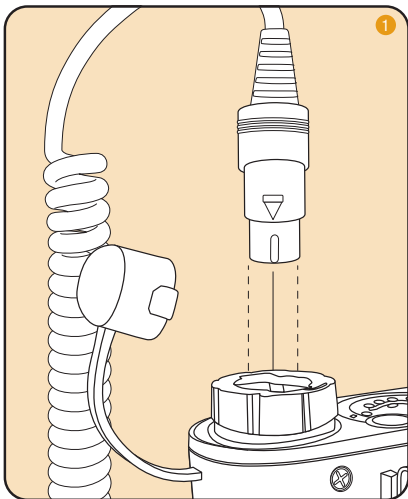

Connecting Your Bolt Cyclone DR Power Pack to Your Flash

You can use the Cyclone DR to power a wide range of flash units. Its level of charge can be checked, you must use a compatible connection cable. Cables sold by some flash and battery pack manufacturers are interchangeable with Bolt cables, but other flash brands use a different connector type. Make sure you select the right one.

Important! Load your flash unit with its standard batteries before connecting it to the Cyclone DR. You may need to set your flash unit to recycle by drawing power from the Cyclone DR only to avoid draining the installed batteries. Check your flash unit's manual for details on the relevant setting.

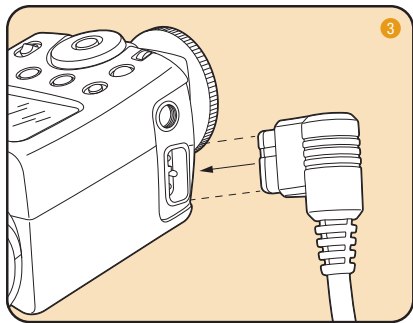

To connect your Cyclone DR to your flash unit:

1. Plug the metal connector of the connection cable firmly into one of the output sockets of the Cyclone DR.
2. If using a cable with a locking mechanism, rotate the locking collar on the terminal to secure the cable.
3. Plug the other end of the connection cable securely into the compatible power port on your flash unit.
4. Press the power button on the Cyclone DR and wait for the Status and battery LEDs to turn on, then power on your flash.

To disconnect your Cyclone DR from your flash unit:

1. Press the power button until the Status and battery LEDs turn off.
2. If you're using a cable with a locking mechanism, rotate the locking collar to the unlocked position.
3. Unplug the connection cable from the battery pack.

Using Your Flash with Your Cyclone DR

Your Cyclone DR can recycle in just 1 second with many popular flash units to keep you shooting and ensure that you don't miss important moments. With your flash firing at full power, it can power between 1200 and 1400 flashes, depending on the specific unit you're using. It can power thousands of shots in automatic mode with some flash units.

To get the best use out of your Cyclone DR:

- Use in environments with moderate temperatures.
- Don't fire more than 40 full-power flashes in a row. Doing this can overheat and even damage your flash. The Cyclone DR has a much higher power output than the typical built-in battery of a flash unit. Refer to your flash unit's manual for information on its continuous full-power flash capacity and limitations.

Reading the indicator lights while using the Cyclone DR:

When you're using your Cyclone DR, its Red Status LED will remain on to indicate that the flash is ready to fire. Its four blue battery LEDs will indicate the level of charge as follows:

Battery LED 1 on: 25% or lower charge level

Battery LEDs 1-2 on: 25%-50% charge level

Battery LEDs 1-3 on: 50%-75% charge level

Battery LEDs 1-4 on: 75% or higher charge level

Battery LED 1 flashing: The Cyclone DR has been drained and needs to be charged.

Status LED flashing: The Status LED flashing indicates that the battery is overheated. Stop using the pack for at least 10 minutes to allow it to cool.

Carrying and wearing the Cyclone DR:

The Cyclone DR is designed to be easy to carry and inconspicuous. Its light weight and compact design make it easy to wear for long periods, and its black finish and clean design make it unobtrusive. It also offers these convenient features:

- **Padded feet.** Two rubberized feet give the Cyclone DR stability and protection when you set it down.
- **Belt clip.** One of the easiest ways to carry the Cyclone DR is to attach it to your belt with the included clip. When you won't be carrying the pack on your belt, you can give it a cleaner profile by removing the clip. To do this, loosen the screws securing it with a Phillips screwdriver, remove the clip, then tighten the screws again.
- **Shoulder strap.** Thread the shoulder strap through the built-in lugs on the Cyclone DR and through the strap clips and buckles, as shown here. After threading it, pull it tight to take up any slack. Always make sure that your strap is attached securely; dropping the Cyclone DR can damage it.

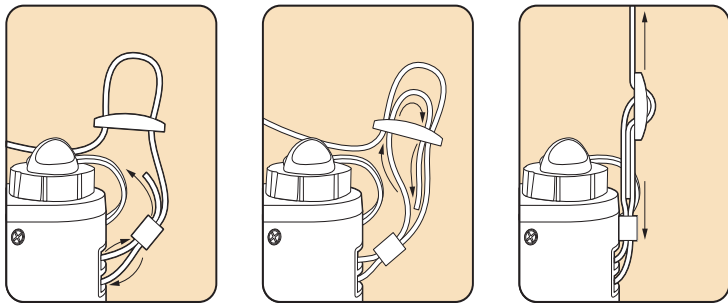

Troubleshooting

Problem	Solution
The Cyclone DR is charged and connected to a flash with a cable, but no indicator lights illuminate when you turn it on.	The cable is damaged or you are using the wrong cable.
The Status indicator light is flashing.	The pack is overheated. Turn it off and wait for at least 10 minutes before using it again.
The Cyclone DR is charged and connected to a flash with a cable, but the flash does not fire.	Make sure you have AA or other internal batteries installed in the flash. These may be required for its computer functions to work.

Customer Service

For customer service, please go to www.boltflashes.com.

Specifications

Power Pack Cyclone DR:

Battery type: lithium-ion

Voltage: 11.1 V DC

Capacity: 4500 mAh

Recycle time with hotshoe-mounted flash units:
approx. 1 second (at full flash power)

Flashes per charge:

approx. 1200-1400 (at full flash power)

Operation environment working temperature range:
-4°F to 104°F (-20°C to 40°C)

Operation environment working humidity:
85% or less

Dimensions: (W x H x D): 4.33 x 6.29 x 1.57 in.
(110 x 160 x 40 mm) including belt clip

Weight: 19.4 ounces (550 grams)

AC Charger BO-1008:

Input: 100-240V AC 50/60Hz

Output: 12V DC 1500mA

Cord length: 60 in. (1.5 m)

Dimensions: 3.75 x 1.25 x 1.62 in.
(95 x 32 x 41 mm)

Warranty

LIMITED ONE-YEAR WARRANTY

Bolt provides a limited warranty that this product is free from defects in materials and workmanship to the original purchaser under normal use for a period of one (1) year from the original purchase date or thirty (30) days after replacement (the “Warranty Period”), whichever occurs later. Our responsibility with respect to this limited warranty shall be limited solely to repair or replacement, at its option, of any product which fails during normal consumer use.

To obtain warranty coverage during the Warranty Period, contact your place of purchase (“Seller”) to obtain a return merchandise authorization (“RMA”) number, and return to Seller the defective product along with proof of purchase and the RMA number.

This warranty does not extend to damage or failure which results from misuse, neglect, accident, alteration, abuse, improper installation or maintenance. EXCEPT AS PROVIDED HEREIN, BOLT MAKES NEITHER ANY EXPRESS WARRANTIES NOR ANY IMPLIED WARRANTIES, INCLUDING BUT NOT LIMITED TO ANY IMPLIED WARRANTY OF MERCHANTABILITY OR FITNESS FOR A PARTICULAR PURPOSE. This warranty provides you with specific legal rights, and you may also have additional rights which vary from state to state.

www.boltflashes.com

Compatible Devices and Accessories

The Cyclone DR is compatible with a wide range of hotshoe and handle-mount flash units. Make sure you select a connection cable that is compatible with your flash unit.

Many compatible accessories are also available from Bolt and other brands. Bolt connection cables are interchangeable with some other manufacturers' battery pack connection cables.

These optional accessories are available from Bolt:

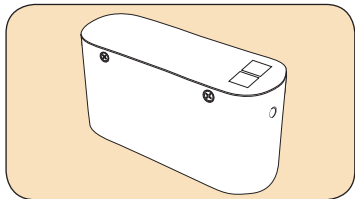

Bolt PP-400BP Battery Pack

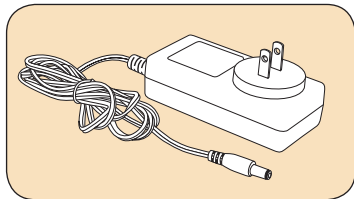

Bolt BO-1008 Replacement Charger

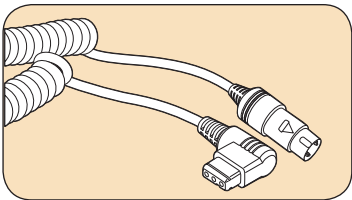

**BO-1006 CZ Canon Flash Cable
With Locking Mechanism**

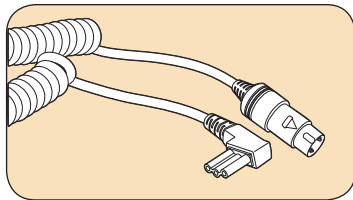

**BO-1007 CKE Nikon Flash Cable
With Locking Mechanism**

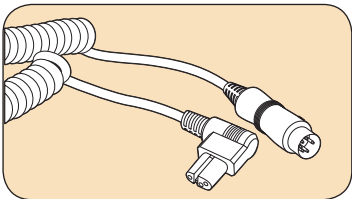

BO-1005 Sony Flash Cable

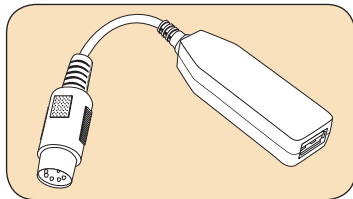

Bolt USB-C Charger for Mobile Devices



Bolt™

www.boltflashes.com

Copyright © 2013 Gradus Group

Free Manuals Download Website

<http://myh66.com>

<http://usermanuals.us>

<http://www.somanuals.com>

<http://www.4manuals.cc>

<http://www.manual-lib.com>

<http://www.404manual.com>

<http://www.luxmanual.com>

<http://aubethermostatmanual.com>

Golf course search by state

<http://golfingnear.com>

Email search by domain

<http://emailbydomain.com>

Auto manuals search

<http://auto.somanuals.com>

TV manuals search

<http://tv.somanuals.com>