

CASIO® ANALOG (3H3E)

1343 1794 2364 5071 5072

ENGLISH

- Be sure to keep all user documentation handy for future reference.
- Your watch may differ somewhat from the one shown in the illustration.

Notes

- Some water resistant models are equipped with a screw lock crown.
- With such models, you must unscrew the crown in the direction noted in the illustration to loosen it before you can pull it out. Do not pull too forcibly on such crowns.
- Also note that such watches are not water resistant while their crowns are loosened. Be sure to screw the crowns back in as far as they will go after making any setting.



To Set Time and Date

[Setting date]

- Pull the crown out to the first click.
- Set the date by turning the crown. Avoid setting the date between the hour of 8:00 p.m. and 1:00 a.m. (The date display may not change in the following day).
- Push the crown in to the normal position.

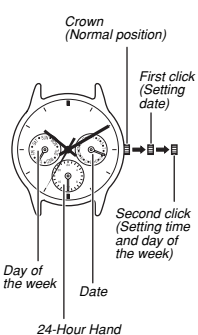

[Module 1343/2364/5071]

[Setting time and day of the week]

- Pull the crown out to the second click when the second hand is at 12 o'clock position and the second hand stops.
- Set the hands by turning the crown. As you do, the day of the week changes accordingly.
- After setting day of the week, carefully set the time, making sure to distinguish between AM and PM.
- In accordance with a time signal, push the crown in.

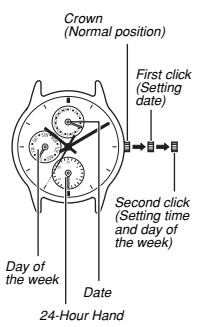

[Module 1794/5072]

- For watch with the elapsed time bezel: Rotate the elapsed time bezel to align the mark with the minute hand. After certain amount of time elapsed, read the graduation on the elapsed time bezel which the minute hand points to. The elapsed time is indicated.



Elapsed time bezel

Specifications

Module No.	Accuracy at normal temperature	Battery type	Battery life
1343	±20 seconds per month	SR916SW	Approx. 3 years
1794/2364	±20 seconds per month	SR621SW	Approx. 2 years
5071/5072	±20 seconds per month	SR621SW	Approx. 3 years

Operating Precautions

Water Resistance

- The following applies to watches with WATER RESIST or WATER RESISTANT marked on the back cover.

Marking	On watch front or on back cover	Water Resistance Under Daily Use	Enhanced Water Resistance Under Daily Use		
			5 Atmospheres	10 Atmospheres	20 Atmospheres
Example of Daily Use	Hand washing, rain	No BARI mark	5BAR	10BAR	20BAR
	Water-related work, swimming	Yes	Yes	Yes	Yes
	Windsurfing	No	No	Yes	Yes
	Skin diving	No	No	Yes	Yes

- Do not use this watch for scuba diving or other types of diving that requires air tanks.
- Watches that do not have WATER RESIST or WATER RESISTANT marked on the back cover are not protected against the effects of sweat. Avoid using such a watch under conditions where it will be exposed to large amounts of sweat or moisture, or to direct splashing with water.
- Even if a watch is water-resistant, do not operate its buttons or crown while it is submerged in water or wet.
- Even if a watch is water-resistant, avoid wearing it in the bath or in areas where detergents (soap, shampoo, etc.) are being used. Such conditions can reduce water resistance.
- After submersion in seawater, use plain water to rinse all salt and dirt from the watch.
- In order to maintain water resistance, have the gaskets of your watch replaced periodically (about once every two or three years).
- A trained technician will know how to check your watch for proper water resistance whenever you have its battery replaced. Battery replacement requires the use of special tools. Always request battery replacement from your original retailer or from an authorized CASIO Service Center.
- Some water-resistant watches come with fashionable leather bands. Avoid swimming, washing, or any other activity that causes direct exposure of a leather band to water.
- The inside surface of the watch glass may fog when the watch is exposed to a sudden drop in temperature. No problem is indicated if the fogging clears up relatively quickly. If the fogging does not clear or if water has gotten into the watch, take the watch in for repair immediately.
- Continued use of the watch with water inside can result in damage to electronic and mechanical components, the face of the watch, etc.

Band

- Tightening the band too tightly can cause you to sweat and make it hard for air to pass under the band, which can lead to skin irritation. Do not fasten the band too tightly. There should be enough room between the band and your wrist so you can insert your finger.
- Deterioration, rust, or corrosion of the band can cause it to break, which may result in the watch falling off your wrist and becoming lost. Be sure to take good care of the band and keep it clean. Should you notice any breakage, discoloration, looseness or other problem with the band, immediately contact your original retailer or an authorized CASIO Service Center to have it checked, repaired, or replaced. Note that you will be charged for any repair or replacement of the band.

Temperature

- Never leave the watch on the dashboard of a car, near a heater, or in any other location that is subject to very high temperatures. Do not leave the watch where it will be exposed to very low temperatures, either. Temperature extremes can cause the watch to lose or gain time, to stop, or otherwise malfunction.

Impact

- Your watch is designed to withstand impact incurred during normal daily use and light activity such as playing catch, tennis, etc. Dropping the watch or otherwise subjecting it to strong impact, however, can lead to malfunction. Note that watches with shock-resistant designs (G-SHOCK, Baby-G, G-ms) can be worn while operating a chain saw or engaging in other activities that generate strong vibration, or while engage in strenuous sports activities (motocross, etc.).

Magnetism

- The hands of analog and combination (analog-digital) watches are moved by a motor that uses magnetic force. When such a watch is close to a device (audio speakers, magnetic necklace, cell phone, etc.) that emits strong magnetism, the magnetism can cause timekeeping to slow down, speed up, or stop, resulting in the incorrect time being displayed.

Electrostatic Charge

- Exposure to very strong electrostatic charge can cause the watch to display the wrong time. Very strong electrostatic charge even can damage electronic components.

Chemicals

- Do not allow the watch to come into contact with thinner, gasoline, solvents, oils, or fats, or with any cleaners, adhesives, paints, medicines, or cosmetics that contain such ingredients. Doing so can cause discoloration or damage to the case, resin band, leather band, and other parts.

Storage

- If you do not plan to use the watch for a long time, wipe it thoroughly free of all dirt, sweat, and moisture, and store it in a cool, dry place.

Resin Components

- Allowing the watch to remain in contact with other items or storing it together with other items for long periods while it is wet can cause the color of the other items to transfer to the resin components of the watch. Be sure to dry off the watch thoroughly before storing it and make sure it is not in contact with other items.
- Leaving the watch where it is exposed to direct sunlight (ultraviolet rays) for long periods or failure to clean dirt from the watch for long periods can cause it to become discolored.
- Friction caused by certain conditions (frequent external force, sustained rubbing, impact, etc.) can cause discoloration of painted components.
- If there are printed figures on the band, strong rubbing of the printed area can cause discoloration.
- Failure to clean dirt from the watch for long periods can cause fluorescent color to fade. Wash dirt off with water as soon as possible and then dry the watch.
- Semi-transparent resin parts can become discolored due to sweat and dirt, and if exposed to high temperatures for long periods.

- Contact an authorized CASIO Service Center to have resin components replaced. Note that you will be charged for replacement costs.

Natural Leather and Imitation Leather Bands

- Allowing the watch to remain in contact with other items or storing it together with other items while it is wet for long periods can cause the color of the other items to transfer to the natural leather or imitation leather band of the watch. Be sure to dry off the watch thoroughly before storing it and make sure it is not in contact with other items.
- Leaving a leather band where it is exposed to direct sunlight (ultraviolet rays) for long periods or failure to clean dirt from a leather band for long periods can cause it to become discolored.

Important!

- Subjecting a natural leather or imitation leather band to rubbing or dirt can cause color transfer and discoloration.

Metal Components

- Failure to clean dirt from a metal band can lead to formation of rust, even if the band is stainless steel or plated. If the watch is exposed to sweat or water, wipe it thoroughly with a soft, absorbent cloth and then store it in a well-ventilated location to dry.
- To clean the band, use a soft toothbrush or similar tool to scrub it with a weak solution of water and a mild neutral detergent. Take care to avoid getting solution on the watch case.

Bacteria and Odor Resistant Band

- The bacteria and odor resistant band protects against odor generated by the formation of bacteria from sweat, which ensures good comfort and hygiene. In order to ensure maximum bacteria and odor resistance, keep the band clean. Use an absorbent soft cloth to wipe the band clean of dirt, sweat, and moisture. The bacteria and odor resistant band suppresses the formation of organisms and bacteria. It does not protect against rash due to allergic reaction, etc.

Note that CASIO COMPUTER CO., LTD. assumes no responsibility for any damage or loss suffered by you or any third party arising through the use of this product or its malfunction.

User Maintenance

Caring for Your Watch

- A dirty or rusty case or band can soil the sleeve of your clothing, cause skin irritation, and even interfere with watch performance. Be sure to keep the case and band clean at all times. Rust tends to form easily after the watch is exposed to seawater and then left without cleaning.
- Sometimes a smudge like pattern may appear on the surface of a resin band. This will not have any effect on your skin or clothing. Wipe the band with a cloth to clean it.
- Keep a leather band clean by wiping it with a dry cloth. Both resin bands and leather band can become worn and cracked over time when subjected to normal daily use.
- Should your band become badly cracked or worn, be sure to have it replaced with a new one. Request band replacement from your original retailer or an authorized CASIO Service Center. Note that you will be charged for band replacement costs, even if your watch is still covered by its warranty.
- Remember that you wear your watch next to your skin, just like a piece of clothing. Because of this, you should always keep your watch clean. Use a soft, absorbent cloth to wipe off any dirt, sweat, water, or other foreign matter from the case and band.

Dangers of Poor Watch Care

Rust

- Though the stainless steel used for the watch is highly rust-resistant, rust can form if the watch is not cleaned after it becomes dirty. Failure of oxygen to come into contact with the metal because it is dirty causes breakdown of the oxidation layer on the metal surface, which leads to the formation of rust.
- Even if the surface of the metal appears clean, sweat and rust in crevasses can soil the sleeves of clothing, cause skin irritation, and even interfere with watch performance.

Premature Wear

- Leaving sweat or water on a resin band or storing it in an area subject to high moisture can lead to premature wear, cuts, and breaks.

Skin Irritation

- Individuals with sensitive skin or in poor physical condition may experience skin irritation when wearing a watch. Such individuals should keep their leather band or resin band particularly clean, or switch to a metal band. Should you ever experience a rash or other skin irritation, immediately remove the watch and contact a skin care professional.

Battery Replacement

- Leave battery replacement up to your original retailer or authorized CASIO Service Center.
- Have the battery replaced only with the type specified by in this manual. Use of another type of battery can cause malfunction.
- When replacing the battery, also request a check for proper water resistance. Note that you will be charged separately for water resistance inspection.

Initial Battery

- The battery that comes loaded in your watch when you purchase it is used for function and performance testing at the factory.
- This type of test battery may go dead quicker than the normally rated battery life as noted in the User's Guide. Note that you will be charged for replacement of this battery, even if replacement is required within the watch's warranty period.

Low Battery Power

- Low battery power is indicated by large timekeeping error, when display contents are dim, or when the display does blank.
- Operation while battery power is low can result in malfunction. Replace the battery as soon as possible.

Free Manuals Download Website

<http://myh66.com>

<http://usermanuals.us>

<http://www.somanuals.com>

<http://www.4manuals.cc>

<http://www.manual-lib.com>

<http://www.404manual.com>

<http://www.luxmanual.com>

<http://aubethermostatmanual.com>

Golf course search by state

<http://golfingnear.com>

Email search by domain

<http://emailbydomain.com>

Auto manuals search

<http://auto.somanuals.com>

TV manuals search

<http://tv.somanuals.com>