



PORTABLE AUTOMATIC ICE MACHINE



Model MIM-5802

Instruction Manual

Before operating your new appliance, please read all instructions carefully and keep for future reference

TABLE OF CONTENTS

IMPORTANT SAFEGUARDS _____	2
PARTS IDENTIFICATION _____	3
BEFORE FIRST USE _____	5
OPERATING INSTRUCTIONS _____	6
CARE & MAINTENANCE _____	7
TROUBLESHOOTING _____	8
WARRANTY & CUSTOMER SERVICE _____	9-10



IMPORTANT SAFEGUARDS

When using electrical appliances, basic safety precautions should be followed to reduce the risk of fire, electric shock, and injury to persons or property. Read all instructions before using any appliance.

1. This ice maker must be properly installed and located in accordance with the Installation Instructions before it is used.
2. Unplug the ice maker before cleaning and/or making repairs
3. We strongly recommend that any servicing be performed by a qualified individual.
4. Do not leave ice maker in extreme cold or warm temperatures.
5. Do not place ice maker near heat sources or open flames.
6. Clean the ice maker with a soft, damp cloth. Remove stains with a mild soap. Do not clean the unit with industrial grade solvents or abrasive chemicals.
7. Do not place heavy items on top of the ice maker.
8. Never install the ice maker where there is a lot of moisture and water can splash.
9. Exercise caution and use reasonable supervision when appliance is used near children.
10. Do not tip over.
11. Do not operate with side or back panels removed.
12. If the ice maker is brought in from outside in wintertime, give it a few hours to warm up to room temperature before plugging in.

CAUTION: DO NOT IMMERSE IN WATER.

SAVE THESE INSTRUCTIONS

THIS PRODUCT IS FOR HOUSEHOLD USE ONLY!

PARTS IDENTIFICATION

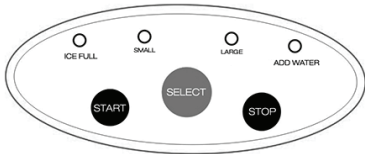

Control Panel Layout

Under Basket

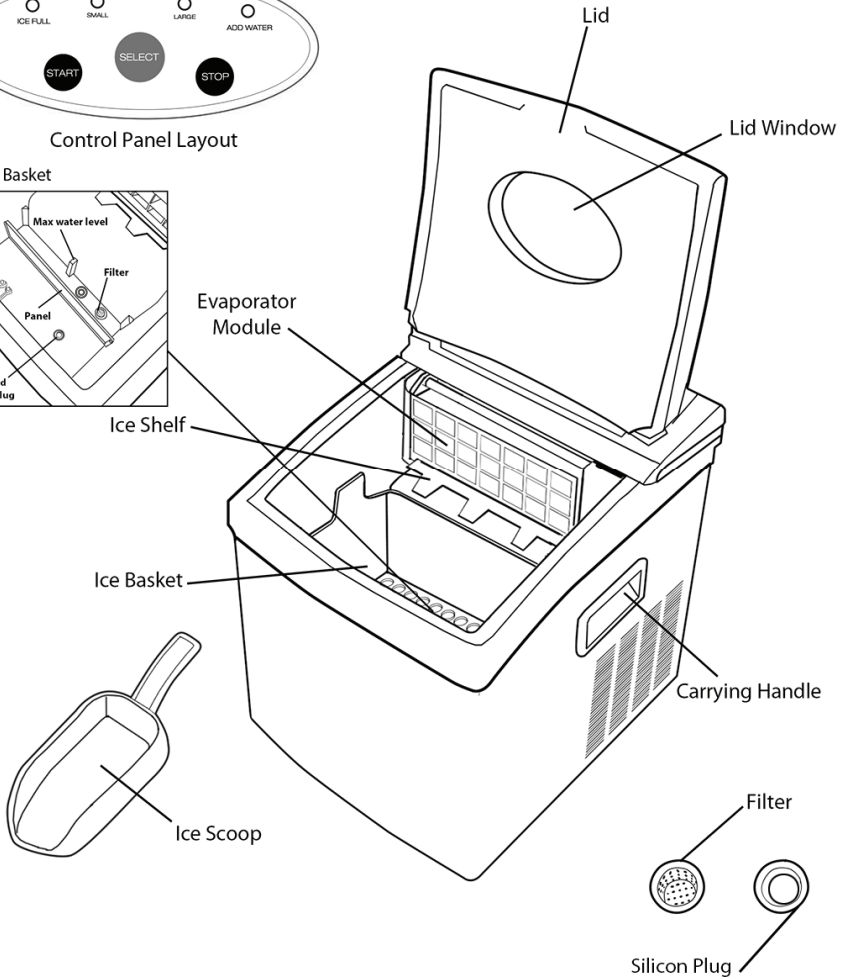
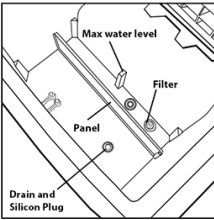

Both the Filter and the Silicone Plug are located below the Ice Basket on the bottom of the unit (See page 7).

GROUNDING INSTRUCTIONS

This appliance must be grounded. In the event of an electrical short circuit, grounding reduces the risk of electric shock by providing an escape wire for the electric current. This appliance is equipped with a cord having a grounding wire with a grounding plug. The plug must be inserted into an outlet that is properly installed and grounded.

WARNING:

Improper use of the grounding plug can result in a risk of electric shock. Consult a qualified electrician or service person if the grounding instructions are not completely understood or if doubt exists as to whether the appliance is properly grounded.

If it is necessary to use an extension cord, use only a three-wire extension cord that has a three blade grounding plug and a three-slot receptacle that will accept the plug on the appliance. The marked rating of the extension cord should be equal to or greater than the electrical rating of the appliance.

SHORT CORD PURPOSE

- 1) A short power-supply cord is provided to reduce risks of injuring yourself from becoming entangled in or tripping over a longer cord.
- 2) Longer extension cords are available and may be used if you exercise caution during use.
- 3) If a longer cord is used please note the following:
 - The marked electrical rating of the extension cord should be at least as great as the electrical rating of the appliance.
The longer cord should be arranged so that it will not drape over the counter top where it can be pulled on by children or tripped over unintentionally.

POLARIZED PLUG

If this appliance has a *polarized plug* (meaning one blade is wider than the other one), please follow the below instructions:

To reduce the risk of electric shock, this plug is intended to fit into a polarized outlet only in one direction. If the plug does not fit fully into the outlet, reverse the plug. If it still does not fit, contact a qualified electrician. Do not attempt to modify the plug in any way.

INSTALLATION

1. **Ventilation:** Do not block air vents. It is necessary to have adequate ventilation space around the ice maker in order to sustain proper performance, dissipation of heat, maintain efficiency and keep power consumption low. There should be a 5 inch minimum clearance maintained at the rear and sides of the unit and 8 on the top of the unit.
2. **Cleaning:** It is highly recommended to thoroughly clean the ice maker before first use.
3. **Wait One Hour:** When plugging in for the first time, wait one hour for refrigerant fluid to settle before turning the unit on.
4. **Power Supply:**
The ice maker should always be plugged into its own individual electrical outlet which has a voltage rating that matches the rating label.

BEFORE FIRST USE

1. Remove all exterior and interior packaging. Check that ice basket and ice scoop are included. If any part or accessory is missing, please contact customer service.
2. Clean the interior with lukewarm water and a soft cloth. Remove the ice basket and wash in warm water.
3. Find a location for your ice maker that is protected from direct sunlight and other sources of heat (i.e.: stove, furnace, and radiator). Place the ice maker on a flat, level surface. Make sure that there is at least 5 inches of space between the back and sides of your ice maker and the wall.
4. Make sure the Silicone Plug is inserted properly into the bottom of the water tank beneath the ice basket.
5. **Allow one hour for the refrigerant fluid to settle before plugging in the unit.**
6. The appliance must be positioned so that the plug is accessible.

OPERATING INSTRUCTIONS

1. Open the lid, remove the Ice Basket and pour water into the water reservoir. Do not exceed the maximum water level line or fill less than the minimum water level line (See Figure 1).
2. Place the Ice Basket back into the ice maker. Make sure the water level in the water reservoir is not higher than the bottom of the Ice Basket.
3. Plug in the unit.
4. Press **"SELECT"** to choose the desired ice cube size **"SMALL"** or **"LARGE."** When you choose large ice cubes, the **"LARGE"** indicator light will illuminate. When you choose small ice cubes, the **"SMALL"** indicator light will illuminate.
5. Press the **"START"** button to start machine (See Figure 2), the ice making process will last approximately 1 hour for the first batch and 30 minutes thereafter depending on size chosen, ambient temperature and how long the unit has been in operation.
6. The ice maker will automatically stop making ice when the ice basket is full and the **"ICE FULL"** indicator light will illuminate.
7. Press the **"STOP"** button at any time to stop making ice.
8. Change the water in the tank every 24 hours to maintain a reasonable hygiene level. Please drain water if the ice maker is not in use.
9. If **"ADD WATER"** indicator light is illuminated, the water level has reached the minimum water level.
 - Refill the tank with fresh water. Do not exceed the maximum water level.
 - Press **"START"** to restart the ice making process.

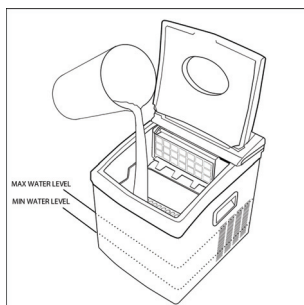

Figure 1.

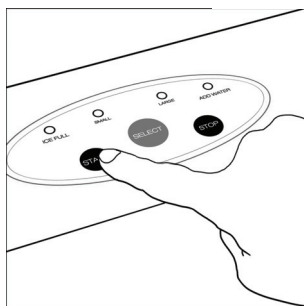

Figure 2.

The ice maker will not automatically re-start the ice making process after the add water light has turned on. Upon adding more water, you must push **"START" to restart the ice making process.

If the ice in the basket melts and the water in the tank rises, you must STILL push **"START" to restart the ice making process.

WARNING:

Only fresh, clean water should be used to make ice. Other liquids such milk, juice, and soda will damage the machine!

NOTE:

When the ambient temperature is lower than 70°F, the SMALL setting is recommended. When the ambient temperature is higher than 77°F, the LARGE setting is recommended. This unit has the unique ability to make CLEAR ice. An insufficient amount of water in the water tank may lead to white, cloudy ice. Add more water to the water tank for CLEAR ice, which is the desired effect.

CARE & MAINTENANCE

1. Unplug the unit and remove the ice basket.
2. Pull out (upwards towards you) the Silicone Plug which is located at the bottom of the water tank beneath the ice basket. (See figure 3). Make sure there is a large bucket or bowl placed underneath the unit to catch the water draining from the ice maker.
3. Clean the interior with a solution of vinegar and warm water using a soft cloth.
4. The outside of the ice maker should be cleaned regularly with a mild detergent solution and warm water.
5. Dry the interior and exterior with a soft cloth.
6. Place the Silicone Plug back into the drain area.
7. When the machine is not in use, be sure to drain water completely from water reservoir.
8. To ensure the cleanliness of the ice cubes, water in the water reservoir should be replaced every 24 hours.
9. If the compressor stops for any reason such as water shortage, too much Ice, power outage, etc, DO NOT start the system right away, wait 3 minutes, and then re-start the ice maker.
10. Always add fresh water before starting ice production, at initial installation, or after long shut off periods.
11. Please clean your Ice maker regularly. Do not spray Ice maker with chemicals or diluted agents such as acids, gasoline or oil. Rinse thoroughly before starting.
12. Mold formation can occur if moisture gets trapped inside the unit. Drain unit of water after every use and ensure the inside of the unit is completely dry before storing.

NOTE:

The Water Filter must be cleaned frequently; at least once a week. Remove Water Filter from the Draining Hole and clean the filter of any residue by rinsing with water. If the water filter becomes dirty or clogged, water cannot be properly drained from the tank. The "ADD WATER" indicator will be illuminated.

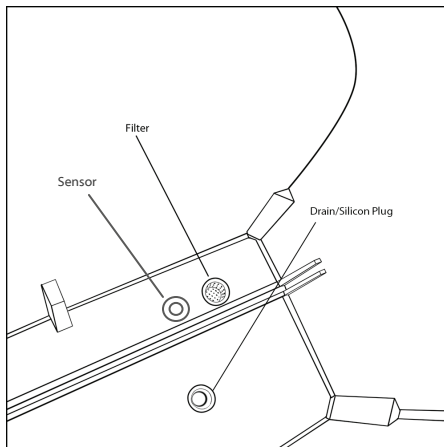

Figure 3.

TROUBLESHOOTING

Problem	Possible Cause	Suggested Solutions
The compressor works abnormally with a buzzing noise	The voltage is lower than recommended	Stop the Ice maker and do not restart until the voltage is normal.
The ADD WATER light is on	1. There is no water 2. The water filter is clogged with residue	1. Press the "STOP" button, fill with water, wait 3 minutes and press the "START" button again to restart. 2. Remove water filter and rinse filter with water to clean any residue buildup **The ice maker will not automatically re-start the ice making process after the add water light has turned on. Upon adding more water, you must push " START " to restart the ice making process. **If the ice in the basket melts and the water in the tank rises, you must STILL push " START " to restart the ice making process.
Indicator light on the display is not on	Broken fuse/No power	Replace fuse / Check the power cord and socket
The ice is too large and forms into one large block onto the evaporator module.	The temperature of water in the water reservoir is too low or the ambient temperature is below 77° F	Stop the machine and reset the ice size. Choose the small size, then Restart the machine. If problem persists, machine may need to be relocated to a warmer location.
Conditions For ice making cycle are right but no ice is made.		Call for service
The lights of ICE FULL and ADD WATER come on in the same time.	Water tray is blocked by ice cube	Clear the ice cube under the ice shovel then press "START" button, wait two minutes for the machines to restart automatically
The ice is not clear and appears white in color.	There is an insufficient amount of water in the water tank.	Add more water.

This appliance is intended for Household Use Only.

**LIMITED WARRANTY* ONE (1) YEAR
WARRANTY IS ONLY VALID WITH A DATED PROOF OF PURCHASE**

1. Your small kitchen appliance is built with precision, inspected and tested before leaving our factory.
2. It is warranted, to the original purchaser to be free from any manufacturing defects under normal use and conditions for one (1) year, cord excluded. This Warranty applies only to the original purchaser of this product.
3. If you need to exchange the unit, please return it in its original carton, with a sales receipt, to the store where you purchased it. If you are past the stores allowed return policy period, please see the enclosed Warranty.
4. If you use your appliance for household use and according to instructions, it should give you years of satisfactory service.
5. During the one-year warranty period, a product with a defect will be either repaired or replaced with a new or reconditioned comparable model (at our option) when the product is returned to our Service Center. (See the "Returns" section below).
6. The repaired or replacement product will be in warranty for the remaining balance of the one-year warranty period and an additional one-month period.
7. **This limited warranty covers appliances purchased and used within the 50 contiguous states plus the District of Columbia and does NOT cover:**
 - Damages caused by unreasonable use, neglect, normal wear and tear, commercial use, improper assembly or installation of product.
 - Damages caused in shipping.
 - Damages caused by replacement or resetting of house fuses or circuit breakers.
 - Defects other than manufacturing defects.
 - Breakage caused by misuse, abuse, accident, alteration, lack of proper care and maintenance, or incorrect current or voltage.
 - Lost or missing parts of the product. Parts will need to be purchased separately.
 - Damages of parts that are not electrical; for example: cracked or broken plastic or glass.
 - Damage from service or repair by unauthorized personnel.
 - Extended warranties purchased via a separate company or reseller.
 - Consumer's remorse is not an acceptable reason to return a product to our Service Center.

*One Year Limited Warranty valid only in the **50 contiguous states plus the District of Columbia, excluding** Puerto Rico and the Virgin Islands.

This warranty is effective only if the product is purchased and operated in the USA; product usage which is in violation of the written instructions provided with the unit will void this warranty.

For international warranty, please contact the local distributor.

**Any instruction or policy included in this manual may be subject to change at any time.

MAXI-MATIC, USA

18401 E. Arenth Ave. City of Industry, CA 91748

Customer Service Dept: (626) 912-9877 Ext: 120/107 MON-FRI 8am-5pm PST

Website: www.maxi-matic.com email: info@maxi-matic.com

RETURN INSTRUCTIONS

RETURNS:

A. Any return of defective merchandise to the manufacturer must be processed accordingly by first contacting customer service (contact information shown below) to obtain an RA # (Return Authorization Number). We will not accept any returns of merchandise without an applicable RA #.

B. **IMPORTANT RETURN INSTRUCTIONS.** Your Warranty depends on your following these instructions if you are returning the unit to Maxi-Matic USA:

1. Carefully pack the item in its original carton or other suitable box to avoid damage in shipping.
2. Before packing your unit for return, be sure to enclose:
 - a) Your name, full address with zip code, daytime telephone number, and RA#,
 - b) A dated sales receipt or **PROOF OF PURCHASE**,
 - c) The model number of the unit and the problem you are having (Enclose in an envelope and tape directly to the unit before the box is sealed,) and
 - d) Any parts or accessories related to the problem.
3. Maxi-Matic USA recommends you ship the package U.P.S ground service for tracking purposes. We cannot assume responsibility for lost or damaged products returned to us during incoming shipment. For your protection, always carefully package the product for shipment and insure it with the carrier. C.O.D shipments cannot be accepted.

4. All return shipping charges must be prepaid by you.

5. Mark the outside of your package:

MAXI-MATIC USA
18401 E. ARENTH AVE.
CITY OF INDUSTRY, CA 91748

6. Once your return has been received by our warehouse, Maxi-Matic USA will repair or replace the product if it is defective in material or workmanship, subject to the conditions in paragraph B.

7. Maxi-Matic will pay the shipping charges to ship the repaired or replacement product back to you.

Free Manuals Download Website

<http://myh66.com>

<http://usermanuals.us>

<http://www.somanuals.com>

<http://www.4manuals.cc>

<http://www.manual-lib.com>

<http://www.404manual.com>

<http://www.luxmanual.com>

<http://aubethermostatmanual.com>

Golf course search by state

<http://golfingnear.com>

Email search by domain

<http://emailbydomain.com>

Auto manuals search

<http://auto.somanuals.com>

TV manuals search

<http://tv.somanuals.com>