



# ***3.5 CUBIC FT. CHEST FREEZER***

## ***OWNER'S MANUAL*** **CF353**

Visit our Web site at [www.emersonradio.com](http://www.emersonradio.com)

UNAUTHORIZED MODIFICATIONS TO THIS DEVICE COULD VOID MANUFACTURER'S WARRANTY.

# **IMPORTANT SAFETY INSTRUCTIONS**

Please follow the precautions below for your new freezer:

1. This freezer must be properly installed and located in accordance with the Installation Instructions before it is used.
2. Do not allow children to climb, stand or hang on the shelves in the freezer. They could damage the freezer and seriously injure themselves.
3. Do not store or use gasoline or other flammable vapors and liquids in the vicinity of this or any other appliance.
4. Keep fingers out of the clearances between the doors and cabinet. Be careful closing doors when children are in the area.
5. Unplug the freezer before cleaning and making repairs or when not in use.
6. We strongly recommend that any servicing be performed by a qualified individual.
7. Turning the temperature control dial to the "OFF" position stops cooling but does not shut off power to the freezer.
8. Do not leave freezer in extreme cold or warm temperatures.
9. Do not place freezer near heat sources or open flames.
10. Clean the freezer with a soft, damp cloth. Remove stains with a mild soap. Do not clean the unit with industrial grade solvents, or abrasive chemicals.
11. Do not place heavy items on top of the freezer.
12. Never install the freezer where there is a lot of moisture and water can splash.
13. Do not allow children to hang on the doors; the freezer may be tipped over and hurt children.
14. Never eat spoiled food stored too long in the freezer or in an out-of-order freezer.
15. Do not use sharp tools inside the freezer - for example - to remove ice as damage may occur.
16. Unplug and remove food from the freezer if not used for a long period of time.

## **PROPER DISPOSAL**

An empty freezer is an extremely dangerous attraction to children. If you are getting rid of your old freezer, please follow the instructions in the Child Entrapment Warning.

## **CHILD ENTRAPMENT WARNING:**

Risk of child entrapment. Before you throw away your old freezer or freezer:

1. Take off the doors.
2. Leave the shelves in place so that children may not easily climb inside.

**CAUTION: USE OF AN EXTENSION CORD IS NOT RECOMMENDED.**

**FOR HOUSEHOLD USE ONLY  
SAVE THESE INSTRUCTIONS**

# GROUNDING INSTRUCTIONS

This appliance must be grounded. In the event of an electrical short circuit, grounding reduces the risk of electric shock by providing an escape wire for the electric current. This appliance is equipped with a cord having a grounding wire with a grounding plug. The plug must be inserted into an outlet that is properly installed and grounded.

**WARNING:** Improper use of the grounding plug can result in a risk of electric shock. Consult a qualified electrician or service person if the grounding instructions are not completely understood, or if doubt exists as to whether the appliance is properly grounded.

If it is necessary to use an extension cord, use only a three wire extension cord that has a three blade grounding plug, and a three slot receptacle that will accept the plug on the appliance. The marked rating of the extension cord should be equal to or greater than the electrical rating of the appliance.

## INSTALLATION

### 1. Steady, flat location:

If the freezer is not leveled during installation, the doors may not close or seal properly, causing cooling, frost, or moisture problems. It is very important for the freezer to be level in order to function properly. To level your freezer, you may either turn the level leg clockwise to raise that side to the freezer or turn counter-clockwise to lower that side. Having someone push against the top of the freezer will take some weight off the leveling leg. This makes it easier to adjust the leveling leg.

### 2. Ventilation: Do not block air vents.

### 3. Power supply:

- Check your local power source. This freezer requires a 110V-120V, 60Hz power supply.
- Use a receptacle that will accept the ground prong. The power cord of this appliance is equipped with a 3-prong (grounding) plug which mates with a standard 3-prong (grounding) wall outlet to minimize the possibility of electric shock hazard from this appliance.
  - (a) Longer cord sets or extension cords are available and may be used if care is exercised in their use.
  - (b) If a long cord or extension cord is used, (1) the marked electrical rating of the cord set or extension cord should be at least as great as the electrical rating of the appliance, (2) the extension cord must be a grounding-type 3-wire cord, and (3) the longer cord should be arranged so that it will not drape over the counter top or table top where it can be pulled on by children or tripped over unintentionally.

### NOTES:

The freezer should always be plugged into its own individual electrical outlet which has a voltage rating that matches the rating plate.

If you have only a standard 2-prong wall outlet, it is your personal responsibility and obligation to have it replaced with a properly grounded 3-prong wall outlet.

Never unplug your freezer by pulling on the power cord. Always grip plug firmly and pull straight out from the outlet.

### When using a 3-pronged plug

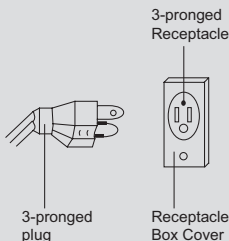

### When using a grounding adapter, make sure the receptacle box is fully grounded.

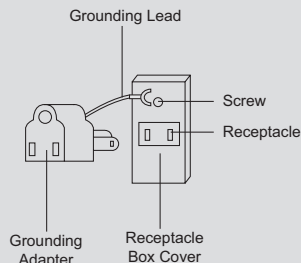

# LOCATION OF CONTROLS

## DOOR OPEN

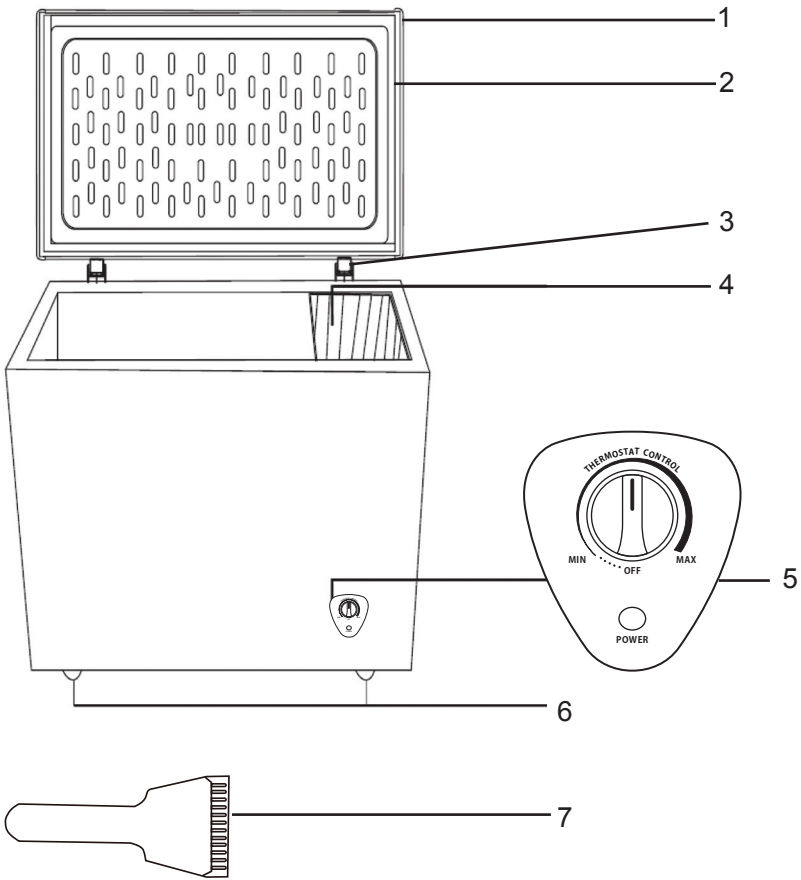

1. Door
2. Door Gasket
3. Hinges
4. Storage Basket
5. Thermostat Control
6. Leveling feet
7. Ice Scraper

## LOCATION OF CONTROLS (CONTINUED)

### Before Using Your Freezer

- Remove the exterior and interior packing
- Check to be sure you have all of the following parts:
  - 1 Storage Basket ①
  - 1 Ice Scraper ②
  - 1 Instruction Manual ③



①

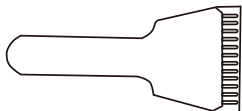

②

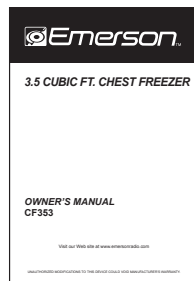

③

- Before connecting the freezer to the power source, let it stand upright for approximately 2 hours. This will reduce the possibility of a malfunction in the cooling system from handling during transportation.
- Clean the interior surface with lukewarm water using a soft cloth.

### Installing Your Freezer

- This appliance is designed to be free standing only, and should not be recessed or built-in.
- Place your freezer on a floor that is strong enough to support the freezer when it is fully loaded.
- Allow 15 cm of space between the back and sides of the freezer, which allows the proper air circulation.
- Locate the freezer away from direct sunlight and sources of heat (stove, heater, radiator, etc.). Direct sunlight may affect the acrylic coating and heat sources may increase electrical consumption. Extreme cold ambient temperatures may also cause the freezer not to perform properly.
- Avoid locating the freezer in moist areas.
- Plug the freezer into an exclusive, properly installed-grounded wall outlet. Do not under any circumstances cut or remove the third (ground) prong from the power cord. Any questions concerning power and/or grounding should be directed toward a certified electrician or an authorized service center.
- After plugging the appliance into a wall outlet, allow the unit to cool down for 2~3 hours before placing food in the freezer compartment.

## OPERATION

### USING THE THERMOSTAT

#### Thermostat control dial

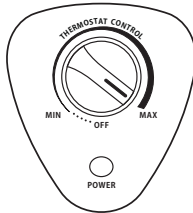

Your freezer has one control for regulating the thermostat. The temperature control is located on the lower right hand corner.

When first time plug in power, set the thermostat control at "MAX" position and run for at least 2 hours before putting frozen foods inside. This will ensure the cabinet is thoroughly chilled before food is put in.

The range of the Thermostat control is from position "MIN" the warmest to "MAX" the coldest. Adjust the Thermostat control to the setting that best suits your needs. The setting of 3/4 Thermostat control should be appropriate for home or office freezer use.

To turn the freezer off, turn the Thermostat control to "OFF".

#### **NOTE:**

Turning the temperature control knob to "OFF" position stops the cooling cycle but does not shut off the power to the freezer. The power indicator will stay "on".

If the unit is unplugged, lost power, or turned off; you must wait 3 to 5 minutes before restarting the unit. If you attempt to restart before the time delay, the freezer will not start.

Large amounts of food will lower the cooling efficiency of the appliance.

## OPERATION (CONTINUED)

### DEFROSTING

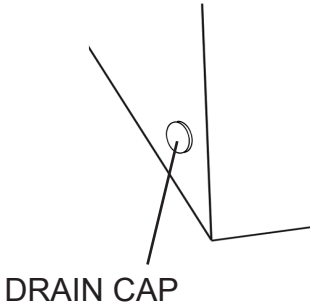

**WHEN?** For the most efficient operation and minimum energy consumption, defrost the freezer when the frost on the freezer walls is excessive or 5 to 10mm thick.

Choose a time when the stock of frozen food is low.

**CAUTION:**

**Do not use boiling water because it may damage the plastic parts. In addition, never use a sharp or metallic instrument to remove frost as it may damage the cooling coils and will void the warranty.**

**We recommend using the plastic ice scraper provided with your unit.**

**Do not use ice scraper for any purpose other than scraping ice from the freezer walls.**

- Remove the frozen food from the freezer and place it in a cooler to protect the food.
- Turn the thermostat knob to "OFF".
- Unplug the freezer. The Power Supply light should be off (green light out).
- During defrosting, the ice melts into the cabinet.
- Remove the drain water cap on the inside floor of the freezer by pulling straight out.
- Place a shallow pan outside drain outlet. The defrost water will drain out.
- Check the pan occasionally so the water does not overflow.
- Clean the interior of the freezer.
- Replace the drain water cap on the inside floor.
- Reset the thermostat to desired setting.
- Allow the cabinet to cool for one hour.
- Return food to the freezer.

**HELPFUL HINT:**

Defrosting usually takes a few hours. Leaving the door open will help speed the process. Also, pouring warm water (not boiling) on the ice/frost will help speed melting. If you must use a scraper, please use caution - it is very easy to damage the freezer compartment and void your warranty.

## OPERATION (CONTINUED)

### The Freezer Compartment

- This compartment is designed for the long-term storage of frozen food. Storage time is up to three months.
- The storage life of frozen foods varies and the recommended storage time should not be exceeded.
- The instructions regarding the care of frozen foods should be followed when defrosting the freezer.
- Pre-packed commercially frozen food should be stored in accordance with the frozen foods manufacturer's instructions for a three star frozen food storage compartment or home freezer.
- Place frozen food into the freezer as quickly as possible after purchase. If there are instructions on the packet, carefully follow these instructions regarding storage times.
- The freezer door is susceptible to breaking due to excessive ice build up. Be sure to defrost when the ice reaches 5 to 10 mm thick.
- A storage basket is provided for the organization of odd-shaped items. To reach other packages in the freezer, just slide the basket to one side, or lift it out.

## CARE AND MAINTENANCE

### Cleaning Your Freezer

- Upon installation of your new appliance, it is recommended that it be cleaned thoroughly.
- Turn the thermostat control to "OFF", unplug the freezer, remove the food and storage basket.
- Wash the inside with a damp warm cloth containing a water and baking soda solution. The solution should be about 2 tablespoons of baking soda to a quart of water.
- Wash the storage basket with a mild detergent solution.
- Be sure to keep the door gasket (seal) clean to keep the unit running efficiently.
- The outside of the freezer should be cleaned with mild detergent and warm water.
- Dry the interior and exterior with a soft cloth.
- It is recommended that the unit be cleaned each time it is defrosted to help keep the unit odor free and running efficiently.

### Vacation Time

- Remove all the food.
- Unplug the freezer.
- Clean the freezer.
- Leave the door open slightly to avoid possible formation of condensation, mold, or odors.
- Use extreme caution in the case of children. The unit should not be accessible to child's play.
- **Short vacations:** Leave the freezer operating during vacations of less than three weeks.
- **Long vacations:** If the appliance will not be used for several months, remove all food and unplug the power cord. Clean and dry the interior thoroughly. To prevent odor and mold growth, leave the door open slightly; blocking it open if necessary or have the door removed.

### Moving Your Freezer

- Remove all the food.
- Securely tape down all loose items inside your freezer.
- Tape the doors shut.
- Be sure the freezer stays in the upright position during transportation.



## OPERATION (CONTINUED)

### Energy Saving Tips

- The freezer should be located in the coolest area of the room, away from heat producing appliances or heating ducts, and out of the direct sunlight.
- Let hot foods cool to room temperature before placing in the freezer. Overloading the freezer forces the compressor to run longer. Foods that freeze too slowly may lose quality, or spoil.
- Be sure to wrap foods properly, and wipe containers dry before placing them in the freezer. This cuts down on frost build-up inside the freezer.
- Freezer storage bin should not be lined with aluminum foil, wax paper, or paper toweling. Liners interfere with cold air circulation, making the freezer less efficient.
- Organize and label food to reduce door openings and extended searches. Remove as many items as needed at one time, and close the door as soon as possible.

### PROBLEMS WITH YOUR FREEZER

You can solve many common freezer problems easily, Try the suggestions below to see if you can solve the problem before calling the servicer.

## TROUBLE SHOOTING GUIDE

PROBLEM	POSSIBLE CAUSE	SOLUTION
Freezer does not operate.	<ul style="list-style-type: none"> <li>• Not plugged in.</li> <li>• The circuit breaker tripped or a blown fuse.</li> <li>• The freezer thermostat control is set at "OFF".</li> </ul>	<ul style="list-style-type: none"> <li>• Check whether the plug properly inserted.</li> <li>• Replacement of the circuit breaker and fuse.</li> <li>• The thermostat control should be set at middle position.</li> </ul>
Compressor turns on and off frequently.	<ul style="list-style-type: none"> <li>• The room temperature is hotter than normal.</li> <li>• A large amount of food has been added to the freezer.</li> <li>• The door is open too often.</li> <li>• The door is not closed completely.</li> <li>• The thermostat control is not set correctly.</li> <li>• The freezer does not have the correct clearances.</li> <li>• The freezer has recently been disconnected for a period of time.</li> </ul>	<ul style="list-style-type: none"> <li>• Indoor air circulation.</li> <li>• Reduce the amount of food storage.</li> <li>• Keep door always close check whether the door was closed properly.</li> <li>• Check the thermostat if control set it at middle position.</li> <li>• Clean freezer according to the manual.</li> <li>• Four hours are required for the freezer to cool down completely.</li> </ul>
Temperature inside the freezer compartment is too high	<ul style="list-style-type: none"> <li>• Thermostat control is set too warm.</li> <li>• Door is kept open too long or is opened too frequently.</li> <li>• The door is not closed completely.</li> <li>• A large amount of warm or hot food might have been stored recently.</li> <li>• The freezer has recently been disconnected for a period of time</li> </ul>	<ul style="list-style-type: none"> <li>• Turn the control to a cooler setting and allow several hours for the temperature to stabilize.</li> <li>• Keep the door closed properly.</li> <li>• Check the door gasket.</li> <li>• Reduce the amount of hot food until temperature drop down.</li> <li>• It is normal wait until the freezer has had a chance to reach its selected temperature.</li> <li>• Four hours are required for the freezer to cool down completely.</li> </ul>

## TROUBLE SHOOTING GUIDE (CONTINUED)

PROBLEM	POSSIBLE CAUSE	SOLUTION
Temperature inside the freezer compartment is too cold.	<ul style="list-style-type: none"> <li>Temperature control is set too cold.</li> <li>The temperature control is set at "MAX" setting. This causes continuous running of the compressor and bypasses the temperature control.</li> </ul>	<ul style="list-style-type: none"> <li>Adjust the temperature control position at middle</li> <li>Turn the control to a warmer setting and allow several hours for the temperature to stabilize.</li> </ul>
Sometimes popping or cracking sound when compressor activated.	<ul style="list-style-type: none"> <li>Metal parts like the copper pipes undergo expansion and contraction, as in hot water pipes.</li> </ul>	<ul style="list-style-type: none"> <li>This is normal. Sound will disappear as freezer continues to run.</li> </ul>
Bubbling or gurgling sound, like water boiling.	<ul style="list-style-type: none"> <li>Refrigerant gas (used to cool freezer) is circulating throughout the system</li> </ul>	<ul style="list-style-type: none"> <li>This is normal.</li> </ul>
Vibrations.	<ul style="list-style-type: none"> <li>Check to assure that the freezer is level.</li> <li>The floor is uneven. Freezer rocks on the floor when it is moved slightly.</li> <li>The freezer is touching the wall.</li> </ul>	<ul style="list-style-type: none"> <li>Ensure freezer placed level</li> <li>Level the freezer by putting wood or metal shims under part of the freezer.</li> <li>Leave spacing between the freezer and the wall.</li> <li>See "Installation Instructions"</li> </ul>
Moisture forms on inside freezer walls.	<ul style="list-style-type: none"> <li>Weather is hot and humid, which increases internal frost build-up.</li> <li>Door is slightly open.</li> <li>Door is kept open too long, or is opened too frequently.</li> <li>The door is not sealed properly.</li> </ul>	<ul style="list-style-type: none"> <li>This is normal.</li> <li>Keep the door close</li> <li>Check the door gasket</li> <li>And close door properly</li> </ul>
Moisture forms on outside of freezer.	<ul style="list-style-type: none"> <li>Door is slightly open, the cold air from inside the freezer leaking to outside.</li> </ul>	<ul style="list-style-type: none"> <li>It is normal close the door firmly.</li> </ul>
The door cannot close properly.	<ul style="list-style-type: none"> <li>The door gasket is dirty.</li> <li>The storage basket is out of position, or not install properly.</li> </ul>	<ul style="list-style-type: none"> <li>Clean the door gasket.</li> <li>Adjust position of storage basket again</li> </ul>

## TECHNICAL SPECIFICATION

Unit Dimension (WxDxH) (inches)	22.3 x 20.7 x 33.1
Power Supply	AC115V~60Hz 125W
Current	0.9A
Power consumption per year	214 kwh

## LIMITED WARRANTY

Emerson Radio Corp. warrants manufacturing defects in original material, including original parts and workmanship, under normal use and conditions, for a period of one year from the date of original purchase in the U.S. With your dated proof of purchase, we will provide repair service at no charge for labor and parts at an authorized Depot Repair Facility, or replace the product in our discretion. For repair or replacement, pack your unit in a padded box, enclose your check or money order payable to Emerson Radio Corp. in the amount of \$10.00 (not required by California residents) to cover shipping and handling costs, and enclose a copy of your proof of purchase. Send your unit to:

Emerson Returns Warehouse,  
11500 Philadelphia Street,  
Mira Loma Ca. 91752

**AU898N**

This warranty does not cover damage from negligence, misuse, abuse, accident, failure to follow operating instructions, commercial use, rental, repairs by an unauthorized facility, or products purchased, used, serviced or damaged outside of the United States.

THIS WARRANTY GIVES YOU SPECIFIC LEGAL RIGHTS AND YOU MAY ALSO HAVE OTHER RIGHTS WHICH VARY FROM STATE TO STATE.

The serial number can be found on the rear of the unit. We suggest that you record the serial number of your unit in the space below for future reference.

**Model Number: CF353**

**Serial Number:** \_\_\_\_\_



◆◆◆◆◆ SERVICE ◆◆◆◆◆

FOR ADDITIONAL SET-UP OR OPERATING ASSISTANCE  
PLEASE CALL:  
1-800-898-9020 OR 1-800-695-0098

---

FOR CUSTOMER SERVICE, PLEASE E-MAIL TO:  
[internet@emersonradio.com](mailto:internet@emersonradio.com)

OR WRITE TO:  
Emerson Radio Corp.  
Consumer Affairs Dept.  
3 University Plaza  
Suite 405  
Hackensack, NJ 07601



## Free Manuals Download Website

<http://myh66.com>

<http://usermanuals.us>

<http://www.somanuals.com>

<http://www.4manuals.cc>

<http://www.manual-lib.com>

<http://www.404manual.com>

<http://www.luxmanual.com>

<http://aubethermostatmanual.com>

Golf course search by state

<http://golfingnear.com>

Email search by domain

<http://emailbydomain.com>

Auto manuals search

<http://auto.somanuals.com>

TV manuals search

<http://tv.somanuals.com>