

RELEASED: 1-24-56
 REVISED: 2-7-08
 (REV. D)

636077 "Z" Swivel 1/8 - 27 N.P.T.F.

DO NOT EXCEED MAXIMUM WORKING PRESSURE OF 10,000 P.S.I. (689.7 BAR).

636077 PARTS LIST

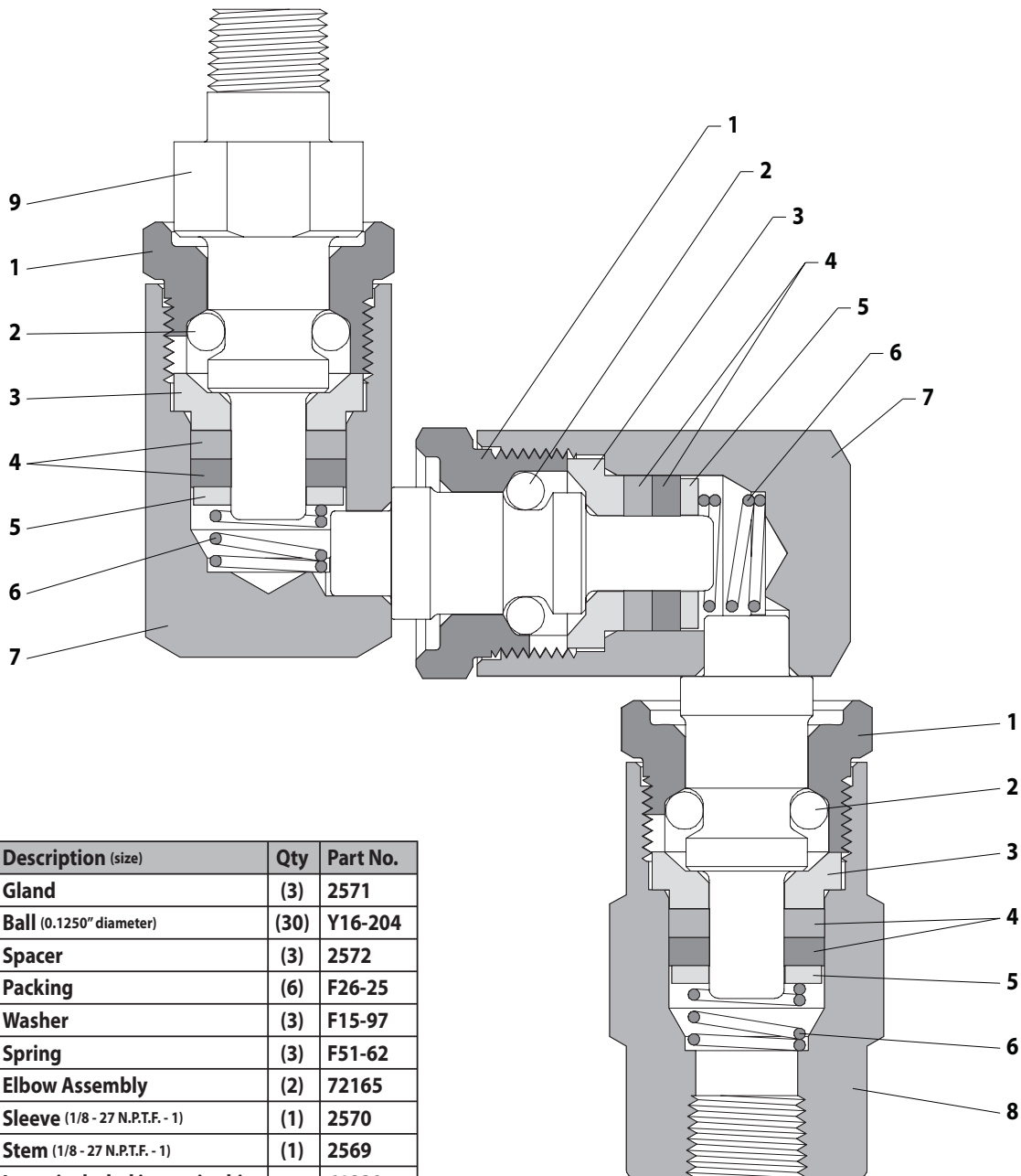

Item	Description (size)	Qty	Part No.
1	Gland	(3)	2571
① 2	Ball (0.1250" diameter)	(30)	Y16-204
3	Spacer	(3)	2572
① 4	Packing	(6)	F26-25
5	Washer	(3)	F15-97
6	Spring	(3)	F51-62
7	Elbow Assembly	(2)	72165
8	Sleeve (1/8 - 27 N.P.T.F. - 1)	(1)	2570
9	Stem (1/8 - 27 N.P.T.F. - 1)	(1)	2569
①	Items included in service kit		61239

PN 97999-42

INGERSOLL RAND COMPANY LTD
 P.O. BOX 151 • ONE ARO CENTER • BRYAN, OHIO 43506-0151
 ① (800) 276-4658 • FAX (800) 266-7016 © 2008 CCN 99608317

ARO

IR Ingersoll Rand
 Industrial Technologies

Free Manuals Download Website

<http://myh66.com>

<http://usermanuals.us>

<http://www.somanuals.com>

<http://www.4manuals.cc>

<http://www.manual-lib.com>

<http://www.404manual.com>

<http://www.luxmanual.com>

<http://aubethermostatmanual.com>

Golf course search by state

<http://golfingnear.com>

Email search by domain

<http://emailbydomain.com>

Auto manuals search

<http://auto.somanuals.com>

TV manuals search

<http://tv.somanuals.com>