

HANDLE LOCK ASSEMBLY REPLACEMENT KIT KIT NO. 1090768



Assembly, Installation and Operating Instructions

SAVE THESE INSTRUCTIONS

NOTE: Check all parts for shipping damage before using. In case of damage, DO NOT use. Contact the Dealer/Carrier for further instructions.

SAFETY SUMMARY

The following recommendations are made for the safe installation of the Lock Handle Assembly Kit (Kit No. 1090768). This kit is used where Roll Pin (Part No. 1079151) is used with Right Hand Lock Handle (Part No. 1068937) and Left Hand Lock Handle (Part No. 1068938).

GENERAL WARNING

DO NOT assemble or use this kit without first reading and understanding this instruction sheet. If you are unable to understand the Warnings, Cautions or Instructions in this Instruction Sheet contact a healthcare professional, dealer or technical personnel before attempting to install this kit, otherwise, injury or damage may occur.

INSTALLATION WARNINGS

After ANY adjustments, repair or service and BEFORE use, make sure all attaching hardware is tightened securely - otherwise injury or damage may occur.

This kit contains the following:

DESCRIPTION	*QTY
Handle Lock (Right Hand)	1
Handle Lock (Left Hand)	1
Tubular Rivet	2

**NOTE: These quantities are per kit.*

*NOTE: Refer to the **GENERAL WARNINGS** in the **SAFETY SUMMARY** of this Instruction Sheet.*

Installing Handle Lock Assembly (Figure 1)

1. Locate bushing arm lock and determine if EXISTING handle lock and/or the EXISTING roll pin are present.
2. If EXISTING handle lock and/or EXISTING roll pin is present, remove by tapping out the roll pin using a center punch - otherwise proceed to **STEP 3**.
3. Slide EXISTING spring on to the narrow end of the EXISTING coil pin (if necessary).
4. Insert the EXISTING coil pin and spring into the bushing arm lock as shown in **FIGURE 1**.
5. The NEW handle lock is placed on to the EXISTING coil pin and bushing arm lock.
6. Ensure hole in the EXISTING coil pin is aligned with holes in the NEW handle lock, insert tubular rivet through NEW handle lock and EXISTING coil pin as in **FIGURE 1 DETAIL "A"**.
7. Head end of tubular rivet is butted against a hard flat surface and lightly tap the end of the center punch into the hollowed end of the tubular rivet causing it to "spread" (**DETAIL "B"**).
8. Repeat steps 1-7 on remaining bushing handle lock.

NOTE: If unable to insert tubular rivet due to frame interference or otherwise, push the existing coil pin so that the narrow end of the existing coil pin is visible at the other end of the bushing arm lock and can be rotated to allow the tubular rivet to be inserted through both the new handle lock and the existing coil pin. (constant pressure will be needed on the coil pin to insert in this manner).

WARNING

When installing the tubular rivet ensure the hollow end is evenly "spread" and secures the handle lock. DO NOT use excessive force when installing the tubular rivet - otherwise the handle lock may not function properly.

*NOTE: it is recommended that **STEP 7** be performed on a work bench or similar structure. If the head end of the tubular rivet can not be butted against a hard flat surface due to frame interference or otherwise, use a solid object (piece of metal, tool handle, ect...) that fits the space between the head end of tubular rivet and the frame interference or otherwise to hold rivet in place.*

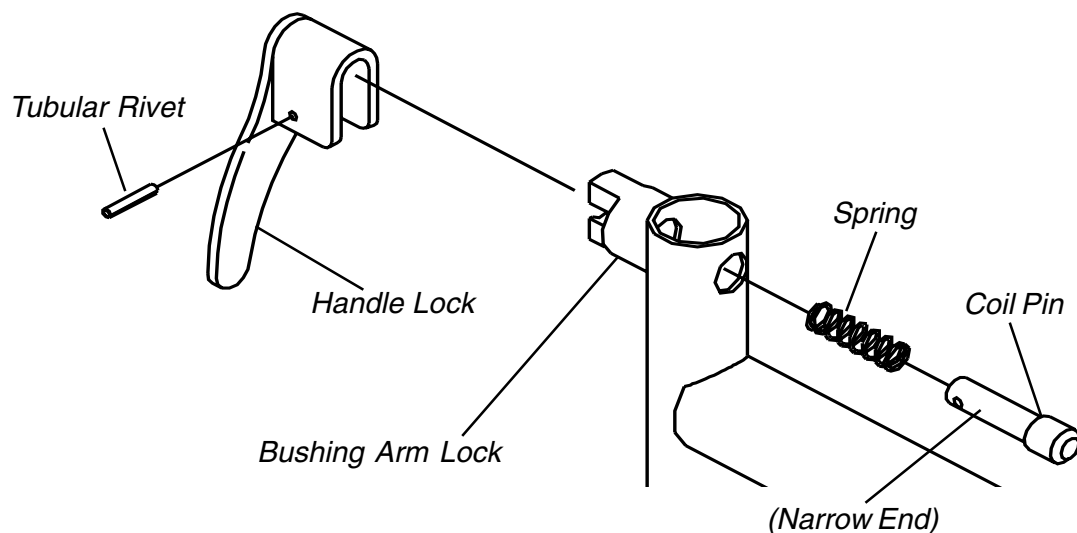

DETAIL "A"

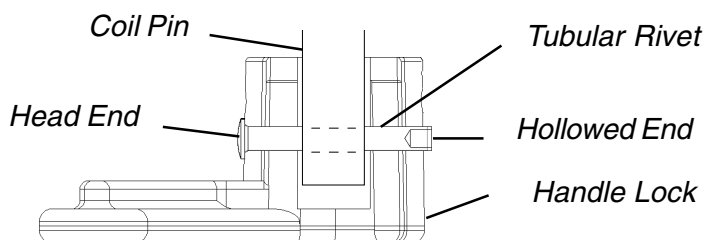

DETAIL "B"

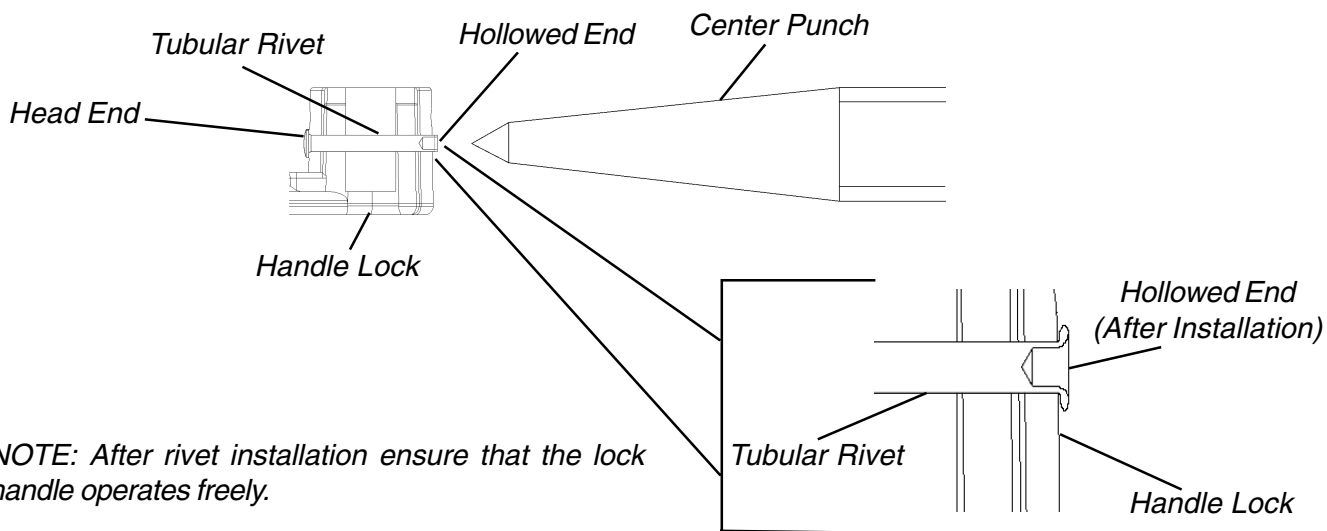

NOTE: After rivet installation ensure that the lock handle operates freely.

FIGURE 1 - INSTALLING THE HANDLE LOCK



INVACARE CORPORATION ● ONE INVACARE WAY ● ELYRIA, OH 44035
 Customer Service (800) 333-6900 ● Technical Support (800) 832-4707

Free Manuals Download Website

<http://myh66.com>

<http://usermanuals.us>

<http://www.somanuals.com>

<http://www.4manuals.cc>

<http://www.manual-lib.com>

<http://www.404manual.com>

<http://www.luxmanual.com>

<http://aubethermostatmanual.com>

Golf course search by state

<http://golfingnear.com>

Email search by domain

<http://emailbydomain.com>

Auto manuals search

<http://auto.somanuals.com>

TV manuals search

<http://tv.somanuals.com>