

Tray Mounting Hardware



Assembly, Installation and Operating Instructions

Right Side Hardware
Part Nos. TR40R

Left Side Hardware
Part No. TR40L

SAVE THESE INSTRUCTIONS

NOTE: Check all parts for shipping damage before using. In case of damage, do not use. Contact the dealer for further instructions.

SAFETY SUMMARY

The following recommendations are made for safe installation and use of the Tray Mounting Hardware:

GENERAL WARNINGS

DO NOT install this equipment without first reading and understanding this instruction sheet. If you are unable to understand these Warnings, Cautions and Instructions, contact a healthcare professional, dealer or technical personnel if applicable before attempting to install this equipment - otherwise, injury or damage may occur.

Consult a physician or therapist for appropriate positioning of the tray relative to the user.

Your therapist and physician should be consulted if you have any questions regarding individual limitations and needs.

The tray mounting hardware is available in two versions
TR40R: Right side hardware (shown)
TR40L: Left side hardware

Tools Required:

1/4-inch drillbit, a 82-degree counter sink drill, a hand drill, a phillips screwdriver and a 1/2-inch open end wrench.

INSTALLATION (FIGURE 1)

1. Remove the armrest from the wheelchair. Refer to the wheelchair owner's manual.
2. Using a Phillips screwdriver remove the armrest pad from the armrest and set the screws aside.
3. Adjust the clamp brackets on the tray receptacle so that one (1) of the four (4) holes on each clamp bracket line up with one (1) armrest hole.
4. Secure the armrest pad and tray receptacle assembly to the armrest with the previously removed screws as shown in FIGURE 1.
5. Put both armrests on the wheelchair.

6. Insert the support arm fully into the tray receptacle until it **cannot move further back**.
7. Have the user sit in the wheelchair and position the tray on the armrests, evenly spaced on both sides.
8. With a pen locate and mark the four (4) drill points on the tray by using the support arm bracket as a template.
9. Using a 1/4" drillbit, drill four (4) holes corresponding to the marks made with the pen.

NOTE: This product is designed to work with Invacare trays LTACL, LTCCL, LTACCL and LTCCCL. The Invacare tray mounting hardware can also be installed on other manufacturers' trays if the tray rim does not interfere with the operation of the tray support arm.

CAUTION

DO NOT drill too deep as this will render the tray useless.

10. Counter-sink the holes to accommodate the flat screws included in the kit.
11. Mount the tray using the flat screws, washers, and acorn nuts with the hex key wrench provided. **DO NOT** over-tighten screws.
12. With the user sitting in the wheelchair, adjust the tray to the desired position and tighten knob on receptacle.

NOTE: The strap on the tray may be removed or wrapped around armrest for additional support.

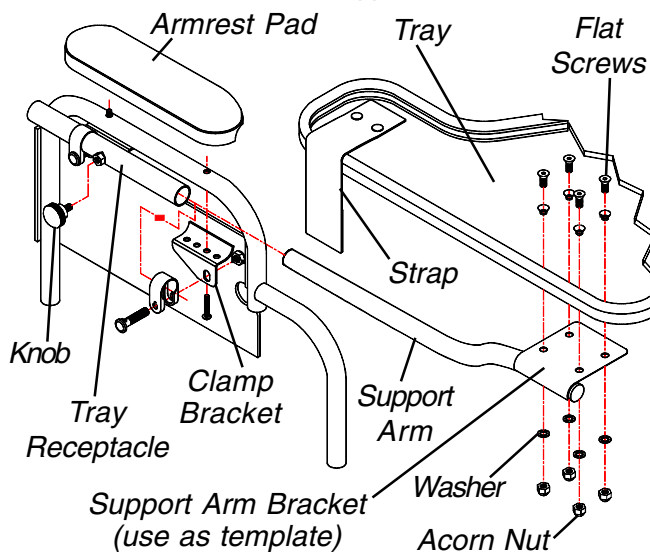

FIGURE 1 - INSTALLATION

Invacare Corporation www.invacare.com



USA
One Invacare Way
Elyria, Ohio USA
44036-2125
800-333-6900

Canada
5970 Chedworth Way
Mississauga, Ontario
L5R 3T9, Canada
800-668-5324

Invacare is a registered trademark of Invacare Corporation.
© 1999 Invacare Corporation

Form No. 99-120 Part No. 0900121 Rev C (2) 12/99

Free Manuals Download Website

<http://myh66.com>

<http://usermanuals.us>

<http://www.somanuals.com>

<http://www.4manuals.cc>

<http://www.manual-lib.com>

<http://www.404manual.com>

<http://www.luxmanual.com>

<http://aubethermostatmanual.com>

Golf course search by state

<http://golfingnear.com>

Email search by domain

<http://emailbydomain.com>

Auto manuals search

<http://auto.somanuals.com>

TV manuals search

<http://tv.somanuals.com>