

CS SERIES

CS2165C

component system
owner's manual

THANK YOU

for purchasing a JBL® CS Series automotive loudspeaker component system. We've organized this manual to make your installation as simple and trouble-free as possible. Please read it thoroughly before proceeding. Remember to keep your sales receipt and this manual in a safe place so both are available for future reference.



JBL

THE OFFICIAL BRAND
OF LIVE MUSIC.

INSTALLATION WARNINGS AND TIPS

ABOUT THESE INSTRUCTIONS

Installation of automotive stereo components can require extensive experience with a variety of mechanical and electrical procedures. Although these instructions explain how to install a CS Series component system in a general sense, they do not show the exact installation methods for your particular vehicle. If you do not feel you have the experience, do not attempt the installation yourself – instead, ask your authorized JBL car audio dealer about professional installation options.

LOUD MUSIC AND HEARING

Playing loud music in an automobile can hinder your ability to hear traffic, as well as permanently damage your hearing. The maximum volume levels achievable with JBL speakers, combined with high power amplification, may exceed safe levels for extended listening. We recommend using low volume levels when driving. JBL accepts no liability for hearing loss, bodily injury or property damage as a result of use or misuse of this product.

REAR DECK PRECAUTION

In some cars, fuel tanks may be located directly beneath the rear deck. Before installation, make sure there is adequate speaker basket clearance before considering this location.

ABOUT THE CONTENTS

The CS Series component system includes:

- Woofers
- Grilles
- Tweeters with surface/flush I-Mount™ (patent no. 5,859,917) kits

INSTALLATION TIPS

- Always wear protective eyewear when using any tools.
 - Turn off all audio components and other electrical devices before you start. Disconnect the (–) negative lead from your vehicle's battery.
 - Keep speakers in their package until final installation. When moving a speaker, always rest it with the cone or dome facing up. Never use force to install any speaker.
 - Check clearances on both sides of a planned mounting surface before drilling any holes or installing any screws. Remember that the screws can extend behind the surface.
 - At the installation sites, locate and make a note of all fuel lines, hydraulic brake lines, vacuum lines and electrical wiring. Use extreme caution when cutting or drilling in and around these areas.
- Before drilling or cutting holes, use a utility knife to remove unwanted fabric or vinyl to keep material from snagging in a drill bit or saw.
 - For door installations, check the clearance with the windows throughout the range of the window's travel, and verify that a mounted speaker will not interfere with the window crank or power window mechanism.
 - If mounting speakers elsewhere, check for clearance around rear-deck torsion bars, glove box or other structural elements.
 - Do not mount speakers where they will get wet.
 - If possible, select a mounting site for the crossover network that is near the speakers and provides easy access for connections.



INSTALLATION

Figure 1. Mounting the woofer in a factory location without the grille.

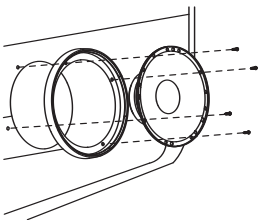
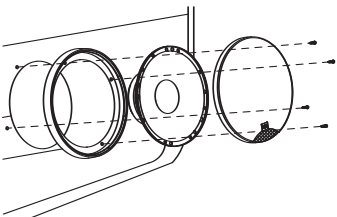
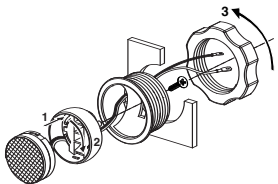

Figure 2. Mounting the woofer with the grille.



I-MOUNT™ FLUSH-MOUNT

Figure 3A. Mounting the tweeter using the I-Mount flush-mounting kit.



I-MOUNT SURFACE-MOUNT

Figure 3B. Mounting the tweeter using the I-Mount surface-mounting cup.

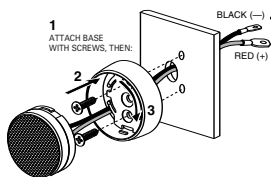

TWEETER ANGLE

Figure 4. Aim the tweeter at the listening position by sliding the screw in the groove on the back of the tweeter cup and lock the tweeter in place using the small retaining screw. Rotate the entire assembly in the mounting surface and tighten the large hand nut.

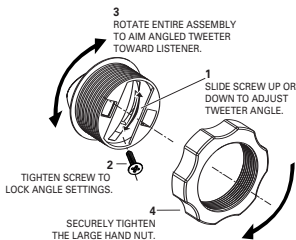

Note: Check screw clearance before installing. Use glue if clearance is an issue.

Note: Not all possible mounting configurations are shown.

CONNECTIONS

Connect the tweeter using the supplied wire with inline crossover to the terminals on the woofer. Note that there are two positive and two negative terminals on the woofer. Connect the unused positive and negative terminals to your amplifier's output leads, observing proper polarity. You must use the supplied inline crossover. Failure to do so may damage the tweeter.

Figure 5. Wiring connections

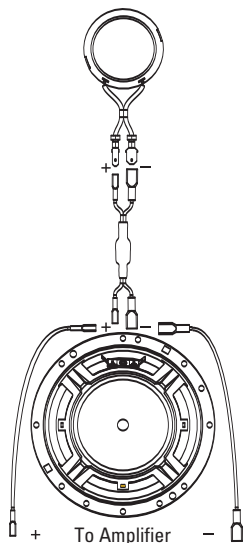

JBL, Incorporated
250 Crossways Park Drive, Woodbury, NY 11797 USA
516.255.4JBL (4525) (USA only) www.jbl.com

© 2006 Harman International Industries, Incorporated. All rights reserved.

JBL and Harman International are trademarks of Harman International Industries, Incorporated, registered in the United States and/or other countries. I-Mount and Starfish are trademarks of Harman International Industries, Incorporated.

Part No. CS2165COM6/06

H A Harman International® Company

SPECIFICATIONS

	CS2165C
Type	165mm Two-way component system
Power Handling	45W RMS, 135W Peak
Sensitivity (2.83V/1m)	91dB
Frequency Response	55Hz – 20kHz
Impedance	4 Ohms
Mounting Depth	2-3/8" (61mm)
Cutout Diameter	5-11/16" (145mm)
Overall Diameter	6-9/16" (167mm)

GENERAL CARE

The loudspeaker grilles may be cleaned with a damp cloth. Do not use any cleaners or solvents on the grilles or the speaker cones.

This product is designed for mobile applications and is not intended for connection to the mains.

A valid serial number is required for warranty coverage.

Features, specifications and appearance are subject to change without notice.

Not all models are available in all markets.

Declaration of Conformity



We, Harman Consumer Group International
2, route de Tours
72500 Château du Loir
France

declare in own responsibility that the product described in this owner's manual is in compliance with technical standards:

EN 61000-6-3:2001
EN 61000-6-1:2001

Klaus Leberherz
Harman Consumer Group International
Château du Loir, France 6/06



www.jbl.com

Free Manuals Download Website

<http://myh66.com>

<http://usermanuals.us>

<http://www.somanuals.com>

<http://www.4manuals.cc>

<http://www.manual-lib.com>

<http://www.404manual.com>

<http://www.luxmanual.com>

<http://aubethermostatmanual.com>

Golf course search by state

<http://golfingnear.com>

Email search by domain

<http://emailbydomain.com>

Auto manuals search

<http://auto.somanuals.com>

TV manuals search

<http://tv.somanuals.com>