

## **GRAND TOURING® SERIES**

**GT0507C  
GT0607C  
GT06507C  
GT08607C  
GT06507SC**

**component  
systems  
owner's  
manual**

### **THANK YOU**

for purchasing a JBL® Grand Touring® Series automotive loudspeaker component system. We've organized this manual to make your installation as simple and trouble-free as possible. Please read it thoroughly before proceeding. Remember to keep your sales receipt and this manual in a safe place so both are available for future reference.



# **JBL**

**THE OFFICIAL BRAND  
OF LIVE MUSIC.**

## INSTALLATION WARNINGS AND TIPS

### ABOUT THESE INSTRUCTIONS

Installation of automotive stereo components can require extensive experience with a variety of mechanical and electrical procedures. Although these instructions explain how to install Grand Touring Series component systems in a general sense, they do not show the exact installation methods for your particular vehicle. If you do not feel you have the experience, do not attempt the installation yourself – instead, ask your authorized JBL car audio dealer about professional installation options.

### LOUD MUSIC AND HEARING

Playing loud music in an automobile can hinder your ability to hear traffic, as well as permanently damage your hearing. The maximum volume levels achievable with JBL speakers, combined with high power amplification, may exceed safe levels for extended listening. We recommend using low volume levels when driving. JBL accepts no liability for hearing loss, bodily injury or property damage as a result of use or misuse of this product.

### REAR DECK PRECAUTION

In some cars, fuel tanks may be located directly beneath the rear deck. Before installation, make sure there is adequate speaker basket clearance before considering this location.

### ABOUT THE CONTENTS

The Grand Touring Series component system includes:

- Woofers
- Grilles and mounting adapter(s) (no grille with the GT08607C)
- Tweeters with surface/flush I-Mount™ (patent no. 5,859,917) kits
- Crossover networks with mounting screws

**NOTE:** The supplied crossover networks are designed to work with the above-listed transducers. Do not substitute another crossover network or use other speakers when connecting the system (see Figures 8A and 8B).

### INSTALLATION TIPS

- Always wear protective eyewear when using any tools.
- Turn off all audio components and other electrical devices before you start. Disconnect the (–) negative lead from your vehicle's battery.
- Keep speakers in their package until final installation. When moving a speaker, always rest it with the cone or dome facing up. Never use force to install any speaker.

## INSTALLATION

**Figure 1.** Mounting the woofer in a factory location without the grille (except GT0607C).

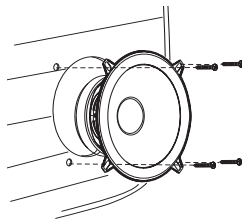

**Figure 2.** Mounting the woofer with the grille. (No grille is supplied with the GT08607C. It is designed to be installed under the factory grille.)

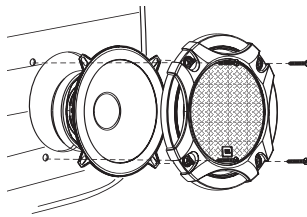

- Check clearances on both sides of a planned mounting surface before drilling any holes or installing any screws. Remember that the screws can extend behind the surface.
- At the installation sites, locate and make a note of all fuel lines, hydraulic brake lines, vacuum lines and electrical wiring. Use extreme caution when cutting or drilling in and around these areas.
- Before drilling or cutting holes, use a utility knife to remove unwanted fabric or vinyl to keep material from snagging in a drill bit or saw.
- For door installations, check the clearance with the windows throughout the range of the window's travel, and verify that a mounted speaker will not interfere with the window crank or power window mechanism.
- If mounting speakers elsewhere, check for clearance around rear-deck torsion bars, glove box or other structural elements.
- Do not mount speakers where they will get wet.
- If possible, select a mounting site for the crossover network that is near the speakers and provides easy access for connections.

## INSTALLATION

### INTERMOUNT III\* MOUNTING RINGS

The GTO607C is packaged with two different speaker adapters. The adapters will allow the speakers to be installed into various factory 6", 6-1/2" and 6-3/4" openings. The metal adapter can be mounted in many European vehicles, Japanese vehicles or vehicles with 6" speaker locations. The plastic adapter can be mounted in many vehicles using 6-3/4" speaker locations or three-point mounting frames.

**Figure 3.** Mounting the GTO607C using the supplied metal adapter. Mounting with the plastic adapter is similar.

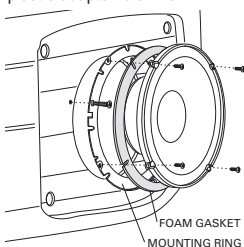

**Figure 4.** Mounting the GTO607C woofer without the metal adapter.

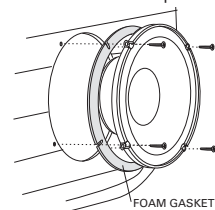

\* patent no. 6,505,705

### FLUSH-MOUNT

**Figure 5A.** Mounting the tweeter using the I-Mount flush-mounting kit.

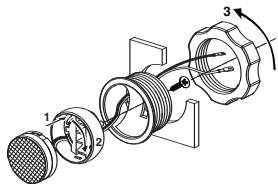

### SURFACE-MOUNT

**Figure 5B.** Mounting the tweeter using the I-Mount surface-mounting cup.

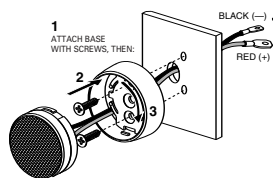

### TWEETER ANGLE

**Figure 6.** Aim the tweeter at the listening position by sliding the screw in the groove on the back of the tweeter cup and lock the tweeter in place using the small retaining screw. Rotate the entire assembly in the mounting surface and tighten the large hand nut.

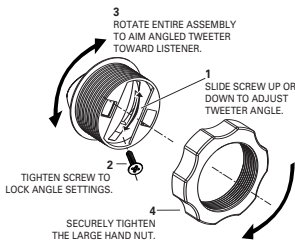

**Figures 7A through 7D.** The Starfish™ tweeter mount is intended to be used when the tweeter will be installed behind a factory grille (e.g., replacing the factory tweeter behind a door panel). The Starfish will allow you to mount the component tweeter directly to the panel itself or to the area behind the panel. The six mounting tabs can be removed easily to create a number of custom configurations.

**Note:** Check screw clearance before installing. Use glue if clearance is an issue.

**Note:** Not all possible mounting configurations are shown.

**Figure 7A.** Surface-mounted behind grille panel.

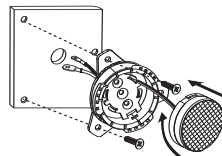

**Figure 7B.** Flush-mounted to surface behind grille panel.

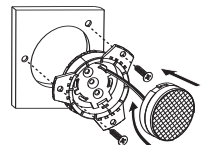

**Figure 7C.** Mounted to grille panel.

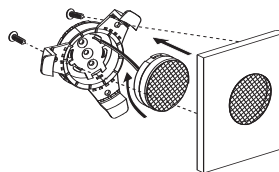

**Figure 7D.** In-dash location (may require gluing).

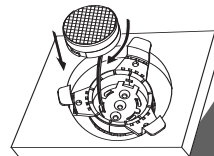

**JBL**

## CONNECTIONS

Open the crossover housing by firmly squeezing the sides of the top half and lifting it away from the bottom. Using screws or a wire tie, mount the crossover using the holes provided. Observing proper polarity, connect the speakers and amplifier as shown in Figures 8A–8C. Replace the cover when you are finished making the connections and adjustments (see following section).

**Figure 8A.** Wiring connections on the crossover network (shown with cover on).

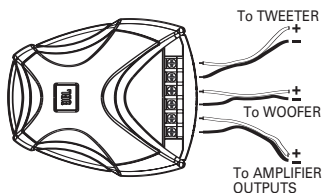

JBL, Incorporated  
250 Crossways Park Drive, Woodbury, NY 11797 USA  
516.255.4JBL (4525) (USA only) [www.jbl.com](http://www.jbl.com)

© 2006 Harman International Industries, Incorporated. All rights reserved.

JBL, Harman International and Grand Touring Series are trademarks of Harman International Industries, Incorporated, registered in the United States and/or other countries. I-Mount and Starfish are trademarks of Harman International Industries, Incorporated.

Part No. GTCOMPONENTSOM4/06

**H** A Harman International® Company

**Figure 8B.** The 0dB setting is the reference setting. Move the jumper to the +3dB setting if more tweeter output is required.

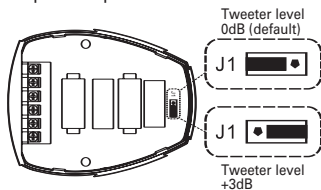

**Figure 8C.** Locating wiring connections on the GT0507C woofer. Other woofers are wired similarly.

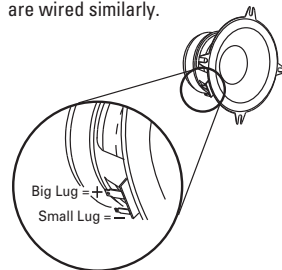

## SPECIFICATIONS

	GT0507C	GT0607C	GT06507C	GT08607C	GT06057SC
Type	5" (130mm) Two-way component	6-1/2" (160mm) Two-way component	165mm Two-way component	6" x 8" (5" x 7") Two-way component	165mm Shallow-mount two-way component
Power Handling	55W RMS, 165W Peak	70W RMS, 210W Peak	70W RMS, 210W Peak	70W RMS, 210W Peak	60W RMS, 180W Peak
Sensitivity (2.83V/1m)	91dB	92dB	92dB	92dB	92dB
Frequency Response	70Hz – 21kHz	55Hz – 21kHz	55Hz – 21kHz	55Hz – 21kHz	55Hz – 21kHz
Impedance	2 Ohms	2 Ohms	2 Ohms	2 Ohms	2 Ohms
Mounting Depth	2-5/16" (59mm)	2-1/16" (53mm)	2-3/8" (61mm)	2-1/4" (58mm)	1-13/16" (47mm)
Cutout Diameter	4-11/16" (120mm)	5-1/16" (129mm)	5-11/16" (145mm)	4-15/16" x 7-3/16" (126mm x 183mm)	5-11/16" (145mm)
Overall Diameter	5-1/8" (131mm)	6-1/4" (159mm)	6-9/16" (167mm)	5-11/16" (145mm)	6-9/16" (167mm)

### GENERAL CARE

The loudspeaker grilles may be cleaned with a damp cloth. Do not use any cleaners or solvents on the grilles or the speaker cones.

These products are designed for mobile applications and are not intended for connection to the mains.

A valid serial number is required for warranty coverage.

Features, specifications and appearance are subject to change without notice.

Not all models are available in all markets.

Declaration of Conformity



We, Harman Consumer Group International  
2, route de Tours  
72500 Château du Loir  
France

declare in own responsibility that the products described in this owner's manual are in compliance with technical standards:

EN 61000-6-3:2001  
EN 61000-6-1:2001

*Klaus Leberher*

Klaus Leberher  
Harman Consumer Group International  
Château du Loir, France 4/06

**JBL**

[www.jbl.com](http://www.jbl.com)

## Free Manuals Download Website

<http://myh66.com>

<http://usermanuals.us>

<http://www.somanuals.com>

<http://www.4manuals.cc>

<http://www.manual-lib.com>

<http://www.404manual.com>

<http://www.luxmanual.com>

<http://aubethermostatmanual.com>

Golf course search by state

<http://golfingnear.com>

Email search by domain

<http://emailbydomain.com>

Auto manuals search

<http://auto.somanuals.com>

TV manuals search

<http://tv.somanuals.com>