

JBL

creature

self powered satellite speakers and subwoofer

user's guide

English
Français
Español
Deutsch
Italian



Safety Instructions

Please read the following operation precautions before use:

- Read instructions ---All the safety and operating instructions should be read thoroughly before attempting to operate this audio system.
- Retain instructions for future reference.
- Heed warnings --- All warnings on this audio system and in the operating instructions should be adhered to.
- Follow instructions --- All operating and use instructions should be followed.
- TO PREVENT THE RISK OF ELECTRIC SHOCK, DO NOT REMOVE THE COVER (OR BACK). THERE ARE NO USER SERVICEABLE PARTS INSIDE THIS UNIT, PLEASE REFER SERVICING TO QUALIFIED HARMAN MULTIMEDIA CORPORATION SERVICE PERSONNEL.
- Do not expose the speakers to liquid or solvent.
- Never remove grille covers in order to service the speaker system. The speaker system does not contain any user serviceable parts. Refer all servicing to the Harman Multimedia Technical Support Group.
- Do not expose the speaker system to temperature or humidity extremes, direct sunlight, excessive dust, or vibrations.
- Place the speaker system on a stable, level surface. Do not drop, apply excessive force to the controls, or put heavy objects on top of the speaker.
- If cleaning is required, use a soft dry cloth. If necessary, use a damp cloth without any solvents.
- In order to protect the speaker system, avoid microphone feedback, continuous output from electronic musical instruments, or distorted output from any signal source.
- Do not place the speakers close to fluorescent light sources, or neon light fixtures.
- Although the speakers are magnetically shielded, keep magnetic storage media (disks and tapes) at least four inches from the speaker system in order to avoid data loss.
- WARNING: To reduce the risk of fire or electric shock, do not expose this speaker system to rain or moisture.

Introduction

The Creature is the latest innovation from JBL, a long time leader in the manufacture of high-end component and computer audio systems. JBL's audio heritage combined with continual research has provided the unique technologies included in the Creature.

The Harman Multimedia Odyssey Plus transducer is a unique full range transducer designed specifically for extremely small speaker enclosures while providing significant mid bass. In addition to the bass, the small, rigid and light inverted aluminum cone provides performance that will rival any tweeter used in multimedia speakers today. The result is a small and elegant satellite speaker that perfectly integrates with the subwoofer while providing superior midrange and highs.

The Magnum series subwoofer transducer provides deep bass. This Magnum series of subwoofers are designed specifically to match with the Harman Multimedia Odyssey Plus transducers. The same approach of providing solid bass from a small enclosure guided the development of these Magnum transducers.

As described in the **Using the speaker system** section of the user's guide, the bottom left and right corners of the control/right speaker feature - and + buttons. Briefly touching the appropriate button will cause a small step increase or decrease in the system volume. Touching the appropriate button for more than 0.5 seconds will cause the volume to increase or decrease rapidly while that button is touched.

Treble, Bass level adjust knobs are located on front of the subwoofer unit. A system on/off switch is also provided on the rear of the subwoofer unit. The system includes two desktop speakers and a subwoofer that can be placed either on the floor or on your desk. Both satellite speakers and the subwoofer are magnetically shielded to provide the greatest protection against computer monitor image distortion.

Setup

Carefully unpack your speaker system and identify all components:

- A Control/Right Satellite speaker
- B Auxiliary/Left Satellite speaker
- C Subwoofer
- D Power Supply
- E Audio input cable

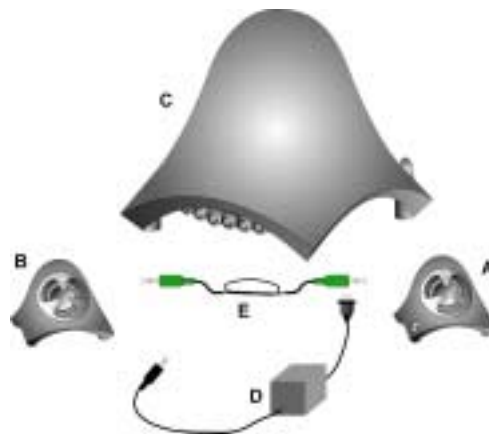

Connect the speaker system as shown in the **Connecting the speaker system to sound card** illustrations. Once the speaker system is properly connected, turn on the power switch located on the rear of the subwoofer.

Step 1 Connecting the speaker system to the computer:

- If you have an integrated sound solution or a stereo sound card; connect the green connector from the subwoofer into the green jack on the computer.
- If you have a multi-channel sound card; connect the green connector from the subwoofer into the green jack on the computer.
- If you have a portable computer; connect the green connector from the subwoofer into the headphone jack on the computer.

Step 2 Plug the orange connector from the right/control satellite into the orange jack on the subwoofer.

Step 3 Plug the brown connector from the left satellite into the brown jack on the subwoofer.

Step 4 Plug the AC power supply jack into the subwoofer.

Step 5 Plug the AC plug into the wall outlet.

Step 6 Turn on the speaker set and adjust the volume accordingly.

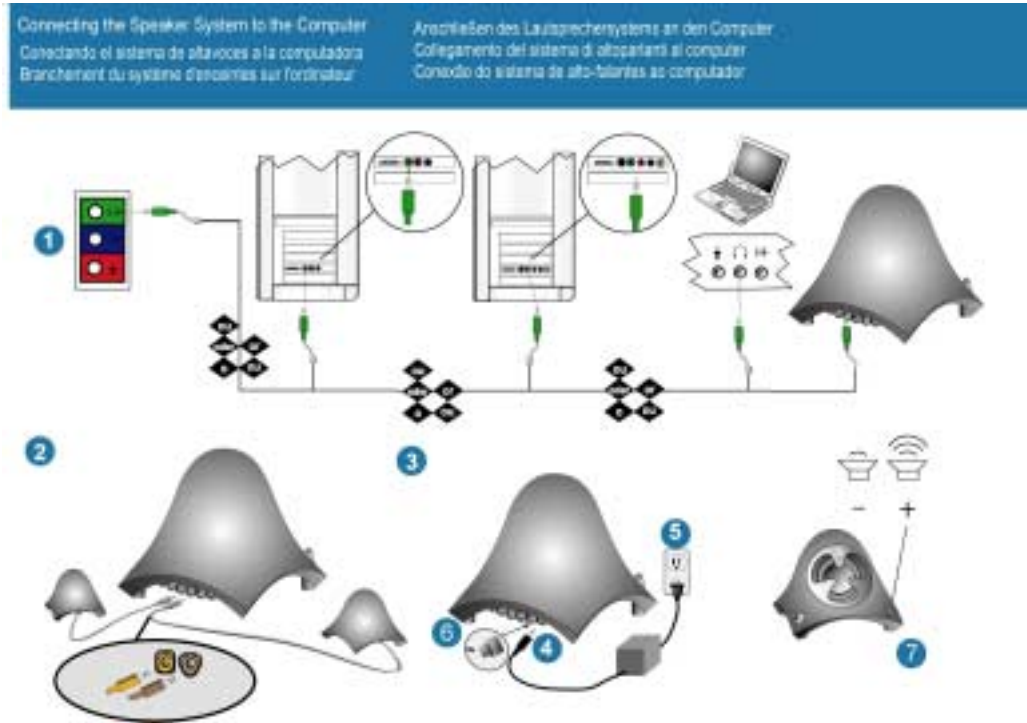

Placement of speakers

The speakers are magnetically shielded and can be placed close to a computer monitor without distorting the image. For optimal stereo imaging, separate the speakers from each other by a distance equal to your distance from the speakers.

The subwoofer's sound is non-directional; therefore, it does not have to be placed in any particular relationship to the satellites. The subwoofer is magnetically shielded and can be placed on the desktop, if desired. If the subwoofer is placed too close to a computer monitor it can cause vibration on the monitor screen.



Using the speaker system

On/Off Switch



An on/off switch is located on the rear of the subwoofer.

There is a green LED located on bottom of each of the two satellite speakers. There is also a green LED located on the bottom-back of the subwoofer. All three LEDs should illuminate when the system is connected correctly and receiving power. Turn the speaker off if it will not be used for a long period.

Volume Control



The volume control can be found on the front of the control/right satellite speaker.

Touching the right + button on the front of this speaker will turn up the volume setting in increments of 2.0 dB per step. If the button is continuously touched, after 0.5 seconds the volume level will constantly increase at a rate of 5 dB per second.

Touching the left - button on the front of the right speaker will turn down the volume setting in increments of 2.0 dB per step. If the button is continuously touched, after 0.5 seconds the volume level will constantly decrease at a rate of 5 dB per second until the system is muted.

The JBL CREATURE will retain the volume setting when it is turned off so that when the speaker system is turned back on, it will restore the last volume setting.

Muting

Touching the left and right buttons simultaneously on the front of the right speaker will mute the audio. Power will remain on (both speakers' LED's remain illuminated). When muted, touching either the left button or the right button, or both buttons simultaneously will restore volume to the level prior to the activation of the mute function.

Controls on the Subwoofer



Bass - Turn the knob marked Bass clockwise to increase the subwoofer level or counterclockwise to decrease the subwoofer level.

Treble - Turn the knob marked Treble clockwise to increase the treble level or counterclockwise to decrease the treble level.

Troubleshooting

SYMPTOM	POSSIBLE PROBLEM	SOLUTION	NOTE
No sound from Speakers	No power to unit.	Make sure wall power outlet or power strip has power. Make sure all switches for outlet/power strip are on and that all switches for speaker system are on.	Check green power LED on the sub. Are the LED's on? If the sub's led is not on, power is not getting to your speaker system. Try the solutions shown.
	Is the control/right satellite of your Creature plugged in correctly?	Ensure that the control speaker connector is pushed in properly. Remove the control /right speaker connector from the subwoofer, then re-connect this cable ensuring that the connector is pushed in properly.	There is an LED located in the bottom of each of the two satellite speakers. These should both be lit. If they are, your speakers are both plugged in correctly.
Distortion (static, crackling or hissing sounds)	Noise may be caused by interference from the monitor.	Turn monitor off to see if noise is eliminated. Move speaker cables farther away from monitor.	
	Speaker is being overdriven by an amplified audio source.	Ensure that speaker is connected to the appropriate receptacle. Check color-coding on connectors when making connections. Make sure that all signal cables are inserted snugly into receptacles.	
	Volume level on sound card may be too high.	Check volume of sound card via Windows Volume Control.	
	Sound card or audio source material may be cause of problem.	Check speakers with another audio source.	Disconnect speaker input cable (green connector) from sound card and plug into CD ROM headphone jack. If static is eliminated, troubleshoot the soundcard.
	Check the speaker control settings.	Set each of the two knobs (treble, bass level) on front of the subwoofer back the their center /nominal positions.	
Too much bass or treble.	Bass/Treble level is set too high	Turn Bass/Treble down or return their settings to the center position.	
Subwoofer emits a loud hum or buzzing noise.	Input cables not plugged in properly	Check input cable connection	
Speaker system experiences radio frequency interference or picks up a radio station	Input cable may be picking up interference	Wrap up excess input cable in order to make as short as possible	
		Purchase a ferrite clamp and attach over input cable. A clamp can be purchased at your local electronics store	

SPECIFICATIONS

Manufacturer	Harman International
Model	Creature
Drivers (satellite)	Odyssey Plus
Drivers (subwoofer)	One 4. 5 inch Magnum woofer
Power (satellite)	9 watts per satellite at 10% THD
Power (subwoofer)	27 watts at 10% THD
Crossover Frequency (subwoofer)	180 Hz
Dimensions	
Width:	
Satellite	3.0 inches
Subwoofer	9.0 inches
Depth:	
Satellite	3.0 inches
Subwoofer	9.0 inches
Height:	
Satellite	3.0 inches
Subwoofer	10 inches
Input Impedance	
Input Impedance	5-10kOhm
Signal-to-Noise ratio	>70dB
Frequency Response	35 – 20 kHz
Input Sensitivity	300-400 mV rms for rated power output
USA/Canada Power	120 volts, 60Hz AC
Maximum Power Consumption	120 watts
UL/CUL/CE Approved	

Regulatory

FCC Statement and Warning

This equipment has been tested and found to comply with the limits for a Class B digital device, pursuant to Part 15 of the FCC rules. These limits are designed to provide reasonable protection against harmful interference in a residential installation. This equipment generates, uses and can radiate radio frequency energy and, if not installed and used in accordance with the instructions, may cause harmful interference to radio communications. However, there is no guarantee that interference will not occur in a particular installation. If this equipment does cause harmful interference to radio or television reception, which can be determined by turning the equipment off and on, the user is encouraged to try to correct the interference by one or more of the following measures:

- a) Re-orient or relocate the receiving antenna.
- b) Increase the separation between the equipment and receiver.
- c) Connect the equipment to an outlet on a circuit different from that to which the receiver is connected.
- d) Consult the dealer or an experienced radio/TV technician for help.

MODIFICATIONS NOT EXPRESSLY APPROVED BY THE MANUFACTURER COULD VOID THE USER AUTHORITY TO OPERATE THE EQUIPMENT UNDER FCC RULES.

Free Manuals Download Website

<http://myh66.com>

<http://usermanuals.us>

<http://www.somanuals.com>

<http://www.4manuals.cc>

<http://www.manual-lib.com>

<http://www.404manual.com>

<http://www.luxmanual.com>

<http://aubethermostatmanual.com>

Golf course search by state

<http://golfingnear.com>

Email search by domain

<http://emailbydomain.com>

Auto manuals search

<http://auto.somanuals.com>

TV manuals search

<http://tv.somanuals.com>