

# Jabra®

DISCOVER FREEDOM

## Jabra® FREEWAY



### User manual

---

## CONTENTS

THANK YOU .....	2
ABOUT YOUR JABRA FREEWAY.....	2
WHAT YOUR SPEAKERPHONE CAN DO .....	3
GETTING STARTED.....	4
CHARGE YOUR SPEAKERPHONE.....	4
TURNING YOUR SPEAKERPHONE ON AND OFF .....	5
PAIRING IT WITH YOUR PHONE/DEVICE .....	6
PAIR A NEW OR SECOND DEVICE.....	6
CONNECTING WITH YOUR PHONE.....	7
PLACE THE SPEAKERPHONE IN YOUR VEHICLE.....	7
HOW TO .....	8
JABRA VOICE FEATURES.....	10
ADDITIONAL FEATURES.....	13
TROUBLESHOOTING & FAQ .....	15
NEED MORE HELP? .....	17
TAKING CARE OF YOUR SPEAKERPHONE.....	18
GLOSSARY .....	19

## THANK YOU

Thank you for purchasing the Jabra FREEWAY Bluetooth® speakerphone. We hope you enjoy it! This instruction manual will get you started and ready to make the most of your speakerphone.

## ABOUT YOUR JABRA FREEWAY

### **A Answer/end button**

Tap to answer/end call

### **B FM button**

Tap to activate FM mode and stream music and calls to your car radio

### **C Volume down**

Tap to adjust volume down

### **D Mute button**

Tap to mute/un-mute your microphone during a call

### **E Volume up**

Tap to adjust volume up

### **F Voice button**

Tap to initiate voice command functions

### **G Visor clip**

### **H Power switch**

Slide to ON position to turn the FREEWAY on

### **I Micro USB charging connector**

Charge with the Micro USB charger

### **J Charging indicator light**

Light red while charging and turns off when fully charged



## WHAT YOUR SPEAKERPHONE CAN DO

### **Your Jabra FREEWAY lets you do all this:**

- Make and answer calls just using your voice
- Ease of use with Jabra Voice Guidance
- Last number redialing and call back last number
- Voice dialing\*
- Three way calling\*
- Advanced MultiUse™ - be connected to two active Bluetooth devices at the same time
- Tells you who is calling\*
- Transfer music and calls to your car radio
- Turns on and off automatically using the builtin G-sensor
- Listen to wireless stereo music in Virtual Surround Sound\*

### **Specifications:**

- Up to 14 hours of talk time and 40 days of standby time
- Rich and crisp stereo sound and Virtual Surround Sound
- Dual microphones provides outstanding background noise reduction
- Digital sound enhancements via DSP technology
- Clear wireless streaming of you r favorite multimedia: Music, podcasts, video, etc. (from A2DP enabled devices\*)
- Bluetooth technology – Easy pairing with Bluetooth 2.1 + EDR & eSCO
- Supported Bluetooth profiles: HFP, HSP, A2DP, AVRCP, PBAP
- Up to 128-bit encryption
- Rechargeable battery with charging option from car charger or PC using the supplied USB cable
- Operating range up to 10 meters (approximately)
- Weight 150 grams
- Size: L 100 mm x W 120 mm x H 20 mm

## GETTING STARTED

You should follow three steps before using your speakerphone:

- 1 Charge your Speakerphone using the supplied USB cable and car charger (approximately 2 hours)
- 2 Activate Bluetooth® on your phone or device (refer to the manual of your device)
- 3 Pair your speakerphone to your phone or device

The first time you turn your Jabra FREEWAY on you will hear Voice Guidance telling you what to do.

**NOTE:** Voice Guidance and Voice commands are enabled as the default setting when you turn on your Jabra FREEWAY the first time. You can at any time disable both by pressing the **Voice** button while you slide the power switch into the **On** position. You will hear "Voice off" and FREEWAY will no longer talk to you or listen for commands. Repeat the process to enable the voice features again.

## CHARGE YOUR SPEAKERPHONE

Make sure that your speakerphone is fully charged before you start using it. Use the USB cable to connect Jabra FREEWAY to the car charger. Plug the car charger into your car's power outlet. The charging indicator light will light up in red while charging. When the Jabra FREEWAY is fully charged the indicator light will turn off. A full charge takes approximately two hours.

Jabra FREEWAY can be charged outside your car using the USB cable.

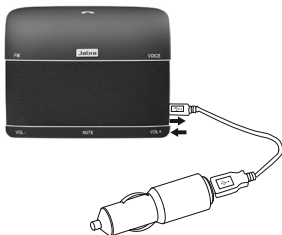

Only use the charger provided in the box – do not use chargers from other devices as this may damage your speakerphone. Also you should not use your supplied FREEWAY charger to charge other devices.

**NOTE:** The lifetime of the battery will be significantly reduced if your device is left uncharged for a long period. We therefore recommend that you recharge your device at least once a month.

## TURNING YOUR SPEAKERPHONE ON AND OFF

- Slide the **On/Off** power switch to turn the speakerphone on or off.
- If the switch is left in the **On** position the Jabra FREEWAY will automatically turn on and reconnect to your phone when you enter your car (open the car door).

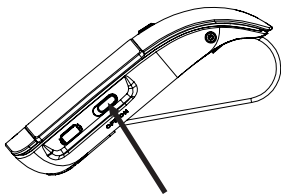

The Jabra FREEWAY will automatically turn off when your phone is moved away from the car.

**NOTE:** Moving the Jabra FREEWAY will also turn it on if the power switch is in the **On** position.

## PAIRING IT WITH YOUR PHONE/DEVICE

Speakerphones are connected to mobile phones using a procedure called 'pairing'. By following a few simple steps, a phone can be paired with a speakerphone in a matter of seconds.

- 1 Activate Bluetooth® on your phone/device
- 2 Turn the Jabra FREEWAY on
- 3 The first time you turn the FREEWAY on it will automatically enter into pairing mode. The **Answer/end** button will flash with a blue light and you will be voice guided through the pairing process. If you have disabled voice guidance go to the Bluetooth® settings menu on your phone/device and search for new Bluetooth® devices. Choose Jabra FREEWAY.
- 4 When pairing is complete you will hear "Connected". You are now ready to start using your Jabra FREEWAY.

**NOTE:** If asked for a passkey or pin code use 0000 (four zeros)

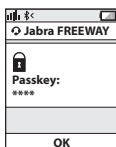
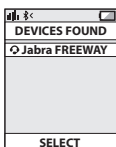
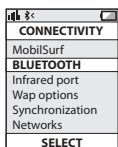

## PAIR A NEW OR SECOND DEVICE

- 1 Ensure that the Jabra FREEWAY is turned on
- 2 Tap the **Voice** button. You will be asked to "Say a command"
- 3 Say "Pair new device" and follow the instructions
- 4 If this is your second device you will need to reconnect to the first device afterwards

**NOTE:** If you have disabled Voice Guidance you can put Jabra FREEWAY in pairing mode manually by pressing and holding the **Answer/end** button while you slide the power switch into the **On** position. The **Answer/end** button will flash blue to indicate that you are in pairing mode.

## CONNECTING WITH YOUR PHONE

Pairing is only needed the first time a speakerphone and a phone/device are used together. When the speakerphone and phone/device have been paired once they will automatically reconnect when the speakerphone is on and Bluetooth® is activated on the phone/device.

If the devices are paired, but do not immediately reconnect tap the **Answer/end** button.

## PLACE THE SPEAKERPHONE IN YOUR VEHICLE

The Jabra FREEWAY sits discreetly and conveniently on the sun visor using the attached clip. **For optimal sound quality place the Jabra FREEWAY right in front of you and speak directly into the speakerphone.**

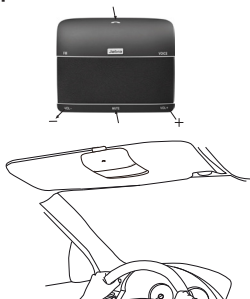



## HOW TO

The Jabra FREEWAY is easy to operate. The buttons performs different functions depending on how long you press them.

Instruction	Duration of press
Tap	Press briefly
Double tap	Press briefly two times within 1/2 second
Press	Approx: 1-3 second
Long press	Approx: 4-5 seconds
Extra long press	Approx: 5-10 seconds

### Answer a call

- Tap the **Answer/End** button
- Say "Answer" after the caller is announced.\*

### End a call

- Tap the **Answer/End** button

### Reject/ignore a call\*

- Double Tap the **Answer/End** button when the phone rings to reject an incoming call. Depending on your phone settings, the person who called you will either be forwarded to voice mail or hear the busy signal
- Say "Ignore" after the caller is announced.\*

### Make a call\*

- Tap the **Voice** button and you will be prompted to "Say a command". You can then:
  - Say "Redial" to redial last outgoing number
  - Say "Call back" to call back the last incoming number\*
  - Say "Phone commands" to activate the voice dialing feature on your phone\*\*

- You can also place a call directly from your phone. If your phone is connected it will automatically transfer the call to your Jabra FREEWAY\*. If the call does not transfer, tap the **Answer/end** button.

#### **Last number redial\***

- Double tap the **Answer/End** button

#### **Activate Voice dialing\*\***

- Press the **Answer/end** button to activate the phones voice dialing or tap the **Voice** button and say "Phone commands".\*

#### **Mute/un-mute**

- Tap the **Mute** button during a call to mute your microphone during a call and again to turn mute off.

#### **Adjust sound and volume**

- Tap the **Vol-** or **Vol+** buttons to adjust the volume when on a call or listening to wireless on your Jabra FREEWAY.

#### **Three way calling\***

- Press the **Answer/end** button to switch to call on hold. Press the **Answer/end** button to switch back to first call.

#### **Transfer call**

- Press and hold the **Answer/end** button until you hear a beep to transfer a call from the speakerphone to the mobile phone.

#### **Play music\***

- If your phone supports A2DP audio streaming then you can transfer music or any other type of audio to the FREEWAY.

#### **Answer a call while playing music\***

- If you have an incoming call while listening to music on the Jabra FREEWAY the music will pause and you will hear your ringtone or caller ID. You can then choose to answer or ignore the call. After the call the music will start to play again\*.

## JABRA VOICE FEATURES

Type	Definition
Voice Control	Your voice in action, where you guide the speakerphone
Voice Guidance	The speakerphone plays voice announcements to you

When you have an incoming call you can answer or ignore just using your voice. You do not have to touch Jabra FREEWAY or your phone. Just say "Answer" to take the call and "Ignore" to reject.

Voice control – Incoming call	
Your voice to FREEWAY	What it does
"Answer"	The speakerphone captures your command and directs the phone to take the call
"Ignore"	The speakerphone captures your command and directs the phone to reject the call

At any time when you are connected to a phone you can tap the **Voice** button, wait for Jabra FREEWAY to ask you to "Say a command", and then say one of the following commands.

Voice control – Outgoing calls, pairing, battery level and start music player	
Your Voice to FREEWAY	What it does
"Pair new device"	Puts the FREEWAY into pairing mode
"Redial"	FREEWAY redials the last outgoing call made on the phone
"Call back"	Calls back the last incoming call received on the FREEWAY

"Phone commands"	Activates your phone's voice dialing feature*
"Battery"	Will tell you the battery level on FREEWAY
"Play"	Will start the music player on your phone/device*
"What can I say?"	Will tell you what your options are
"Cancel"	Will cancel the current operation and close the voice menu

When you are playing music on the Jabra FREEWAY you can at any time tap the **Voice** button to remote control you music player using your voice.

<b>Voice control – While listening to music*</b>	
<b>Your Voice to FREEWAY</b>	<b>What it does</b>
"Next track"	Will skip to the next track on your playlist
"Previous track"	Will skip to the previous track on your playlist
"Stop"	Will stop the music in your music player
"Play"	Will start your music player again
"What can I say?"	Will tell you what your options are
"Cancel"	Will cancel your current operation and close the voice menu

The Jabra FREEWAY is loaded with voice announcements that talks you through setup and daily operation. In the table below you can see the most common announcements.

<b>Voice guidance</b>	
<b>FREEWAY announcements to you</b>	<b>What it means</b>
<p>"Welcome! You are now ready for pairing. Go to the Bluetooth menu on your phone. Turn on or enable Bluetooth. Search for devices and select your Jabra hands free device. Select pair or OK. If asked for a PIN code enter 0000"</p>	<p>The FREEWAY is in pairing mode. Announced automatically when powered on the first time and whenever FREEWAY is put into pairing mode.</p>
"Pairing failed"	Announced if pairing fails
"Connected"	Announced when FREEWAY is connected to a phone
"Two devices connected"	Announced when FREEWAY is connected to two phones/devices
"Disconnected"	Announced if a connected phone/device is turned off, goes out of range or has BT disabled while in range and while the speakerphone is still turned on.
"Battery level is low"	Announced when the battery level goes below 10%
"Voice on/off"	Announced when voice guidance and controls are enabled or disabled
"Call from <name from phone address book or number>"*	Announced when there is an incoming call if your phone/device supports caller ID (PBAP)

## ADDITIONAL FEATURES

### **Play music, podcasts and audio from GPS applications\***

If your phone or device supports A2DP audio streaming you can hear your music or any other audio through your Jabra FREEWAY. Simply start playing your music or start your application and the audio will automatically transfer to FREEWAY. If your phone rings the audio will mute and you can answer or ignore the call. The audio will resume after the call.\*

You can also start your music player by tapping the **Voice** button. Wait for the FREEWAY to ask you to "Say a command" and then say "Play"\*.

When playing music you can at any time tap the **Voice** button again and:

- Say "Next track" and "Previous track" to skip between songs
- Say "Stop" or "Play" to start or stop your music

If you want to exit A2DP streaming mode or stop the music you can:

- Tap the **Voice** button and say "Stop"
- Stop the music/audio in your device

### **Using you Jabra FREEWAY with two mobile devices at the same time**

The Jabra FREEWAY supports Advanced MultiUse™ and is capable of having two mobile phones (or other Bluetooth® devices) connected at the same time. This will give you the freedom of having only one headset to operate both of your mobile phones/devices.

When you have two active phones/devices connected you will hear "Two devices connected". In this state the phone paired last will be used for voice dialing. When two phones are connected you can place and answer calls on both and switch between the two. If you are on a call and receive a second call you will be alerted by a tone. You can then:

- Put the first call on hold and accept the incoming call by pressing the **Answer/end** button
- Switch between the two active calls by pressing the **Answer/end** button again
- Tap the **Answer/end** button once to end the first call and accept the new incoming call

## FM Transmitter

You can transmit your calls, music and GPS directions from your phone/device to your car stereo using the built-in FM transmitter.

Tap the **FM** button and set your radio to the announced frequency. If you experience interference from a radio station on your set frequency you can either tap the **FM** button to quickly redirect the audio back to the FREEWAY or press the **VOL+** button to search for a new frequency.

If your radio supports RDS it will automatically adjust to the new frequency. If it doesn't you have to manually set the radio to the new frequency.

**Note:** When in FM mode the volume controls on the FREEWAY are disabled. Use the volume control on your car radio instead.

### QUICK REFERENCE TABLE FOR MANUALLY CONTROLLING YOUR JABRA FREEWAY

Function	Action
Entering pairing mode	Press and hold the <b>Answer/end</b> button while sliding the Power switch into the <b>On</b> position
Cancel pairing mode	Tap the <b>Answer/end</b> button
Answer call	Tap the <b>Answer/end</b> button
End a call	Tap the <b>Answer/end</b> button
Reject a call	Double tap the <b>Answer/end</b> button to reject an incoming call
Initiate phone voice dial*	Press the <b>Answer/end</b> button when connected or not on an active call or tap the <b>Voice</b> button and say "Phone commands" to activate the voice dialing feature on your phone.*

Enable or disable Voice Guidance and commands	Press and hold the <b>Voice</b> button while sliding the Power switch into the <b>On</b> position. You will hear "Voice on" when you enable and "Voice off" when you disable the voice features.
Reset to factory default	Turn on the FREEWAY and press and hold the <b>Answer/end, Voice</b> and <b>Mute</b> button together for about 6 seconds. When the FREEWAY is reset it will automatically go into pairing mode.
Night driving mode	When powered on you can tap the <b>Vol-</b> and <b>Vol+</b> simultaneously to disable the LED's. And again to enable them again. The LED's will be enabled every time you reconnect or power on the FREEWAY.

### Download Firmware updates and additional languages

Go to [jabra.com/freeway](http://jabra.com/freeway) and download the latest firmware and additional languages.

## TROUBLESHOOTING & FAQ

### I hear crackling noises

- Bluetooth is a radio technology, which means it is sensitive to objects between the speakerphone and the connected device. It is designed for the speakerphone and the connected device to be used within 33 feet (10 meters) of each other, with no major objects in the way (walls, etc.).

### I cannot hear anything in my speakerphone

- Increase the volume in the speakerphone.
- Ensure that the speakerphone is paired to a device that is playing.
- Make sure your phone is connected to the speakerphone by tapping the **Answer/End** button.



### **I am having pairing problems**

- You may have deleted your speakerphone pairing connection in your mobile phone/device. Follow the pairing instruction to pair it again.

### **I want to reset the pairing list in my speakerphone**

- The speakerphone registers a list of up to 7 mobile phones. To clear the pairing list and reset the Jabra FREEWAY to factory settings you can turn the FREEWAY on while pressing the **FM, Voice** and **Answer/end** button for about 6 seconds. The next time you power on the Jabra FREEWAY it will automatically go into pairing mode.

### **Will the Jabra FREEWAY work with other Bluetooth equipment?**

- The Jabra FREEWAY is designed to work with Bluetooth mobile phones. It can also work with other Bluetooth devices that are compliant with Bluetooth version 1.1 or higher and support a headset, hands-free and/or advance audio distribution profile.

### **I cannot use Reject call, call on hold, Redial or voice dialing**

- These features are dependent on the ability of your phone to support a hands-free profile. Even if the handsfree profile is implemented reject call, call hold and voice dialing are optional features which are not supported by all devices. Please consult your device manual for details.

Please note that some features can only be operated from the primary device e.g. voice dial using Jabra FREEWAY with 2 mobile phones.

### **I can not connect speakerphone and radio via FM transmitter**

- Make sure the radio is turned on and speakerphone is in FM mode (FM Status Icon is on).
- If your radio when searching is not able to find the FM frequency set by your speakerphone, the FM frequency must be tuned in manually on the radio. Please read radio manual to find out how to manually change frequency on your radio.
- If your radio is in TA (Traffic Announcement) mode, switch TA off and your radio should be able to find your speakerphone when using the search function on the radio. If not tune in manually.

- The sensitivity of the search function on your radio determines whether it is able to find the frequency set by your speakerphone. On some radios you are able to adjust the sensitivity thus making it possible to find the speakerphone frequency when searching. If not tune in manually.
- In urban areas it might be difficult to find a clear frequency. It is therefore advisable to use a frequency in the lower or upper end of the FM frequency band (e.g. 88.1 or 107.7 MHz) where you will have the best chance to find a clear frequency.

### **My Jabra FREEWAY does not announce the caller names during incoming calls**

- Ensure that your phone supports the Bluetooth® phonebook access profile (PBAP) and that the name of the caller is in your phonebook.

Please note that on some Android phones a warning message about the phonebook transfer appears in the top left corner. You must select this message and agree to the connection in order to get caller ID to function properly.

### NEED MORE HELP?

**1. Web:** [www.jabra.com](http://www.jabra.com)  
(for the latest support info and online User Manuals)

### **2. E-mail:**

Deutsch	<a href="mailto:support.de@jabra.com">support.de@jabra.com</a>
English	<a href="mailto:support.uk@jabra.com">support.uk@jabra.com</a>
Español	<a href="mailto:support.es@jabra.com">support.es@jabra.com</a>
Français	<a href="mailto:support.fr@jabra.com">support.fr@jabra.com</a>
Italiano	<a href="mailto:support.it@jabra.com">support.it@jabra.com</a>
Nederlands	<a href="mailto:support.nl@jabra.com">support.nl@jabra.com</a>
Polska	<a href="mailto:support.pl@jabra.com">support.pl@jabra.com</a>
Scandinavian	<a href="mailto:support.no@jabra.com">support.no@jabra.com</a>
Россия	<a href="mailto:support.ru@jabra.com">support.ru@jabra.com</a>
	Information: <a href="mailto:info@jabra.com">info@jabra.com</a>

### 3. Phone:

Belgique/Belgie	00800 722 52272
Danmark	70 25 22 72
Deutschland	0800 1826756
Die Schweiz	00800 722 52272
España	900 984572
France	0800 900325
Italia	800 786532
Luxembourg	00800 722 52272
Nederland	0800 0223039
Norge	800 61272
Österreich	00800 722 52272
Polska	0801 800 550
Portugal	00800 722 52272
Suomi	00800 722 52272
Sverige	020792522
United Kingdom	0800 0327026
Россия	+7 916 246 69 00
International	00800 722 52272

### TAKING CARE OF YOUR SPEAKERPHONE

- Always store the Jabra FREEWAY with the power off and safely protected.
- Avoid storage at extreme temperatures (above 45°C/113°F – including direct sunlight – or below -10°C/14°F). This can shorten battery life and may affect operation. High temperatures may also degrade performance.
- Do not expose the Jabra FREEWAY to rain or other liquids.

## GLOSSARY

- 1 Bluetooth** is a radio technology that connects devices, such as mobile phones and headsets, without wires or cords over a short distance (approx. 10 meters/33 feet). Bluetooth is safe to use. It is secure too, so once a connection has been made no-one can listen in and there is no interference from other Bluetooth devices either. Get more information at [www.bluetooth.com](http://www.bluetooth.com).
- 2 Bluetooth profiles** are the different ways that Bluetooth devices communicate with other devices. Bluetooth phones support the headset profile, the hands-free profile or both. In order to support a certain profile, a phone manufacturer must implement certain mandatory features within the phone's software.
- 3 Pairing** creates a unique and encrypted link between two Bluetooth devices and lets them communicate with each other. Bluetooth devices will not work if the devices have not been paired.
- 4 Passkey or PIN** is a code that you enter on your Bluetooth enabled device (e.g. a mobile phone) to pair it with your Jabra FREEWAY. This makes your device and the Jabra FREEWAY recognize each other and automatically work together.
- 5 Standby mode** is when the Jabra FREEWAY is passively waiting for a call. When you 'end' a call on your mobile phone, the speakerphone goes into standby mode.



Dispose of the product according to local standards and regulations.

[www.jabra.com/weee](http://www.jabra.com/weee)

# Jabra®

DISCOVER FREEDOM

A BRAND BY

**GN Netcom**

© 2011 GN Netcom US, Inc. All rights reserved. Jabra® is a registered trademark of GN Netcom A/S. All other trademarks included herein are the property of their respective owners. The Bluetooth® word mark and logos are owned by the Bluetooth SIG, Inc. and any use of such marks by GN Netcom A/S is under license. (Design and specifications subject to change without notice).

© 2011 GN Netcom A/S. All rights reserved. Jabra® is a registered trademark of GN Netcom A/S. All other trademarks included herein are the property of their respective owners. The Bluetooth® word mark and logos are owned by the Bluetooth SIG, Inc. and any use of such marks by GN Netcom A/S is under license. (Design and specifications subject to change without notice).

MADE IN CHINA  
TYPE: HFS100



REV A

## Free Manuals Download Website

<http://myh66.com>

<http://usermanuals.us>

<http://www.somanuals.com>

<http://www.4manuals.cc>

<http://www.manual-lib.com>

<http://www.404manual.com>

<http://www.luxmanual.com>

<http://aubethermostatmanual.com>

Golf course search by state

<http://golfingnear.com>

Email search by domain

<http://emailbydomain.com>

Auto manuals search

<http://auto.somanuals.com>

TV manuals search

<http://tv.somanuals.com>