

SD audio player

Type	: SD audio player
Sampling rate	: 32 kHz/44.1kHz/48kHz
Audio format	: AAC format/MP3 format
Number of channels	: 2 channels (stereo)
Frequency response	: 20 Hz to 20,000 Hz (+0dB, -6dB)
Maximum recording time (with a 64 MB SD memory card)	
High-quality rec.	: Approx. 64 minutes (128 kbps)
Standard rec.	: Approx. 86 minutes (96 kbps)
Long-hour rec.	: Approx. 129 minutes (64 kbps)
Output	: Headphones (3.5 mm dia. stereo × 1) 2.5 mW/ch (32 ohms) matching impedance (16 ohms to 47 kohm)
Duration of battery	: Approx. 11 hours when using two fully charged rechargeable batteries Approx. 17 hours when using two alkaline batteries (L30 (24A), AAA size)
Power requirements	: DC 1.2 V (rechargeable battery) DC 1.5 V (AAA size battery) Two batteries are used in parallel.
Dimensions (W × H × D)	: 2 1/8" × 1 3/16" × 2 9/16" (53.5 × 30.5 × 65 mm) (Excluding buttons and controls)
Mass	: Approx. 0.172 lbs (78 g) (without batteries)

Battery charger

Input power source	: AC 120 V, 60 Hz
Output voltage	: DC 1.7 V, 950 mA

* Design and specifications are subject to change without notice.

This main unit is resistant to spray.

Supplied Accessories

Check the packing carton for these accessories.



Headphones 1 pc.

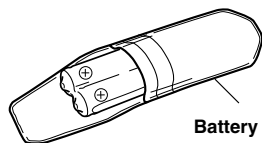

Battery case

Rechargeable battery (BN-R1213)
1 pack (2 pcs.)

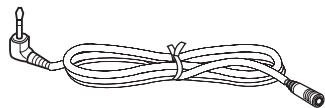

Extension cord 1 pc.



CD-ROM (Media Manager) 1 pc.

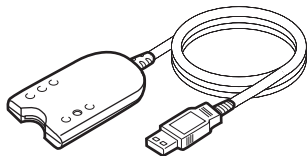

USB reader/writer unit 1 pc.

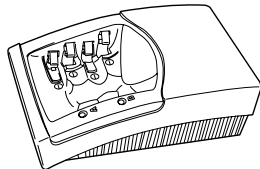

Battery charger (AC-R129) 1 pc.

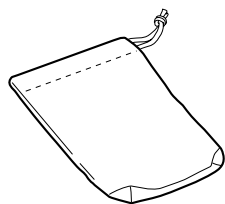

Carrying pouch 1 pc.



SD memory card (64 MB) 1 pc.

Remove the rechargeable batteries from their case before use.
Use numbers indicated in parentheses when asking for replacement parts.

- SD logo is a trademark.
- Portions of this product are protected under copyright law and are provided under license by ARIS/SOLANA/4C.
- RealJukebox® is a registered trademark of RealNetwork, Inc.

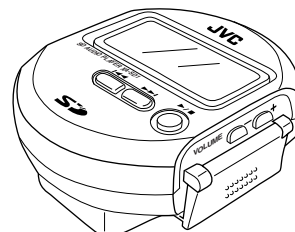

SD Audio Player

XA-SD1



Be sure to read this before any other information

After checking the accessories, perform check-out (recording) on the SD memory card using the following procedure.
For more details, read the operating instructions of Media Manager and the Online Help of RealJukebox®.

- 1 Install the USB reader/writer driver and installation software (RealJukebox®) in the CD-ROM in your PC.**
- 2 Connect the USB reader/writer to the PC.**
- 3 Open RealJukebox® and perform check-out of the SD memory card.**

For Customer Use:

Enter below the Model No. and Serial No. which are located either on the rear of the cabinet or inside of the battery compartment. Retain this information for future reference.

Model No. _____

Serial No. _____

Thank you for purchasing this JVC product. Please read these instructions carefully before starting operation to be sure to obtain optimum performance and a longer service life from the unit.

LVT0718-002A [J]



VICTOR COMPANY OF JAPAN, LIMITED



Printed in Japan
0601HMMWSTOZK

Recharging the Rechargeable Batteries

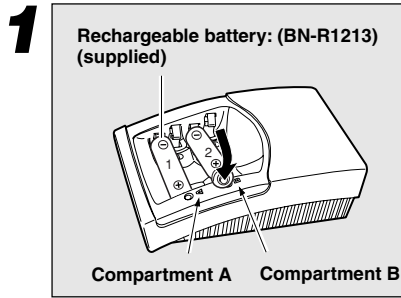

Insert two rechargeable batteries in the battery charger.

- Insert them in the correct \oplus and \ominus polarity as indicated inside the battery charger.
- The two batteries will be recharged separately one after another.

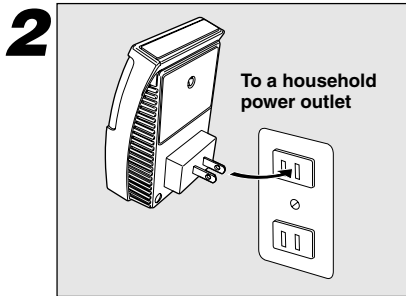

Insert the power plug blades into a household power outlet.

- Recharging begins with the battery inserted in position A. The recharging of two batteries will complete in about 4-1/2 hours.
- It is possible to recharge about 300 times.
- After recharging completes, remove the power plug blades from the power outlet.

Charge indicator lamps

	A charging state	B charging state	Completed
Compartment A	<p>Charging</p> <p>(Fast on-and-off)</p>	<p>Finished</p> <p>(Continuous on)</p>	<p>Finished</p> <p>(Continuous on)</p>
Compartment B	<p>Charging</p> <p>(Slow on-and-off)</p>	<p>Charging</p> <p>(Fast on-and-off)</p>	<p>Finished</p> <p>(Continuous on)</p>

- If two batteries are inserted in the battery charger that has already been plugged into the power outlet, the first-inserted battery will be recharged first.
- Fast blinking refers to one blink per about 1 second, and slow blinking refers to one blink per about 3 seconds.

Insert batteries in the Main unit.

1 Open the battery compartment cover.

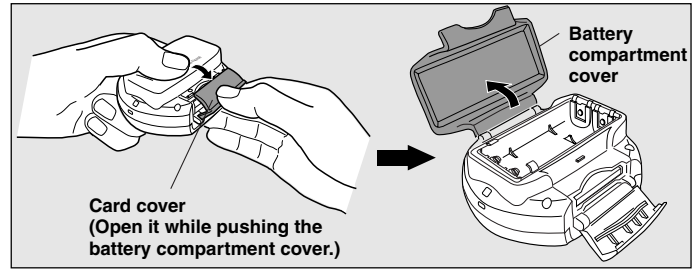

2 Insert batteries.

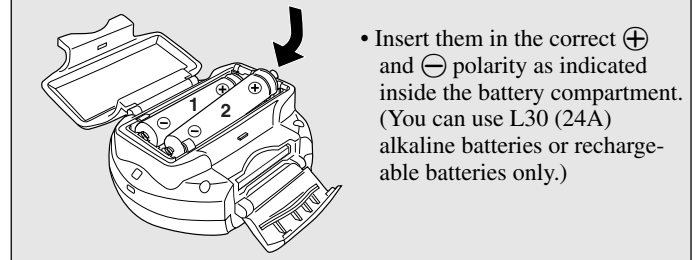

3 Close the battery compartment cover.

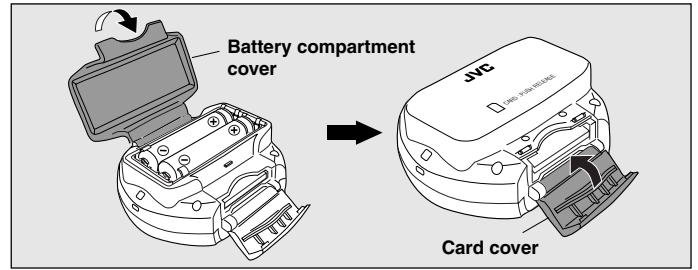

Caution for use of dry cell batteries:

Be sure to use L30 (24A) alkaline batteries. Manganese batteries cannot be used to power the unit.

Remaining battery power display:

Use the remaining battery power indicator in the display panel as the reference for identifying the available power.

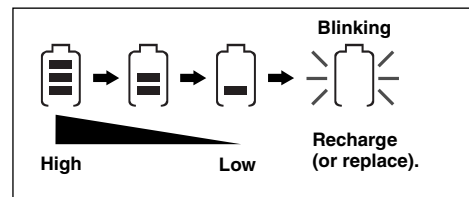

Notes on battery replacement

During recharging of the batteries, use two L30 (24A) alkaline batteries, which is available in electric appliance stores. The built-in clock display can be retained by changing the batteries within 30 seconds.

Hold mode

The hold mode protects the unit against accidental press of control buttons.

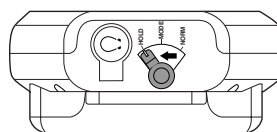

It prevents the following accidents:

- Battery exhaustion by turning the unit on without noticing it.
- Interruption of playback due to accidental press of a button.

1

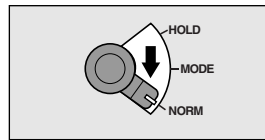

Set to NORM.

2

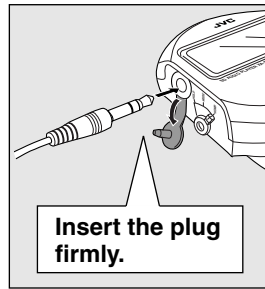

Connect headphones.

To use an extension cord, see below.

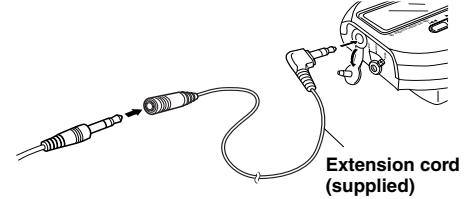

3

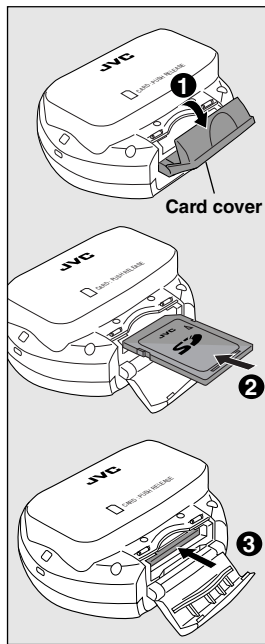

Insert an SD memory card containing data check-out (recording).

① Slide the card cover on the side of the unit in the direction of the arrow and open the card cover.

Open it while pushing the battery compartment cover.

② Hold the SD memory card with the label side up, then insert the card from the side having cut corners.

③ Insert the SD memory card by pushing the center of its edge until it locks, then close the card cover.

Note

Never insert the SD memory card upside down. Otherwise, it will not be able to be removed.

4

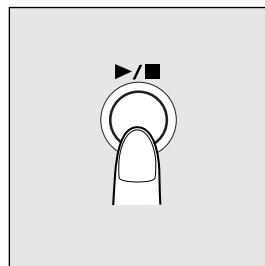

Press ▶/■.

The unit is turned on and playback starts.

Immediately after press



Approx. 2 sec. later

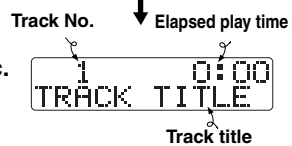

5

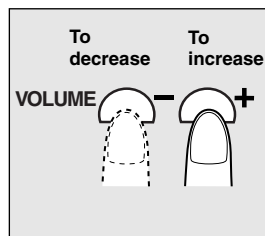

Adjusting the volume

Press and hold to vary continuously.

Volume level meter



Volume level (Adjustment range 0 to 25)

Stop playback and turn the unit off.



Press ▶/■.

The unit is turned off automatically in about 10 seconds.

Resume

When ▶/■ is pressed again after the unit has been turned off, playback resumes from the position at which the unit was turned off. However, playback starts from the first track if the SD memory card is changed or batteries are removed and inserted again while the unit is off.

To remove the SD memory card

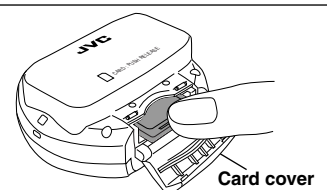

While playback is stopped, open the card cover (operations ① in step 3 above) and unlock and remove the SD memory card by pushing its center area.

Using the convenient features

Preparation

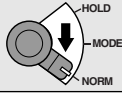

Set the MODE switch knob to "NORM".

Skipping tracks

Press **◀◀▶▶** during playback.



To skip backward To skip forward

- When the all-track repeat mode (see below) is set, it is also possible to skip from the final track to the first track.
- In the random play mode (see below), it is not permitted to skip to a track which has already been played.

Forward search/ Reverse search

Press and hold **◀◀▶▶** during playback.



Reverse search Forward search

- When the all-track repeat mode (see below) is set, it is also possible to search the memory from the final track to the first track.
- In the random play mode (see below), it is not permitted to search disc into a track which has already been played.

Selecting track

1 Press **▶/■** during playback.



Playback is stopped.

2 Press **◀◀▶▶** to select a track.



To skip backward To skip forward

3 Press **▶/■** to play the selected track.



- If you hold the key depressed in step 2, the track numbers can be varied in sequence.
- When the unit is left untouched for more than about 10 seconds after playback is stopped or a track is selected, the unit will be turned off automatically.

Preparation

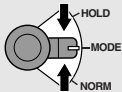

Set the MODE switch knob to "MODE".

Repeat playback

Random playback

Press **VOLUME -** during playback.



(VOLUME button)

In the playlist play mode (see below), repeat or random playback plays only the tracks in the selected playlist.

Each press alternates:

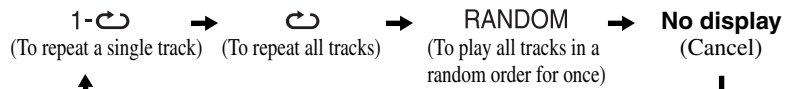

Selecting the sound

Press **VOLUME +** during playback.



(VOLUME button)

Each press alternates:

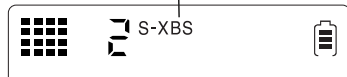
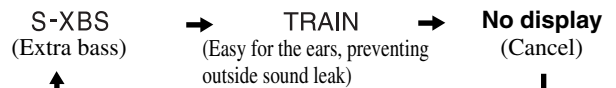

Playlist playback

RealJukebox® does not support the playlist playback.

1 Press **▶▶** during playback.



Number of playlists

The clock/playlist setting mode starts.

2 Press **▶▶**.



3 Press **VOLUME +/-** to select a playlist number.



Playlist No. Total play time

Total number of tracks

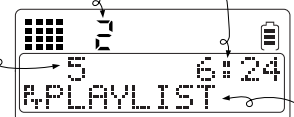

Playlist title

Tracks in the selected playlist will be played automatically.

- If you selected a playlist in stop mode, press **▶/■** to start playback.
- To return to all-track play mode, select "▶▶" (default Playlist) in step 3.
- To cancel the above procedure in the middle, set the MODE switch knob to "NORM" any time you want.

After setting

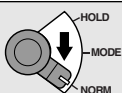

Set the MODE switch knob to "NORM".

Adjusting the clock

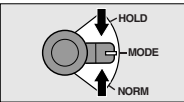
- 

Set to "MODE" during playback.
To cancel the following procedure in the middle, set the switch knob to "NORM" any time you want.
- 

Press ►►.
The unit enters the clock/playlist setting mode.

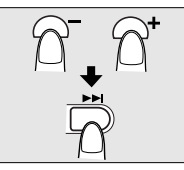
- 

Select "TIME?".
Press ►►.
The unit enters the clock setting mode.

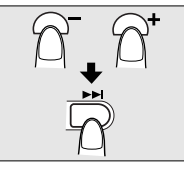
- 

Select either display mode.
12-hour or 24-hour?
Press ►►.

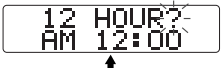
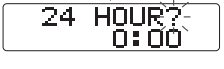
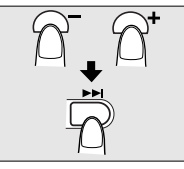

- 

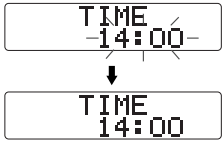
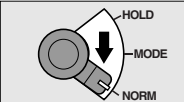
Adjust the time.
Press ►►.
Count of time starts.

- 

Set to "NORM".

The clock is displayed for about 2 seconds when either operation below is performed.

- When the MODE switch knob is set to "HOLD" during playback.
- When ►/■ is pressed while the unit is in the hold mode.

To maintain the accuracy of clock, it is recommended to adjust the time of the day periodically.

Adjustment and Switching of Display Panel

Adjusting the contrast

- Set the MODE switch knob to "HOLD" during playback.
- While holding ►/■ depressed, adjust contrast by pressing VOLUME + (to brighten) or - (to darken).
- Set the MODE switch knob to "NORM".

Switching the displayed information

- Set the MODE switch knob to "MODE" during playback.
- Press ◀◀ to switch information.

- When a track title, playlist title or artist information is too long to be displayed once, it is displayed by scrolling (moved toward the left).
- This unit may not be capable of displaying certain letters such as Chinese characters.

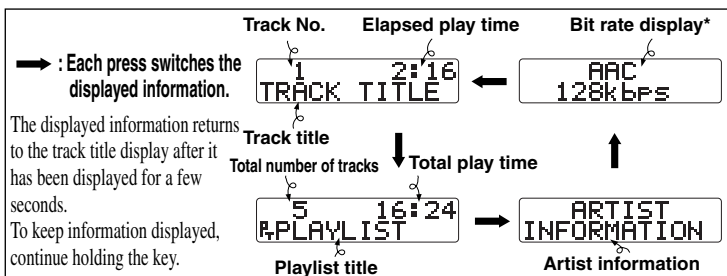

* The above bit rate display is an example with a track recorded in the AAC format. With the track recorded in the MP3 format, the display becomes as shown on the right.



- Set the MODE switch knob to "NORM".

Controls

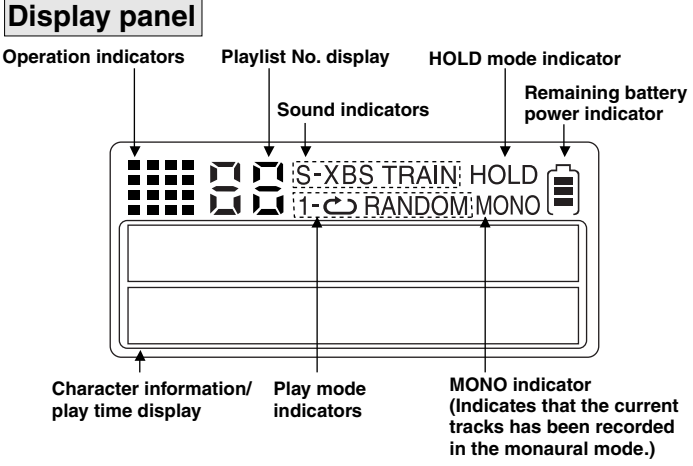
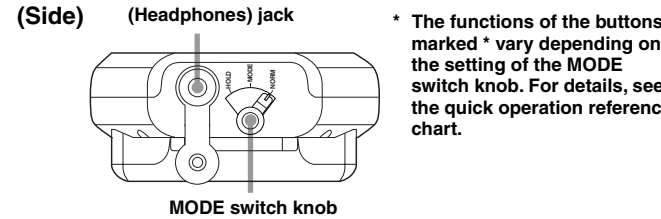
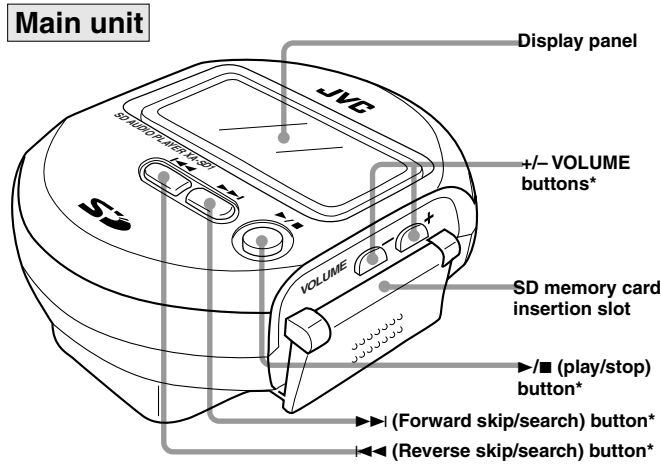

Battery charger (AC-R129)

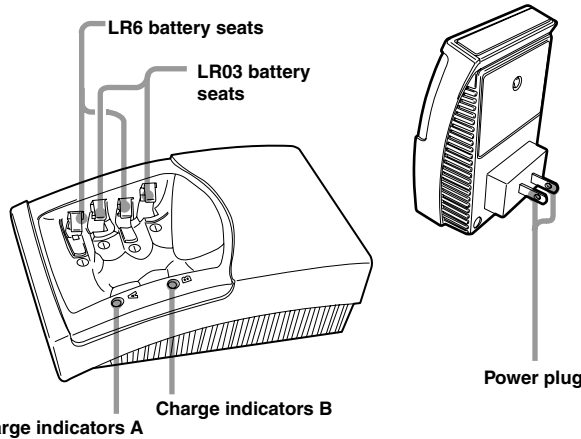

JVC SD Audio Player XA-SD1 Quick Operation Reference for Each Mode

MODE Control Position	◀◀	►►	▶/■	◀	▶
NORM	Skip/Fast Reverse	Skip/Fast Forward	Play/Stop	Volume Down	Volume Up
MODE	Display change	Clock/playlist setting mode	Play/Stop	Play mode change	Sound change
	Cancel selection	Enter selection	Selection in clock/playlist setting mode		
HOLD			Clock		

Cautions

Before using this unit, be sure to read the applicable items of the operating instructions and these safety-suggestions carefully. Afterwards keep them handy for future reference. Take special care to follow the warnings indicated on the unit itself as well as in the operating instructions.

Safety

1. **Care of battery charger** - Never take hold of the battery charger if your hand is wet, and always grasp the plug body when connecting or disconnecting it.
2. **Nonuse Periods** - When not in use, be sure to disconnect the battery charger from the AC power outlet.
3. **Batteries** - If the set is not used for a long period of time, remove all the batteries to prevent potential damage due to possible battery leakage. Do not mix batteries (old and new) or different types of batteries.

Installation

Placement

1. **Foreign Material** - Care should be taken so that objects do not fall into and liquids are not spilled into the unit. Do not subject this unit to excessive smoke, dust, mechanical vibration, or shock.
2. **Magnetism** - The unit should be situated away from equipment or devices that generate strong magnetic fields.
3. **Stacking** - Do not place any objects, on top of the unit.

WARNING:

TO REDUCE THE RISK OF FIRE OR ELECTRIC SHOCK, DO NOT EXPOSE THIS APPLIANCE TO RAIN OR MOISTURE.

CAUTION

This main unit is resistant to spray.

However, this function is inactive in any of the following condition.

- When the cap on the headphones is removed.
- When the card cover or the battery compartment cover is open.

In case the unit is moistened, wipe it with a soft, dry cloth before reusing it. Also take care of the following points.

- Do not leave the unit under high humidity, for example in a bathroom.
- Keep the unit away from direct moistening by tap water etc.
- Do not change the SD memory card or batteries with wet hands. (Otherwise, the water drop may fall from your hand and penetrate inside the unit.)

THE FOLLOWING PHRASES ARE APPLIED ONLY FOR U.S.A.:

This device complies with Part 15 of the FCC Rules. Operation is subject to the following two conditions : (1) This device may not cause harmful interference, and (2) this device must accept any interference received, including interference that may cause undesired operation.

CAUTION!

This equipment has been tested and found to comply with the limits for a Class B digital device, pursuant to Part 15 of the FCC Rules. These limits are designed to provide reasonable protection against harmful interference in a residential installation. This equipment generates, uses and can radiate radio frequency energy and, if not installed and used in accordance with the instructions, may cause harmful interference to radio communications. However, there is no guarantee that interference will not occur in a particular installation. If this equipment does cause harmful interference to radio or television reception, which can be determined by turning the equipment off and on, the user is encouraged to try to correct the interference by one of the following measures:

- Reorient or relocate the receiving antenna.
- Increase the separation between the equipment and receiver.
- Connect the equipment into an outlet on a circuit different from that to which the receiver is connected.
- Consult the dealer or an experienced radio/TV technician for help.

Any unauthorized changes or modifications to this equipment would void the user's authority to operate this device.

Precautions on the unit and SD memory card

To prevent malfunction, do not leave the unit and/or SD memory card in the following locations.

- In a closed automobile (particularly in the summer).
- In a place with high humidity, for example in a bathroom
- In a place with excessive dust.
- In a place subject to direct sunlight or near heating equipment.
- In a place exposed to corrosive gas, etc.

Also avoid the following:

- Disassembly or modification.
- Strong impact, dropping or moistening with rainwater.
- Inserting an object other than an SD memory card into the card insertion slot.
- Using a cracked or deformed SD memory card.
- Applying excessive force when opening the battery compartment cover or card cover.
- Removing the label on SD memory card or attaching another label or sticker on the existing label.
- When the unit is moistened by water, water drops may penetrate the SD memory card insertion slot or behind the card cover. When the unit is moistened, hold it so that the card insertion slot faces downward, open the card cover and wipe off water drops well before inserting or removing the SD memory card. Also be sure to wipe water drops around and inside the headphones jack.

To protect recorded data

- Set the write protect switch on the SD memory card to "LOCK". Do not unlock this switch until the next time you check out (record) or edit the data in the card.
- Do not touch the metallic terminals of the SD memory card with a bare hand or metallic object.

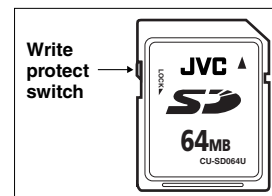

Cautions

Listening caution



Do not play your headphones or earphones at a high volume. Hearing experts advise against continuous extended play.

If you experience a ringing in your ears, reduce volume or discontinue use.

Do not use while operating a motorized vehicle. It may create a traffic hazard and is illegal in many areas.

You should use extreme caution or temporarily discontinue use in potentially hazardous situations.

Even if your headphones or earphones is an open-air type designed to let you hear outside sounds, don't turn up the volume so high that you can't hear what's around you.

Sound can be deceiving. Over time your hearing "comfort level" adapts to higher volumes of sound. So what sounds "normal" can actually be loud and harmful to your hearing.

Guard against this by setting your equipment at a safe level BEFORE your hearing adapts.

To establish a safe level:

- Start your volume control at a low setting.
- Slowly increase the sound until you can hear it comfortably and clearly, and without distortion.

Once you have established a comfortable sound level:

- Set the dial and leave it there.

Rechargeable batteries

- Only the BN-R1213 or HHR-4UP/HHR-4AH (Panasonic) battery can be recharged.
- Recharging already charged batteries will shorten their service life.
- When recharging batteries for the first time or when they have not been used for a long period of time, the play time may be shorter than usual. In a case like this, repeatedly recharge and discharge the batteries. This will restore them to their regular state.
- Do not allow any metal objects to touch the terminals of rechargeable batteries since this may cause short-circuiting which is dangerous.
- The rechargeable batteries and charger equipment may generate heat during recharging. This is not a malfunction.
- If the rechargeable batteries are recharged near a radio receiver, noise may interfere with AM reception.
- The rechargeable batteries should be recharged under an ambient temperature between 10 and 35°C.
- When the rechargeable batteries are not to be used for a long period, recharge them at least every 3 months to prevent degradation of performance.
- When the battery operation time from the fully charged condition drops below half the usual, it is a sign that the service life of the rechargeable batteries has expired. In this case, replace the rechargeable batteries.

WARNING

- Use only JVC chargers designed for BN-R1213.
- Do not disassemble, dispose of in fire, or short circuit.
- Do not remove the covering.

Dry cell batteries / rechargeable batteries

To prevent damage to the batteries and electrolyte leakage, heed the following points.

- Align the ⊕ and ⊖ polarities properly when inserting the batteries.
- Do not mix different types or makers of batteries or old and new batteries.
- Remove the batteries if you do not plan to use the unit for a long period of time.
- Do not throw batteries into a fire, and do not short-circuit, disassemble or subject them to excessive heat.
- Do not attempt to recharge dry cell batteries.

Carrying dry cell batteries / rechargeable batteries around

When putting dry cell or rechargeable batteries in a pocket or bag, ensure that no other metal objects such as a necklace are placed together with them. Contact with metal may cause short-circuiting which, in turn, may cause a fire.

Be absolutely sure to carry the rechargeable batteries in the provided battery carrying case.

When purchasing rechargeable batteries

As a safety precaution, the SD audio players made by JVC have a construction designed to make it impossible to recharge ordinary batteries. To use rechargeable batteries, be absolutely sure to purchase the rechargeable Ni-MH batteries designed especially for this unit.

Special rechargeable Ni-MH batteries:

BN-R1213 (set of 2)

For details, check with your dealer.

Notice about the rechargeable battery

The battery is designed recyclable.
Please follow your local recycling regulations.

When driving a car

In the interest of traffic safety, do not operate the unit while driving.

Messages

NO CARD	No SD memory card is inserted. The SD card is not inserted firmly.
NOT SD CARD	A card other than SD memory card is inserted.
NOT SD AUDIO	The SD memory card does not contain recording of SD audio data.
NO PLAYLIST	No play list has been created.
NO TITLE	The track and play list are not titled.
NO INFO	The artist information is not recorded.
NO TRACK	The play list contains no recording (check-out) at all.
UNFORMAT	The SD memory card is not formatted.
ILLEGAL FORM	The data format is other than specified.
LOCKED	The inserted SD memory card is unusable.
NOT PLAY	The data is not in the AAC or MP3 data. (Displayed in playback)
NOT DISPLAY	The character data are not displayable.
NOT SUPPORT	The data is other than AAC or MP3 data. (Displayed in the bit rate screen)
U01	The battery power is too low to turn the unit on.
ERROR	There is an error. If it cannot be recovered by removing then inserting the card or by turning the unit off then to on again, remove and insert the batteries.

Maintenance

Maintenance of the unit

When the unit gets dirty, wipe with a soft, dry cloth. If it is contaminated seriously, clean with a cloth slightly moistened with light neutral detergent solution then wipe dry with a soft, dry cloth.

- Do not use any type of abrasive pad, scouring powder or solvent such as alcohol or benzine.
- When you want to use a chemical cloth for cleaning, be sure to read carefully and observe its cautions and notes.

Note

This unit is a precision instrument. Do not subject it to a strong impact by hitting or dropping it. Otherwise, the SD memory card may be unlocked or the unit may fail.

Troubleshooting Guide

Before requesting service for this unit, check the chart below for a possible cause of the problem you are experiencing. Some simple checks or a minor adjustment on your part may eliminate the problem and restore proper operation.

If you are in doubt about some of the check points, or if the remedies indicated in the chart do not solve the problem, refer to the directory of Authorized Service Centers (enclosed with this unit) to locate a convenient service center, or consult your dealer for instructions.

Problem	Check this
Cannot play	<ul style="list-style-type: none"> • Is the unit set to the hold mode? • Is the SD memory card inserted? • Are batteries exhausted? (If they are not, remove and insert them again.)
Cannot hear music	<ul style="list-style-type: none"> • Is the volume too low? • Does the selected play list contain no check-out (recording) at all? • Is the headphone plug inserted completely into the jack? (Unplug then plug in again.) • Is the headphone plug dirty?
Tracks on SD card do not play in order	<ul style="list-style-type: none"> • Is random playback activated? • Is a playlist selected?
Too noisy.	<ul style="list-style-type: none"> • Is the unit placed near a TV or cellular phone?

Note

This unit provides versatile operations under the microcomputer control. If the unit cannot be operated properly by pressing any button, remove the batteries and insert them again.

Free Manuals Download Website

<http://myh66.com>

<http://usermanuals.us>

<http://www.somanuals.com>

<http://www.4manuals.cc>

<http://www.manual-lib.com>

<http://www.404manual.com>

<http://www.luxmanual.com>

<http://aubethermostatmanual.com>

Golf course search by state

<http://golfingnear.com>

Email search by domain

<http://emailbydomain.com>

Auto manuals search

<http://auto.somanuals.com>

TV manuals search

<http://tv.somanuals.com>