

JVC

WIDE LCD PANEL TV INSTRUCTIONS

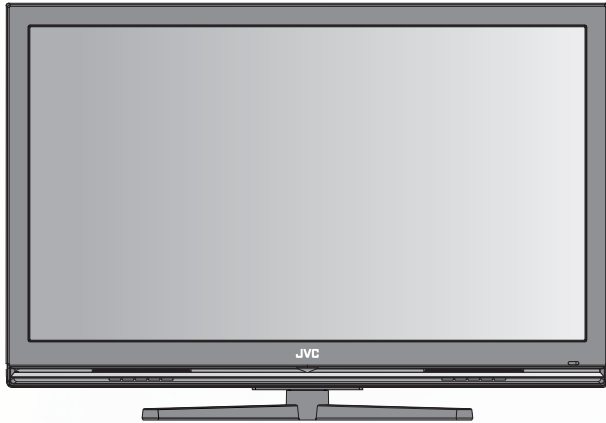

Contents

PREPARATION

Safety precautions.....	2
Remote control buttons and functions.....	3
Set up and connections.....	4
Initial settings.....	6
Registering / Editing channels.....	7
Channel Summary.....	8
Operating the menus.....	9

FUNCTIONS

Picture setting.....	10
Sound setting.....	12
Useful functions.....	14
Multi Media Input.....	16
Viewing Teletext.....	19
Viewing Closed Caption.....	19
Watching Video or DVDs.....	20

REFERENCE

Technical information.....	20
Troubleshooting.....	22
CH/CC List.....	23
Specification.....	24

LT - 42Z10

HDMI™
HIGH-DEFINITION MULTIMEDIA INTERFACE

GGT0359-001A-H

Safety precautions

Thank you for buying this JVC LCD panel television.

To make sure you understand how to use your new TV, please read this manual thoroughly before you begin.

- **Follow this manual regarding setup!**
 - Connect only to a 110-240 V, 50/60Hz AC outlet.
- **Make enough room for inserting and removing the power plug!**
- **Place the TV as close to the outlet as possible!**
 - The main power supply for this TV is controlled by inserting or removing the power plug.
- **Never cut or damage the power cord!**
 - If the AC plug is not the right shape, or the power cord is not long enough, use an appropriate plug adapter or extension cable. (Consult your retailer)
- **Unplug the power cord when going out!**
 - The power buttons on the remote control and the TV unit cannot completely turn off the TV. (Make appropriate arrangements for bedridden people.)
- **Do not allow the TV to fall!**
 - Do not rest your elbows on, or allow children to hang from the TV.
 - There is a risk that the TV will fall and cause injuries.
 - Make use of the hole on the back of the stand to prevent the TV from falling easily.
- **If the TV is damaged or behaving strangely, stop using it at once!**
 - Unplug the power cord and contact your retailer.
- **Never place anything on the TV!**
 - Placing liquid, naked flames, cloths, paper, etc. on the TV may cause a fire.
- **Never expose to rain or moisture!**
 - To prevent fire or electric shock, never allow liquids to enter the unit.
- **Never insert objects into the cabinet openings!**
 - It may cause a fatal electric shock.
 - Take care when children are near.
- **Hold the TV so as not to scratch the screen!**
 - Do not touch the screen when carrying the TV.
- **Do not carry the TV on your own!**
 - In order to prevent accidents, ensure that the TV is carried by two or more people.
- **Never insert the power cord by wet hand!**
 - It may cause a fatal electric shock.
- **Keep the TV set away from direct sunlight!**
 - TV set can be damaged.
- **For more details on installation, usage and safety → Consult your retailer.**
- **Place the TV set in a neat and dry place. Do not place the product close to source of steam, heat, moisture or oil. Because it may cause a fire hazard or electric shock hazard!**
- **Don't touch an external metal part of the TV set!**
 - It may cause an electrocuted.
- **For keep a distance from potential ignition sources to the components or part in side TV set, customer should install TV set with a stand within ± 10 perpendicularly degree.**
- **Never dismantle the rear panel!**
 - It may cause an electric shock.
- **Never obstruct the ventilation holes!**
 - It may cause overheating or a fire.
- **Handle LCD panel with care!**
 - Use a soft, dry cloth when cleaning.
- **Never try repair the TV yourself!**
 - If the problem cannot be solved in "Troubleshooting" unplug the power cord and contact your retailer.
- **If a television is not positioned in a sufficiently stable location, it can be potentially hazardous due to falling. Many injuries, particularly to children, can be avoided by talking simple precautions such as:**
 - Using cabinets or stands recommended by the manufacturer of the television.
 - Only using furniture that can safely support the television.
 - Ensuring the television is not overhanging the edge of the supporting furniture.
 - Not placing the television on tall furniture (for example, cupboards or bookcases) without anchoring both the furniture and the television to a suitable support.
 - Not standing the television on cloth or other materials placed between the television and supporting furniture.
 - Educating children about the dangers of climbing on furniture to reach the television or its controls.
- **To prevent accidents, firmly attach the TV stands to the TV shelf before using microphone.**
- **Make sure that the subwoofer is in good condition before installing it on the TV.**
 - If the subwoofer has leakage current, it may damage the TV or cause electric shock.

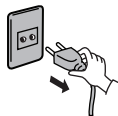
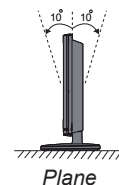

WARNING:

To prevent the spread of fire, keep candles or other open flames away from this product at all times.



Remote control buttons and functions

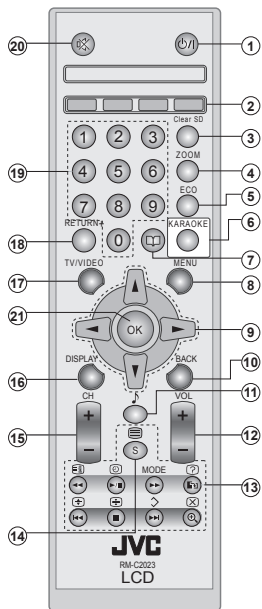

- ① Power On / Off
- ② Colour buttons
- ③ Turn on "Clear SD"
- ④ Turn on "Zoom"
- ⑤ Turn on "Eco Sensor"
- ⑥ Turn on "Karaoke"
- ⑦ Favourite channel setting
- ⑧ Display on-screen menu
- ⑨ Operate the menu
- ⑩ To previous screen
- ⑪ Turn on "Sound Meister"
- ⑫ Volume control / Turn off muting
- ⑬ Function for viewing Teletext and "Multi Media Input"
- ⑭ To Teletext

- ⑮ Change channel / Page / Hyper Scan
- ⑯ Channel information
- ⑰ Select the input Source (P.20)
- ⑱ Return Plus / Return function
- ⑲ Change channel / Page
- ⑳ Turn the volume off / on
- ㉑ Turn on "Freeze" / Setup data

Zoom : Change the aspect ratio.

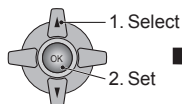
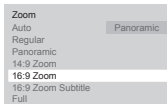

V-Scroll

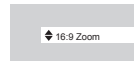

Move the picture with ▼ or ▲ while this bar is displayed.

Hyper Scan :

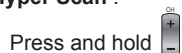

Press and hold . PR changes without changing the picture screen. Once you release the button, the picture of the selected PR will appear.

Return Plus : Return to the frequently viewed channel

Return Plus Programmed by select the frequently viewed channel then press and hold .

Return Plus Canceled by press and hold .

Return : Return to the previously viewed channel.

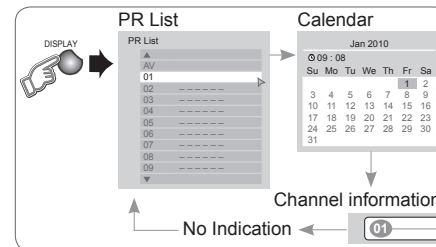

- Insert the batteries
Use two "AAA/R03" dry cell batteries. Insert the batteries from the ⊖ end, making sure the ⊖ and ⊕ polarities are correct.



Favourite channel setting.

1. Register the favourite channel



Press and hold
Programmed! will be displayed.

Press
number
button
(1-4 only)

2. Recall the favourite channel



Press

- If the favourite channel has not been registered then "No memory" will be displayed.

WARNING:

Batteries shall not be exposed to excessive heat such as direct sunshine, fire or the like.



If this symbol is shown, it is only valid in the European Union.

Set up and connections

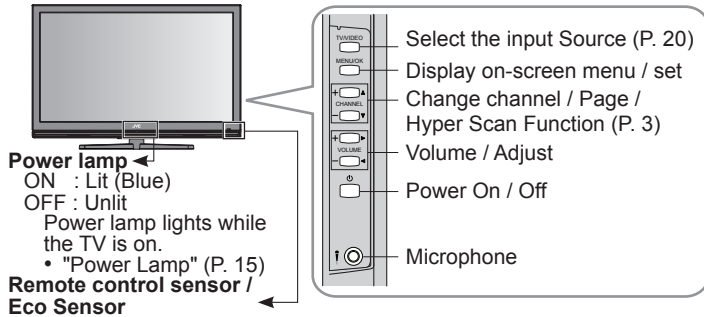

Care when setting

■ Power requirements

- Connect the power cord only to a 110-240V, 50/60Hz AC outlet.

■ When attaching the TV to the wall, use the optional JVC wall mounting unit

- Consult a qualified technician.
- JVC assumes no responsibility for damage due to improper mounting.
- 400 mm x 200 mm mount which conforms to VESA standards.

■ Installation requirements

- To avoid overheating, ensure the unit has ample room.

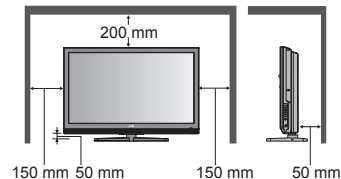

- If the microphone is installed, should be lock it's cable follow picture.

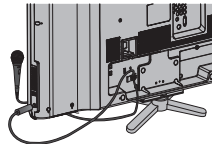

- To prevent the TV from falling thread the belt through the hole on the back of the stand and secure it to the TV rack.

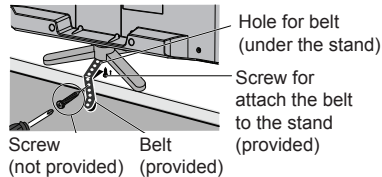

Connect an aerial and VCR / DVD Player

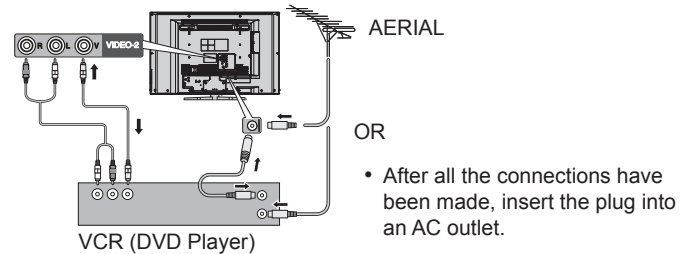

Stand Assembly

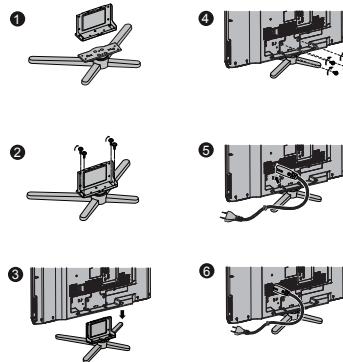

Change the direction of TV

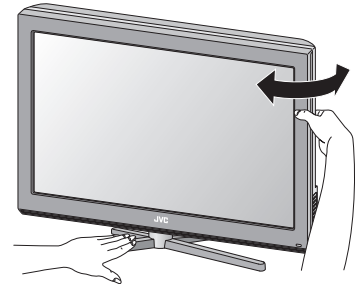

Set up and connections (continued)

You can connect many different devices to the rear panel of the TV. Please read the user manuals of each device before setup. (Connecting cables are not supplied with this TV.)

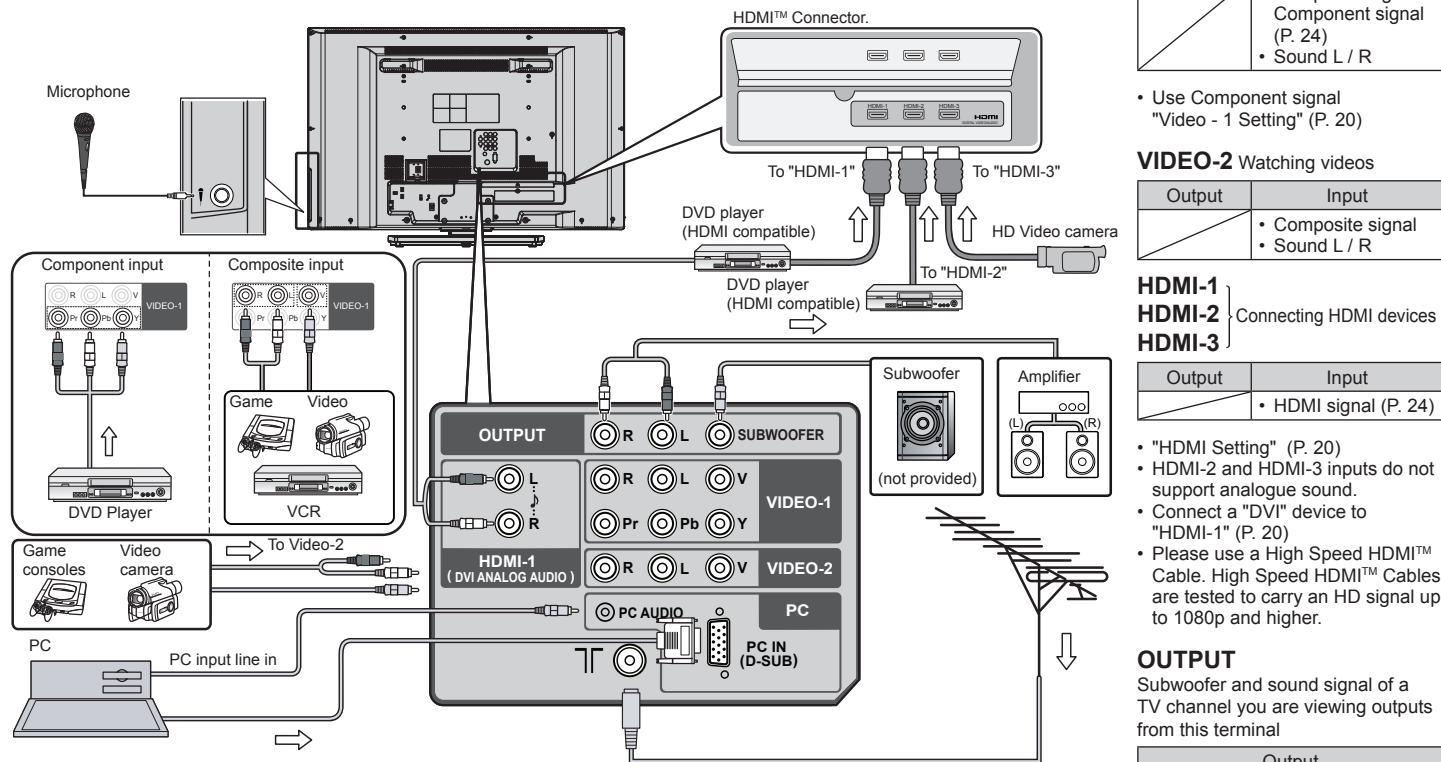

- Check for PC compatibility.
- "PC signals that can be displayed" (P. 21)

Initial Settings

1 Turn on the TV.



JVC logo appears

- Show only when powering on for the first time.
- The power on the unit can also be used.
- The select the new Country Area after Initial Setting has completed.

(While the cursor is pointing to Picture menu and hold for 3 seconds.)

2 Select a language.

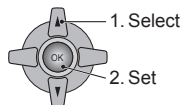
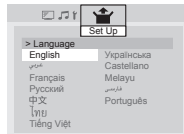

3 Select Country Area.

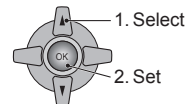

Area-1 : Asia, Middle East, Europe, Oceania, Africa
Area-2 : South America, Philippines

If you select Country Area to "Area-1"

4 Select the Teletext language group.

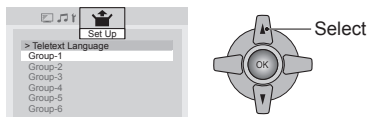

- See "Language group for Teletext" (P. 21).

5 Automatically register channels (Auto Program).

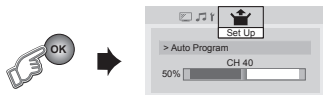

6 Check what was registered.

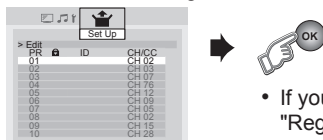

- If you want to edit channel, see "Registering / Editing channels" (P. 7)

If you select Country Area to "Area-2"

4 Select Air or Cable.

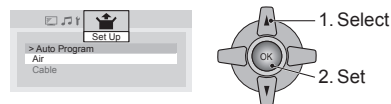

5 Searching for the channels (Auto Program).

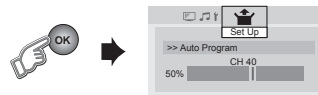

6 Check what was registered.

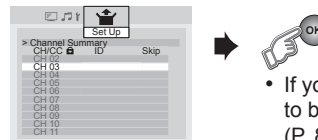

- If you want to set undesired channels to be skipped, see "Channel Summary" (P. 8)

Registering / Editing channels

This function is available when select Country Area to "Area-1" only.
You can edit the channel list or register new channel manually.

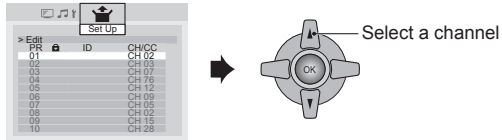

Move Move a channel position.

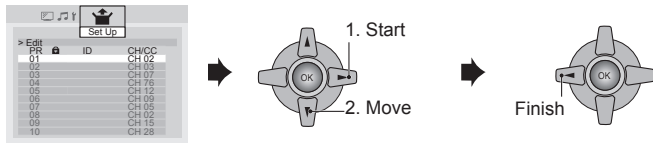

ID Edit a channel name

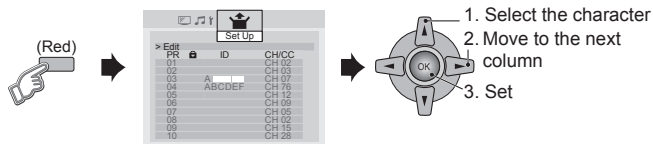

Insert / Delete Insert / Delete a channel

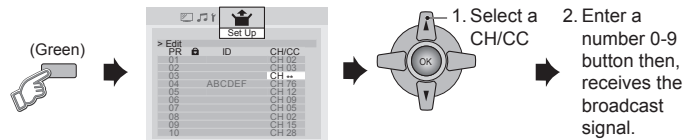

- Delete a channel by press (Yellow) button.
- "CH/CC List" (P. 23)

Manual Register a new channel

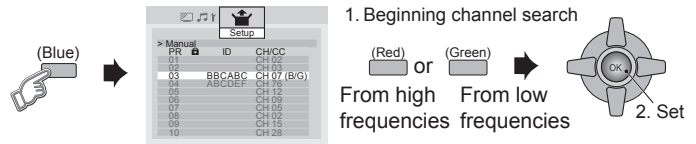

- Channel fine tuning ⇒ (Yellow) / (Blue)
- If the picture or sound is unnatural ⇒ (Yellow) for select a system.

Channel Summary

This function is available when select Country Area to "Area-2" only.
You can edit the channel list.

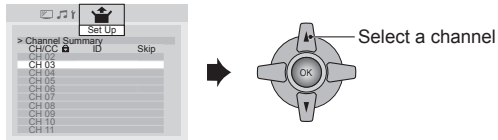

Skip Skip the channel.

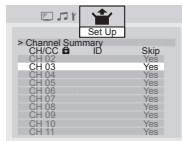

Cancel Cancel the skip channel.

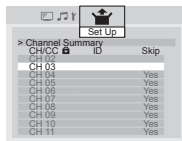

ID Edit a channel name.

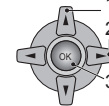
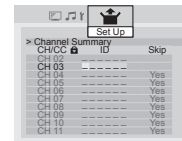

- Channels are to be skipped cannot be selected by the CHANNEL +/- button.
- The skip can be set to all channels of Air (CH02 - CH69) and Cable (CC01 - CC125)

Operating the menus

You can select the Country Area between Area-1 and Area-2. See in item 3 of "Initial setting" (P. 6)
See the menus location in the below table.

Set Country Area to "Area-1"			
Top Menu	2nd Menu	Page	
Picture	Picture Mode	10	
	Backlight	10	
	Contrast	10	
	Brightness	10	
	Sharpness	10	
	Colour	10	
	Tint	10	
	White Balance	10	
	Features	11	
	Sound	Stereo / I+II	12
		-	-
Sound Meister		12	
Treble		12	
Bass		12	
Surround		12	
Balance		12	
Voice Enhancer		12	
AI Volume		12	
Subwoofer Out		13	
Subwoofer Level		13	
Karaoke		13	
Features		On Timer	14
	Sleep Timer	14	
	Calendar	14	
	Channel Guard	14	
	Blue Back	15	
	Child Lock	15	
	Auto Shutoff	15	
	Favorite Setting	15	
	Power Lamp	15	
	Eco Sensor	15	
	Set Up	Auto Program	6
		Edit / Manual	7
		-	-
Language		6	
Video-1 Setting		20	
Rocket Start		15	
Teletext Language		6	
HDMI Setting		20	
PC Setting		20	
-		-	

Set Country Area to "Area-2"			
Top Menu	2nd Menu	Page	
Picture	Picture Mode	10	
	Backlight	10	
	Picture	10	
	Brightness	10	
	Detail	10	
	Color	10	
	Tint	10	
	White Balance	10	
	Features	11	
	Sound	-	-
		MTS	12
Sound Meister		12	
Treble		12	
Bass		12	
Surround		12	
Balance		12	
Voice Enhancer		12	
AI Volume		12	
Subwoofer Out		13	
Subwoofer Level		13	
Karaoke		13	
Features		On Timer	14
	Sleep Timer	14	
	Calendar	14	
	Channel Guard	14	
	Blue Back	15	
	Child Lock	15	
	Auto Shutoff	15	
	Favorite Setting	15	
	Power Lamp	15	
	Eco Sensor	15	
	Set Up	Auto Program	6
		-	-
		Channel Summary	7
Language		6	
Video-1 Setting		20	
Rocket Start		15	
-		-	
HDMI Setting		20	
PC Setting		20	
Closed Caption		19	

Picture setting

1. Display "Picture" menu

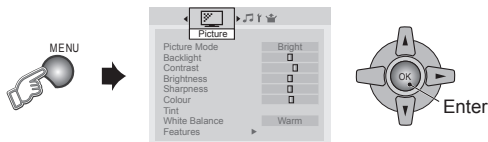

2. Select item and setting or adjust

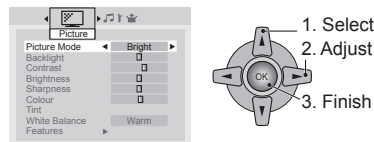

• To enter an items menu

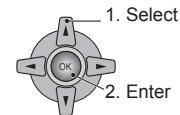

Picture Mode	<p>You can select a preset picture setting according to your favour.</p> <p>Bright : Hightens contrast and sharpness. Game Mode : Adjust sharpness of the picture when play the game. Soft : Softens contrast and sharpness. Standard : Standardize picture adjustment.</p>
Backlight	<p>You can change the backlight brightness. Darker ↔ Brighter</p>
Contrast	<p>You can change the contrast of the picture. Lower ↔ Higher</p>
Brightness	<p>You can change the brightness of the picture. Darker ↔ Brighter</p>
Sharpness	<p>You can change the sharpness of the picture. Softer ↔ Sharper</p>
Colour	<p>You can change the colour of the picture. Lighter ↔ Deeper</p>
Tint	<p>You can change tint only in NTSC. Reddish ↔ Greenish</p>
White Balance	<p>You can change the white balance of the picture to better match the type of video being view.</p> <p>Mid : Normal white colour. Cool : Bluish white colour. Warm : Reddish white colour.</p>

Picture setting (continued)

Features

Finer Picture adjustment

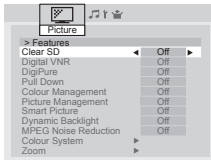

Clear SD : For clearly picture (Off / Mode-1 / Mode-2)
When Clear SD set to Mode-1 or Mode-2, then Digital VNR, DigiPure, Picture Management and MPEG Noise Reduction cannot operate.

Digital VNR : Reduce the amount of noise in original picture. (Off / On)

DigiPure : For natural - looking outlines (Off / On)

Pull Down : For smooth cinema film (Auto / Off / On)

Colour Management : For natural - looking pictures (Off / On)

Picture Management : Fix bright / dark pictures. (Off / On)

Smart Picture : Make it easier to view white areas (Off / On)

Dynamic Backlight : Reduce the brightness of the backlight when the screen is dark. (Off / On)

MPEG Noise Reduction : Reduce MPEG video noise. (Off / On)

Colour System : When there is no colour, change the colour system.
: (Area-1 : PAL / SECAM / NTSC 3.58 / NTSC 4.43 / Auto, Area-2 : PAL-M / PAL-N / NTSC / Auto)

Zoom : Change the aspect ratio.

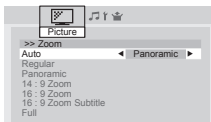

Panoramic

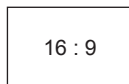

Regular/Slim



14:9 Zoom



- When 720p or 1080i or 1080p signal is received, "Full", "Slim" and "Panoramic Zoom" can be selected.
- In PC mode, "Regular" and "Full" can be selected.

Sound setting

1. Display "Sound" menu.

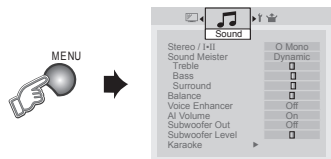

2. Select item and setting or adjust.

- Set Country Area to "Area-1"
- Set Country Area to "Area-2"

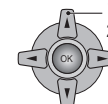
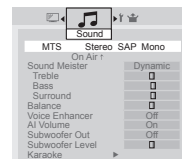
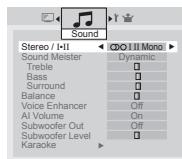

Stereo/I•II	Select the broadcast sound stereo, mono or bilingual. (○: Mono / ◯: Stereo / I : SUB1 / II : SUB2 / Mono)
MTS	Select the stereo and SAP broadcasted programs. (Stereo : Stereo sound / SAP : Second Audio Programs / Mono : mono sound)
Sound Meister	Ambience (Off / Dynamic / Pure / Living)
Treble	Compensates high frequencies to widen the frequency band. (Weaker ↔ Stronger)
Bass	Compensates low frequencies to widen the frequency band. (Weaker ↔ Stronger)
Surround	Expands the stereo sound naturally. (Narrow ↔ Wide)
Balance	Speaker balance (Left Stronger ↔ Right Stronger)
Voice Enhancer	Sound enhancement technology. (Off / On)
AI Volume	Prevent sudden increase or decrease of sound when changing channels. (Off / On)

Sound setting (continued)

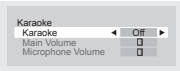
Subwoofer Out	<p>Chooses to connect subwoofer. (Off / On)</p> <ul style="list-style-type: none">• Subwoofer to be used must have a built-in amplifier.
Subwoofer Level	<p>Adjusts sound level of your subwoofer. (Lower ↔ Louder)</p> <ul style="list-style-type: none">• When Subwoofer Out set to On, you can adjust Subwoofer Level.
Karaoke	<p>You can enjoy to reduce the vocals for your own karaoke.</p>   <p>Karaoke Chooses to reduce the vocals.</p> <p>Off : Normal sound of song</p> <p>Mode-1 : Only sound of music</p> <p>Mode-2 : To sing, accompanying with sound of song.</p> <ul style="list-style-type: none">• Karaoke function works only for stereo sound system.• If using Karaoke disc, users must choose to remove the vocals from the player. <p>Main Volume Adjusts volume level. (Lower ↔ Louder)</p> <p>Microphone Volume Adjusts volume level of microphone. (Lower ↔ Louder)</p> <ul style="list-style-type: none">• Microphone Volume is available when plug in microphone.• Microphone to be used with the "Karaoke" function of JVC must be of "HIGH GRADE LOW NOISE MICROPHONE CABLE" type; otherwise, noise will result.

Useful functions

1. Display "Features" menu.

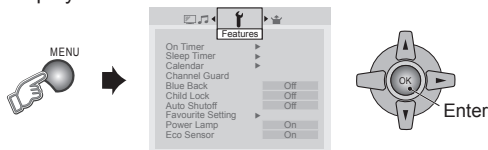

2. Select item and setting or adjust.

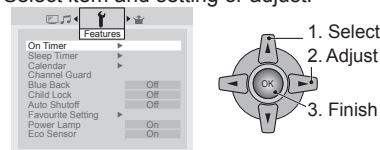

• To enter an items menu

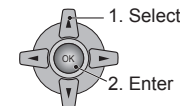

On Timer

TV to turn on automatically from standby mode at a set channel and time.

1. Select PR channel that you want to watch.



2. Set the On time to your desired period at time.

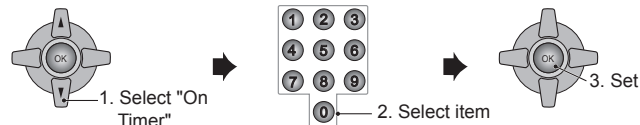

Note : Press for reset time setting.

Sleep Timer

TV to turn off automatically to standby mode after a set time.

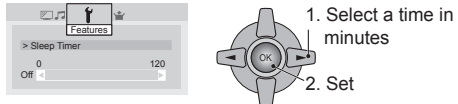

Note : When the remaining elapse is one minute, "Good Night!" appears on the screen.

Calendar

Watch calendar, date and time on screen LCD TV.

1. Select "Calendar" to On. 2. Set "Time" and "Date".

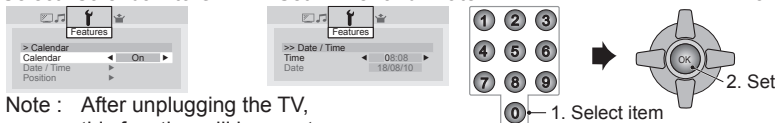

3. Set "Position" for adjust screen position.

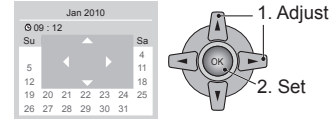

Note : After unplugging the TV, this function will be reset.

Channel Guard

Stop children from watching specific channels.

1. Select "Channel Guard".

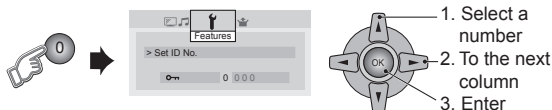

2. Select a channel and lock it (🔒 : locked).

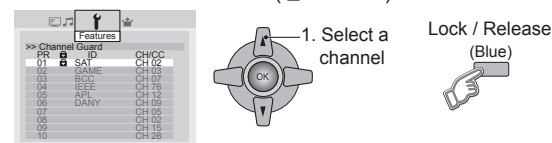

• View a locked channel by use the numerical buttons to enter the channel number. When 🔒 appears, press "DISPLAY" button and enter your "ID No."

Useful functions (continued)

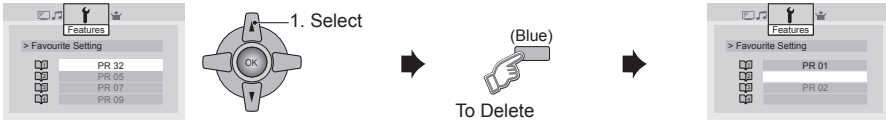
Blue Back	Display a blue screen and mute the sound when the signal is weak or absent. (Off / On)
Child Lock	Disables the side control buttons of the TV. (Off / On)
Auto Shutoff	Set the power to turn off if no signal is received and no operation is performed for about 15 minute. (Off / On)
Favourite Setting	<p>Delete the favourite channel that you registered.</p> 
Power Lamp	Power lamp lights while the TV is on. (Off / On) (P. 4)
Eco Sensor	<p>Automatically adjusts the picture contrast according to the brightness of your room to reduce power consumption.</p> <p>Off : Deactivates the function</p> <p>On : Activates the function.</p> <p>Demo : Only sound is available, no picture (this is to save energy in such situation as when you want to listen to the news while doing other house works at the same time).</p> <p>MAX-Eco : Only sound is available, no picture (this is to save energy in such situation as when you want to listen to the news while doing other house works at the same time).</p> <ul style="list-style-type: none"> - After choosing Eco Sensor as Max-Eco, picture will go off in 3 seconds. - When you want the picture to appear again, press any button on the remote control then function will be reset back to "Off". - After unplugging the TV or press "Power off" button, this function will be reset back to "Off"

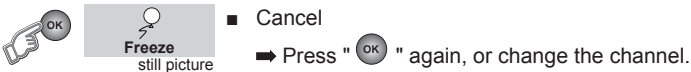
Freeze	<p>Take snapshots of the screen.</p>  <ul style="list-style-type: none"> • You cannot save or export the snapshot. • Freeze function is not available for HDMI, PC and Component signal.
--------	--

"Set up" Menu

Rocket Start	<p>TV can turn on quickly. (Off / On)</p> <p>When Rocket Start is On, power consumption at standby mode will more than normal standby mode.</p>
--------------	---

Multi Media Input

Allows you to enjoy pictures, musics, movies and text files stored on your USB device or SD card you have connected to the terminal of the TV.

Cautions

- Insert or remove SD cards and USB devices gently and in the right direction.
Otherwise, the devices or the TV may be damaged.
- It is recommended to keep a backup of your files.
- Do not connect a mouse, keyboard or the like.
- Do not use a USB hub or extension cable.

- 1** Insert an SD card / USB device into the SD card slot / USB terminal on the side of the TV.
TV will auto detect and display signals in accordance with Article 3 automatically.

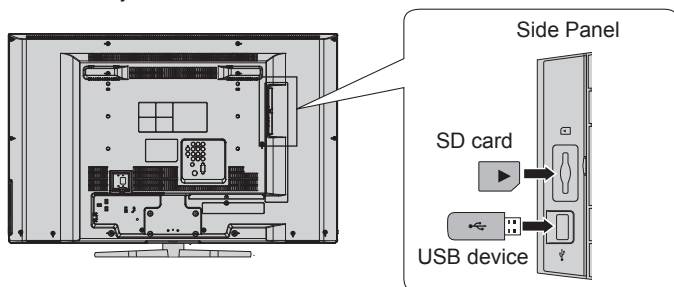

- Slide the SD card into the slot until it clicks into place.
- To remove the SD card, push it in until it clicks and then pull it out

- 2** When you change the channel to see other signals. You want to view files from USB or SD card again, you have to set the input to "1 SD / USB".

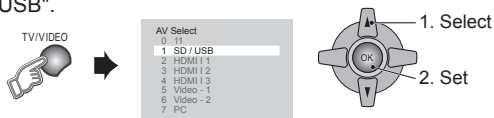

- 3** Select "SD/MMC" or "USB"

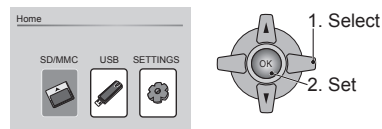

If you want to setting, select "SETTINGS"

Slideshow duration Select how long each picture is displayed for during slide shows. (3S / 5S / 15S / 1mins / 15mins / 1hour)

Slideshow mode Select the format for displaying pictures in slide show mode. (off / Bottom To Top / Top To Bottom / Left To Right / Right To Left / Door Close / Door Open / Hori Cross / Verti Cross / Random / Fading)

Music repeat mode Select Repeat to play musics. (Repeat All / Repeat One)

Movie repeat mode Select Repeat to play movies. (Repeat All / Repeat One)

Default Return to the default.

The icon device in Home menu will be displayed according to the device you have connected (SD/MMC or USB).

Multi Media Input (continued)

4

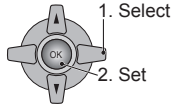
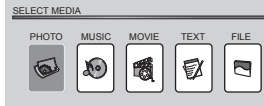

- PHOTO** View picture from your USB device or SD card.
- MUSIC** Listen music from your USB device or SD card.
- MOVIE** Watch movie from your USB device or SD card.
- TEXT** View (*.txt) file from your USB device or SD card.
- FILE** Copy or delete your files in USB device or SD card.

SD card and USB can support files as

- PHOTO : JPEG, PNG, BMP, GIF
 - MUSIC : MP3, WMA, WAV
 - MOVIE : MPEG1, MPEG2, MPEG4, RMVB
 - TEXT : Text
- MOVIE file ; Supported up to 720 x 576 x 24 or 800 x 600 x 30 compressed video resolution (SD mode)

Buttons for Multi Media

- Select audio language in MOVIE
Play music while viewing PHOTO
- Select previous / next chapter
- Rewind
- Stop
- Play / Pause
- Zoom
- Forward
- Menu bar to control playback.
- Rotate photo 90°

5.1 PHOTO

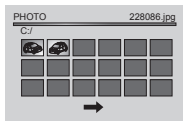

Select a photograph to display, and press or . The selected photograph is displayed full-screen.

- Some files may be displayed with bands around the edges.
- To see the next / previous file, press / .
- To exit the full-screen display and show the folder index, press .
- The thumbnails of some files may not be shown.
- This TV can only display file names as alphabetical letters.
- Photographs with large file-sizes may take a while to be displayed.
- This TV can not play some files. Including files that are changed on the PC, even a file format is compatible. Depending on the specifications of the file.
- To listen to music during a slideshow, press .
- (Music file must exist in your USB or SD card)
- If the image displayed within more than one full screen. Arrows are shown at the bottom of the screen to choose to display the next / previous screen.
- Press to display the control operation bar, select left or right button for choose operations, then press .

5.2 MUSIC



- Once the music is selected, It will be run automatically. The detail of that song will be shown inside the frame on the right. After finish that song, the next will be played accordingly.
- To play or pause the song, just press or .
- To control the sound volume, just use VOL +/- button or press to silent mode.
- Press or to stop the music.
- To show the files in a folder, press on the folder.

Multi Media Input (continued)

5.3 MOVIE

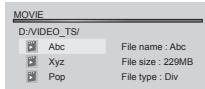

- When the movie file is selected the highlight bar, the detail of that movie will be shown inside the frame on the right.
- To play or pause the movie, press **OK** or **▶/⏸**.
- To control the sound volume, use the VOL +/- button or press **OK** to silent mode.
- Press **OK** to enlarge the picture with double, 4 times, 8 times and 16 times.
- Press **S** to select audio language (if your file have many audio languages)
- Press **DISPLAY** to display the control operation bar, select left or right button for choose operations, then press **OK**.

5.4 TEXT

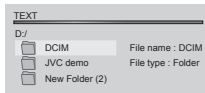

- To show the file in a folder, press **OK** on the folder.
- Use Up / Down button to move the highlight bar to the file to be opened, then, press **OK** to open.
- Press **BACK** or **EXIT** button to exit from the Text which being run and back to the Text list.

5.5 FILE

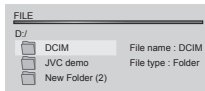

- To show the file in a folder, press **OK** on the folder.
- Use Up / Down button to move the highlight bar.
- Press right arrow button or **OK**, you can enter into the file you chose.
- Press the left arrow button, you can exit and back to previous status.

Copy (file)

1. Move the highlight bar to the file that you want to copy.
2. Press right arrow button, then a remark will be showed on the right of the file you selected.

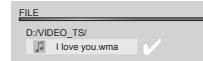

3. To make another copy, just repeat the step of No.2.
4. After file is selected, press **DISPLAY**. Then, indication of [Copy] and [Delete] to be seen.

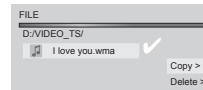

5. Select [Copy] then press **OK**, you will enter to the next stage. Select the drive C: or D: that you want to copy the files stored. Press right arrow button for copy selection to inside folder.



6. After selection, press **OK** to start the process when finished press **OK** again.

Delete (file)

1. Move the highlight bar to the file you want to delete.
2. Press right arrow button, then a remark will be showed on the right of the file you selected.

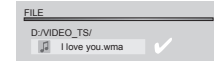

3. To make another delete, just repeat the step of No.2.
4. After file is selected, press **DISPLAY**. Then, indication of [Copy] and [Delete] to be seen.

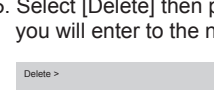

5. Select [Delete] then press **OK**, you will enter to the next stage.
6. Select [**✓**] to Delete. (If you want to cancel delete select [**X**])
7. Press **OK** when finished press **OK** again, The file that you delete is disappear.

About SD cards and USB devices.

- When using miniSD cards or microSD cards, put them in an appropriate adapter before inserting them into the TV.
- Not all SD cards or USB devices are guaranteed to work on this TV.

Viewing Teletext

This function is available when select Country Area to "Area-1" only.
This TV can display TV broadcasts and Teletext on the same channel in two windows.

-
- Select a Teletext page by press number button (0-9).
 - Move up or down a page by .

List Mode	<p>Bookmark your favourite page.</p> <p>MODE (Red) (Green) (Yellow) (Blue)</p> <p> to bookmark</p> <p> Press number button for enter the Save number of page.</p> <ul style="list-style-type: none"> • Recall your favourite page by press the colour button.
Hold	<p> Hold the current page.</p> <ul style="list-style-type: none"> • Cancel by press this button again.
Reveal	<p> Display hidden information.</p> <ul style="list-style-type: none"> • Example : answer to a quiz, etc.
Size	<p> Double the size of the displayed text.</p>
Index	<p> Returns to page "100" or a previously designated page.</p>
Cancel	<p> Leave the current page open, while you switch to watch TV.</p> <ul style="list-style-type: none"> • Useful when running a page search.
Sub-page	<p> Display the number of Sub-page.</p> <ul style="list-style-type: none"> • Cancel by press this button again.

Viewing Closed Caption

- Select "Set Up".

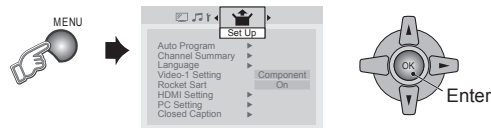

- Select "Closed Caption".

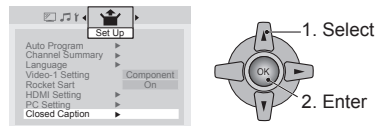

- Select the desired caption or text channel.

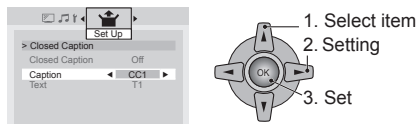

- Closed Caption : Select to view close caption or text information.
(Off / CC / Text)
- Caption : Select the desired caption.
(CC1 / CC2 / CC3 / CC4)
- Text : Select the desired text channel.
(T1 / T2 / T3 / T4)

Watching Video or DVDs

Select the input Source.

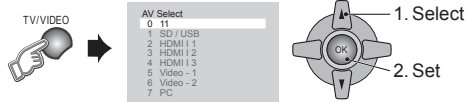

• Operate the connected device and play video.

1. Select "Set Up".

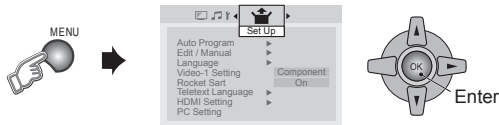

2. Select item.

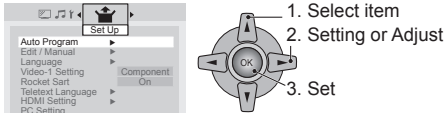

Video - 1 Setting

Switch between video and component signal.
(Video / Component)

HDMI Setting

Setting for HDMI input

Size : Normally set to "Auto." If wrong screen size appears in 480p (525p), change to "1" or "2".

Audio : Normally set to "Auto." If no sound, change to "Analogue" or "Digital".

Mode : If no picture, change to "1" or "2".

PC Setting

Setting for PC input

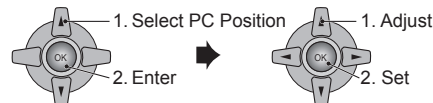

PC Position : Adjust screen position.

Phase : Sets the focus of screen.

Pixel : Adjusts the horizontal feature of screen.

Technical information

Connect "DVI" devices

Connect a "DVI" device to "HDMI" using "DVI-HDMI" conversion cable. Connect analogue sound output of the DVI device to L and R terminals in HDMI-1.

- Set "Audio" in "HDMI Setting" to "Analogue" or "Auto".
- HDMI-2 and HDMI-3 input does not support analogue sound (IN HDMI-1).
- HDMI-2 and HDMI-3 input does not support DVI devices.

What is "Full Native" ?

- With the full HD LCD display and "Full Native", you can enjoy full native HD resolution of 1920 x 1080. It exposes flaws in the video that were hidden when viewing on "Full".



Full



Full Native

- The illustrations are emphasised to make clear differences between "Full" and "Full Native".
- Dark bar or noise may appear at the edges of the screen when viewing in "Full native" for some videos. This is resulted from the signal itself, not due to TV malfunction.

Technical information (continued)

Language group for Teletext

Group	Languages
Group-1	Turkish, Hungarian, English, German, French, Italian, Spanish, Portuguese, Greek, Swedish, Finnish
Group-2	Polish, Serbian, Croatian, Slovenian, Czech, Slovak, Rumanian, Hungarian, German, French, Italian, Swedish, Finnish
Group-3	Russian, Bulgarian, Lettish, Lithuanian, Estonian, Ukrainian, Serbian, Croatian, Slovenian, Czech, Slovak, English, German
Group-4	Arabic, Czech, Slovak, Hungarian, English, German, French, Italian, Spanish, Portuguese, Swedish, Finnish
Group-5	Farsi, English, French, Turkish
Group-6	Lettish, Lithuanian, Estonian, Ukrainian, Czech, Slovak, English, German, Serbian, Croatian, Slovenian

- If the characters are unreadable. ➔ Select different Teletext language group. (P. 6)

Sound and Colour system in your country or region

Area	Country or Region	System	System
Asia, Middle East	Bahrain, Kuwait, Oman, Qatar, United Arab Emirates, Yemen, Indonesia, Malaysia, Singapore, Thailand, India, etc.	B/G	PAL
	China, Vietnam, etc.	D/K	
	Hong Kong, etc.	I	
	Islamic Republic of Iran, Lebanon, Saudi Arabia, etc.	B/G	SECAM
	Philippines, Taiwan, Myanmar, etc.	M	NTSC
Europe	Russia, etc.	D/K	SECAM
	Czech Republic, Poland, etc.		
	Germany, Holland, Belgium, etc.	B/G	PAL
	UK, etc.	I	
Oceania	Australia, New Zealand, etc.	B/G	PAL
	Republic of South Africa, etc.	I	PAL
Africa	Nigeria, etc.	B/G	SECAM
	Egypt, Morocco, etc.		
	Argentina, Paraguay, Uruguay	N	PAL
South America	Brazil	M	
	Chile, Peru, Bolivia, Colombia, Venezuela, Ecuador, etc.	M	NTSC

PC Signals that can be displayed

- If the signal doesn't appear, check that the vertical frequency on the PC is set to "60Hz".

Resolution	640 x 480(VGA) / 1024 x 768(XGA)
Vertical frequency (Hz)	60.0

What is "Clear SD"

LCD picture is unstable due to a large number of signal noise. Such noise appears extensively especially when an LCD displays SD signals. Clear SD mode resolves disadvantage for better picture quality.



No use "Clear SD"



Use "Clear SD"

What is "Eco Sensor"?

You can adjust this TV so that the screen automatically adjusts to the optimum contrast of light and dark according to the brightness of your room. This function reduces eyestrain and the power consumption of this TV.

- Set "Eco Sensor" (P. 15)
- Make sure not to block the Eco Sensor on front of the TV (P. 4)
- To fully reduce eyestrain and the power consumption of this TV. Set to the following functions.

Eco Sensor : On or Demo (P. 15)

Smart Picture : On (P. 11)

- Using "Demo" in "Eco Sensor", you can display the effect of the "Eco Sensor" on the screen.

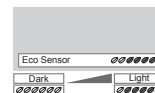

Troubleshooting

If a problem occurs when you are using the TV, check the below troubleshooting guide before calling for repair.

Severe noise or snow	Page	Poor picture quality	Page
Check the aerial cable and TV connections .	P. 4	Unnatural colour >> Adjust "Colour" and "Backlight"	P. 10
Check the direction of the aerial.	P. 4	Check "Colour System". If "Auto" is selected	P. 11
Check the aerial or its cable damaged or not.	--	select the specific colour system manually.	
Patterns, stripes or noise		Noise >> Set to the following functions.	
Interference caused by devices such as an amplifier, personal computer, or a hair drier, Move it away from TV.	--	Picture Mode : Standard	P. 10
Ghosting (Doubling of images)		DigiPure : On	P. 11
Interference occurs caused by signal reflection from mountains or building. Try to adjust the aerial's direction or use another antenna.	--	Dull picture >> Set to the following functions.	
Cannot turn it on		Picture Mode : Bright	P. 10
Ensure the power cord is connected to the AC outlet correctly.	--	DigiPure : On	P. 11
Cannot operate the remote control.		Poor sound	
The batteries may be exhausted. Replace with new batteries.	--	Adjust the "Bass" and "Treble".	P. 12
Ensure that you are operation the remote control at less than 7 meters from the front of your TV.	--	If receiving a poor signal in "Stereo/I-II" switch to "Mono".	P. 12
Remote control stops working		Adjust the channel reception using "Manual".	P. 7
Unplug TV, several minutes later plug it in again.	--	For HDMI signal, wrong screen size in 480p (525p).	
Side control buttons do not work		Switch "Size" in "HDMI Setting" to "1" or "2".	P. 20
Switch "Child Lock" to "Off".	P. 15	For HDMI signal, green and distorted screen	
Aspect ratio changed unintentionally		Wait a little for the signal to stabilize when switching the signal format for an "HDMI" device.	--
Press "  " button to return to your settings.	P. 11	For HDMI signal, No picture / No sound	
PC screen alignment is off		Use the cable marked with HDMI logo.	P. 5
Adjust the "PC Position" in "PC Setting" of Set Up menu.	P. 20	Check if the device is compliant with HDMI.	P. 20
Blue screen appears on the screen		Switch "Audio" in "HDMI Setting" to "Digital" or "Auto" for HDMI devices, or "Analogue" or "Auto" for DVI devices.	
Switch "Blue Back" to "Off".	P. 15	Some functions do not work.	
Strange picture when using an external device		It is not a malfunction. Some functions (dark background) in the menu do not work depending on the situation.	--
If the top of the image is distorted, check the video signal quality itself.	--	Black or white dots appear on the screen.	
If movement appears unnatural when receiving a signal from a DVD player, etc. with 625p (progressive-scanning), change the output setting of the external device to 625i (interlace-scanning).	--	LCD panels use fine dots ("pixels") to display images. While more than 99.99% of these pixels function properly, a very small number of pixels may not light, or may light all the time. It is not a malfunction.	--
Icon does not appear on the screen when plug USB or SD card into the TV.		No picture, No sound	
Make sure the USB or SD card inserted engaged.		Some input do not output from OUT terminal.	--
Set input signal (See page 16 Article 2)		Subwoofer, No sound	
USB or SD card may be damaged.		May be signal source is not low frequency bass signal.	--
		Check subwoofer cable connected correctly.	
		Feedback sound symptoms	
		Keep the microphone away from the TV's speakers.	--
		Echo	
		Lower the sound level in "Microphone Volume" in order to prevent the echo.	--

CH / CC List

To use the Insert function (P. 7), find the "CH/CC" number corresponding to the TV's channel number from this table.

US: The US channel numbers are the channel numbers used in the United States, Philippines, etc.

CCIR: The CCIR channel numbers are the channel numbers used in the Middle East, Southeast Asia, etc.

OIRT: The OIRT channel numbers are the channel numbers used in Eastern Europe, Russia, Vietnam, etc.

AUSTRALIA: The AUSTRALIA channel numbers are the channel numbers used in Australia, etc.

CH	Channel			
	US	CCIR	OIRT	AUSTRALIA
CH 02	US-02	E2	R1	AU-0
CH 03	US-03	E3		AU-1
CH 04	US-04	E4	R2	AU-2
CH 05	US-05	E5	R6	AU-6
CH 06	US-06	E6	R7	AU-7
CH 07	US-07	E7	R8	AU-8
CH 08	US-08	E8	R9	AU-9
CH 09	US-09	E9		
CH 10	US-10	E10	R10	AU-10
CH 11	US-11	E11	R11	AU-11
CH 12	US-12	E12	R12	
CH 13	US-13			
CH 14	US-14, W+29			
CH 15	US-15, W+30			
CH 16	US-16, W+31			
CH 17	US-17, W+32			
CH 18	US-18, W+33			
CH 19	US-19, W+34			
CH 20	US-20, W+35			
CH 21	US-21, W+36	E21		
CH 22	US-22, W+37	E22		
CH 23	US-23, W+38	E23		
CH 24	US-24, W+39	E24		
CH 25	US-25, W+40	E25		
CH 26	US-26, W+41	E26		
CH 27	US-27, W+42	E27		
CH 28	US-28, W+43	E28		
CH 29	US-29, W+44	E29		
CH 30	US-30, W+45	E30		
CH 31	US-31, W+46	E31		
CH 32	US-32, W+47	E32		
CH 33	US-33, W+48	E33		
CH 34	US-34, W+49	E34		
CH 35	US-35, W+50	E35		
CH 36	US-36, W+51	E36		
CH 37	US-37, W+52	E37		
CH 38	US-38, W+53	E38		
CH 39	US-39, W+54	E39		
CH 40	US-40, W+55	E40		
CH 41	US-41, W+56	E41		
CH 42	US-42, W+57	E42		
CH 43	US-43, W+58	E43		
CH 44	US-44, W+59	E44		
CH 45	US-45, W+60	E45		
CH 46	US-46, W+61	E46		
CH 47	US-47, W+62	E47		

CH 48	US-48, W+63	E48		
CH 49	US-49, W+64	E49		
CH 50	US-50, W+65	E50		
CH 51	US-51, W+66	E51		
CH 52	US-52, W+67	E52		
CH 53	US-53, W+68	E53		
CH 54	US-54, W+69	E54		
CH 55	US-55, W+70	E55		
CH 56	US-56, W+71	E56		
CH 57	US-57, W+72	E57		
CH 58	US-58, W+73	E58		
CH 59	US-59, W+74	E59		
CH 60	US-60, W+75	E60		
CH 61	US-61, W+76	E61		
CH 62	US-62, W+77	E62		
CH 63	US-63, W+78	E63		
CH 64	US-64, W+79	E64		
CH 65	US-65, W+80	E65		
CH 66	US-66, W+81	E66		
CH 67	US-67, W+82	E67		
CH 68	US-68, W+83	E68		
CH 69	US-69, W+84	E69		

CC	Channel			
	US	CCIR	OIRT	AUSTRALIA
CC 01		S-1		AU-5
CC 02	US-26, W+41	S-2		
CC 03		S-3		
CC 04		S-4		
CC 05		S-5		
CC 06		S-6		AU-5A
CC 07		S-7		
CC 08		S-8		
CC 09		S-9		
CC 10		S-10		
CC 11		S-11		
CC 12		S-12		
CC 13		S-13		
CC 14	A	S-14		
CC 15	B	S-15		
CC 16	C	S-16		
CC 17	D	S-17		
CC 18	E	S-18		
CC 19	F	S-19		
CC 20	G	S-20		
CC 21	H	S-21		
CC 22	I	S-22		
CC 23	J	S-23		

CC 24	K	S-24		
CC 25	L	S-25		
CC 26	M	S-26		
CC 27	N	S-27		
CC 28	O	S-28		
CC 29	P	S-29		
CC 30	Q	S-30		
CC 31	R	S-31		
CC 32	S	S-32		
CC 33	T	S-33		
CC 34	U	S-34		
CC 35	V	S-35		
CC 36	W	S-36		
CC 37	W+1	S-37		
CC 38	W+2	S-38		
CC 39	W+3	S-39		
CC 40	W+4	S-40		
CC 41	W+5	S-41		
CC 42	W+6			
CC 43	W+7			
CC 44	W+8			
CC 45	W+9			
CC 46	W+10			
CC 47	W+11			
CC 48	W+12			
CC 49	W+13			
CC 50	W+14			
CC 51	W+15			
CC 52	W+16			
CC 53	W+17			
CC 54	W+18			
CC 55	W+19			
CC 56	W+20			
CC 57	W+21			
CC 58	W+22			
CC 59	W+23			
CC 60	W+24			
CC 61	W+25			
CC 62	W+26			
CC 63	W+27			
CC 64	W+28			
CC 75		X		
CC 76		Y	R3	
CC 77		Z	R4	AU-3
CC 78		Z+1	R5	
CC 79		Z+2		AU-4
CC 95	A-5			
CC 96	A-4			
CC 97	A-3			
CC 98	A-2			
CC 99	A-1			

Specification

Main unit

Model	LT-42Z10	
Broadcasting systems	Area-1	B / G / I / D / K / M
	Area-2	M / N
Colour systems	Area-1	PAL / SECAM / NTSC 3.58 / NTSC 4.43
	Area-2	NTSC / PAL-M / PAL-N
Channels and frequencies	Area-1	VHF low channel (VL) = 46.25 to 140.25 MHz VHF high channel (VH) = 147.25 to 423.25 MHz UHF channel (U) = 431.25 to 863.25 MHz
	Area-2	VHF low channel (VL) = 55.25 to 127.25 MHz VHF high channel (VH) = 133.25 to 361.25 MHz UHF channel (U) = 367.25 to 801.25 MHz
	Receives cable channels in mid band (X to Z+2, S1 to S10), super band (S11 to S20) and hyper band (S21 to S41)	
Sound-multiplex systems	NICAM (I / B / G / D / K), A2 (B / G / D / K)	
Teletext systems	FLOF (Fastext), WST (World System Teletext)	
Power requirements	AC 110 V - 240 V, 50/60Hz	
Audio output (Rated power output)	10 W + 10 W	
Speakers	(4 cm x 16 cm) x 2	
Power consumption [standby]	167 W	
["Rocket Start" mode standby]	[1 W]	
	[15W]	
Screen size (visible area size measured diagonally)	106.7 cm	
Dimensions (W x H x D: mm) [without stand]	1014.8 x 695.4 x 279 [1014.8 x 646.9 x 108.7]	
Weights [without stand]	20 kg [19 kg]	
Accessories	Power cord x 1 Remote control unit : RM-C2023 x 1 AAA/R03 dry cell battery x 2 Screw x 8	

Terminals / Connectors

Terminal name	Terminal type	Signal type (IN)	Signal type (OUT)
Input terminals	VIDEO-1	RCA connectors x 6	Composite video, Analogue component 576i (625i) / 480i (525i), Progressive : 576p (625p) / 480p (525p), HD : 1080i (1125i), 720p (750p) / 1080p (1125p) Audio L / R
	VIDEO-2	RCA connectors x 3	Composite video, Audio L / R
	HDMI-1	HDMI connector x 1	HDMI 576i (625i) / 480i (525i) / 576p (625p) / 480p (525p), 720p (750p) / 1080p (1125p) / 1080i (1125i)
	HDMI-2		
	HDMI-3		
	IN HDMI -1	RCA connectors x 2	Audio L/R
	PC INPUT	D-SUB (15 pins) x 1	Analogue PC signal
	PC AUDIO	PC-IN (3.5 pinjack) x 1	Audio
	Microphone	mini-jack x 1 (3.5 mm in diameter)	Microphone input
	Output terminals	MONITOR OUT	RCA connectors x 3

- We may change the design and specifications without notice.
- HDMI, the HDMI Logo, and High-Definition Multimedia Interface are trademarks or registered trademarks of HDMI Licensing LLC in the United States and other countries.

JVC

Free Manuals Download Website

<http://myh66.com>

<http://usermanuals.us>

<http://www.somanuals.com>

<http://www.4manuals.cc>

<http://www.manual-lib.com>

<http://www.404manual.com>

<http://www.luxmanual.com>

<http://aubethermostatmanual.com>

Golf course search by state

<http://golfingnear.com>

Email search by domain

<http://emailbydomain.com>

Auto manuals search

<http://auto.somanuals.com>

TV manuals search

<http://tv.somanuals.com>