

Using the Wired Remote Control

The remote control can be operated regardless of the hold mode of the unit.

Preparation:

Release the remote control from the hold mode.

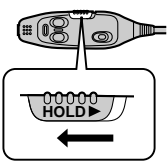

Operation confirmation tones

When an operation button is pressed, a confirmation tone sounds. Refer to the parentheses in the illustration for the different types of confirmation tones.

How to use the wired remote control

| | | |
|-----------------------------|--|---|
| To start play | Press once during off or stop mode. (Beep) | Skip function Press once during play. Forward (Beep Beep) Reverse (Beep Beep Beep) |
| To stop play | Press once during play. (Beep . . . Beep) | Search function Keep depressed during play. |
| To turn off the unit | Keep depressed during play or stop mode. (Beep . . . Bee . . . p) | To adjust the volume When adjusting the volume using the remote control, position the volume control on the unit between 4 and 6. |

Using the Unit with Optional Accessories

Using the unit with an audio system

Using a stereo connection cable (not included), you can listen to CDs through your audio system.

- Connect the cable to the amplifier after turning off its power.
- Do not connect the cable to the PHONO jacks on the amplifier.
- Obtain the optional connecting cable if the amplifier comes with mini-phone jacks.
- Adjust the volume level on the amplifier.

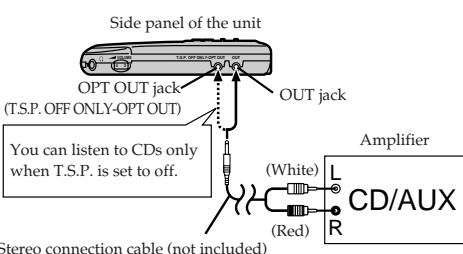

Note: Sound quality changes when HBS or LIVE is selected, but volume is reduced by approximately fifty percent.

Using the unit with a car audio system

XL-PV700 comes with the car adaptor and car audio cassette adaptor.

- Car adaptor (CA-R455)
- Car audio cassette adaptor (CA-RC4/CA-RC5)

For connection to the car audio system:

Connect the car audio cassette adaptor to the unit's headphones jack. (When doing this, keep the unit's VOLUME control at a setting between 4 and 6.)

If there is an Aux jack in the car audio system, connect the OUT or OPT OUT jack of the CD player with the Aux jack using a 3.5 mm diameter stereo mini-plug signal cord (optional). Depending on the automobile used, noise may occur, and in that case, it is recommended that a KS-U32 noise filter (optional) be used.

Note:

It may not be possible to use the unit with some types of car stereo owing to restrictions imposed by the construction of the car audio cassette adaptor.

For further details, refer to the instructions of the part concerned.

Maintenance

Maintaining the unit

Wipe the unit with a soft cloth. Remove stubborn dirt using a cloth which has been dipped in water or soapy water and wrung out, and then wipe dry.

- If you intend to use a chemically treated cleaning cloth, read its directions first.
- Do not use alcohol or paint thinners.

Maintaining the lens

Open the lid and clean the lens as shown in the figure. Use a cotton swab to gently wipe off any finger-prints. Recommended product: Lens cleaner kit

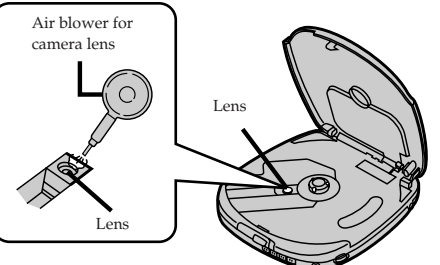

Specifications

Portable CD player

- Type : Compact disc player
- Signal detection system : Non-contact optical pickup (semiconductor laser)
- Pickup system : 3 beam laser
- Number of channels : 2 channels (stereo)
- Frequency response : 20 Hz to 20,000 Hz
- Wow & flutter : Unmeasurable
- Output : Headphones (3.5 mm dia. stereo × 1)
9 mW/ch at 10 % THD/16 ohms matching impedance (16 ohms to 1 kohm)
Out (3.5 mm dia. stereo × 1) 0.6 V/50 kohms
OPT Out (3.5 mm dia. stereo × 1) 0.6 V/50 kohms
- Duration of battery (with T.S.P. ON) : Approx. 6 hours when using two rechargeable batteries (BN-R122J or equivalent) charged for 1.5 hours, Approx. 21 hours when using two alkaline batteries (LR6-Panasonic)
Approx. 48 hours when using two alkaline batteries and two alkaline batteries in the external battery case
- Power requirements : DC 3 V ("AA" size battery × 2)
DC 2.4 V (rechargeable battery × 2)
DC IN 4.5 V
- Dimensions (W×H×D) : 128.0×27.9×136.1 mm (5-1/16"×1-1/8"×5-3/8") (Excluding buttons and controls)
- Mass : Approx. 235 g (0.52 lbs) (without batteries)

AC adaptor

- Input power source : AC 120 V, 60 Hz
- Output voltage : DC 4.5 V, 600 mA

* Design and specifications are subject to change without notice.

Troubleshooting Guide

Before requesting service for this unit, check the chart below for a possible cause of the problem you are experiencing. Some simple checks or a minor adjustment on your part may eliminate the problem and restore proper operation. If you are in doubt about some of the check points, or if the remedies indicated in the chart do not solve the problem, refer to the directory of Authorized Service Centers (enclosed with this unit) to locate a convenient service center, or consult your dealer for instructions.

| Problem | Check this |
|--|---|
| Cannot close cover. | Is the disc properly secured in place? |
| Cannot play discs. | <ul style="list-style-type: none"> • Is the unit in HOLD status? • Is the disc properly secured in place? • Is there moisture condensation on the lens? (Wait for about an hour and then try again.) |
| Cannot remove disc. | Did you press the PUSH button to release the disc? |
| Tracks on disc do not play in order, starting with the first track. | Is the RESUME, NORMAL, RANDOM (play mode) selector in the NORMAL position? |
| Cannot hear music—too noisy. | <ul style="list-style-type: none"> • Are the headphone plug and the wired remote control plug inserted all the way? • Is the plug dirty? (Wipe away dirt on the plug.) |
| TV picture is distorted. Radio reception is noisy. | Are you using the unit body too near a TV or tuner? (If the TV or tuner is connected to a simple indoor antenna, connect it to an outdoor antenna.) |

Concerning Compact Discs

Only compact discs bearing this mark can be used with this unit.

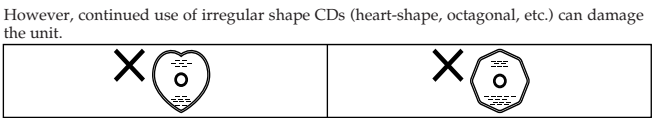

How to remove a disc from its case

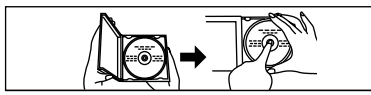

How to store the disc in its case

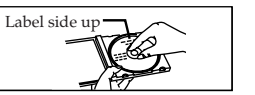

How to hold a disc

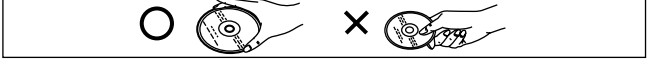

If the surface is dirty
Wipe it with a damp cloth and then wipe dry. Wipe from the center toward the outer circumference.



If moisture has formed on a disc

When moisture has formed because the disc was brought suddenly into a warm room from a cold environment, wipe it off using a soft dry cloth.

- When storing discs**
Avoid locations which are
- Exposed to direct sunlight.
 - Susceptible to high levels of humidity or dust.
 - Directly exposed to heat from a heating appliance.
 - On top of a car dashboard or near the rear window.
- Handling precautions**
- On the label side (the side with writing) Do not write anything using a pencil, ball-point pen, etc. Do not stick on paper or labels.
 - On the disc (shiny) side Handle this side carefully to keep it free from fingerprints or scratches. Do not use record cleaners, solvents, etc.
 - Do not attach labels or stickers to CDs. Do not use CDs with exposed adhesive from tape or left over peeled off stickers.
 - Do not use scratch-proof protectors or covers other than those specified for use with this unit.

Precautions

Before using this unit, be sure to read the applicable items of the operating instructions and these safety-suggestions carefully. Afterwards keep them handy for future reference. Take special care to follow the warnings indicated on the unit itself as well as in the operating instructions.

Safety

- Care of AC adaptor** - Take care that the cord of the AC adaptor should be routed so that they are not likely to be walked on or pinched by items placed upon or against them. Never take hold of the AC adaptor if your hand is wet, and always grasp the plug body when connecting or disconnecting it.
- Nonuse Periods** - When not in use, be sure to disconnect the AC adaptor from the AC power outlet.
- Batteries** - If the set is not used for a long period of time or is used only from an AC power source, remove all the batteries to prevent potential damage due to possible battery leakage. Do not mix batteries (old and new) or different types of batteries.

Installation

- Environment**
- Condensation** - Moisture may form on the lens in the following conditions...
 - immediately after a heater has been turned on.
 - in a steamy or very humid room.
 - when the unit is suddenly moved from a cold environment to a warm one. If moisture forms inside this unit, it may not operate properly. To correct this problem wait about one hour for the moisture to evaporate.
- Placement**
- Foreign Material** - Care should be taken so that objects do not fall into and liquids are not spilled into the unit. Do not subject this unit to excessive smoke, dust, mechanical vibration, or shock.
 - Magnetism** - The unit should be situated away from equipment or devices that generate strong magnetic fields.
 - Stacking** - Do not place any objects, on top of the unit.

INFORMATION (For Canada)
This digital apparatus does not exceed the Class B limits for radio noise emissions from digital apparatus as set out in the interference-causing equipment standard entitled "Digital Apparatus", ICES-003 of the Department of Communications.

Cautions

Listening caution

Do not play your headphones or earphones at a high volume. Hearing experts advise against continuous extended play.

If you experience a ringing in your ears, reduce volume or discontinue use.

Do not use while operating a motorized vehicle. It may create a traffic hazard and is illegal in many areas.

You should use extreme caution or temporarily discontinue use in potentially hazardous situations.

Even if your headphones or earphones is an open-air type designed to let you hear outside sounds, don't turn up the volume so high that you can't hear what's around you.

Sound can be deceiving. Over time your hearing "comfort level" adapts to higher volumes of sound. So what sounds "normal" can actually be loud and harmful to your hearing. Guard against this by setting your equipment at a safe level BEFORE your hearing adapts.

To establish a safe level:

- Start your volume control at a low setting.
- Slowly increase the sound until you can hear it comfortably and clearly, and without distortion.

Once you have established a comfortable sound level:

- Set the dial and leave it there.

Rechargeable batteries

- Only the BN-R122J battery can be recharged.
- If the power delivered by the batteries lasts for a very short time after recharging, it means that the batteries' service life is over. Do not use them any more.

Accidental Operation Prevention Function (Hold Mode)

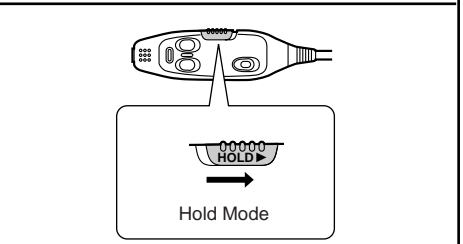
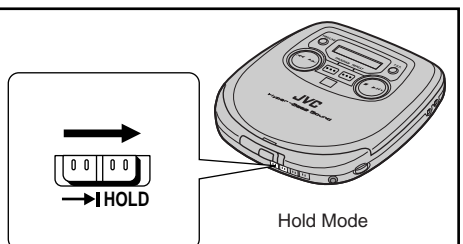

This function causes the unit to ignore short, accidental button presses.

The misoperation prevention function prevents the following:

- Powering on the unit accidentally (which can cause the batteries to go dead).
- Play being cut off unexpectedly in the middle of a selection.

The unit and wired remote control have HOLD switches, each of which works independently.

To use the accidental operation prevention function

- To prevent the unit from powering up accidentally, set the HOLD switch to the HOLD position.
- To prevent the unit from unexpected operation during play, set the HOLD switch to the HOLD position after playing the disc.

"ho l d" indication

When the unit is in hold mode, pressing any operation button causes the indication "ho l d" to appear on the display.

When the unit is powered off

The "ho l d" indication appears only when the ► || button is pressed.

To release the function

Move back the HOLD switch.

Free Manuals Download Website

<http://myh66.com>

<http://usermanuals.us>

<http://www.somanuals.com>

<http://www.4manuals.cc>

<http://www.manual-lib.com>

<http://www.404manual.com>

<http://www.luxmanual.com>

<http://aubethermostatmanual.com>

Golf course search by state

<http://golfingnear.com>

Email search by domain

<http://emailbydomain.com>

Auto manuals search

<http://auto.somanuals.com>

TV manuals search

<http://tv.somanuals.com>