

# JVC



English

中文

## SPEAKER SYSTEM

扬声器系统

# SX-L77



## INSTRUCTIONS

使用说明书

LVT1283-002A  
[U]

Thank you for purchasing a JVC speaker. Before you begin using it, please read the instructions carefully to be sure you get the best possible performance. If you have any questions, consult your JVC dealer.

## Warnings, Cautions and Others

### ■ Precautions for installation

- To avoid personal injury or accidentally dropping the unit, have two persons unpack, carry, and install the unit.
- Do not install the speakers on an uneven surface or in a place subject to vibration; otherwise, they may fall over, causing damage or injury.
  - Take the occurrence of earthquakes or other physical shocks into consideration when selecting the installation place, and secure the speakers thoroughly.
- To prevent deformation or discoloration of the cabinet, do not install the speakers where they are exposed to direct sunlight or high humidity, and avoid installation near air conditioning outlets.
- Speaker vibrations may cause howling. Place the speakers as far away from the player as possible.
- The speakers are magnetically shielded to avoid color distortions on TVs. However, if not installed properly, it may cause color distortions. So, pay attention to the following when installing the speakers.
  - When placing the speakers near a TV set, turn off the TV's main power switch or unplug it before installing the speakers. Then wait at least 30 minutes before turning on the TV's main power switch again.

Some TVs may still be affected even though you have followed the above. If this happens, move the speakers further away from the TV.
- Tuner reception may become noisy or hissing if a speaker is installed near the tuner. In this case, leave more distance between the tuner and the speakers or use an outdoor antenna for better tuner reception without interference from the speakers.
- Do not lean against the speakers, as the speakers could fall down or break, possibly causing an injury. Especially be careful that children do not lean against them.



### ■ Precautions for daily use

- To maintain the appearance of the speakers**
  - Wipe with a dry, soft cloth if the cabinet should become dirty. If very dirty, wipe with a cloth applied a small amount of water or neutral detergent, then wipe with a dry cloth.
  - Do not use chemicals such as benzene and thinner for cleaning the cabinet.
- To improve the sound field**
  - It is recommended to leave a space of more than 50 cm between the speakers and the wall.
  - If the speakers are facing a solid wall or glass door, etc., it is recommended to furnish the wall with materials that absorb sounds, for example by hanging up thick curtains, to prevent reflections and standing waves.
- To use the speakers without any trouble**
  - Do not reproduce sounds at so high a volume that they are distorted; otherwise, the speakers may be damaged by internal heat buildup.
  - When moving the speakers, do not pull the speaker cords; otherwise, the speakers may fall over, causing damage or injury.

## Preparation

### ■ Checking the supplied accessories

- Speaker grille (1)**  
If any item is missing, contact your dealer immediately.

### ■ Adjusting the feet

- If the speaker is unstable, adjust each foot until it stands stably.
- To avoid personal injury, and physical damage both to the speaker and to the floor be careful not to drop the speaker on your feet.
  - Have two persons to adjust the feet to avoid falling off the speaker.
  - Do not touch the speaker units while adjusting the feet.
  - When installing the speaker on the floor, be careful not to place it over your hands.

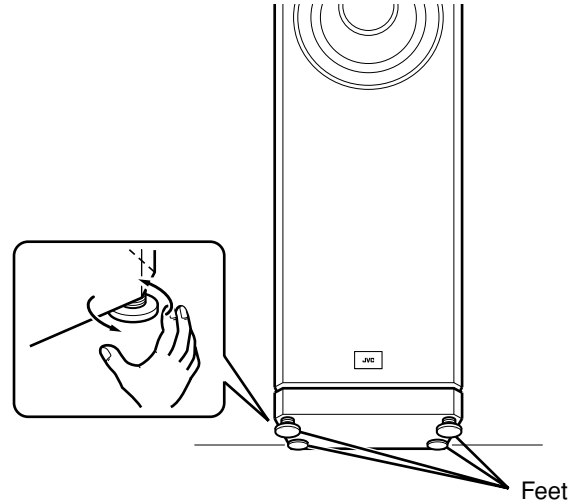

### ■ About speaker grille

**To attach the speaker grille**, put the projections of the speaker into the holes of the speaker grille.

- Do not press the speaker grille strongly.

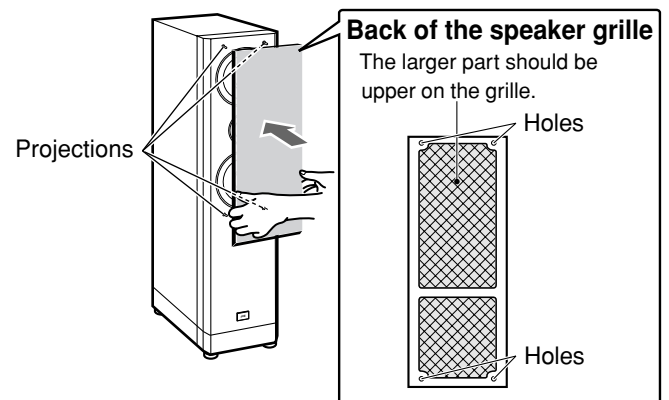

**To remove the speaker grille**, insert your fingers at the bottom of the speaker grille, then pull upward.

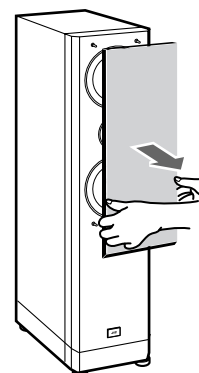

## ■ Connecting the speaker system to the amplifier

### Before connecting:

- Make sure to match the polarity ( $\oplus$  and  $\ominus$ ) when connecting the speaker cords.
- Turn off the power to the amplifier before connecting the speaker system; otherwise, the speakers may be damaged.
- The impedance of each speaker is 6  $\Omega$ .  
If this does not match with the speaker impedance range indicated on the amplifier, you cannot connect this system to the amplifier.
- The maximum power handling capacity of the SX-L77 is 180 W. Excessive input will result in abnormal noise and possible damage.
- Be sure to turn down the volume level on the amplifier to prevent unwanted noise before performing following operations:
  - Turning on or off other components
  - Operating the amplifier
  - Tuning FM stations
  - Fast-forwarding a tape
  - Continuously reproducing high frequency oscillation or high pitch electronic sounds
  - Connecting or disconnecting a microphone
- When using a microphone, do not aim it at the speakers or use it near the speakers; otherwise, the howling which occurs may damage the speakers.
- Before replacing the cartridge, always turn off the power both to the amplifier and to the turntable; otherwise, the clicking noise may damage the speakers.
- Use speaker cords as follows;
  - Buy thick speaker cords rather than thin cords, and make them as short as possible for connection.
  - Use speaker cords of the same length for both left and right speakers.
  - Do not use long speaker cords; otherwise, the sound quality may deteriorate.
  - Using a special speaker cord such as a litz wire, a coaxial cable, or a cord which has the specified connecting directionality may influence the sound quality.

## ■ Connecting the speaker cord

Connect the "INPUT" terminal of the speaker to the speaker terminal of the amplifier.

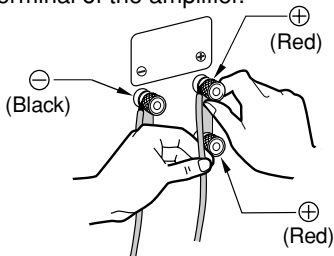

Rotate the speaker terminal knob counterclockwise and fit the speaker cord into the groove. Then rotate the knob clockwise to secure the cord.

- Make sure to match the polarity ( $\oplus$  and  $\ominus$ ); otherwise, the surround effect will become less effective.

## ■ Conventional connection

- 1 Loosen the knobs of the "FULL RANGE" terminals.
- 2 Fit the speaker cords into the grooves of the "FULL RANGE" terminals, then tighten the knobs to secure the speaker cords and short-circuit plates.

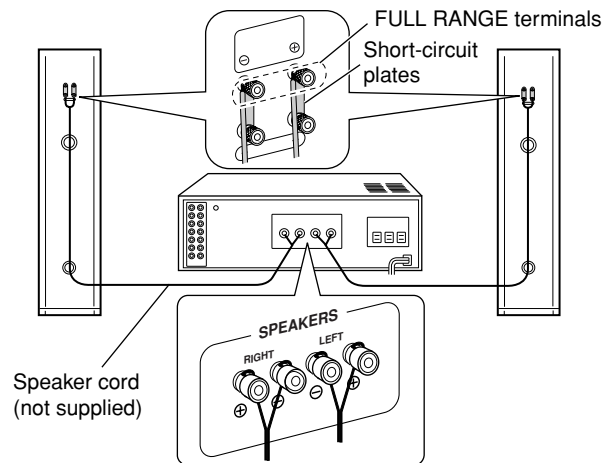

## ■ Bi-wiring connection

This speaker is bi-wireable. Comparing with the conventional connection, the bi-wiring connection makes the sound field larger, deeper, and richer.

- 1 Loosen all speaker terminal knobs and detach the short-circuit plates.

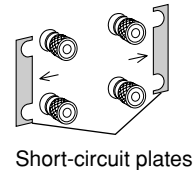

- 2 Connect the "FULL RANGE" terminals and "LOW FREQUENCY" terminals separately to the speaker terminals of the amplifier.

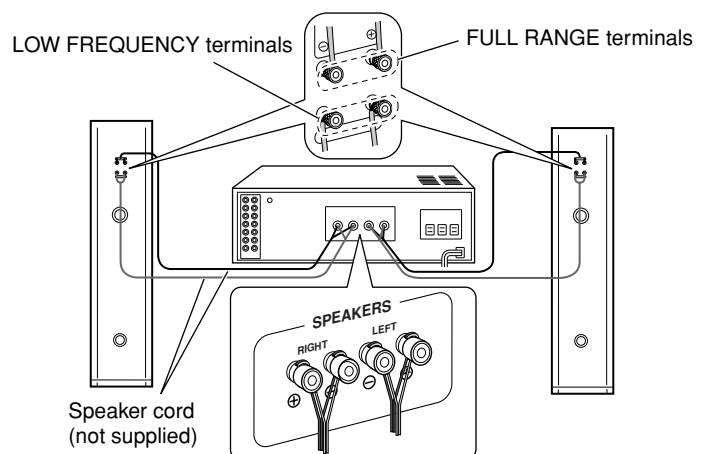

## Specifications

**Type:** 3-way 3-speaker bass-reflex type  
Magnetically-shielded type

**Speaker unit:**

Woofer: 17.5 cm cone  
Mid and low range: 17.5 cm cone  
Tweeter: 2.5 cm dome

**Power handling Capacity:** 180 W

**Impedance:** 6  $\Omega$

**Crossover frequency:** 170 Hz, 3 000 Hz

**Frequency range:** 28 Hz to 70 000 Hz

**Sound pressure level:** 89 dB/W•m

**Dimensions (W x H x D):** 253 mm x 1 077 mm x 387 mm

**Mass:** 38.0 kg

*Design and specifications subject to change without notice.*

感谢您惠购 JVC 扬声器。  
在开始使用之前，请您仔细阅读本使用说明书，以确保您获得扬声器的最佳性能。若有疑问，请与 JVC 代理销售商联系。

## 警告，注意及其他

### ■ 安装时的注意事项

- 为了防止人员受伤或意外跌损机器，在拆开包装，搬运和安装本机时需要由两个人来完成。
- 切勿将扬声器放置在凹凸不平处或受到震动处。否则扬声器摔落可能导致自身损坏或损伤他物。
  - 在选择安装场所时，须事先考虑到可能会发生地震或其他物理性冲击等情况，确保扬声器安装牢靠。
- 为防止机壳变形或变色，勿将扬声器安装在受到阳光直射或高度潮湿处，亦避免安装在空调器的排气孔附近。
- 扬声器的振动可能产生颤噪。应尽量将扬声器远离唱机放置。
- 尽管扬声器具有磁性屏蔽性能可以避免造成电视机色彩失真，但如果安装不当仍然可能引起电视机色彩失真。因此在安装扬声器时请注意以下事项。
  - 如果欲将扬声器安装在电视机附近，在安装扬声器之前请先关闭电视机的主电源开关或拔下电源插头。  
在重新启动电视机的主电源之前至少要等待 30 分钟。尽管您已经按照上述方法去做，有些电视机仍然会受到影响。发生此种情况时，须将扬声器移到远离电视机处进行安装。
- 如果将扬声器安装在调谐器附近，在调谐器接收时可能出现噪音或嘶嘶声。发生此种情况时，须将调谐器与扬声器之间多出一些距离，或者使用室外天线，这样调谐器便不会受到扬声器的干扰，而获得较好的接收效果。
- 切勿倚靠在扬声器上，因为扬声器可能摔倒或摔坏，而且可能砸伤人。特别注意不要让儿童倚靠在扬声器上。



### ■ 日常使用时的注意事项

- 保养扬声器的外表
  - 如果机壳脏污，可用干爽柔软的布进行擦拭。
  - 如果脏污严重，可在布上沾少量的水或中性洗涤剂擦去污物，然后再用干布擦拭。
  - 切勿使用苯及稀释剂等化学溶剂清洁机壳。
- 改良音场
  - 建议在扬声器与墙壁之间留出 50 cm 以上的间隔。
  - 如果扬声器面对固质材料的墙壁或玻璃门等设施，建议您使用吸音性材料，如厚料窗帘来装饰墙壁，这样便可以防止发生反射波和驻波。
- 常规使用扬声器
  - 勿在极高，乃至出现声音失真的音量下播放音响，否则扬声器内部热量积聚可能损坏扬声器。
  - 在移动扬声器时勿拉扯扬声器导线；否则扬声器摔落可能导致自身损坏或损伤他物。

## 使用注意事项

### ■ 检查附件

- 扬声器罩网 (1)  
如果有任何项目遗漏，请速与经销商联络。

### ■ 调节支脚

- 如果扬声器不稳定，调节每个支脚直到扬声器站稳为止。
- 为避免人员受伤，扬声器和地板受到外部损伤，注意不要摔落扬声器砸到脚。
  - 由两个人调节支脚以避免摔落扬声器。
  - 调节支脚时请勿碰触扬声器装置。
  - 地板上安装扬声器时，注意不要被支脚夹到手。

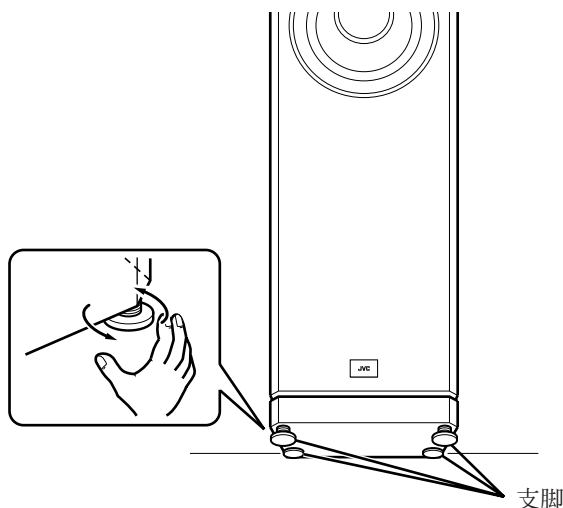

### ■ 关于扬声器罩网

- 要装上扬声器罩网时，将扬声器上的插销插到扬声器罩网上的插孔里。
- 切勿过度用力推插扬声器罩网。

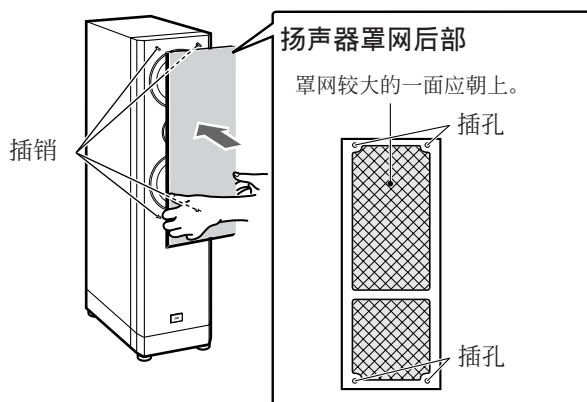

- 要卸下扬声器罩网时，将手指插入扬声器罩网底部，然后朝前拉。

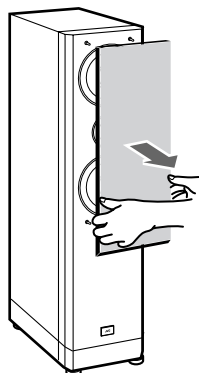

## ■ 将扬声器系统连接到功率放大器上

进行连接之前：

- 在连接扬声器导线时确保对准极性（⊕ 和 ⊖）。
- 在连接扬声器系统之前，首先关闭功率放大器的电源，否则可能损坏扬声器。
- 每只扬声器的阻抗为 6 Ω。
- 如果扬声器的阻抗与功率放大器上标出的阻抗范围不一样，便不要将其连接到功率放大器上。
- SX-L77 的最大额定功率为 180 W。超过该值以上的信号传入时该机将产生异常噪音并可能受到损坏。
- 在执行下列操作之前确保调低功率放大器的音量水平，以防止出现异常噪音：
  - 启动或关闭其他组件
  - 操作功率放大器
  - 调收 FM 电台
  - 快速前进倒带
  - 连续播放高频振幅或高调电子音
  - 连接或拔下麦克风
- 在使用麦克风时，不要将其朝向扬声器，也不要不要在扬声器附近使用，否则颤噪可能会损坏扬声器。
- 在更换唱头之前，请务必将接至功率放大器和接至唱机的电源均关掉，否则咯噪音可能会损坏扬声器。
- 请按如下规定使用扬声器导线：
  - 购买扬声器导线时尽量买粗的而不要买细的，而且接线尽量要短。
  - 对左置和右置扬声器使用相同长度的扬声器导线。
  - 不要使用过长的扬声器导线，否则音响质量会降低。
  - 使用特殊的扬声器导线，如辫线，同轴电缆或带有特定的连接定向性的导线可能会影响音响质量。

## ■ 连接扬声器导线

将扬声器的“INPUT”端子连接到功率放大器的扬声器端子上。

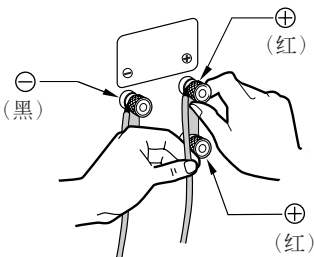

逆时针方向旋转扬声器端子上的旋钮，将扬声器导线放到线槽内。然后顺时针方向旋转旋钮以固定导线。

- 确保对准极性（⊕ 和 ⊖）；否则，环绕声效果将会丢失。

## ■ 普通连接

- 1 松开“FULL RANGE”端子上的旋钮。
- 2 将扬声器导线放到“FULL RANGE”端子的线槽内。然后旋转旋钮固定扬声器导线和短路板。

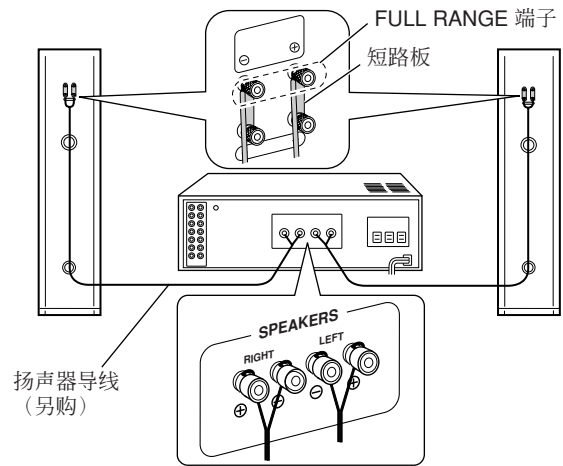

## ■ 双线连接

本扬声器可以进行双线连接。与普通连接法相比，双线连接法可使音场更大，更深，更饱满。

- 1 松开所有扬声器端子上的旋钮并卸下短路板。

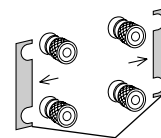

短路板

- 2 分别将“FULL RANGE”端子和“LOW FREQUENCY”端子连接到功率放大器的扬声器端子上。

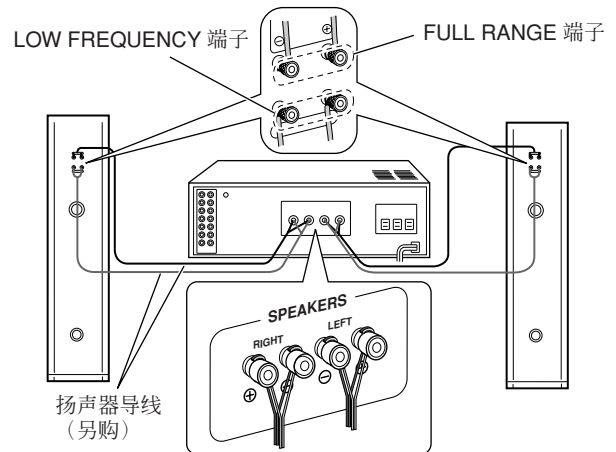

类型:	3 向 3 扬声器低音反射型 磁性屏蔽型
扬声器装置:	
低音扬声器:	17.5 cm 圆锥型
中低音扬声器:	17.5 cm 圆锥型
高音扬声器:	2.5 cm 圆顶型
额定功率:	180 W
阻抗:	6 $\Omega$
分解频率:	170 Hz, 3 000 Hz
频率范围:	28 Hz 至 70 000 Hz
声压水平:	89 dB/W·m
尺寸 (宽 x 高 x 深) :	253 mm x 1 077 mm x 387 mm
重量:	38.0 kg

设计及规格如有变更恕不另行通知。

**JVC**



## Free Manuals Download Website

<http://myh66.com>

<http://usermanuals.us>

<http://www.somanuals.com>

<http://www.4manuals.cc>

<http://www.manual-lib.com>

<http://www.404manual.com>

<http://www.luxmanual.com>

<http://aubethermostatmanual.com>

Golf course search by state

<http://golfingnear.com>

Email search by domain

<http://emailbydomain.com>

Auto manuals search

<http://auto.somanuals.com>

TV manuals search

<http://tv.somanuals.com>