

Operating Instructions

Before first use of the unit
read these operating instructions
and act in accordance with them.

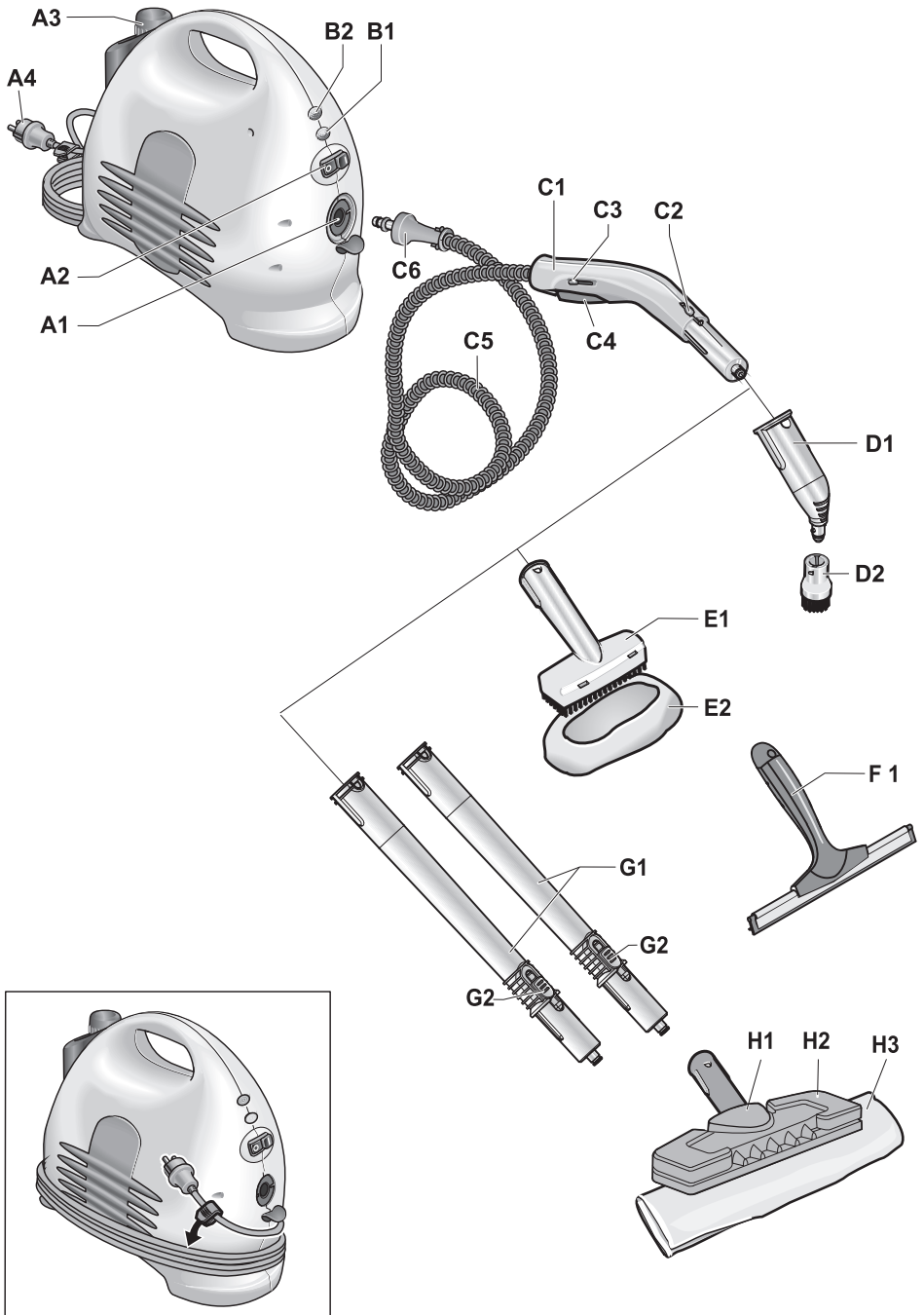



Contents

Description of the Appliance	3
Safety instructions.....	4
Preparing the Appliance.....	5
Quick Reference	6
Operation	7
How to Use the Accessories	9
Maintenance and care	11
Troubleshooting	12
Helpline	13
Technical specifications	13
Spare parts	15

Dear Customer,



Please read and comply with these original instructions prior to the initial operation of your appliance and store them for later use or subsequent owners.

Proper use

Only use the steam cleaner for private household applications. The unit is meant for steam cleaning and can be used with appropriate accessories as described in these operating instructions. Especially mind the safety instructions during use.

Description of the Appliance

→ See page 2

- A1 Appliance connector with cover
- A2 Switch - ON/OFF
- A3 Safety cap
- A4 Mains cable with mains plug

- B1 Indicator lamp (red) - lack of water steam boiler
- B2 Indicator lamp (orange) - heating

- C1 Steam gun
- C2 Unlocking button
- C3 Steam lever locking (child control)
 - Front – steam lever blocked
 - Middle – reduced steam amount
 - Back – maximum steam amount
- C4 Steam lever
- C5 Steam hose
- C6 Steam plug

- D1 Detail nozzle
- D2 Round brush

- E1 Manual nozzle
- E2 Terry cloth cover

- F1 Squeegee

- G1 Extension tubes (two tubes)
- G2 Unlocking button

- H1 Floor nozzle
- H2 Retaining clip
- H3 Floor cleaning cloth

Symbols on the machine



Steam

CAUTION - Danger of scalding

Safety instructions

⚠ Danger

- *The appliance may not be used in areas where a risk of explosion is present.*
- *If the appliance is used in hazardous areas the corresponding safety provisions must be observed.*
- *Never use the appliance in pools containing water.*
- *The device should not be used to clean electrical appliances such as oven, exhaust, micro-wave, televisions, lamps, hair-dryer, electrical heating systems, etc.*
- *Check the faultless condition of the appliance and the accessories before using it. Otherwise, the appliance must not be used. Please check in particular the power cord, the safety lock, and the steam hose.*
- *If the power cord is damaged, please arrange immediately for the exchange by an authorized customer service or a skilled electrician.*
- *Please arrange for the immediate exchange of a damaged steam hose. You may only use a steam hose that is recommended by the manufacturer (see spare parts list for the order number).*
- *Never touch the mains plug and the socket with wet hands.*
- *Never use the appliance to clean objects containing hazardous substances (e.g. asbestos).*
- *Never touch the steam jet from a short distance with your hands and never direct the steam jet to persons or animals (risk of scalds).*

⚠ Warning

- *The appliance may only be connected to an electrical supply which has been installed in accordance with IEC 60364.*
- *The appliance may only be connected to alternating current. The voltage must correspond with the type plate on the appliance.*

- *In wet rooms, e.g. bathrooms, connect the appliance to sockets with a series connected RCD adapter.*
- *Unsuitable extension cables can be hazardous. Only use a splashproof extension cable with a minimum section of 3x1 mm².*
- *The connection between power cord and extension cable must not lie in water.*
- *If couplings of the power cord or extension cable are replaced the splash protection and the mechanical tightness must be ensured.*
- *The operator must use the appliance correctly. When working with the appliance, he must consider the local conditions and pay due care and attention to other persons, in particular children, who are nearby.*
- *This device is not intended for use by persons (including children) with reduced physical, sensory or mental abilities or lacking experience and/or knowledge, unless they are supervised by a person responsible for their safety or are instructed by these persons on the use of the device. Children should be supervised, to ensure that they do not play with the device.*
- *Never leave the appliance unattended when it is in operation.*
- *Be very careful while cleaning tiled walls with sockets.*

Caution

- *Make sure that the power cable or extension cables are not damaged by running over, pinching, dragging or similar. Protect the power cable from heat, oil, and sharp edges.*
- *Never fill solvents, solvent-containing liquids or undiluted acids (e.g. detergents, benzene, paint thinner, and acetone) into the water reservoir as these substances affect the materials used on the appliance.*
- *The appliance must provide of a stable ground.*

- *Never operate or store the appliance in a horizontal position!*
- *The steam switch must not be locked during the operation.*
- *Protect the appliance from rain. Do not store outside.*

Safety elements

This steam cleaner is equipped with several safety devices that provide an all-round protection of the appliance. The most important safety devices are described in the following.

Pressure controller

The pressure controller keeps the boiler pressure during the operation as constant as possible. The heating is turned off if the maximum operating pressure of 4 bar is reached in the boiler and is reactivated in case of a pressure drop in the boiler due to steam tapping.

Low-water thermostat

When the water in the boiler becomes exhausted, the temperature of the heating increases. The low-water thermostat turns off the heating, and the red low-water indicator lamp lights up. The heating is prevented from being turned on again until the boiler has cooled down or refilled with water.

Safety thermostat

If the boiler thermostat fails and the appliance overheats, then the safety thermostat turns off the appliance.

Please contact your local KÄRCHER customer service to arrange for the reset of the safety thermostat.

Safety lock

The safety lock seals the boiler against the steam pressure that builds up in the boiler. If the pressure controller is defect and the steam pressure in the boiler rises, a pressure control valve in the safety lock opens, and steam is emitted through the lock to the outside.

Please contact your local KÄRCHER customer service before you put the appliance into operation again.

Preparing the Appliance

Unpacking the Appliance

When you unpack the system, check that everything is complete (see page 3). If there are any missing parts or you detect any transport damage when unpacking, please inform your dealer immediately.

Environmental protection



The packaging material can be recycled. Please do not place the packaging into the ordinary refuse for disposal, but arrange for the proper recycling.



Old appliances contain valuable materials that can be recycled. Please arrange for the proper recycling of old appliances. Please dispose your old appliances using appropriate collection systems.

Notes about the ingredients (REACH)

You will find current information about the ingredients at:

<http://www.karcher.de/de/unternehmen/umweltschutz/REACH.htm>

Quick Reference

- 1 Fill the steam cleaner with 1.2 liters of water.
- 2 Screw in safety cap.
- 3 Insert the steam plug into the appliance connector.
- 4 Plug in the main plug. Turn on the appliance. The orange indicator light comes on.
- 5 Wait until the orange indicator light goes out.
- 6 Connect the accessories to the steam gun. The steam cleaner is ready to use.

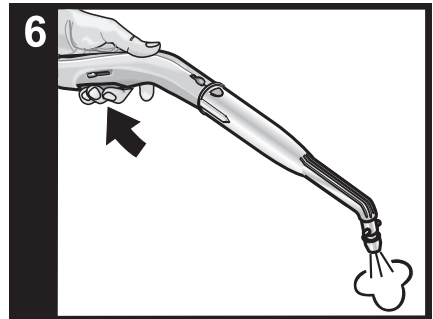
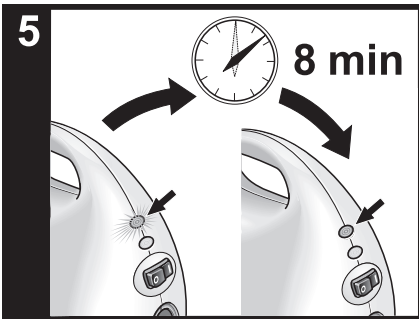
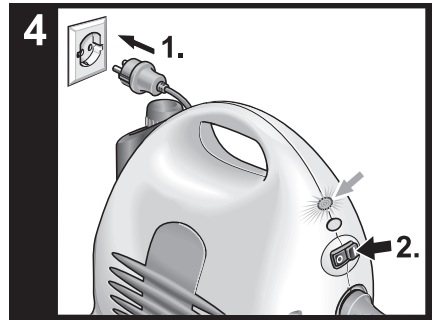
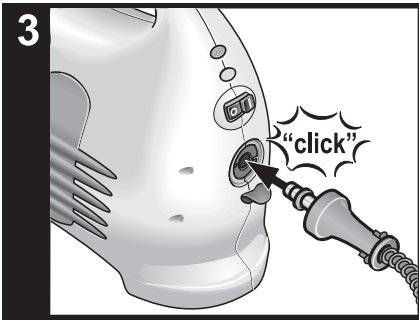
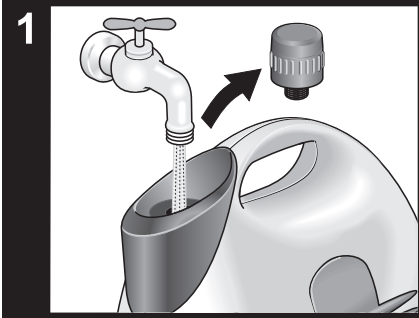

Operation

Attaching the Accessories

- Tightly insert the steam plug (C6) into the appliance connector (A1). The plug must click into place audibly.
- Connect the required accessories to the steam gun (C1). Insert the open end of the accessory on the steam gun and push onto the steam gun until the unlocking button (C2) of the steam gun locks into place.

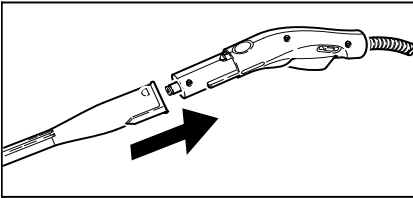

Figure 1

- Use the extension pieces (G1) if necessary. To do so, connect one or both extension pieces to the steam gun (C1). Insert the required accessories on the free end of the extension piece.

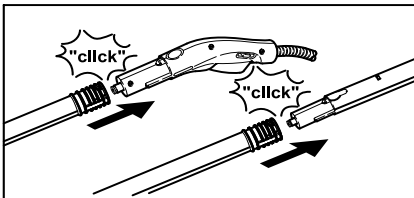

Figure 2

Removing the Accessories

⚠ DANGER

Hot water may drip out of the accessory parts while you are detaching them! Never detach accessory parts while steam streams out - risk of scalding!

- Push the lock (C3) to the front (steam switch blocked).
- To detach the accessory parts, press the unlocking button (C2 or G2), and pull the items apart.

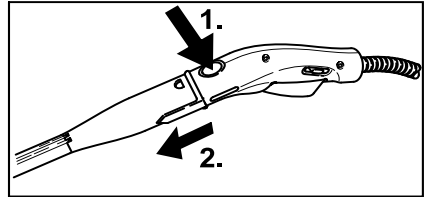

Figure 3

Fill up with water

Note: *If you always use usual commercial distilled water it is not necessary to descale the boiler.*

CAUTION

Do not use condensation water from the drier! Do not fill in detergents or other additions!

- Remove the safety clamp (A3) from the device.
- Empty remaining water from boiler.
- Fill the boiler with a maximum of 1.2 liters of fresh tap water.

Note: *The boiler can be filled up to 2 cm below the edge of the filler neck. You can cut down the heating-up time by using warm water.*

- Screw the safety clamp (A3) back onto the device.

Turning on the Appliance

- Place the unit securely on a firm surface.
Note: Do not carry the unit while cleaning.

CAUTION

Do not turn the appliance on without water in the boiler. Otherwise, the appliance may overheat (see troubleshooting).

- Insert the mains plug into a socket.
- Press the switch (A2) to turn on the appliance.

The orange indicator lamp glows.

- The orange indicator lamp (B2) goes out after approximately 8 minutes. The steam cleaner is ready to use.
- Push the steam switch lock (C3) to the back.

Note: If you push the lock (C3) backwards, the steam switch (C4) cannot be actuated (child control).

- While operating the steam switch (C4), always direct the steam gun (C1) at a separate piece of cloth until the steam is emitted evenly.

Note: The heating of the steam cleaner is turned on in regular intervals during the operation of the appliance in order to maintain the pressure in the boiler at a constant level. When the heating is turned on, the orange indicator lamp (B2) lights up.

Adjusting the Steam Quantity

- Use the steam switch (C4) to regulate the discharged steam.
- The lock also (C3)
 - Switch in front position: no steam (child control)
 - Switch in middle position: reduced steam amount
 - Switch in back position: maximum steam amount

Refilling Water

The steam pressure will sink if the boiler is empty. Then the red control light will indicate low water (B1).

To immediately refill water, the remaining steam pressure can be discharged quickly while the control light indicates low water.

Note: The safety lock (A3) cannot be opened as long as slight pressure remains in the boiler.

- Push the steam lever (C4) until steam discharge stops. Now, the boiler of the appliance is unpressurized.

⚠ DANGER

A residual amount of steam may be emitted when you open the safety lock. Be careful when opening the safety lock, there is a risk of scalding.

- Remove the safety clamp (A3) from the device.
- Press the switch (A2) to turn off the appliance.

⚠ DANGER

If the boiler is hot, there is the risk of scalding as the water may splash back during the filling process! Do not fill any detergents or other additives into the boiler!

- Fill the boiler with a maximum of 1.2 liters of fresh tap water.
- Screw the safety clamp (A3) back onto the device.
- Press the ON/OFFswitch to turn on the appliance.
- The orange indicator lamp (B2) goes out after approximately 8 minutes. The steam cleaner is ready to use.

Turning Off the Appliance

- Press the ON/OFFswitch to turn off the appliance.
- Disconnect the mains plug from the socket.
- Pull the steam plug (C6) from the appliance connector (A1).

How to Use the Accessories

Important application instructions

Cleaning of Textiles

Before you use the steam cleaner for the cleaning of textiles, you should always test the resistance of the fabrics against steam by means of cleaning a hidden spot. Apply steam to the hidden spot, and then let it dry. Check whether the colour and shape of the area have changed.

Cleaning of Coated or Lacquered Surfaces

WARNING

Never direct the steam jet at glued edges as the edge band may loosen. Do not use the steam cleaner on wooden or parquet floors that have not been sealed.

Be careful when you clean kitchen and living room furniture, doors, parquet, lacquered or plastic-coated surfaces! Upon a longer influence of steam, wax, furniture polish, plastic coatings, or paint may come off, or stains may occur. Therefore, you should only clean such surfaces using a piece of cloth to which steam has been applied or very briefly using a double layer of cloth on the nozzle.

Cleaning of Glass

WARNING

Never direct the steam jet directly at the sealed parts of the window around the window frame to prevent damages of the sealing.

In case of low outside temperatures, especially in the winter, warm up the window pane. Apply a small quantity of steam to the entire glass surface. Thus, you compensate temperature differences and avoid stresses in the glass surface. This is of importance because glass surfaces that are heated unevenly may crack.

Steam gun (C1)

You can use the steam gun without any additional accessories.

Application:

- elimination of odours and creases from garments: Apply steam to the hanging garment from a distance of 10–20 cm.
- Removing dust from plants: Respect a distance of 20-40 cm.
- dusting with a damp cloth: Apply a small amount of steam to a cloth, and then use this cloth to wipe over the furniture.

Detail nozzle (D1)

The closer you hold the nozzle to the dirty spot, the higher the cleaning effect as temperature and pressure of the steam reach their maximum values immediately when they are emitted from the nozzle.

Application:

- Fittings, drains
- Wash-basins, toilets
- Blinds, radiators
- Stain removal: Moisten stubborn limestone with vinegar, and allow to react for approximately 5 minutes.

Round brush (D2)

Note: *The round brush is not suited for the cleaning of delicate surfaces.*

The extension piece is attached to the detail nozzle.

Application:

- locations that are difficult to access, such as corners and joints
- Fittings, drains

Manual nozzle (E1)

Pull the terry cloth cover (E2) over the manual nozzle.

Application:

- small, washable surfaces, such as kitchen surfaces made of plastic, tiled walls
- Shower cabins, mirror
- Furniture fabrics
- Vehicle interior, windshields
- Bath-tubs

Squeegee (F1)

Application:

- Windows, mirrors
 - Glass surfaces on showers
 - other smooth surfaces
- Perform a fat dissolving basic cleaning using the manual nozzle (E1) and a terry cloth cover (E2) before the first cleaning using the window nozzle.
- Apply steam to the glass surface from a distance of approximately 20 cm until the surface is moistened evenly.
- Strip the glass surface in straight lines from the top to the bottom using the rubber lip of the window nozzle. Wipe the rubber lip and the bottom edge of the window dry after each strip.

Floor nozzle (H1)

Application:

- all washable wall and floor coverings, e.g.: Stone floors, tiles, and PVC floors.
- Attach the floor cloth to the floor nozzle.
- 1 Fold the floor cloth the long way and place the floor nozzle on top of it.
 - 2 Open holding clamps.
 - 3 Place the cloth ends into the openings.
 - 4 Close the holding clamps.

Caution

Do not insert fingers between the clamps.

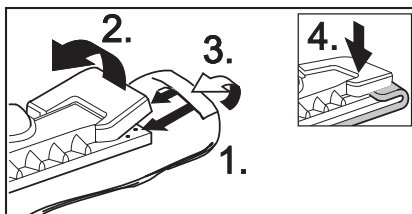

Figure 4

- To remove the cloth, press the retaining clips (H2), and pull out the cloth.
- Turn and exchange the floorcloth in regular intervals. Thus, you improve the ability to pick up dirt.
- Work slowly on very dirty surfaces to allow the steam to act on the dirt for a longer period of time.
- If there are residues of detergents or floor cleaning products (e.g. wax, liquid polish) on the surface to be cleaned, streaks may form during the cleaning. These streaks normally disappear after a repeated use of the steam cleaner.

Special accessories

Set of micro-fibre dusters "Bath"

(order no. 2.863-171)

- 2 soft bath towels made of plush velours.
- 1 Abrasive cover for hand nozzle.
- 1 polishing cloth for mirror and bathroom fittings

Set of micro-fibre dusters "Kitchen"

(order no. 2.863-172)

- 2 soft floor towels made of plush velours.
- 1 soft cover for hand nozzle made of plush velours.
- 1 cloth for streak-free cleaning of stainless steel surfaces.

Set of micro-fibre dusters for floor nozzle

(Order no. 2.863-173) - 2 soft floor towels made of plush velours.

Set of micro-fibre dusters for hand nozzle

(order no. 2.863-174)

- 1 soft cover made of plush velours.

Round brush kit (order no. 2.863-058)

4 round brushes for the detail nozzle.

Round brush kit with brass bristles

(order no. 2.863-061)

3 round brushes for the detail nozzle (for particularly stubborn dirt)

Terry cloths (order no. 6.369-357)

- 5 floorcloths

Terry covers (order no.6.3710-990)

- 5 covers

Decalcifier sticks

(order no. 6.295-206)

Round brush with scraper

(order no. 2.863-140)

Window nozzle (order no. 4.862-115)

Rubber lip for window nozzle

(order no. 6.273-140)

Steam turbo-brush

(order no. 2.863-159)

Extension (order no. 5.762-236)

Detail nozzle extension

Power nozzle (order no. 5.762-326)

Detail nozzle attachment

Maintenance and care

⚠ **DANGER**

Always disconnect the mains plug and allow the steam cleaner to cool down before performing any maintenance work.

Note: *If you always use usual commercial distilled water it is not necessary to descale the boiler.*

Rinsing the boiler

Rinse the steam cleaner boiler at the latest after 5 boiler fillings.

- ➔ Fill the boiler with water and shake it strongly. This dissolves lime scaling residing on the boiler bottom.
- ➔ Empty water out.

Descaling the boiler

As limescale builds up on the boiler walls, we recommend to descale the boiler in the following intervals (RF=reservoir fillings):

Degree of hardness	° dH	mmol/l	RF	
I	soft	0- 7	0-1,3	55
II	medium	7-14	1,3-2,5	45
III	hard	14-21	2,5-3,8	35
IV	very hard	>21	>3,8	25

Note: *Please contact your Conservancy Board or the local water supply company to inquire about the hardness of your water.*

- ➔ Disconnect the mains plug from the socket.
- ➔ Completely empty the steam boiler.

⚠ **WARNING**

Only use products approved by Kärcher to exclude any damages of the appliance.

- ➔ Use the KÄRCHER decalcifier sticks (order no. 6.295-206) for decalcifying the water. Please follow the dosing instructions on the packaging while using the decalcifying solution.

⚠ **Caution**

Use caution when filling and emptying the steam cleaner. The descaling solution can have an aggressive effect on delicate surfaces.

- Pour the descaling solution into the boiler and allow it to react for approximately 8 hours.

⚠ WARNING

Do not screw the steam boiler cap on the appliance during the descaling. Do not use the steam cleaner as long as there is descaling agent in the boiler.

- Empty the descaling solution after 8 hours. A small amount of the solution will remain in the boiler. Therefore, you should rinse the boiler two to three times with cold water to remove any residues of the descaler.
- The steam cleaner is now ready for use again.

Care of the Accessories

Allow the accessory parts to dry completely before storing them.

- Do not place the floor nozzle (H1), the manual nozzle (E1), and the round brush (D2) onto the bristles during the cooling and drying process to avoid a deformation of the bristles.

Note: *The floorcloth and the terry cloth cover have been pre-washed and can be used immediately for working with the steam cleaner.*

- You can wash dirty floorcloths and terry cloth covers in the washing machine at 60°C. Do not use a liquid softener as this would affect the ability of the cloths to pick up dirt. You may tumble dry the cloths.

Troubleshooting

Often, failures have simple causes and you can do the troubleshooting yourself using the following overview. If you are in doubt or if the failure is not listed here please contact the authorized customer service.

⚠ Risk of electric shock!

Repair works may only be performed by the authorized customer service.

Long heating-up time

Steam boiler is decalcified.

- Descale the steam boiler.

No steam

Red low-water indicator lamp lights up.

No water in the steam boiler. Water scarcity thermostat switches off the heating.

- Turn off the appliance.
- See "Refilling Water" Page 8

Steam lever cannot be pressed anymore

Steam switch is secure with the lock / child-proof lock (C3).

- Push the steam switch lock (C3) to the back.

Check the steam plug

The steam plug is not completely inserted into the unit plug socket.

- Tightly insert the steam plug into the appliance connector. The plug must click into place audibly.

Spare Parts

Only use original KÄRCHER spare parts. You will find a list of spare parts at the end of this document.

Helpline

KÄRCHER UK Limited operate a helpline allowing customers to discuss any problems experienced with our products. The helpline operates during normal business hours and may be busy at peak periods. If you have difficulty getting through we would ask that you try to contact us again later in the day.

The helpline number is 01295 752200, open from 8.30 am to 5.00 pm Monday to Friday.

It helps us if you have the model number and data plate details to hand before making your call so that we can assist you with your query more effectively.

Alternatively you may write to us at the address below:

KÄRCHER UK Ltd
Kärcher House
Beaumont Road
Banbury
Oxon, OX16 1TB

or E-mail us:

info@karcher.co.uk

Technical specifications

Power connection

Voltage	220-240 V
Current type	1~ 50/60 Hz
Protective class	I
Protection class	IPX4

Performance data

Heating output	1400 W
Operating pressure max.	3,0 bar
Heating time per litre of water	7 min
Max. steam quantity	50 g/min

Dimensions

Boiler capacity	1,2 l
Weight (without accessories)	3 kg
Width	190 mm
Length	360 mm
Height	290 mm

Warranty

The warranty terms published by the relevant sales company are applicable in each country. We will repair potential failures of your appliance within the warranty period free of charge, provided that such failure is caused by faulty material or defects in manufacturing. In the event of a warranty claim please contact your dealer or the nearest authorized Customer Service centre. Please submit the proof of purchase.

Spare parts

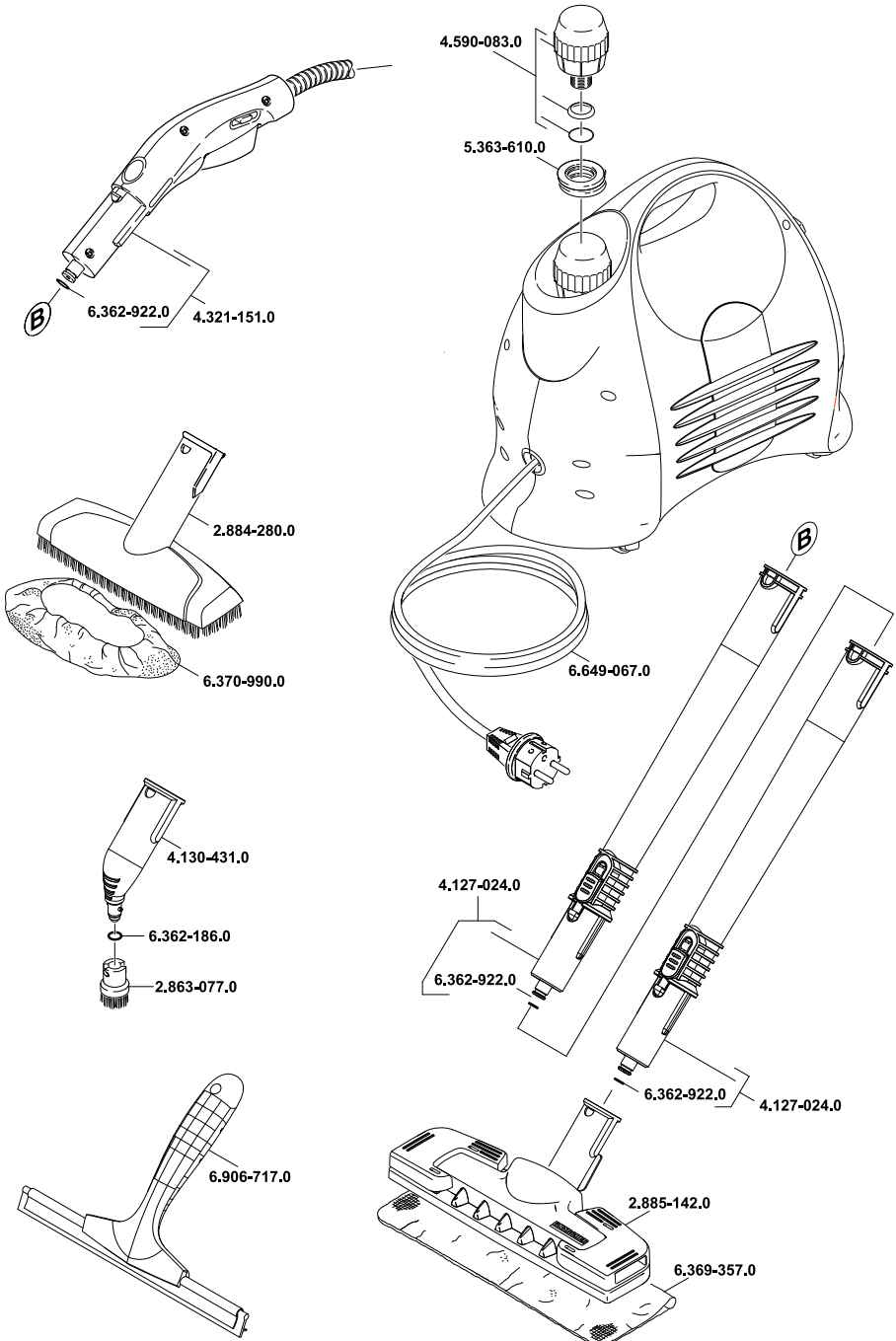

5.963-185.0 02.12.2009



www.karcher.co.uk

Free Manuals Download Website

<http://myh66.com>

<http://usermanuals.us>

<http://www.somanuals.com>

<http://www.4manuals.cc>

<http://www.manual-lib.com>

<http://www.404manual.com>

<http://www.luxmanual.com>

<http://aubethermostatmanual.com>

Golf course search by state

<http://golfingnear.com>

Email search by domain

<http://emailbydomain.com>

Auto manuals search

<http://auto.somanuals.com>

TV manuals search

<http://tv.somanuals.com>