



Model K 5500

Part No. 1.195-107.0

Vacuum Cleaner Operator Manual

Contents

- K 5500 model overview 1-2
- Filter performance 2
- Safety Instructions 3
- Assembling and operating the cleaner
 - Preparation 4
 - Attaching the accessory holder 4
 - Setting the suction tube 4
 - Filling the water filter container 4-5
 - Switching on 5
 - Working with the carpet turbo nozzle, hard floor nozzle, crevice nozzle, upholstery nozzle and furniture brush ... 6
 - Suction control 6
 - Wet vacuuming 6
 - Taking a break 7
 - Storage of accessories 7
 - Shutdown, transporting and storing ... 7
- Care / Maintenance
 - Cleaning the appliance and accessories 8
 - Changing the intermediate filter 8
 - Changing the HEPA combination filter . 8
 - Cleaning the suction manifold in the water filter container 9
- Service
 - Warranty 9
 - Customer service 9
 - Technical specifications 9
 - Circuit diagram 9
 - Troubleshooting 10
 - Assembly diagram 11

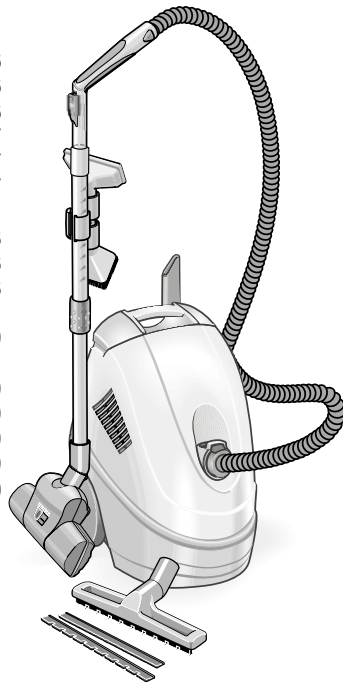

USA: 1-800-537-4129
www.karcher-usa.com

CAN: 1-800-465-4980
www.karcher.ca

MEX: 01-800-024-13-13
www.karcher.com.mx

Manual Part No. 5.960-032.0

MODEL 5500 OVERVIEW

Note: When unpacking the appliance, make sure that all listed parts are supplied. Please inform your dealer if there has been any damage during transportation.

Item Description

- 1. ON / OFF Switch**
Press to switch on; press again to switch off.
- 2. Cord rewind button**
Press to wind up the cable.
- 3. Carpet turbo nozzle**
Can be adjusted to clean different types of carpet. Ideal for deep cleaning.
- 4. Stainless steel telescopic suction tube**
Infinitely variable length adjustment for ergonomic handling.
- 5. Fine nozzle**
For gentle cleaning of furniture and dusting books.
- 6. Upholstery nozzle**
For cleaning upholstery, etc.
- 7. Handle with soft grips**
Suction performance variable using false-air slide.
- 8. Suction hose**
Flexible and sturdy hose for convenient vacuuming. Easily detachable for service and storage.
- 9. Accessory holder**
For furniture brush and upholstery nozzle.
- 10. Crevice nozzle**
For edges, crevices and around radiators.
- 11. Carry handle**
For carrying the appliance on stairs, etc.
- 12. Hard floor nozzle**
Includes nylon and natural bristle brushes for different types of hard surfaces.

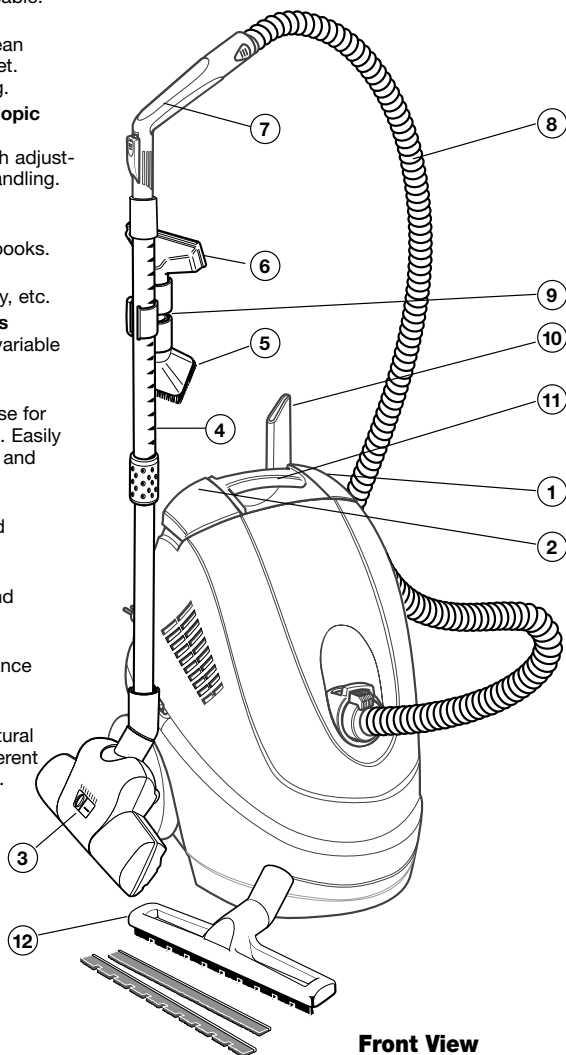

Front View

MODEL 5500 OVERVIEW - continued

Item Description – Continued

- 13. Intermediate filter**
Filters suspended matter and protects the suction turbine.
- 14. Container cover**
- 15. Air guard**
- 16. Water filter container**
Filters the vacuumed up dirt in the water bath.
- 17. HEPA-Plus filter**
consists of:
HEPA filter
Filters 99.99 % of all particles over 0.3 micron in size.
Exhaust air filter
Filters the cooling air of the suction turbine (not pictured).
- 18. Anti-foaming liquid**
(Kärcher foam stop, not pictured)
- 19. Allergy guide** (not pictured) In this brochure we deal with the increasingly important topic of allergies and their causes. You will find it worthwhile to spend a little time reading this brochure.

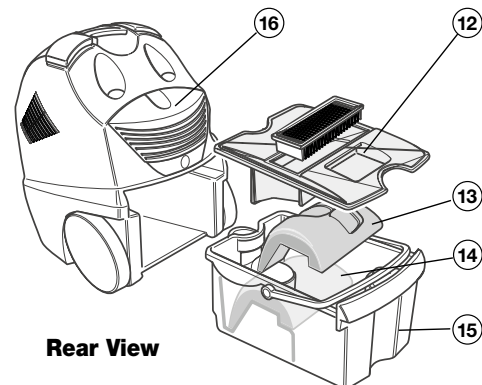

Rear View

FILTER PERFORMANCE

The K 5500 vacuum cleaner features a completely new Kärcher water filter system which picks up even the smallest particles. The additional HEPA-Plus high-performance filter catches all allergens. 99.99 % of all particles over 0.3 microns in size are removed from the exhaust air which is then cleaner than the ambient air.

The supplied items illustrated on these pages are intended to give you an overview of the appliance and accessories. Information on operating the appliance can be found on the following pages.

The effect of the Kärcher water filter vacuum cleaner

Water filter K 5500	Intermediate filter	HEPA
Respirable particles	98 %	99.99 %
Fine dust	98 %	99.99 %
Domestic dust mites (excretions)	98 %	99.99 %
Bacteria	98 %	99.99 %
Dust	98 %	99.99 %
Spores	98 %	99.99 %
Pollen	98 %	99.99 %
Coarse dirt (animal hair, fluff, crumbs)	98 %	99.99 %

Filtration efficiency (%) of all particles over 0.3 μm in size

IMPORTANT SAFETY INSTRUCTIONS – Read First!

Safety Warnings

When using an electrical appliance, basic precautions should always be followed, including the following:

READ ALL INSTRUCTIONS BEFORE USING THIS APPLIANCE

WARNING—To reduce the risk of fire, electric shock, or injury:

1. Do not leave appliance when plugged in. Unplug from outlet when not in use and before servicing.
2. **WARNING**—To Reduce The Risk Of Electric Shock. Do not use outdoors or on wet surfaces."
3. Do not allow to be used as a toy. Close attention is necessary when used by or near children.
4. Use only as described in this manual. Use only manufacturer's recommended attachments.
5. Do not use with damaged cord or plug. If appliance is not working as it should, has been dropped, damaged, left outdoors, or dropped into water, return it to a service center.
6. Do not pull or carry by cord, use cord as a handle, close a door on cord, or pull cord around sharp edges or corners. Do not run appliance over cord. Keep cord away from heated surfaces.
7. Do not unplug by pulling on cord. To unplug, grasp the plug, not the cord.
8. Do not handle plug or appliance with wet hands.
9. Do not put any object into openings. Do not use with any opening blocked; keep free of dust, lint, hair, and anything that may reduce air flow.
10. Keep hair, loose clothing, fingers, and all parts of body away from openings and moving parts.
11. Turn off all controls before unplugging.
12. Use extra care when cleaning on stairs.
13. Do not use to pick up flammable or combustible liquids, such as gasoline, or use in areas where they may be present.

14. Always turn off this appliance before connecting or disconnecting motorized nozzle.
15. Hold plug when rewinding onto cord reel. Do not allow plug to whip when rewinding.
16. This appliance is provided with double insulation. Use only identical replacement parts. See instructions for Servicing of Double-Insulated Appliances.
17. Do not pick up anything that is burning or smoking, such as cigarettes, matches, or hot ashes.
18. Do not use without all filters in place.

SAVE THESE INSTRUCTIONS!

SERVICING OF DOUBLE-INSULATED APPLIANCES

In a double-insulated appliance, two systems of insulation are provided instead of grounding. No grounding means is provided on a double-insulated appliance, nor should a means for grounding be added to the appliance. Servicing a double-insulated appliance requires extreme care and knowledge of the system, and should be done only by qualified service personnel. Replacement parts for a double-insulated appliance must be identical to the parts they replace.

Customer Service

USA: 1-800-537-4129
www.karcher-usa.com

CAN: 1-800-465-4980
www.karcher.ca

MEX: 01-800-024-13-13
www.karcher.com.mx

ASSEMBLY INSTRUCTIONS

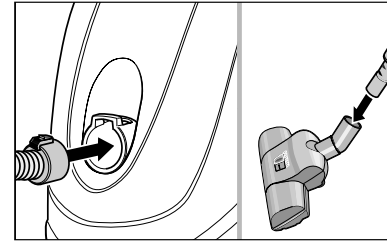

1. Preparation

- Connect the suction hose
- Connect the telescopic suction tube and carpet turbo nozzle.

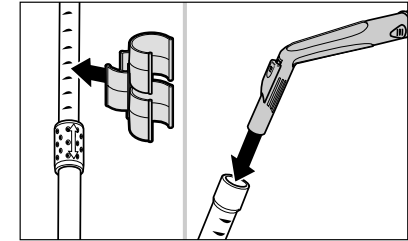

2. Attaching the accessory holder

- Connect the handle to the telescopic suction tube.

The accessory holder is for storing the furniture brush and upholstery nozzle.

OPERATING INSTRUCTIONS

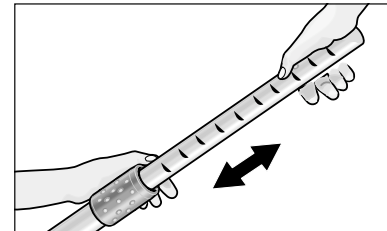

1. Setting telescopic suction tube

- Unlock the tube by moving the lock ring and set the tube to the desired length by drawing the inner pipe out or by sliding it in further.

You can vacuum in a comfortable, upright position by setting the telescopic suction pipe to suit your height.

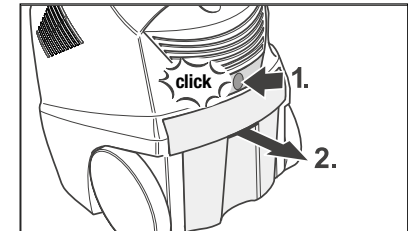

2. Filling the water filter container

- Press the unlock button and pull out the water filter container.

The appliance is delivered with the intermediate filter and curved air guard already assembled. When filling the container, ensure that these components (see: Supplied items) have been assembled correctly. They may be the cause of poor suction performance or premature failure of the intermediate filter.

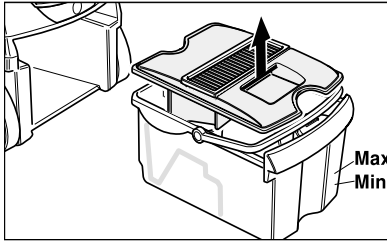
OPERATING INSTRUCTIONS – continued

- Remove the cover from the water filter container and fill the water filter container up to the MAX mark with tap water (approximately 2 liters or 1/2 gallon).

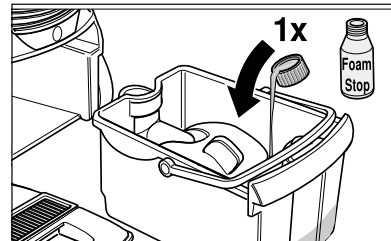

- Add a capful of anti-foaming liquid (Kärcher Foam Stop) to the water filter container.

The vacuum cleaner operates on the basis of swirling suction air into the water filter. The vacuumed material and detergent residues from the floor covering are being filtered in the water bath. Under certain circumstances this may result in the formation of foam. To prevent this, add a capful of anti-foaming liquid to the water filter bath. The anti-foaming liquid is environmentally friendly and completely biodegradable. Slight foam formation during operation is normal and does not impair function.

5

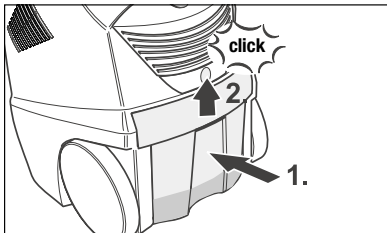

- Re-attach the cover. Push in the water filter container all the way and pull up until it "clicks" into position.

If the water level in the container drops below the "MIN" mark during operation, please refill with water.

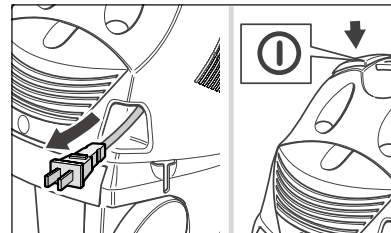
**3. Switching on**

- Unwind the power chord completely and insert the plug into the power outlet.
 - To switch on, press the On/Off switch.
- Do not vacuum large quantities of powdered substances such as cocoa, flour, washing powder, custard powder, etc.

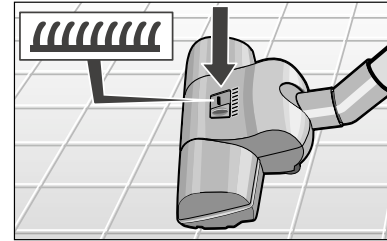
OPERATING INSTRUCTIONS – continued**4. Using the carpet turbo nozzle**

Slide the turbo control switch on the floor nozzle to a regulate the brushing action. Full closed (+) increases brushing action for deep pile carpets and full open (-) for

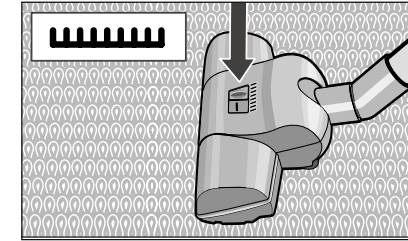
**5. Use and assembly of the hard floor nozzle**

The hard floor nozzle includes nylon and natural bristle brush inserts for cleaning smooth hard surfaces. Use the nylon brush set for ceramic tile or similar scratch resistant surfaces. Use the soft natural brushes for finished wood floors or other scratch sensitive surfaces. To change the brushes use a flat bladed screw driver or putty knife to gently pry open the plastic nozzle clips to release the brush inserts. Then slide the replacement brushes into the white plastic holder and snap holder back into place. Brushes must be replaced as a set for proper operation.

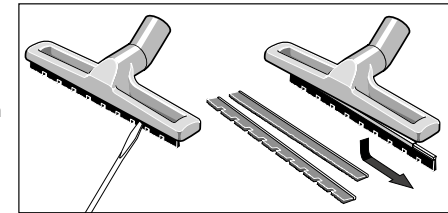

6

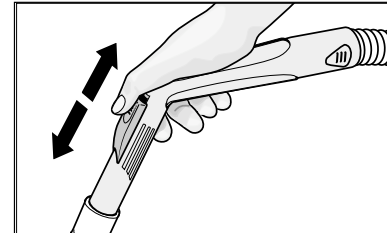
**6. Suction control (false-air slide)**

Due to the high constant suction capacity of the appliance, the suction nozzles may be too powerful for cleaning carpets, upholstery, curtains, etc. In this case use the false air slide to reduce the suction capacity. After use, close again.

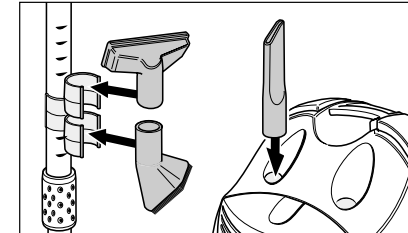
**7. Using the crevice nozzle**

Crevice nozzle: For edges, crevices, radiators, etc.

Upholstery nozzle: For cleaning upholstery and curtains

Furniture brush: (can be rotated 360°) For gentle cleaning of furniture, dusting books, dashboards, etc.

8. Wet vacuuming

Use either the crevice nozzle, upholstery nozzle or the hard surface nozzle with the nylon bristles for vacuuming wet surfaces (do not use the carpet turbo nozzle for wet surfaces).

- When the water filter container is empty, up to 2.5 liters or 1/2 gallon of liquid can be vacuumed.

Damp dirt or small quantities of liquid up to approximately 0.5 liters or 2 cups can be vacuumed at any time when the water filter container is full. Use the crevice nozzle or the handle without attached accessory.

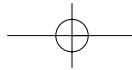

OPERATING INSTRUCTIONS – continued

9. Storage of accessories

- After use, attach upholstery nozzle and furniture brush to the accessory holder.
- Store the crevice nozzle and the Kärcher foam stop on the appliance.

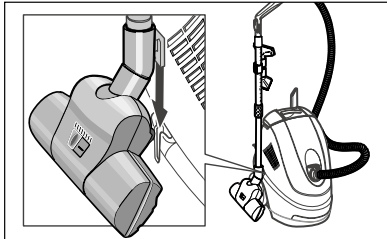

10. Taking a break

- To switch off, press the On/Off button.
- If taking a break from work, attach the floor nozzle to the appliance.

7

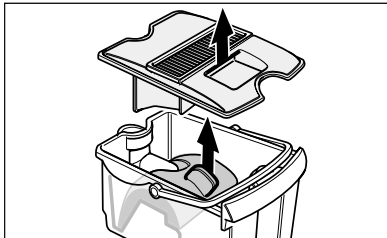

- Take the water filter container out of the appliance (see: Filling the water filter container).
- Remove the cover and air guard.
- Empty the water filter container via one of the corners.

CAUTION

- All parts of the water filter system, especially the intermediate filter, must be dried thoroughly before being stored!

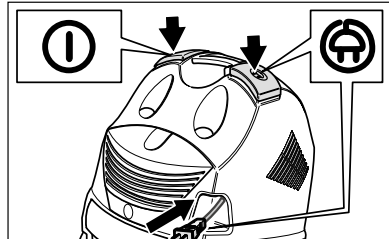

11. Shut down for storage

- To switch off, press the On/Off button.
- Pull the plug out of the power outlet.
- Press the cord rewind button. The power cord is automatically wound up.

Note: After each use, the water filter container, filter cover and baffle plate must be cleaned and dried.

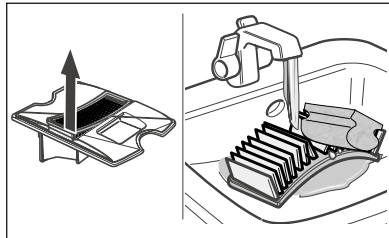

- Clean and dry the cover and water filter container.
- If the appliance is used regularly, wash the intermediate filter every 2 weeks under running water.

12. Transporting / Storing

- Transport the appliance by the carrying handle.
- To ventilate the water filter container while the appliance is in storage, do not insert container fully into the appliance.

CARE AND MAINTENANCE



WARNING • Before any care and maintenance work on the machine, unplug the power cord.

1. Cleaning the appliance and accessories

- If required, wipe down the exterior of the appliance with a damp cloth. Do not use any aggressive agents such as scouring powder.
- The suction hose and handle can be dismantled for cleaning.
- Check the accessories for blockages and, if required, clean. Do NOT use water to clean the floor nozzle.

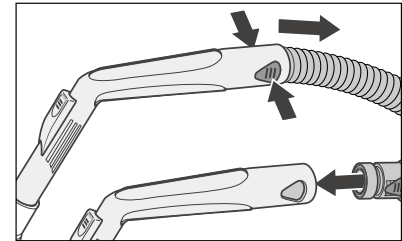

Press in on the left and right hose release clips at the same time to dismantle the hose for cleaning.

2. Changing the intermediate filter

- Under normal conditions of use please change the intermediate filter after at least 8 weeks or earlier if required (see page 2, model 5500 overview item number 13).

The intermediate filter must be disposed of in the residual waste.

3. Changing the HEPA filter

The HEPA-Plus filter consists of the HEPA filter and an exhaust air filter. To ensure that the appliance cleans and functions optimally, this filter should be changed after 15 months. If damaged or very dirty, change earlier.

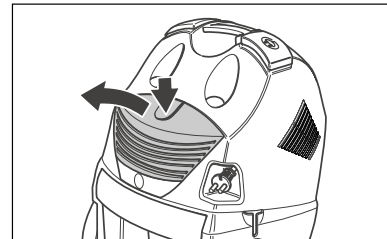

- Remove the cover.



IMPORTANT • Do not wash the HEPA-Plus filter!

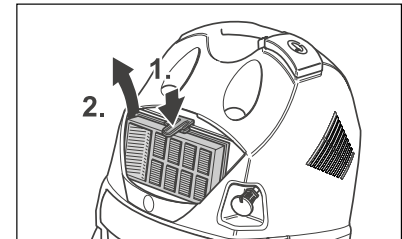

- Remove the HEPA-Plus filter.
- Insert a new HEPA-Plus filter, ensuring that it “clicks” into position.
- Attach the cover, ensuring that it “clicks” into position.

8

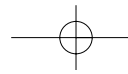

CARE AND MAINTENANCE – continued

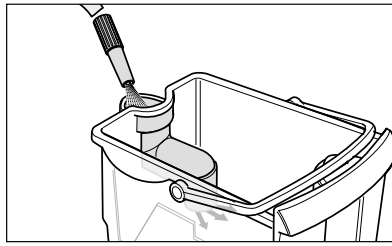

4. Cleaning the suction manifold in the water filter container

- Deposits in the suction manifold can be removed by rinsing from above with a jet of water.

SERVICE

Warranty

Please refer to the warranty card included with the product. Should you have any questions regarding the warranty please feel free to call our customer service department.

9

Customer Service

USA: 1-800-537-4129
www.karcher-usa.com

CAN: 1-800-465-4980
www.karcher.ca

MEX: 01-800-024-13-13
www.karcher.com.mx

Technical Specifications

Rated voltage	120 V
Rated frequency	60 Hz
Power P max	1400 W
Power P nom	1200 W
Vacuum	90.55 inches water lift
Air flow rate	116.54 cubic feet per minute
Capacity of water filter container	1/2 gallon
Sound level	69 dB(A)
Weight without accessories	18 3/4 pounds
Connection cable	18 feet
Dimensions	19 x 12 x 24 inches
Nominal width, accessory	Ø 1.5 inches
HEPA - Plus filter	H 12 class in compliance with EN 1822

We reserve the right to introduce technical changes without prior notice.

Circuit diagram

- S1 Vacuum motor switch
- C1 Interference suppressor
- M1 Turbine
- X1 Plug with cable rewriter

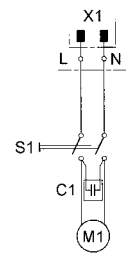

TROUBLE SHOOTING

Often symptoms have causes which you can fix yourself with the aid of the following table. In case of doubt, or if you encounter a symptom or cause not listed, please consult an authorized Customer Service center.

Symptom	Cause	Solution
Machine does not work.	Current power supply has been interrupted.	Pull out power cord, check the connection plug and power cord for damage.
Suction performance decreases during operation.	Air guard is missing or not inserted correctly.	Insert air guard correctly (see model overview page 1 & 2).
	Intermediate filter in container cover wet.	Wash and dry intermediate filter or insert a new filter (see Care / Maintenance page 7 & 8).
	Too little or too much water in the water container.	Check MIN / MAX mark on the container.
Intermediate filter in container cover is wet.	Excessive foam formation in the water filter container.	Change water and add 1–2 capfuls of Kärcher foam stop. Wash and dry intermediate filter or insert a new filter.
Suction performance inadequate.	Intermediate filter is missing or not inserted correctly.	Check.
	HEPA-Plus filter is dirty.	Change HEPA-Plus filter (see Care / Maintenance page 7 & 8).
	Intermediate filter is dirty.	Wash filter; if required, insert new filter (see Care and Maintenance page 7 & 8).
	Accessory blocked.	Remove blockage.
	Deposits in suction manifold.	Remove deposits (see Care and Maintenance page 7 & 8).
	Water container not inserted correctly.	Check (see Operation page 3 & 4).
Excessive foam formation in the container.	False air slide on handle open.	Close false air slide.
	No or inadequate Foam Stop.	Change water and add 1 capful of Foam Stop to the water filter container.

10

Repair work on this machine may only be carried out by an authorized Kärcher Service Center.

WARNING!
 To reduce the risk of fire or electric shock, do not remove this cover. No user serviceable parts inside. Repair should be done by authorized service personnel only.

Customer Service

USA: 1-800-537-4129
www.karcher-usa.com

CAN: 1-800-465-4980
www.karcher.ca

MEX: 01-800-024-13-13
www.karcher.com.mx

Free Manuals Download Website

<http://myh66.com>

<http://usermanuals.us>

<http://www.somanuals.com>

<http://www.4manuals.cc>

<http://www.manual-lib.com>

<http://www.404manual.com>

<http://www.luxmanual.com>

<http://aubethermostatmanual.com>

Golf course search by state

<http://golfingnear.com>

Email search by domain

<http://emailbydomain.com>

Auto manuals search

<http://auto.somanuals.com>

TV manuals search

<http://tv.somanuals.com>