

NT 361 Eco TEA / NT 611 Eco TEA

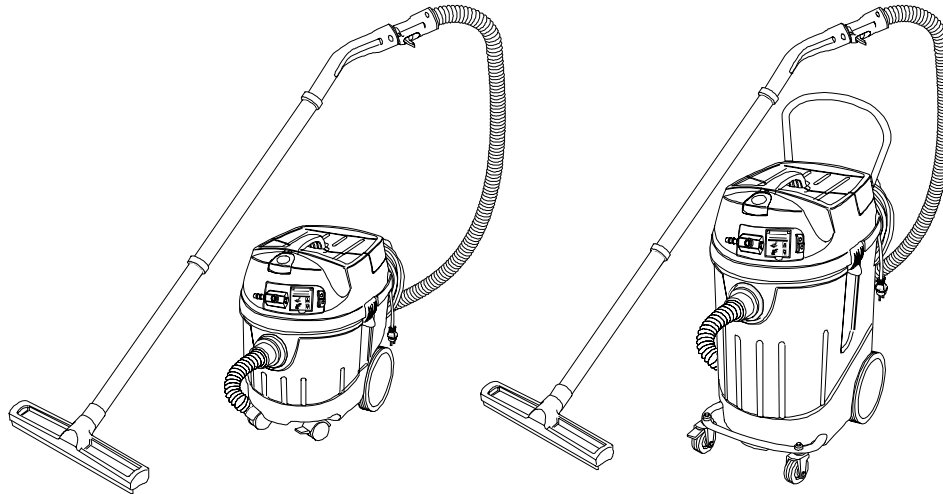

www.karcher.com

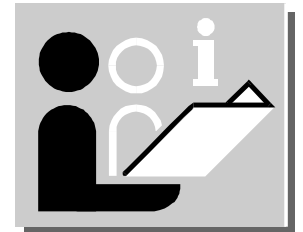

5.960-354 A2006372 07/03

NT 361 Eco TEA / NT 611 Eco TEA



Inhaltsverzeichnis	DE	Seite
Inbetriebnahme		4
Betriebsanleitung		5
Kärcher-Niederlassungen		77
Technische Daten / Schaltplan / Ersatzteilliste		78/79/80

Vor erster Inbetriebnahme Betriebsanleitung und Sicherheitshinweise Nr. 5.956-251 unbedingt lesen! Dieses Gerät ist für den gewerblichen Gebrauch geeignet, z.B. in Hotels, Schulen, Krankenhäusern, Fabriken, Läden, Büros und Vermietergeschäften.

Lists of contents	EN	Page
Commissioning		4
Operating Instructions		11
Kärcher branches		77
Technical Data / Wiring diagram / Spare Parts List		78/79/80

Prior to initial startup, operating manual and safety instructions no. 5.956-251 must be consulted! This machine is suitable for industrial use, for instance in hotels, schools, hospitals, factories, shops, offices and on hire.

Tables des matières	FR	Page
Mise en service		4
Notice d'utilisation		16
Filiales Kärcher		77
Caractéristiques techniques / Schéma de câblage / Liste des pièces de rechange		78/79/80

Avant la première mise en service, lire absolument le mode d'emploi et les 5.956-251 remarques de sécurité! Cet appareil est adapté à l'usage professionnel, p. ex. dans les hôtels, les écoles, les hôpitaux, les usines, les magasins, les bureaux et les locations.

Indici	IT	Pagina
Messa in funzione		4
Istruzioni per l'uso		21
Filiali Kärcher		77
Dati tecnici / Schema elettrico / Elenco pezzi di ricambio		78/79/80

Prima della prima messa in funzione leggere assolutamente le istruzioni per l'uso e le avvertenze per la sicurezza n. 5.956-251! Questo apparecchio è adatto per settori commerciali, per es. hotel, scuole, ospedali, fabbriche, negozi, uffici e noleggi.

Inhoudsopgave	NL	Pagina
Inbedrijfstelling		4
Gebruiksaanwijzing		27
Kärcher – filialen		77
Technische gegevens / Schakelschema / Reserveonderdelenlijst		78/79/80

**Vóór de eerste ingebruikneming de gebruiksaanwijzing en de veiligheidsinstructies nr.: 5.956-251 beslist lezen!
Dit apparaat is geschikt voor professioneel gebruik, bijv. in hotels, scholen, ziekenhuizen, winkels, kantoren en verhuurbedrijven.**

Índices	ES	Paginación
Puesta en servicio		4
Instrucciones de servicio		33
Filiales de Kärcher		77
Datos técnicos / Diagrama de conexiones / Lista de piezas de requesto		78/79/80

**Las instrucciones de servicio y las indicaciones de seguridad núm. 5.956-251 se deben leer imprescindiblemente antes de la primera puesta en servicio!
Este aparato es apropiado para el uso a escala industrial, p. ej. en hoteles, centros escolares, hospitales, fábricas, tiendas comerciales, oficinas y empresas dedicadas al alquiler.**

Índices	PT	Página
Colocação em funcionamento		4
Manual de instruções		39
Filiais da Kärcher		77
Dados técnicos / Esquema de ligações / Lista de peças sobresselentes		78/79/80

**Antes da primeira colocação em funcionamento, ler atentamente o manual de instruções e as indicações de segurança nº5.956-251!
Este aparelho destina-se ao uso industrial, nomeadamente em hotéis, escolas, hospitais, fábricas, lojas, escritórios e empresas de aluguer.**

Πίνακες περιεχομένων	EL	σελίδα
Θέση σε λειτουργία		4
Οδηγίες λειτουργίας		45
Αντιπροσωπείες Kärcher		77
Τεχνικά χαρακτηριστικά/Κυκλωματικό διάγραμμα/ανταλλακτικά		78/79/80

**Πριν από την πρώτη θέση λειτουργίας διαβάστε οπωσδήποτε τις Οδηγίες χρήσης και Υποδείξεις ασφαλείας, αρ. 5.956-251 !
Αυτή η συσκευή είναι κατάλληλη για την επαγγελματική χρήση, π.χ. σε ξενοδοχεία, σχολεία, νοσοκομεία, εργοστάσια, καταστήματα, γραφεία και εταιρείες δανεισμού συσκευών.**

NT 361 Eco TEA / NT 611 Eco TEA



Indholdfortegnelser	DA	Side
Idrifttagning		4
Driftsvejledning		51
Kärcher agenturer		77
Tekniske data / Strømskema / Reservedelsliste		78/79/80

Inden første idrifttagning skal driftsvejledningen og sikkerhedshenvisningerne nr. 5.956-251 læses!

Dette apparat er beregnet til erhvervs-mæssig brug, f.eks. i hoteller, skoler, sygehuse, fabrikker, forretninger, kontorer og udlejningsforretninger.

Innholdsfortegnelser	NO	Side
Igangsetting		4
Bruksveiledning		56
Kärcher filialer		77
Tekniske data / Koplingsskjema / Reservedelsliste		78/79/80

Før første gangs bruk må bruksanvisning og sikkerhetsanvisning nr. 5.956-251 ubetinget leses!

Denne maskinen er egnet til bruk i næringslivet, f.eks. i hoteller, skoler, sykehus, fabrikker, butikker, kontorer og utleiebutikker.

Innehållsförteckningar	SV	Sid
Idrifttagning		4
Driftinstruktion		61
Kärcher filialer		77
Tekniske data / Kopplingsschema / Reservedelslista		78/79/80

Läs noga instruktionsboken och säkerhetsanvisningarna

nr.: 5.956-251 innan aggregatet tas i bruk!

Denna apparat är lämplig för användning inom näringslivet, t.ex. hotell, skolor, sjukhus, fabriker, butiker, kontor och uthyrningsaffärer.

Sisällysluettelo	FI	Sivu
Käyttöönnotto		4
Käyttöohje		66
Kärcher-toimipisteet		77
Tekniset tiedot / Kytentäkaavio / Varaosalista		78/79/80

Ennen ensimmäistä käyttöönottoa on käyttöohje ja turvallisuusohjeet numero. 5.956-251 ehdottomasti luettava!

Tämä laite soveltuu ammattimaiseen käyttöön esim. hotelleissa, kouluissa, sairaaloissa, tehtaissa, myymälätiloissa, toimistoissa ja vuokrausliikkeissä.

Spis treści	PL	Strona
Uruchomienie		4
Instrukcja obsługi		71
Filie firmy Kärcher		77
Dane techniczne / Schemat ideowy / Lista części zamiennych		78/79/80

Przed pierwszym uruchomieniem należy koniecznie przeczytać.

Instrukcję obsługi i wskazówki dotyczące bezpieczeństwa nr 5.956-251!

do zasywania substancji płynnych.

Urządzenie to przeznaczone jest do użytku przemysłowego, np. w hotelach, szkołach, szpitalach, fabrykach, sklepach, biurach i wypożyczalniach.

NT 361 Eco TEA / NT 611 Eco TEA

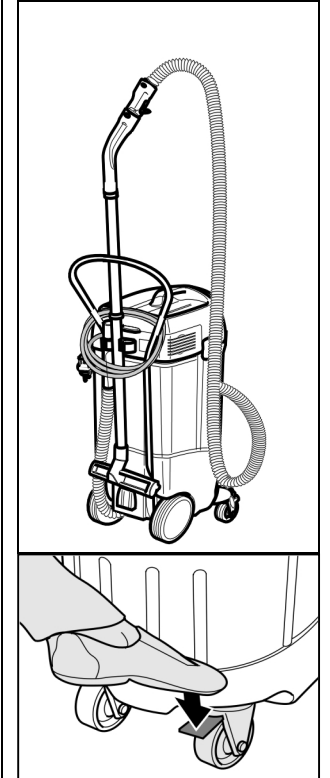
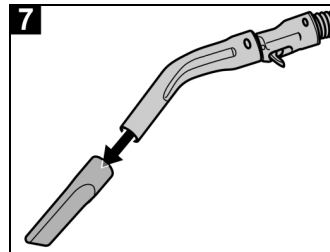
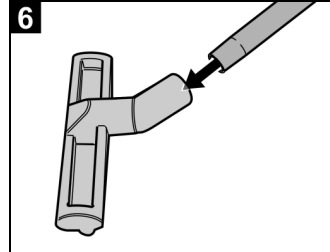
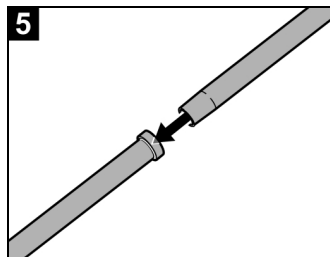
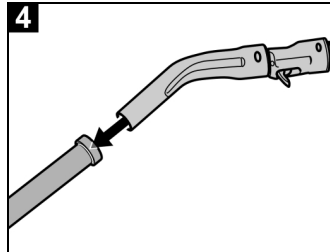
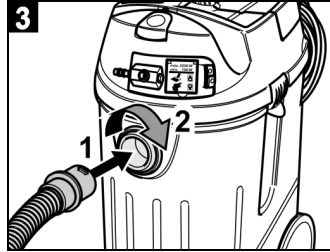
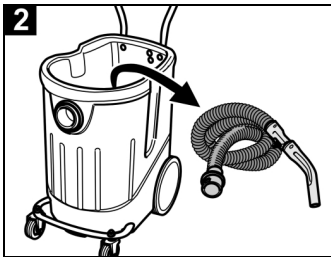
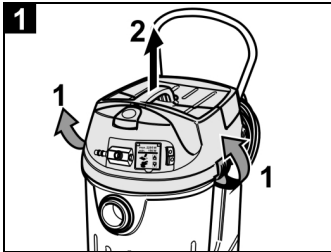
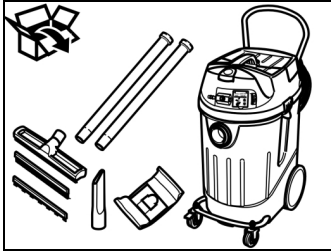

Dry suction

Manual mode



Warning!

During vacuuming it is not permitted to ever remove the flat pleated filter. A paper filter bag or a diaphragm filter (special accessories) can additionally be used to vacuum fine dust.

Fitting the paper filter bag

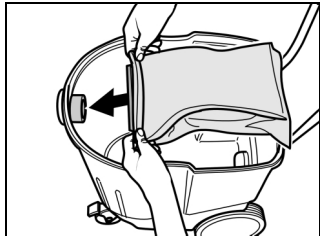

- Unlock and remove the suction head
- Attach the paper filter bag
- Replace the suction head and lock it in place

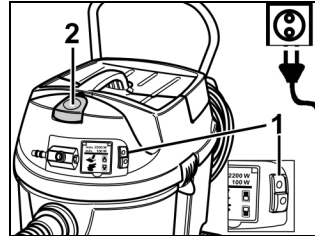

- Insert power plug
- Switch unit to manual operation (1)
- Turn on unit (2) and start operating it

Automatic operation with a pneumatic and/or a power tool

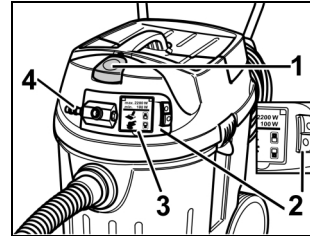

- Switch unit to automatic operation (2)
- Plug power tool's power plug into vacuum cleaner (3) or connect pneumatic tool (4) and open compressed air supply
- Switch on the machine (1)

Note:

- The vacuum cleaner is automatically started and stopped when the power tool is turned on and off.
- The vacuum cleaner has a starter delay of up to 0,5 s and an after-running time of up to 15 s.
- See page – technical data - for connected performance data of the tools.

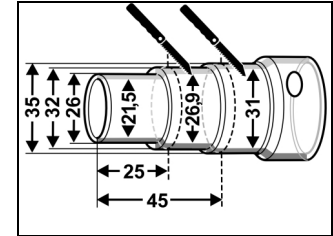

Adapt connecting sleeve to tool adaptor.

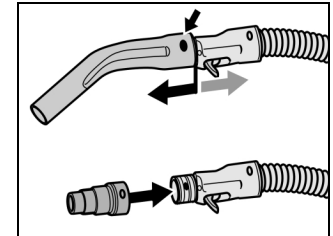

- Remove the pipe bend from the suction hose
- Install the connection sleeve to the suction hose

Optional accessories for connecting pneumatic tools

Suction hose with integrated air hose

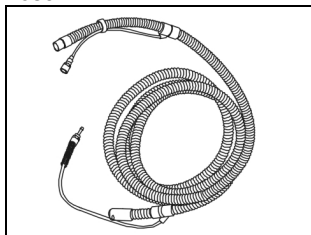

2.860-197

Suction hose with an integrated pneumatic hose especially for Festo air tools

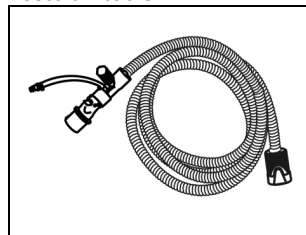

2.860-198



Warning!

Use hose 2.860-198 only if it is attached to an air tool. Direct vacuuming of dirt causes damage to the hose.

Grinding accessory set
2.639-484

Grinding accessory set, electrically conducting
2.639-485

Filter de-duster

Power Filter Clean

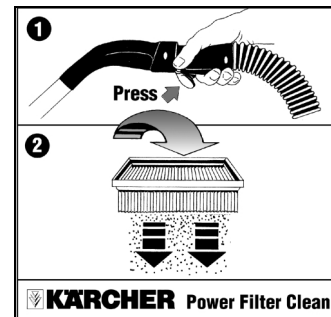

Your vacuum cleaner is provided with a new type of filter cleaner – especially effective for fine dust.

The flat pleated filter is automatically cleaned (pulsing sound) by an air blast if you press the remote control at the hand grip for several seconds

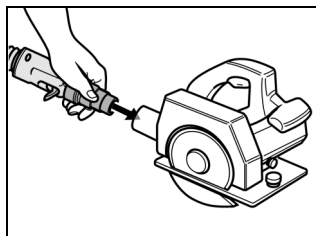

➤ Connect connecting sleeve to power tool

For pneumatic tool

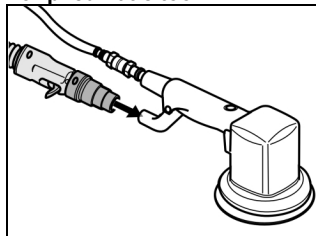

➤ Connect air hose

Switch Power Filter Clean on Slide setting (1) - downwards

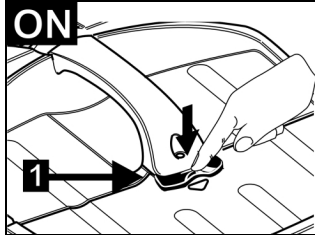

Warning!

Actuate Power Filter Clean at regular intervals during vacuuming and after finishing the vacuuming job.

Wet-vacuuming

Fitting rubber lips

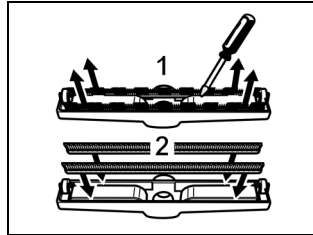

- Dismantle the strip brush (1)
- Mount the rubber squeegees (2)

Note:

The profiled surface of the rubber squeegees must be on the outside.

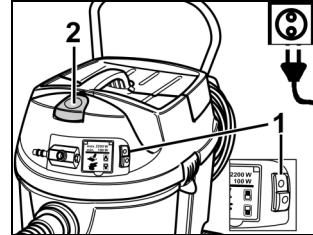

- Remove the paper filter bag
- Switch unit to manual operation (1)
- Insert power plug
- Turn on unit (2) and start operating it

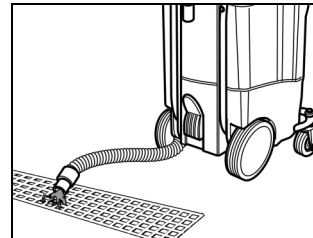

- Drain dirty water using the drain hose
- (Applies only to NT 611 Eco TEA)**

Warning!

- During vacuuming it is not permitted to ever remove the flat pleated filter.
- The paper filter bag and the membrane filter (optional accessories) respectively must always be removed for vacuuming wet dirt. The use of a special filter bag (wet type) is recommended (see filter systems).
- The unit does not switch off when the container is full when non-conductive liquids (e.g. drilling emulsion, oils and greases) are vacuumed. The fill level must be regularly checked and the container emptied before it is too full.

Switch Power Filter Clean off

- Setting of the slide (1) - upwards.

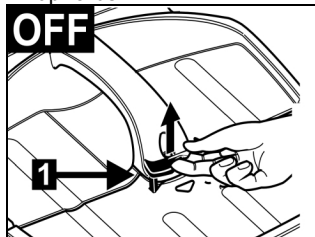

Note:

- It is advisable to switch off the - Power Filter Clean – function when vacuuming wet dirt with the upholstery or the crevice nozzles or mainly water out of a container.
- The appliance turns itself automatically off when the max. liquid level has been reached.
- Switch the appliance off and empty the container.
- Clean and dry the flat pleat filter and the electrodes as well as the container after finishing wet vacuuming jobs.

Care and maintenance



Danger!

Always pull out the mains plug when working on the suction machine.

Replacing the flat pleated filter or the exhaust air filter

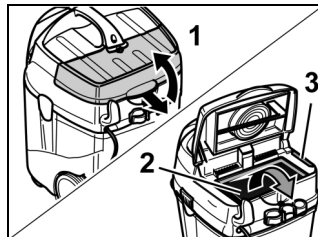

- Open the filter cover (1)
- Replace the flat pleated filter (2) or the exhaust air filter (3)
- Close filter cover, it must audibly engage

Clean electrodes

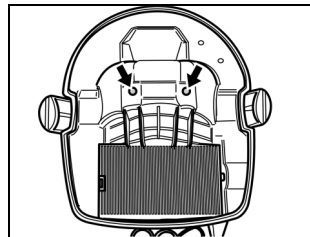

- Unlock and remove the suction head
- Clean electrodes
- Replace the suction head and lock it in place

Fault instructions

The suction turbine does not run

- Check the cable, plug, fuse and socket.
- Switch on the machine.

The suction turbine switches off

- Empty the container.

The suction turbine does not restart following emptying of the container

- Switch the appliance off and wait for 5 s, switch it on again after 5 s.
- Clean the electrodes as well as the space between them.

The suction power decreases

- Remove the parts clogging up the suction nozzle, the suction tube, the Power Filter Clean handle, the suction hose or the flat pleat filter.
- Change the paper filter bag.
- Actuate the filter cleaner: Power Filter Clean several times at the handle.
- Engage the filter cover properly.
- Replace the flat pleat filter.

Dust ejects when sucking

- Check the proper mounting position of the flat pleat filter.
- Replace the flat pleat filter.

The (wet-vacuuuming) automatic switch-off does not respond

- Clean the electrodes as well as the space between them.
- Constantly check the filling level for an electrical non-conductive liquid.

Power Filter Clean switches regularly

- Detach blocked suction nozzle or end of hose.
- Stop continuous vacuuming from liquid-containing container or switch off - Power Filter Clean – function (see chapter on wet vacuuming).
- Remove the parts clogging up the suction nozzle, the suction tube, the Power Filter Clean handle, the suction hose or the flat pleat filter.
- Replace the flat pleat filter.

EC conformity declaration

We hereby declare that the machine specified below as the marketed design, the machine specified below complies with the relevant fundamental safety and health requirements of the EC directives listed below.

Modification of the machine without our approval invalidates this declaration.

Product: Wet/dry vacuum
 Type: 1.145-xxx 1.146-xxx
 1.184-xxx

Relevant EC directives

EC machine directive (98/37/EC)
 EC low voltage directive (73/23/EEC) amended by 93/68/EEC
 EC directive on electromagnetic compatibility (89/336/EEC) amended by 91/263/EEC, 92/31/EEC, 93/68/EEC

Applied harmonised standards

DIN EN 60335-1
 DIN EN 60335-2-69
 DIN EN 61000-3-2:2000
 DIN EN 61000-3-3:1995 + A1:2001
 DIN EN 55014-2:1997
 DIN EN 55014-1:2000 + A1:2001

Internal measures ensure that the in series produced units always comply with the requirements of current EC directives and applied standards. The signatories act for and in authority of management.

5.957-602 (02/03)

Alfred Kärcher Limited Partnership.
 Registered office: Winnenden.
 Company Register: Waiblingen, HRA 169.
 Personally liable partner. Kärcher Reinigungstechnik GmbH.
 Registered office Winnenden, 2404 Waiblingen Company Register, HRB

Managing directors:

Dr. Bernhard Graf,
 Hartmut Jenner, Georg Metz

Alfred Kärcher GmbH & Co. KG
 Cleaning Systems
 Alfred-Kärcher-Strasse 28-40
 P.O.Box 160
 D-71349 Winnenden
 Phone: ++49 7195 14-0
 Fax :++49 7195 14-2212



(Reiser Jenner)

NT 361 Eco TEA / NT 611 Eco TEA

AT

Alfred Kärcher Ges. m.b.H.
Lichtblaustraße 7
A-1220 Wien

AU

Kärcher (Pty.) Ltd.
2/158 Browns Road
Noble Park 3174
Melbourne, Vict.

BE, LU, NL

Kärcher Benelux
Industrieweg 12
2320 Hoogstraden

BR

Kärcher Indústria e Comércio Ltda.
Av. Prof. Benedicto Montenegro

n°419

Paulinia – Estado de Sao Paulo
CEP 13.140-000

CA

Kärcher Cleaning Systems Inc.
1770 Alstep Drive
Mississauga, Ontario L5S1W1

CH

Kärcher Variorapid AG
Industriestr. 16
CH - 8101 Dällikon

CZ

Kärcher spol. S. r. a.
Za Mototschnou
155 00 Praha – Stodůlky

DE

Alfred Kärcher GmbH & Co. KG
Vertrieb Deutschland
Friedrich - List - Straße 4
D - 71364 Winnenden

DK

Kärcher A/S
Gejihavegaard 5
DK – 6000 Kolding

ES

Kärcher S.A.
Pol. Industrial Font del Radium
Calle Doctor Trueta 6-7
E - 08400 Granollers (Barcelona)

FR

Kärcher S.A.
Z.A. des Petits Carreaux
5, avenue des Coquelicots
F - 94865 Bonneuil s. Marne/CEDEX

FI

Kärcher Oy
Yrittäjätie 17
FIN - 01800 Klaukkala

GB

Kärcher (U.K.) Ltd.
Kärcher House
Beaumont Road
Banbury Oxon, OX 16 7TB

GR

Kärcher S.A.
Cleaning Systems
99 Aristoutelous & Ioanninou
GR - 136 71 Aharnes

HU

Kärcher Hungaria Kft.
H-2051 Biatorbagy (Vendelpark)
Tormasret ut 2
Tel.: +36/23530 Fax.: +36/23530-341
E-mail: info@kaercher.hu

HK

Kärcher Ltd.
Unit 10, 17/FL. APEC Plaza
49 Hoi Yuen Road
Kwun Tong, Kowloon

IT

Kärcher S.p.A.
Via Elvetia 4
I - 25050 Cantello (VA)

JP

Kärcher (Japan) Co., Ltd.
Irene Kärcher Building
No. 2, Matsusaka-Daira 3-chome
Taiwa-cho, Kurokawa-gun
Miyagi, 981-34, Japan

NO

Kärcher AS
PO Box 114 Grorud
N - 0905 Oslo

PT

Neoparts
Comercio e Indústria Automóvel, Lda
Largo Vitorino Damásio. 10
1200 Lisabon

PL

Kärcher Poland Ltd.
Sp. zo. o.
Ul. Godlewskiego 22
30-198 Kraków

SE

Kärcher AB
Box 24
S - 42502 Hisings - Kärra

USA

Alfred Kärcher Inc.
P.O. Box 6510
1600 Cottontail Lane
Somerset, NJ 08875

ZA

Kärcher (Pty.) Ltd.
P.O. Box 2417
Kempton Park 1620

NT 361 Eco TEA / NT 611 Eco TEA

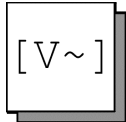

EUR: 230 V/1~50/60 Hz



7,5 m
H 07 RN – F3 x 1,5 mm² 6.648-584



1.184-xxx: 63 dB (A)
1.146-xxx: 63 dB (A)

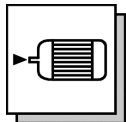

P max: 1380 W
P nom: 1200 W

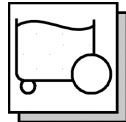

1.184-xxx 34 l
1.146-xxx 55 l



1.184-xxx 20 l
1.146-xxx 44 l

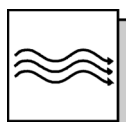

1.184-xxx max. 78 l/s
1.146-xxx max. 56 l/s

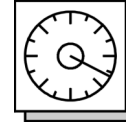

1.184-xxx max. 178 mbar
1.146-xxx max. 235 mbar

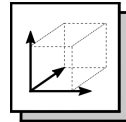

1.184-xxx 505 mm x 370 mm x 535 mm

1.146-xxx 570 mm x 370 mm x 860 mm



1.184.xxx: 10,5 kg
1.146-xxx: 15,0 kg

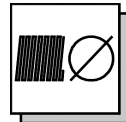

35 mm

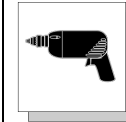

P: 100 - 2200 W
EUR:

min. 4 bar
max. 6 bar
min. 200 l/min.

NT 361 Eco TEA / NT 611 Eco TEA

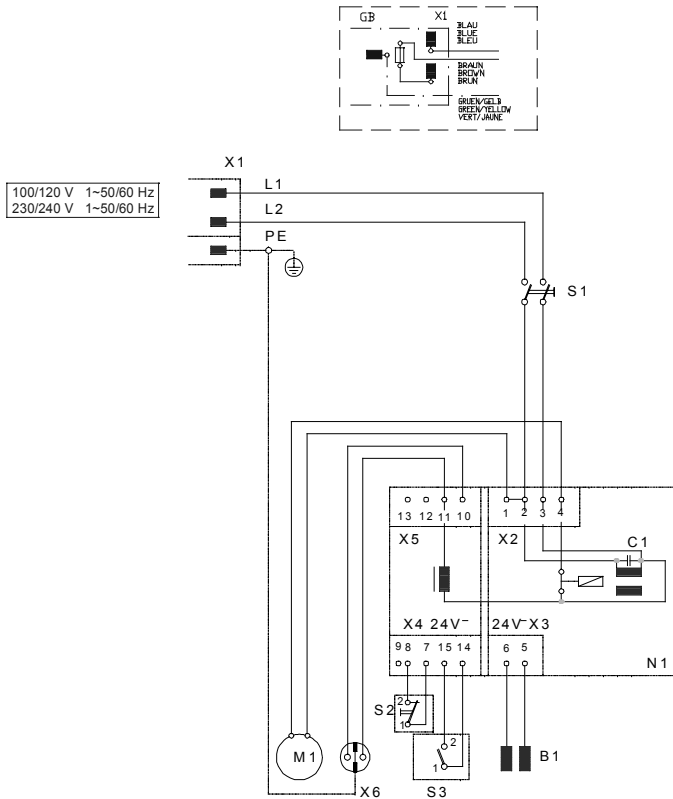

- | | |
|----|---|
| B1 | Elektroden
Electrodes
Electrodes |
| C1 | Entstörkondensator
Suppression Capacitor
Condensateur Antiparasites |
| M1 | Saugturbine
Suction Turbine
Turbine d'aspiration |
| N1 | Platine
Circuit Board
Platine |
| S1 | Schalter Turbine
Switch Suction Turbine
Interrupteur de Turbine |
| S2 | Umschalter Betriebsart
Switch
Inverseur |
| S3 | Reedschalter
Reed Switch
Interrupter Reed |
| X1 | Stecker
Plug
Fiche |
| X2 | Steckkupplung |
| X5 | Plug-In Coupling |
| | Raccord Prise |
| X6 | Steckdose
Socket
Prise de Courant |

NT 361 Eco TEA / NT 611 Eco TEA

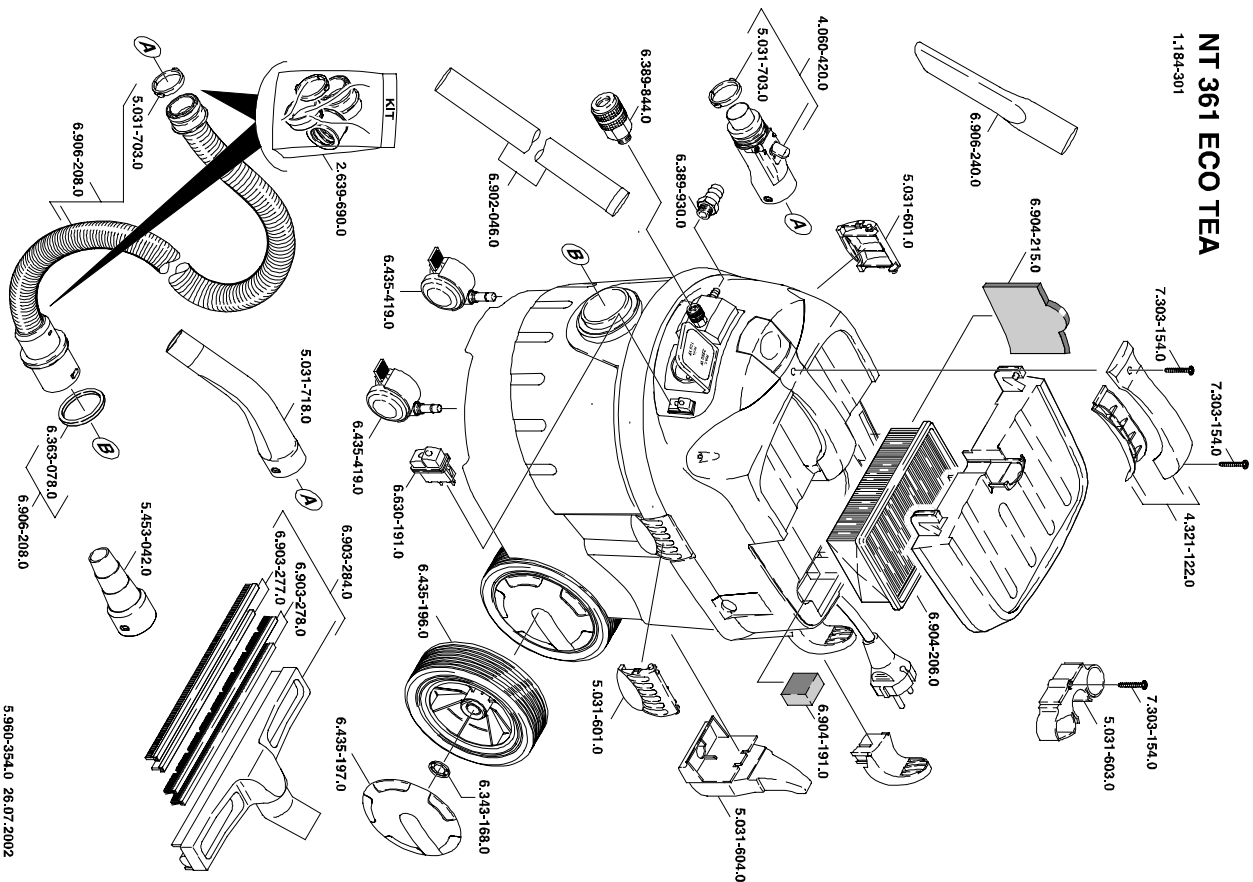

5.960-354.0 26.07.2002

NT 361 Eco TEA / NT 611 Eco TEA

NT 611 ECO TEA

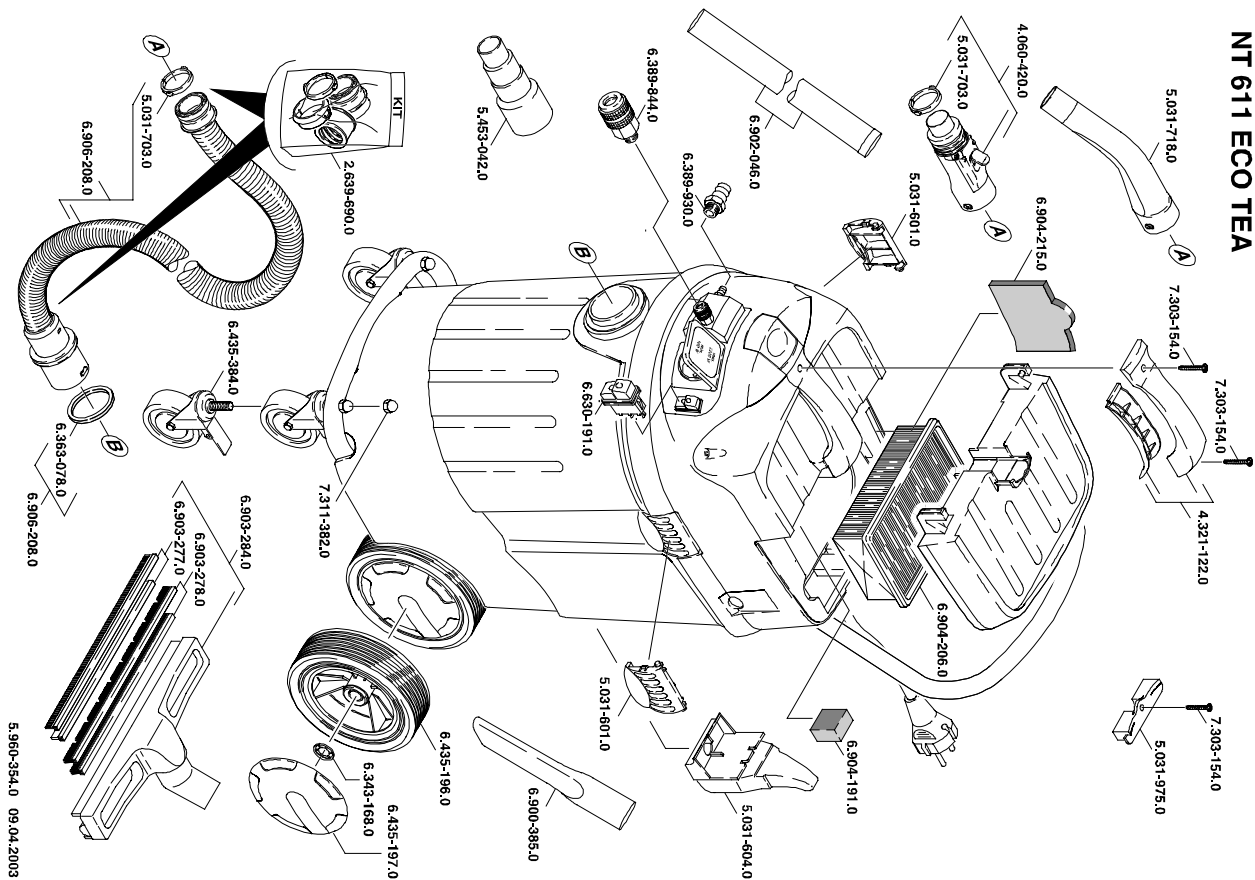

Free Manuals Download Website

<http://myh66.com>

<http://usermanuals.us>

<http://www.somanuals.com>

<http://www.4manuals.cc>

<http://www.manual-lib.com>

<http://www.404manual.com>

<http://www.luxmanual.com>

<http://aubethermostatmanual.com>

Golf course search by state

<http://golfingnear.com>

Email search by domain

<http://emailbydomain.com>

Auto manuals search

<http://auto.somanuals.com>

TV manuals search

<http://tv.somanuals.com>