

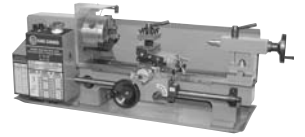

Service Manual / Manuel de Service

7" x 12" Variable Speed Mini Metal Lathe

Mini Tour à Métal à Vitesse Variables 7" x 12"



Revised/Revisé 08/2008

KC-0712ML

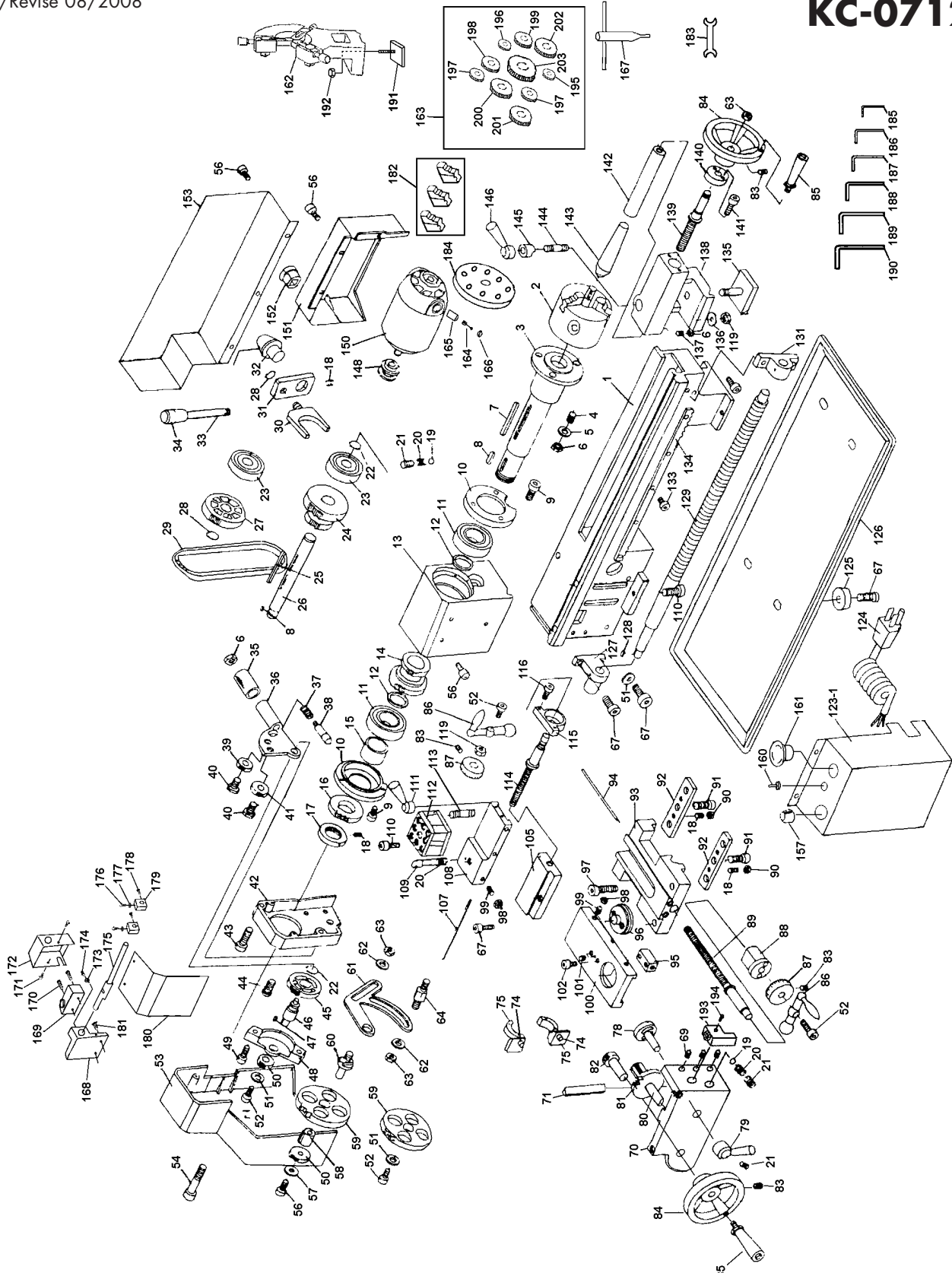



Parts Pricing List / Liste de Prix des Pièces

KC-0712ML

Diag.	Order # Com.	English Description	Description Française	Qty./Qté.	Price/Prix
1	6407120010	BED WAY	SOCLE	1	\$227.70
2	6407120020	4" -3 JAW CHUCK	MANDRIN 4" -3 MACHOIRES	1	\$159.85
3	6407120030	SPINDLE	ARBRE	1	\$148.35
4	6407120040	STUD	TIGE DU MANDRIN	3	\$4.43
5	6407120050	WASHER	RONDELLE	3	\$1.55
6	6407120060	NUT	ECROU	5	\$1.55
7	6407120070	KEY	CLE DE RETENUE	1	\$2.59
8	6407120080	KEY	CLE DE RETENUE	2	\$2.01
9	6407120090	CAP SCREW	BOULON A TETE CYLINDRIQUE	6	\$1.67
10	6407120100	COVER	COUVERCLE	2	\$25.24
11	6407120110	BALL BEARING	ROULEMENT A BILLES	2	\$32.14
12	6407120120	SPACER	ESPACEUR	2	\$4.54
13	6407120130	HEAD STOCK CASTING	BOITIER DES ENGRENAGES	1	\$166.75
14	6407120140	GEAR	ENGRENAGE	1	\$41.34
15	6407120150	SPACER	ESPACEUR	1	\$5.58
16	6407120160	SPUR GEAR	ENGRENAGE A DENTS DROITE	1	\$34.33
17	6407120170	NUT	ECROU	1	\$10.06
18	6407120180	SET SCREW	VIS SANS TETE	6	\$1.55
19	6407120190	STEEL BALL	BILLES EN ACIER	2	\$1.44
20	6407120200	COMPRESSION SPRING	RESSORT A COMPRESSION	3	\$1.55
21	6407120210	SET SCREW	VIS SANS TETE	3	\$2.13
22	6407120220	RETAINING RING	ANNEAU DE RETENU	2	\$1.55
23	6407120230	BALL BEARING	ROULEMENT A BILLES	2	\$20.64
24	6407120240	GEAR	ENGRENAGE	1	\$39.04
25	6407120250	KEY	CLE DE RETENUE	1	\$2.93
26	6407120260	GEAR SHAFT	TIGE A ENGRENAGE	1	\$21.10
27	6407120270	PULLEY	POULIE	1	\$21.79
28	6407120280	RETAINING RING	ANNEAU DE RETENU	2	\$1.55
29	6407120290	TIMING TOOTH BELT	COURROIE DENTELEE	1	\$20.64
30	6407120300	SHIFTING FORK	FOURCHE D'EMBRAYAGE	1	\$11.33
31	6407120310	SHIFTING ARM	BRAS D'EMBRAYAGE	1	\$6.84
32	6407120320	SHIFTING HUB	MOYAU D'EMBRAYAGE	1	\$7.76
33	6407120330	SHIFTING LEVER	LEVIER D'EMBRAYAGE	1	\$6.73
34	6407120340	SHIFTING GRIP	POIGNEE D'EMBRAYAGE	1	\$4.08
35	6407120350	HANDLE	POIGNEE	1	\$5.00
36	6407120360	HANDLE MOUNT	MONTURE DE LA POIGNEE	1	\$22.83
37	6407120370	SPRING	RESSORT	1	\$3.97
38	6407120380	INDICATOR	INDICATEUR	1	\$5.69
39	6407120390	PINION	PIGNON	1	\$5.69
40	6407120400	SUPPORT SCREW	VIS DE SUPPORT	2	\$3.28
41	6407120410	PINION	PIGNON	1	\$5.00
42	6407120420	FIXED COVER	COUVERCLE FIXE	1	\$57.33
43	6407120430	CAP SCREW	BOULON A TETE CYLINDRIQUE	3	\$1.78
44	6407120440	SCREW	VIS	1	\$1.78
45	6407120450	GEAR	ENGRENAGE	1	\$40.19
46	6407120460	SHAFT	TIGE	1	\$21.56
47	6407120470	KEY	CLE DE RETENUE	1	\$1.67

Pricing subject to change without prior notice. / Prix sujet à changement sans préavis.



Parts Pricing List / Liste de Prix des Pièces

KC-0712ML

Diag.	Order # Com.	English Description	Description Française	Qty./Qté.	Price/Prix
48	6407120480	MOUNT	SUPPORT	1	\$29.50
49	6407120490	CAP SCREW	BOULON A TETE CYLINDRIQUE	2	\$1.67
50	6407120500	PINION	PIGNON	2	\$5.00
51	6407120510	WASHER	RONDELLE	3	\$1.55
52	6407120520	CAP SCREW	BOULON A TETE CYLINDRIQUE	4	\$1.67
53	6407120530	COVER	COUVERCLE	1	\$64.23
54	6407120540	CAP SCREW	BOULON A TETE CYLINDRIQUE	2	\$2.47
56	6407120560	CAP SCREW	BOULON A TETE CYLINDRIQUE	4	\$1.55
57	6407120570	WASHER	RONDELLE	1	\$1.50
58	6407120580	BUSHING W/ KEY	BAGUE/CLE DE RETENUE	1	\$10.29
59	6407120590	GEAR	ENGRENAGE	2	\$28.58
60	6407120600	SHAFT	TIGE	1	\$17.19
61	6407120610	SUPPORT PLATE	PLAQUE DE SUPPORT	1	\$28.35
62	6407120620	WASHER	RONDELLE	2	\$1.50
63	6407120630	NUT	ECROU	3	\$1.55
64	6407120640	SHAFT	TIGE	1	\$13.63
67	6407120670	CAP SCREW	BOULON A TETE CYLINDRIQUE	7	\$1.78
69	6407120690	SET SCREW	VIS SANS TETE	1	\$1.90
70	6407120700	APRON HOUSING	BOITIER DU TABLIER	1	\$110.20
71	6407120710	GIB STRIP	GLISSIERE	1	\$20.53
74	6407120740	SHAFT/PIN	TIGE	2	\$3.28
75	6407120750	HALF NUT SET (2)	JEU DEMI-ECROU (2)	1	\$65.26
78	6407120780	GROOVE CAM	RAINURE A CAME	1	\$21.45
79	6407120790	HANDLE	POIGNEE	1	\$14.66
80	6407120800	SHAFT	TIGE	1	\$27.20
81	6407120810	FEEDING GEAR (A)	ENGRENAGE D'ALIMENTATION (A)	1	\$25.01
82	6407120820	FEEDING GEAR (B)	ENGRENAGE D'ALIMENTATION (B)	1	\$20.64
83	6407120830	SET SCREW	VIS SANS TETE	4	\$1.55
84	6407120840	TAIL STOCK WHEEL	MANIVELLE DE LA POUPEE ARRIERE	2	\$22.83
85	6407120850	HANDLE & BOLT	POIGNEE ET BOULON	2	\$6.84
86	6407120860	HANDLE	POIGNEE	2	\$25.24
87	6407120870	DIAL	CADRAN	2	\$27.43
88	6407120880	BRACKET	SUPPORT	2	\$41.11
89	6407120890	FEEDING SCREW	TIGE SANS FIN	1	\$43.53
90	6407120900	NUT	ECROU	2	\$1.67
91	6407120910	CAP SCREW	BOULON A TETE CYLINDRIQUE	2	\$1.78
92	6407120920	SLIDE PLATE	PLAQUE COULISSANTE	2	\$20.53
93	6407120930	CARRIAGE	SELLE	1	\$144.73
94	6407120940	GIB STRIP (15CM)	GLISSIERE	1	\$22.60
95	6407120950	FEEDING NUT	ECROU D'ALIMENTATION	1	\$15.93
96	6407120960	SWIVEL DISK	DISQUE DE PIVOTEMENT	1	\$21.68
97	6407120970	CAP SCREW	BOULON A TETE CYLINDRIQUE	1	\$1.90
98	6407120980	NUT	ECROU	2	\$1.55
99	6407120990	SCREW	VIS	2	\$1.55
100	6407121000	CROSS SLIDE	CHARIOT TRANSVERSAL	1	\$114.60
101	6407121010	SET SCREW	VIS SANS TETE	1	\$1.50
102	6407121020	CAP SCREW	BOULON A TETE CYLINDRIQUE	1	\$1.55

Pricing subject to change without prior notice. / Prix sujet à changement sans préavis.



Parts Pricing List / Liste de Prix des Pièces

KC-0712ML

Diag.	Order # Com.	English Description	Description Française	Qty./Qté.	Price/Prix
105	6407121050	TOP SLIDE REST	BASE DE CHARIOT LONGITUDINAL	1	\$68.71
107	6407121070	GIB STRIP	GLISSIERE	1	\$21.10
108	6407121080	TOP SLIDE	CHARIOT LONGITUDINAL	1	\$113.79
109	6407121090	POSITIONING PIN	GOUPILLE DE POSITIONNEMENT	1	\$5.69
110	6407121100	CAP SCREW	BOULON A TETE CYLINDRIQUE	10	\$1.67
111	6407121110	CLAMPING LEVER	LEVIER DE CRAMPONNEMENT	1	\$13.40
112	6407121120	TOOL REST	PORTE-OUTIL	1	\$57.10
113	6407121130	STUD	TIGE	1	\$5.35
114	6407121140	CROSS FEEDING SCREW	TIGE SANS FIN	1	\$41.00
115	6407121150	BRACKET	SUPPORT	1	\$20.18
116	6407121160	CAP SCREW	BOULON A TETE CYLINDRIQUE	2	\$1.78
119	6407121190	NUT	ECROU	2	\$1.55
123-1	6407121231	CONTROL BOX & CHART ASS'Y	BOITE DE CONTROLE & TABLEAU	1	\$57.33
124	6407121240	PLUG W/CORD	CORDON D'ALIMENTATION	1	\$25.24
125	6407121250	RUBBER PAD	PIED EN CAOUTCHOUC	4	\$2.59
126	6407121260	CHIP TRAY	PLATEAU	1	\$107.93
127	6407121270	BRACKET	SUPPORT	1	\$34.33
128	6407121280	KEY	CLE DE RETENUE	1	\$1.55
129	6407121290	LEAD SCREW	TIGE SANS FIN PRINCIPALE	1	\$67.68
131	6407121310	BRACKET	SUPPORT	1	\$32.83
133	6407121330	CAP SCREW	BOULON A TETE CYLINDRIQUE	4	\$1.55
134	6407121340	RACK	CREMAILLIERE	1	\$36.63
135	6407121350	CLAMP PLATE	PLAQUE DE CRAMPONNEMENT	1	\$15.70
136	6407121360	WASHER	RONDELLE	1	\$1.44
137	6407121370	SCREW	VIS	1	\$1.55
138	6407121380	TAILSTOCK	POUPEE	1	\$113.33
139	6407121390	TAILSTOCK SCREW	TIGE SANS FIN	1	\$41.00
140	6407121400	BRACKET	SUPPORT	1	\$11.44
141	6407121410	CAP SCREW	BOULON A TETE CYLINDRIQUE	2	\$1.67
142	6407121420	TAILSTOCK QUILL	MANCHON DE LA POUPEE	1	\$57.21
143	6407121430	DEAD CENTER	POINTE FIXE	1	\$21.68
144	6407121440	STUD	TIGE	1	\$5.58
145	6407121450	CLAMP	CRAMPON	1	\$5.69
146	6407121460	HANDLE	POIGNEE	1	\$11.10
148	6407121480	PULLEY	POULIE	1	\$13.63
150	6407121500	MOTOR	MOTEUR	1	\$211.31
151	6407121510	COVER	COUVERCLE	1	\$43.53
152	6407121520	STRAIN RELIEF	ATTACHE-CORDON	1	\$2.59
153	6407121530	REAR SPLASH GUARD	GARDE D'ECLABOUSSEMENT	1	\$114.83
157	6407121570	VAR. CONTACT SPEED SWITCH	INTERR. CONTACT A VITESSE VAR.	1	\$62.04
160	6407121600	FWD-STOP-REV. SWITCH	INTERR. AV-ARRET-AR.	1	\$66.53
161	6407121610	EMERGENCY SAFETY SWITCH	INTERR. ARRET D'URGENCE	1	\$64.34
162	6407121620	STEADY REST ASS'Y	LUNETTE FIXE ASS.	1	\$91.43
163	6407121630	10PC-PLASTIC GEAR KIT	ENS. 10 MCX. D'ENGRENAGE	1	\$28.58
164	6407121640	CARBON BRUSH SET (2)	JEU DE BALAI AU CARBONE (2)	1	\$15.93
165	6407121650	BRUSH HOLDER	PORTE-BALAI	2	\$9.09
166	6407121660	BRUSH CAP	CAPUCHON DES PORTE-BALAIS	2	\$3.28

Pricing subject to change without prior notice. / Prix sujet à changement sans préavis.



Parts Pricing List / Liste de Prix des Pièces

KC-0712ML

Diag.	Order # Com.	English Description	Description Française	Qty./Qté.	Price/Prix
167	6407121670	CHUCK KEY	CLE POUR MANDRIN	1	\$26.39
168	6407121680	FIXING PLATE	PLAQUE DE FIXATION	1	\$34.33
169	6407121690	LIMIT SWITCH	INTERRUPTEUR DE CONTACT	1	\$34.21
170	6407121700	RD HD SCREW	VIS A TETE RONDE	2	\$1.67
171	6407121710	SINKING HD SCREW	VIS FRAISER	2	\$1.90
172	6407121720	FIXING PLATE COVER	COUV. DE LA PLAQUE DE FIXATION	1	\$26.97
173	6407121730	HEX. NUT	ECROU HEXAGONALE	1	\$1.55
174	6407121740	SPECIAL SET SCREW	VIS SANS TETE SPECIALE	1	\$2.13
175	6407121750	GUARD SHAFT	TIGE DU GARDE	1	\$15.58
176	6407121760	RD HD SCREW	VIS A TETE RONDE	2	\$1.67
177	6407121770	WASHER	RONDELLE	2	\$1.55
178	6407121780	CAP SCREW	BOUTON A TETE CYLINDRIQUE	2	\$1.67
179	6407121790	FIXING BLOCK	BLOC DE FIXATION	2	\$6.15
180	6407121800	SAFETY GUARD	GARDE DE SECURITE	1	\$11.33
181	6407121810	SINKING HD SCREW	VIS FRAISER	2	\$1.90
182	6407121820	SET OF REVERSE JAW (3)	JEU DE MACHOIRE INVERSE (3)	1	\$73.43
183	6407121830	OPEN KEY	CLE OUVERTE	1	\$4.54
184	6407121840	FACE PLATE	PLATEAU DE TOURNAGE	1	\$44.79
185	6407121850	ALLEN KEY	CLE HEXAGONALE	1	\$3.39
186	6407121860	ALLEN KEY	CLE HEXAGONALE	1	\$3.39
187	6407121870	ALLEN KEY	CLE HEXAGONALE	1	\$2.59
188	6407121880	ALLEN KEY	CLE HEXAGONALE	1	\$2.70
189	6407121890	ALLEN KEY	CLE HEXAGONALE	1	\$2.82
190	6407121900	ALLEN KEY	CLE HEXAGONALE	1	\$2.93
191	6407121910	FIX PLATE W/SCREW	PLAQUE DE FIXATION	1	\$11.33
192	6407121920	HEX. NUT	ECROU HEXAGONAL	1	\$2.24
193	6407121930	COMPLETE THREAD DIAL	CADRAN A FILET COMPLET	1	\$57.44
194	6407121940	CAP SCREW	BOULON A TETE CYLINDRIQUE	1	\$1.73
195	6407121950	PLASTIC CHANGE GEAR -30T	ENG. DE RECHANGE EN PLAS. -30D	1	\$2.93
196	6407121960	PLASTIC CHANGE GEAR -35T	ENG. DE RECHANGE EN PLAS. -35D	1	\$2.93
197	6407121970	PLASTIC CHANGE GEAR -40T	ENG. DE RECHANGE EN PLAS. -40D	2	\$3.05
198	6407121980	PLASTIC CHANGE GEAR -45T	ENG. DE RECHANGE EN PLAS. -45D	1	\$3.05
199	6407121990	PLASTIC CHANGE GEAR -50T	ENG. DE RECHANGE EN PLAS. -50D	1	\$3.16
200	6407122000	PLASTIC CHANGE GEAR -55T	ENG. DE RECHANGE EN PLAS. -55D	1	\$3.16
201	6407122010	PLASTIC CHANGE GEAR -57T	ENG. DE RECHANGE EN PLAS. -57D	1	\$3.28
202	6407122020	PLASTIC CHANGE GEAR -60T	ENG. DE RECHANGE EN PLAS. -60D	1	\$3.28
203	6407122030	PLASTIC CHANGE GEAR -65T	ENG. DE RECHANGE EN PLAS. -65D	1	\$3.39
	640712MBIL	BILINGUAL MANUAL KC-0712ML	MANUEL BILINGUE KC-0712ML	1	\$15.00

Pricing subject to change without prior notice. / Prix sujet à changement sans préavis.

Free Manuals Download Website

<http://myh66.com>

<http://usermanuals.us>

<http://www.somanuals.com>

<http://www.4manuals.cc>

<http://www.manual-lib.com>

<http://www.404manual.com>

<http://www.luxmanual.com>

<http://aubethermostatmanual.com>

Golf course search by state

<http://golfingnear.com>

Email search by domain

<http://emailbydomain.com>

Auto manuals search

<http://auto.somanuals.com>

TV manuals search

<http://tv.somanuals.com>