



INSTALLATION INSTRUCTIONS FOR PART 99-8211

APPLICATIONS

2000-04 TOYOTA AVALON

99-8211



KIT FEATURES

- DIN Head Unit Provisions with Pocket
- ISO DIN Head Unit Provisions with Pocket

KIT COMPONENTS

A) Radio Housing | B) ISO Brackets | C) ISO Trim Plate | D) Radio Housing Brackets

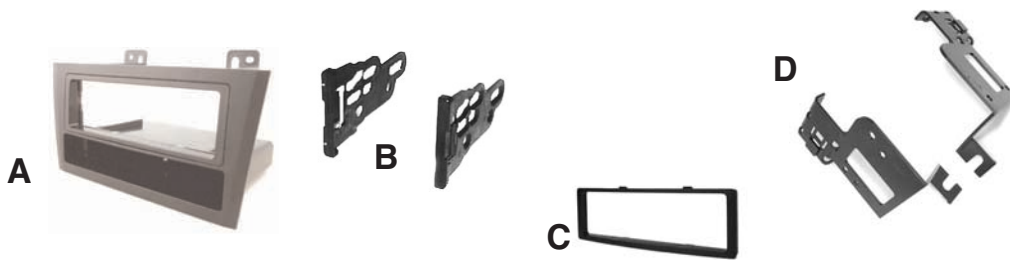

TOOLS REQUIRED:

Small Flat Blade Screwdriver | Phillips Screwdriver | Socket Wrench



1-800-221-0932



www.metraonline.com

© COPYRIGHT 2004 METRA ELECTRONICS CORPORATION



99-8211

TABLE OF CONTENTS

- **Dash Disassembly**
 - **2000-2004 Toyota Avalon (column shift models) 1**
 - **2000-2004 Toyota Avalon (console shift models) 2**

- **Kit Assembly**
 - **DIN Head Unit Provision 3**
 - **ISO DIN Head Unit Provision 4**

- **Final Assembly 5**

- **Notes 6 & 7**

2000-2004 TOYOTA AVALON (column shift models)

DASH DISASSEMBLY

- 1 Disconnect the negative battery terminal to prevent an accidental short circuit.



- 2 Unsnap the trim below the climate control to reveal (2) 10 MM bolts and remove. (Figure A)

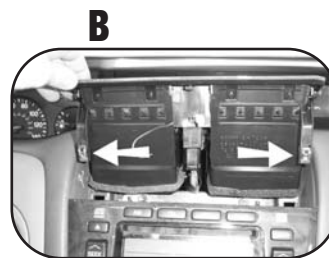

- 3 Carefully pull air vents above radio towards rear of car to unsnap. Note: There are (3) snaps, (2) are at the bottom sides and (1) is at the top middle of the vent assembly. (Figure B)



- 4 Remove (2) 10 MM bolts from above radio/climate control assembly and remove assembly together. (Figure C)

- 5 Remove (6) Phillips screws (4 from radio and 2 from climate control) from each side bracket to separate radio and climate control. (Figure D)



2000-2004 TOYOTA AVALON (console shift models)

- 1 Disconnect the negative battery terminal to prevent an accidental short circuit.
- 2 Open the center console armrest, unsnap cover above cup holder and remove (2) Phillips screws toward the outside of the panel. (Figure A)
- 3 Lift up and remove shifter trim/ashtray assembly. (Figure B)
- 4 Unsnap black cover from under climate controls and remove (2) 10 MM bolts. (Figure C)
- 3 Carefully pull air vents above radio towards rear of car to unsnap. Note: There are (3) snaps, (2) are at the bottom sides and (1) is at the top middle of the vent assembly. (Figure D)
- 4 Remove (2) 10 MM bolts from above radio/climate control assembly and remove assembly together. (Figure E)
- 5 Remove (6) Phillips screws (4 from radio and 2 from climate control) from each side bracket to separate radio and climate control. (Figure F)

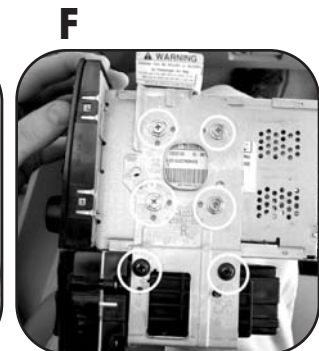
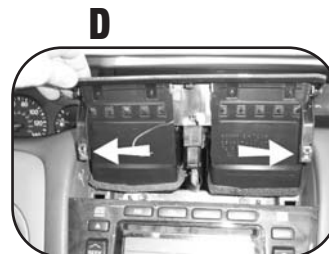
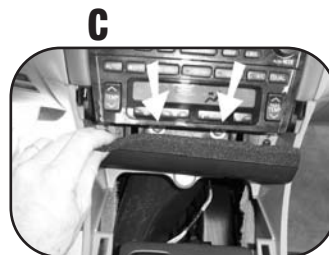
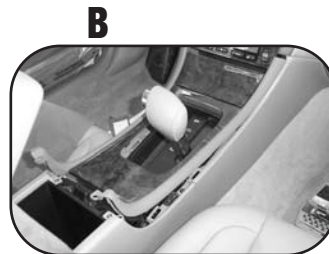
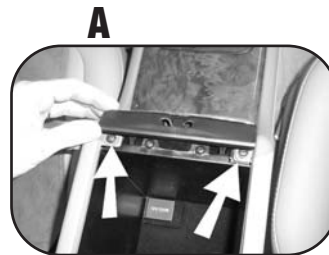

DIN Head Unit Provision

- 1 Slide the mounting bracket onto the 99-8211 until side clips engage. (Figure A)
- 2 Slide factory climate controls into the 99-8211 and secure using the factory hardware. (Figure B)
- 3 Slide the DIN cage into the Radio Housing and secure by bending the metal locking tabs down. (Figure C)
- 4 Slide the aftermarket head unit into the cage and secure.
- 5 Snap the Trim plate into the Radio Housing.

A

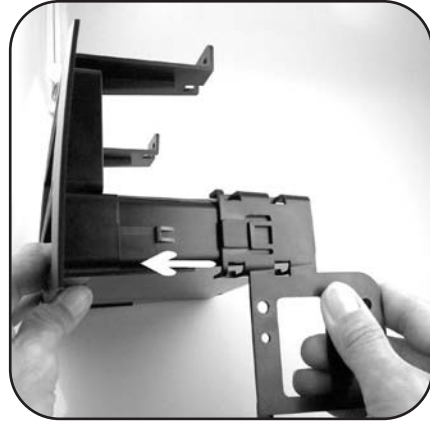

B



C



ISO DIN HEAD UNIT PROVISION

- 1** Slide the mounting bracket onto the 99-8211 until side clips engage. (Figure A)
- 2** Slide factory climate controls into the 99-8211 and secure using the factory hardware. (Figure B)
- 3** Mount the ISO Brackets to the head unit with the screws supplied with the unit.
- 4** Slide the head unit into the radio opening until the side clips engage. (Figure C)
- 5** Snap the Trim plate into the Radio Housing.

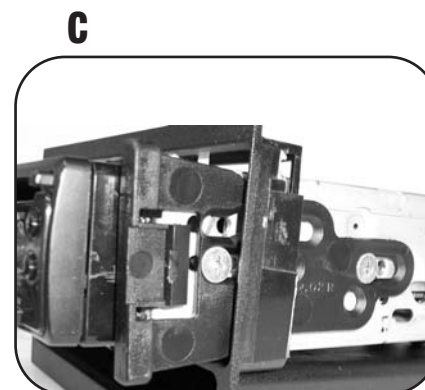
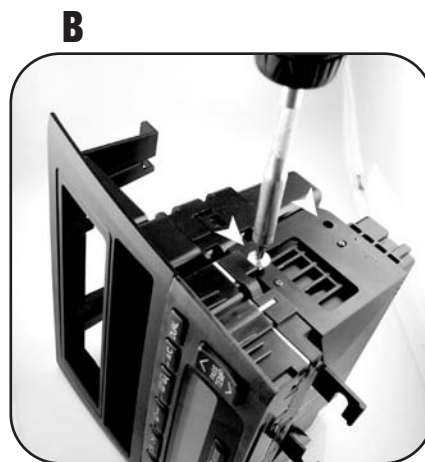
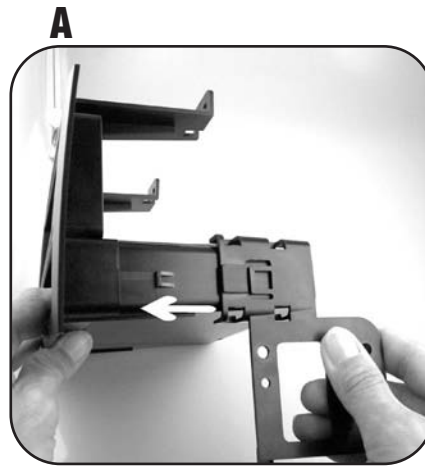

KIT ASSEMBLY

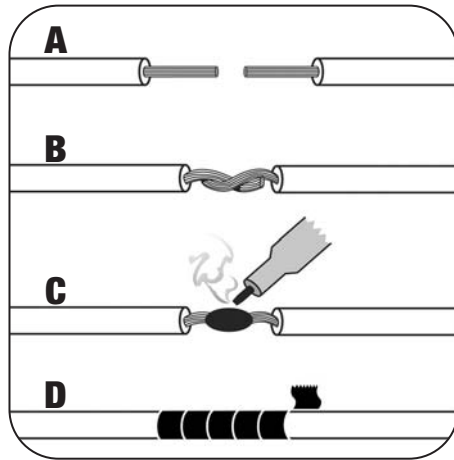
FINAL ASSEMBLY

- A) Strip wire ends back 1/2"**
- B) Twist ends together**
- C) Solder**
- D) Tape**

- 1** Locate the factory wiring harness in the dash. Metra recommends using the proper mating adapter and making the connections as shown. (Isolate and individually tape off the ends of any unused wires to prevent electrical short circuit)
- 2** Re-connect the negative battery terminal and test the unit for proper operation.
- 3** Reassemble radio and dash assemblies in reverse order of disassembly.



99-8211

NOTES

A large rectangular area containing 25 horizontal lines, intended for handwritten notes. The lines are evenly spaced and extend across most of the page width.



99-8211

NOTES

Lined area for notes, consisting of 25 horizontal lines.

INST998211



1-800-221-0932



www.metraonline.com

© COPYRIGHT 2004 METRA ELECTRONICS CORPORATION

Free Manuals Download Website

<http://myh66.com>

<http://usermanuals.us>

<http://www.somanuals.com>

<http://www.4manuals.cc>

<http://www.manual-lib.com>

<http://www.404manual.com>

<http://www.luxmanual.com>

<http://aubethermostatmanual.com>

Golf course search by state

<http://golfingnear.com>

Email search by domain

<http://emailbydomain.com>

Auto manuals search

<http://auto.somanuals.com>

TV manuals search

<http://tv.somanuals.com>