

# LEGACY

## INSTRUCTION MANUAL



**THEFT DETERRENT DETACHABLE SYSTEM  
AUTO-LOADING DISC CD / MP3 PLAYER  
WITH ELECTRONIC ANTI-SHOCK FUNCTION  
AM/FM STEREO 2 BAND TUNING RADIO**

**MODEL:LCD18M**

[www.legacycaraudio.com](http://www.legacycaraudio.com)

## WELCOME!

Thank you for your purchase of our audio-visual product.

Selecting fine audio equipment such as the unit you have just purchased is only the start of your musical enjoyment. Now it is time to consider how you can maximize the fun and excitement your equipment offers.

We hope you get the most out of your equipment by playing it at a safe level.

One that lets the sound come through loud and clear without annoying blare or distortion, and, more important, without affecting your sensitive hearing.

Sound can be misled. Over time your hearing " comfort level " adapts to higher volumes of sound. So what sounds " normal " can actually be loud and harmful to your hearing.

Guard against this by setting your equipment at a safe level BEFORE your hearing adapts.

- To establish a safe level:

Start your volume control at the lowest setting , then slowly increase the sound until you can hear it comfortably and clearly, and without distortion we want you listening for a lifetime.

- Once you have established a comfortable sound level:

Set the dial and leave it there.

Taking a minute to do this now will help to prevent hearing damage or loss in the future. After all, we want you listening for a lifetime.

- ABOUT THIS MANUAL

This product features a number of sophisticated functions ensuring superior reception and operation. All are designed for the easiest possible use, but many are not self-explanatory.

This operation manual is intended to help you benefit fully from their potential and to maximize your listening enjoyment.

- We recommend that you familiarize yourself with the functions and their operation by reading through the manual before you begin using this product. In this operation manual, the Basic Operation for each sound source is outlined at the beginning of its explanation, covering simple operation for that source, such as merely playing music.

Remark:

- In addition to normal audio CD, this unit can play CD-R and CD-R/W disc that contain audio tracks as well; however, depending on the conditions of the recording equipment, recording program or the CD-R as well as CD-R/W disc itself, some CD-R or CD-R/W may not play.

- When making music CD with CD-R or CD-R/W disc, too high recording speed may result in poor signal quality and therefore, it is recommendable to select 24x or lower speed for CD-R recording and 4x or lower speed for CD-R/W recording.

## SPECIFICATIONS

### GENERAL

Supply Voltage	DC 12V. Negative Ground
Current Consumption	Max.7A
Power Output	40W X 4
Unit Dimensions	178[W] X 157[D] X 50[H] mm.

### FM SECTION

Frequency range	88MHz -108MHz
Effective sensitivity	3uV.
I.F Frequency	10.7MHz.

### AM(MW) SECTION

Frequency range	530KHz - 1700KHz
I.F Frequency	455KHz

### RCA LINE OUT (OPTION)

Output	CD Max. 800mV.
--------	----------------

### CD PLAYER

System	Compact Disc Audio System.
Suitable CDs	MP3, CD, CD-R, CD-RW Disc.
Signal format	Sampling frequency 44.1KHz.

Frequency characteristics	No. of quantization bits 1bit.
	20-100Hz ≤ 5dB
	10-20KHz ≤ 5dB.

S/N Ratio to CD	50dB [1KHz]
Number of channels	2 STEREO channels.

Specifications subject to change, forgive without notification.

## INSTALLATION METHOD

This is an anti-theft installation method. The main unit wears a METAL MOUNTING SLEEVE. Please connect the wiring, eg, the Power supply, the Speakers and the Antenna according to the requirements of this Instruction Manual, then install the metal mounting sleeve into the car as per the diagram illustrated below.

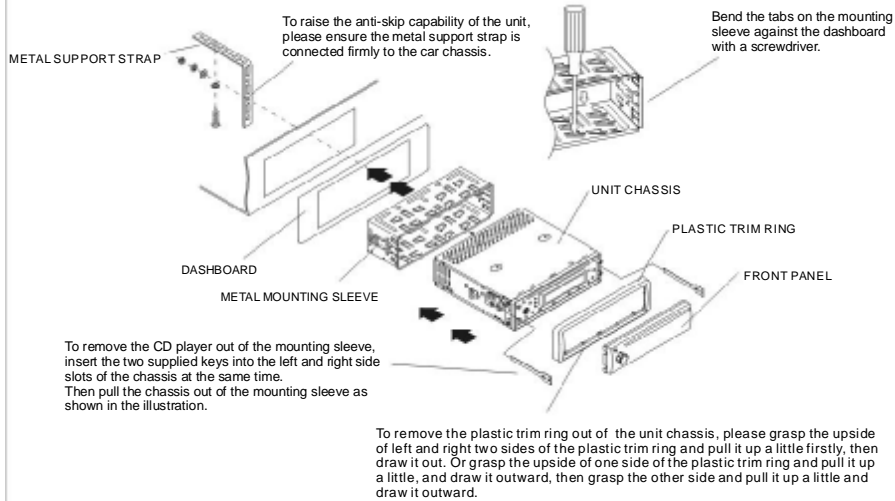

## NOTE

Before installing and operating the CD player, remove the metal mounting sleeve illustrated by the arrows.

Remove the two screws that protect the CD player during transportation before operating the player.

To attach the removable faceplate, insert the right side of the faceplate into the right of the CD player chassis first. Then push the left side of the faceplate into the chassis until you hear it click.

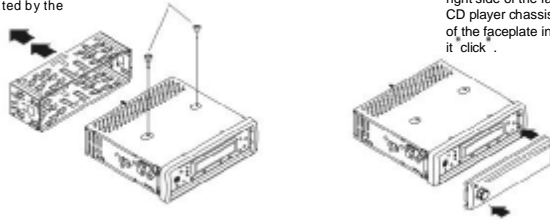

## LOCATION AND FUNCTION OF CONTROLS

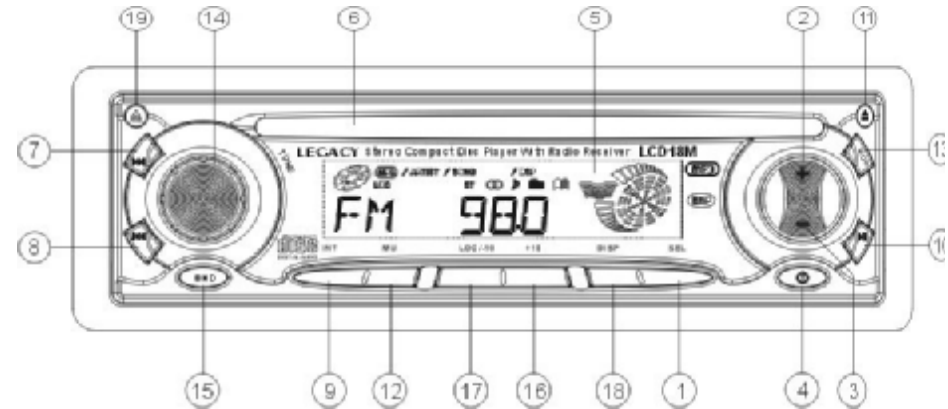

### 1, 2 & 3. SEL(MENU) BUTTON AND VOLUME UP (+) / DN (-) BUTTONS

a) Press the SEL button briefly, it is activated as selecting each mode of E. VOL -> VOLUME -> BASS -> TREBLE -> BALANCE -> FADER -> When selecting a desired audio mode, press the + and - button to adjust the audio effect.

In each mode, the waiting time is about 5 seconds, and the time waiting time is over, it returns to the last display mode of tuner or CDP mode.

The control mode of E. VOL is operated with following numeric display.

- VOL: (MIN)00, 01, .....49, 50(MAX).
- BASS/TREB: -10, -9, ..., 0, ..., 9, 10
- BAL: 10L, 9L, ..., L=R, ..., 9R, 10R
- FAD: 10F, 9F, ..., F=R, ..., 9R, 10R

b) When pressed longer 2 seconds, it is activated as cyclical mode of following functions for user's selection.

-> DSP(OFF/ FLAT/ POP M/ROCK/CLASSICS) ->BEEP (2ND/ALL/OFF) -> VOL LAST/VOL ADJ -> ESP 10 seconds/40 seconds mode.

After selecting the desired mode, press the + and - button to select one setup item of the desired mode.

**BEEP 2ND, BEEP ALL, BEEP OFF MODE**

The situation of beep sound is selected. The 3 mode is selected as also the + or - button.

- BEEP 2ND mode:

The beep is only generated when an allotted double key is pressed long (2 second).

- BEEP ALL mode:

The beep is generated when any key is pressed.

- BEEP OFF mode:

The beep sound is disabled.

**VOL LAST/VOL ADJ**

You can select VOL LAST or VOL ADJ mode by using the + and - button.

**VOL LAST:** The radio switches on at the actual volume it had when it was last switched off.

**VOL ADJ:** After pressing SEL button, you can pre-select a constant switch-on volume by using the + and - button.

ESP 10 seconds/40 seconds:  
 IN ESP mode, you can select 10 seconds or 40 seconds electronic shockproof mode by using the + and - button.

#### 4. POWER ON/OFF

Turn the device on by using any button except the REL button, EJECT key and TUNING knob on the front panel; and the LCD will display WELCOME. It can also turn on this device to insert a disc into the CD slot with label surface up. Press power button and hold for approximately 1 second to turn power off; and the LCD will display GOOD BYE.

#### 5. LCD DISPLAY

#### 6. CD SLOT

#### 7&8. CD TRACK UP / DOWN AND CD FF/REW BUTTONS

Whilst in CD/MP3 mode, press the >>| button briefly to play next track. Press the |<< button briefly to play the previous track. Press the >>| or |<< button and hold to skip forwards or backwards, release to resume disc playback.

#### 9. INTRO ON/OFF BUTTON

In CD/MP3 playback process, press the INT button briefly to activate the CD track scan mode. Whilst INTRO is on, it begins playing the first 10 second section of each song, until the last song is played. It stops the CD track scanning and begins playing the selected track when the INT button is pressed again.

#### 10. TOP/⏸️ BUTTON

In CD/MP3 playback process, press the TOP/⏸️ button to pause the CD playback, press again to resume normal playback. First song will be played when the TOP/⏸️ button is pressed for longer than 1 second during CD/MP3 playback.

#### 11. CD EJECT BUTTON

The loaded CD can be ejected by pressing the EJECT button. If the CD is left in the CD slot after ejection, it will reload the CD after 8 seconds.

#### 12. MUTE ON/OFF BUTTON

This button serves to switch the MUTED state on/off. Press the MUTE button to suppress the loudspeaker temporarily, and press again to resume listening. The muted state will be also released when the MODE, BAND, SEL and the + and - button on the front panel is pressed.

#### 13. MODE BUTTON

When a disc is present in the CD slot, pressing the MODE button will allow you to change to RADIO mode (and back). The LCD display information changes with the mode (please note: when no disc is present in the unit, this button does not provide a function).

## WIRING DIAGRAM

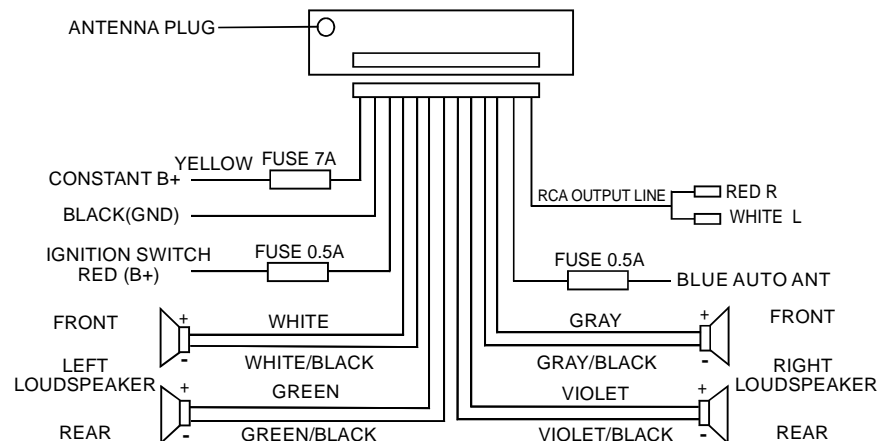

Note:

1. Make sure you use a speaker with 4 ohm load impedance
2. Make sure the auto antenna wire does not come into contact with the vehicle chassis.

CAUTION:

In order to protect power IC from being burnt out during installation the car stereo, it is necessary to follow the steps below to connect the wires during installation:

Step 1: Connect the ground wire (Black);

Step 2: Connect all speaker wires and power antenna wire (Blue):

Left speaker

Right speaker

Front speaker: White (+) White/Black (-) Gray (+) Gray/Black (-)

Rear speaker: Green (+) Green/Black (-) Violet (+) Violet/Black (-)

Step 3: RCA Line Out (R- Red/ L-White).

Step 4: Connect Back up (Yellow) and Acc wire (Red)

## TROUBLE SHOOTING

Before using the check list please make all the connections first.  
If you still have questions after going through the checklist, please consult your local customer service representative.

PROBLEM	CAUSE	SOLUTION
No power	The car ignition is not on.	If the power supply is properly connected to the car, switch the ignition key to " ACC "
	The fuse is blown	Replace the fuse
Disc cannot be loaded or ejected	Another CD is present in the player	Remove CD in the player, then insert a new one with label face up
	Disc incorrectly inserted upside-down	Insert the CD with label face up
	CD is extremely dirty or defective	Clean the CD or try a different CD
	Temperature inside the car is too high	Give enough time for the temperature in the vehicle to cool down.
No sound	Condensation	Turn off the player for at least an hour, then try again.
	Volume is too low	Adjust volume to desired level
Sound skips	Wiring is not properly connected	Check the wiring connection
	The installation angle is more than 30 degrees	Adjust the installation angle to less than 30 degrees
The radio does not work	CD is extremely dirty or defective	Clean the CD or try a different CD
	The antenna cable is not connected	Insert the antenna cable firmly

### 14. TUNING CONTROL

Rotate this control at radio mode to select your desired radio broadcasting station. The selected frequency will appear on the LCD display.

### 15. BAND BUTTON

In radio mode, press the BAND button for AM or FM reception. The character of the selected band will be visible on the display. In CD/MP3 format-mixed disc playback mode, long press BND button, it will change from CD mode to MP3 mode(the defaulted mode is CD). This BAND button as a search function during MP3 playback:

During MP3 mode:

Press the BAND button short, it is activated as cyclical selecting song mode as following: -> TRACK SERIAL NUMBER SEARCH -> THE FIRST CHARACTER SEARCH -> DIRECTORY SEARCH

- In TRACK SERIAL NUMBER SEARCH selecting song mode, the MP3 T 000 will be visible on the LCD display and the hundreds digit 0 that the MP3 disc contain will flash. Press the + or - button to select and enter the number on the flashing digit place from 1 to 9. Then press the SEL button to confirm the entered number and the 0 on the tens digit will be flashing. Press the + or - button to select and enter the number on the flashing digit from 1 to 9. Then press the SEL button to confirm the entered number and the 0 on the units place digit will be flashing. Press the + or - button to select and enter the number on the flashing digit from 1 to 9. After finishing enter all the number of the song serial number on the flashing digit, press the SEL button to play the corresponding track.
- In the FIRST CHARACTER SEARCH selecting song mode, the A--....., will be visible on the LCD display. (If there are files names its first character are A, the.....is the first file name its first character is A by the order of A~Z and 0~9; otherwise, the .....is NONE.) Press the + or - button to select files that the first character by the order of A~Z and 0~9. Then press the >>| or |<< button to select one file its first character is the selected one. Finally press the SEL button to play the selected file.
- In DIRECTORY SEARCH selecting song mode, the root folder will be visible on the LCD display. (If there is not a root folder in the current MP3 disc, you will find a root named ROOT.) Then press the + or - button to select a desired folder. And then press the >>| or |<< button to select a desired track in the folder. Finally press the SEL button to play the selected track.

### 16&17. +10 AND LOC/-10 BUTTON

During the normal playback of CDs in MP3 format:

Press +10 and LOC/-10 button to move up and down 10 tracks at a time. When the remained total tracks is lack of 10, the both buttons are inactively. During RADIO mode, press the LOC/-10 button to change local reception or distance reception. (Note: This operation is for FM reception only)

## 18. DISP BUTTON

In MP3 playback process, press this DISP button repeatedly to display as follows: TRACK NUMBER=>ELAPSED TIME=>REAL TIME=>TRACK NAME.  
In RADIO mode, press the DISP button once to display frequency or the real time.

The time will appear on the display, when the DISP button is pressed for 2 secs. The time flashes, you can then adjust HOUR and MINUTE by pressing the + and - button, respectively.

## 19. RELEASE BUTTON

To remove the front control panel from the main body, press the REL button.

## PRECAUTIONS AND MAINTENANCE

CAUTION: Do not install the detachable panel before connecting the wire.

1. The unit is designed for negative terminal of the battery which is connected to the vehicle metal. Please confirm it before installation.
2. During the radio or CD mode, if you drop the front panel, the unit will automatically turned off.
3. If the car interior is extremely hot, as after being parked in the sun, do not use the player until the car has been driven for a while to cool off the interior.
4. Store the detachable in its protective case for safe keeping.
5. To drop/take away/install and recover front panel, see under the illustration.

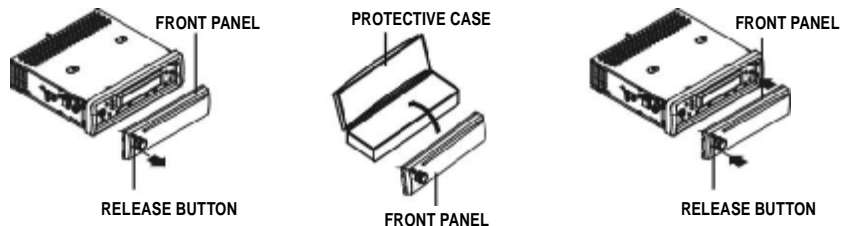

## PRECAUTION OF DISC PLAY:

Cleaning the CD:

Before playing a CD, wipe it off with a clean, dust-free cleaning cloth. Wipe the disc in the direction of the arrow.

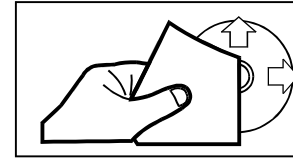

Always insert the CD with the label side facing upwards.  
If the CD is inserted with the printed side facing downwards, the device may be damaged.

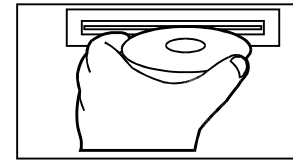

Note: If there is already a CD in the CD slot, do not try to insert a second CD.

This may damage the device.

Always hold CDs by the edge. In order to keep the CD clean do not touch the surface. Pull out the CD as shown below.

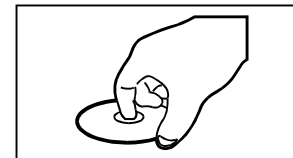

Do not attach any sticker or adhesive tape on the CD.

Do not expose the CD to direct sunlight or sources of heat such as heating vents. Do not leave CDs in a car if it is parked in direct sunlight as that will lead to a considerable rise in the temperature inside the car.

Note: Do not use any solvents such as petrol or thinning agents.

Commercially available cleaning substances or antistatic spray. This will damage the device.

## Free Manuals Download Website

<http://myh66.com>

<http://usermanuals.us>

<http://www.somanuals.com>

<http://www.4manuals.cc>

<http://www.manual-lib.com>

<http://www.404manual.com>

<http://www.luxmanual.com>

<http://aubethermostatmanual.com>

Golf course search by state

<http://golfingnear.com>

Email search by domain

<http://emailbydomain.com>

Auto manuals search

<http://auto.somanuals.com>

TV manuals search

<http://tv.somanuals.com>