

L7HM

7 Inch Headrest TFT-LCD Monitor



OPERATION MANUAL

Specifications

Power Requirements	DC 12~14.4V
Power Consumption	9W
Screen Size	7" TFT-LCD
Screen Format	16 9 Wide
Resolution Pixel	1440*234
A/V Inputs	Video Input 3EA
Dimensions	(L)7.7 (W)5.0 (H)0.92inch
IR Power Requirements	DC 12V
IR Power Consumption	3W
IR Transmitter Frequency A	Right 2.8MHz Left 2.3MHz
IR Transmitter Frequency B	Right 3.8MHz Left 3.2MHz
LCD Panel Type	Active Matrix TFT
Compatible video standard	NTSC/PAL AUTO SWITCHING

*Although the effective pixels for the liquid crystal panel is given as 99.98% or more, 0.02% of pixels may not light or may light incorrectly.

Troubleshooting check list

- * Please make these simple checks before calling for assistance.
- * If the TV is to be used in conjunction with any other equipment, read the other product's instruction manual.
- * If you choose not follow the below checklist or any problems you are experiencing with this product are not solved, never attempt to repair a defective monitor yourself. Check with your dealer .

No picture & no sound

- * Power cord inserted into power source incorrectly.
- * Another product's cord inserted into TV incorrectly.
- * Check the signal in AV mode.

No picture

- * Check the signal in AV mode.
- * Adjust the contrast and brightness settings.

Monitor not responding to remote control

- * Check whether the batteries have sufficient power. Replace if necessary.
- * Check whether the batteries are correctly installed in the remote control.
- * Check the remote control sensor lens on the monitor and the distance and angle on the remote control(2m,30°).

Contents

Thank you for your purchase.

Please read this user's Manual in detail and use the set properly.

Caution·····	3
Installation·····	4
Operation Function·····	6
Remote Function·····	7
Connections·····	8
Troubleshooting check list·····	9
Specifications·····	10

Caution

Read this page in detail in order to protect people's health or assets.

- Driver never operates while driving.
Driver may cause car accident by watching monitor while driving.
- Do not disassemble the device.
- Use proper volume while driving.
- Do not watch the monitor for a long period of time without the engine running. It will drain your battery and you will have issues starting your car.
- Do not drop or give strong impact to LCD panel.
- Do not recharge, disassemble or heat the remote control battery.
- Keep remote control battery away from child.
- Use only soft cloth with non-ammonia glass cleaner to clean the panel.

Check Point

- 1 The range of preservation temperature for the device is from -20°C to 70°C
Be cautious that the inside temperature of car may arise up to 100°C in summer time.
- 2 The monitor picture may not be displayed normally when it is higher or lower than the using temperature.
In this case, the screen will be back normal condition after minutes.
The range of using temperature for the device is from 0°C to 40°C .
- 3 You can watch the best picture condition when you are in the front side.



(Visual Angle)

Connections

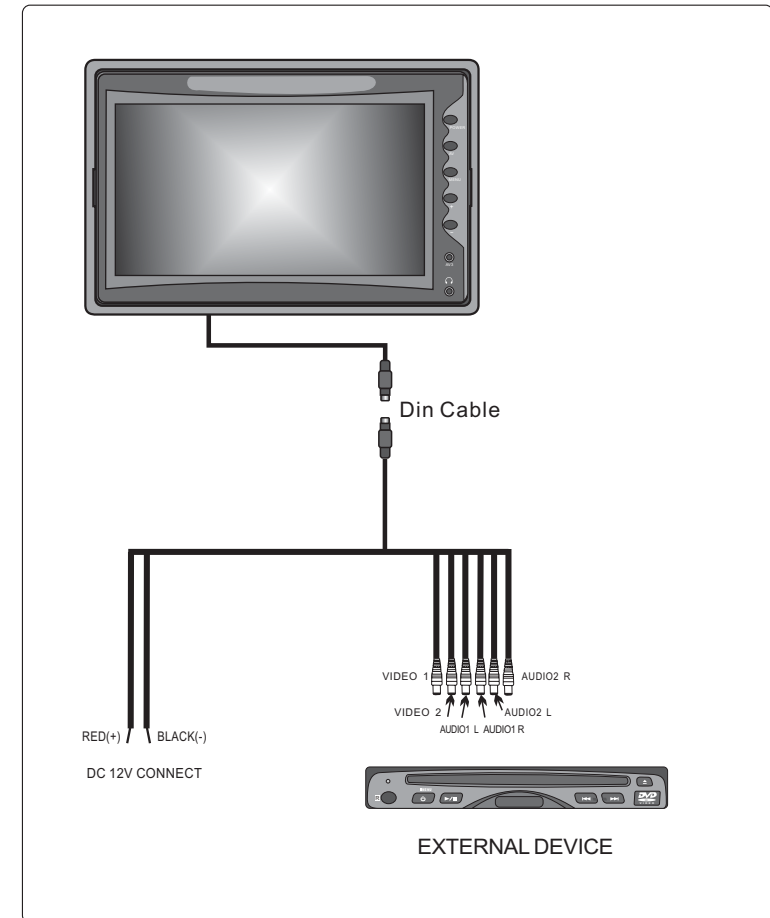

Remote Function

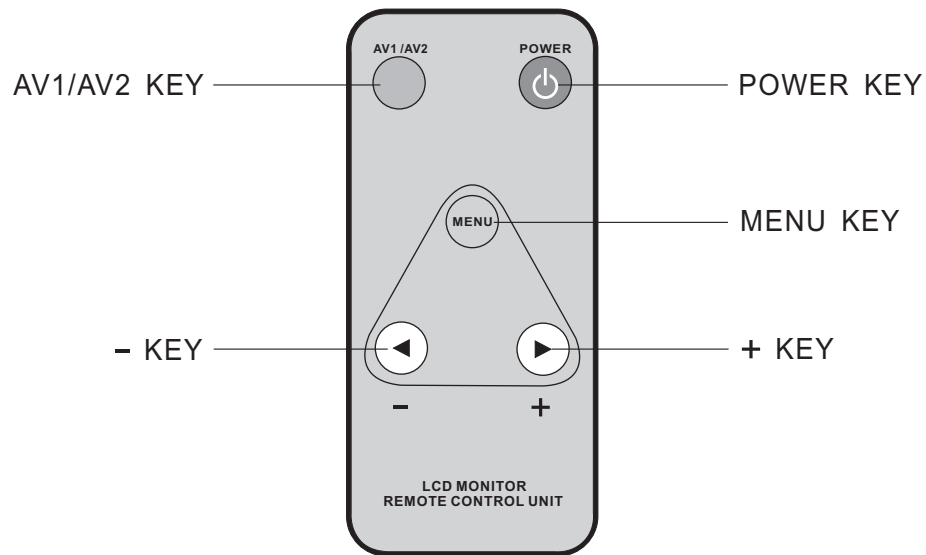

POWER: Power ON/OFF

AV1/AV2: Signal Select

MENU: Press this button for OSD menu.
After that it is the ENTER button.

+ : Increase current option value

- : Decrease current option value

Installation

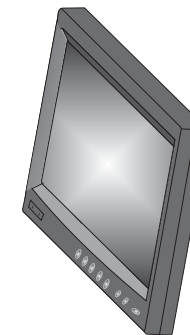
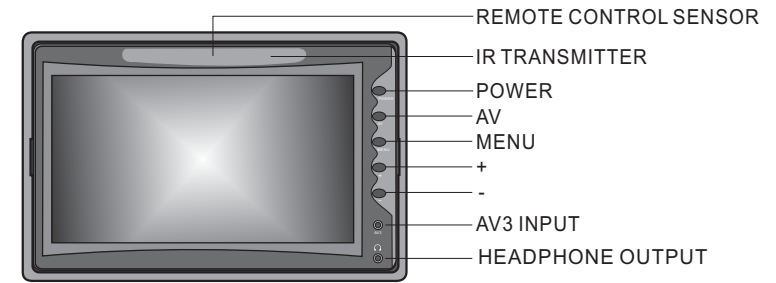

MONITOR

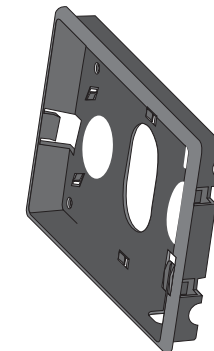

HEADREST BRACKET

STEP1: Use either screws or cable straps to mount the housing to your bracket.

STEP2: Place the monitor into the headrest bracket.
Notice: the terminal comes out from the headrest through the special hole for it.

Installation

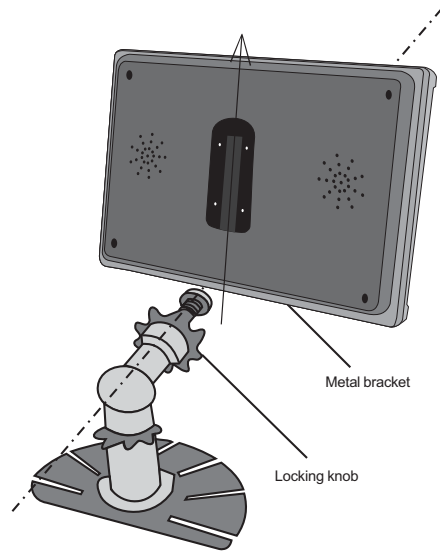

- STEP 1: Put the locking knob into the metal bracket.
- STEP 2: Adjust to the locking knob to select the desired angle.
- STEP 3: Connect the " DC terminal " and "RCA terminal " to the Wiring Harness.

Please notice the true installation of the monitor holder

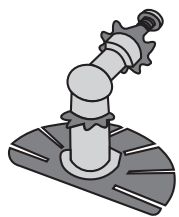

TRUE



FALSE

Operation Function

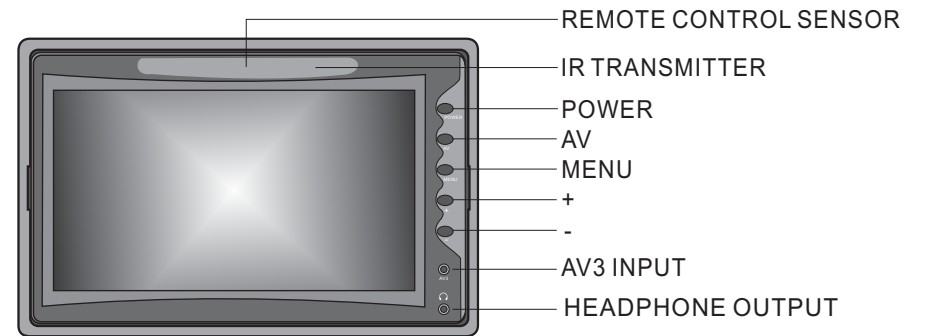

Interface Switch Function

- Power: Power ON/OFF
- AV: Signal Select
- Menu: Press this button for OSD menu.
After that it is the ENTER button.
- +: Increase current option value
- : Decrease current option value

Free Manuals Download Website

<http://myh66.com>

<http://usermanuals.us>

<http://www.somanuals.com>

<http://www.4manuals.cc>

<http://www.manual-lib.com>

<http://www.404manual.com>

<http://www.luxmanual.com>

<http://aubethermostatmanual.com>

Golf course search by state

<http://golfingnear.com>

Email search by domain

<http://emailbydomain.com>

Auto manuals search

<http://auto.somanuals.com>

TV manuals search

<http://tv.somanuals.com>