

DURABRAND

MODEL HT-400

Digital Home Theater Audio System

—Turns Your DVD Player Into a Home Theater—

**DOLBY
DIGITAL**

**5.1 CHANNEL
SYSTEM**

**SURROUND
SOUND**

**FRONT PANEL
GAME INPUTS**



—The Perfect Sound System for Your DVD Player—

- Just add your TV & DVD player; everything else is in the box.
- Incredible surround sound, perfect for DVD viewing & enhanced TV game experience.



PLEASE READ CAREFULLY BEFORE USE

IB-HT400-WM-E-122502

SAFETY INSTRUCTIONS

WARNING

TO PREVENT FIRE OR SHOCK HAZARD, DO NOT USE THE PLUG WITH AN EXTENSION CORD, RECEPTACLE OR OTHER OUTLET UNLESS THE BLADES CAN BE FULLY INSERTED TO PREVENT BLADE EXPOSURE. TO PREVENT FIRE OR SHOCK HAZARD, DO NOT EXPOSE THIS APPLIANCE TO RAIN OR MOISTURE.

 <p>The lightning flash with arrowhead symbol, within an equilateral triangle, is intended to alert the user to the presence of uninsulated "dangerous voltage" within the product's enclosure that may be of sufficient magnitude to constitute a risk of electric shock to persons.</p>	<p>WARNING RISK OF ELECTRIC SHOCK DO NOT OPEN</p> <p>WARNING: TO REDUCE THE RISK OF ELECTRIC SHOCK, DO NOT REMOVE COVER (OR BACK). NO USER SERVICEABLE PARTS INSIDE. REFER SERVICING TO QUALIFIED SERVICE PERSONNEL.</p>	 <p>The exclamation point within an equilateral triangle is intended to alert the user to the presence of important operating and maintenance (servicing) instructions in the literature accompanying the appliance.</p>
--	---	---

IMPORTANT SAFETY INSTRUCTIONS

1. Read these instructions.
2. Keep these instructions.
3. Heed all warnings.
4. Follow all instructions.
5. Do not use this apparatus near water.
6. Clean only with dry cloth.
7. Do not block any ventilation openings, install in accordance with the manufacturer's instructions.
8. Do not install near any heat sources such as radiators, heat registers, stoves, or other apparatus (including amplifiers) that produce heat.
9. Do not defeat the safety purpose of the polarized or grounding-type plug. A polarized plug has two blades with one wider than the other. A grounding type plug has two blades and a third grounding prong. The wide blade or the third prong are provided for your safety. If the provided plug does not fit into your outlet, consult an electrician for replacement of the obsolete outlet.
10. Protect the power cord from being walked on or pinched particularly at plugs, convenience receptacles, and the point where they exit from the apparatus.
11. Only use attachments/accessories specified by the manufacturer.
12. Unplug this apparatus during lightning storms or when unused for long periods of time.
13. Refer all servicing to qualified service personnel. Servicing is required when the apparatus has been damaged in any way, such as power-supply cord or plug is damaged, liquid has been spilled or objects have fallen into the apparatus, the apparatus has been exposed to rain or moisture, does not operate normally or has been dropped.
14. This appliance shall not be exposed to dripping or splashing water and that no object filled with liquid such as vases shall be placed on the apparatus.

Do not apply oil or petroleum products or solvents to any part of this set.

Cleaning the Cabinet

Clean the cabinet, panel and controls with a very dry or slightly moistened soft cloth. Do not use any type of abrasive pad, scouring powder, or solvents, such as alcohol or benzene. Also be extra gentle when cleaning the mirror lens on the center of the set.

FCC NOTE

This equipment has been tested and found to comply with the limits for a Class B digital device, pursuant to Part 15 of the FCC rules. These limits are designed to provide reasonable protection against harmful interference in a residential installation. This equipment generates, uses and can radiate radio frequency energy and, if not installed and used in accordance with the instructions, may cause harmful interference to radio communications. However, there is no guarantee that interference will not occur in a particular installation. If this equipment does cause harmful interference to radio or television reception, which can be determined by turning the equipment off and on, the user is encouraged to try to correct the interference by one or more of the following measures.

- Reorient or relocate the receiving antenna.
- Increase the separation between the equipment and receiver.
- Connect this equipment into an outlet on a circuit different from that to which the receiver is connected.
- consult the dealer or an experienced radio/TV technician for help.

CAUTION

FCC Regulations state that unauthorized changes or modifications to this equipment may void the user's authority to operate it.

PRECAUTIONS

ON SAFETY

Should any solid object or liquid fall into the Home Theater System, unplug the player, and have it checked by qualified personnel before operating it any further.

ON PLACEMENT OF YOUR HOME THEATER SYSTEM

- Do not leave the Home Theater in a location near a heat source, or in a place subject to direct sunlight, excessively dusty rooms or rooms with very high humidity.
- Do not place the Home Theater system on an inclined or unstable place.
- Do not place anything within 1 inch of the sides or 2 inches from the back of the cabinet. The ventilation holes must not be covered for the set to operate properly and prolong the life of its components.

HUMMING NOISE

This set has a cooling fan (similar to a computer). Occasionally during play, you may hear this humming, this is normal. When the main power is shut off or the set is in STANDBY mode, the cooling fan and humming will stop.

INTRODUCTION

Thank you for purchasing this Digital Home Theater System. This deluxe audio theater system turns your home into a virtual theater. In addition to the incredible surround sound of a 5.1 channel audio source, such as your current DVD player, this system also superbly enhances your other audio sources, such as a CD player, VCR, or a cassette deck. The only thing you need to add is your own TV or other devices. We have designed this system to be easy to set up, but please, review this manual before you operate your system. Please have it handy while you are setting the system up; and keep it available for future reference, or in the unlikely event that you encounter any unexpected questions or problems. We have tried to keep this manual as simple as possible. It begins with how to connect the speakers, your TV, and other optional devices. It also includes instructions on how to position the speakers for the most natural surround sound. If you follow the instructions carefully you can have the system set up in about an hour.

This system was designed to provide you with many years of reliable operation with a minimum of care and maintenance. Every component in your system was perfect when it left our factory. If you experience any problem with the set up or operation of this system, please review the Trouble Shooting Guide at the end of this manual before you contact the Customer Service Department at 1-800-315-5885.

All of the adjustable system settings have been preset at our factory for normal operation of the system. All you have to do is to sit back and enjoy the great home theater experience.

Later on, you may want to change some of the optional settings like speaker volume and balance or equalizer (tone) settings. Instructions for changing them, are found later in this manual.

Basic Features & Benefits of this Digital Home Theater System:

1. **Dolby Digital** 5.1 channel audio decoder for real theater surround sound.
2. Multi-position preset graphic equalizer for truly customized tones.
3. Digital coaxial input jack with cable included.
4. TV Game / Video Camera input Jacks on the front panel.
5. Includes audio inputs for DVD, TV / VCR, AUX and TUNER.
6. Fully customizable individual speaker level controls.
7. Powerful subwoofer provides real BOOM in your bass.
8. Automatic decoding of Dolby Digital & Dolby Pro Logic audio signals.
9. Deluxe easy-to-use remote control with batteries included.
10. Designed for easy, mistake-proof color-coded speaker setup.

NOTE:

We recommend that you use this Home Theater System with your DVD player in order to experience the true 5.1 channel sound. However, if you do not have a DVD player, you may still use this system to get better sound from your TV set or any audio device.

THIS SYSTEM CONTAINS



1 Remote Control

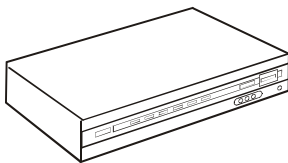

1 Main Unit



1 Center Speaker

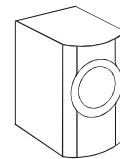

**1 Subwoofer
speaker with wires**

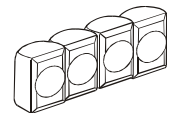

**4 Satellite
Speakers**



2 "AAA" batteries

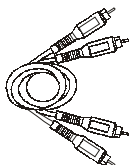

**1 set of Audio Cables
(Red & White)**

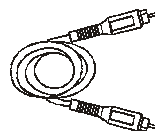

**1 Yellow
Video Cable**

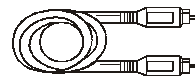

**1 Orange
Coaxial Cable**



**4 sets of
Speaker Wires**

TABLE OF CONTENTS

• Getting Started

Safety Instructions	1
Introduction	2
Location of Controls	4,5
Remote Control Operation	6

• Connections

Choose Your Connection	7
Cables Needed to Connect Components to Your Home Theater System	7
<u>Speaker system connections:</u>	
Speaker system connections	8,9
Speaker Positioning Information	10,11
TV Connections	12
TV + DVD Connections	13
TV + VCR Connections	14
TV + VCR + Satellite Receiver Connections	15
TV + TV Game Connections	16
TV + Video Camera Connections	17
AUX IN Connections	18
AM/FM Tuner Connections	19

Amplifier

General	20
Test Tones	21
Volume Adjustment	22

• Listening Mode

Dolby Digital (AC-3) Mode	23
Listening with Stereo Headphones (not included)	23
Dolby Pro Logic and Stereo Modes	24

• Trouble Shooting

• Specifications

Manufactured under license from Dolby Laboratories. "Dolby" and the double-D symbol are trademarks of Dolby Laboratories. Confidential Unpublished works. ©1992-1997 Dolby Laboratories, Inc. All rights reserved.

LOCATION OF CONTROLS

FRONT PANEL

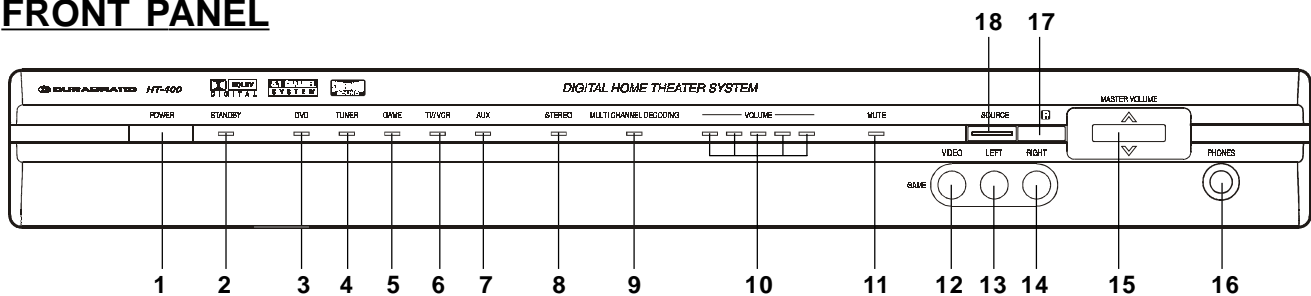

- 1. MAIN POWER button** - Press to switch the set on or off.
NOTE: This button must be **on** in order to be able to use the REMOTE control.
- 2. STANDBY indicator** - This indicator has 2 colors: red and green (red is standby, green is on). When the set is off (standby), pressing the SOURCE or MASTER VOLUME buttons on the main unit, or pressing any button on the REMOTE CONTROL will turn the set on. The indicator will become green. Also this indicator will flash confirming that you pressed any button on the REMOTE CONTROL.
- 3. DVD indicator** - For DVD sound use, press the SOURCE button till this lights or press the DVD button on your REMOTE control.
- 4. TUNER indicator** - For AM/FM TUNER sound use, press the SOURCE button till this lights or press the TUNER button on your REMOTE control.
- 5. GAME indicator** - For TV GAME or VIDEO CAMERA use, press the SOURCE button till this lights or press the GAME button on your REMOTE control.
- 6. TV/VCR indicator** - For TV/VCR sound use, press the SOURCE button till this lights or press the TV/VCR button on your REMOTE control.
- 7. AUX indicator** - For AUX IN sound use, press the SOURCE button till this lights or press the AUX button on your REMOTE control.
- 8. STEREO indicator** - In STEREO mode, this red indicator lights up (for 2 channel sound).
- 9. MULTI CHANNEL DECODING indicator** - When the input source is Dolby Digital, DTS or PRO LOGIC, this blue indicator lights up (for 5.1 channel sound).
- 10. VOLUME indicators** - These indicators light up showing the level of the master volume.
- 11. MUTE indicator** - In mute mode, this indicator will light.
- 12. VIDEO IN jack** - For connection of a video signal from a TV game or video camera (see details on Page 16 & 17).
- 13. AUDIO LEFT jack** - Connect to the left channel audio output of a TV game or video camera.
- 14. AUDIO RIGHT jack** - Connect to the right channel audio output of a TV game or video camera.
- 15. MASTER VOLUME UP & DOWN control** - Increases or decreases the volume level of all speakers.
- 16. PHONES jack** - For connecting stereo headphones.
- 17. REMOTE CONTROL SIGNAL sensor** - Receives the signal from the REMOTE CONTROL (Aim the REMOTE control towards this sensor).
- 18. SOURCE button** - Press several times to select the sound input source you want: DVD, TUNER, GAME, TV/VCR, or AUX.

BACK PANEL

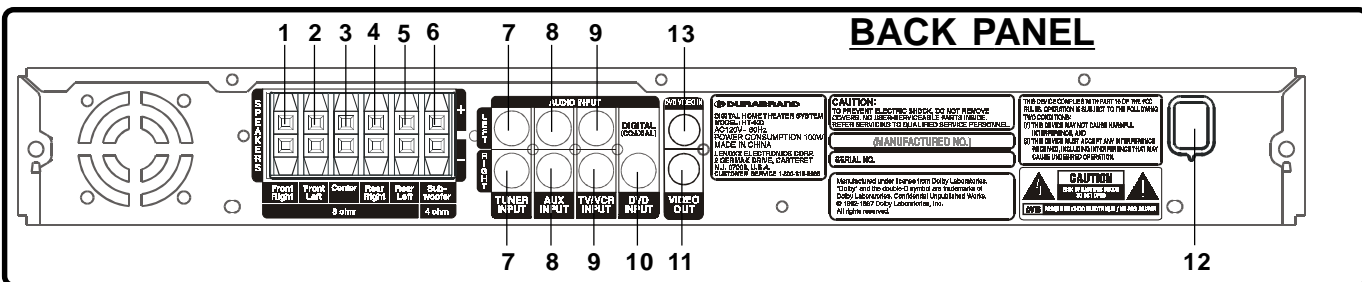

- 1. FRONT RIGHT SPEAKER jacks** - Connect the FRONT RIGHT SPEAKER to the red and black terminals.
- 2. FRONT LEFT SPEAKER jacks** - Connect the FRONT LEFT SPEAKER to the red and black terminals.
- 3. CENTER SPEAKER jacks** - Connect only the CENTER SPEAKER to the blue and black terminals.
- 4. REAR RIGHT SPEAKER jacks** - Connect the REAR RIGHT SPEAKER to the grey and black terminals.
- 5. REAR LEFT SPEAKER jacks** - Connect the REAR LEFT SPEAKER to the grey and black terminals.
- 6. SUBWOOFER SPEAKER jacks** - Connect the SUBWOOFER SPEAKER to the green and black terminals.
- 7. TUNER AUDIO INPUT jacks** - Connect to the audio output of your AM/FM TUNER.
- 8. AUX AUDIO INPUT jacks** - Connect to the audio output of a tape deck or other component.
- 9. TV/VCR AUDIO INPUT jacks** - Connect to audio output of a TV or VCR.
- 10. DVD AUDIO INPUT jacks** - Connect to the digital (coaxial) audio output of a DVD player to have Dolby Digital, DTS 5.1 channel surround sound.
- 11. VIDEO OUT jack** - Connect to your TV's video input jack. (If your TV has no VIDEO jack, you have to buy a VIDEO RF MODULATOR.)
IMPORTANT: This jack is only used if you are connecting a TV GAME or VIDEO CAMERA to the set.
- 12. AC LINE CORD** - Connect to a 120V/60Hz AC standard wall outlet.
- 13. DVD VIDEO IN jack** - Connect to your DVD's video out jack.

LOCATION OF CONTROLS

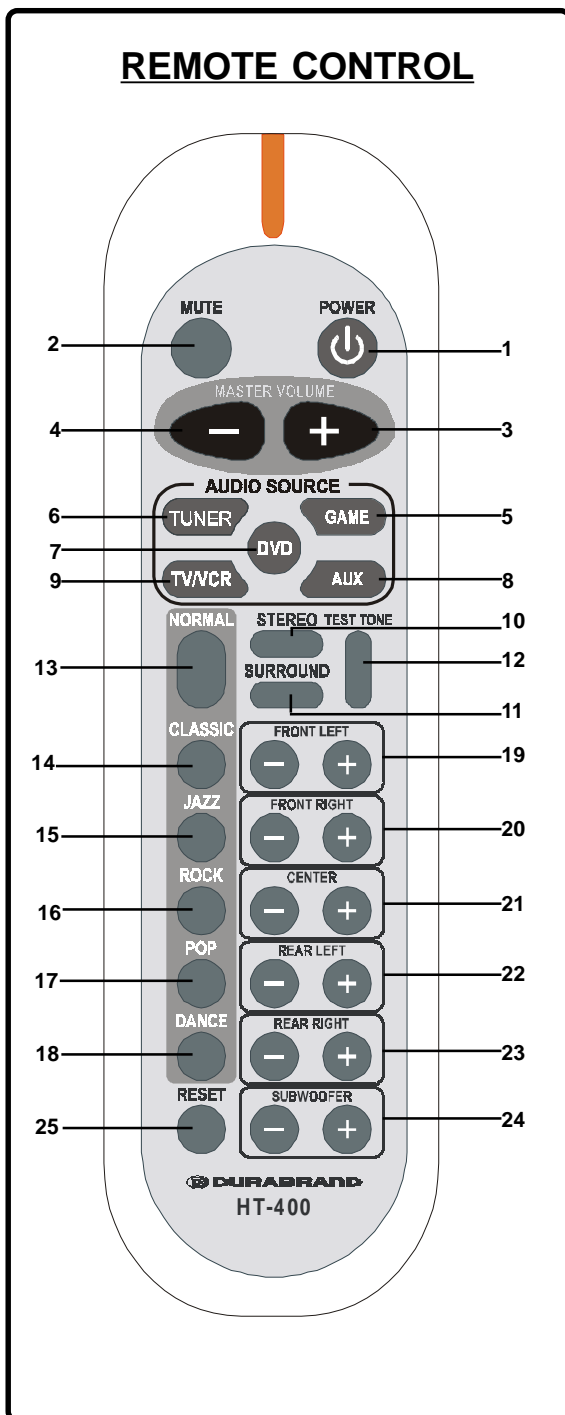

- POWER button** - Switches the player from STANDBY to ON or ON to STANDBY (if the main POWER of the set is ON).
 - MUTE button** - Instantly turns off the sound. Press again to restore the sound.
 - MASTER VOLUME UP button** (+) - Press to raise the volume level of all speakers.
 - MASTER VOLUME DOWN button** (-) - Press to lower the volume level of all speakers.
 - GAME button** - Selects the TV GAME (or VIDEO CAMERA) play mode. The GAME indicator on the front panel will light.
 - TUNER button** - Selects the AM/FM TUNER audio input mode. The TUNER indicator on the front panel will light.
 - DVD button** - Selects the DVD player audio input mode. The DVD indicator on the front panel will light.
 - AUX button** - Selects the AUXILIARY audio input mode. The AUX indicator on the front panel will light.
 - TV/VCR button** - Selects the TV or VCR audio input mode. The TV/VCR indicator on the front panel will light.
 - STEREO button** - Press to select STEREO (2 channel) listening mode, and the STEREO indicator on the front panel will be on.
 - SURROUND button** - Press to select DTS, Dolby Digital Pro Logic 5.1 channel audio listening mode. The MULTI CHANNEL DECODING indicator will be on (sound will come out of all 6 speakers).
 - TEST TONE button** - Press to activate the test tone function to check whether your speakers are connected properly.
- NOTE:** The following 6 buttons adjust the frequency response (tones) of your system.
- NORMAL button** - Press to select NORMAL tones listening mode.
 - CLASSIC button** - Press to select CLASSIC tones listening mode.
 - JAZZ button** - Press to select JAZZ tones listening mode.
 - ROCK button** - Press to select ROCK tones listening mode.
 - POP button** - Press to select POP tones listening mode.
 - DANCE button** - Press to select DANCE tones listening mode.
 - FRONT LEFT UP & DOWN VOLUME buttons** - Press to adjust the individual FRONT LEFT speaker's sound level.
 - FRONT RIGHT UP & DOWN VOLUME buttons** - Press to adjust the individual FRONT RIGHT speaker's sound level.
 - CENTER UP & DOWN VOLUME buttons** - Press to adjust the individual CENTER speaker's sound level.
 - REAR LEFT UP & DOWN VOLUME buttons** - Press to adjust the individual REAR LEFT speaker's sound level.
 - REAR RIGHT UP & DOWN VOLUME buttons** - Press to adjust the individual REAR RIGHT speaker's sound level.
 - SUBWOOFER UP & DOWN VOLUME buttons** - Press to adjust the SUBWOOFER speaker's sound level.
 - RESET button** - Press to reset all speakers' output to the factory's default settings.

REMOTE CONTROL OPERATION

Battery Installation

Remove the BATTERY COMPARTMENT DOOR of the REMOTE CONTROL and insert 2 size "AAA" alkaline batteries (included) according to the \oplus and \ominus markings inside the BATTERY COMPARTMENT of the REMOTE CONTROL unit.

Gently push here and slide to open the BATTERY DOOR.

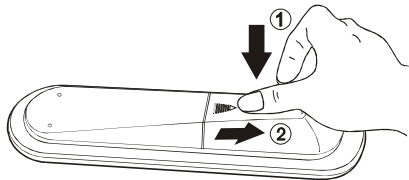

Insert the 2 size "AAA" batteries as shown (included).

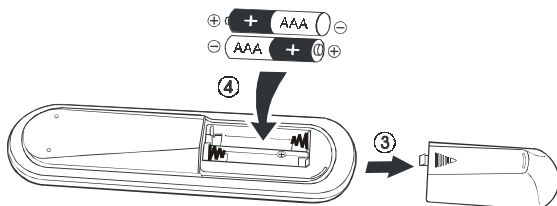

Remember, the spring touches the \ominus side of each battery.

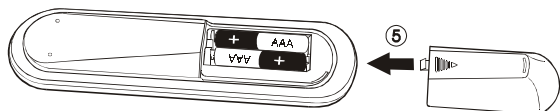

Replace the door.

Tips on Battery Use

- Reversing polarities will damage the batteries and possibly your REMOTE. Be sure to follow polarity \oplus and \ominus as indicated.
- Do not mix different types of batteries together (Alkaline, Carbon-Zinc, Nickel-Cadmium etc.), or old batteries with new ones.
- When not in use for an extended period of time (over 60 days), remove the batteries to prevent possible acid leakage or corrosion resulting in possible damage to your REMOTE CONTROL.
- When the batteries have become discharged, they must be disposed of in a safe manner that complies with all applicable laws.
- Installation of batteries should only be done by an adult (for safety).

Remote Control Operating Range

Point the REMOTE CONTROL unit within 20 feet from the remote control sensor and facing the front of the HOME THEATER SYSTEM.

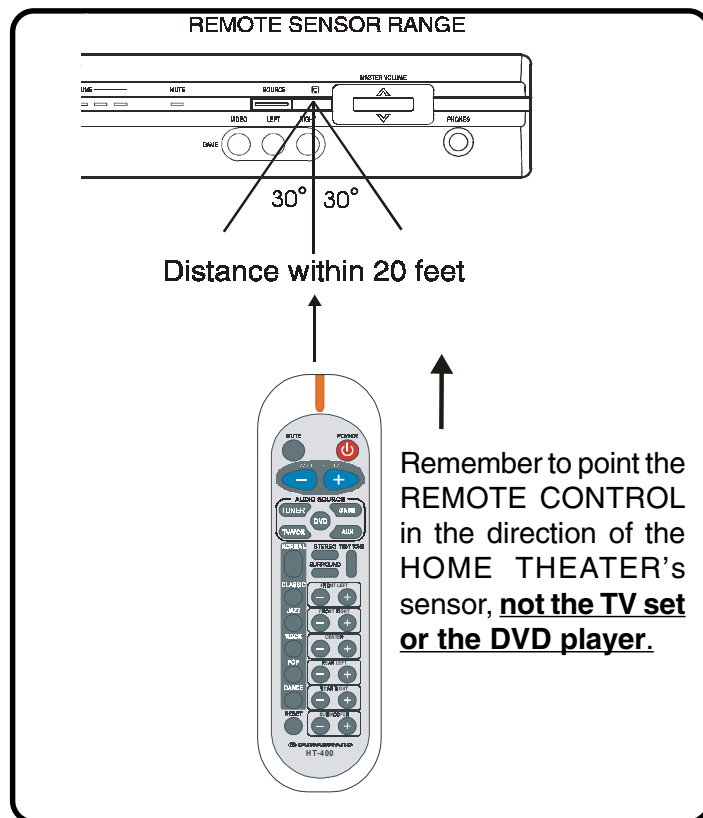

Point the REMOTE CONTROL at the Home Theater's Front

Make sure there is a clear path between the REMOTE CONTROL and the HOME THEATER SYSTEM so that the signal is not blocked.



Tips on REMOTE CONTROL operation

- The REMOTE control's operating distance may vary according to the brightness of the room.
- Do not point bright lights at the REMOTE CONTROL SENSOR (like laser pointers).
- Do not place objects between the REMOTE CONTROL unit and the REMOTE CONTROL SENSOR.
- Do not use this REMOTE CONTROL while simultaneously using the remote control unit of any other equipment, the signals may mix.
- Sometimes your TV's remote may cause an LED to flash, you can ignore this.

CONNECTIONS

Choose Your Connection

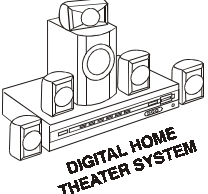
There are several ways to connect your Home Theater System. Please use the following chart to determine which connection is the best for you. Turn to the appropriate page and connect your Home Theater System.

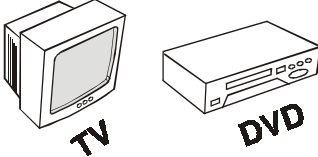
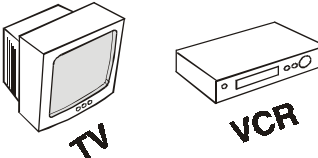
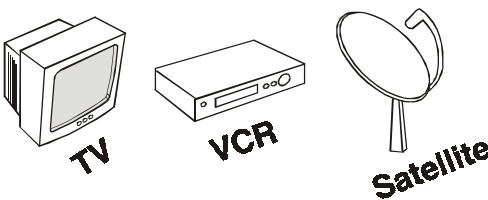
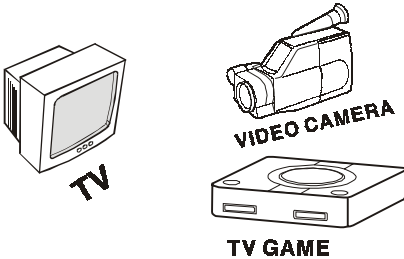
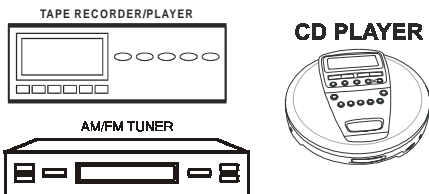
COMPONENTS		CABLES NEEDED	GO TO ...
	 NOTE: This only applies if your TV has audio out jacks.	TV + HOME THEATER (only)	<ul style="list-style-type: none"> • Audio (included) Page 12
	 TV DVD	TV/DVD + HOME THEATER	<ul style="list-style-type: none"> • Video (included) • Coaxial (included) Page 13
	 TV VCR	TV/VCR + HOME THEATER	<ul style="list-style-type: none"> • Video (included) • Audio (included) Page 14
	 TV VCR Satellite	TV/VCR + HOME THEATER + SATELLITE	<ul style="list-style-type: none"> • Video (included) • Audio (included) Page 15
	 TV VIDEO CAMERA TV GAME	TV + HOME THEATER + TV GAME or VIDEO CAMERA	<ul style="list-style-type: none"> • Video (special, not included) • Audio (special, not included) Page 16,17
	 TAPE RECORDER/PLAYER CD PLAYER AM/FM TUNER	AM/FM TUNER or other AUX DEVICE + HOME THEATER	<ul style="list-style-type: none"> • Audio (included) Page 18,19

Cables Needed to Connect Components to Your Home Theater System

The pictures below show the cables needed for the connections represented in this booklet.

NOTE: Audio cables are usually sold as a bundled set, but the connection sketches in this booklet show each cable separately for better visibility. You need additional cables to connect everything shown above. Check your other equipments' booklets to see what cables are needed.

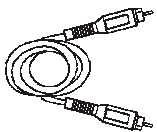

Yellow Video cable (included)

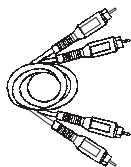

Red & White Audio cables (included, most installations will need these)



Speaker Wires (6 sets are included, and one set is attached on the back of the SUBWOOFER)

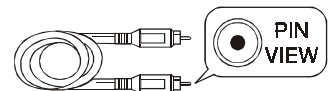

Orange Coaxial cable (included)

SPEAKER SYSTEM CONNECTIONS

Speaker System Connections

Connect the supplied speaker system using the supplied speaker cords by matching the colors of the terminals to those of the cords.

IMPORTANT:

Before making connections, make sure the power is off. At the rear of each supplied speaker you will find two spring type connectors in different colors: a black one (-) and a red, blue or gray one(+). (The Subwoofer does not have spring type connecting tabs at the rear, only a set of black & green speaker wires from its back.)

The speaker wires and connectors are color coded for easier set up.

- Connect the Front Left speaker to the Front Left terminals.
- Connect the Front Right speaker to the Front Right terminals.
- Connect the Center speaker to the Center speaker terminals.
- Connect the Rear Left speaker to the Rear Left terminals.
- Connect the Rear Right speaker to the Rear Right terminals.
- Connect the Subwoofer to the Subwoofer terminals.

QUICK SETUP DIAGRAM

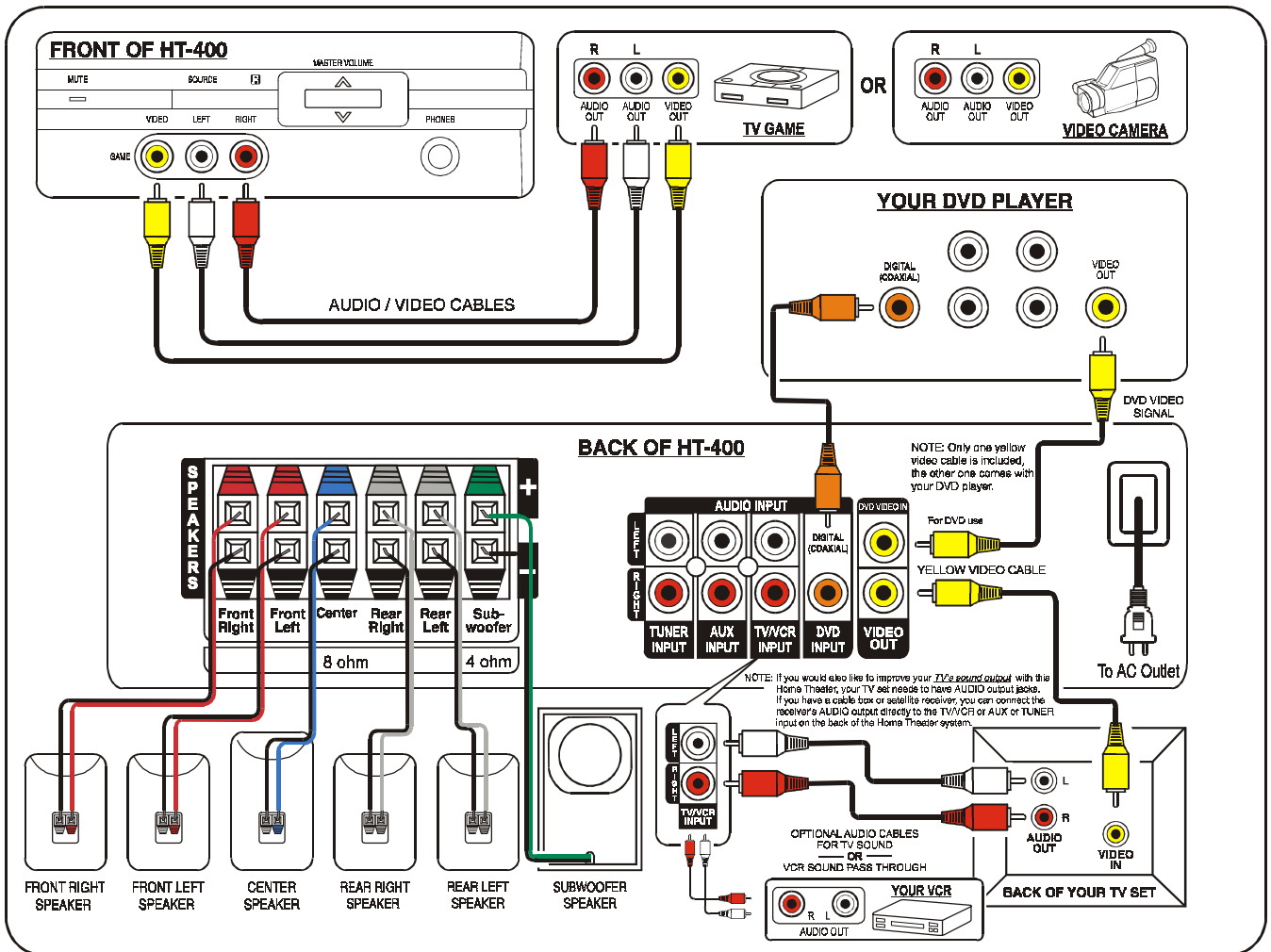

IMPORTANT!

This Home Theater only improves the **sound** of your DVD systems, it works only when your DVD's AUDIO OUTPUT is set to DIGITAL mode.

NOTE

In your package you will find 6 sets of colored speaker wire pairs for connecting your Home Theater to the 6 different speakers:

- 1 **green and black** pair of wires for the subwoofer which comes out of the back of the subwoofer (12 1/2 feet long).
- 2 **grey and black** pairs of wires (26 feet long) for connecting the rear speakers with **grey and black** terminals.
- 1 **blue and black** pair of wires (13 feet long) for the center speaker with **blue and black** terminals.
- 2 **red and black** pairs of wires (13 feet long) for the front speakers with **red and black** terminals.

SPEAKER SYSTEM CONNECTIONS

Tips for connecting the speaker wires

Push and hold the Speaker terminal tab down to insert each wire. Release the tab to lock the wire into the terminal. Make sure the wire is fully inserted, but the insulation is not covering the inserted part of the speaker wires.

SPEAKER TERMINALS

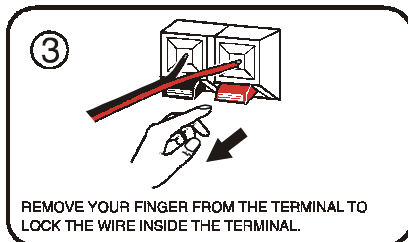
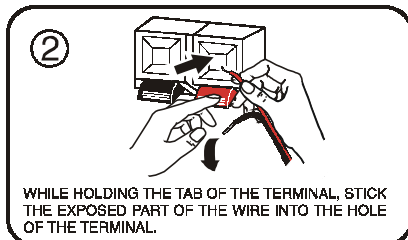
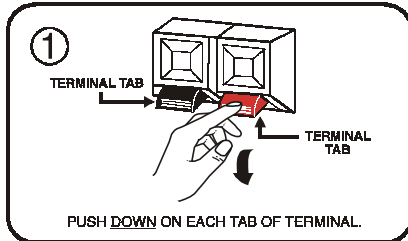

SET TERMINALS

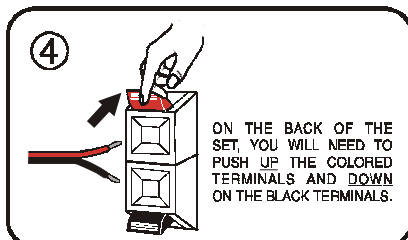

GO ON TO THE NEXT WIRE & REPEAT ABOVE. REMEMBER WIRES MUST GO FROM THE SET TO THE SPEAKERS. MAKE SURE POWER IS OFF WHEN DOING THE ABOVE.

NOTE:

Be sure to match the speaker wire to the appropriate terminal on the components: (+) to (+) (color), and (-) to (-) (black). If the wires are reversed, the sound will be distorted and will lack some tones. Follow the color codes of each speaker.

To avoid short-circuiting the speakers

- Make sure the stripped end of each speaker wire does not touch another speaker terminal or the stripped end of another speaker wire.

Examples of poor connection of the speaker wires

LOOSE STRANDS TOUCHING

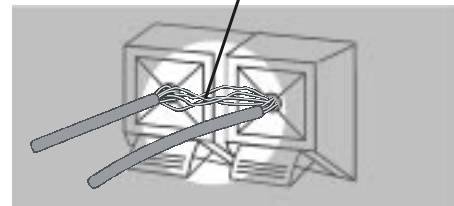

- Stripped speaker wire is touching another speaker terminal. **Make sure not even 1 strand of wire touches the other wire!**

WIRES SHORTED TO EACH OTHER

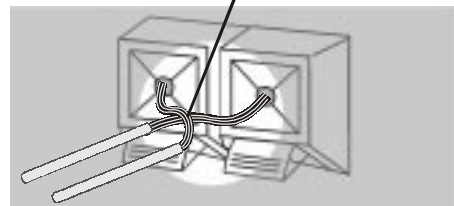

- Stripped wires are touching each other due to excessive removal of insulation. Do not allow the above to happen on your set or speakers.

SPEAKER POSITIONING INFORMATION

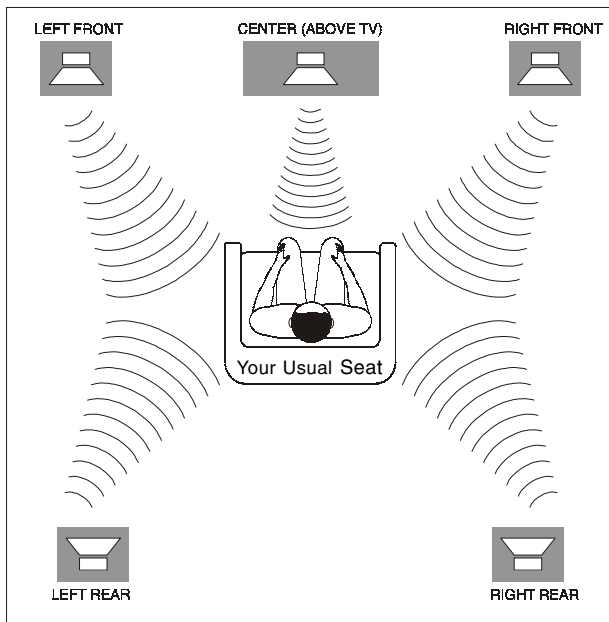

POSITION ALL 5 SPEAKERS APPROXIMATELY AT THE SAME DISTANCE FROM YOUR LISTENING POSITION. POSITION THE SUBWOOFER AS BELOW.

Your system is supplied with 4 compact sized satellite speakers, one slightly larger center speaker and one large subwoofer. The satellite speakers and the center speaker reproduce only the mid range and higher frequencies. All of the low frequency (bass) sounds are produced by the subwoofer. Proper positioning and placement of the speakers is important in order to provide the best surround sound experience. We understand that due to the size and shape of your listening room, and the location of your furniture, you may not be able to set up the speakers exactly as per these diagrams. However these simple guidelines will help you maximize your home theater experience.

- Note the speaker levels are preset at the factory and most people will not need to fine tune the sound of each speaker. We suggest you skip this part at first. Later on you can adjust the sound level of each individual speaker. See Page 22.
- Although all 4 satellites are of the same size, the speakers inside the cabinets are different. The speaker terminals on the back of the cabinets are color-coded, as are the speaker wires and the speaker terminals on the back of the main unit. Refer to the connection diagram on page 8. **Be sure you are using the correct satellite speaker in each location, front, rear and center.** Please follow the colors for best results.
- For best surround sound effects, all 4 of the satellite speakers and the center speaker should be roughly at the same distance from your usual listening position.

POSITION THE SPEAKERS LIKE THIS FOR OPTIMAL LISTENING EXPERIENCE

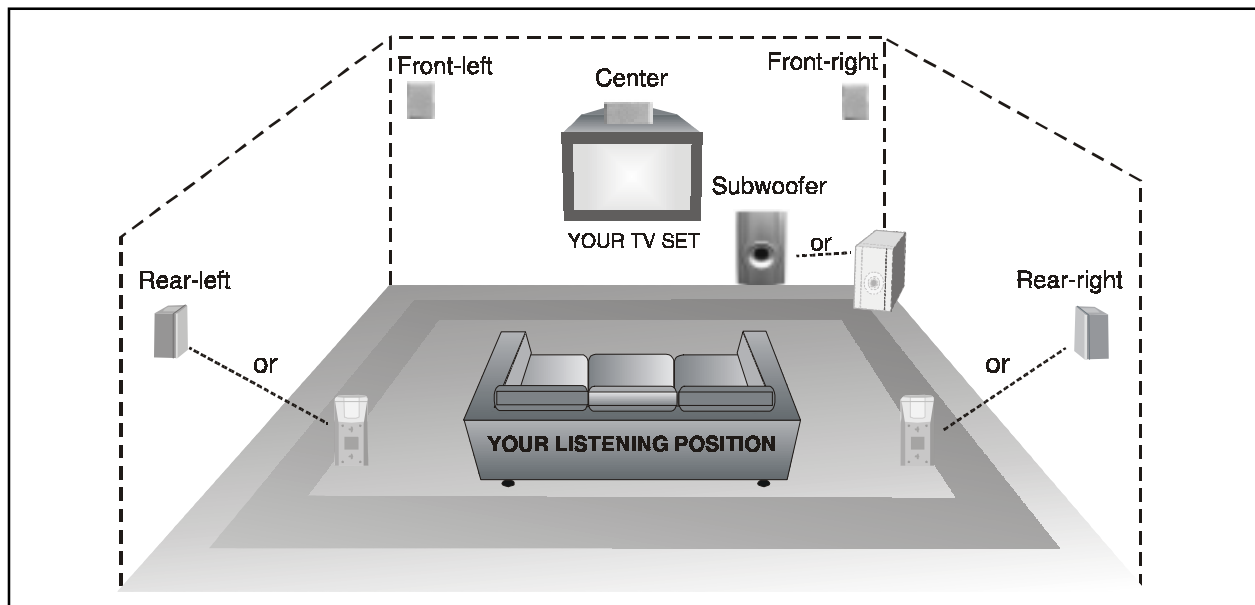

- All 4 satellite speakers and the center speaker should be placed approximately the same distance from your listening position.
- The center speaker should be placed directly above (or below) the TV set. Left and right front speakers should be approximately at the same height as the center speaker.
- The rear speakers should be either in line with, or behind your listening position, approximately at ear level, or slightly above.
- The subwoofer should be on the floor near the TV, or in any corner, with the front hole facing your listening position.
- All speakers must be visible. Do not hide them behind curtains, furniture, etc, as this will affect the sound.

SPEAKER POSITIONING INFORMATION

SATELLITE SPEAKERS

- The center speaker, as well as the other 4 satellite speakers, can be positioned either vertically or horizontally.
- The left front, right front, and center speakers should be placed at roughly the same height. The center speaker reproduces most of the dialog spoken by the actors on the TV screen, therefore it should be placed either directly above or below the center of the TV set. Once you position the center speaker, try to position the left front and right front speakers at the same height. It is not recommended to place any of the satellite speakers on the floor. Many people prefer to place the center speaker horizontally above the TV set.
- The left rear and right rear speakers can be placed in line with your listening position or behind your listening position. Ideally they should be placed slightly above your ear level when you are seated in your normal listening position.
- We have provided 2-way keyhole openings on the backs of all the satellite speakers that allow the satellite speakers to be wall mounted in either a vertical or horizontal position.
- The subwoofer will provide the most dramatic bass effects (low frequency sounds like explosions and thunder) when it is placed on the floor. Do not place the subwoofer on a stand or table. The subwoofer should be placed in the front of the room so that it is facing towards your listening position. It can be placed on either side of the TV or even in the corner of the room, as far away as the cable will allow. The bass sounds from the subwoofer are non-directional. You will not really be able to tell where the bass is coming from.
- LONG ROOMS - In case your room is unusually long, you may buy speaker wires from your dealer for adding wire length to your speakers. Be careful not to allow the plus ⊕ and minus ⊖ wires to touch each other. Use electrical tape or plastic connectors to insulate the wires from each other.

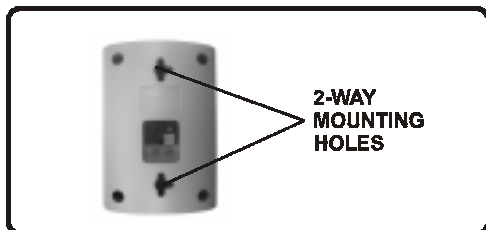
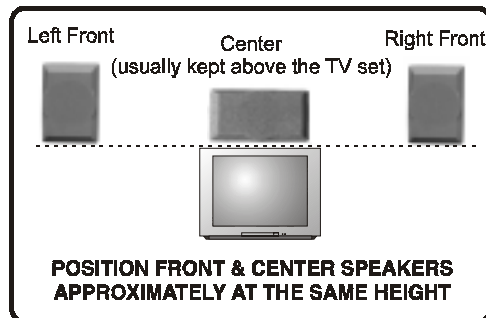
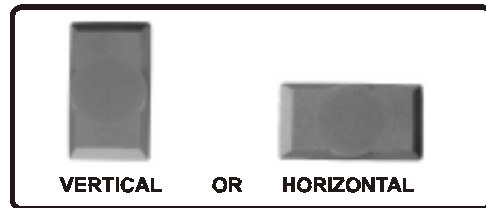

SUBWOOFER

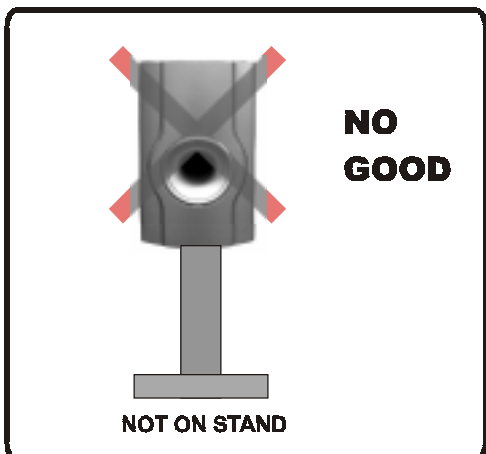

TV CONNECTIONS (If you don't have a DVD player yet)

Home Theater System + TV (if your TV has Audio Output jacks)

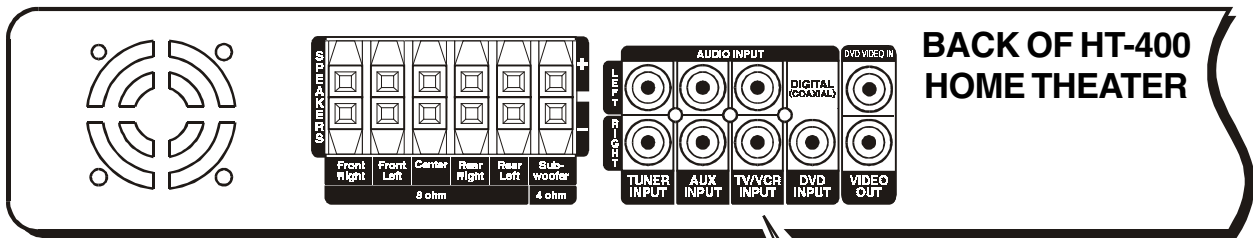

CONNECT ALL SPEAKERS AS SHOWN ON PAGE 8 (OR THE QUICK SETUP DIAGRAM SHEET).

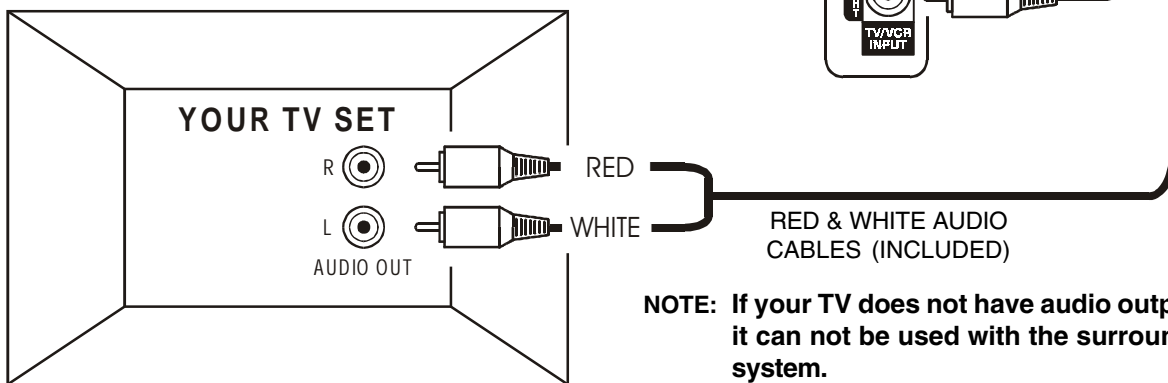

NOTE: On some TVs, these jacks are in the front, or your TV may not have these jacks.

NOTE: If your TV does not have audio output jacks, it can not be used with the surround sound system.

If you have a cable box or satellite receiver, you can connect the receiver **AUDIO OUTPUT** directly to your **TV/VCR INPUT** on the back of the **HOME THEATER SYSTEM**.

1. Connect the 5 satellite speakers and subwoofer as shown on Page 8 (or the QUICK SETUP DIAGRAM packed with the set).
2. Insert the stereo audio cables (included) into the TV / VCR AUDIO INPUT L (left=white) and R (right=red) jacks on the back of your HOME THEATER SYSTEM, and into the corresponding AUDIO OUT jacks on your TV, this will allow your TV's sound to play through your HOME THEATER SYSTEM.

NOTE: Your TV's sound will come out of the 2 front speakers plus the subwoofer since the default setting for the sound output is the same as the audio source from the TV (2 channel, STEREO). For "Dolby Pro Logic" (5.1 channel) sound reproduction, press the SURROUND button. The sound will come out of all 5 speakers plus the subwoofer.

NOTE: On some TVs, you may have to activate the audio out jacks of your TV. See your TV's booklet.

3. Insert the AC power cord into an AC outlet.
4. Press the POWER button on the main unit (not the REMOTE) to turn on the main power of the set. Next press the POWER button on the REMOTE to turn the set on (or off).
5. Press the SOURCE button several times till the TV/VCR indicator lights.
6. Go to Page 20 for detailed instructions.

NOTE: Your cable or antenna connection to your TV are not touched with this connection. Leave your antenna cable to your TV as you normally would. No changes will be made to your current antenna connections.

TV + DVD CONNECTIONS

Home Theater System + TV + DVD Player

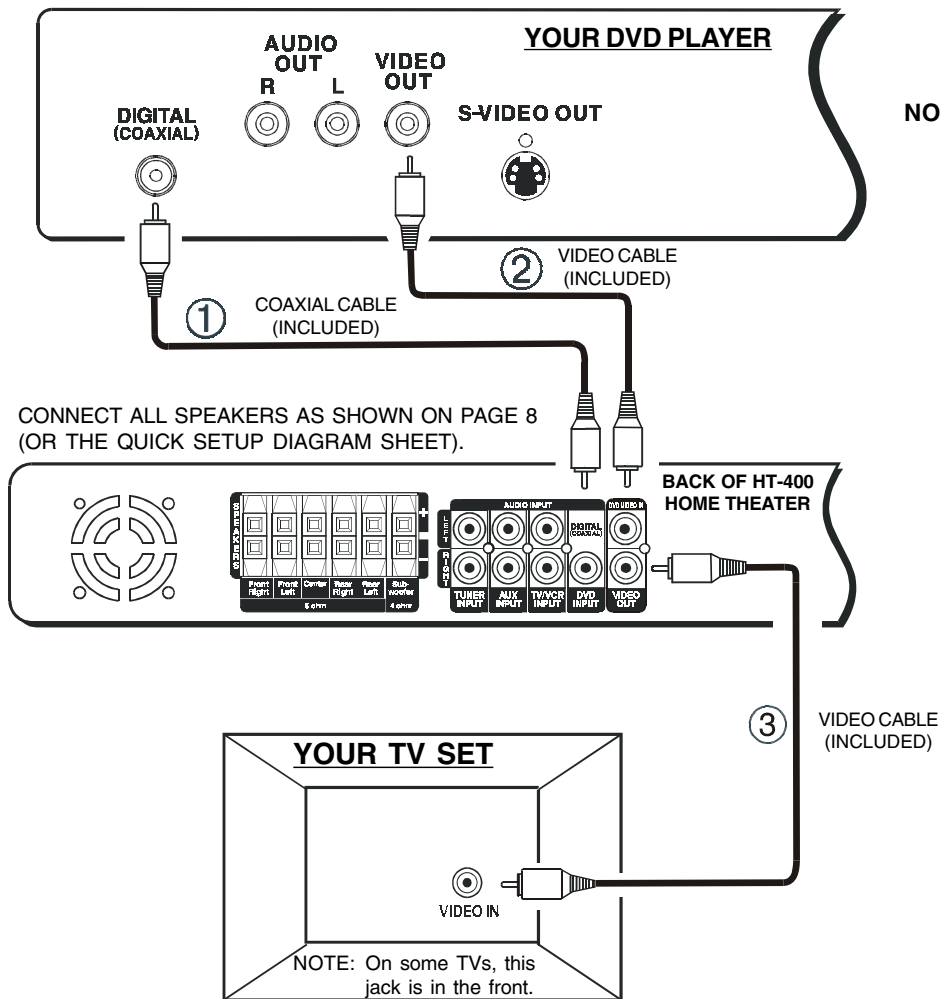

NOTE: Some newer TV sets have several VIDEO INPUT jacks. You may use one of these for your DVD player and the others for connecting to the VIDEO OUT jack. If your set is older and only has a single VIDEO INPUT jack, you may buy a switch box to change video inputs from DVD to game video out (Game), etc.

1. Insert the COAXIAL cable (included) into the DVD INPUT jack on the back of your HOME THEATER SYSTEM, and into the DIGITAL (COAXIAL) jack on your DVD player, this will allow your DVD's Dolby Digital audio or DTS sound to play through your HOME THEATER SYSTEM.

NOTE: For a Dolby Digital or a DTS (5.1 channel) recorded DVD disc, the sound will come out of all 5 speakers plus the subwoofer. For a Stereo DVD disc (2 channel), the sound will only come out of the 2 front speakers plus the subwoofer. This set will decode and automatically play back whatever sound system was recorded on the DVD or audio disc. To manually change stereo (2 channel) audio to Dolby Pro Logic, press the SURROUND button. The sound will come out of all 5 speakers plus the subwoofer.

NOTE: Make sure your DVD's AUDIO OUTPUT is set to "DIGITAL".

2. Insert the video cable into the VIDEO OUT jack on the back of your DVD player, and into the DVD VIDEO IN jack on the back of your HOME THEATER SYSTEM.
3. Insert the video cable into the VIDEO IN jack on your TV, and into the VIDEO OUT jack on the back of your HOME THEATER SYSTEM.
4. Insert the AC power cord into an AC outlet.
5. Press the POWER button on the main unit (not the REMOTE) to turn on the main power of the set. Next press the POWER button on the REMOTE to turn the set on (or off).
6. Press the SOURCE button several times till the DVD indicator lights.
7. Make sure your DVD player is on and follow your DVD player's instructions.
8. Go to Page 20 for detailed instructions.

NOTE: Your cable or antenna connection to your TV are not affected with this connection. Leave your antenna cable connected to your TV as you normally would. No changes will be made to your current antenna connections.

TV + VCR CONNECTIONS

Home Theater System + TV + VCR

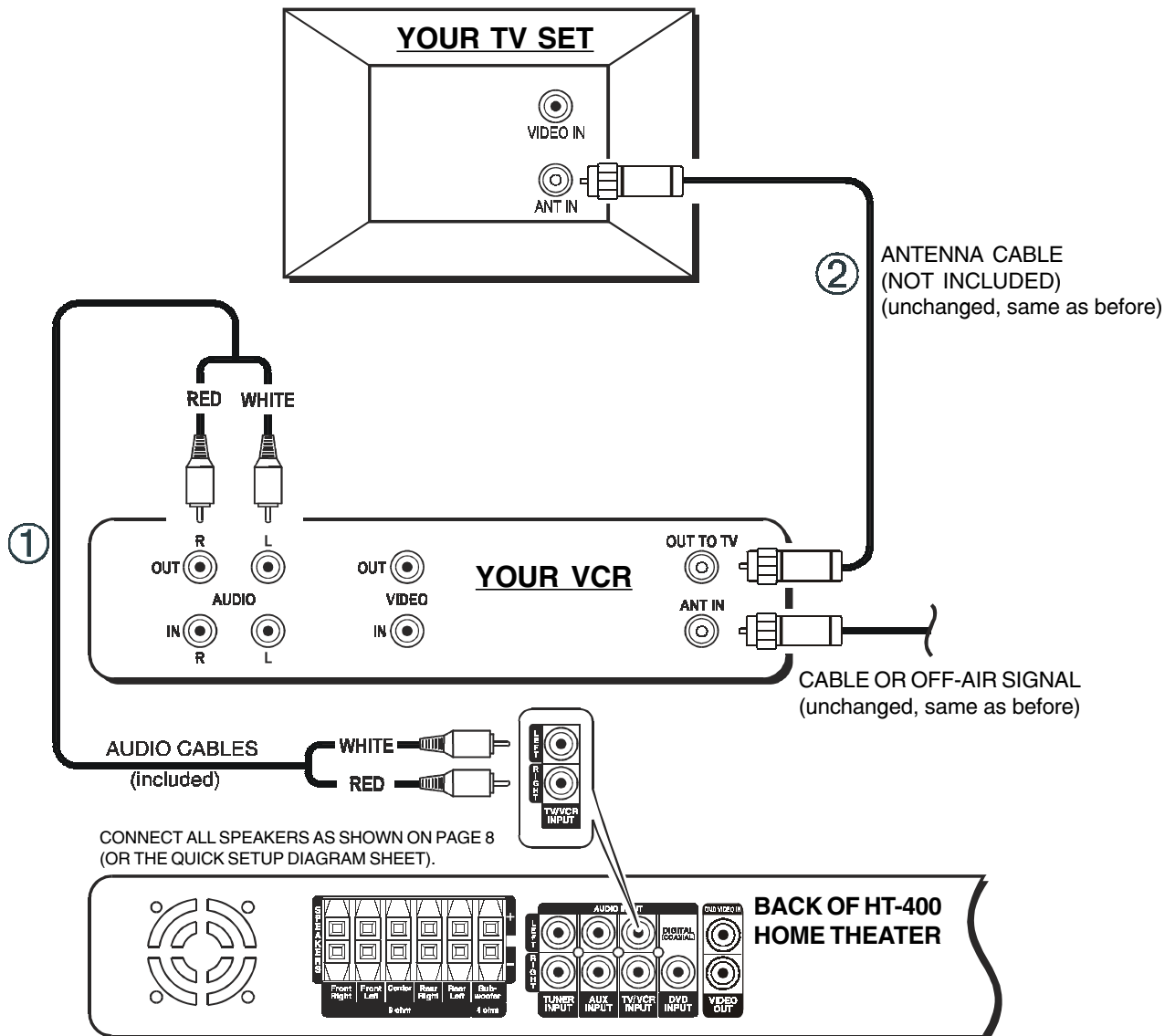

1. Insert the stereo audio cables (included) into the TV/VCR AUDIO INPUT L (left=white) and R (right=red) jacks on the back of your HOME THEATER SYSTEM, and into the corresponding AUDIO OUT jacks on your VCR, this will allow your VCR's sound to play through your HOME THEATER SYSTEM.

NOTE: Your VCR's sound will come out of the 2 front speakers plus the subwoofer since the default setting for the sound output is the same as the audio source from the VCR (2 channel, STEREO). For "Dolby Pro Logic" (5.1 channel) sound reproduction, press the SURROUND button. The sound will come out of all 5 speakers plus the subwoofer.

2. Connect your VCR to your TV using a coaxial antenna cable (probably already connected), your VCR's picture will go to your TV through the antenna connection.
3. Connections of your other antenna cables are not changed when you add your HOME THEATER SYSTEM.
4. Insert the AC power cord into an AC outlet.
5. Press the POWER button on the main unit (not the REMOTE) to turn on the main power of the set. Next press the POWER button on the REMOTE to turn the set on (or off).
6. Press the SOURCE button several times till the TV/VCR indicator lights.
7. Make sure your VCR is on and follow your VCR's instructions.
8. Go to Page 20 for detailed instructions.

TV + VCR + SATELLITE RECEIVER CONNECTIONS

Home Theater System + TV + VCR + Satellite

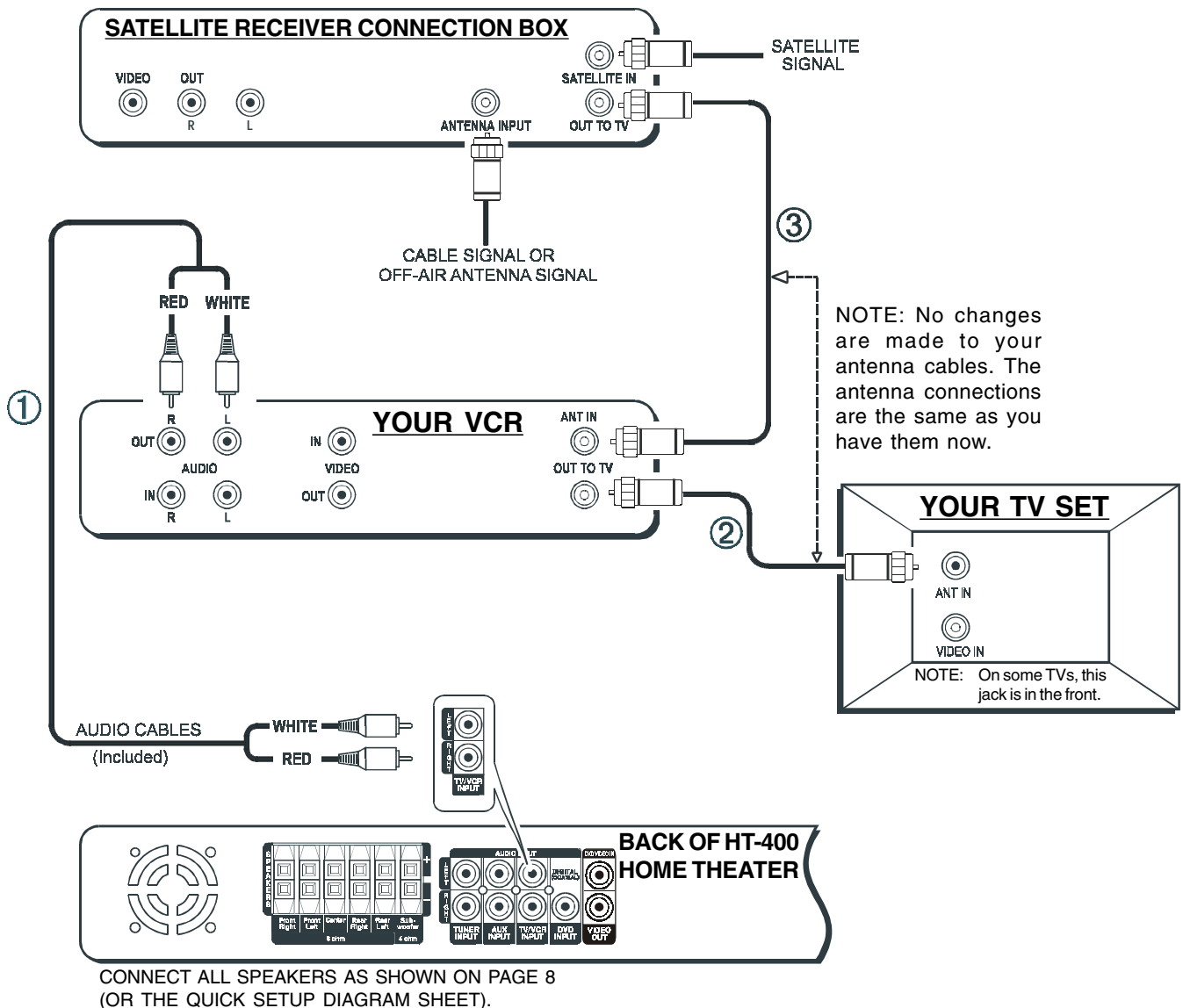

1. Follow the above connection diagram and check if you have these items. If your VCR has AUDIO OUT jacks, you may connect your VCR to your HOME THEATER as shown.

NOTE: Your VCR's sound will come out of the 2 front speakers plus the subwoofer since the default setting for the sound output is the same as the audio source from the VCR (2 channel, STEREO). For "Dolby Pro Logic" (5.1 channel) sound reproduction, press the SURROUND button. The sound will come out of all 5 speakers plus the subwoofer.

2. Connect your VCR to your TV using a coaxial antenna cable (probably already connected), your VCR's picture will go to you TV through the antenna connection.
3. Use an antenna cable to connect the antenna output on the satellite receiver to the antenna input on the VCR the same as you have it connected now. This HOME THEATER SYSTEM does not change any antenna connections.
4. Insert the AC power cord into an AC outlet.
5. Press the POWER button on the main unit (not the REMOTE) to turn on the main power of the set. Next press the POWER button on the REMOTE to turn the set on (or off).
6. Press the SOURCE button several times till the TV/VCR indicator lights.
7. Make sure your VCR is on and follow your VCR's instructions.
8. Go to Page 20 for detailed instructions.

TV + TV GAME CONNECTIONS

Home Theater System + TV + TV Game

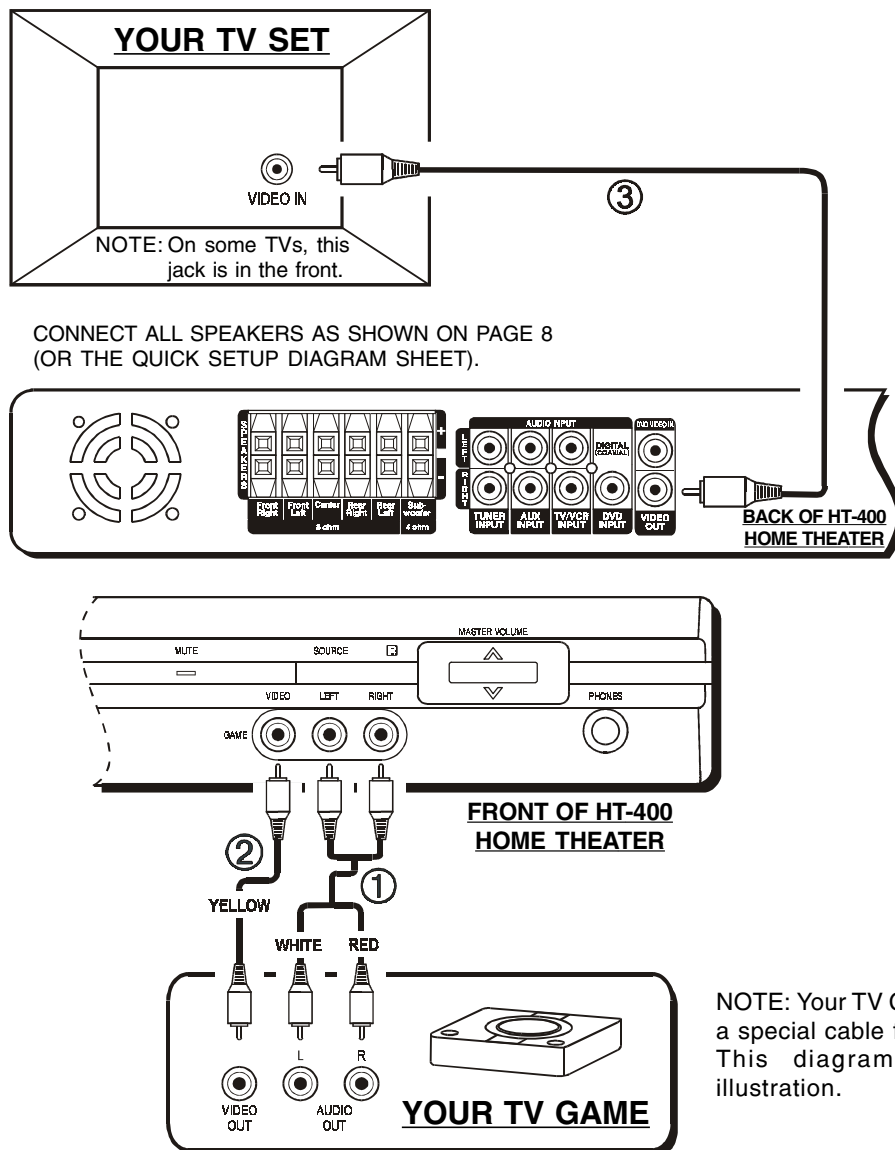

1. Insert the stereo audio cables into the AUDIO INPUT L (left=white) and R (right=red) jacks on the **FRONT** of your HOME THEATER SYSTEM, and into the corresponding AUDIO OUT jacks on your TV GAME, this will allow your TV GAME's sound to play through your HOME THEATER SYSTEM.
2. Insert the yellow video cable (included with your TV GAME) into the VIDEO IN jack on the **FRONT** of your HOME THEATER SYSTEM, and into the VIDEO OUT jack on your TV GAME.
3. Insert another video cable into the VIDEO OUT jack on the back of your HOME THEATER SYSTEM, and into the VIDEO IN jack on your TV.

NOTE: Your TV GAME's sound will come out of the 2 front speakers plus the subwoofer since the default setting for the sound output is the same as the audio source from the TV GAME (2 channel, STEREO). For "Dolby Pro Logic" (5.1 channel) sound reproduction, press the SURROUND button. The sound will come out of all 5 speakers plus the subwoofer.

4. Insert the AC power cord into an AC outlet.
5. Press the POWER button on the main unit (not the REMOTE) to turn on the main power of the set. Next press the POWER button on the REMOTE to turn the set on (or off).
6. Press the SOURCE button several times till the GAME indicator lights.
7. Make sure your TV GAME is on and follow your TV GAME's instructions.
8. Go to Page 20 for detailed instructions.

TV + VIDEO CAMERA CONNECTIONS

Home Theater System + TV + Video Camera

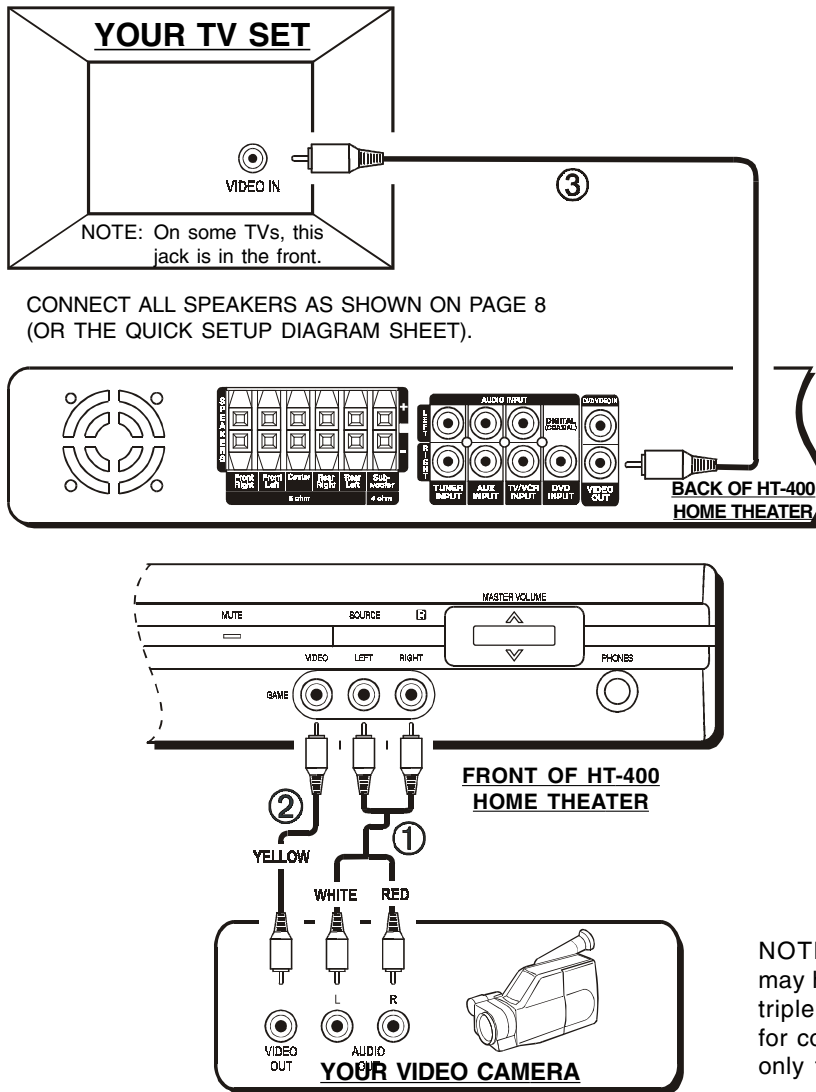

1. Insert the stereo audio cables into the AUDIO INPUT L (left=white) and R (right=red) jacks on the **FRONT** of your HOME THEATER SYSTEM, and into the corresponding AUDIO OUT jacks on your VIDEO CAMERA, this will allow your CAMERA VIDEO's sound to play through your HOME THEATER SYSTEM. (NOTE: Many video cameras have special plugs on one side to connect to your camera.)
2. Insert the video cable (included with your VIDEO CAMERA) into the VIDEO IN jack on the **FRONT** of your HOME THEATER SYSTEM, and into the VIDEO OUT jack on your VIDEO CAMERA. (NOTE: Your video camera may have a 3.5mm triple jack, consult your camera's booklet for details.)
3. Insert the video cable (included) into the VIDEO OUT jack on the back of your HOME THEATER SYSTEM, and into the VIDEO IN jack on your TV.

NOTE: Your VIDEO CAMERA's sound will come out of the 2 front speakers plus the subwoofer since the default setting for the sound output is the same as the audio source from the VIDEO CAMERA (2 channel, STEREO). For "Dolby Pro Logic" (5.1 channel) sound reproduction, press the SURROUND button. The sound will come out of all 5 speakers plus the subwoofer.

4. Insert the AC power cord into an AC outlet.
5. Press the POWER button on the main unit (not the REMOTE) to turn on the main power of the set. Next press the POWER button on the REMOTE to turn the set on (or off).
6. Press the SOURCE button several times till the GAME indicator lights. (This setting is either for a Video Camera or a TV Game.)
7. Make sure your VIDEO CAMERA is on and follow your VIDEO CAMERA's instructions.
8. Go to Page 20 for detailed instructions.

AUX IN CONNECTIONS

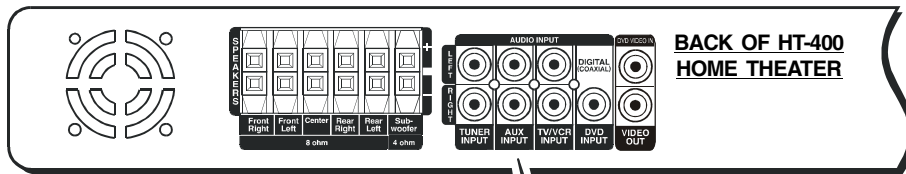

CONNECT ALL SPEAKERS AS SHOWN ON PAGE 8 (OR THE QUICK SETUP DIAGRAM SHEET).

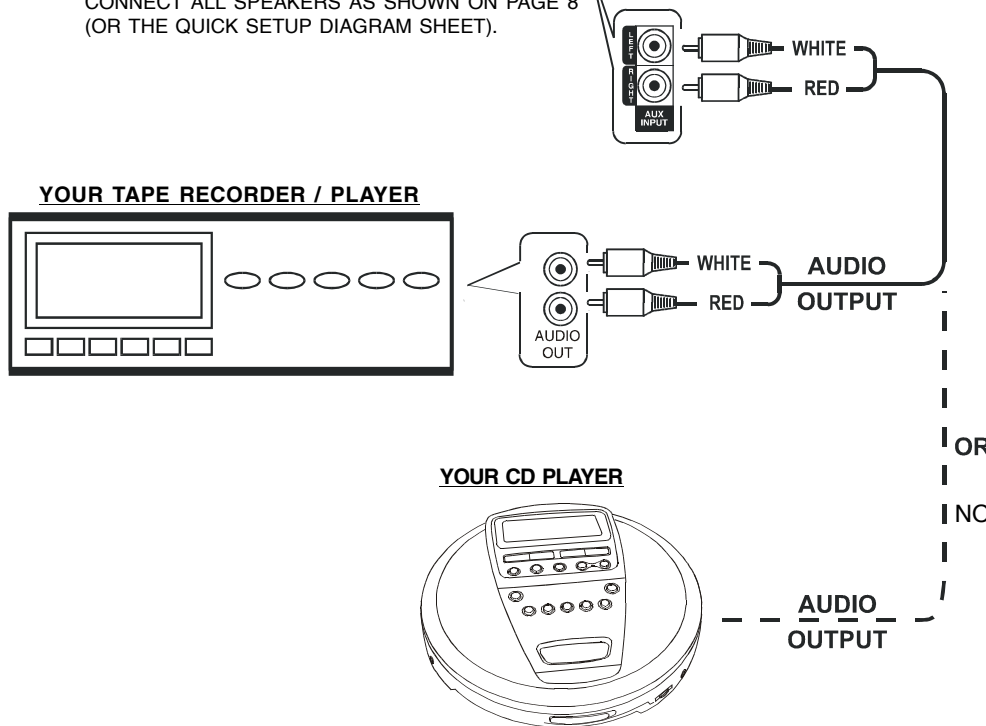

OR

NOTE: Cable requires 3.5mm stereo plug on one side of some sets.

- Illustration is showing some possible connections. You can only connect **ONE** of these components to the AUX INPUT jacks of your HOME THEATER SYSTEM (AUX stands for Auxiliary).
- You can hear the sound of any one of these devices through your HOME THEATER SYSTEM if you connect the proper cables.

1. Insert the audio cables into the AUX OUTPUT L (left=white) and R (right=red) jacks of your stereo system, such as a TAPE RECORDER/PLAYER, CD PLAYER into the corresponding AUX INPUT AUDIO jacks on your HOME THEATER. This will enable you to hear your components system through your HOME THEATER SYSTEM.

NOTE: Your audio device's sound will come out of the 2 front speakers plus the subwoofer since the default setting for the sound output is the same as the audio source from the device (2 channel, STEREO). For "Dolby Pro Logic" (5.1 channel) sound reproduction, press the SURROUND button. The sound will come out of all 5 speakers plus the subwoofer.

NOTE: If the signal of your device (such as a CABLE/SAT BOX or some STEREO TVs) is not a true STEREO signal, even though it has stereo output jacks, when you press the SURROUND button, the sound may not come out from all 5 speakers. This is normal.

2. Press the POWER button on the main unit (not the REMOTE) to turn on the main power of the set. Next press the POWER button on the REMOTE to turn the set on (or off).
3. Press the SOURCE button several times till the AUX indicator lights.
4. Make sure your AUX IN component is on and follow your component's instructions.
5. Go to Page 20 for detailed instructions.

AM / FM TUNER CONNECTIONS

CONNECT ALL SPEAKERS AS SHOWN ON PAGE 8
(OR THE QUICK SETUP DIAGRAM SHEET).

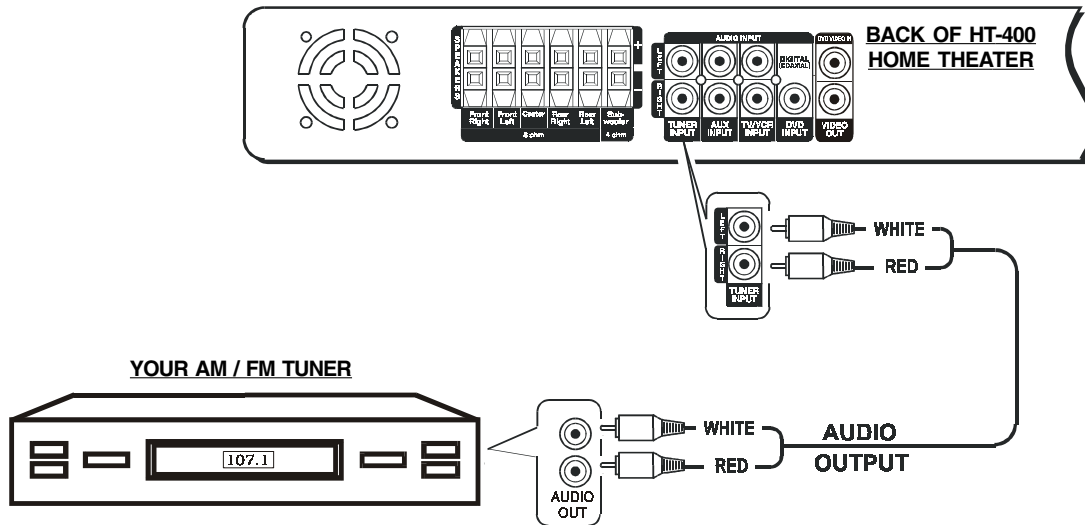

1. Insert the audio cables into the AUX OUTPUT **L** (left=white) and **R** (right=red) jacks on the back of your AM/FM TUNER, and into the corresponding TUNER INPUT AUDIO jacks on the back of your HOME THEATER. This will enable you to hear your stereo AM/FM TUNER through your HOME THEATER SYSTEM.

NOTE: Your AM/FM TUNER's sound will come out of the 2 front speakers plus the subwoofer since the default setting for the sound output is the same as the audio source from the AM/FM TUNER (2 channel, STEREO). For "Dolby Pro Logic" (5.1 channel) sound reproduction, press the SURROUND button. The sound will come out of all 5 speakers plus the subwoofer.

2. Press the POWER button on the main unit (not the REMOTE) to turn on the main power of the set. Next press the POWER button on the REMOTE to turn the set on (or off).
3. Press the SOURCE button several times till the TUNER indicator lights.
4. Make sure your AM/FM TUNER is on and follow your AM/FM TUNER's instructions.
5. Go to Page 20 for detailed instructions.

AMPLIFIER

General

- 1 Press the **POWER** button on the front panel of the main unit to turn the main power on, press **SOURCE** or **MASTER VOLUME** buttons on the main unit, or any button on the **REMOTE** control to turn the set on. Make sure the **STANDBY** indicator is lit in green.

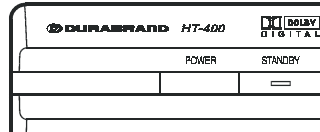

NOTE: The **STANDBY** indicator has 2 colors: red and green (green is on, red is standby). When the set is off (standby), pressing the **SOURCE** or **MASTER VOLUME** buttons on the main unit, or pressing **any** button on the **REMOTE CONTROL** will turn the set on. The indicator will become green. Also this indicator will flash confirming that you pressed any button on the **REMOTE CONTROL**.

- 2 Press the **SOURCE** button on the front panel of the main unit repeatedly to select one of the input sources, or press the individual **DVD**, **TUNER**, **GAME**, **TV/VCR** or **AUX** buttons on the **REMOTE** to select the audio input source directly, the corresponding indicator will light.

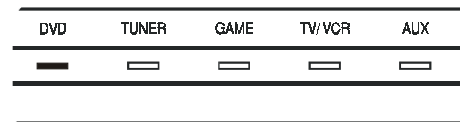

- 3 For volume adjustments, press each individual speaker's volume control buttons:

- ⊕ raises the volume
- ⊖ lowers the volume

Follow this step to adjust the other speakers as well. Or you may press the **MASTER VOLUME** buttons to raise or lower **all** speakers' volumes at the same time.



For details, see page 22.

- 4 To select the listening mode, press the **SURROUND** or **STEREO** button on the **REMOTE CONTROL**.

NOTE: This set will decode and automatically play back whatever sound system was recorded on the DVD or audio disc. For a Dolby Digital or a DTS (5.1 channel) recorded DVD disc, the **blue** **MULTI CHANNEL DECODING** indicator will be on and sound will come out of 5 speakers plus the subwoofer. For a Stereo DVD disc (2 channel) or other stereo audio source, the **red** **STEREO** indicator will be on, and the sound will only come out of the 2 front speakers plus the subwoofer. To manually change a stereo (2 channel) disc to Dolby Pro Logic, press the **SURROUND** button. The sound will come out of all 5 speakers plus the subwoofer.

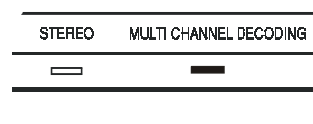

- 5 For different graphic equalizers (tone selections), press the **NORMAL**, **CLASSIC**, **JAZZ**, **ROCK**, **POP** or **DANCE** buttons on the **REMOTE** to select the tones (frequency response) you like best. This is the pre-set graphic equalizer.

- 6 To momentarily shut off the sound, press the **MUTE** button. The red **MUTE** indicator will light. Press the **MUTE** button again or press the **MASTER VOLUME** button to restore the sound.



AMPLIFIER

Test Tones

You can check whether your speakers are connected correctly by using the TEST TONE button.

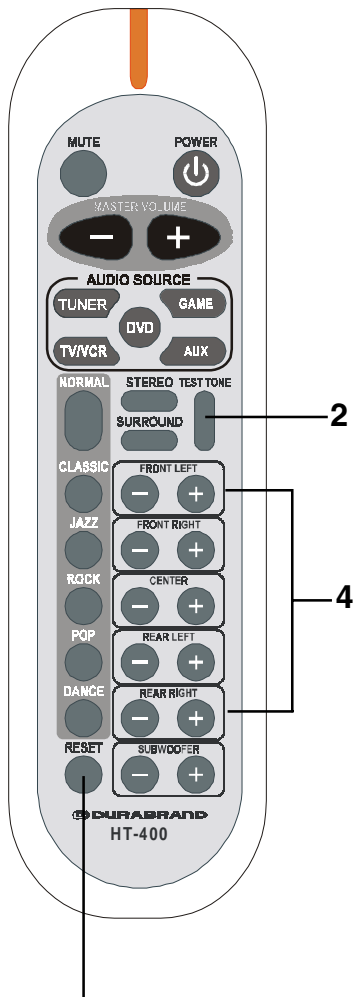

RESET BUTTON

Pressing this button on the remote control will reset all 5 satellite speakers and the subwoofer to their default setting and will also reset the preset graphic equalizer to the normal position.

- 1 Press the **POWER** button on the front panel of the main unit to turn the main power on, press SOURCE or MASTER VOLUME buttons on the main unit, or any button on the REMOTE control to turn the set on. Make sure the STANDBY indicator is lit in green.

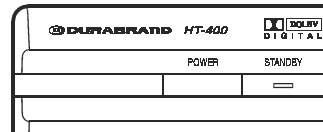

- 2 Press the **TEST TONE** button on the REMOTE.
- 3 You will hear a test tone (actually some blank noise similar to a steady ocean wave) from the FRONT LEFT (FL), CENTER (C), FRONT RIGHT (FR), REAR RIGHT (RR) and REAR LEFT (RL) speakers in sequence when the set is in MULTI CHANNEL DECODING mode (the blue MULTI CHANNEL DECODING indicator is on). The VOLUME indicators on the front panel will show the corresponding speaker which is being tested.

NOTE: If the set is in STEREO mode (the red STEREO indicator is ON), you will only hear a test tone from the FRONT LEFT (FL) and FRONT RIGHT (FR). To change the set from STEREO to MULTI CHANNEL DECODING mode, press the SURROUND button on the REMOTE.

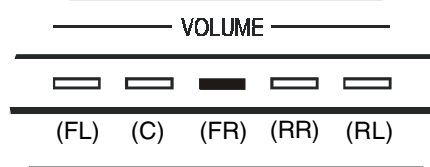

NOTE: The (FL), (C), (FR), (RR) & (RL) letters are not shown on the front panel of your set.

NOTE: You can stop the test tone by pressing any button on the REMOTE control, or press the SOURCE or MASTER VOLUME buttons on the main unit.

- 4 After your test, you may play the theater system or adjust the individual volume controls while playing any music or movie and then retest the levels if you like. You may then adjust each speaker's volume level by pressing the VOLUME controls of the individual speakers, so that from your center listening position, they all have approximately the same sound level. To restore all speaker levels to their defaults, press the RESET button.

AMPLIFIER

Volume Adjustment

1 To adjust the master volume

(Change all the speakers' volume settings at the same time), press the MASTER VOLUME buttons on the main unit or on the REMOTE to decrease or increase the master volume level.

⊕ raises the volume

⊖ lowers the volume

The VOLUME indicator on the front panel will show the corresponding volume level as progressively lit LED lamps:

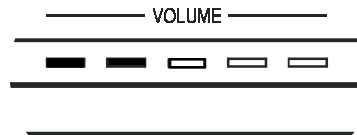

Factory's default setting for volume level



Minimum volume level



Maximum volume level

2 To adjust the individual speaker's volume:

Press the FRONT LEFT VOLUME CONTROL ⊕ or ⊖ button on the REMOTE to adjust the sound level of the FRONT LEFT SPEAKER.

Do the same to adjust the volume of the other individual speakers: FRONT RIGHT SPEAKER, CENTER SPEAKER, REAR LEFT SPEAKER, REAR RIGHT SPEAKER and SUBWOOFER SPEAKER.



The default volume control



Increased volume level



Decreased volume level

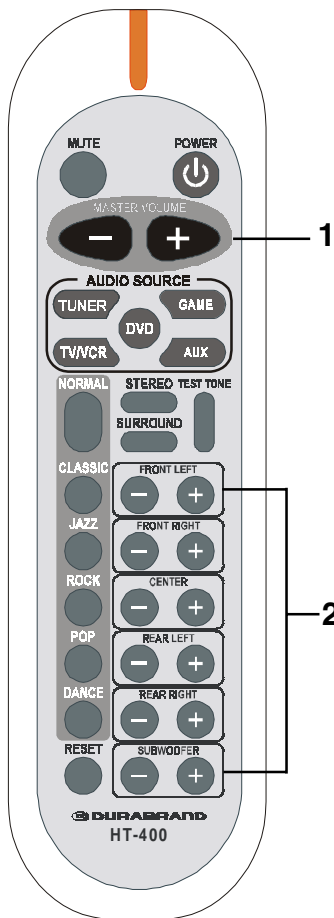

NOTE: Every time you turn the set on, the MASTER VOLUME will go back to the factory's default setting; and whenever you press the SOURCE button on the main unit or one of the source buttons on the REMOTE control (DVD, TUNER, GAME, TV/VCR or AUX), the MASTER VOLUME will go back to the factory's default setting. This avoids sudden very loud sounds from startling you.

LISTENING MODE

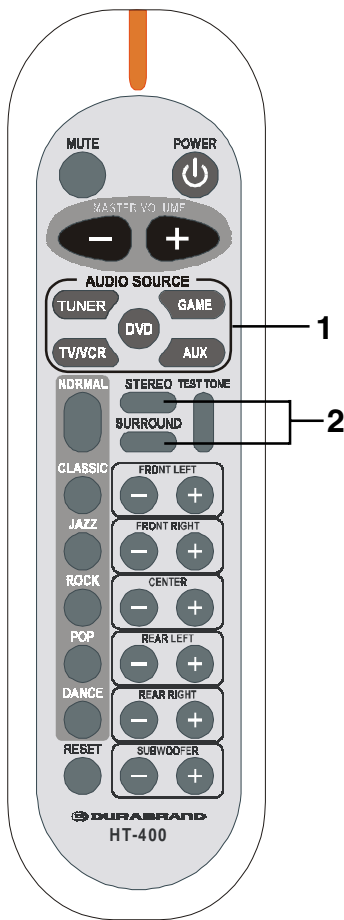

Dolby Digital (AC-3) Mode

Dolby Digital (also known as AC-3 or Dolby 5.1) surround sound system delivers a realistic and dynamic sound similar to the latest movie theaters. All five speakers and subwoofer must be connected for correct Dolby Digital Surround Sound reproduction. Each channel plays its own unique role in providing the proper sound. Front left, center and front right speakers join rear left and rear right to reproduce high, mid and bass frequencies in separate five full-range channels of surround sound. Bass rumble, explosions and low frequency effects you feel are heard through the subwoofer. Most DVD movie discs have been recorded in Dolby Digital surround sound mode. This set will automatically select the correct Dolby mode according to source provided.

- 1 Press the **SOURCE** button on the front panel of the main unit repeatedly to select one of the input source, or press the **DVD**, **TUNER**, **GAME**, **TV/VCR** or **AUX** button on the REMOTE to select your required audio input source directly. The corresponding indicator will light.

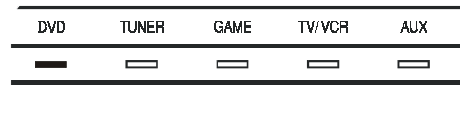

NOTE: This set will decode and automatically play back whatever sound system was recorded on the DVD or audio disc. For a Dolby Digital or a DTS (5.1 channel) recorded DVD disc, the **blue** MULTI CHANNEL DECODING indicator will be on and sound will come out of 5 speakers plus the subwoofer. For a Stereo DVD disc (2 channel) or other stereo audio source, the **red** STEREO indicator will be on, and the sound will only come out of the 2 front speakers plus the subwoofer. To manually change a stereo (2 channel) disc to Dolby Pro Logic, press the SURROUND button. The sound will come out of all 5 speakers plus the subwoofer.

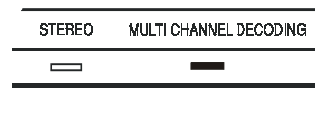

Listening with Stereo Headphones (not included)

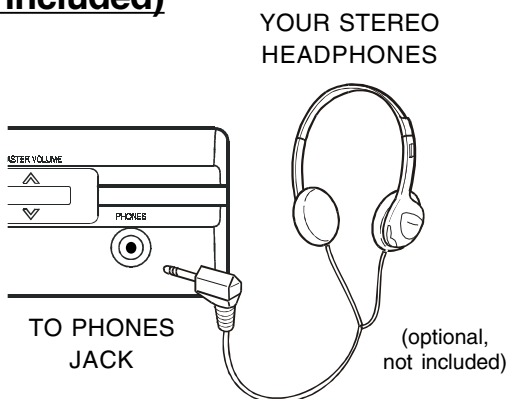

- 2 Press the **SURROUND** button on the REMOTE control to select 5.1 channel sound format. Press the STEREO button to select the stereo mode.

NOTE: If the input signal is Dolby Digital sound format, then two listening modes can be selected: Dolby Digital or STEREO. Try each to see what you prefer. Some programs may sound better in the STEREO mode.

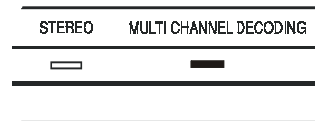

- A. If a Dolby Digital sound input signal is received, the MULTI CHANNEL DECODING indicator will be on. Sound will come out of all 6 speakers.

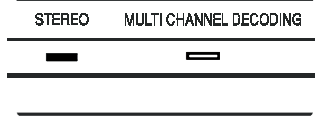

- B. If a stereo sound signal is received from TUNER or AUX, etc., the STEREO indicator will be on. Sound will come out of 2 front speakers plus the SUBWOOFER.

When you are playing your set in MULTI CHANNEL DECODING mode, if you plug your stereo headphones into the phones jack, the set will turn to STEREO mode automatically (the STEREO indicator on the front panel will light), and you can hear the 2 channel stereo sound coming out of your stereo headphones, no sound will be heard from the 6 speakers (there may be a 2 second delay for the circuits to detect and change to headphone use).

LISTENING MODE

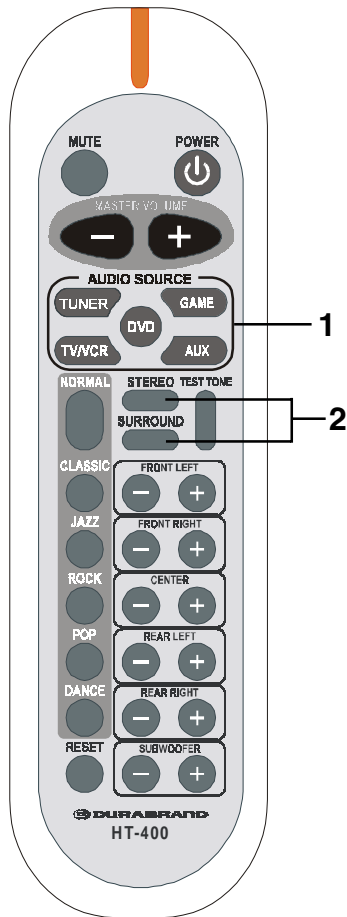

Dolby Pro Logic and Stereo Modes

The Dolby Pro Logic surround system is a specially encoded two-channel analog format that will produce sound through four speaker channels (front left, center, front right, mono surround). This is also compatible with stereo systems, but the user will only have two-channel (front left & right) sound. Most currently released DVDs, video cassettes and audio compact discs and many TV broadcasts are encoded with Dolby Pro Logic. Audio discs and tuner broadcasts are in Stereo. This set will automatically select Dolby Digital or Dolby Pro Logic for you according to the source provided.

- 1 Press the **SOURCE** button on the front panel of the main unit repeatedly to select one of the audio input sources, or press the **DVD**, **TUNER**, **GAME**, **TV/VCR** or **AUX** button on the REMOTE to select directly your required audio input source. The corresponding indicator will light.



NOTE: This set will decode and automatically play back whatever sound system was recorded on the DVD or audio disc. For a Dolby Digital or a DTS (5.1 channel) recorded DVD disc, the **blue** MULTI CHANNEL DECODING indicator will be on and sound will come out of 5 speakers plus the subwoofer. For a Stereo DVD disc (2 channel) or other stereo audio source, the **red** STEREO indicator will be on, and the sound will only come out of the 2 front speakers plus the subwoofer. To manually change a stereo (2 channel) disc to Dolby Pro Logic, press the SURROUND button. The sound will come out of all 5 speakers plus the subwoofer.

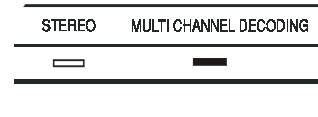

- 2 Press the **SURROUND** button on the REMOTE control to select Dolby Pro Logic format (or automatic decoding). Press the STEREO button to select the stereo mode.

NOTE: If the input signal is Dolby Pro Logic format, then two listening modes can be selected: Dolby Digital or STEREO.

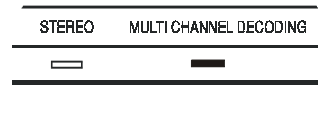

A. If a Dolby Digital sound input signal is received, the MULTI CHANNEL DECODING indicator will be on. Sound will come out of all 6 speakers.

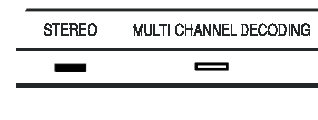

B. If a stereo sound signal is received from TUNER or AUX, etc., the STEREO indicator will be on. Sound will come out of 2 front speakers plus the SUBWOOFER.

TROUBLE SHOOTING

Symptom	Remedy
No power	<ol style="list-style-type: none"> 1. Is the power cord firmly plugged into the power outlet? Insert the AC power plug securely into the power outlet. Make sure your outlet has power, you can check this by plugging a lamp into the outlet to see if works. 2. One of the safety mechanisms may be operating. In this event, unplug the player from the power outlet briefly and then plug it in again to reset the set.
Your DVD player has no picture	Make sure your DVD's video cable is plugged into your TV set. This Home Theater only improves the sound of your DVD player, it does not affect the video at all.
<ul style="list-style-type: none"> • No sound or only a very low-level sound is heard. • Distorted sound. 	<ol style="list-style-type: none"> 1. Check that the speakers and components are connected securely and correctly (see Page 8, 9). Also check speaker volume (see Page 22). 2. Make sure your source (DVD or other) is plugged in and operating. Also check that component's booklet, maybe you need adjust that component. 3. Make sure that you have selected the correct source on the system (DVD or other). 4. Ensure that the input settings for the TV and stereo system are correct. 5. Adjust the master volume settings on the HOME THEATER's remote. 6. Ensure the MUTE button is <u>not</u> pressed on the HOME THEATER remote (If yes, press the MUTE button again, the MUTE indicator will go off). 7. The audio or speaker connecting wires are damaged. Replace them with new ones.
The REMOTE CONTROL unit does not work.	<ol style="list-style-type: none"> 1. Check if the batteries are installed with the correct polarities (\oplus and \ominus). 2. If the batteries are weak or dead, replace them with new ones (size "AAA"). 3. Point the remote control unit at a distance of less than 20 feet from the main unit of the HOME THEATER system. 4. Remove any obstacles between the remote control unit and remote control sensor. 5. If the battery terminals are dirty or corroded, clean them with sandpaper.
No buttons operate (on the main unit and / or the REMOTE CONTROL unit).	Press the POWER button on the MAIN UNIT to turn the set ON. Then press the POWER button on the REMOTE. The HOME THEATER may not be operating properly due to lightning, static electricity, or some other external factors. Reset the player by disconnecting the power plug and then re-connecting it before calling customer service.
Humming noise is heard even if the set stopped.	This is a normal sound the cooling fan inside makes. This will stop if the power is off. Press the POWER button on the REMOTE to put the set in STANDBY mode.
The left and right sounds are unbalanced or reversed.	<ol style="list-style-type: none"> 1. Check that the speakers and components are connected correctly and securely. 2. Adjust front balance by pressing the volume controls of the left and right speakers on the REMOTE (see Page 22).
Loud hum or noise is heard.	<ol style="list-style-type: none"> 1. Check that the speakers and components are connected securely. 2. Insert all wires firmly, follow the setup pages starting on Page 7.
The surround effect is difficult to hear when playing a Dolby Digital sound track.	Depending on the digital sound input, the output signal may at times be monaural or stereo even if the main sound track is recorded in Dolby Digital format.
The sound comes from the 2 front speakers and subwoofer only.	The input audio signal is stereo. This set will decode and automatically play back sound in the format that was originally input. This is normal.
During DVD play, the STEREO indicator is on.	If your DVD disc was recorded with PCM, this is normal. Press the SURROUND button.
No sound is heard from the center speaker.	<ol style="list-style-type: none"> 1. Make sure the Center speaker's volume is set to a normal level (see Page 22). 2. Adjust the center speaker volume by pressing the volume control buttons of the center speaker on the REMOTE (see Page 22). 3. If you are listening to a stereo broadcast, only 2 front speakers (plus the subwoofer) will have sound.
No sound or only a very low-level sound is heard from the rear speakers.	<ol style="list-style-type: none"> 1. Make sure the volume control of the rear speakers are set to normal levels (see Page 22). 2. Adjust the rear speakers' volume by pressing the VOLUME control buttons on the REMOTE.
The system does not operate properly.	Double check if input & output jacks were inserted properly. Also ask a friend to help you before calling customer service.
Slight delay when switching from DVD to TUNER input.	This is normal, as the set tries to detect stereo or 5.1 channel signals.

SPECIFICATIONS

General

Power requirements ----- AC 120V, 60Hz
Power consumption -----100W
Main Unit Dimensions ---17 x 11 x 1 7/8 inches / 43.0 X 28.0 X 4.8 cm
Weight ----- 12.7 lbs / 5.76 kg

Audio Power Outputs

Total output power: 200 Watts at Maximum

Distortion

0.06% @ reference output

Audio Line Outputs

Audio L/R: 1 Vrms, 1 kilohms

Remote Operating Range

Within 20 feet between the main unit and the remote.

Speakers

Subwoofer -----Dimensions: 12 x 7 7/8 x 13 inches / 307 X 199 X 329 mm
Weight: 10 lbs / 4.6 kg
Front Left ----- Dimensions: 4 x 3 5/8 x 5 1/2 inches / 100 X 93 X 140 mm
Weight: 1 lb / 0.47 kg
Center -----Dimensions: 4 x 6 5/8 x 3 3/4 inches / 100 X 170 X 95 mm
Weight: 1.1 lb / 0.5 kg
Front Right ----- Dimensions: 4 x 3 5/8 x 5 1/2 inches / 100 X 93 X 140 mm
Weight: 1 lb / 0.47 kg
Rear Left ----- Dimensions: 4 x 3 5/8 x 5 1/2 inches / 100 X 93 X 140 mm
Weight: 0.88 lb / 0.4 kg
Rear Right ----- Dimensions: 4 x 3 5/8 x 5 1/2 inches / 100 X 93 X 140 mm
Weight: 0.88 lb / 0.4 kg

LENOXX reserves the right to make design and specification changes for product improvement.

PROTECT YOUR FINE FURNITURE!

WE RECOMMEND A CLOTH OR OTHER PROTECTIVE MATERIAL BE PLACED UNDER THE SET WHEN PLACING IT ON A SURFACE WITH A NATURAL OR LACQUER FINISH.

For customer service of this Durabrand product

Visit Our Website: <http://www.lenoxx.com>

or Dial 1-800-315-5885 (MONDAY-THURSDAY 9:00 AM - 5:00 PM, FRIDAY 9:00 AM - 1:00 PM EST)

or Write to:

LENOXX ELECTRONICS CORP.
2 GERMAK DRIVE
CARTERET, N.J. 07008

© 2002 LENOXX ELECTRONICS CORP.
MADE & PRINTED IN CHINA

Free Manuals Download Website

<http://myh66.com>

<http://usermanuals.us>

<http://www.somanuals.com>

<http://www.4manuals.cc>

<http://www.manual-lib.com>

<http://www.404manual.com>

<http://www.luxmanual.com>

<http://aubethermostatmanual.com>

Golf course search by state

<http://golfingnear.com>

Email search by domain

<http://emailbydomain.com>

Auto manuals search

<http://auto.somanuals.com>

TV manuals search

<http://tv.somanuals.com>