

In the unlikely event that ink gets on your fingers, it can easily be removed by moistening a paper towel with a solution of laundry bleach diluted with an equal amount of water. Be sure to wash hands thoroughly after using bleach solution.

## Inkjet Products Limited Warranty

for U.S.A. and Canada

Repeat-O-Type Manufacturing Corporation warrants its refill ink products against defects in materials and workmanship for one year from date of purchase. In the unlikely event that a Repeat-O-Type refill ink product does not perform satisfactorily when used as directed, Repeat-O-Type will replace it at no charge. If a cartridge is refilled and will not produce acceptable prints, the ink cartridge may be worn out or damaged. Repeat-O-Type makes no warranty on the life of an ink cartridge of which it is not the manufacturer.

Furthermore, Repeat-O-Type guarantees that when used as directed, our ink will not damage your printer. If the use of Repeat-O-Type ink is cited as the cause of damage to a printer, you should request a written statement from the service company specifying exactly how Repeat-O-Type's ink was responsible for the damage. This statement must be on the service company's letterhead, dated and signed by the company's representative. Before authorizing repair, forward the statement to Repeat-O-Type along with the following: 1) Written estimate of cost to repair damage caused by use of Repeat-O-Type ink, 2) Store receipt showing purchase of Repeat-O-Type ink, and 3) Ink cartridge in which Repeat-O-Type ink was used. After verification, Repeat-O-Type will either agree to pay reasonable service or repair charges or will authorize shipment of printer to a repair facility of Repeat-O-Type's choice for repair at no charge.

This warranty gives you specific legal rights and you may have other rights which vary from state to state.

**THIS WARRANTY SHALL BE IN LIEU OF ALL OTHER WARRANTIES; EXPRESSED, IMPLIED, OR STATUTORY, INCLUDING WARRANTIES OF MERCHANTABILITY ARISING OUT OF THE USE OF, OR AN INABILITY TO USE THE PRODUCT.**

**REPEAT-O-TYPE**  
MANUFACTURING CORPORATION  
ESTABLISHED 1931

# INSTRUCTIONS FOR REFILLING LEXMARK COLOR CARTRIDGES

Also for some Compaq,  
Xerox and Sharp

**IMPORTANT!** You will have much better success in refilling if you add ink as soon as a color is depleted. It is difficult to unclog a dried-out cartridge.

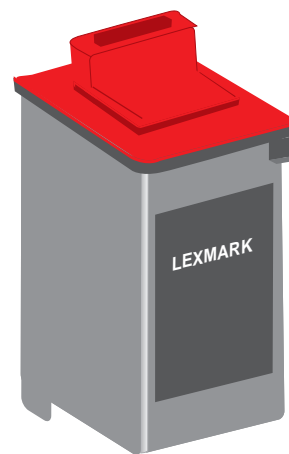

All Lexmark  
Color Cartridges  
Except 10N0026  
See Page 1

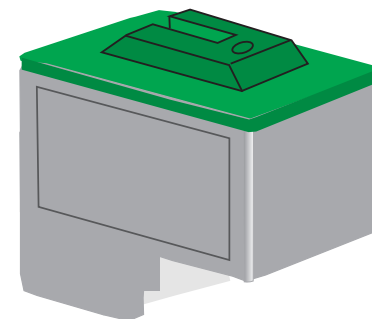

Lexmark 10N0026 ONLY  
See Page 2

IF YOU HAVE ANY QUESTIONS OR ENCOUNTER ANY DIFFICULTY  
IN USING THIS PRODUCT, PLEASE CONTACT:

**REPEAT-O-TYPE**  
MANUFACTURING CORPORATION  
ESTABLISHED 1931

665 State Highway 23 • Wayne, NJ 07470-6892 U.S.A. • (973) 696-3330 • (800) 288-3330  
Fax: (973) 694-7287 • Email: help@repeatotype.com • www.repeatotype.com

Lexmark is a registered trademark of Lexmark International.  
Scotch Tape is a registered trademark of 3M Corp. Compaq is a trademark of Compaq Computer Co.  
Xerox is a trademark of Xerox Corp. Sharp is a trademark of Sharp Electronics Corp.

©2002 Repeat-O-Type Manufacturing Corporation.

LX80RC 5/02

# Refilling Instructions —All except 10N0026

for Lexmark 12A1980/12A1985/15M0120/15M0125/17G0060/16G0065;  
Compaq 337710-001; Xerox 8R7880/8R7882/8R12591  
and Sharp AJ-C50C Tri-Color Cartridges

**CONTAINS SHARP BLADE  
KEEP KIT AND TOOL  
OUT OF REACH OF  
CHILDREN**

## CONTENTS:

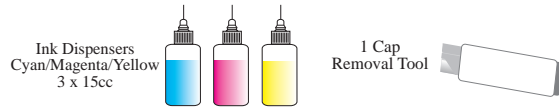

### 1. Protect work surface.

Refilling your cartridge is a clean and simple job, but it is best to cover your work area with newspaper or other scrap paper to protect from accidental ink spills.

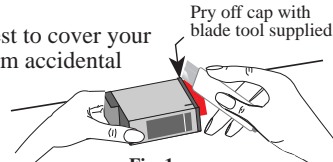

Fig. 1

### 2. Remove depleted color print cartridge from printer according to printer manufacturer's instructions.

### 3. Lay cartridge on its side. CAREFULLY using the razor knife provided in the kit, work the blade into the joint between the green cap and black cartridge body on all four sides to pry off cap. See Fig. 1.

### 4. Remove the scabbard from the refill dispenser of the color you wish to refill. Insert the filler tube into the corresponding color compartment through either of the two fill holes. Determine appropriate color chamber by following figure 2. Push the filler tube into the absorbent material as far as it will go. Then draw it back out about 1/4" (6.5mm). See Fig. 2

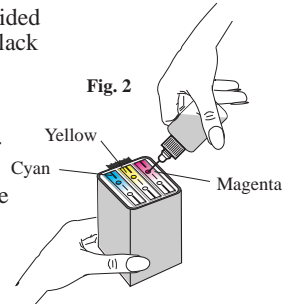

Fig. 2

### 5. Tilt the bottle until the filler tube is in the fully inverted position Fig. 3. Squeeze the bottle with moderate pressure and keep pressure applied until you see ink appear at the top of the color compartment. Immediately stop squeezing the bottle. Draw filler tube most of the way out then release pressure on bottle and allow the refill bottle to suck back any excess ink.

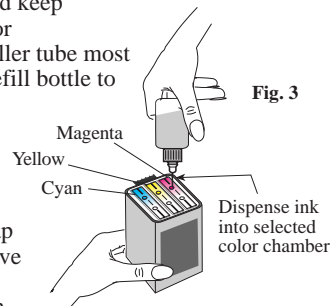

Fig. 3

### 6. Bring the bottle back to the position shown in Fig. 2 (filler tube in horizontal position) and remove the filler tube. Recap the ink bottle and save for future refills. Replace the cap on the print cartridge and tape into place with pressure sensitive Scotch Tape™. See Fig. 4. Inspect the print head and wipe off any excess ink immediately to prevent possible contamination of print nozzles.

### 7. Reinstall the cartridge into the printer.

If asked "Installing a new cartridge" or "Reinstalling a used cartridge," choose "Installing a new cartridge." This will reset the ink level monitor to read "Full." Run a priming/cleaning cycle and print test following the instructions included with your printer. It may be necessary to repeat the print test several times to bring the color balance back to normal.

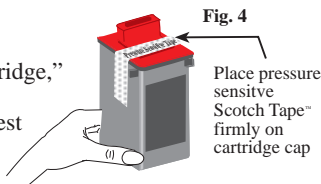

Fig. 4

# Refilling Instructions —ONLY 10N0026

for Lexmark 10N0026 Tri-Color Cartridge ONLY

**CONTAINS SHARP BLADE  
KEEP KIT AND TOOL  
OUT OF REACH OF  
CHILDREN**

## CONTENTS:

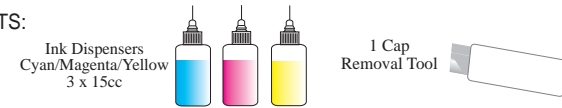

### 1. Protect work surface.

Refilling your cartridge is a clean and simple job, but it is best to cover your work area with newspaper or other scrap paper to protect from accidental ink spills.

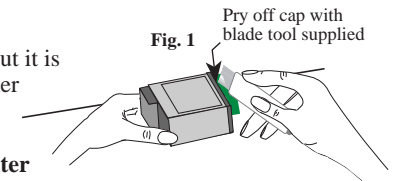

Fig. 1

### 2. Remove depleted color print cartridge from printer according to printer manufacturer's instructions.

### 3. Lay cartridge on its side. CAREFULLY using the razor knife provided in the kit, work the blade into the joint between the green cap and black cartridge body on all four sides to pry off cap. See Fig. 1.

### 4. Remove the scabbard from the refill dispenser of the color you wish to refill. Insert the filler tube into the corresponding color compartment through either of the two fill holes. Determine appropriate color chamber by following figure 2. Push the filler tube into the absorbent material as far as it will go. Then draw it back out about 1/4" (6.5mm). See Fig. 2

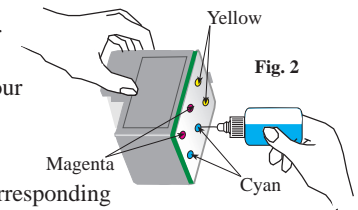

Fig. 2

### 5. Tilt the bottle until the filler tube is in the fully inverted position Fig. 3. Squeeze the bottle with moderate pressure and keep pressure applied until you see ink appear at the top of the color compartment. Immediately stop squeezing the bottle. Draw filler tube most of the way out then release pressure on bottle and allow the refill bottle to suck back any excess ink.

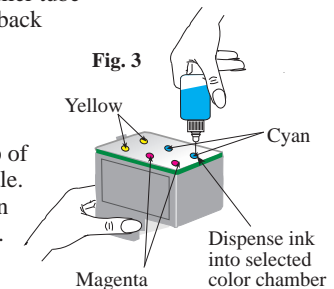

Fig. 3

### 6. Bring the bottle back to the position shown in Fig. 2 (filler tube in horizontal position) and remove the filler tube. Recap the ink bottle and save for future refills. Replace the cap on the print cartridge and tape into place with pressure sensitive Scotch Tape™ see Fig. 4. Inspect the print head and wipe off any excess ink immediately to prevent possible contamination of print nozzles.

### 7. Reinstall the cartridge into the printer.

If asked "Installing a new cartridge" or "Reinstalling a used cartridge," choose "Installing a new cartridge." This will reset the ink level monitor to read "Full." Run a priming/cleaning cycle and print test following the instructions included with your printer. It may be necessary to repeat the print test several times to bring the color balance back to normal.

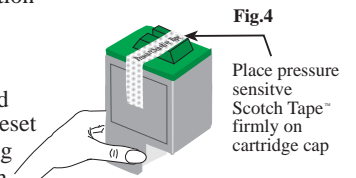

Fig. 4

## Free Manuals Download Website

<http://myh66.com>

<http://usermanuals.us>

<http://www.somanuals.com>

<http://www.4manuals.cc>

<http://www.manual-lib.com>

<http://www.404manual.com>

<http://www.luxmanual.com>

<http://aubethermostatmanual.com>

Golf course search by state

<http://golfingnear.com>

Email search by domain

<http://emailbydomain.com>

Auto manuals search

<http://auto.somanuals.com>

TV manuals search

<http://tv.somanuals.com>