

# Refilling Instructions

for Lexmark 18L0042 "83" Tri-Color Cartridge ONLY

CONTENTS:



## 1. Protect work surface.

Refilling your cartridge is a clean and simple job, but it is best to cover your work area with newspaper or other scrap paper to protect from accidental ink spills.

## 2. Remove depleted color print cartridge from printer according to printer manufacturer's instructions.

3. Lay cartridge on its side. Using the cap removal tool provided in the kit, pry the blue cap off the cartridge body. See Fig. 1.

4. Remove the scabbard from the refill dispenser of the color you wish to refill. Insert the filler tube into the corresponding color compartment through either of the two fill holes. Determine appropriate color chamber by following figure 2. Push the filler tube into the absorbent material as far as it will go. Then draw it back out about 1/4" (6.5mm). See Fig. 2

5. Tilt the bottle until the filler tube is in the fully inverted position Fig. 3. Squeeze the bottle with moderate pressure and keep pressure applied until you see ink appear at the top of the color compartment. Immediately stop squeezing the bottle. Draw filler tube most of the way out then release pressure on bottle and allow the refill bottle to suck back any excess ink.

6. Bring the bottle back to the position shown in Fig. 2 (filler tube in horizontal position) and remove the filler tube. Recap the ink bottle and save for future refills. Replace the cap on the print cartridge. Inspect the print head and wipe off any excess ink immediately to prevent possible contamination of print nozzles.

## 7. Reinstall the cartridge into the printer.

If asked "Installing a new cartridge" or "Reinstalling a used cartridge," choose "Installing a new cartridge." This will reset the ink level monitor to read "Full." Run a priming/cleaning cycle and print test following the instructions included with your printer. It may be necessary to repeat the print test several times to bring the color balance back to normal.

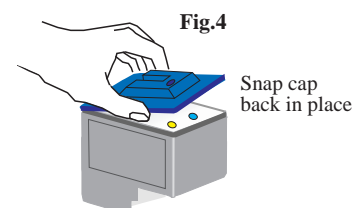
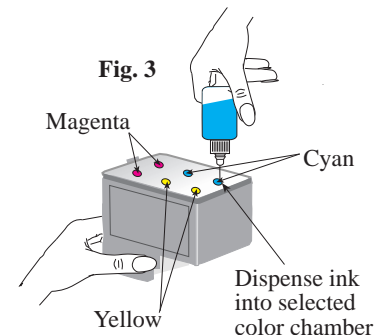
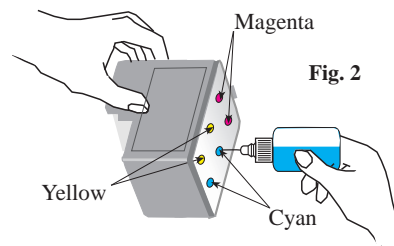
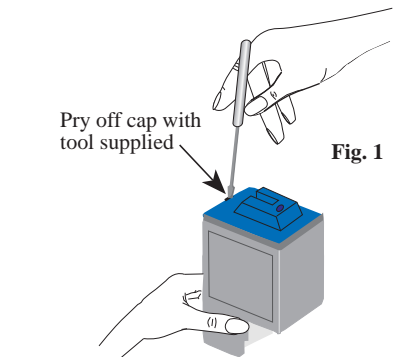

IF YOU HAVE ANY QUESTIONS OR ENCOUNTER ANY DIFFICULTY IN USING THIS PRODUCT, PLEASE CONTACT:

**REPEAT-O-TYPE**  
MANUFACTURING CORPORATION  
ESTABLISHED 1931

665 State Highway 23 • Wayne, NJ 07470-6892 U.S.A. • (973) 696-3330 • (800) 288-3330  
Fax: (973) 694-7287 • Email: help@repeatotype.com • www.repeatotype.com

Lexmark is a registered trademark of Lexmark International. Compaq is a trademark of Compaq Computer Co. Xerox is a trademark of Xerox Corp.  
Sharp is a trademark of Sharp Electronics Corp. ©2003 Repeat-O-Type Manufacturing Corporation.

LX83RC 5/03

## Free Manuals Download Website

<http://myh66.com>

<http://usermanuals.us>

<http://www.somanuals.com>

<http://www.4manuals.cc>

<http://www.manual-lib.com>

<http://www.404manual.com>

<http://www.luxmanual.com>

<http://aubethermostatmanual.com>

Golf course search by state

<http://golfingnear.com>

Email search by domain

<http://emailbydomain.com>

Auto manuals search

<http://auto.somanuals.com>

TV manuals search

<http://tv.somanuals.com>