

In response to the increasing desire for improved health, personal balance and overall well-being, we developed the LifeWise brand of personal and home health products. This comprehensive suite of technologically advanced and easy-to-use products offers a variety of smart ideas designed to help keep you, your family and your home happier, healthier and more at ease.

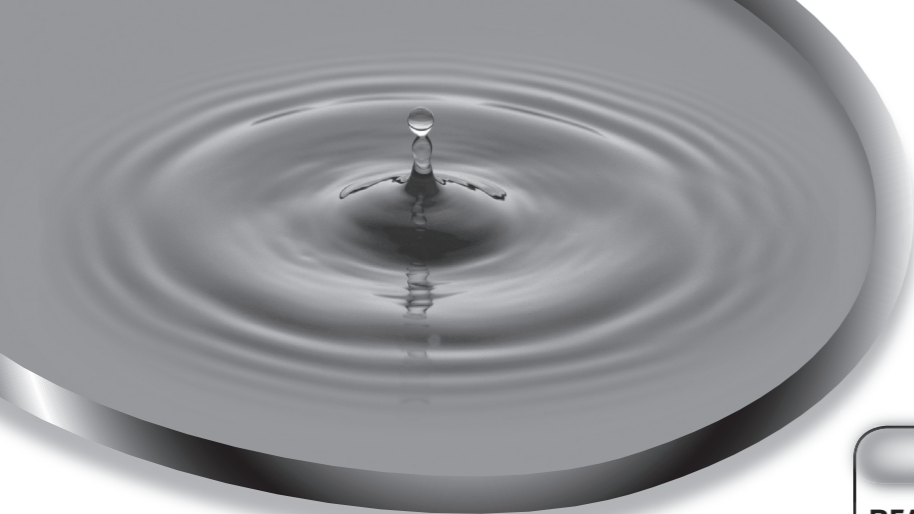

IFD™ Air Purifiers

63-1533, 63-1532, 63-1530

Thank you for purchasing the LifeWise Air Purifier, with breakthrough IFD™ air purification technology. Please read below on how to operate and care for your new air purifier.



63-1532

63-1533

63-1530

what's included

Air Purifier

User's Guide

NOTE: Actual product may vary from images found in this document.

important safety instructions

READ AND SAVE THESE SAFETY INSTRUCTIONS BEFORE USING THIS AIR PURIFIER

When using electrical appliances, basic precautions should always be followed to reduce the risk of fire, electric shock, and injury to persons, including the following:

1. Read all instructions before operating the air purifier.
2. Place the air purifier where it is not easily knocked over by persons in the household.
3. Always turn the air purifier to the **OFF** position and unplug from the wall outlet when not in use.
4. To disconnect the model 63-1533 air purifier, first turn the control to the OFF position, grip the plug and pull it from the wall outlet. To disconnect the model 63-1532 and 63-1530 air purifiers, press the power button to turn the unit off, grip the plug and pull it from the wall outlet. Never pull by the cord.
5. Do not use any product with a damaged cord or plug or if product malfunctions, is dropped or damaged in any manner. Keep the cord away from heated surfaces.
6. Do not use the air purifier outdoors.
7. Never use the air purifier unless it is fully assembled.
8. Do not run the power cord under carpets, and do not cover with throw rugs. Arrange the cord such that it will not be tripped over.
9. Do not use the air purifier where combustible gases or vapors are present.
10. Do not expose the air purifier to rain, or use near water, in a bathroom, laundry area or other damp location.
11. The air purifier must be used in its upright position.
12. Do not allow foreign objects to enter ventilation or exhaust opening as this may cause electric shock or damage to the air purifier. Do not block air outlets or intakes.
13. Locate the air purifier near the outlet and avoid using an extension cord.
14. This appliance has a polarized plug (one blade is wider than the other). To reduce the risk of shock, this plug is intended to fit only one way in a polarized outlet. If the plug does not fit fully in the outlet, reverse the plug. If it still does not fit, contact a qualified electrician. **DO NOT** attempt to defeat this safety feature.
15. A loose fit between the AC outlet (receptacle) and plug may cause overheating and a distortion of the plug. Contact a qualified electrician to replace loose or worn outlet.
16. Do not sit, stand or place heavy objects on the air purifier.
17. Disconnect power supply before servicing.

WARNING: To Reduce The Risk of Fire or Electric Shock, Do Not Use This Air Purifier With Any Solid-State Speed Control Device.

For model 63-1530 Ultra with UV Lights:

The sealed UV bulbs contain a small amount of mercury. Dispose of these items at household hazardous waste collection sites only. If the UV bulb breaks, do not vacuum or handle with your bare hands.

set-up

1. Select a firm, level and flat location. For proper air flow, locate the unit at least 3 feet (1 M) from any wall or furniture.
2. Ensure the exit grille faces away from the closest wall or furniture.
3. Ensure no grilles are blocked.
4. Plug into a grounded 120V outlet. See **IMPORTANT SAFETY INSTRUCTIONS**.

operation

63-1532 operation

1. Press the power (⏻) button once. The unit will automatically start at medium power.
2. Select a power level by pressing one of three power level buttons: High (⏻) Medium (⏻) or Low (⏻). The indicator light above the selected button will illuminate.
3. Press the power button again to turn off the air purifier.

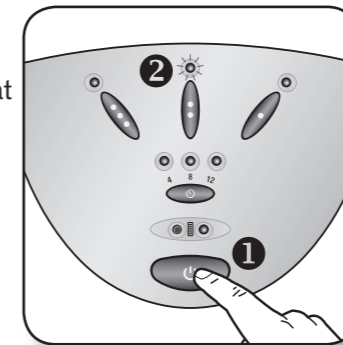

63-1532 timer operation

1. Press the timer (⌚) button to select 4, 8 or 12-hour operation. The timer indicators will illuminate to reflect the selected time. The air purifier will automatically turn off when time runs out.
2. The timer can be turned off by repeatedly pressing the timer button until all of the timer indicator lights go out.

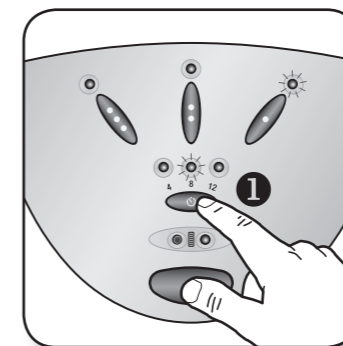

NOTE Removing the IFD™ filter assembly or turning the unit off will cancel the timer function.

63-1530 operation

1. Press the power (⏻) button to turn the air purifier on.
2. The LCD screen will display Medium (⏻).
3. To change speeds, press the ⏻+ (speed plus) and ⏻- (speed minus) buttons to select Low (⏻), Medium (⏻) and High (⏻). The display will indicate the current setting.
4. For Super air purifier cleaning, set the unit to operate at High speed. For quieter settings, or during sleep, set the unit to Medium or Low.
5. To turn the unit off, press the power button until the LCD screen is blank.

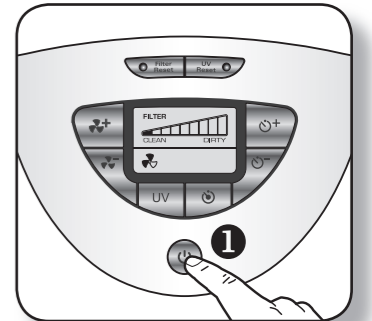

63-1530 timer operation

1. Touch the timer (⌚) button - the LCD screen flashes the number 8.
2. Press the timer plus (⌚+) or timer minus (⌚-) button to increase or decrease the desired number of hours (1 to 18). The selected number will flash for a few seconds. Once it stops flashing, the air purifier is in Timer Mode. (Example: If you want the unit to turn off in 6 hours, touch the ⌚ button. Then, press the ⌚+ or ⌚- button until the number "6" is displayed.)
3. To turn the Timer mode off, press the timer button twice. The LCD Timer portion will be blank.

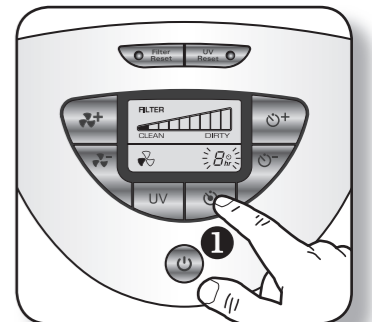

NOTE Removing the IFD filter assembly or turning the unit off will cancel the timer function.

63-1533 operation

Ensure the unit is in the OFF (O) position and then plug into a working outlet.

1. Rotate the control knob to the desired speed level: High (⏻), or Low (⏻).
2. The Indicator Light will illuminate when the power is on.
3. Turn the control knob to the Off (O) position to turn off the air purifier.



Take the LifeWise Heart Truth Pledge and begin making one change a month to improve the health of you and your family.
www.hearttruthpledge.com

dual UV lamp operation

dual UV lamp operation (63-1530 only)

1. Press the UV button to turn the Lamps on or off.
2. The Lamps will light and you will see a faint blue glow along the front of the unit above the grille. "UV" will be displayed in the LCD screen.

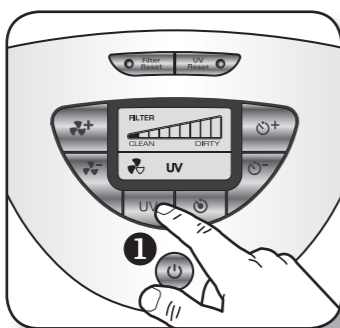

NOTE Removing the IFD filter assembly or turning the unit off will cancel the UV Lamp function.

filter clean indicator operation

63-1532 filter clean reminder operation

1. When the filter clean LED illuminates, it is time to inspect/clean the IFD filter (see "removing/cleaning the IFD™ filter").
2. Once you have cleaned the filter, press the filter reset button until the LED light goes out.

63-1530 filter clean reminder operation

1. As you operate your air purifier, the filter bar within the LCD control panel will slowly fill up with additional bars leading from CLEAN to DIRTY.
2. Once all of the bars are filled in and indicate DIRTY, the LED will illuminate above the control panel. You should inspect/clean the filter (see "removing/cleaning the IFD™ filter").
3. Once you have inspected/cleaned the filter, press the filter reset button until the bars decrease to indicate CLEAN. The LED light will now go out.

removing/cleaning the IFD™ filter

to remove the IFD™ filter

1. Turn off and unplug the air purifier.
2. Push the Filter Release (IFD) button and then gently lift the filter assembly. The filter assembly will only release if the button is pushed.
3. Remove the pre-filter (see "cleaning the pre-filter"), and set aside.

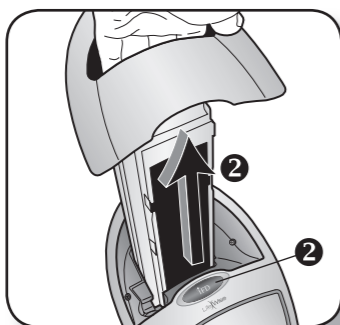

to clean the IFD™ filter

1. DO NOT USE WATER OR OTHER LIQUIDS TO CLEAN THE IFD FILTER.
2. After removing the IFD Filter assembly from the air purifier, gently tap the filter onto a firm surface within a trash receptacle to release the captured particles. Should the IFD filter(s) dislodge from the frame, just place back in gently.

3. To clean the filter with a vacuum, lay the filter on a flat surface, with the pre-filter side down, and run a vacuum cleaner with a nozzle or brush attachment along the filter to pick-up dirt.

cleaning the pre-filter

to remove the pre-filter

Press the top tab to release the pre-filter from the filter assembly.

to clean the pre-filter

The particle pre-filter helps pick-up large airborne particles that enter the rear grille. This pre-filter can be removed from the frame and rinsed by hand under warm water. Let the pre-filter dry completely before inserting it back into the unit.

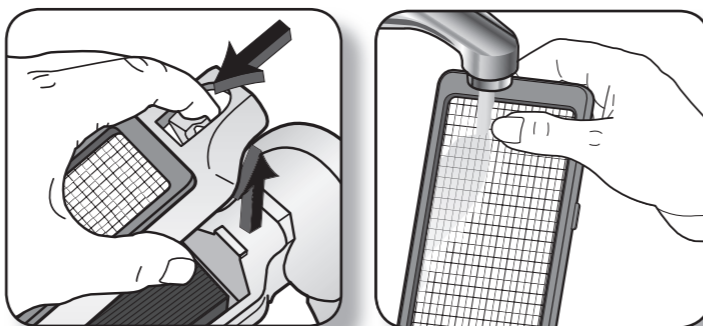

installing the filters

NOTE Please make sure that the air purifier is off and unplugged.

to install the IFD™ filter and pre-filter

1. Insert the lower tab of the pre-filter into the filter assembly and press the top tab into the filter assembly until you hear a "click".
2. Align the filter assembly with the opening in the unit and insert back into the unit. Press until it is flush and you hear a "click".

replacing the dual UV lamps

The UV Reset LED light will illuminate when it is time to replace the dual UV bulbs.

to replace the dual UV bulbs (63-1530 only)

1. Be sure to turn off and unplug your air purifier.
2. Press the Filter Release (IFD) button and remove the filter assembly.
3. The UV bulb housing is on the left and has a finger grip for ease of removal. Gently remove the UV bulb housing.
4. Turn the tab towards the unlock symbol (⓪).
5. Gently grasp the top of the tab and pull the bulb cartridge straight out of the UV socket. Do not touch the bulb directly with your hands.

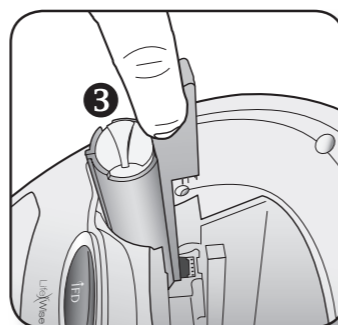

6. Do the same for the bottom tab and pull the bulb cartridge out of the UV socket.
7. Replace the top and lower UV bulb sockets.
8. The bulb cartridge will only fit one way; if it does not fit, turn the bulb cartridge the other way (with the arrow pointing to the center of the unit) and insert.
9. Push down gently so that the bulb cartridge engages with the unit. Turn arrow to the lock position.
10. Discard old UV bulb cartridge(s) only at household hazardous waste collection sites.
11. Place UV bulb housing back in air purifier housing and then insert IFD™ filter assembly.
12. Press UV reset button.

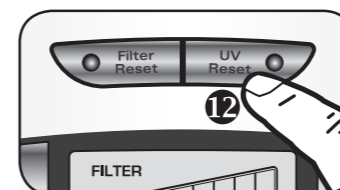
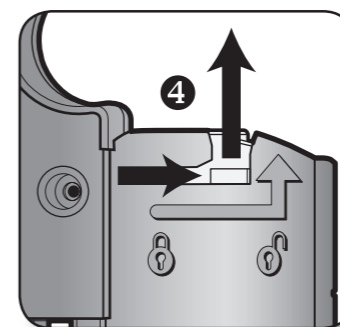

NOTE Bulb and bulb housing are not intended for use with any other product or purpose.

cleaning and maintenance

to clean the unit

1. Use a clean, dry cloth to wipe the external surfaces of the air purifier. DO NOT USE WATER, GASOLINE, POLISH, OR ANY CHEMICAL SOLUTION.
2. The IFD™ filter and pre-filter should be cleaned at least once a month, or sooner depending on the air quality of the room (see "removing/cleaning the IFD filter" or "cleaning the pre-filter" respectively).

frequently asked questions

How often is cleaning required?

About every four weeks depending on the air quality of the room. Select models have a filter clean indicator, advising you when to clean the filters.

Is the IFD™ Air Purifier considered an ozone generator?

No. Ozone generators produce large amounts of ozone and the EPA considers these unsafe for household use.

replacement filters

If you should damage your pre-filter, order a replacement pre-filter for the LifeWise IFD™ Air Purifier, by visiting our website at www.kaz.com or call us at 1-800-332-1110.

Filter No.	For Model	Qty.	Price
63-1533-F	63-1533	1	\$6.25 ea.
63-1533-F	63-1532	2	\$6.25 ea.
63-1533-F	63-1530	2	\$6.25 ea.

consumer relations

Mail questions or comments to:

Kaz, Inc.
Consumer Relations Dept.
250 Turnpike Road
Southborough, MA 01772

Call us toll-free at: 1-800-332-1110
E-mail: consumerrelations@kaz.com

Please be sure to specify a model number.

Patent # 6,749,669 and other patents pending.

important note

The ionizing process used by the air purifier produces small amounts of ozone as a by-product. These air purifiers comply with U.S. Government limits for acceptable levels of ozone (less than 50 parts per billion by volume of air circulating through the product). People with a history of respiratory problems or heart/lung disease should consult a physician prior to using this product.

limited 5-year warranty

You should first read all instructions before attempting to use this product.

A. This limited 5-year warranty applies to repair or replacement of product found to be defective in material or workmanship within 5 years of the date of purchase. This warranty does not apply to damage resulting from commercial, abusive, unreasonable use or supplemental damage. Defects that are the result of normal wear and tear will not be considered manufacturing defects under this warranty. KAZ IS NOT LIABLE FOR INCIDENTAL OR CONSEQUENTIAL DAMAGES OF ANY NATURE. ANY IMPLIED WARRANTY, INCLUDING MERCHANTABILITY OR FITNESS FOR A PARTICULAR PURPOSE, ON THIS PRODUCT IS LIMITED IN DURATION TO THE DURATION OF THIS LIMITED WARRANTY. Some regions do not allow the exclusion or limitation of incidental or consequential damages or limitations on how long an implied warranty lasts, so the above limitations or exclusions may not apply to you. This warranty gives you specific legal rights, and you also may have other rights which vary from region to region. This warranty applies only to the original purchaser of this product from the original date of purchase.

B. At its option, Kaz will repair or replace this product if it is found to be defective in material or workmanship within the limited warranty period. Defective product should be returned to the place of purchase in accordance with store policy. Thereafter, while within the warranty period defective product may be returned to Kaz.

C. This warranty does not cover damage resulting from any unauthorized attempts to repair or from any use not in accordance with the user's guide.

D. This warranty DOES NOT cover the pre-filter or the IFD filter except for material or workmanship defects.

E. Return defective product to Kaz, Inc. with a brief description of the problem. Include proof of purchase and a \$10 US check or money order for handling, return packing and shipping charges. Please include your name, address and a daytime phone number. You must prepay shipping charges.

Send to:

Kaz, Inc.
Attn: Returns Department
4755 Southpoint Drive
Memphis, TN 38118
USA

Free Manuals Download Website

<http://myh66.com>

<http://usermanuals.us>

<http://www.somanuals.com>

<http://www.4manuals.cc>

<http://www.manual-lib.com>

<http://www.404manual.com>

<http://www.luxmanual.com>

<http://aubethermostatmanual.com>

Golf course search by state

<http://golfingnear.com>

Email search by domain

<http://emailbydomain.com>

Auto manuals search

<http://auto.somanuals.com>

TV manuals search

<http://tv.somanuals.com>