

Part # LS-LED TASSO

211101

Part List

- 1 Tasso Lamp Body (A)
- 1 Tasso Lamp Base (B)
- 1 Power Adaptor (C)
- 1 Allen Wrench (D)

Instructions

1. Remove Tasso Lamp from carton.
2. Place Tasso Lamp Body (A) into Tasso Lamp Base (B).
3. Secure by fastening internal screws on Tasso Lamp Base (B) using Allen Wrench (D).
4. Plug Power Adaptor (C) into power outlet.
5. Press power switch ON/OFF to operate.

Caution

1. Never operate this appliance if it has a damaged cord, plug or cable.
2. Use the provided adaptor only.
3. Keep cord away from heated areas.

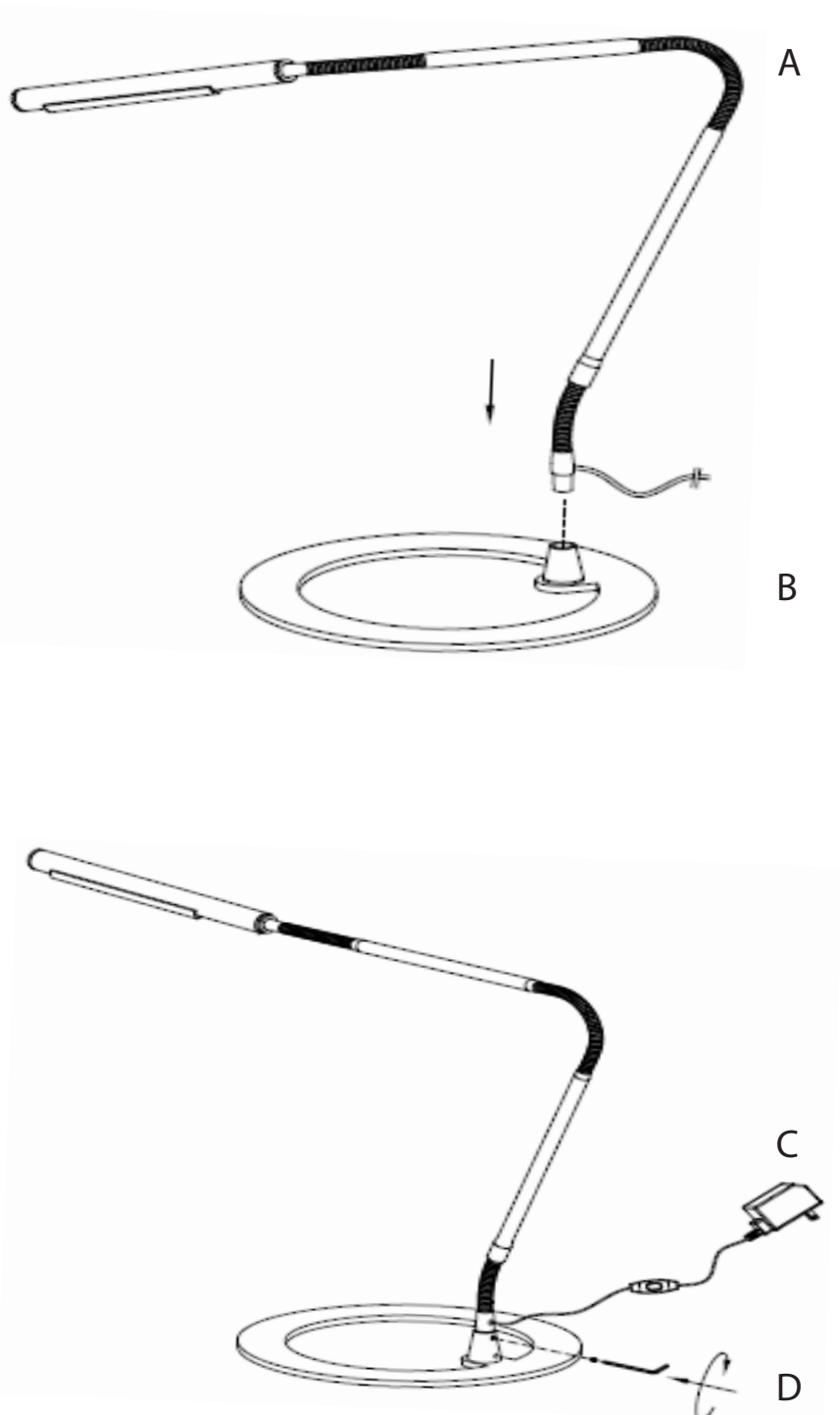

Free Manuals Download Website

<http://myh66.com>

<http://usermanuals.us>

<http://www.somanuals.com>

<http://www.4manuals.cc>

<http://www.manual-lib.com>

<http://www.404manual.com>

<http://www.luxmanual.com>

<http://aubethermostatmanual.com>

Golf course search by state

<http://golfingnear.com>

Email search by domain

<http://emailbydomain.com>

Auto manuals search

<http://auto.somanuals.com>

TV manuals search

<http://tv.somanuals.com>