

Feature rich programmable/non-programmable all-in-one thermostat

5/1/1-day
Programmable • Non-Programmable

Product Highlights

- ✓ All In-One Programmable / Non-Programmable
- ✓ Universal heat pump & conventional heat / cool
- ✓ Dual power
- ✓ 3 year warranty
- ✓ Adjustable 2nd stage heat offset



Product Features

- Easy installation
- Program 5/1/1-day or non programmable
- Easy-view back light
- Optional wall plate model #WP567
- User option: 2 or 4 periods per day
- Keypad lock for unauthorized use
- Temporary override and manual hold
- Dual powered (2AA) Alkaline Batteries (included)
- Temporary compressor protection bypass
- 5/2 minute selectable time delay for equipment protection
- User temperature calibration
- Display option: fahrenheit or celsius temperature
- Adjustable heating and cooling limits
- Speed Slide® for easy programming
- Graphical air filter monitor
- Selectable smart recovery
- AM/PM clock or military time option
- Adjustable temperature differential/swing

Installation

Compatible With

- Universal compatibility for conventional heat & A/C
- Universal compatibility for heat pumps with up to 2-stage heat/1 stage cool (including AUX/EMERG heat)
- 2 and 3-wire hydronic systems (hot water baseboard & radiator)
- Gas Millivolt heaters (wall heaters/furnaces & gas fireplaces)

Not Compatible With

- Line voltage systems (120/240 VAC)

SPECIFICATIONS

MODEL# **P621U**

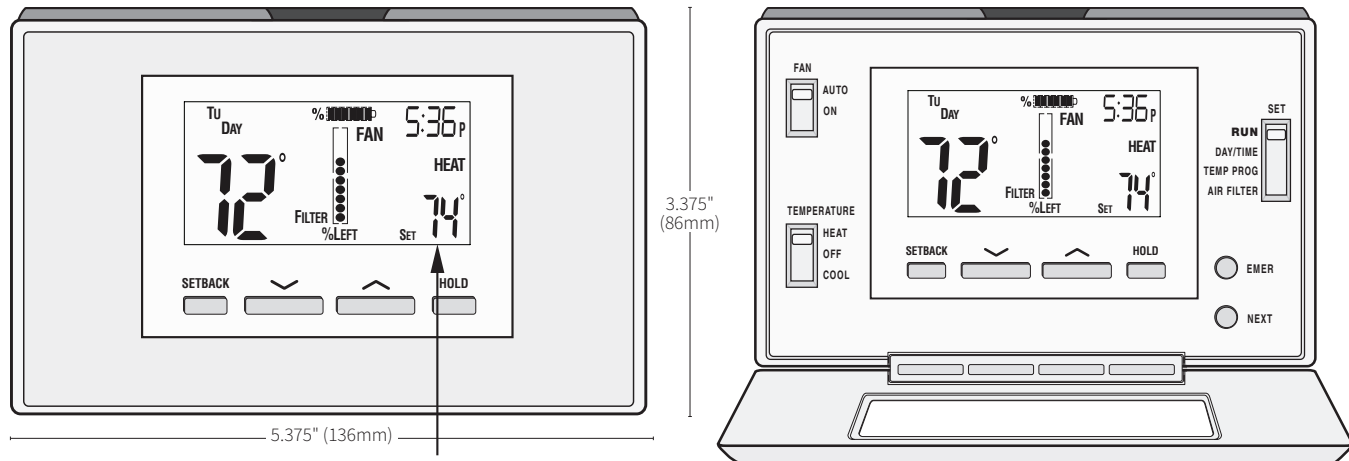

Easy to read LCD provides time, temperature and program information at a glance.

Dimensions	5.375" (136mm) wide x 3.375" (86mm) tall x 1.125" (28mm) deep
Heat/Cool Terminals	O, B, G, Y, RC, RH, W1, A, W2, C (solid pins for 24v and Millivolt systems)
Electrical Ratings	1.5 Amps per terminal at 24 volts
Temperature Control Range	<ul style="list-style-type: none"> Temp control 45°F to 90°F (7°C to 32°C) Display range: 23°F to 99°F (-5°C to 37°C) Temperature Differential: adjustable from ±0.25°F to ±2.25°F <i>Accuracy ±1°F over a range of 45°F to 90°F.</i>
Environmental Limits	<ul style="list-style-type: none"> Moisture and Dust: meets IP20 Operating Humidity: 20% to 90% (non-condensating) Operating temperature: 14°F to 122°F (-10°C to 50°C) Storage temperature: -4°F to 140°F (-20°C to 60°C) Electrical Immunity: meets relevant EMI/EMC specifications
Compatible With	<ul style="list-style-type: none"> Universal compatability for conventional heat & A/C Universal compatability for heat pumps with up to 2-stage heat/ 1 stage cool (including AUX/EMERG heat) 2 and 3-wire hydronic systems (hot water baseboard & radiator) Gas Millivolt heaters (wall heaters/furnaces & gas fireplaces)
Not Compatible With	<ul style="list-style-type: none"> Line voltage systems (120/240 VAC)
Packaging	<ul style="list-style-type: none"> Master Carton: 10 units UPC: 0 21079 12621 7

Project Name _____

Date _____

Contractor / Engineer _____

Location _____

Free Manuals Download Website

<http://myh66.com>

<http://usermanuals.us>

<http://www.somanuals.com>

<http://www.4manuals.cc>

<http://www.manual-lib.com>

<http://www.404manual.com>

<http://www.luxmanual.com>

<http://aubethermostatmanual.com>

Golf course search by state

<http://golfingnear.com>

Email search by domain

<http://emailbydomain.com>

Auto manuals search

<http://auto.somanuals.com>

TV manuals search

<http://tv.somanuals.com>