

MAGNASONIC

For Customer Assistance Call:

1-800-663-5954

07MF117

7" Leather Digital Photo Frame

Instruction Manual



Thank you for your purchase of this Magnasonic product. Please read this Instruction Manual carefully before using product to ensure proper use. Keep this manual in a safe place for future reference.

www.magnasonic.ca

Introduction

Precautions and Maintenance

- For indoor use only
- To avoid risk of fire or electric shock, do not expose this appliance to moisture.
- To avoid overheating, do not block the ventilation holes on the back of this digital photo frame at any time.
- Keep this Multimedia Digital Photo Frame out of sunlight. Direct sunlight may cause damage.
- Always use the eject buttons on the memory storage card slots to remove the memory storage cards.
- Do not dismantle this Digital Photo Frame. There is a risk of electric shock, and there are no user serviceable parts inside. Dismantling your Multimedia Digital Photo Frame will void your warranty.
- Do not use this Multimedia Digital Photo Frame if conditions could allow condensation to occur, this may result in damage.

Cleaning the LCD Screen

- Treat the screen gently. The screen on this Digital Photo Frame is made of glass and can be easily scratched or broken.
- If fingerprints or dust accumulate on the LCD screen, use a soft, non-abrasive cloth such as a camera lens cloth to clean the LCD screen.
- If you use an LCD cleaning Kit sold at various retail outlets, do not apply the cleaning liquid directly to the LCD screen. Moisten the cleaning cloth with the cleaning solution and apply the cloth to the screen.

WARNING:

Please STOP the unit before inserting or removing a memory card or USB Drive. Failure to do so may cause damage to the card/USB and the unit.

Table of Contents

Introduction	1
Precautions and Maintenance	1
Cleaning the LCD Screen	1
Important Safety Instructions	3
Inserting Memory Cards	4
Remote Control Function Buttons	5
Installing and replacing the Remote Control Battery	7
Player Overview	8
Getting Started	9
Connection to a TV (Optional)	10
Main Menu	11
Play Music File	11
Play Photo File	12
Combo Play	13
Play Video File	13
Setup Menu	14
Calendar	18
Clock	19
Alarm	20
Auto-Power	21
Edit	22
Troubleshooting Guide	23
Specifications	24

Important Safety Precautions

- Read these instructions.
- Keep these instructions.
- Heed all warnings.
- Follow all instructions.
- Do not use this Digital Photo Frame near water.
- Clean only with a dry cloth.
- Do not block any ventilation openings. Install in accordance with the manufacturer's instructions.
- Do not install near any heat sources such as radiators, heat registers, stoves or other apparatus (including amplifiers) that produce heat.
- Do not defeat the safety purpose of the polarized or grounding-type plug. A polarized plug has two blades with one wider than the other. A grounding type plug has two blades and a third grounding prong. The wide blade or the third prong is provided for your safety. If the provided plug does not fit into your outlet, consult an electrician for replacement of the obsolete outlet.
- Protect the power cord from being walked on or pinch particularly at plugs, convenience receptacles, and the point where they exit from the Digital Photo Frame.
- Only use attachments/accessories specified by the manufacturer.
- Unplug this Digital Photo Frame during lightening storms or when unused for long periods of time.
- Refer all servicing to qualified service personnel. Servicing is required when the Digital Photo Frame has been damaged in any way, such as power supply cord or plug is damaged. Liquid has been exposed to rain or moisture, does not operate normally or has been dropped.
- This Digital Photo Frame shall not be exposed to dripping or splashing water and that no object filled with liquid such as vases shall be placed on the Digital Photo Frame.



This symbol on the product or in the instructions means that your electrical and electronic equipment should be disposed at the end of its life separately from your household waste. There are separate collection systems for recycling. For more information, please contact the local authority or your retailer where you purchased the product.

Resource

Inserting Memory Cards



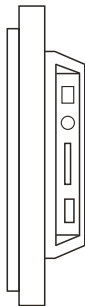

Your Digital Photo Frame is compatible with the following memory cards:

- Secure Digital Card (SD)
- Multimedia Card (MMC)
- Memory Stick (MS)
- USB Drive



Insert the memory card with the screen and slots all facing yourself. Do not force the card into the slot. If you are not able to easily insert the memory card completely, you may have inserted it in the wrong direction.

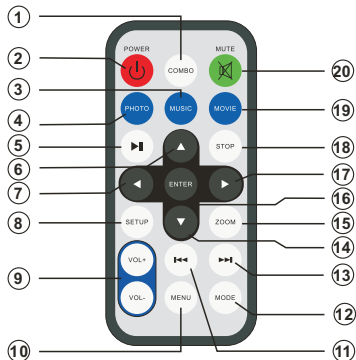

Remote Control Function Buttons

- 1. COMBO KEY:** Pressing this the button will select combo mode to play.
- 2. POWER BUTTON ():** This is used to turn ON/OFF the player.
- 3. MUSIC BUTTON:** Music file will play.
- 4. PHOTO BUTTON:** Photo File will play.
- 5. PLAY / PAUSE BUTTON ():** This button is used to PLAY or PAUSE the current photo or audio file.
- 6. UP BUTTON ():** Up cursor selection function.
- 7. LEFT SHIFT BUTTON ():** Left cursor selecting function.
- 8. SETUP BUTTON:** Used to enter the photo frame setup options.
- 9. VOLUME+/- BUTTON:** Used to adjust the volume up or down.
- 10. MENU BUTTON:** Used to revert back to the photo frames Main Menu.
- 11. PREV BUTTON ():** Used to revert back to the previous file.



- 12. MODE BUTTON:** Set the screen Aspect Ratio.
- 13. NEXT BUTTON ():** Used to fast forward to the next file.
- 14. DOWN BUTTON ():** Down cursor selection function.
- 15. ZOOM BUTTON:** Used to zoom into the image. Each press advances the zoom one setting at a time.

Remote Control Function Buttons (continued)

- 16. ENTER BUTTON:** Used to confirm your current.
- 17. RIGHT SHIFT BUTTON (▶):** Right cursor selecting function.
- 18. STOP BUTTON:** Used to stop playback of current file.
- 19. MOVIE BUTTON:** Play movie file format.
- 20. MUTE BUTTON:** Press once to silence audio playback. Press again to resume audio playback.

Installing and replacing the Remote Control Battery:

1

1. Rotate the remote control so it is face down and pop out the battery tray.

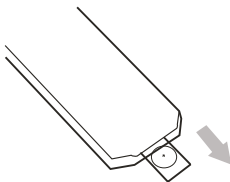

2

2. Insert the batteries.

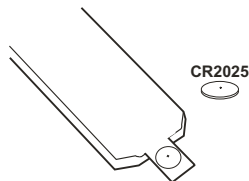

Insert the batteries according to the correct (+)(-) polarity.

3

3. Close the battery tray.

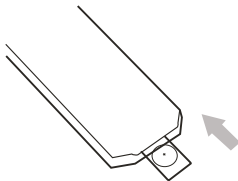

1. Insert the battery matching the correct polarity.
2. Do not expose the battery to heat/fire and do not short-circuit the battery.
3. Do not leave dead batteries in the remote control.
4. If you do not use the remote control for a long period of time, remove the battery.
5. If the remote control does not function correctly or the operating range becomes reduced, replace the battery.

Note:

1. Point the remote control directly at the digital frame remote sensor.
2. Do not leave the remote control in an extremely hot or humid place.
3. Do not spill water or put anything wet on the remote control.
4. Battery life is 1 year under normal operating conditions.

Player Overview

Key Control and Key Functions:

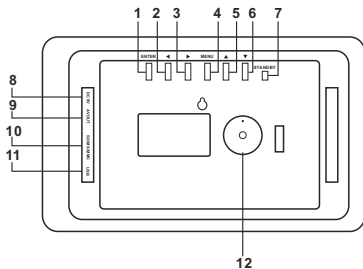

- 1. ENTER BUTTON:** Used to confirm your current selection.
- 2. LEFT SHIFT BUTTON (◀):** Left cursor selecting function.
- 3. RIGHT SHIFT BUTTON (▶):** Right cursor selecting function.
- 4. MENU BUTTON:** Used to revert back to the photo frames Main Menu.
- 5. UP BUTTON (▲):** Up cursor selection function.
- 6. DOWN BUTTON (▼):** Down cursor selection function.
- 7. STANDBY BUTTON:** Used to power on and off the Digital Photo Frame.
- 8. DC 9V:** Input for the DC Power Adaptor into the DPF.
- 9. AV OUTPUT:** Connect a TV set to output video.
- 10. SD/MS/MMC CARD SLOT:** Insert memory cards here
- 11. USB:** Connect to a USB Drive.
- 12. Bracket jack.**

Getting started

Getting Started

1. Assemble the Multimedia Digital Photo Frame bracket to prop the unit up. Insert the DC Adaptor into the DPF player first, then plug the power cord into a standard wall outlet.

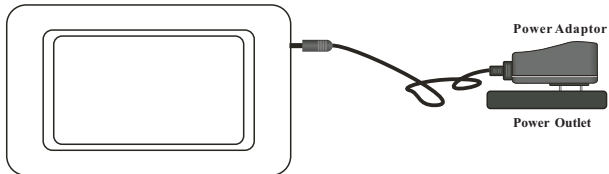

2. Press the STANDBY switch to turn ON and OFF the DPF. The following screen will display with the DPF is on.

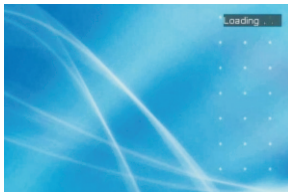

Connection to a TV (Optional)

Connecting your Multimedia DPF to your TV (Fig 1)

Use the supplied TV Cable to connect the Multimedia DPF to your TV / AV jacks (usually yellow, red and white). Turn off both the frame and the TV before making the connection. Once the connection is made, make sure that your TV is in the right setting (usually option AV, Video or AUX).

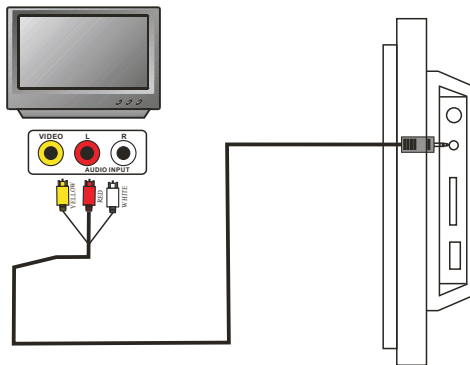

Fig 1

Main Menu

Function

The Main Menu interface is the selection for all menu options, such as Photo, Music, Photo+Music, Movie, Favorite, Setup, Calendar, Clock, Alarm, Auto-Power, and Edit (Fig 2).

Operation:

Press the Arrow ▲▼◀▶ buttons to choose the option, press the **ENTER** key to confirm the selection.



Fig 2

Play Music File

You can insert a SD, MS, MMC card or a USB Drive. After the unit reads the songs, you can select the content that you want to play. Refer to the image below: (Fig 3).

Operation:

- Use the Arrow (◀▶▲▼) buttons to enter the Directory List and highlight the desired directory. Then the first track under it will start playback. Also, you can use the Arrow (◀▶▲▼) buttons to enter the File List and select the file you want to play.
- If the automatic MUSIC playing function is turned on, then **MUSIC** will automatically be played when the system enters **MUSIC MODE**.

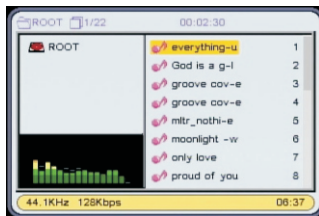

Fig 3

Play Photo File

You can insert a SD, MS, MMC card or a USB Drive. After the unit reads the picture, you can select the content that you want to play. Refer to the image below: (Fig 4)

Operation:

a) Use the Arrow (◀▶▲▼) buttons to enter the Directory List and highlight the desired directory. Then the first file under it will start playback. Also, you can use the Arrow (◀▶▲▼) buttons to enter the File List and select the file you want to play.

b) In the **Setup Menu-Photo Setting**, the user can choose the picture display mode freely.

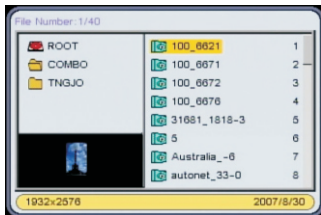

Fig 4

Photo Rotation

When playing or pausing, press the arrow buttons to change the display angle:

Up (▲): Flip Horizontally

Down (▼): Flip Vertically

Left (◀): Rotate 90° counter-clockwise

Right (▶): Rotate 90° clockwise

Combo Play

Operation

Press the Arrow ▲▼◀▶ buttons to choose **Photo + Music** in the Main Menu. Press the **ENTER** key to play (Fig 5).

- Press **VOL+/VOL-** keys to increase or decrease the volume.
- Press the **MUTE** key to mute the volume.



Fig 5

NOTE: Music and pictures must be put in the same directory when choosing **Photo+Music** in the main menu. If pressing the **COMBO** key on the remote control to play music and pictures (it's unnecessary to put music and picture in the same directory).

Play Video File

You can insert a SD, MS, MMC card or a USB Drive. After the unit reads the picture, you can select the content that you want to play. Refer to the image below: (Fig 6).

Operation:

a) Use the Arrow (◀▶▲▼) buttons to enter the Directory List and highlight the desired directory. Then the first file under it will start playback. Also, you can use the Arrow (◀▶▲▼) buttons to enter the File List and select the file you want to play.

b) Press the **STOP** button to return to the File List.

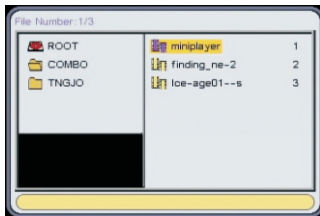

Fig 6

Setup Menu

The **DPF** setup menu allows you to configure the Photo Setting, Auto-play, Display Setup, Custom Setup, and Power off the **DPF** Player.

Operation:

Press the Arrow **▲▼◀▶** buttons to choose **SETUP** in the Main Menu. Press the **ENTER** key to enter into the **SETUP** interface (Fig 7). Press the **▲▼** key to choose the set item. Press the **▶** key to open the corresponding menu.

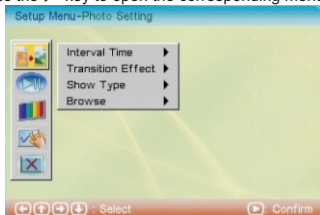

Fig 7

Photo Setting (Fig 8)

1. Interval Time

This option can be used to set the length of time for each image displayed. There are six options: 5, 10, 15, 30 seconds, 1 minute, 3 minutes and off.

2. Transition Effect

This option is used to set the transition effect as images change.

3. Show Type

This function allows you to select the picture. The available options are Fit Screen and Full Screen.

4. Browse

There are two kinds of Photo modes, one is the File Manager mode and the other is the Thumbnail mode.

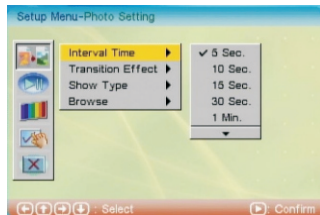

Fig 8

Operation:

Press the **▲▼** keys to choose the set item. Press the **▶** key to open the corresponding menu. Press **ENTER** to confirm. Press **◀** to exit.

Setup Menu

Auto-play

1. Photo (Fig 9)

This setting can be set to either On or Off. This setting decides whether or not to activate the automatic display function after entering the Photo mode.

If this option is set to "On", then the system will enter slide show mode after you enter Photo. If it is set to "Off", then the system will enter either File Manager mode or Browser mode (according to the Browser settings set by the user).

2. Music (Fig 10)

This setting can be set to either On or Off. This setting decides whether or not to initiate the automatic play function after entering Music mode. If this setting is set to "On", then the system will enter file mode and initiate automatic playback after entering Music mode. If this setting is set to "Off", then after entering Music file mode, the user will have to manually press the Play button.

3. Movie (Fig 11)

This setting can be set to either On or Off. This setting decides whether or not to initiate the automatic play function after entering Movie mode. If this setting is set to "On", the system will automatically play the video after entering Movie mode. If this setting is set to off, then after entering the Movie file mode, the user will be allowed to manually browse the videos.

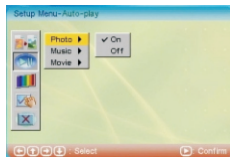

Fig 9

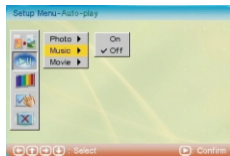

Fig 10

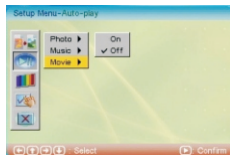

Fig 11

Setup Menu

Display Setup (Fig 12)

1. TV Standard

The user can select according to their standard television system. The options are: NTSC, PAL, and Auto.

2. Brightness

This option allows the user to set the brightness of the television screen. There are three different options: Normal, Bright, and Soft.

3. Contrast

According to their individual preference. The contrast is divided into 9 different levels, from -4~0~4, with larger (positive) numbers representing greater contrast.

4. TFT Brightness

If an LCD display is used this option can be used to set the screens brightness. The brightness is divided into 15 levels, from -7~0~7, with the larger (positive) numbers representing greater brightness.

5. TFT Contrast

If an LCD display is used, this option can be used to set the screen contrast. The contrast is divided into 15 different levels, from -7~0~7, with larger (positive) numbers representing greater contrast.

6. TFT Saturation

If the user uses an LCD display, this option can be used to set the saturation of the display. The saturation is divided into 15 levels, from -7~0~7, with larger (positive) numbers representing a higher degree of saturation.

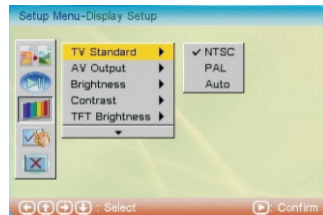

Fig 12

Setup Menu

Custom Setup (Fig 13)

1. OSD Language

This option can be used to set the language for the OSD (on screen display). The user can choose from: English, French, German, Italian, Spanish, Dutch Portuguese and Polish.

2. Style

This option allows the user to choose their preferred operation style. There are four different styles for the user to choose from: Style 1, Style 2, Style 3, and Style 4

3. LOGO Type

The user can choose the menu background freely: Default and Favorite.

Operating Method:

First copy your favorite picture into the Favorite Folder. Open the **Favorite Folder**, and press the **►|** button to play their favorite photos.

4. Repeat Mode

This option allows the user to set the play repeat mode. There are four available options: Off, One, Folder, and All.

5. Media

The user can choose the media player freely: USB, SD/MMC, MS.

6. Default

By setting this option, all settings will be reset to the original system settings.

Exit (Fig 14)

Leaves the setup menu, and goes back to the main menu.



Fig 13

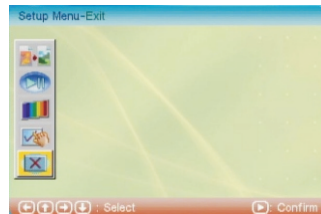

Fig 14

Calendar

Calendar (Fig 15)

After selecting Calendar from the Main Menu, press the **PLAY** button, and you will enter the date setting mode.

1. Display (Fig 16)

This option provides the Calendar display function. The date displayed in the calendar is the current date set in the system.

In addition to displaying the current date, the user can use the ▲▼ keys to browse different months, or use the ◀▶ keys to browse different years.

2. Set Date (Fig 17)

This function allows the user to set the system date.

3. Exit

Exits date settings and reverts back to the Main Menu.

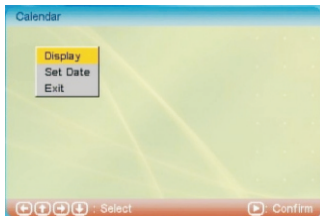

Fig 15

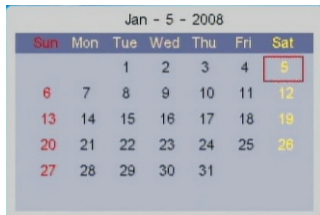

Fig 16



Fig 17

Clock

Clock Setting (Fig 18)

After selecting Clock from the Main Menu, press the **ENTER** key, and the system will enter time setting mode.

1. Display (Fig 19)

This option allows the user to display the Clock or Clock & Calendar. Select Time, and press the **ENTER** key. Select Clock & Calendar, and press the **PLAY** key.

2. Set Time (Fig 20)

This function allows the user to set the system time.

3. Exit

Exits the time settings, and goes back to the Main Menu.

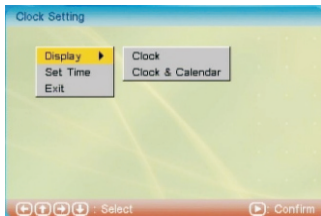

Fig 18



Fig 19

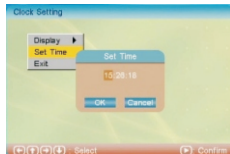
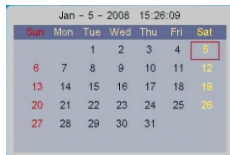

Fig 20

Alarm

Alarm Setting

After selecting Alarm from the Main Menu, press the **ENTER** button, and the system will enter the alarm setting mode.

1. Enable (Fig 21)

This function allows the user to activate (On) or de-activate (Off) the alarm.

2. Set Time (Fig 22)

This function allows the user to set the alarm time. When the alarm function has been activated, a prompt will appear. Press any key to exit the alarm mode.

3. Exit

Exits the alarm settings, and reverts back to the Main Menu.

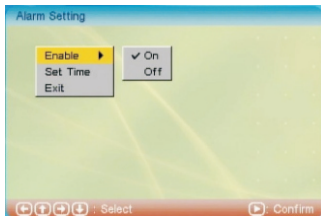

Fig 21



Fig 22

Auto-Power

Auto-Power On/Off Setting

After selecting Auto-Power from the main menu, press the **ENTER** button, and the system will enter the automatic Power-on/Power-off settings mode.

1. Power On Enable (Fig 23)

This option allows the user to either activate (On) or de-activate (Off) the automatic Power-on function.

2. Power Off Enable (Fig 24)

This function allows the user to activate (On) or de-activate (Off) the automatic Power-off function.

3. Set Time (Fig 25)

This function allows the user to set the automatic power-on/power-off times. The user can choose to set the Power-on time or the Power-off time.

4. Exit

Exits the automatic Power-on/Power-off settings, and goes back to the Main Menu.

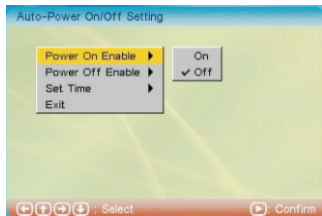

Fig 23



Fig 24

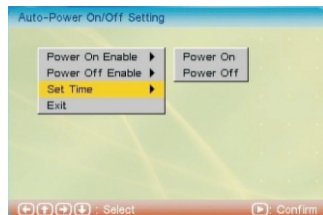

Fig 25

Edit

After selecting Edit from the Main Menu, press the ENTER button, and the system will enter Edit mode. In Edit mode, the user can choose to Copy, Delete, or to Exit.

1. Copy (Fig 26)

The user can Copy image files from the storage device, and use the images as screen saver images. The user can use the ▲▼ keys to select images. After choosing images, press the ENTER button, and the selected images will display a red frame which indicates that they have been selected. If the user wishes to cancel a selection, they can accomplish this by pressing the ENTER button again. After the user completes the selection, they can press the ◀▶ keys to go to the Save option, and then press Save to save the selected images. The maximum number of images this function can save is 15 (including the default screen saver images).

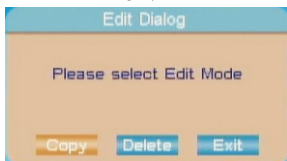

Fig 26

2. Delete (Fig 27)

This function allows users to delete screen saver images. The user can first go to the Delete option, and then after entering the delete mode by pressing the ENTER key, you can use the ◀▶ keys to select the images you wish to delete; press ENTER and the selected image will be deleted, or select Delete All to delete all of the images. In addition to the Delete option, the user can also select Sort to change the sequence in which screen saver images are displayed. First select the images for which you wish to change sequencing. By pressing the ENTER button you will be able to select a particular image, then, by pressing the ◀▶ buttons, you can change the order of the image. Finally, users can select the Slide Show option to enter the screen saver mode to preview the images.



Fig 27

Troubleshooting Guide

If you are experiencing problems with your Digital Photo Frame, please consult the following Troubleshooting information. If you need further assistance, please contact Technical Support at 1 800-663-5954.

No power:

Please check whether there is power, and that the DC power cord is plugged in correctly.

Remote Control not functioning:

Please check that the battery has power, and that it is inserted correctly matching the polarities.

Can not read the CARD or USB:

Please check that there is content on the card or USB disk.

No AV output:

Please check to ensure that all audio and video cables are connected correctly.

Can not play the file:

Please confirm whether the file format can be played by the player.

Display too bright or too dark:

Please adjust the brightness or contrast in the setup menu.

The color is light or no color:

Please adjust the color setup.

No sound:

Please check that the volume is not at minimum and is not in MUTE mode.

The picture can do display in full screen:

Please check the picture aspect ratio setup.

Specifications

Specifications

Display: 7" TFT LCD 480 (RGB) x 234

Output: Audio / Video

Speaker: Stereo

Operation: Remote Control

Power: AC Adaptor; Input 100-240V~; Output 9V, 1.5A

Environmental operating ranges

Operating Temperature: -10~70 degrees celcius

Storage Temperature: -20~80 degrees celcius

Accessories:

Power Adapter
AV Cable (Optional)
Remote Control
User Manual

All specifications and instructions are subject to change without notice.

75-70C71KY-01R

Free Manuals Download Website

<http://myh66.com>

<http://usermanuals.us>

<http://www.somanuals.com>

<http://www.4manuals.cc>

<http://www.manual-lib.com>

<http://www.404manual.com>

<http://www.luxmanual.com>

<http://aubethermostatmanual.com>

Golf course search by state

<http://golfingnear.com>

Email search by domain

<http://emailbydomain.com>

Auto manuals search

<http://auto.somanuals.com>

TV manuals search

<http://tv.somanuals.com>