

User Manual

**MAGNAVOX**  
SMART. VERY SMART.

**MDV435**  
**MDV436**  
DVD VIDEO PLAYER



Thank you for choosing  
Magnavox.

**Need help fast?**

Read your Quick Use/Start Guide and/or  
Owner's Manual first for quick tips  
that make using your Magnavox product  
more enjoyable.

If you have read your instructions  
and still need assistance,  
you may access our online help at

[www.magnavox.com/usasupport](http://www.magnavox.com/usasupport)  
or call

**1-800-705-2000**

while with your product  
(and Model / Serial number)



Magnavox vous remercie de  
votre confiance.

**Besoin d'une aide  
rapide?**

Les Guide d'utilisation rapide et Manuel de  
l'utilisateur regorgent d'astuces destinées à  
simplifier l'utilisation de votre produit Magnavox.

Toutefois, si vous ne parvenez pas à résoudre  
votre problème, vous pouvez accéder à  
notre aide en ligne à l'adresse

[www.magnavox.com/usasupport](http://www.magnavox.com/usasupport)  
ou formez le

**1-800-661-6162 (Francophone)**

**1-800-705-2000 (English speaking)**

Veillez à avoir votre produit à  
portée de main  
(et model / serial nombre)



Gracias por escoger  
Magnavox.

**Necesita ayuda  
inmediata?**

Lea primero la Guía de uso rápido o el  
Manual del usuario, en donde encontrará  
consejos que le ayudarán a disfrutar  
plenamente de su producto Magnavox.

Si después de leerlo aún necesita ayuda,  
consulte nuestro servicio de  
asistencia en línea en

[www.magnavox.com/usasupport](http://www.magnavox.com/usasupport)

o llame al teléfono

**1-800-705-2000**

y tenga a mano el producto  
(y número de model / serial)



**Return your Product Registration Card or register online at  
www.magnavox.com/usasupport today to get the very most from your purchase.**

Registering your model with MAGNAVOX makes you eligible for all of the valuable benefits listed below, so don't miss out. Complete and return your Product Registration Card at once, or register online at [www.magnavox.com/usasupport](http://www.magnavox.com/usasupport) to ensure:

**\*Proof of Purchase**

Returning the enclosed card guarantees that your date of purchase will be on file, so no additional paperwork will be required from you to obtain warranty service.

**\*Product Safety Notification**

By registering your product, you'll receive notification - directly from the manufacturer - in the rare case of a product recall or safety defect.

**\*Additional Benefits**

Registering your product guarantees that you'll receive all of the privileges to which you're entitled, including special money-saving offers.

**MAGNAVOX**

*Congratulations on your purchase, and welcome to the "family!"*

**Dear MAGNAVOX product owner:**

Thank you for your confidence in MAGNAVOX. You've selected one of the best-built, best-backed products available today. We'll do everything in our power to keep you happy with your purchase for many years to come.

As a member of the MAGNAVOX "family," you're entitled to protection by one of the most comprehensive warranties and outstanding service networks in the industry. What's more, your purchase guarantees you'll receive all the information and special offers for which you qualify, plus easy access to accessories from our convenient home shopping network.

Most importantly, you can count on our uncompromising commitment to your total satisfaction.

All of this is our way of saying welcome - and thanks for investing in a MAGNAVOX product.

**P.S. To get the most from your MAGNAVOX purchase, be sure to complete and return your Product Registration Card at once, or register online at:**

[www.magnavox.com/usasupport](http://www.magnavox.com/usasupport)

Know these **safety** symbols



This "bolt of lightning" indicates uninsulated material within your unit may cause an electrical shock. For the safety of everyone in your household, please do not remove product covering.

The "exclamation point" calls attention to features for which you should read the enclosed literature closely to prevent operating and maintenance problems.

**WARNING:** To reduce the risk of fire or electric shock, this apparatus should not be exposed to rain or moisture and objects filled with liquids, such as vases, should not be placed on this apparatus.

**CAUTION:** To prevent electric shock, match wide blade of plug to wide slot, fully insert.

**ATTENTION:** Pour éviter les choc électriques, introduire la lame la plus large de la fiche dans la borne correspondante de la prise et pousser jusqu'au fond.

**For Customer Use**

Enter below the Serial No. which is located on the rear of the cabinet. Retain this information for future reference.

Model No. \_\_\_\_\_  
Serial No. \_\_\_\_\_

**MAGNAVOX**

Visit our World Wide Web Site at <http://www.magnavox.com/usasupport>

## IMPORTANT SAFETY INSTRUCTIONS

1. Read these instructions.
2. Keep these instructions.
3. Heed all warnings.
4. Follow all instructions.
5. Do not use this apparatus near water.
6. Clean only with dry cloth.
7. Do not block any ventilation openings. Install in accordance with the manufacturer's instructions.
8. Do not install near any heat sources such as radiators, heat registers, stoves, or other apparatus (including amplifiers) that produce heat.

9. Do not defeat the safety purpose of the polarized or grounding-type plug.

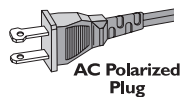

A polarized plug has two blades with one wider than the other. A grounding type plug has two blades and a third grounding prong. The wide blade or the third prong are provided for your safety. If the provided plug does not fit into your outlet, consult an electrician for replacement of the obsolete outlet.

10. Protect the power cord from being walked on or pinched, particularly at plugs, convenience receptacles, and the point where they exit from the apparatus.
11. Only use attachments/accessories specified by the manufacturer.

12.  Use only with the cart, stand, tripod, bracket, or table specified by the manufacturer or sold with the apparatus. When a cart is used, use caution when moving the cart/apparatus combination to avoid injury from tip-over.

13. Unplug this apparatus during lightning storms or when unused for long periods of time.

14. Refer all servicing to qualified service personnel. Servicing is required when the apparatus has been damaged in any way, such as power-supply cord or plug is damaged, liquid has been spilled or objects have fallen into the apparatus, the apparatus has been exposed to rain or moisture, does not operate normally, or has been dropped.

15. Battery usage **CAUTION** – To prevent battery leakage which may result in bodily injury, property damage, or damage to the unit:

- Install **all** batteries correctly, + and - as marked on the unit.
- Do not mix batteries (**old** and **new** or **carbon** and **alkaline**, etc.).
- Remove batteries when the unit is not used for a long time.

16. Apparatus shall not be exposed to dripping or splashing.

17. Do not place any sources of danger on the apparatus (e.g. liquid filled objects, lighted candles).

18. This product may contain lead and mercury. Disposal of these materials may be regulated due to environmental considerations.

**For disposal or recycling information, please contact your local authorities or the Electronic Industries Alliance : [www.eiae.org](http://www.eiae.org).**

**Class II equipment symbol**   
This symbol indicates that the unit has a double insulation system

EL 6475-E005: 04/01

The apparatus shall not be exposed to dripping or splashing and that no objects filled with liquids, such as vases, shall be placed on apparatus.

Due to the inconsistency of disc formats provided by various disc manufacturers, your DVD system may require a playability enhancement or upgrade. As DVD technology advances, these enhancements will become common and will be easy to complete.  
**Go to [www.philips.com/support](http://www.philips.com/support) for software upgrade.**

This warning label is located on the rearside and inside this laser product.

<b>CAUTION</b> INVISIBLE LASER RADIATION WHEN OPEN. DO NOT STARE INTO BEAM. INVISIBLE LASER RADIATION WHEN OPEN. <b>DANGER</b> AVOID DIRECT EXPOSURE TO BEAM. <b>VARO!</b> AVATTAESSA JA SUOJALUKITUS OHITETTAESSA OLET ALTTINA HÄNKÄYTTÖMAALLE LASERSÄTEILYLLE. ÄLÄ KATSO SATEESEEN. <b>VARNING!</b> OSYNLIG LASERSTRÅLNING NÄR DENNA DEL ÄR ÖPPNAD. OCH SIKRAREN ÄR UNGSKYDDSBETRÄKKA SÅ STRÅLEN.
or
<b>DANGER</b> - In-visible laser radiation when open. AVOID DIRECT EXPOSURE TO BEAM.

### WARNING

To reduce risk of fire or electric shock, do not expose this appliance to rain or moisture. Use of controls or adjustments or performance of procedures other than herein may result in hazardous radiation exposure.  
The set complies with the FCC-Rules, Part 15 and with 21 CFR 1040.10.

### Canada

**English:**  
This digital apparatus does not exceed the Class B limits for radio noise emissions from digital apparatus as set out in the Radio Interference Regulations of the Canadian Department of Communications.

**Français:**  
Cet appareil numérique n'émet pas de bruits radioélectriques dépassant les limites applicables aux appareils numériques de Class B prescrites dans le Règlement sur le Brouillage Radioélectrique édicté par le Ministère des Communications du Canada.

## Language Code

Abkhazian	6566	Inupiaq	7375	Pusho	8083
Afar	6565	Irish	7165	Russian	8285
Afrikaans	6570	Íslenska	7383	Quechua	8185
Amharic	6577	Italiano	7384	Raeto-Romance	8277
Arabic	6582	Ivrit	7269	Romanian	8279
Armenian	7289	Japanese	7465	Rundi	8278
Assamese	6583	Javanese	7486	Samoan	8377
Avestan	6569	Kalaallisut	7576	Sango	8371
Aymara	6589	Kannada	7578	Sanskrit	8365
Azerbaijani	6590	Kashmiri	7583	Sardinian	8367
Bahasa Melayu	7783	Kazakh	7575	Serbian	8382
Bashkir	6665	Kernewek	7587	Shona	8378
Belarusian	6669	Khmer	7577	Shqip	8381
Bengali	6678	Kinyarwanda	8287	Sindhi	8368
Bihari	6672	Kirghiz	7589	Sinhalese	8373
Bislama	6673	Komi	7586	Slovensky	8373
Bokmål, Norwegian	7866	Korean	7579	Slovenian	8376
Bosanski	6683	Kuanyama; Kwanyama	7574	Somali	8379
Brezhoneg	6682	Kurdish	7585	Sotho; Southern	8384
Bulgarian	6671	Lao	7679	South Ndebele	7882
Burmese	7789	Latina	7665	Sundanese	8385
Castellano, Español	6983	Latvian	7686	Suomi	7073
Catalán	6765	Letzeburgesch;	7666	Swahili	8387
Chamorro	6772	Limburgan; Limburger	7673	Swati	8383
Chechen	6769	Lingala	7678	Svenska	8386
Chewa; Chichewa; Nyanja	7889	Lithuanian	7684	Tagalog	8476
中文	9072	Luxembourgish;	7666	Tahitian	8489
Chuang; Zhuang	9065	Macedonian	7775	Tajik	8471
Church Slav; Slavonic	6785	Malagasy	7771	Tamil	8465
Chuvash	6786	Magyar	7285	Tatar	8484
Corsican	6779	Malayalam	7776	Telugu	8469
Česky	6783	Maltese	7784	Thai	8472
Dansk	6865	Manx	7186	Tibetan	6679
Deutsch	6869	Maori	7773	Tigrinya	8473
Dzongkha	6890	Marathi	7782	Tonga (Tonga Islands)	8479
English	6978	Marshallese	7772	Tsonga	8483
Esperanto	6979	Moldavian	7779	Tswana	8478
Estonian	6984	Mongolian	7778	Türkçe	8482
Euskara	6985	Nauru	7865	Turkmen	8475
Ελληνικά	6976	Navaho; Navajo	7886	Twi	8487
Faroese	7079	Ndebele, North	7868	Uighur	8571
Français	7082	Ndebele, South	7882	Ukrainian	8575
Frysk	7089	Ndonga	7871	Urdu	8582
Fijian	7074	Nederlands	7876	Uzbek	8590
Gaelic; Scottish Gaelic	7168	Nepali	7869	Vietnamese	8673
Gallegan	7176	Norsk	7879	Volapuk	8679
Georgian	7565	Northern Sami	8369	Walloon	8765
Gikuyu; Kikuyu	7573	North Ndebele	7868	Welsh	6789
Guarani	7178	Norwegian Nynorsk;	7878	Wolof	8779
Gujarati	7185	Occitan; Provençal	7967	Xhosa	8872
Hausa	7265	Old Bulgarian; Old Slavonic	6785	Yiddish	8973
Herero	7290	Oriya	7982	Yoruba	8979
Hindi	7273	Oromo	7977	Zulu	9085
Hiri Motu	7279	Ossetian; Ossetic	7983		
Hrvatski	6779	Pali	8073		
Ido	7379	Panjabi	8065		
Interlingua (International)	7365	Persian	7065		
Interlingue	7365	Polski	8076		
Inuktitut	7385	Português	8084		

## General Information

### Environmental Information

All unnecessary packaging has been omitted. The packaging has been made easy to separate into three materials; cardboard (box), polystyrene foam (buffer) and polyethylene (bags, protective foam sheet).

Your DVD player consists of materials which can be recycled and reused if disassembled by a specialised company. Please observe the local regulations regarding the disposal of packaging materials, exhausted batteries and old equipment.

*(only for model MDV436)*

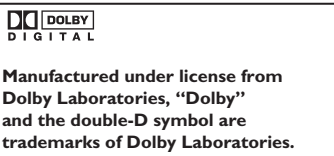

The apparatus shall not be exposed to dripping or splashing and that no objects filled with liquids, such as vases, shall be placed on apparatus.

Due to the inconsistency of disc formats provided by various disc manufacturers, your DVD system may require a playability enhancement or upgrade. As DVD technology advances, these enhancements will become common and will be easy to complete.

### Laser Safety

This unit employs a laser. Due to possible eye injury, only a qualified service person should remove the cover or attempt to service this device.

#### **NOTE:**

**Pictures shown maybe different between countries.**

#### **CAUTION:**

**WARNING LOCATION: ON THE BACKPLATE OF THE SET**

**NEVER MAKE OR CHANGE CONNECTIONS WITH THE POWER SWITCHED ON.**

*This product incorporates copyright protection technology that is protected by method claims of certain U.S. patents and other intellectual property rights owned by Macrovision Corporation and other rights owners. Use of this copyright protection technology must be authorized by Macrovision Corporation, and is intended for home and other limited viewing uses only unless otherwise authorized by Macrovision Corporation. Reverse engineering or disassembly is prohibited.*

**'CONSUMERS SHOULD NOTE THAT NOT ALL HIGH DEFINITION TELEVISION SETS ARE FULLY COMPATIBLE WITH THIS PRODUCT AND MAY CAUSE ARTIFACTS TO BE DISPLAYED IN THE PICTURE. IN CASE OF 525 OR 625 PROGRESSIVE SCAN PICTURE PROBLEMS, IT IS RECOMMENDED THAT THE USER SWITCH THE CONNECTION TO THE 'STANDARD DEFINITION' OUTPUT. IF THERE ARE QUESTIONS REGARDING TV SET COMPATIBILITY WITH THIS MODEL 525p AND 625p DVD PLAYER, PLEASE CONTACT OUR CUSTOMER SERVICE CENTER.'**

## Index

English ..... 6

Français ..... 38

Español ..... 70

English

Français

Español

### ATTENTION

L'utilisation des commandes ou réglages ou le non-respect des procédures ci-incluses peuvent se traduire par une exposition dangereuse à l'irradiation.

### ATENCIÓN

El uso de mando o ajustes o la ejecución de métodos que no sean los aquí descritos puede ocasionar peligro de exposición a radiación.

For Customer Use:  
Read carefully the information located at the bottom or rear of your DVD Video player and enter below the Serial No. Retain this information for future reference.

Model No. MDV 435 & MDV 436  
Serial No. \_\_\_\_\_

### LASER

Type	Semiconductor laser InGaAlP (DVD) AlGaAs (CD)
Wave length	650 nm (DVD) 790 nm (CD)
Output Power	10.0 mW (DVD) 5.0 mW (VCD/CD)
Beam divergence	60 degrees

## Contents

<b>Care and Safety Information</b>	
Setup .....	10
Cleaning discs .....	10
<b>General Information</b>	
Accessories supplied .....	11
Region codes .....	11
<b>Connections</b>	
<b>Connecting to television</b> .....	<b>12~13</b>
Using Composite Video sockets (CVBS) .....	12
Using Component Video sockets (YPbPr) .....	12
Using an accessory RF modulator .....	13
<b>Connecting the power cord</b> .....	<b>13</b>
<b>Optional connections</b>	
<b>Connecting to an stereo system</b> .....	<b>14</b>
Stereo system has Right/Left Audio In sockets .....	14
<b>Connecting to a digital AV receiver</b> .....	<b>14</b>
Receiver has a PCM, Dolby Digital or MPEG decoder .....	14
<b>Product Overview</b>	
<b>Front and Rear panels</b> .....	<b>15</b>
<b>Remote Control</b> .....	<b>16</b>
<b>Getting Started</b>	
<b>Step 1: Inserting Batteries</b> .....	<b>17</b>
Using the remote control to operate the system .....	17
<b>Step 2: Finding your viewing channel</b> .....	<b>17</b>
<b>Step 3: Setting up Progressive Scan feature</b> .....	<b>18</b>
<b>Step 4: Selecting the matching color system</b> .....	<b>19</b>
<b>Step 5: Setting the language</b> .....	<b>20</b>
On-screen display (OSD) language .....	20
Audio, Subtitle and Disc menu languages .....	20
<b>Playback from Disc</b>	
<b>Playable discs</b> .....	<b>21</b>
Supported formats .....	21
<b>Playback Features</b>	
<b>Starting disc playback</b> .....	<b>22</b>
<b>Basic playback control</b> .....	<b>22</b>
Pausing playback .....	22
Selecting title/chapter/track .....	22
Stopping playback .....	22
<b>Operations for video playback (DVD/VCD/SVCD)</b> .....	<b>23</b>
Using the Disc Menu .....	23
Zooming in .....	23
OSD (On-Screen Display) .....	23
<b>Selecting various repeat / shuffle functions</b> .....	<b>24</b>
Repeat play mode .....	24
Repeating a section within a chapter/track .....	24



# Contents

English

<b>Special DVD Features</b> .....	<b>24~25</b>
Playing a Title.....	24
Camera Angle.....	24
Changing the Audio Language.....	25
Subtitle .....	25
<b>Special VCD and SVCD Feature</b> .....	<b>25</b>
Playback Control (PBC) .....	25
<b>Playing a DivX disc (optional)</b> .....	<b>25</b>
<b>Playing MP3/JPEG/Kodak Picture CD</b> .....	<b>26</b>
General Operation .....	26
Playback selection .....	26
Repeat .....	26
<b>DVD Menu Options</b>	
<b>Using the System setup menu</b> .....	<b>27~28</b>
TV System .....	27
TV Type.....	27
Password .....	28
Rating.....	28
Default.....	28
<b>Using the Language setup menu</b> .....	<b>29~30</b>
OSD Language.....	29
Audio, Subtitle and Disc Menu Language.....	29
Setting the DivX Subtitle font (optional).....	30
DivX(R) registration code (optional) .....	30
<b>Using the Audio setup menu</b> .....	<b>30~31</b>
Digital Out .....	30
Down Sample .....	31
Downmix.....	31
<b>Using the Video setup menu</b> .....	<b>32</b>
Video Out.....	32
Brightness / Contrast.....	32
Hue.....	32
Saturation .....	32
Sharpness.....	32
<b>Others</b>	
<b>Specifications</b> .....	<b>33</b>
<b>Troubleshooting</b> .....	<b>34~35</b>
<b>Glossary</b> .....	<b>36</b>
<b>Limited Warranty</b> .....	<b>37</b>

## Care and Safety Information

### DANGER!

**High voltage! Do not open the device. You run the risk of getting an electric shock.**

**The machine does not contain any user-serviceable parts. Please leave all maintenance work to qualified personnel.**

### Setup

#### Finding a suitable location

- Place the set on a flat, hard and stable surface. Do not place the set on a carpet.
- Do not position the set on top of other equipment that might heat it up (e.g., receiver or amplifier).
- Do not put anything under the set (e.g., CDs, magazines).
- Install this unit near the AC outlet and where the AC power plug can be reached easily.

#### Space for ventilation

- Place the apparatus in a location with adequate ventilation to prevent internal heat build up. Allow at least 10 cm (4.0") clearance from the rear and the top of the set and 5cm (2.0") from the left and right to prevent overheating.

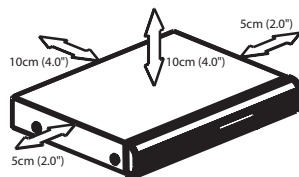

#### Avoid high temperatures, moisture, water and dust

- Apparatus shall not be exposed to dripping or splashing.
- Do not place any sources of danger on the apparatus (e.g., liquid filled objects, lighted candles).

### Cleaning discs

Some problems occur because the disc inside the recorder is dirty (frozen picture, sound disruptions, picture distortions). To avoid these problems, discs should be cleaned on a regular basis.

To clean a disc, use a micro fibre cleaning cloth and wipe the disc from the center to the edge in a straight line.

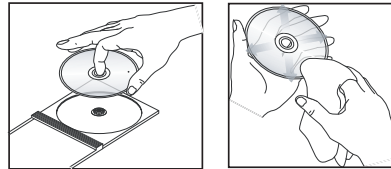

### CAUTION!

Do not use solvents such as benzene, thinner, commercially available cleaners, or anti-static sprays intended for analog discs. Since the optical unit (laser) of the DVD recorder operates at a higher power than regular DVD or CD players, cleaning CDs intended for DVD or CD players may damage the optical unit (laser). Therefore, refrain from using a cleaning CD.

## General Information

### Accessories supplied

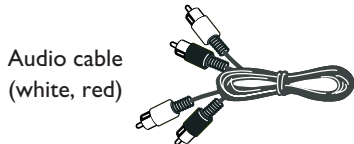

Remote control and two AAA batteries

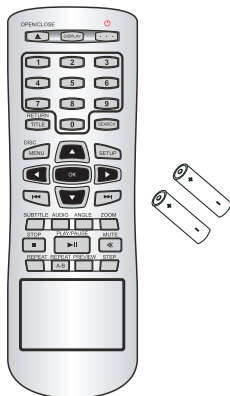

### Region codes

This DVD player is designed to support the Region Management System. Check the regional code number on the disc package. If the number does not match the player's region number (see table below), the player may be unable to playback the disc.

*Tips:*

- It may not be possible to play CD-R/RW or DVD-R/RW in all cases due to the type of disc or condition of the recording.
- If you are having trouble playing a certain disc, remove the disc and try a different one. Improper formatted disc will not played on the DVD player.

Region	Discs that can be played	
U.S.A. and Canada regions		
U.K and Europe regions		
Asia Pacific, Taiwan, Korea		
Australia, New Zealand, Latin America		
Russia and India regions		
China, Calcos Islands, Walls and Futuna Islands		

## Connections

### Connecting to television

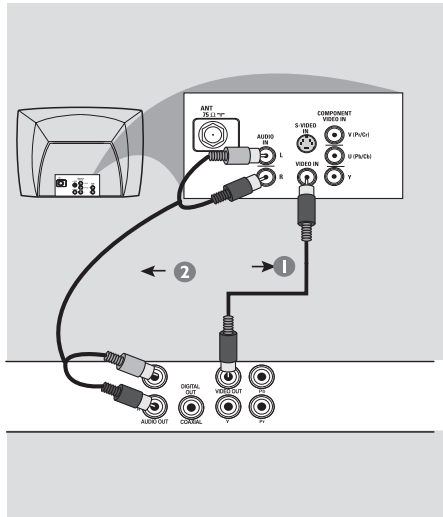

#### IMPORTANT!

- You only need to make one video connection from the following options, depending on the capabilities of your television.
- Connect the DVD player directly to the television.

#### Using Composite Video sockets (CVBS)

- 1 Use the composite video cable (yellow) to connect the DVD player's CVBS (VIDEO) socket to the video input jack (or labeled as A/V In, Video In, Composite or Baseband) on the television (cable supplied).
- 2 To hear sound of this DVD player through your TV, use the audio cables (white/red) to connect AUDIO OUT (L/R) sockets of the DVD player to the corresponding AUDIO IN sockets on the television (cable supplied).

**TIPS:** Before making or changing any connections, make sure that all the devices are disconnected from the power outlet.

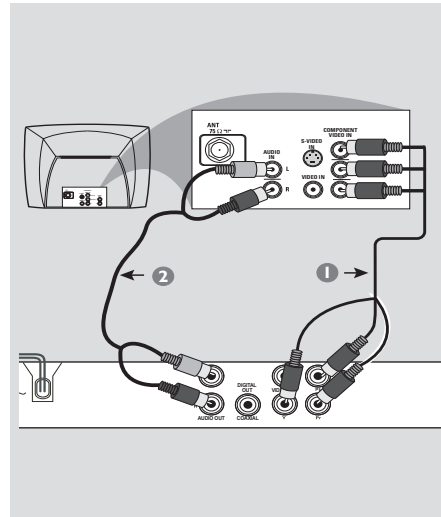

#### IMPORTANT!

- The progressive scan video quality is only possible when using YPbPr and a progressive scan television is required.

#### Using Component Video sockets (YPbPr)

- 1 Use the component video cables (red/blue/green) to connect the DVD player's YPbPr sockets to the component video input sockets (or labeled as YPbPr) on the television (cable not supplied).
- 2 To hear sound of this DVD player through your TV, use the audio cables (white/red) to connect AUDIO OUT (L/R) sockets of the DVD player to the corresponding AUDIO IN sockets on the television (cable supplied).
- 3 Proceed to page 18 for detailed progressive scan setup.

## Connections (continued)

### Connecting the power cord

English

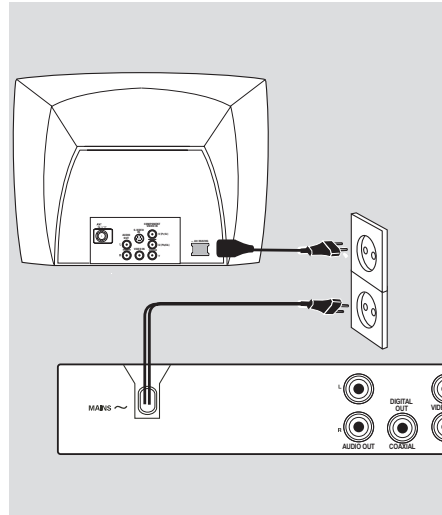
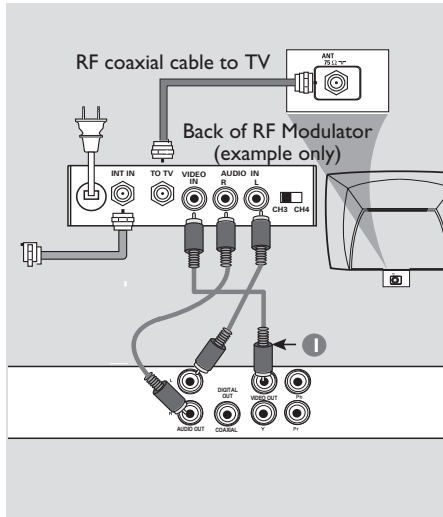

#### IMPORTANT!

– If your television only has a single Antenna In jack (or labeled as 75 ohm or RF In,) you will need an RF modulator in order to view the DVD playback on the television. See your electronics retailer for details on RF modulator availability and operations.

#### Using an accessory RF modulator

- 1 Use the composite video cable (yellow) to connect the DVD player's CVBS jack to the video input jack on the RF modulator.
- 2 Use the RF coaxial cable (not supplied) to connect the RF modulator to your television's RF jack.
- 3 To hear sound of this DVD player through your TV, use the audio cables (white/red) to connect AUDIO OUT (L/R) sockets of the DVD player to the corresponding AUDIO IN sockets on the RF modulator (cable supplied).

**TIPS:** Before making or changing any connections, make sure that all the devices are disconnected from the power outlet.

After everything is connected properly, plug in the AC power cord to the power outlet.

Never make or change any connections with the power switched on.

When no disc is loaded, press **STANDBY ON** on the DVD player front panel. **"NO DISC"** may appear on the display panel.

## Optional connections

### Connecting to an stereo system

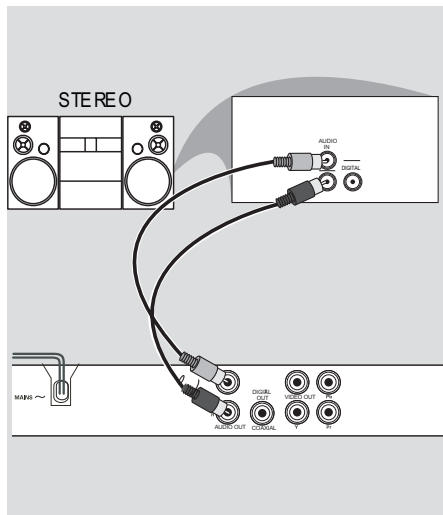

#### Stereo system has right/ left Audio In sockets

- 1 Select one of the video connections (CVBS VIDEO IN, COMPONENT VIDEO IN) depending on the options available on your TV.
- 2 Use the audio cables (white/red) to connect AUDIO OUT (L/R) sockets of the DVD Player to the corresponding AUDIO IN sockets on the stereo system (cable supplied).

### Connecting to a digital AV receiver

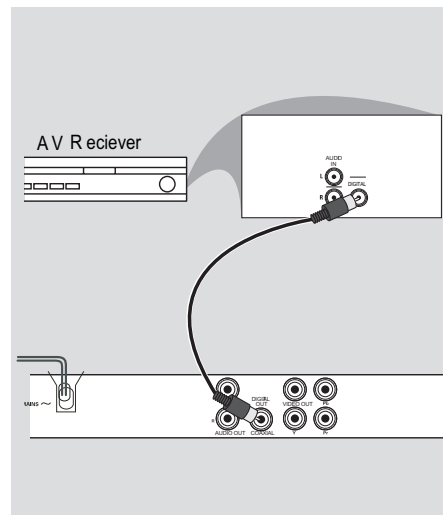

#### Receiver has a PCM, Dolby Digital or MPEG decoder

- 1 Select one of the video connections (CVBS VIDEO IN, COMPONENT VIDEO IN) depending on the options available on your TV.
- 2 Connect the COAXIAL jack of the DVD player to the corresponding Digital Audio In socket on your receiver (cable not supplied).
- 3 Set the DVD player's digital output to PCM or ALL depending on the capabilities of your receiver (see page 30 {Digital Out}).

*Tip:*

– If the audio format of the Digital Output does not match the capabilities of your receiver, the receiver will produce a strong, distorted sound or no sound at all.

**TIPS:** Before making or changing any connections, make sure that all the devices are disconnected from the power outlet.

# Product Overview

English

## Front and Rear Panels

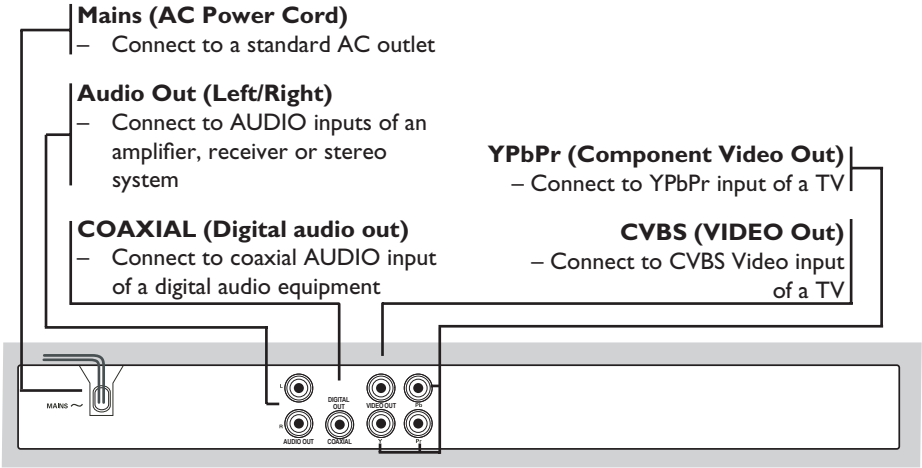
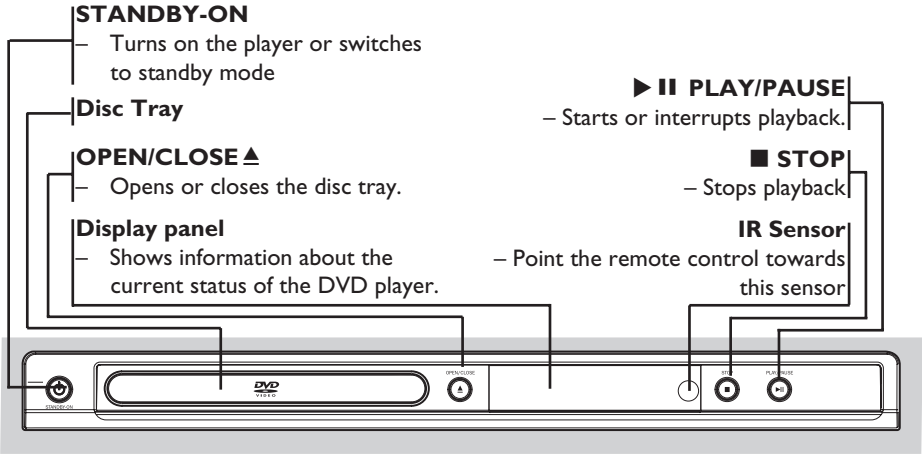

**TIPS:** Before making or changing any connections, make sure that all the devices are disconnected from the power outlet.

## Product Overview (continued)

### Remote Control

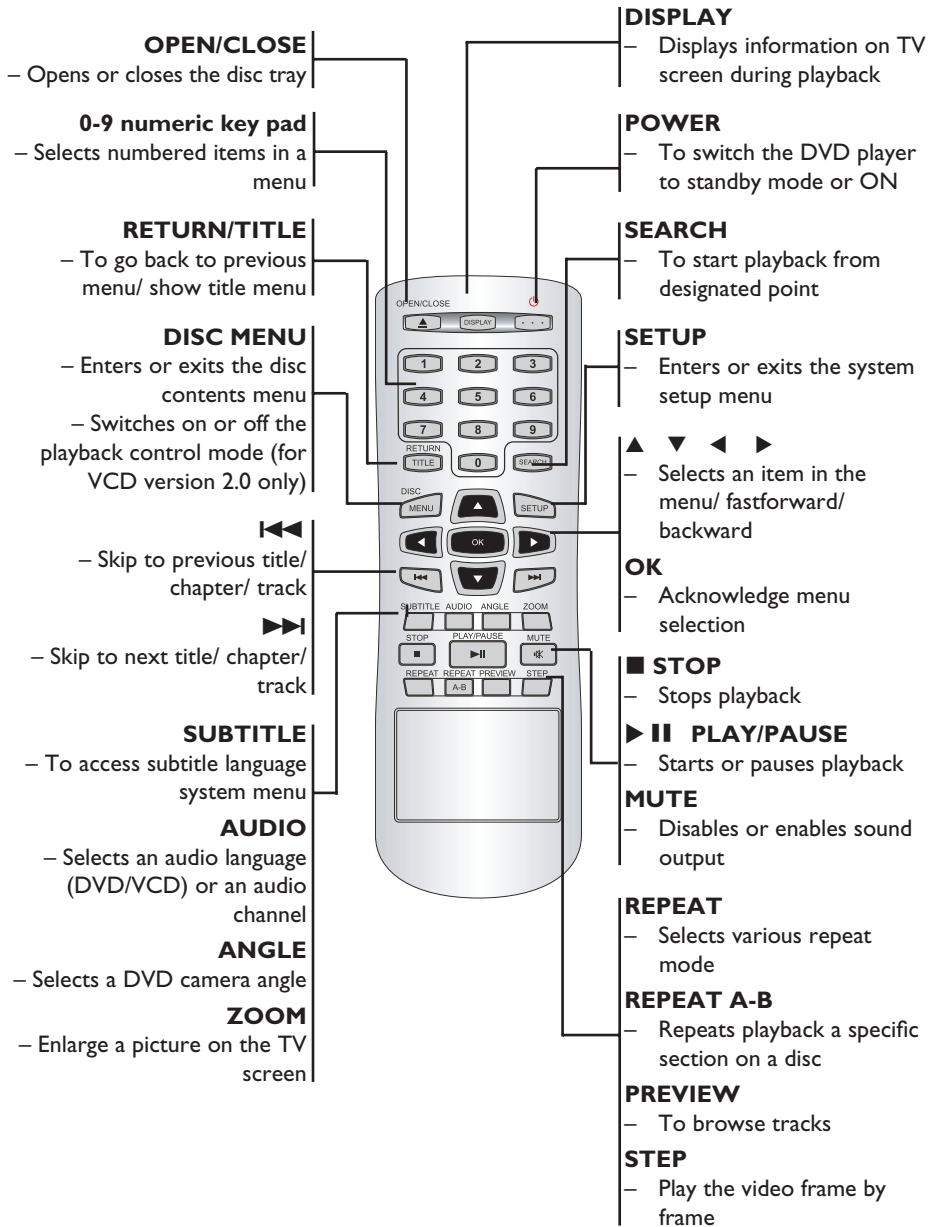



## Getting Started

English

### Step 1 : Inserting Batteries

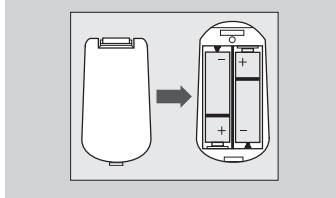

- 1 Open the battery compartment.
- 2 Insert two batteries type R03 or AAA, following the indications (+ -) inside the compartment.
- 3 Close the cover.

#### CAUTION!

- Remove batteries if they are exhausted or if the remote is not to be used for a long time.
- Do not use old and new or different types of batteries in combination.
- Batteries contain chemical substances, so they should be disposed of properly.

### Using the remote control to operate the system

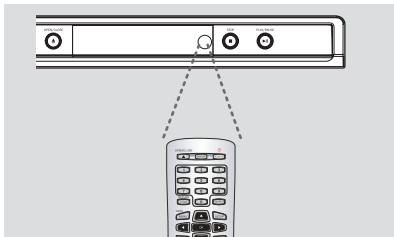

- 1 Aim the remote control directly at the remote sensor (IR) on the front panel.
- 2 Do not put any objects between the remote control and the DVD player while operating the DVD player.

### Step 2 : Finding your viewing channel

- 1 Press **STANDBY-ON**  on the DVD player to turn it on.
- 2 Turn on the TV and set it to the correct video-in channel. You should see the blue DVD background screen.
  - Usually these channel are between the lowest and highest channels and may be called FRONT, A/V IN, VIDEO. See your TV's manual for more details.
  - Or, you may go to channel 1 on your TV, then press the Channel down button repeatedly until you see the Video In channel.
  - Or, the TV remote control may have a button or switch that chooses different video modes.
  - Or, set the TV to channel 3 or 4 if you are using an RF modulator.
- 3 If you are using external equipment, (e.g. audio system or receiver), turn it on and select the appropriate input source for the DVD player output. Refer to the equipment user's manual for detail.

## Getting Started (continued)

### Step 3 : Setting up Progressive Scan feature

(for Progressive Scan TV only)

The progressive scan displays twice the number of frames per seconds than interlaced scanning (ordinary normal TV system). With nearly double the number of lines, progressive scan offers higher picture resolution and quality.

#### Before you start...

- Ensure that you have connected this DVD player to a progressive scan TV using the Y Pb Pr connection (see page 12).
- Ensure that you have completed the basic installation and set-up.

- 1 Turn on your TV and set to interlace mode (refer to your TV user manual).
- 2 Press **POWER** on the remote control to turn on the DVD player.
- 3 Select the correct video-in channel.  
→ The DVD background menu appears.
- 4 Press **SETUP**.
- 5 Press **◀ ▶** to select { **VIDEO SETUP** }.
- 6 Press **▲ ▼** repeatedly to select { **VIDEO OUT** }.

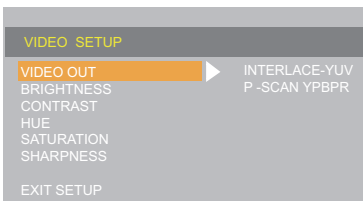

- 7 Press **▶** to select { **P-SCAN YPBPR** }, then press **OK**.  
→ The menu will appear on the TV.

- 8 Press **◀** to select { **OK** } and press **OK** to confirm.

**There will be a distorted picture on the TV at this state until you turn on the progressive scan mode on your TV.**

- 9 Turn on your TV progressive scan mode (refer to your TV user manual).  
→ The menu will appear on the TV.

- 10 Press **◀** to select { **OK** } and press **OK** to confirm.  
→ The setup is now completed and you can start enjoy the high quality picture.

#### To deactivate Progressive Scan manually:

- Wait for 15 seconds for auto recovery.

#### Tip:

– There are some progressive scan TVs and High-Definition TVs that are not fully compatible with this unit, resulting in the unnatural picture when playing back a DVD VIDEO disc in the progressive scan mode. In such a case, turn off the progressive scan feature on both the DVD player and your TV.

**TIPS:** The underlined option is the factory default setting.  
Press **◀** to go back to previous menu item. Press **SETUP** to exit the menu item.



## Getting Started (continued)

### Step 4 : Selecting the matching color system

The color system of the DVD player, disc and TV should match in order for the disc to play. Before changing the TV system, determine the color system of your TV.

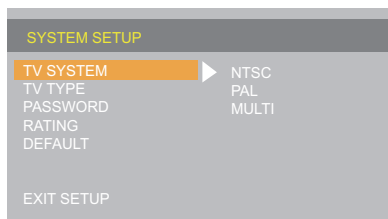

- 1 Press **SETUP**.
- 2 Press **◀ ▶** to select { **SYSTEM SETUP** }.
- 3 Press **▲ ▼** to select { **TV SYSTEM** }, then press **▶**.
- 4 Use **▲ ▼** to select one of the options below:

#### { **PAL** }

Select this if the connected TV has the PAL color system. It will change the video signal of an NTSC disc and output it to PAL format.

#### { **NTSC** }

Select this if the connected TV has the NTSC color system. It will change the video signal of a PAL disc and output it to NTSC format.

#### { **MULTI** }

Select this if the connected TV is compatible with both NTSC and PAL (multi-system). The output format will be in accordance with the video signal of the disc.

- 5 Select an item and press **OK**.

#### Tip:

– Before changing the current TV color setting, ensure that your TV supports the 'selected TV System'.

**CHANGING PAL TO NTSC:**  
 1. ENSURE THAT YOUR TV SUPPORTS NTSC STANDARD.  
 2. IF THERE IS DISTORTED PICTURE DISPLAY ON THE TV  
 WAIT 15S FOR AUTO RECOVERY.

**OK** **NO**

**CONFIRM AGAIN TO USE NEW TV TYPE SETTING.**  
 PLEASE WAIT 15 S

**OK** **NO**



**TIPS:** The underlined option is the factory default setting.  
 Press **◀** to go back to previous menu item. Press **SETUP** to exit the menu item.



## Getting Started (continued)

### Step 5 : Setting the language

The language options are different depending on your country or region. It may not correspond to the illustrations shown on the user manual.

#### On-screen display (OSD) language

Select this to change the language of this DVD player screen display menu.

The menu language (on-screen display) for the system will remain as you set it.

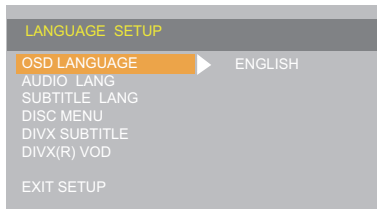

- 1 Press **SETUP**.
- 2 Press **◀ ▶** to select { **LANGUAGE SETUP** }.
- 3 Press **▲ ▼** to highlight { **OSD LANGUAGE** }, then press **▶**.
- 4 Use **▲ ▼** to select a language and press **OK**.

#### Audio, Subtitle and Disc menu languages

You can choose your preferred language or soundtrack from audio, subtitles and DVD menu languages. If the selected language is not available on the disc, the disc's default language will be used instead.

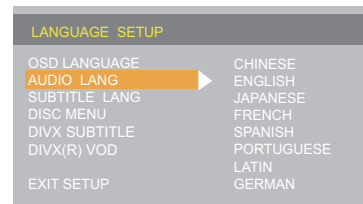

- 1 Press **SETUP**.
- 2 Press **◀ ▶** to select { **LANGUAGE SETUP** }.
- 3 Press **▲ ▼** to highlight one of the options below, then press **▶**.
  - { **AUDIO LANG** }  
Select this to change disc soundtrack language.
  - { **SUBTITLE LANG** }  
Select this to change the subtitle language.
  - { **DISC MENU** }  
Select this to change the language of the disc menu.
- 4 Use **▲ ▼** to select a language and press **OK** to confirm.
- 5 Repeat steps 3 - 4 for other language settings.

#### Tip:

– Audio Lang and Subtitle Lang can only be activated during disc ejecting or no disc mode.

**Tip:** DivX is an option for certain models only.

**TIPS:** The underlined option is the factory default setting.  
Press **◀** to go back to previous menu item. Press **SETUP** to exit the menu item.

## Playback from Disc

### IMPORTANT!

- If the **INVALID ENTRY** appears on the TV screen when a button is pressed, it means the function is not available on the current disc or at the current time.
- DVD discs and players are designed with regional restrictions. Before playing a disc, make sure the disc is for the same zone as your player.

### Playable discs

Using this DVD player, you can playback on the following discs:

**DVD Video** (Digital Versatile Disc)



**DVD±RW** (DVD Rewritable) Audio/Video format or MP3/JPEG/DivX files.



**DVD±R** (DVD Recordable) Audio/Video format or MP3/JPEG/DivX files.



**CD-R** (CD-Recordable) Audio/Video format or MP3/JPEG/DivX files.



**CD-RW** (CD-Rewritable) Audio/Video format or MP3/JPEG/DivX files.



**Audio CD** (Compact Disc Digital Audio)



**Video CD**  
(Formats 1.0, 1.1, 2.0)



**Super Video CD**



**MP3-Disc**



**DivX Disc**  
(DivX 3.11, 4.x, 5.x and 6.x)



### Supported formats

#### MP3 tracks

- The file extensions has to be '.mp3.'
- JPEG/ISO format
- Maximum 10 characters display.
- Supported sampling frequencies;  
(MPEG-1) 32kHz, 44.1kHz, 48kHz  
(MPEG-2) 16kHz, 22.05kHz, 24kHz
- Supported bit-rates;  
(MPEG-1) 32 ~ 256 kbps  
(MPEG-2) 16 ~ 160 kbps

#### JPEG pictures

- The file extensions has to be to be '.JPG' and not '.JPEG.'
- JPEG/ISO format
- It can only display DCF-standard still pictures or JPEG pictures e.g. TIFF.

#### DivX movies

- The file extensions has to be to be '.AVI,' '.MPG,' or '.MPEG.'
- DivX 3.11, 4.x and 5.x
- Q-pel accurate motion compensation
- Global Motion Compensation (GMC) playback.

**Tip:** DivX is an option for certain models only.

**TIPS:** Some discs cannot be played on this DVD player due to the configuration and characteristics of the disc, or due to the condition of recording and authoring software that was used.

## Playback Features

### Starting disc playback

- 1 Turn on the TV to the correct programme number for the DVD player (e.g. 'EXT', '0', 'AV').
- 2 Press **STANDBY-ON** to turn on the DVD player.
- 3 Press **OPEN/CLOSE** on the front of the DVD player.
- 4 Place a disc into the disc tray with the label facing up, then press **OPEN CLOSE ▲**.  
→ For double-sided discs, load the side which you want to play facing up.
- 5 Playback may start automatically. If not, press **PLAY/PAUSE ► II**.
- If a disc menu appears on the TV, see page 23 'Using the Disc Menu'.
- If the child lock was activated for the inserted disc, you have to enter your four-digit password (see page 28).
- For more playback features, see pages 22~25.

### Basic playback controls

Unless otherwise stated, all operations described are based on Remote Control use.

#### Pausing playback

- 1 During playback, press **PLAY/PAUSE ► II** to pause playback and display a still picture.  
→ Sound will be muted.
- 3 To resume normal playback, press **PLAY/PAUSE ► II** again.

#### Selecting title/chapter/track

- Press **◀◀ / ▶▶** to go to the previous or next title/chapter/track.
- In STOP mode, press **DISPLAY** to display the disc information text line for title/chapter/track (example - 00/08).
- Use **alphanumeric keypad (0-9)** to enter valid title/chapter/track number.  
→ The playback skips to the selected title/chapter/track.

#### Stopping playback

- Press **STOP ■**.

#### Tips:

- Screen saver will start automatically if the disc playback is stopped for 5 minutes.
- The player will automatically switch to Power Standby mode if you do not press any buttons for 10 minutes after the disc has stopped playing.

**TIPS:** The operating features described here might not be possible for certain discs. Always refer to the instructions supplied with the discs.

## Playback Features (continued)

### Operations for video playback (DVD/VCD/SVCD)

#### Using the Disc Menu

Depending on the disc, a menu may appear on the TV screen once you load in the disc.

#### To select a playback feature or item

- Use ▲ ▼ ◀ ▶ keys or numeric keypad (0-9) on the remote, then press **OK** to start playback.

#### To access or remove the menu

- Press **DISC MENU** on the remote.

#### Zooming in

This function allows you to enlarge the picture on the TV screen and to pan through the enlarged picture.

- 1 During playback, press **ZOOM** repeatedly to display the picture with different scales.
  - Use ▲ ▼ ◀ ▶ keys to pan through the enlarged picture.
  - Playback will continue.
- 2 Press **ZOOM** repeatedly to return to the original size.

#### OSD (On-Screen Display)

This function display disc information on the TV screen during playback.

- 1 During playback, press **DISPLAY** repeatedly.
  - A list of available current disc information appears on the TV screen.
- 2 Press **SEARCH**, then use ◀ ▶ keys to select an option.

Enter hours, minutes and seconds from left to right in the time edit box using remote control numerical key pad.

Playback will change to the chosen time or to the selected title/ chapter/ track.

#### For DVD

- {TT XX/03 CH XXX/010}: displays the total available title and chapters in the disc and enable to select a chapter for viewing.
- {⊕ XX:XX:XX} displays the total available title in the disc and enable to select the hour, minute and second of the title.

#### For Super VCD or VCD

- {⊕ XX:XX:XX}: enable to select any part within the disc.
- {TRK XX/XX}: enable to select any track.

**TIPS:** The operating features described here might not be possible for certain discs. Always refer to the instructions supplied with the discs.

## Playback Features (continued)

### Selecting various repeat/shuffle functions

#### Repeat play mode

The repeat play options vary depending on the disc type.

- 1 While playing a disc, press **REPEAT** continuously to choose a repeat options.

#### **CHAPTER** (DVD)

- to repeat playback of the current chapter.

#### **REP I** (CD/ SVCD/ VCD) / **TITLE** (DVD)

- to repeat playback of the current track (CD/ SVCD/ VCD) / title.

#### **REP ALL**

- to repeat playback of the disc.

#### **RANDOM** (CD/ VCD)

- the tracks and chapters being played in random order.

#### **OFF**

- to cancel the repeat mode.

- 2 Press **REPEAT** repeatedly to cancel the repeat mode.

#### Tip:

- For VCD, repeat playback is not possible if the PBC mode is switched on.

### Repeating a section within a chapter/track

You can repeat the playback of a specific segment within a title/chapter track. To do this, you must mark the start and end of the segment you want.

- 1 While playing a disc, press **REPEAT A-B** at your chosen starting point.
- 2 Press **REPEAT A-B** again at your chosen end point.
  - The section A and B can be set only within the same chapter/track.
  - The section will now repeat continuously.
- 3 To exit the sequence, press **REPEAT A-B**.

### Special DVD Features

#### Playing a Title

- 1 Press **DISC MENU**.
  - The disc title menu appears on the TV screen.
- 2 Use **▲ ▼ ◀ ▶** keys or **alphanumeric keypad 0-9** to select a play option.
- 3 Press **OK** key to confirm.

#### Camera Angle

- Press **ANGLE** repeatedly to select different desired angle.

**TIPS:** The operating features described here might not be possible for certain discs. Always refer to the instructions supplied with the discs.



## Playback Features (continued)

### Changing the Audio Language

#### For DVD

- Press **AUDIO** repeatedly to select different audio languages.

#### Changing the Audio Channel For VCD

- Press **AUDIO** to select the available audio channels provided by the disc (MONOL, MONOR, STEREO).

### Subtitles

- Press **SUBTITLE** repeatedly to select different subtitle languages.

### Special VCD and SVCD Feature

#### Playback Control (PBC)

##### For VCD with Playback Control (PBC) feature (version 2.0 only)

- Press **DISC MENU** to toggle between 'PBC ON' and 'PBC OFF'.
  - If you select 'PBC ON', the disc menu (if available) will appear on the TV.
  - Use the **◀◀ / ▶▶** or the **alphanumeric keypad 0-9** to select a play option.
- During playback, pressing **RETURN/TITLE** will return to the menu screen (if PBC is on).

##### If you want to skip the index menu and playback directly from the beginning,

- Press **DISC MENU** key on the remote control to switch to PBC off.

### Playing a DivX disc (optional)

This DVD player supports the DivX movie playback that you download from your computer onto a CD-R/RW or DVD±R/RW.

- 1 Load a DivX disc.
  - 2 Press **SUBTITLE** on the remote control will turn on or off the subtitle.
- If multilingual subtitles are embedded on the DivX disc, pressing **SUBTITLE** will change the subtitle language during playback.

#### Tips:

- Subtitle files with the following filename extensions (.srt, .smi, .sub, .ssa, .txt) are supported but do not appear on the file navigation menu.
- The subtitle filename have to be the same as the filename of the movie.

English

**Tip:** DivX is an option for certain models only.

**TIPS:** The operating features described here might not be possible for certain discs. Always refer to the instructions supplied with the discs.

## Playback Features (continued)

### Playing MP3/JPEG/Kodak Picture CD

#### IMPORTANT!

You have to turn on your TV and set to the correct Video In channel. (See page 17 'Finding your viewing channel').

- Load a picture disc (Kodak Picture CD, JPEG)
    - For Kodak disc, the slide show will begin.
    - For JPEG disc, the picture menu appears on the TV screen.
- Press **PLAY/PAUSE ► II** to start the slide-show playback.

#### General Operation

- 1 Load a MP3/JPEG Picture CD disc.
  - The data disc menu appears on the TV screen
- 2 Press ▲▼ to select the folder and press **OK** to open the folder, then press ►.



- 3 Press ▲▼ or use the numeric keypad (0-9) to highlight an option.
  - 4 Press **OK** to confirm.
    - Playback will start from the selected file to the end of the folder.
- MP3 track will automatically playback if a disc contains music and picture is loaded.
  - To play JPEG file, press ► repeatedly to highlight the photo icon and press **OK** to confirm.

**TIPS:** The operating features described here might not be possible for certain discs. Always refer to the instructions supplied with the discs.

#### Playback selection

During playback, you can;

- Press **◀◀ / ▶▶** to select another track/file in the current folder.
- Press **PLAY/PAUSE ► II** repeatedly to pause/resume playback.

#### Repeat

- Press **REPEAT** continuously to access different 'Play Mode'.

#### REPEAT I

– keep a JPEG image still on the screen or play an MP3 file repeatedly.

#### REPEAT DIR

– play all files in the selected folder repeatedly.

#### REPEAT ALL

– play all files in the discs.

#### RANDOM

– to repeat playback in random order.

#### OFF

– turn off REPEAT Mode.

## DVD Menu Options

This DVD Player setup is carried out via the TV, enabling you to customise the DVD player to suit your particular requirement.

### Using the System Setup menu

- 1 In disc mode, press **SETUP**.
- 2 Press **◀▶** to select { **SYSTEM SETUP** }.

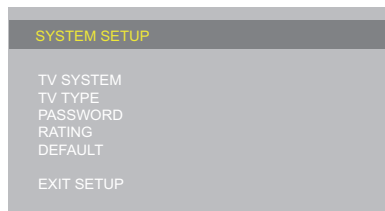

### TV System

This menu contains the options for selecting the color system that matches the connected TV. For details, see page 15.

### TV Type

Set the TV TYPE of the DVD player according to the TV you have connected. The format you select must be available on the disc. If it is not, the setting for TV display will not affect the picture during playback.

- 1 In 'System Setup', press **▲▼** to select { **TV TYPE** }, then press **▶**.
- 2 Press **▲▼** to highlight one of the options below:

#### { **4.3 PANSKAN** }

Select this if you have a normal TV and want both sides of the picture to be trimmed or formatted to fit your TV screen.

#### { **4.3 LETTER BOX** }

Select this if you have a normal TV. In this case a wide picture with black bands on the upper and lower portions of the TV screen will be displayed.

#### { **16:9** }

Select this if you have a wide screen TV.

- 3 Select an item and press **OK**.

**TIPS:** The underlined option is the factory default setting.  
Press **◀** to go back to previous menu item. Press **SETUP** to exit the menu item.

## DVD Menu Options (continued)

### Password

You need to enter the four-digit password to play a prohibited disc or if prompted for a password. If the disc is locked, set the Rating to (8 Adult) to have all disc play.

- 1 In 'System Setup', press ▲ ▼ to select { **PASSWORD** }, then press **OK**.  
→ You will be prompted to enter your four-digit password.
- 2 Use the **numeric keypad (0-9)** to enter your default four-digit password.  
→ When doing this for the first time, key in '0000'.
- If you forget your old four-digit password, key in '0000'.
- 3 Enter the new four-digit password.
- 4 Press **OK** to confirm.

### Rating

This feature lets you set a playback limitation level. The rating levels are from 1 to 8 and are country dependent. You can prohibit the playing of certain discs that are not suitable for your children or have certain discs played with alternative scenes.

- Unlock the disc by entering the four-digit password before you can access into the {RATING} menu.
- 1 In 'System Setup' press ▲▼ to highlight { **RATING** }, then press ►.
- 2 Press ▲▼ to highlight a rating level for the disc inserted and press **OK**.  
→ To disable parental controls and have all Disc play, select 8 { **Adult** }.
- 3 Use the **numeric keypad (0-9)** to enter the four-digit password (see page 28 "Password").
- DVDs that are rated above the level you selected will not play unless you enter your four-digit password.

#### Tips:

- This feature will not limit viewing if the disc manufacturer did not code the disc.
- VCD, SVCD, CD have no level indication, so parental control has no effect on these type of discs. This also applies to most illegal DVDs.
- Some DVDs are not coded with a rating though the movie rating may be printed on the disc cover. The rating level feature does not prohibit play of such discs.

**TIPS:** The underlined option is the factory default setting.  
Press ◀ to go back to previous menu item. Press **SETUP** to exit the menu item.

## DVD Menu Options (continued)

### Default

Setting the DEFAULT function will reset all options and your personal settings to the factory defaults, except your password for rating.

- 1 In 'System Setup' menu, press ▲▼ to highlight { **DEFAULT** }, then press ► to select { **RESTORE** }.
- 3 Press **OK** to confirm.  
→ All settings will now reset to factory defaults.

### Using the Language setup menu

- 1 In disc mode, press **SETUP**.
- 2 Press ◀▶ select { **LANGUAGE SETUP** }.

### OSD Language

This menu contains various language options for the language displayed on the screen. For details, see page 20.

### Subtitle/Audio/Disc Menu Language

These menus contain various language options for audio, subtitle and disc menu which may be recorded on the DVD. For details, see page 20.

English

**TIPS:** The underlined option is the factory default setting.  
Press ◀ to go back to previous menu item. Press **SETUP** to exit the menu item.

## DVD Menu Options (continued)

### Setting the DivX subtitle font (optional)

You can set the font type that supports the recorded DivX subtitle.

- 1 In 'Language Setup', press ▲ ▼ to select { **DIVX SUBTITLE** }, then press ►.

#### { **STANDARD** }

Albanian, Danish, Dutch, English, Finnish, French, Gaelic, German, Italian, Kurdish (Latin), Norwegian, Portuguese, Spanish, and Swedish.

- 2 Press ▲ ▼ to select a setting, then press **OK** to confirm your selection.

### DivX(R) registration code (optional)

DivX® VOD (Video On Demand) registration code allows you to rent and purchase movies using the DivX® VOD service from the internet.

For more information, visit website; <http://vod.divx.com>

- 1 In 'Language Setup', press ▲ ▼ to select { **DIVX(R) VOD** }.  
→ The registration code will appear.
- 2 Use the registration code to rent or purchase the movies from DivX® VOD service at <http://vod.divx.com>  
→ Follow the instructions and download the movie from your computer onto a CD-R/RW for playback on this DVD player.

#### Tip:

– All the downloaded movies from DivX® VOD can only be played back on this DVD player.

## Using the Audio setup menu

- 1 In disc mode, press **SETUP**.
- 2 Press ◀ ▶ select { **AUDIO SETUP** }.



### Digital Out

The options included in 'Digital Out' are: {ALL}, {PCM}.

- 1 In 'Audio Setup', press ▲ ▼ to highlight { **DIGITAL OUT** }, then press ►.

#### { **ALL** }

Select this if the connected device has a built-in multichannel decoder that supports one of the multichannel audio format (Dolby Digital, MPEG-2).

#### { **PCM** }

Select this if the connected device is not capable of decoding multichannel audio. The DVD player will convert the Dolby Digital and MPEG-2 multichannel signals to PCM (Pulse Code Modulation).

- 2 Press ▲ ▼ to select a setting, then press **OK** to confirm your selection.

**Tip:** DivX is an option for certain models only.

**TIPS:** The underlined option is the factory default setting.  
Press ◀ to go back to previous menu item. Press **SETUP** to exit the menu item.

## DVD Menu Options (continued)

### Down Sample

You can enable and disable the digital signal for better sound output quality.

- 1 In 'Audio Setup', press ▲▼ to highlight { **DOWN SAMPLE** }, then press ►.

{ 48K }

Playback a disc recorded at the sampling rate of 48kHz.

{ **96K** }

Playback a disc recorded at the sampling rate of 96kHz. This rate can only be achieved in Stereo-Classic (Flat) mode.

- 2 Press ▲▼ to select a setting, then press **OK** to confirm your selection.

### Downmix

This option allows you to set the stereo analog output of your DVD Player.

- 1 In 'Audio Setup', press ▲▼ to highlight { **DOWNMIX** }, then press ►.

{ LT/RT }

Select this option if your DVD Player is connected to a Dolby decoder.

{ **STEREO** }

Select this to change channel output to stereo which delivers sound from only the two front speakers.

{ **VSURR** }

Allows the DVD player to use virtual surround sound effects.

- 2 Press ▲▼ to select a setting, then press **OK** to confirm your selection

English

**TIPS:** The underlined option is the factory default setting.  
Press ◀ to go back to previous menu item. Press **SETUP** to exit the menu item.

## DVD Menu Options (continued)

### Using the Video setup menu

- 1 In disc mode, press **SETUP**.
- 2 Press **◀ ▶** select { **VIDEO SETUP** }.

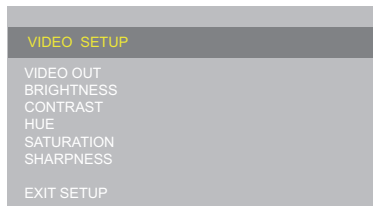

#### Video Out

- 1 In 'Video Setup', press **▲ ▼** to select { **VIDEO OUT** }, then press **▶**.
- 2 Press **▲ ▼** to highlight one of the options below,
  - { **INTERLACE - YUV** }
  - use component video cables (Y/Pb/Pr) to connect the appliance to the TV set, and the TV set is set to INTERLACE - YUV.
  - { **P-SCAN YPBPR** }
  - use component video cables (Y/Pb/Pr) to connect the appliance to the TV set, and the TV set is set to progressive scan.
- 2 Press **▲ ▼** to select a setting and press **OK** to confirm.

#### Brightness/ Contrast

Increasing the value will brighten the picture or vice versa. Choose six (6) for average setting.

- 1 In 'Video Setup', press **▲ ▼** to highlight { **BRIGHTNESS** } or { **CONTRAST** }, then press **▶**.
  - The menu appears.
- 2 Press **▲ ▼** to adjust the setting that best suit your personal preference.
- 3 Press **OK** to confirm.

#### Hue

Use cursor buttons **▲ ▼** to move the slider to adjust the hue of the video output.

#### Saturation

Use cursor buttons **▲ ▼** to move the slider to adjust the saturation of the video output.

#### Sharpness

You can personalize your picture color by adjusting sharpness.

- 1 In 'Video Setup', press **▲ ▼** to highlight { **SHARPNESS** } then press **▶**.
- 2 Press **▲ ▼** to select a setting, then press **OK** to confirm your selection.

**TIPS:** The underlined option is the factory default setting.  
Press **◀** to go back to previous menu item. Press **SETUP** to exit the menu item.



# Specifications

English

## TV STANDARD (PAL/50Hz) (NTSC/60Hz)

Number of lines	625	525
Playback	Multistandard (PAL/NTSC)	

## VIDEO PERFORMANCE

Video DAC	10 bit, 108mHz	
YPbPr	0.7 Vpp ~ 75 ohm	
Video Output	1Vpp ~ 75 ohm	

## VIDEO FORMAT

Digital	MPEG 2 for DVD,SVCD	
Compression	MPEG 1 for VCD DivX	

<b>DVD</b>	<b>50Hz</b>	<b>60Hz</b>
Horiz. resolution	720 pixels	720 pixels
Vertical resolution	576 lines	480 lines

<b>VCD</b>	<b>50Hz</b>	<b>60Hz</b>
Horiz. resolution	352 pixels	352 pixels
Vertical resolution	288 lines	240 lines

## AUDIO FORMAT

Digital	MPEG/ AC-3/ PCM	compressed Digital 16, 20, 24 bits fs, 44.1, 48, 96 kHz
	MP3(ISO 9660)	96, 112, 128, 256 kbps & variable bit rate fs, 32, 44.1, 48 kHz

Analog Sound Stereo  
Dolby Surround compatible downmix from Dolby  
Digital multi-channel sound

## AUDIO PERFORMANCE

DA Converter	24 bit, 192 kHz	
DVD	fs 96 kHz	4Hz- 44kHz
	fs 48 kHz	4Hz- 22kHz
SVCD	fs 48 kHz	4Hz- 22kHz
	fs 44.1kHz	4Hz- 20kHz
CD/VCD	fs 44.1kHz	4Hz- 20kHz
Signal-Noise (1kHz)	> 95 dB	
Dynamic range(1kHz)	> 85 dB	
Crosstalk (1kHz)	> 85 dB	
Distortion/noise (1kHz)	> 75 dB	
MPEG MP3	MPEG Audio L3	

## CONNECTIONS

YPbPr Output	Cinch 3x
Video Output	Cinch (yellow)
Audio Output(L+R)	Cinch (white/red)
Digital Output	1 coaxial IEC60958 for CDDA / LPCM IEC61937 for MPEG 1/2, Dolby Digital

## CABINET

Dimensions (w x h x d)	360 x 37 x 235 mm
Weight	Approximately 2.88 kg

## POWER CONSUMPTION

Power Supply Rating	120V; 60Hz
Power consumption	< 10 W
Power consumption in Standby mode	< 1 W

## Troubleshooting

### WARNING

Under no circumstances should you try to repair the system yourself, as this will invalidate the warranty. Do not open the system as there is a risk of electric shock.

If a fault occurs, first check the points listed below before taking the system for repair. If you are unable to remedy a problem by following these hints, consult your dealer for help.

Problem	Solution
<b>No power.</b>	<ul style="list-style-type: none"> <li>– Press STANDBY-ON button on the front of the DVD player to switch on the system.</li> <li>– Make sure the AC outlet has power.</li> </ul>
<b>Remote control does not work.</b>	<ul style="list-style-type: none"> <li>– Aim the remote control directly at the sensor on the front of the DVD player (not towards TV).</li> <li>– Remove any obstacles between DVD player and the remote control.</li> <li>– Batteries are weak, replace the batteries.</li> <li>– Check the polarities of the batteries are as indicated on the remote control (± signs).</li> </ul>
<b>No picture.</b>	<ul style="list-style-type: none"> <li>– Switch on your TV and set to the correct Video In channel for the DVD player. You may go to Channel 1 on your TV, then press the channel down button on your TV's remote control until you see the TV programme.</li> <li>– Check the video connection between the DVD player and the TV.</li> </ul>
<b>The picture is distorted or black &amp; white during playback.</b>	<ul style="list-style-type: none"> <li>– The disc does not match with the TV color system standard (PAL/NTSC).</li> <li>– The disc is dirty, clean the disc.</li> <li>– Sometimes a small amount of picture distortion may appear. This is not a malfunction.</li> <li>– To deactivate progressive scan function manually;               <ol style="list-style-type: none"> <li>1) Turn off your TV progressive scan mode (or set to interlace mode)</li> <li>2) Press OPEN/CLOSE to open the DVD player disc tray.</li> </ol> </li> </ul>
<b>No sound.</b>	<ul style="list-style-type: none"> <li>– Check the audio connections, the red and white jacks are connected correctly.</li> <li>– Set the Digital output correctly, based on the equipment you connected to the DVD player.</li> </ul>
<b>Disc does not play.</b>	<ul style="list-style-type: none"> <li>– Insert the disc with the label facing up.</li> <li>– Wrong region code.</li> <li>– Wrong disc type. Read chapter "Playback - Playable discs" for details.</li> <li>– Make sure the disc is not scratched or warped. Clean the disc or replace a new one.</li> <li>– Check if the disc is defective by trying another disc.</li> </ul>
<b>The aspect ratio of the screen cannot be changed.</b>	<ul style="list-style-type: none"> <li>– The aspect ratio is fixed on the DVD disc.</li> <li>– Depending on the TV, it may not be possible to change the aspect ratio.</li> </ul>

**Tip:** DivX is an option for certain models only.



## Troubleshooting (continued)

Problem	Solution
<b>Not able to select some items in the setup/system menu.</b>	<ul style="list-style-type: none"> <li>- Press STOP button twice before selecting the setup/system menu.</li> <li>- Depending on the disc availability, some menu items cannot be selected.</li> </ul>
<b>The DVD player does not start playback.</b>	<ul style="list-style-type: none"> <li>- Insert a readable disc with the playback side facing down.</li> <li>- Check the disc type, color system (PAL/NTSC) and region code.</li> <li>- Check for any scratches or smudges on the disc.</li> <li>- Press SETUP to turn off the setup menu screen.</li> <li>- You may need to enter the password in order to change the parental rating level or to unlock the disc for playback.</li> <li>- Moisture may have condensed inside the system. Remove the disc and leave the system turned on for about an hour.</li> <li>- Disconnect the power cord from the power outlet for a few minutes. Reconnect the power cord and try to operate again as usual.</li> </ul>
<b>Picture freezes momentarily during playback.</b>	<ul style="list-style-type: none"> <li>- Check the disc for fingerprint/scratches and clean with a soft cloth wiping from center to edge.</li> </ul>
<b>Unable to select Progressive Scan on/off.</b>	<ul style="list-style-type: none"> <li>- Check that the output of the video signal is switch to { YPbPr }.</li> </ul>
<b>Unable to play DivX movies.</b>	<ul style="list-style-type: none"> <li>- Check that the DivX file is encoded in 'Home Theatre' mode with DivX 6.0 encoder.</li> <li>- Check that the DivX movie downloaded is a complete file.</li> </ul>
<b>No sound during DivX movies playback.</b>	<ul style="list-style-type: none"> <li>- The audio codec may not be supported by this DVD player.</li> </ul>
<b>An DivX movies does not repeat.</b>	<ul style="list-style-type: none"> <li>- Check that file size of the movie does not exceed the file size of the disc during downloading.</li> </ul>

**Tip:** DivX is an option for certain models only.

English



## Glossary

**Analog:** Sound that has not been turned into numbers. Analog sound varies, while digital sound has specific numerical values. These jacks send audio through two channels, the left and right.

**Aspect ratio:** The ratio of vertical and horizontal sizes of a displayed image. The horizontal vs. vertical ratio of conventional TVs. is 4:3, and that of wide-screens is 16:9.

**AUDIO OUT Jacks:** Jacks on the back of the DVD System that send audio to another system (TV, Stereo, etc.).

**Bit Rate:** The amount of data used to hold a given length of music; measured in kilobits per seconds, or kbps. Or, the speed at which you record. Generally, the higher the bit rate, or the higher the recording speed, the better the sound quality. However, higher bit rates use more space on a Disc.

**Chapter:** Sections of a picture or a music piece on a DVD that are smaller than titles. A title is composed of several chapters. Each chapter is assigned a chapter number enabling you to locate the chapter you want.

**Component Video Out Jacks:** Jacks on the back of the DVD System that send high-quality video to a TV that has Component Video In jacks (R/G/B, Y/Pb/Pr, etc.).

**Disc menu:** A screen display prepared for allowing selection of images, sounds, subtitles, multi-angles, etc recorded on a DVD.

**Digital:** Sound that has been converted into numerical values. Digital sound is available when you use the DIGITAL AUDIO OUT COAXIAL or OPTICAL jacks. These jacks send audio through multiple channels, instead of just two channels as analog does.

**DivX 3.11/4.x/5.x/6.x:** The DivX codec is a patent-pending, MPEG-4 based video compression technology, developed by DivXNetworks, Inc., that can shrink digital video to sizes small enough to be transported over the internet, while maintaining high visual quality.

**Dolby Digital:** A surround sound system developed by Dolby Laboratories containing up to six channels of digital audio (front left and right, surround left and right, center and subwoofer).

**JPEG:** A very common digital still picture format. A still-picture data compression system proposed by the Joint Photographic Expert Group, which features small decrease in image quality in spite of its high compression ratio.

**MP3:** A file format with a sound data compression system. MP3 is the abbreviation of Motion Picture Experts Group 1 (or MPEG-1) Audio Layer 3. By using MP3 format, one CD-R or CD-RW can contain about 10 times as much data volume as a regular CD can.

**Multichannel:** DVD is specified to have each sound track constitute one sound field. Multichannel refers to a structure of sound tracks having three or more channels.

**Parental Control:** A function of the DVD to limit playback of the disc by the age of the users according to the limitation level in each country. The limitation varies from disc to disc; when it is activated, playback will be prohibited if the software's level is higher than the user-set level.

**PCM (Pulse Code Modulation):** A system for converting analog sound signal to digital signal for later processing, with no data compression used in conversion.

**Playback control (PBC):** Refers to the signal recorded on video CDs or SVCDs for controlling reproduction. By using menu screens recorded on a Video CD or SVCD that supports PBC, you can enjoy interactive-type software as well as software having a search function.

**Progressive Scan:** It displays all the horizontal lines of a picture at one time, as a signal frame. This system can convert the interlaced video from DVD into progressive format for connection to a progressive display. It dramatically increases the vertical resolution.

**Region code:** A system for allowing discs to be played back only in the region designated beforehand. This unit will only play discs that have compatible region codes. You can find the region code of your unit by looking on the product label. Some discs are compatible with more than one region (or ALL regions).

**Title:** The longest section of a picture or music feature on DVD, music, etc., in video software, or the entire album in audio software. Each title is assigned a title number enabling you to locate the title you want.

**VIDEO OUT jack:** Jack on the back of the DVD System that sends video to a TV.



## MAGNAVOX LIMITED WARRANTY ONE (1) YEAR

### WARRANTY COVERAGE:

MAGNAVOX warranty obligation is limited to the terms set forth below.

### WHO IS COVERED:

Magnavox warrants the product to the original purchaser or the person receiving the product as a gift against defects in materials and workmanship as based on the date of original purchase ("Warranty Period") from an Authorized Dealer. The original sales receipt showing the product name and the purchase date from an authorized retailer is considered such proof.

### WHAT IS COVERED:

The Magnavox warranty covers new products if a defect arises and a valid claim is received by Magnavox within the Warranty Period. At its option, Magnavox will either (1) repair the product at no charge, using new or refurbished replacement parts, or (2) exchange the product with a product that is new or which has been manufactured from new, or serviceable used parts and is at least functionally equivalent or most comparable to the original product in Magnavox current inventory, or (3) refund the original purchase price of the product.

Magnavox warrants replacement products or parts provided under this warranty against defects in materials and workmanship from the date of the replacement or repair for ninety (90) days or for the remaining portion of the original product's warranty, whichever provides longer coverage for you. When a product or part is exchanged, any replacement item becomes your property and the replaced item becomes Magnavox' property. When a refund is given, your product becomes Magnavox' property.

**Note: Any product sold and identified as refurbished or renewed carries a ninety (90) day limited warranty.**

**Replacement product can only be sent if all warranty requirements are met. Failure to follow all requirements can result in delay.**

### WHAT IS NOT COVERED - EXCLUSIONS AND LIMITATIONS:

This Limited Warranty applies only to the new products manufactured by or for Magnavox that can be identified by the trademark, trade name, or logo affixed to it. This Limited Warranty does not apply to any non-Magnavox hardware product or any software, even if packaged or sold with the product. Non-Magnavox manufacturers, suppliers, or publishers may provide a separate warranty for their own products packaged with the bundled product.

Magnavox is not liable for any damage to or loss of any programs, data, or other information stored on any media contained within the product, or any non-Magnavox product or part not covered by this warranty. Recovery or reinstallation of programs, data or other information is not covered under this Limited Warranty.

This warranty does not apply (a) to damage caused by accident, abuse, misuse, misapplication, or non-Magnavox product, (b) to damage caused by service performed by anyone other than Magnavox or Magnavox Authorized Service Location, (c) to a product or a part that has been modified without the written permission of Magnavox, or (d) if any Magnavox serial number has been removed or defaced, or (e) product, accessories or consumables sold "AS IS" without warranty of any kind by including refurbished Magnavox product sold "AS IS" by some retailers.

### This Limited Warranty does not cover:

- Shipping charges to return defective product to Magnavox.
- Labor charges for installation or setup of the product, adjustment of customer controls on the product, and installation or repair of antenna systems outside of the product.
- Product repair and/or part replacement because of improper installation, connections to improper voltage supply, abuse, neglect, misuse, accident, unauthorized repair or other cause not within the control of Magnavox.
- Damage or claims for products not being available for use, or for lost data or lost software.
- Damage occurring to product during shipping.
- A product that requires modification or adaptation to enable it to operate in any country other than the country for which it was designed, manufactured, approved and/or authorized, or repair of products damaged by these modifications.
- A product used for commercial or institutional purposes (including but not limited to rental purposes).
- Product lost in shipment and no signature verification receipt can be provided.
- Failure to operate per Owner's Manual.

### TO OBTAIN ASSISTANCE IN THE U.S.A., PUERTO RICO, OR U.S. VIRGIN ISLANDS...

Contact Magnavox Customer Care Center at:  
1-800-705-2000

### TO OBTAIN ASSISTANCE IN CANADA...

1-800-661-6162 (French Speaking)  
1-800-705-2000 - (English or Spanish Speaking)

REPAIR OR REPLACEMENT AS PROVIDED UNDER THIS WARRANTY IS THE EXCLUSIVE REMEDY FOR THE CONSUMER. MAGNAVOX SHALL NOT BE LIABLE FOR ANY INCIDENTAL OR CONSEQUENTIAL DAMAGES FOR BREACH OF ANY EXPRESS OR IMPLIED WARRANTY ON THIS PRODUCT. EXCEPT TO THE EXTENT PROHIBITED BY APPLICABLE LAW, ANY IMPLIED WARRANTY OF MERCHANTABILITY OR FITNESS FOR A PARTICULAR PURPOSE ON THIS PRODUCT IS LIMITED IN DURATION TO THE DURATION OF THIS WARRANTY.

Some states do not allow the exclusions or limitation of incidental or consequential damages, or allow limitations on how long an implied warranty lasts, so the above limitations or exclusions may not apply to you.

*This warranty gives you specific legal rights. You may have other rights which vary from state/province to state/province.*

**Magnavox, P.O. Box 671539, Marietta, GA. 30006-0026**

3121 233 4892



## Free Manuals Download Website

<http://myh66.com>

<http://usermanuals.us>

<http://www.somanuals.com>

<http://www.4manuals.cc>

<http://www.manual-lib.com>

<http://www.404manual.com>

<http://www.luxmanual.com>

<http://aubethermostatmanual.com>

Golf course search by state

<http://golfingnear.com>

Email search by domain

<http://emailbydomain.com>

Auto manuals search

<http://auto.somanuals.com>

TV manuals search

<http://tv.somanuals.com>