



Quick Use and Hookup Guide

CONTENTS

TV CHANNEL INSTALLATION	1	TUNER MODE CONTROL	6
ACCESSORIES	2	AUTO PROGRAM (SETTING UP CHANNELS) . . .	6
BATTERY INSTALLATION	2	CABLE BOX (WITH RF IN /OUTPUTS)	7
PRESENTATION OF THE LCD TV	2	CABLE BOX (WITH AUDIO /VIDEO	
REMOTE CONTROL-FOR TV OPERATIONS	3	OUTPUTS)	7
REMOTE CONTROL-FOR DVD OPERATIONS	4	S-VIDEO CONNECTIONS	8
ANTENNA TV	5	COMPONENT CONNECTIONS	8
BASIC CABLE TV CONNECTION	5	PC (MONITOR) INPUTS	9

IMPORTANT

NOTE: This quick setup guide is used with several different LCD TV models. Not all features (and drawings) discussed in this manual will necessarily match those found with your LCD TV set. This is normal and does not require that you contact your dealer or request service.

WARNING: TO PREVENT FIRE OR SHOCK HAZARD DO NOT EXPOSE THIS UNIT TO RAIN OR EXCESSIVE.

TV CHANNEL INSTALLATION

Immediately after unpacking and plugging your new television, you must attach ANTENNA or CABLE RF to the back of this set. Your TV is ready to detect antenna and cable signal then run the AUTO PROGRAM function to set up the TV for the broadcast or cable channels available in your area. If you do not run the auto program function, your new TV may not operate properly.

Please follow these steps to install TV channels:

- 1 Select a TV channel via SOURCE button on your remote control.
- 2 Press MENU button on your remote control to open the onscreen menu.
- 3 Press ^/v to move to INSTALL, press </> on your remote control to enter INSTALL.
- 4 Press ^/v to select TUNER MODE, press </> on your remote control to select CABLE, ANTENNA or AUTO mode.
 CABLE IF you have a cable input
 ANTENNA IF you have an antenna input
 AUTO IF you are not sure what kind of TV signal input you have (Cable or Antenna)
- 5 Press ^/v to move to AUTO PROGRAM.
- 6 Press </> to start auto install the TV Channels.

For more detailed explanation of AUTO PROGRAM, please refer to AUTO PROGRAM section on page 6.

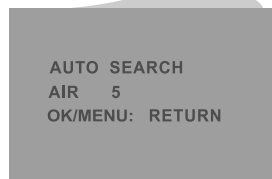
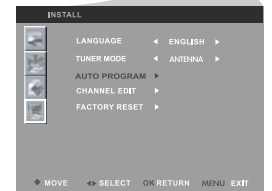
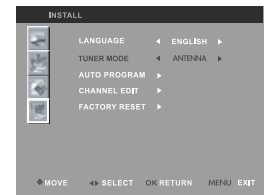
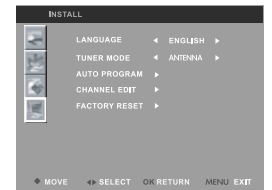
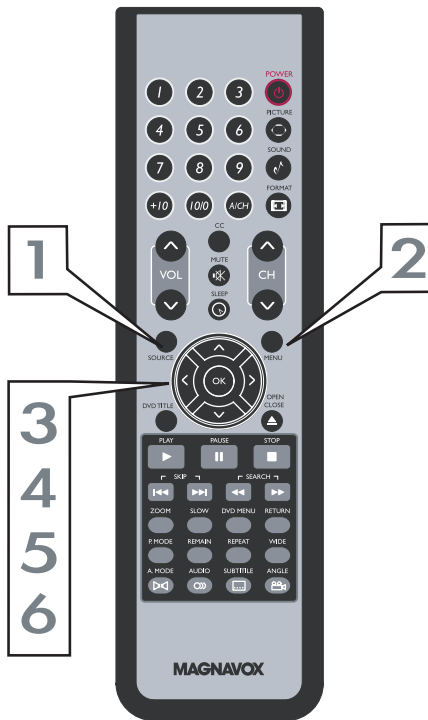

ACCESSORIES

When you unpack this unit, make sure it includes the following:

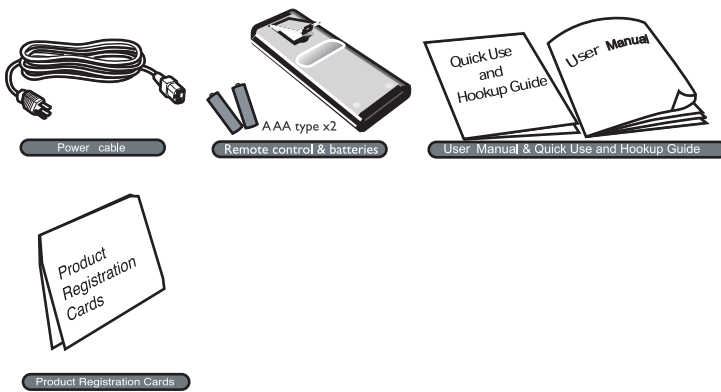

BATTERY INSTALLATION

- 1 Open the battery compartment on the back of the remote.
- 2 Place two AAA batteries in the remote. Be sure the (+) and (-) ends of the batteries line up as marked inside the battery compartment.
- 3 Close the battery compartment.

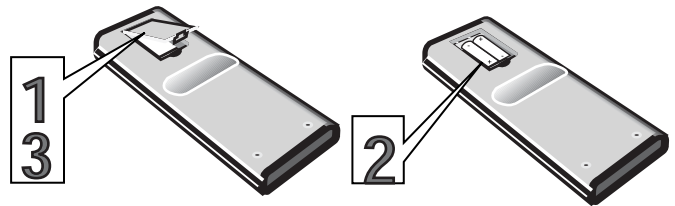

PRESENTATION OF THE LCD TV

- 1 **Television Keys**
 - VOLUME + / - : To adjust sound level.
 - CHANNEL + / - : To select programs.
 - MENU : To access or close onscreen menu,
- 2 **Power button, LED light and infrared sensor**
 - To switch the TV on or off.
 - Aim remote control at infrared sensors to activate TV controls.
- 3 **Rear connectors**
Located back of set.
- 4 **Bottom connectors**
Located at the bottom of the set.

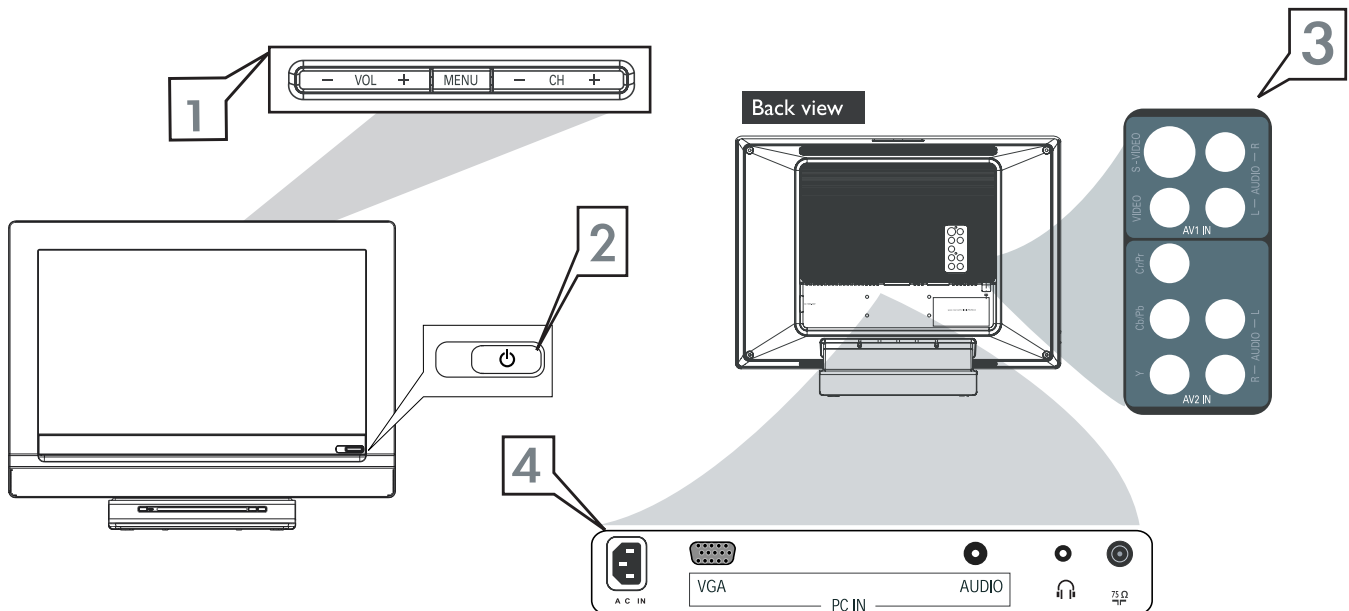

NUMBER buttons

Press to select TV channels. When selecting single-digit channels, press the number of the desired channel. The LCD TV will pause for a few seconds then tune to the selected channel.
Note: +10 button is for DVD use.

CC buttons

Press the CC button to select OFF, CC1, CC2, CC3, CC4, TEXT1, TEXT2, TEXT3, TEXT4, CC MUTE, XDS.

MUTE button

Press to eliminate or restore the LCD TV sound. Mute will appear on the screen when the sound is muted.

VOLUME button

Press to increase or decrease the sound level.

SOURCE button

Press to select the video input source: AV1, AV2, DVD, PC, TV.

OK button

- Press to confirm the option you selected in the onscreen menu.
- Press to return to the previous layout in the OSD screen menu.



Standby(Power) buttons

Press to turn the LCD TV on or off.

Smart Picture

Press repeatedly to select either Personal, Movie, Sports, Weak signal, Multimedia, or Night picture setting.

Smart Sound button

Press repeatedly to select among the 4 settings; Personal, News, Music, or Theatre.

Picture Format button

Press the Format button repeatedly to toggle among the six screen format sizes: wide screen, 4:3, zoom 14:9, zoom 16:9, subtitle zoom, super wide.

Channel button

Press to adjust the channel up or down.

SLEEP button

Press to set the LCD TV to turn itself off within a certain time.

MENU button

Press to activate onscreen menu, also press to exit the onscreen menu.

DVD TITLE button

Use to bring up the DVD title menu.

PLAY button

Use to begin the DVD playback.

PREV/NEXT button

Use to skip to the previous or next chapter.

ZOOM button

Use to zoom the DVD playback picture.

Slow button

Use to slow the DVD playback speed.

P.MODE button

Use to shift DVD play mode.

REMAIN button

Use to display the time of the DVD playback.

A.MODE button

Use to shift the DVD playback audio mode.

AUDIO button

Use to shift DVD audio language.



OPEN/CLOSE button

Use to eject the disc being played in the disc slot, the main unit must be set to DVD status.

STOP button

Use to stop the DVD playback.

PAUSE button

Use to pause the DVD playback.

FF/FR button

Use to play DVD fast forward/backward.

DVD MENU button

Use to bring up the DVD root menu.

RETURN button

Return to the previous menu screen.

WIDE button

In DVD mode, use to set TV display mode.

REPEAT button

Use to repeat the DVD playback.

ANGLE button

Use to shift DVD viewing angle.

SUBTITLE button

Use to shift DVD subtitle language.

ANTENNA TV

A combination antenna receives normal broadcast channels (VHF 2 - 13 and UHF 14 - 69). Your connection is easy because there is only one 75 Ω (ohm) antenna jack on the back of your TV, and that's where the antenna goes.

- 1 If your antenna has a round cable (75 ohm) on the end, then you're ready to connect it to the LCD TV. If your antenna has flat, twin-lead wire (300 ohm), you first need to attach the antenna wires to the screws on a 300- to 75-ohm adapter (not supplied).
- 2 Connect the antenna (or adapter) to the TV jack on the bottom of the LCD TV.
- 3 Plug the Power cable into the AC IN jack on the LCD TV. Plug the power cable into an outlet and switch TV set on.
- 4 Run the AUTO PROGRAM function to set up the TV for the broadcast or cable channels available in your area. If you do not run the auto program function to set up the channels, your television may not operate properly.

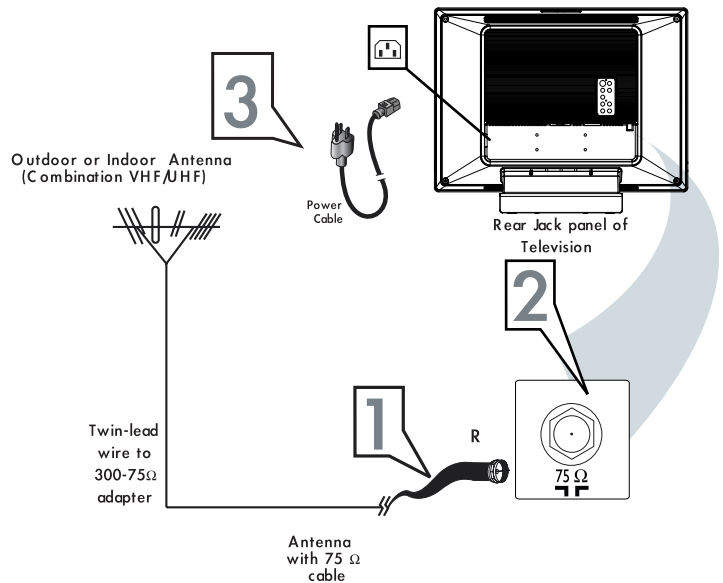

HELPFUL HINT

- Remember, an antenna or cable TV signal must first be connected to your LCD TV.
- Please make sure that you have selected the TV mode with source key on your remote control, before installing TV channels.

BASIC CABLE TV CONNECTION

Your Cable TV input into your home may be a single (75 ohm) cable or use a cable box decoder. In either case the connection is very simple. Follow the steps below to connect your cable signal to your new television.

Direct cable connections:

- 1 Connect the Cable TV signal to the TV jack on the LCD TV.
- 2 Plug the Power cable into the AC IN jack on the LCD TV. Plug the power cable into an outlet and switch TV set on.
- 3 Run the AUTO PROGRAM function to set up the TV for the broadcast or cable channels available in your area. If you do not run the auto program function to set up the channels, your television may not operate properly.

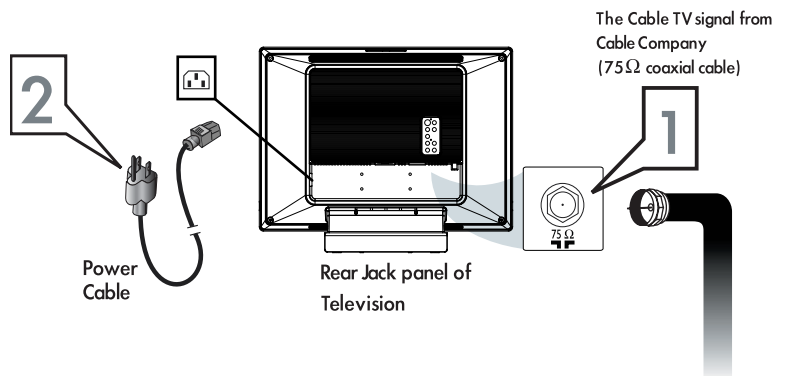

HELPFUL HINT

- Remember, an antenna or cable TV signal must first be connected to your LCD TV.
- Please make sure that you have selected the TV mode with source key on your remote control, before installing TV channels.

TUNER MODE CONTROL

The Tuner Mode allows you to change the LCD TV's signal input to Cable or Air (antenna).

It's important for the LCD TV to know if you want to receive channels from a cable TV signal or an antenna signal.

- 1 Press the MENU button to see the onscreen menu.
- 2 Press the ^/∨ button to highlight the INSTALL menu.
- 3 Press the </> button to enter the INSTALL menu.
- 4 Press the ^/∨ button to highlight the TUNER MODE menu.
- 5 Press the </> buttons to select CABLE, ANTENNA or AUTO.
- 6 Press the MENU button repeatedly to clear the menu from the screen.

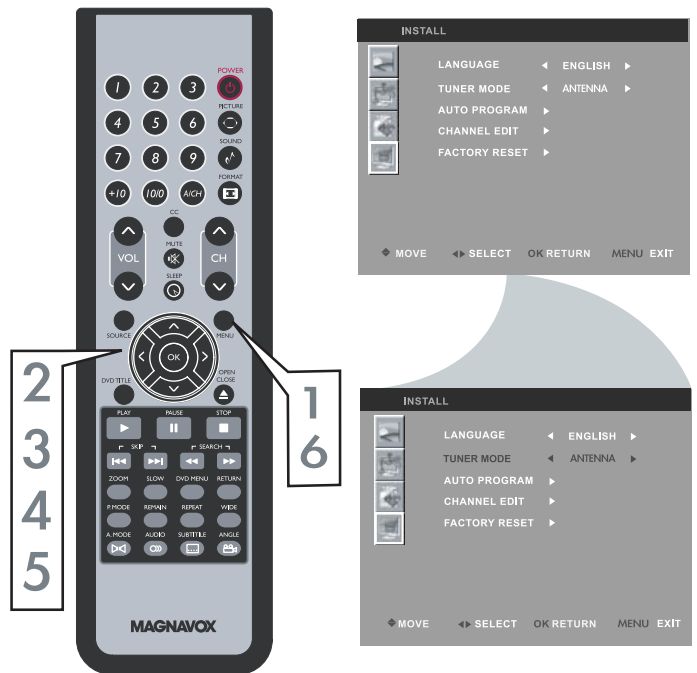

HELPFUL HINT

- When CABLE is selected, channels 1-125 are available.
- When ANTENNA is selected, channels 2-69 are available.
- When AUTO is selected, your LCD TV will search automatically for antenna or cable channels.
- Immediately after unpacking and plugging in your new television, run the AUTO PROGRAM function to set up the TV for the broadcast or cable channels available in your area. If you do not run the auto program function to set up the channels, your television may not operate properly.

AUTO PROGRAM (SETTING UP CHANNELS)

Your LCD TV can automatically set itself for local area (or cable TV) channels. This makes it easy for you to select only the TV stations in your area by pressing the CH (+) or CH (-) button.

- 1 Press the MENU button on the remote control to show the onscreen menu.
- 2 Press the ^/∨ button to highlight the INSTALL menu.
- 3 Press the </> button to enter the INSTALL menu.
- 4 Press the ^/∨ button to highlight the AUTO PROGRAM control.
- 5 Press the </> button to start the AUTO PROGRAM scanning of channels.
- 6 Press the MENU button repeatedly to clear the menu from the screen, after AUTO SEARCH has finished.

HELPFUL HINT

- Immediately after unpacking and plugging in your new television, run the auto program function to set up the TV for the broadcast or cable channels available in your area. If you do not run the auto program function to set up the channels, your television may not operate properly.
- After you've run Auto Program, check out the results. Press the CH button and see which channels you can select.
- Remember, an antenna or cable TV signal must first be connected to your LCD TV.

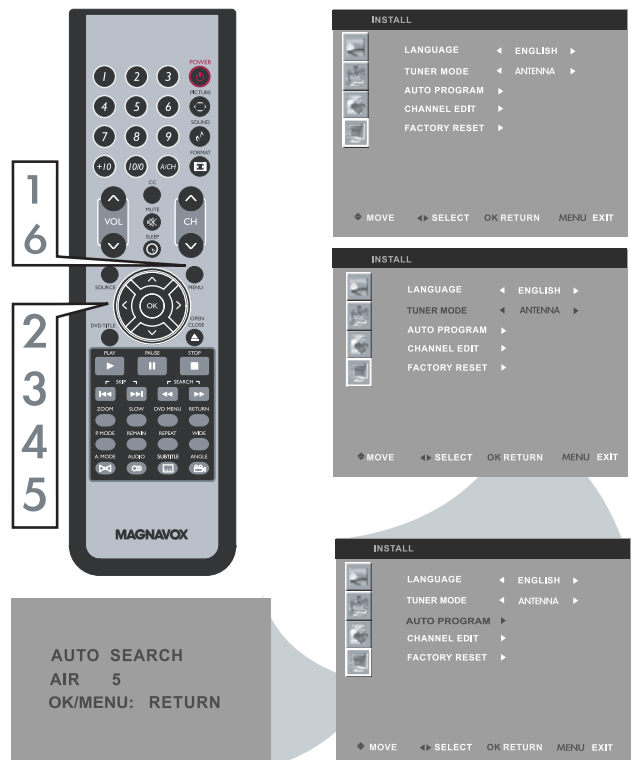

CABLE BOX (WITH RF IN/OUTPUTS):

- 1 Connect the Cable TV signal to the IN jack (or RF IN or CABLE IN) on the Cable Box.
- 2 Connect an RF coaxial cable (not supplied) to the OUT jack (or TO TV or RF OUT) of the Cable Box.
- 3 Connect the other end of the coaxial cable to the TV jack on the LCD TV.
- 4 Plug the power cable into the AC IN jack on the LCD TV. Plug the power cable into an outlet and switch TV set on.
- 5 Set the Channel 3/4 (or Output channel) switch of the Cable Box to 3 or 4. Set the TV to the same channel. When watching TV programming, change channels at the Cable Box, not the LCD TV.

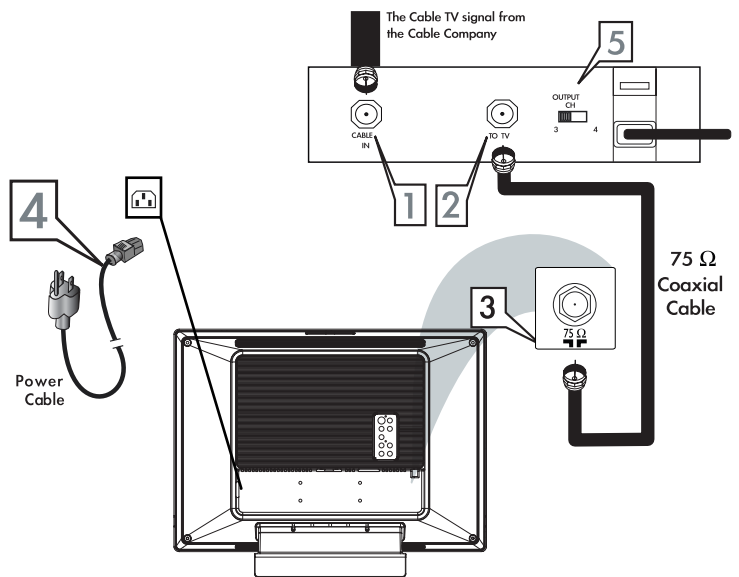

HELPFUL HINT

- Immediately after unpacking and plugging in your new television, run the auto program function to set up the TV for the broadcast or cable channels available in your area. If you do not run the auto program function to set up the channels, your television may not operate properly.
- Please make sure that you have selected the TV mode with source key on your remote control, before installing TV channels.

CABLE BOX (WITH AUDIO/VIDEO OUTPUTS):

This connection will supply stereo sound to the LCD TV.

- 1 Connect the Cable TV signal to the IN jack (or RF IN or CABLE IN) on the Cable Box.
- 2 Using video cable (not supplied) connect one end of the video cable to the Video Out jack of the Cable Box. Connect the other end of the cable to the yellow VIDEO jack on the side of the TV. Video cables are usually marked with yellow and are available from Magnavox or electronics retailers. Video jacks on most equipment are yellow.
- 3 Using stereo audio cables (not supplied), connect one end of the cables to the left and right Audio Out jacks of the Cable Box. Connect the other end of that cable to the Audio jack on the side of the LCD TV. Audio cables are usually marked with red and white and are available from Magnavox or electronics retailers. The right audio jack is red and the left audio jack is white. Match the cable colors to the jack colors.
- 4 Plug the power cable into the AC IN jack on the LCD TV. Plug the power cable into an outlet and switch TV set on.

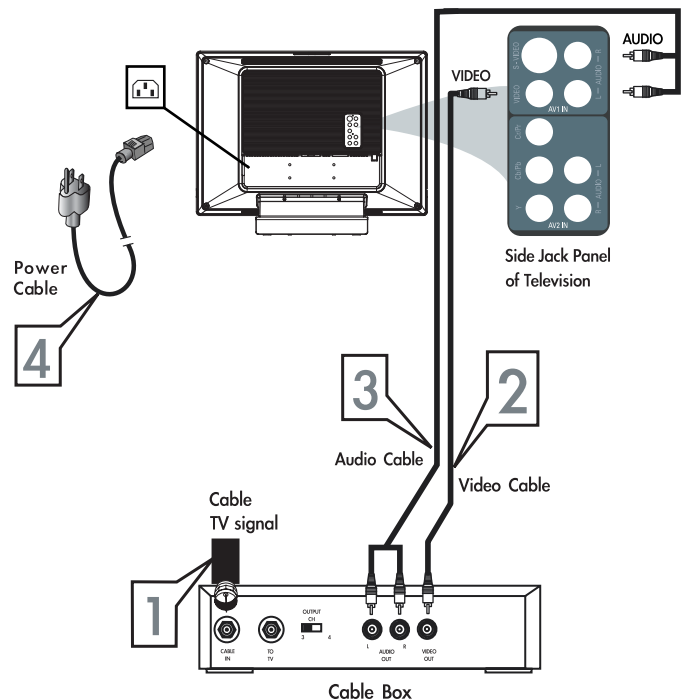

Note: Use the Source button on the remote control to tune to the AV channel for the cable box signal. Once tuned, change channels at the cable box, not the television.

S-VIDEO CONNECTIONS

The S-Video connection on the rear of the LCD TV can provide you with better picture detail and clarity for the playback of accessory sources such as DBS (digital broadcast satellite), DVD (digital video discs), video games, and VHS VCR (video cassette recorder) tapes than the normal antenna picture connections.

- 1 Connect an S-Video cable to the S-VIDEO jack of the other equipment (DVD Player, Camcorder, etc.) and to the S-VIDEO jack on the rear of the LCD TV.
- 2 Connect audio cables (usually red and white) to the AUDIO OUT (left and right) jacks on the other equipment. Connect the other end of the cables to the AUDIO jack on the rear of the LCD TV.
- 3 Plug the power cable into the AC IN jack on the LCD TV. Plug the power cable into an outlet. Turn on the LCD TV and other equipment.
- 4 Press the Source buttons to set the LCD TV to its AV1 mode.
- 5 Press PLAY on the other equipment to view its material on the LCD TV.

Note:

- The Magnavox LCD TV remote control can not be used to operate other video/audio equipment.
- The Audio jack of AV1 IN is shared between Video (CVBS) and S-Video signals. If Audio and Video is connected to S-Video input, you can still hear sound if you select Video via Source select, even there appears no image on screen.

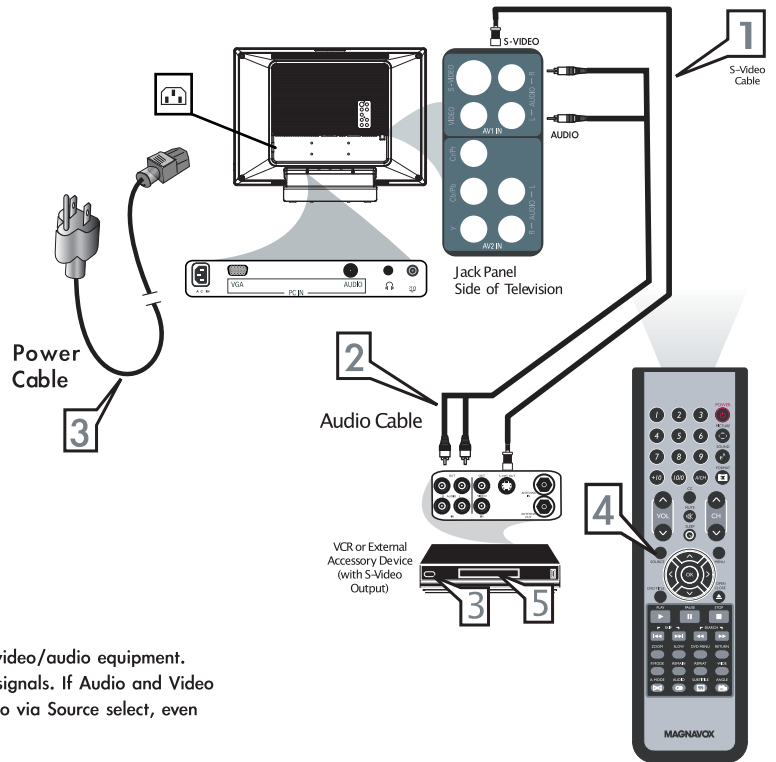

COMPONENT CONNECTIONS

Component Video input provide the highest possible color and picture resolution in the playback of digital signal source material, such as with DVD players. If you are using a HD (High Definition) receiver that can transmit high definition programming, the TV can accept those signals through the Component input located on the rear of the TV.

- 1 Connect the component (Y, Pb, Pr) Video OUT jacks from the DVD player (or similar device) to the AV2 Input jacks on the rear of the LCD TV.
- 2 Connect the red and white AUDIO CABLES to the Audio (left and right) output jacks on the rear of the accessory device to the AUDIO IN jack. Connect the other end of the cable to the Audio jack on the rear of LCD TV.
- 3 Plug the Power cable into the AC IN jack on the LCD TV. Plug the power cable into an outlet. Turn on the LCD TV and other equipment.
- 4 Press the SOURCE button on the remote control to select AV2. AV2 will appear in the upper left corner on the TV screen.
- 5 Insert a DVD disc into the DVD player and press the PLAY button on the DVD Player.

Note:

- The Magnavox LCD TV remote control can not be used to operate other video/audio equipment.

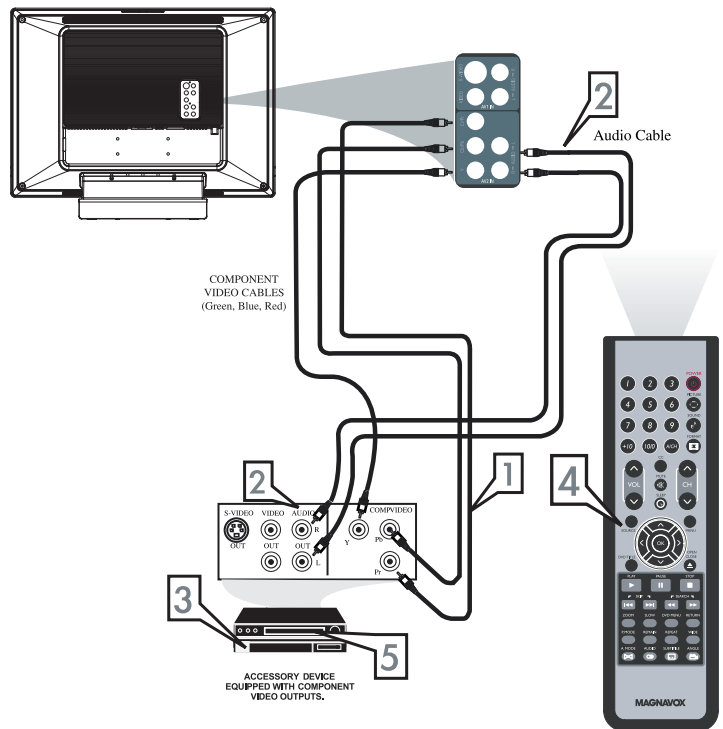

PC (MONITOR) INPUTS:

This LCD TV can be used as a PC. Your computer will have to be equipped with a VGA type video output and VGA cable.

- 1 Connect one end of the VGA Video cable (not supplied) to the Monitor (video) output on the computer, while connecting the other ends to the VGA INPUT jack on the LCD TV.
- 2 Although audio connections are not required, the LCD TV can reproduce the computers audio out by an AUDIO ADAPTER to the Audio output jack on the computer (if available) while connecting the other ends of the Audio cables to the PC AUDIO Jacks on the bottom of the TV.
- 3 Plug the power cable into the AC IN jack on the LCD TV. Plug the power cable into an outlet. Turn on the LCD TV and PC.
- 4 Press the SOURCE button until PC MODE appears on the screen.

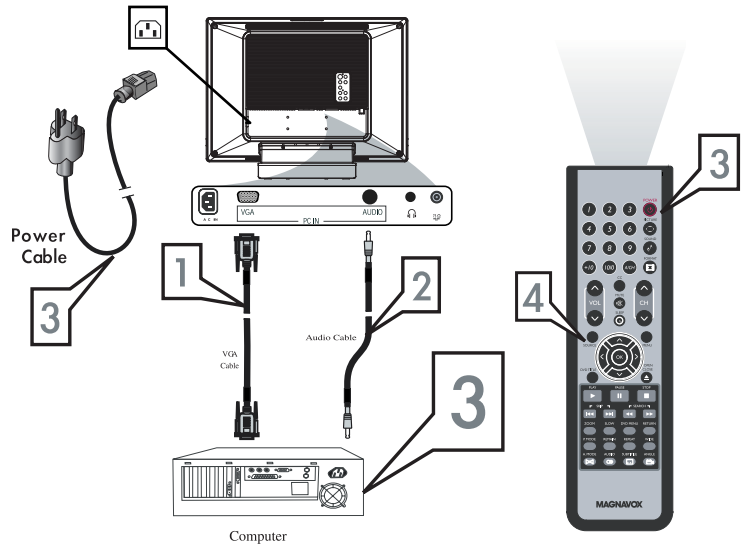

Free Manuals Download Website

<http://myh66.com>

<http://usermanuals.us>

<http://www.somanuals.com>

<http://www.4manuals.cc>

<http://www.manual-lib.com>

<http://www.404manual.com>

<http://www.luxmanual.com>

<http://aubethermostatmanual.com>

Golf course search by state

<http://golfingnear.com>

Email search by domain

<http://emailbydomain.com>

Auto manuals search

<http://auto.somanuals.com>

TV manuals search

<http://tv.somanuals.com>