



**Manitowoc®**

## Manitowoc SN12/SN20 Model Nugget Ice Machines Cutter Head Replacement Instructions

1. Disconnect water supply.
2. Remove front panel.
3. Move toggle switch to CLEAN position after the 5 minute delay expires. The evaporator and float chamber will drain.
4. Disconnect power at electrical disconnect.

**⚠ WARNING**

Disconnect power to the ice machine at the electrical disconnect, moving the toggle switch to the off position will not disconnect line voltage.

5. Remove top, left and right side panels.
6. Remove ice chute assembly.  
NOTE; if the ice wiper can not be hand removed; place the handle end of a screwdriver against the ice wiper, then tap the screwdriver (counterclockwise) with a hammer to loosen the ice wiper from the auger.

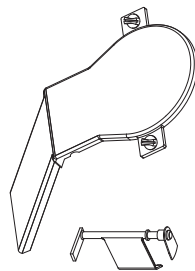

REMOVE COVER

REMOVE ICE DAMPER



REMOVE STRAINER



REMOVE ICE WIPER

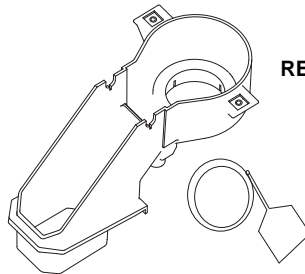

REMOVE ICE CHUTE

LOOSEN HOSE CLAMP AND  
DISCONNECT DRAIN LINE

7. Peel evaporator insulation down to expose 3 bolts securing top cutter head - remove 3 bolts.



7. Use puller to remove cutter head from auger shaft. NOTE: If the bearing is destroyed or the auger heavily damaged from bearing wear contact the Manitowoc service department @ 1-800-545-5720.

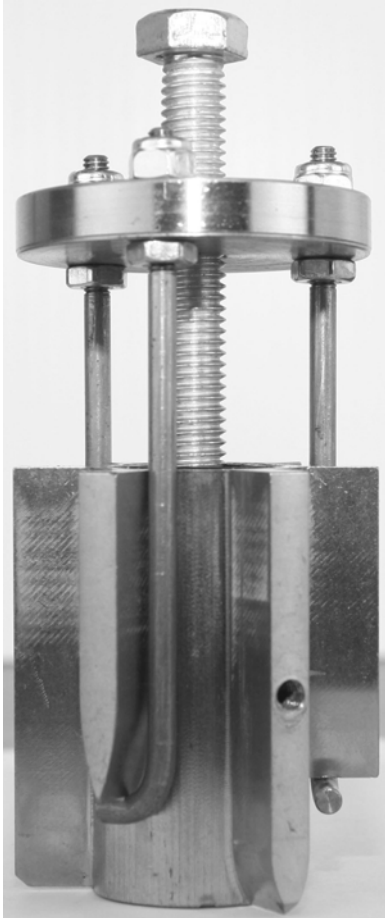

8. Install new cutter head and secure with three bolts removed in step 7. Use removable loctite on bolt threads.
9. Reassemble chute assembly and test run ice machine.

## Free Manuals Download Website

<http://myh66.com>

<http://usermanuals.us>

<http://www.somanuals.com>

<http://www.4manuals.cc>

<http://www.manual-lib.com>

<http://www.404manual.com>

<http://www.luxmanual.com>

<http://aubethermostatmanual.com>

Golf course search by state

<http://golfingnear.com>

Email search by domain

<http://emailbydomain.com>

Auto manuals search

<http://auto.somanuals.com>

TV manuals search

<http://tv.somanuals.com>