



SMB-430

SMB SERIES

Sliding Glass Door Merchandisers

MODELS

- SMB-430
- SMB-580
- SMB-870

FEATURES

CONSTRUCTION

- 24 gauge painted steel interior and exterior
- Low profile evaporator coil with horizontal, forced air system
- Four white epoxy-coated, heavy-duty, welded wire shelves per door
- Shelves adjustable in 1/2" increments
- Dual overhead, high output fluorescent lamps
- Independent on/off light switch
- 8 foot cord with molded plug (excluding SMB-870)
- 2" foamed-in-place "zero ODP" urethane insulation

FINISH

- Sparkling white polyester enamel interior and exterior

DOORS

- Sliding, dual pane, tempered glass doors
- Self-closing with cord and sash system
- Extruded aluminum frame doors
- Stainless steel, ball-bearing door rollers and tracks
- Full length easy-grip door handles

REFRIGERATION

- Self-contained, bottom mount, slide-out refrigeration system
- Electric condensate evaporator
- Refrigerant: R-134a
- Temperature range: 34° to 41°F (1° to 5°C)
- R-factor (insulation efficiency rating): 17.24

WARRANTY

- Standard limited four year extended compressor and one year limited parts and labor

OPTIONS

- Casters
- Door lock
- Extra shelves



SMB SERIES SLIDING GLASS DOOR MERCHANDISERS

TECHNICAL SPECIFICATIONS

MODEL	DIMENSIONS (in.)			DIMENSIONS (mm)			VOLTS	AMPS	UNIT H.P.	NO. OF DOORS	NO. OF SHELVES	STANDARD SHELF SIZE (in inches)	CAP. CU. FT.	SHIP CU. FT.	SHIP WT. LB/KG
	L	D	H	L	D	H									
SMB-430	53	32 ¹ / ₄	76 ¹ / ₂	1346	819	1930	115	15.0	1/2	2	8	22 ¹ / ₄ x 23 ³ / ₈	43.0	103.0	615/280
SMB-580	70	32 ¹ / ₄	76 ¹ / ₂	1778	819	1930	115	15.0	1/2	2	8	22 ¹ / ₄ x 31 ⁷ / ₈	58.0	147.0	900/409
SMB-870	102 ³ / ₄	32 ¹ / ₄	76 ¹ / ₂	2610	819	1930	115	22.5	3/4	4	16	22 ¹ / ₄ x 23 ³ / ₈	87.0	210.0	1115/507

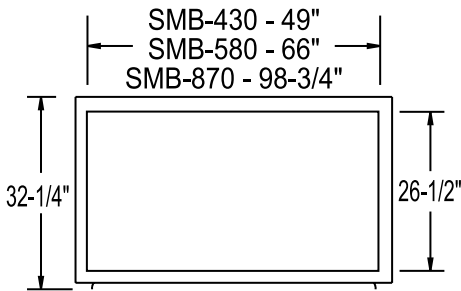

PLAN VIEW

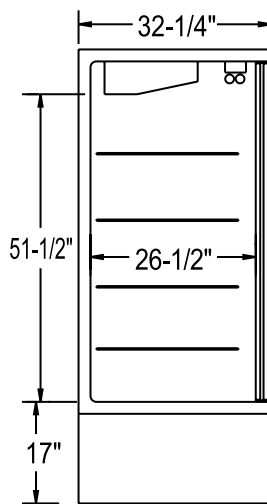

SIDE VIEW

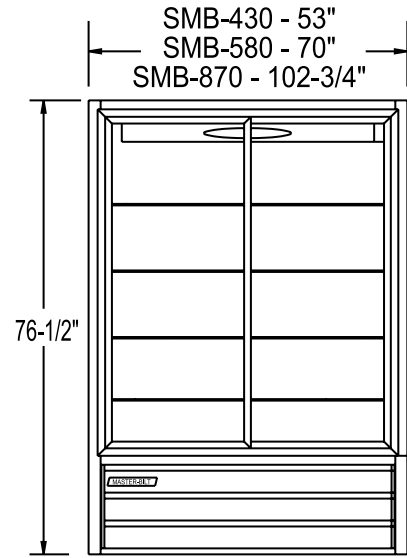

ELEVATION VIEW

LISTINGS



HOOKUP

SMB-430 and SMB-580 via plug in, 8 foot long, flexible three wire 14/3 cord with molded plug. SMB-870 is a 115/60/1 hardwire with a maximum 30 amp fuse.



BID SPECIFICATIONS

Item no. SMB- _____
Provide _____ () Sliding Glass Door Merchandiser(s), Master-Bilt model no. SMB- _____.
Merchandiser to have stainless steel, ball-bearing door rollers and tracks and an

independent on/off light switch. Cabinet to be provided with electric condensate evaporator and dual overhead high output fluorescent lamps. Provide SMB-430 and SMB-580 with eight foot cord and molded plug.

Merchandiser to have standard limited four year extended compressor warranty and one year limited parts and labor warranty.

Merchandiser to be UL and C-UL listed as well as UL EPH classified.

NOTE: Cabinet designed for optimum performance in air-conditioned area at 75°F ambient and 55% relative humidity. All specifications subject to change without notice.



908 Highway 15 North • New Albany, MS 38652
PHONE: 800-647-1284 or 662-534-9061 • FAX: 800-232-3966 or 662-534-6049 • www.master-bilt.com



Free Manuals Download Website

<http://myh66.com>

<http://usermanuals.us>

<http://www.somanuals.com>

<http://www.4manuals.cc>

<http://www.manual-lib.com>

<http://www.404manual.com>

<http://www.luxmanual.com>

<http://aubethermostatmanual.com>

Golf course search by state

<http://golfingnear.com>

Email search by domain

<http://emailbydomain.com>

Auto manuals search

<http://auto.somanuals.com>

TV manuals search

<http://tv.somanuals.com>