

#### This device complies with Part 15 of the FCC Rules.

Operation is subject to the following two conditions:

(1) This device may not cause harmful interference, and (2) this device must accept any interference received, including interference that may cause undesired operation.

- This equipment has been tested and found to comply with the limits for a Class B digital device, pursuant to Part 15 of the FCC Rules. These limits are designed to provide reasonable protection against harmful interference in a residential installation. This equipment generates, uses and can radiate radio frequency energy and, if not installed and used in accordance with the instructions, may cause harmful interference to radio communications. However, there is no guarantee that interference will not occur in a particular installation. If this equipment does cause harmful interference to radio or television reception, which can be determined by turning the equipment off and on, the user is encouraged to try to correct the interference by one or more of the following measures:
  - Reorient or relocate the receiving antenna.
  - Increase the separation between the equipment and receiver.
  - Connect the equipment into an outlet on a circuit different from that to which the receiver is connected.
  - Consult the dealer or an experienced radio / TV technician for help.

**NOTE:** Changes or modifications to this unit not expressly approved by the party responsible for compliance could void the user's authority to operate the equipment.



Protect the environment by not disposing of this product with household waste (2002/96/EC). Check your local authority for recycling advice and facilities.

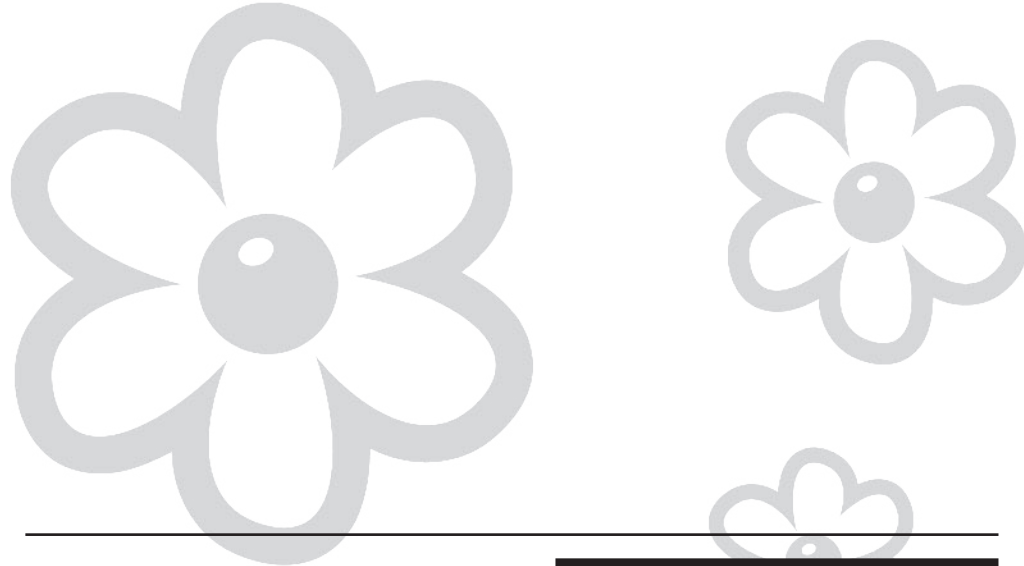

CONFORMS TO THE SAFETY REQUIREMENTS OF ASTM F963 / PEN CONFORMS TO ASTM D4236.

© 2010 Mattel, Inc. All Rights Reserved.

RADICA USA Ltd. www.radicagames.com Helpline 1.800.803.9611 or service.mattel.com.

Mattel, Inc., 636 Girard Avenue, East Aurora, NY 14052, U.S.A.

Retain this address for future reference: Mattel U.K. Ltd., Vanwall Business Park, Maidenhead SL6 4UB. Helpline - 01628 500303.

Mattel Europa, B.V., Gondel 1, 1186 MJ Amstelveen, Nederland.

Mattel Australia Pty. Ltd., Richmond, Victoria. 3121. Consumer Advisory Service - 1300 135 312. Mattel East Asia Ltd., Room 1106, South Tower, World Finance Centre, Harbour City, Tsinghsui, HK, China.

Diimport & Diedarkan Oleh: Mattel SEA Ptd Ltd. (993532-P) Lot 13.5, Menara Lien Hoe, Persiaran Tropicana Golf Country Resort, 47410 PJ.

Tel: 03-78803817, Fax: 03-78803867.

#### CONSUMER INFORMATION

Need Assistance? Visit [service.mattel.com](http://service.mattel.com) or call 1.800.803.9611 (US and Canada only).

[SERVICE.MATTEL.COM](http://SERVICE.MATTEL.COM)



ELECTRONIC

Barbie™ Glam Diary

Ages  
6+

R7326-0920

## INSTRUCTION MANUAL

Keep these instructions for future reference as they contain important information.

### CONTENTS

- 1 Barbie™ Glam Diary (Case and Journal)
- 1 Bracelet
- 1 Pen

Please remove all components from the container and compare them to the contents list. If any items are missing, please call 1.800.803.9611. Outside the U.S., please consult the listing of your local Mattel offices at the end of these instructions.



**WARNING:**  
CHOKING HAZARD - Small parts.  
Not for children under 3 years.



### BATTERY INFORMATION

- Requires 3 "AAA" Alkaline batteries. Batteries included are for demonstration purposes.
- For longer life use only alkaline batteries.
- If game malfunctions, check the battery installation.
- BATTERIES SHOULD BE CHANGED WHEN SOUND DISTORTS OR LOCKING MECHANISM MALFUNCTIONS.

**- AAA +** x 3  
Included

### BATTERY SAFETY INFORMATION

In exceptional circumstances batteries may leak fluids that can cause a chemical burn injury or ruin your product. To avoid battery leakage:

- Non-rechargeable batteries are not to be recharged.
- Rechargeable batteries are to be removed from the product before being charged (if designed to be removable).
- Rechargeable batteries are only to be charged under adult supervision (if designed to be removable).
- Do not mix alkaline, standard (carbon-zinc), or rechargeable (nickel-cadmium) batteries.
- Do not mix old and new batteries.
- Only batteries of the same or equivalent type as recommended are to be used.
- Batteries are to be inserted with the correct polarity.
- Exhausted batteries are to be removed from the product.
- The supply terminals are not to be short-circuited.
- Dispose of battery(ies) safely.
- Do not dispose of this product in a fire. The batteries inside may explode or leak.

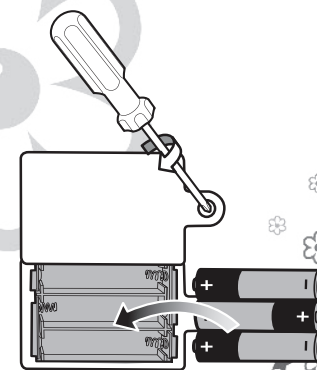

### INSTRUCTION SHEET SPECIFICATIONS

Toy: Barbie Diary  
Toy No.: R7326  
Part No.: 0920  
Trim Size: 11" W x 8.5" H  
Folded Size: 5.5" W x 4.25" H  
Type of Fold: Fold into half (W & H)  
# colors: One  
Colors: Pantone 219 U  
Paper Stock: White Offset  
Paper Weight: 70 lb.  
EDM No.: 001

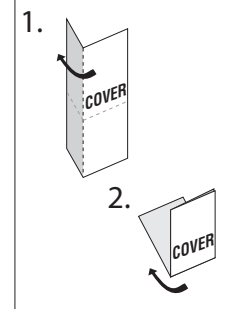

R7326 Manual\_1L-English  
P/N 823-D9600, Rev.A  
Date: Feb. 02, 2010

Printed in  
Pantone 219 U

## THE KEY TO YOUR DIARY

### Unlocking Your Diary



- Hold your bracelet so that the "magic jewel" on the bracelet is over the "magic jewel" on your diary for 2 seconds.
- When you hear sounds, your diary has magically unlocked! Your diary will open and you will hear Barbie® greet you.
- Now you are ready to write your heart out!

### Opening Your Diary Without Your Bracelet



If you do not have your bracelet handy, unlock your diary by pressing the tip of a pen or pencil to the reset button located next to the battery door.

### Closing Your Diary

Done expressing yourself for the day? Simply shut your diary and hear Barbie® say goodbye. Your secrets are safely locked away.

## Free Manuals Download Website

<http://myh66.com>

<http://usermanuals.us>

<http://www.somanuals.com>

<http://www.4manuals.cc>

<http://www.manual-lib.com>

<http://www.404manual.com>

<http://www.luxmanual.com>

<http://aubethermostatmanual.com>

Golf course search by state

<http://golfingnear.com>

Email search by domain

<http://emailbydomain.com>

Auto manuals search

<http://auto.somanuals.com>

TV manuals search

<http://tv.somanuals.com>