

**Replacement Parts List**

**NOTE:** If requested color is not available, similar color will be substituted.

Part	Cost	Qty	Total Cost
Crotch Strap/Buckle	\$4.99	X _____	= \$ _____
Harness Strap . . . . .	\$2.00	X _____	= \$ _____
Pad Set . . . . .	\$42.00	X _____	= \$ _____
Harness Retainer . . . . .	\$1.50	X _____	= \$ _____
Locking Clip . . . . .	\$2.50	X _____	= \$ _____
Tether Kit . . . . .	\$9.99	X _____	= \$ _____
Latch Kit . . . . .	\$24.99	X _____	= \$ _____
Instructions . . . . .	\$0.00	X _____	= \$ _____

**Merchandise Total** \$ \_\_\_\_\_

**Shipping and handling:** \$ \_\_\_\_\_

Up to \$25.00 . . . . .	\$5.95	\$100.01 to \$150.00 . . .	\$10.95
\$25.01 to \$50.00 . . . . .	\$6.95	\$150.01 to \$200.00 . . .	\$11.95
\$50.01 to \$75.00 . . . . .	\$8.95	\$200.01 and up . . . . .	\$13.95
\$75.01 to \$100.00 . . . . .	\$9.95	Outside ContinentalUS . . .	\$10.00
\$75.01 to \$100.00 . . . . .	\$9.95		

**Sales Tax** \$ \_\_\_\_\_  
 (Indiana, California, Arkansas, and Massachusetts residents add applicable sales tax.)

**Grand Total** \$ \_\_\_\_\_

No shipping and handling on instructions for quantities under 6. Add \$.50 for each instruction over 6, then add applicable shipping and handling.

**Fill Out For Credit Card**

Visa    Mastercard

Card Exp. Date: \_\_\_\_\_

Cardholder's Name: \_\_\_\_\_

Card Number: \_\_\_\_\_

Signature \_\_\_\_\_

CUT ON DOTTED LINE

Eng. 4358-4274

**Priori**  
**Instruction Manual**

www.maxi-cosi.com



This child restraint is designed for use by children whose:

**Weight:**  
 5-40 pounds  
 (2.3-18 kg)

**Height:**  
 19-43 inches  
 (48-110 cm)

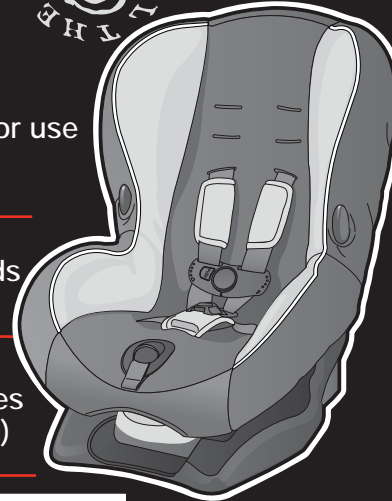

**Read all instructions BEFORE USING this child restraint.**  
 KEEP INSTRUCTIONS FOR FUTURE USE.

**▲ IMPORTANT!**

Failure to follow the warnings on the labels and in the instruction manual can result in the death or serious injury of your child.

Para recibir las instrucciones en español, llame al 1-800-544-1108 o solicítase por escrito al dirección por arriba.

## Before You Begin...

Thank you for choosing this car seat, referred to throughout this manual as a child restraint. The Maxi-Cosi Brand is part of the Dorel Juvenile Group (DJG) family that is committed to creating a child restraint with the most comfort and convenience available today.

Remember, parents are a child's first teachers and examples. If you always buckle your seat belt, your child will think it is the natural thing to do. Make it a firm rule that the vehicle does not go until everyone is buckled up. Make no exceptions.

No one can predict if use of a child restraint will prevent injury or death in a particular crash. However, combined with careful driving, proper use of a child restraint can lower a child's risk of injury or death in most crashes.

Your child's safety is worth the time it will take to read and follow these instructions. After reading, if you still have questions or have any problems with this child restraint, please contact our Consumer Relations Department at:

### Dorel Juvenile Group, Inc.

Website: [www.maxi-cosi.com](http://www.maxi-cosi.com)

Fax: 1-800-207-8182

Mailing Address: Dorel Juvenile Group, Inc.  
P.O. Box 2609  
Columbus, IN 47202-2609

Telephone: 1-800-951-4113

7 A.M. to 6 P.M. EST M-TH  
7 A.M. to 4:30 P.M. EST FRI

On the recline foot there is an expiration date for use of this child restraint. Do not use this seat after the expiration date.

## Table of Contents

Table of Contents	1
General and Warm Weather Use	2
Registration and Recall	2
Warnings	3-5
Aircraft Installation	5
Understanding Your Vehicle	6-7
Child Restraint Parts	8-9
Choosing Restraint and Position	10
Reclining the Child Restraint	11
Accessories	11
Preparing Child Restraint to Fit Your Child	12-15
Securing Your Child in the Child Restraint	16-17
Removing Your Child From the Child Restraint	18
Choosing LATCH or Vehicle Belts	19
Knowing Your Vehicle Belts	20-21
Locking Clip Rear-Facing Only	22-23
Rear-Facing Use	24
Rear-Facing Installation	25-26
with Vehicle Belt	27-28
with LATCH	29-31
Forward-Facing Use	32
Forward-Facing Installation	33-34
with Vehicle Belt	35-37
with LATCH	38-40
Adjusting the Top Anchorage Strap	41
Removing Seat Pad for Cleaning	42-44
Trouble Shooting	45-46
Warranty	47-48
Replacement Parts Order Form	49-50

## General and Warm Weather Use

To help protect your vehicle seat's upholstery from damage, use a seat protector or a towel underneath and behind child restraint.

**To avoid your child being seriously burned, take the following precautions:**

1. Park in the shade or where sun does not directly hit the child restraint.
2. Cover the child restraint with a sheet or blanket when not in use.
3. Check for hot seat and buckles before placing child in child restraint.

## Registration and Recall Information

Child restraints could be recalled for safety reasons. You must register this restraint to be reached in a recall. Send your name, address and the restraint's model number and manufacturing date to:

Dorel Juvenile Group, Inc.  
P.O. Box 2609,  
Columbus, IN 47202-2609  
Attn: Consumer Relations or visit  
[www.maxi-cosi.com](http://www.maxi-cosi.com)  
or call 1-800-951-4113.

You can now register your child restraint online at [www.maxi-cosi.com](http://www.maxi-cosi.com). Please do not send in your registration card if you registered your child restraint online

For recall information, call the U.S. Government's Vehicle Safety Hotline at 1-888-327-4236 (TTY: 1-800-424-9153), or go to <http://www.NHTSA.gov>.

2

## ! WARNING

Failure to follow these warnings can result in the serious injury or death of your child. To help you recognize those instructions which are most critical for your child's safety, we use this symbol !:

! According to accident statistics, children are safer when properly restrained in the rear seating positions than in the front seating positions.



! Never place a child rear-facing in a seating position with an active frontal airbag.

! This child restraint must always face the rear of the vehicle and be in the fully reclined position when the child weighs between 5-35 lbs. (2.3-16 kg) and is less than one year old.

! Never place a child less than one-year old forward facing.

! Check vehicle instructions for more information about air bag/child restraint use.

! For vehicles with an air bag, but without a back seat, refer to your vehicle owners manual.

! Make sure the harness height is correct for your child's size.

! The harness must be snug.

! Do not lubricate buckles and fasteners.

3

## WARNING

 The vehicle or LATCH belt must stay tight at the belt path. When you switch from one mode to the next, review the sections of this instruction manual that apply to that mode. If you don't, your child could be injured or killed.

 Never take your child out of the child restraint or try to tend to your child's needs while the vehicle is moving. Never leave child unattended.

 Do not use a child restraint with damaged or missing parts.

 Do not use cut, frayed or damaged harnesses.

 Do not substitute parts or try to modify the child restraint in any way.

 Do not use a child restraint that has been in a crash. You must get a new child restraint.

 Use the child restraint only on vehicle seats that face forward. Do not use on seats that face the sides or rear of the vehicle.

 Check the vehicle or LATCH belt before each use. Use only if the belt can be tightened properly and securely.

 Secure the top anchorage strap (tether) provided with this child restraint as specified in both the vehicle and child restraint manufacturer's instructions.

 Do not use this child restraint without the seat pad.

4

## WARNING

 This child restraint should be securely belted in the vehicle even when not in use. In a crash or sudden stop, an unsecured child restraint could injure other occupants.

 Do not use this child restraint if the midpoint of your child's head is above the top of the child restraint.

 Dorel Juvenile Group does not recommend the use of any child restraint accessories except those provided by DJG.

 Never allow any child to play with this child restraint; it is not a toy.

 Do not remove any of the warning labels or other labels on the child restraint.

 Placing your child in a hot child restraint may result in burns.

 Read instructions for other warnings.

## **Aircraft Installation**

This restraint is certified for aircraft use. Use on forward-facing aircraft seats only and in a position where the lap belt can be tightened securely. This child restraint is installed in an aircraft seat the same way it is installed in the vehicle.

Use the child restraint only with F.A.A. certified equipment. Contact the airline prior to taking a child restraint on board in order to comply with their specific regulations.

5

## Understanding Your Vehicle

Your vehicle's features may be considerably different than those pictured here. Consult your vehicle owner's manual to help identify your vehicle's specific features.

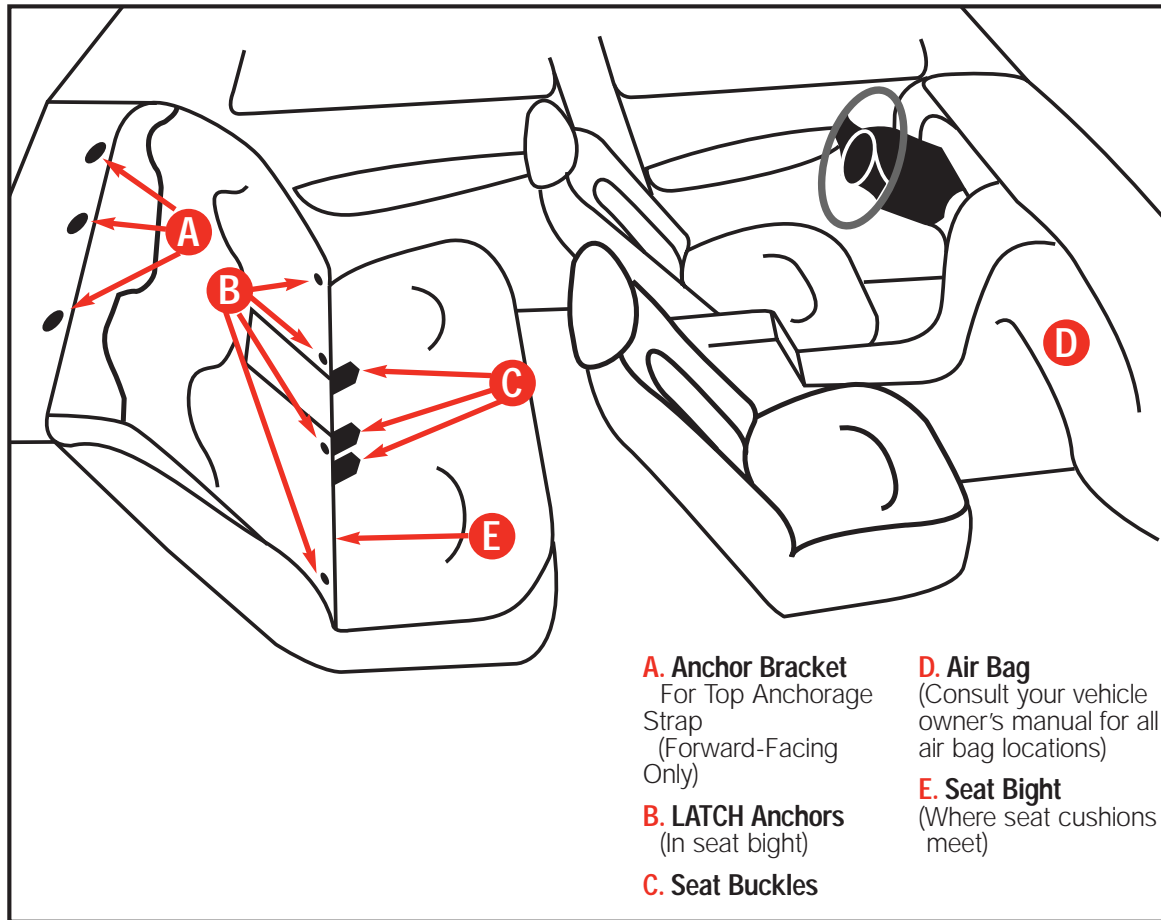

## Child Restraint Parts

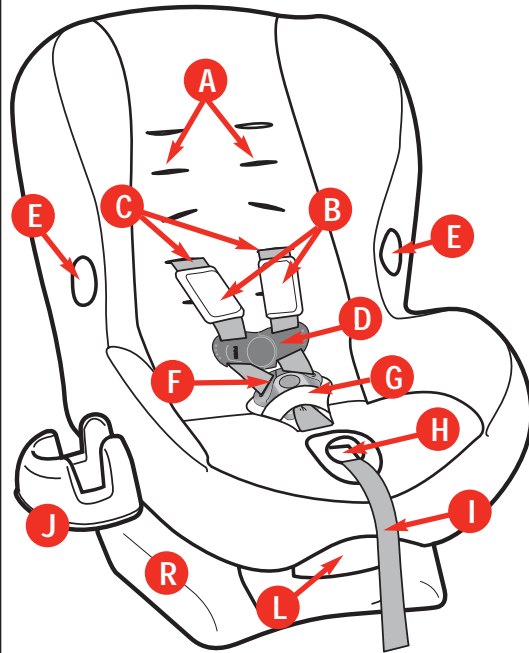

- |   |   |
|---|---|
| <b>A.</b> Harness Slots                     | <b>H.</b> Harness Release Lever               |
| <b>B.</b> Harness Covers (on select models) | <b>I.</b> Harness Adjustment Strap            |
| <b>C.</b> Harness Straps                    | <b>J.</b> Cup Holder (on select models)       |
| <b>D.</b> Harness Retainer                  | <b>K.</b> Instructions                        |
| <b>E.</b> Harness Strap Holders             | <b>L.</b> Recline Handle                      |
| <b>F.</b> Buckle                            | <b>M.</b> Top Anchorage (Tether) Strap & Hook |
| <b>G.</b> Buckle Cover (on select models)   |   |

8

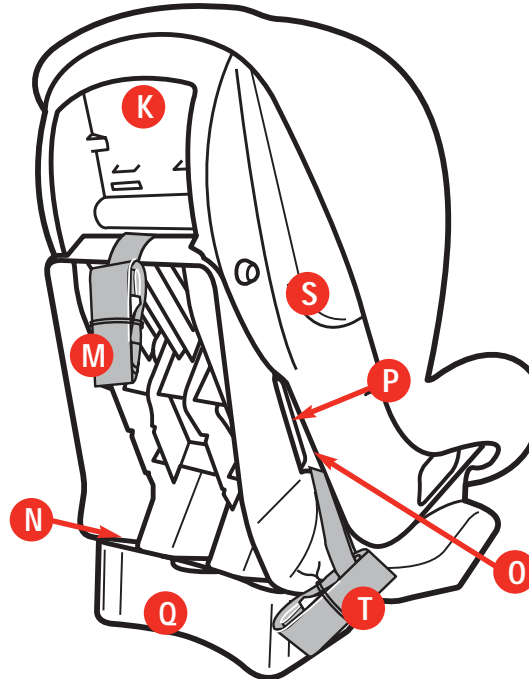

- |   |                      |
|---|----------------------|
| <b>N.</b> Locking Clip (inside recline foot)                                | <b>S.</b> Shell      |
| <b>O.</b> Splitter Plate (between shell and base, under harness guard door) | <b>T.</b> LATCH Belt |
| <b>P.</b> Shoulder Belt Lock-Off  |                      |
| <b>Q.</b> Recline Foot  |                      |
| <b>R.</b> Base  |                      |

9

## Choosing Restraint and Position

Your child's height, weight and age determine how your child restraint should be placed in the vehicle and which restraint should be used.

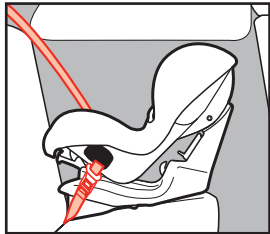

**5-35 lbs (2.3-16 kg)  
19-36 in. (48-91 cm)**

**Rear-Facing using 5-point harness**  
Child and child restraint face the back of the vehicle and are placed in the back seat.

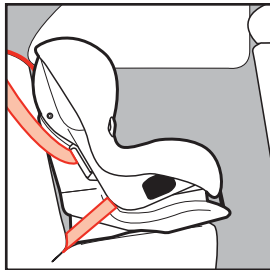

**22-40 lbs (10.1-18 kg)  
34-43 in. (85.1-110 cm)  
and Over 1 Year Old**

**Forward-Facing using 5-point harness**  
Child and child restraint face the front of the vehicle and are placed in the back seat.

## Reclining the Child Restraint

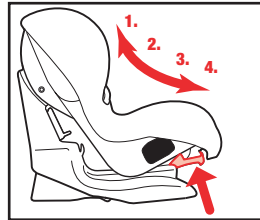

This child restraint has 4 recline positions: Upright, 2 semi recline positions, and reclined.

Squeeze recline handle to recline.

**Rear-Facing** - Must be fully reclined.

**Forward-Facing** - Can use any of the 4 positions.

## Accessories (on select models)

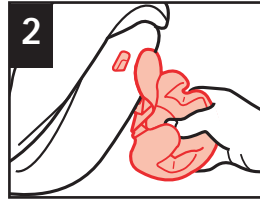

**2 Install Cup Holder (on select models):**  
Hook cup holder on side of shell. Make certain both top and bottom of cup holder snaps into place.

Cup holder can be installed on either side.

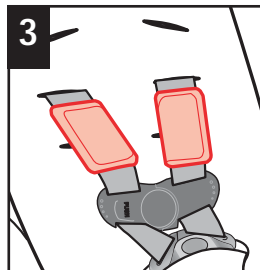

**3 Harness Covers (on select models):**  
Harness covers help provide comfort to the neck. For harness covers to fit correctly, you may have to fit the upper ends of the covers through the harness

slots. To remove, unthread harness from harness splitter plate. Slide covers off and reattach harness.

## Preparing Child Restraint to Fit Your Child

You **MUST** make these adjustments with your child before you install the child restraint in the vehicle.

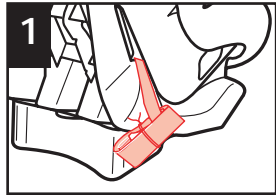

**1** Make sure LATCH belt packaging is pulled free of child restraint shell.

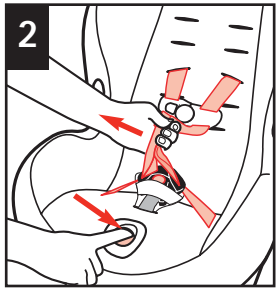

**2** Loosen harness by pushing down on the harness release lever while pulling out on the harness.

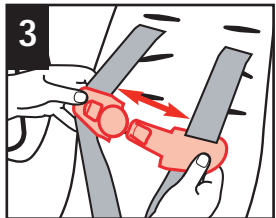

**3** Press on harness retainer release button and pull apart.

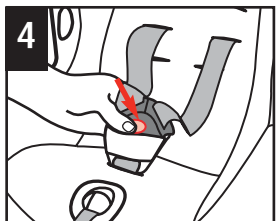

**4** Press red button on buckle to release the buckle plates. Hook harnesses on the harness strap holders on the sides of child restraint.

12



**5** Place the child's bottom and back flat against the child restraint. This will increase comfort and allow the harness to properly tighten.

### Check Harness Height

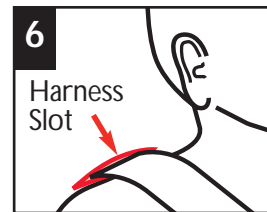

**Rear-Facing Position:** Harness slot must be **even with or just below** the shoulders.

If the bottom harness slots are above the child's shoulders, **do not** use this child restraint. Use an infant child restraint instead.

**Forward-Facing Position:** Harness slots must be **even with or just above** the shoulders.

If the top harness slots are below the child's shoulders, **do not** use this child restraint. Use a belt-positioning booster instead.

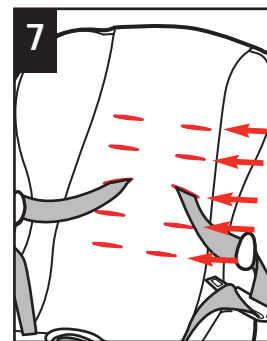

**7** Determine which set of harness slots works best for your child. Adjust if needed.

13 *continued on next page.*



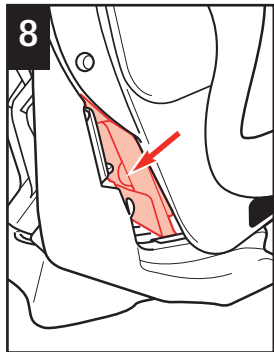

**8 To Change Harness Location:**

Place the child restraint into the fully reclined position. Locate the harness guard door and open it by pressing in on the door's tab.

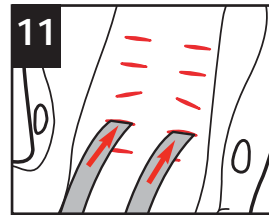

Pull harness through the harness slots from the front.

Rethread harness into new harness guide location. Refasten harness to splitter plate.



**Make sure harness is completely on splitter plate and it does not twist.**

Close and lock the harness guard door.

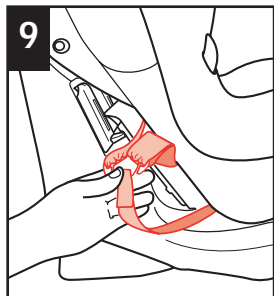

**9** Pull out the harness and splitter plate.

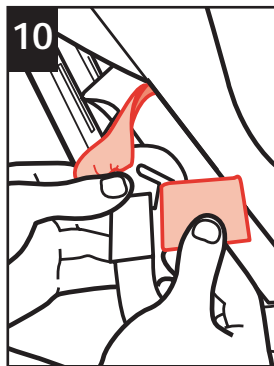

**10** Remove harness from splitter plate.

**⚠ WARNING**

**Failure to reattach the harness correctly, can result in serious injury or death.**

## Securing Your Child in the Child Restraint

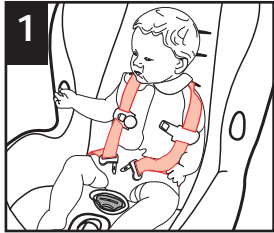

1 Position harness straps over the child's shoulders.

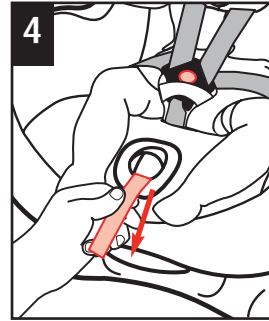

4 Pull on harness adjustment strap to tighten harness snugly.

**NOTE:** A snug strap should not allow any slack. It lies in a relatively straight line without sagging. It does not press on the child's flesh or push the child's body into an unnatural position.

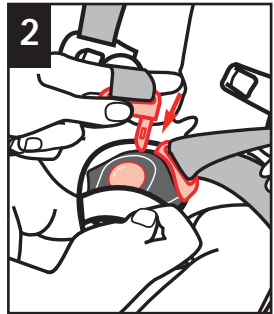

2 Push each buckle plate into buckle until you hear a "click". Remember to always pull up on harness straps to make sure buckle is locked tightly.



5 Position the harness retainer at mid-chest (even with arm pits), away from the child's neck.

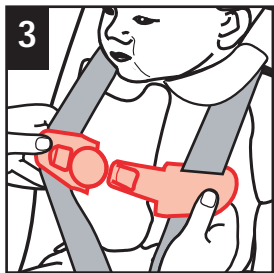

3 Snap the harness retainer together.

### **⚠ WARNING:**

**Failure to fasten and tighten the harness system correctly with each use can result in serious injury or death.**

## Removing Your Child From the Child Restraint

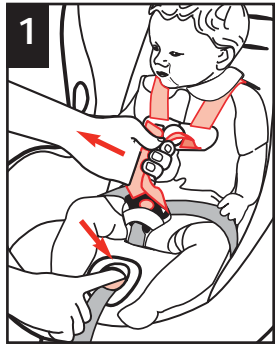

1 Loosen harness by pushing down on the harness release lever while pulling out on the harness.



2 Press on harness retainer release button and pull apart.

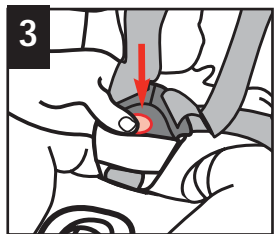

3 Press red button on buckle to release the buckle plates. Place harness over sides of child restraint. Remove child.

18

## Choosing LATCH or Vehicle Belts

### The LATCH System

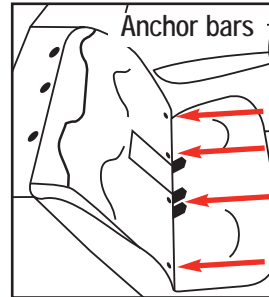

LATCH means Lower Anchors and Tethers for CHildren. Not all vehicles manufactured before September 2002 were equipped with LATCH.

The LATCH system allows a child restraint to be secured in the vehicle without using the vehicle belt system and can ONLY be used in vehicles that have the anchor bars installed.

Check your vehicle owners manual to see which seating positions may be equipped with the LATCH system.

### Vehicle Belts

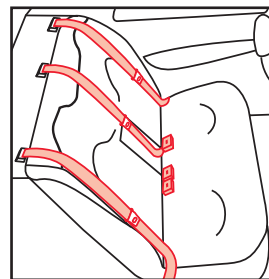

If LATCH is not an option, you will use your vehicle's belts. In most cases you will use the lap/shoulder belt combination.

There are some vehicle belts that will not work with a child restraint or will require special attention. See next page for specific instructions.

19

## Knowing Your Vehicle Belts

Not all vehicle belts will work with this child restraint. You must determine if your vehicles belts are compatible with this child restraint. If you will use the LATCH system, refer to the LATCH section.

### ELR - Emergency Locking Retractor Belts

**Definition:** These belts only lock in a sudden stop or crash. To see if you have this type of belt, pull on the lap belt, let it return part way, then pull on it again. If it moves freely, it is an ELR belt and the child restraint could work loose during normal driving. Refer to your vehicle owner's manual. Some ELR belts will convert to Automatic Locking Retractor (ALR) belts if you pull the belt all the way out. Refer to your vehicle owner's manual. ELR shoulder belts either require a locking clip or cannot be used with any child restraint.

ELR lap-only belts must be replaced with a manual belt; contact your vehicle dealer. A locking clip will not correct this problem.

### Automatic/Passive vehicle seat belts

Automatic (passive) 2-point belt has no lap belt. You must install a lap belt to secure a child restraint. You may also need to install an extra lap belt for an automatic 3-point belt. Refer to the vehicles owner's manual. A locking clip will not correct this problem.

### Vehicle belt too short

Contact your vehicle dealer for a seat belt extender.

### Belts in center of the door or side panel (A) or middle of the vehicle seat cushion (B).

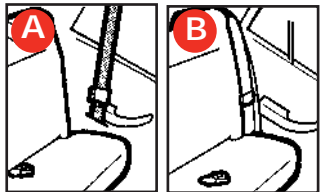

See "Locking Clip" section.

20

You must move the child restraint to another seating location. A locking clip will not fix this problem.

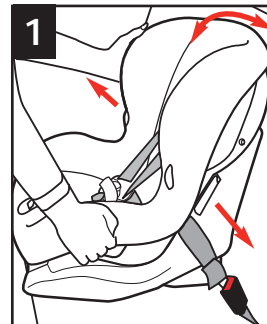

### Manual Belts

Manual lap belts are common in the center rear seat and can allow the child restraint to loosen when it is tilted or jarred. After tightening the lap belt securely, tilt and push the child

restraint forward and to both sides. If no loosening occurs, your child restraint should be secure.

If loosening does occur, try the following: If the buckle plate slides on the belt, turn

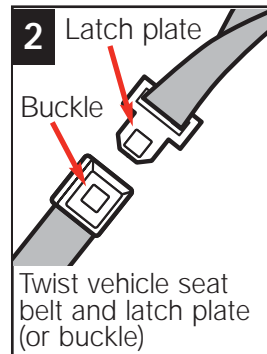

the buckle plate over. If the buckle slides, turn the buckle. Refasten the vehicle lap belt. The release button should face **out** after twisting so that it is easy to reach in an emergency.

Twist vehicle seat belt and latch plate (or buckle)

If the lap belt

continues to loosen, the child restraint must be moved to another location in the vehicle. A locking clip will not correct this problem; see your vehicle owner's manual.

### ⚠ WARNING

Failure to check and adjust the manual belt as described above can result in serious injury or death.

21

## Locking Clip: Rear-Facing Only

**NOTE:** Remove the locking clip when the seat belt is not being used with a child restraint. The locking clip is located on the recline foot. A locking clip will not fix all types of seat belt problems. The locking clip is not used in the forward-facing mode of use because this child restraint uses shoulder belt lock-offs.

Before you put your child restraint in the vehicle in the rear-facing mode of use, buckle the lap/shoulder belt. Pull on the lap belt portion. If it loosens or slips, you must either use a locking clip to hold the seat belt tight or move the child restraint to another seating location.

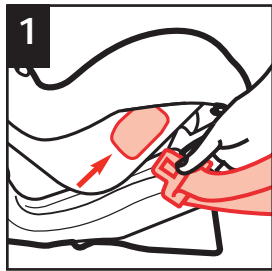

1 Thread both vehicle lap and shoulder belts through the slot (as shown) and out other side. Buckle. Pull up on shoulder belt until all slack is out and lap belt is tight.

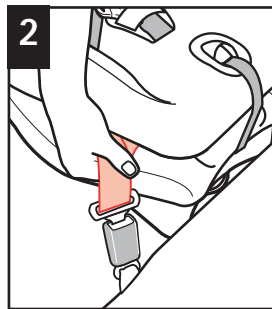

2 Grasp both vehicle belts together just behind the buckle plate and unbuckle. **NOTE:** If the buckle plate ends up behind the child restraint, grasp the belts to the outside of the child restraint, as close to the buckle plate as possible.

22

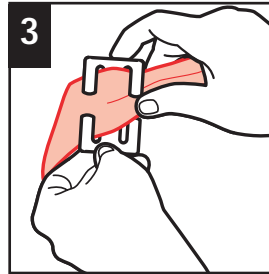

3 Thread both portions of the vehicle belt onto the locking clip.

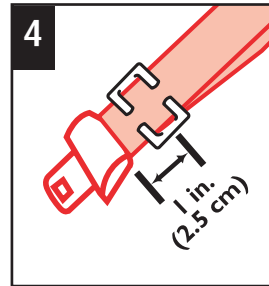

4 Position locking clip about 1 in. (2.5 cm) from vehicle belt's buckle plate.

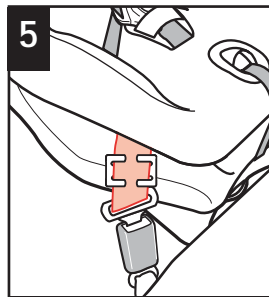

5 Rebuckle belt. Lap belt portion should now be tight. If not, remove locking clip and repeat all steps.

23

Rear Facing Use: 5-35 lbs. (2.3-16 kg), 19-36" (48-91 cm)

## Rear-Facing Use

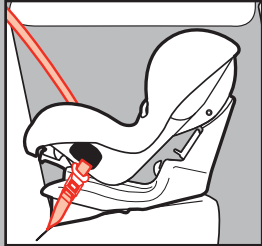

Lap/Shoulder Belt

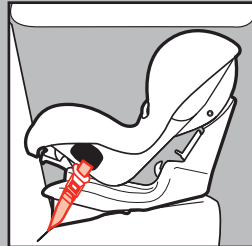

Lap Belt

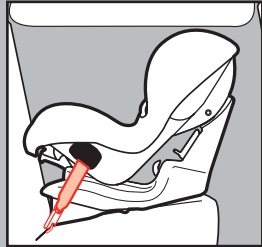

LATCH Belt

Refer to the "Choosing Restraint and Position" section to determine if your child should be in the rear-facing position.

### **⚠ WARNING:**

This child restraint must always face the rear of the vehicle and be in the fully reclined position when the child weighs between 5-35 lbs. (2.3-16 kg) and is less than one year old.



Never place a child rear-facing in a seating position with an active frontal airbag.

## Rear-Facing Installation

After deciding whether to use your Vehicle Belts or LATCH, be sure to read the warnings below as they pertain to both systems.

The recline foot **MUST** be in the rear-facing position.

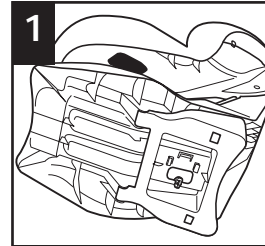

To move the recline foot to the rear-facing position, lay restraint on it's side.

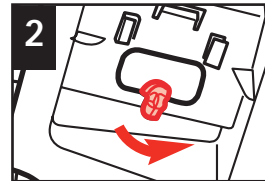

Unlock the recline foot by turning the knob 1/4 turn.

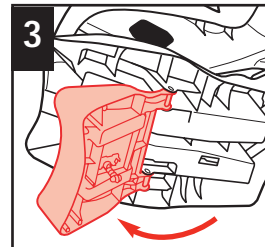

Rotate the recline foot to the front of the restraint and lock into place.

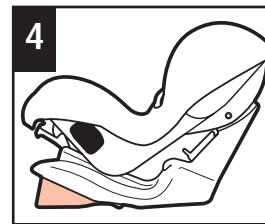

Correct position of the recline foot is shown.

Rear Facing Use: 5-35 lbs. (2.3-16 kg), 19-36" (48-91 cm)

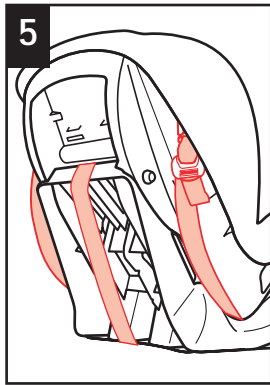

**5** When LATCH is not being used, fasten LATCH hooks on side of child restraint as shown.

**Do Not Use** the top anchorage strap in the rear-facing position.

Hook top anchorage strap to recline foot (see "Adjusting the Top Anchorage Strap" section).

**⚠ WARNING:**  
**A loose top anchorage (tether) strap can result in serious injury or death.**  
**Loose LATCH hooks can result in serious injury or death.**

## Rear-Facing Installation with Vehicle Belt:

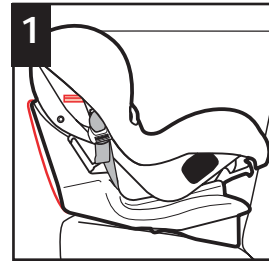

**1** Place child restraint rear-facing in the back seat. With child restraint in the fully reclined position, make sure level line on side of shell is level with ground. Adjust child restraint if needed.

**NOTE:** Hook top anchorage strap to recline foot (see "Adjusting the Top Anchorage Strap" section).

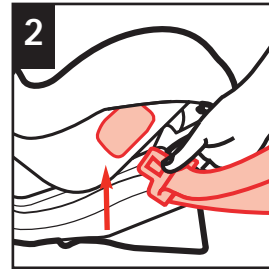

**2** Thread the vehicle lap or lap/shoulder belt combination through the rear-facing belt slot.

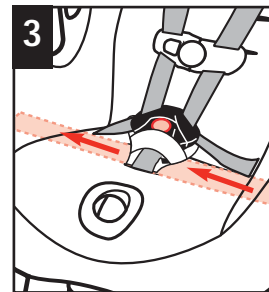

**3** Thread UNDER seat pad behind the crotch strap, between crotch strap and rear harness slot, and out opposite side. Buckle vehicle belt.

**Do not place vehicle belt over child's legs.**

*27 continued on next page.*

Rear Facing Use: 5-35 lbs. (2.3-16 kg), 19-36" (48-91 cm)

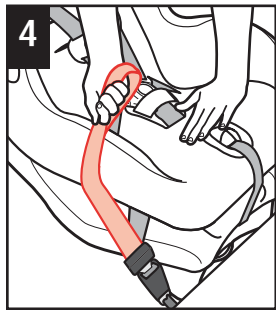

4 Push down firmly on the child restraint and pull up on belt to tighten. For a manual belt, refer to "Knowing your Vehicle Belt" section. Pull up on shoulder strap to remove any slack.

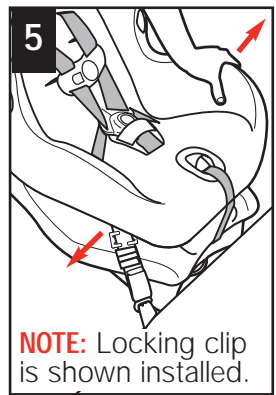

5 With weakest hand at belt path, tilt and push the child restraint forward and back, and from side to side. If the seat belts do not loosen, your child restraint should be secure.

**NOTE:** Locking clip is shown installed.

**NOTE:** Some "play" from front to back or about an inch from side to side is acceptable. If it moves more, review "Knowing your Vehicle Belts" and "The Locking Clip" sections.



6 After checking for hot seat and buckles, secure child as described in "Securing Your Child in the Child Restraint" section.

**⚠ WARNING**  
Using this child restraint in any vehicle seat where the lap belt cannot be tightened securely and properly or where it can be loosened by pulling on it can result in serious injury or death.

## Rear-Facing Installation with LATCH

**NOTE:** Do not use the LATCH system along with the adult lap or lap/shoulder belt.

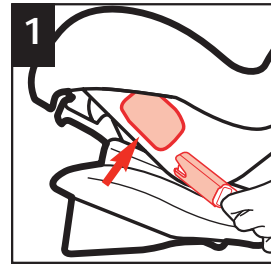

1 To thread the LATCH belt, put belt end with connector and adjuster through the rear-facing belt path slot.

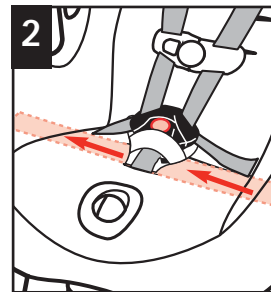

2 Thread UNDER seat pad behind the crotch strap and out opposite side.

**Do not place vehicle belt over child's legs.**

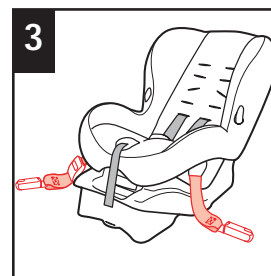

3 Adjuster **MUST** be on the **left side** of child restraint as shown. **DO NOT** twist belt.

Rear Facing Use: 5-35 lbs. (2.3-16 kg), 19-36" (48-91 cm)



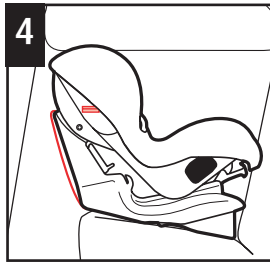

4 Place child restraint rear-facing in the back seat. With child restraint in the fully reclined position, make sure level line on side of shell is level with ground. Adjust

child restraint if needed.

**NOTE:** Hook top anchorage strap to recline foot (see "Adjusting the Top Anchorage Strap" section).

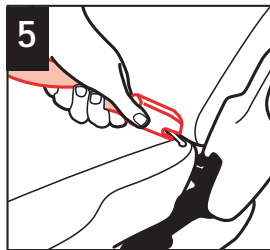

5 Fasten one LATCH belt connector to the anchor in the vehicle seat located in the vehicle seat bight. Repeat for other side of child restraint. See your vehicle owner's manual for more information.

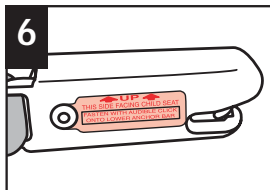

**NOTE:** Make sure arrows on connectors are facing up.

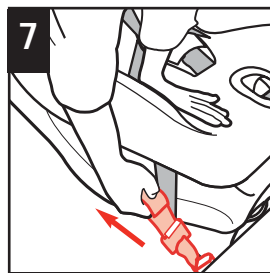

7 Push down firmly on the child restraint and pull up on the loop to tighten belt.

30

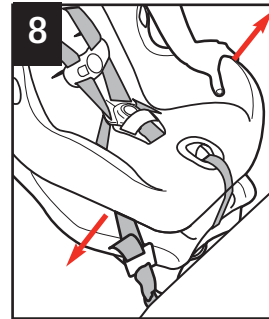

8 With weakest hand at belt path, tilt and push the child restraint forward and back, and from side to side. If the LATCH belts do not loosen, your child restraint should be secure.

**NOTE:** Some "play" from front to back or about an inch from side to side is acceptable.

If the child restraint does not remain tight, do not use the child restraint in this seating location with this LATCH system.

**! WARNING**

**LATCH hooks MUST be securely fastened. Failure to do this can result in serious injury or death.**



9 After checking for hot seat and buckles, place child in child restraint. See "Securing Your Child in the Child Restraint" section.

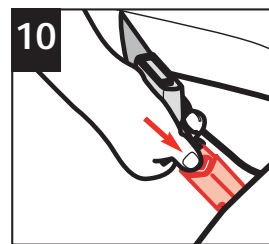

**To Release LATCH:**

Remove LATCH from vehicle anchors by pressing the red release button on each connector.

31

Rear Facing Use: 5-35 lbs. (2.3-16 kg), 19-36" (48-91 cm)

Forward-Facing Use: 22-40 lbs. (10.1-18 kg), 34-43" (85.1-110 cm), Over 1 year of age.

### Forward-Facing Use

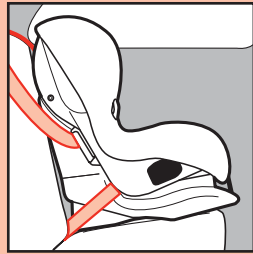

Lap/Shoulder Belt

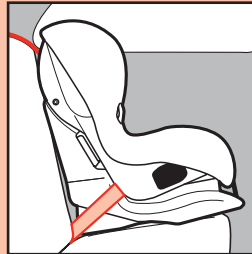

Lap Belt

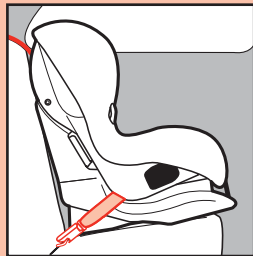

LATCH Belt

Refer to the "Choosing Restraint and Position" section to make sure your child is at the proper weight and height to face forward.

### ⚠ WARNING:

Using this child restraint in any vehicle seat where the lap or LATCH belts cannot be tightened securely and properly or where it can be loosened by pulling on it can result in serious injury or death.

Check vehicle owner's manual for more information about airbag/child restraint use.

### Forward-Facing Installation

After deciding whether to use your Vehicle Belts or LATCH, be sure to read the warnings below as they pertain to both systems.

The recline foot **MUST** be in the forward-facing position.

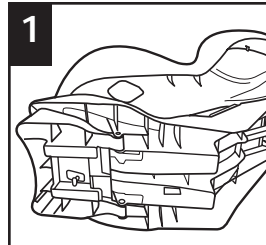

1 To move the recline foot to the forward-facing position, lay restraint on it's side.



2 Unlock the recline foot by turning the knob 1/4 turn.

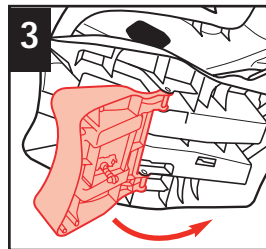

3 Rotate the recline foot to the back of the restraint and lock into place.

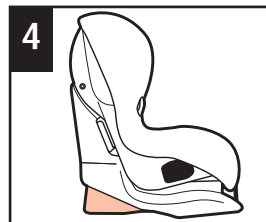

4 Correct position of the recline foot is shown.

Forward-Facing Use: 22-40 lbs. (10.1-18 kg), 34-43" (85.1-110 cm), Over 1 year of age.

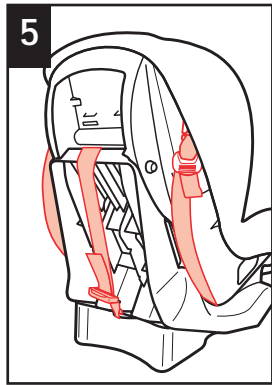

When LATCH is not being used, fasten LATCH hooks on side of child restraint as shown. Hook top anchorage strap to recline foot (see "Adjusting the Top Anchorage Strap" section).

**⚠ WARNING:**  
 A loose top anchorage (tether) strap can result in serious injury or death.  
 Loose LATCH hooks can result in serious injury or death.

## Forward-Facing Installation with Vehicle Belts

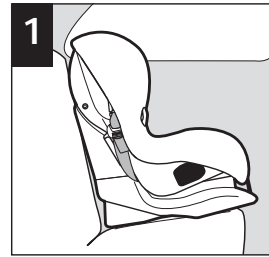

Place child restraint **flush** against the back of the vehicle seat **forward-facing** in the back seat.

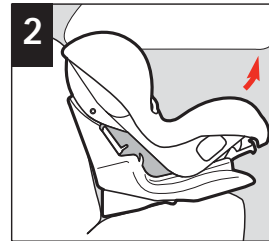

Reline the child restraint to open the belt bath area.

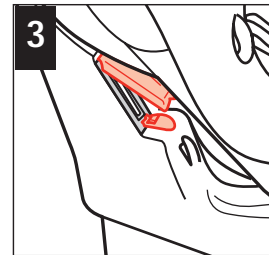

Open the lock-off opposite of the vehicle buckle by press down on the lock-off's tab.

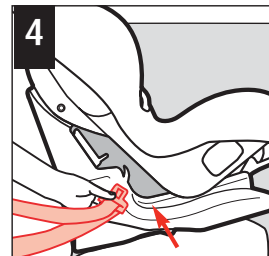

Thread the vehicle lap belt or lap/shoulder belt combination through the belt path and out other side. Buckle.

Forward-Facing Use: 22-40 lbs. (10.1-18 kg), 34-43" (85.1-110 cm), Over 1 year of age.

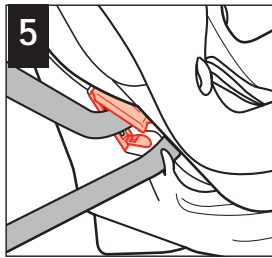

Thread the shoulder belt through the lock-off on the **opposite side of the vehicle buckle**. Close the lock-off. Lock by lifting up the tab to the locked position.

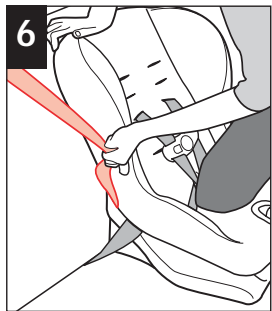

Place one knee in the child restraint and push down firmly while pulling up on shoulder belt to tighten. For a manual belt, refer to "Knowing your Vehicle Belt" section.

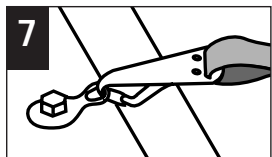

With knee still in child restraint, attach hook to anchor in vehicle. Push down firmly and tighten top

anchorage strap.

To adjust top anchorage strap: See "Adjusting Top Anchorage Strap" section.

**NOTE:** If your vehicle does not have an anchor bracket, hook the top anchorage strap's hook to recline foot (see "Adjusting the Top Anchorage Strap" section).

36

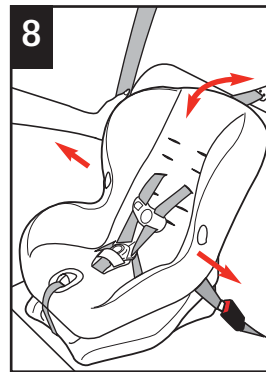

With weakest hand at belt path, tilt and push the child restraint forward and back, and from side to side. If the seat belts do not loosen, your child restraint should be secure.

**NOTE:** Some "play" from front to back or about an inch from side to side is acceptable. If it moves more, review "Knowing Your Vehicle Belts".

### **⚠ WARNING**

**Using this child restraint in any vehicle seat where the lap belt cannot be tightened securely and properly or where it can be loosened by pulling on it can result in serious injury or death.**



After checking for hot seat and buckles, place child in child restraint. See "Securing Your Child in the Child Restraint" section.

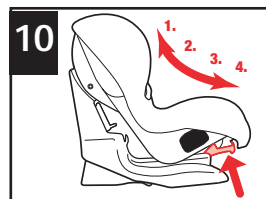

Recline the child restraint to any of the 4 positions.

37

Forward-Facing Use: 22-40 lbs. (10.1-18 kg), 34-43" (85.1-110 cm), Over 1 year of age.

## Forward-Facing Installation with LATCH Belt

**NOTE:** Do not use the LATCH system along with the adult lap or lap/shoulder belt.

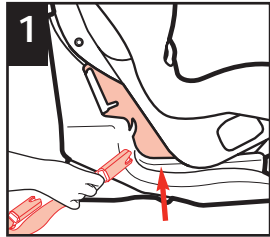

1 Recline child restraint. To thread the LATCH belt, put belt end with connector and adjuster through the forward-facing belt path slot.

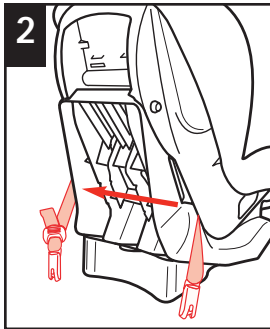

2 Adjuster **MUST** be on the **left side** of child restraint as shown. **DO NOT** twist belt.

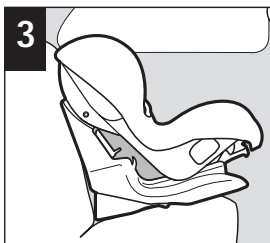

3 Place child restraint **flush** against the back of the vehicle seat **forward-facing** in the back seat.

38

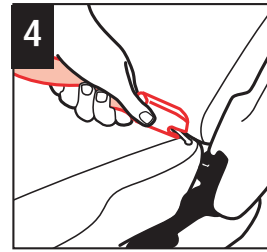

4 Fasten one LATCH belt connector to the anchor in the vehicle seat located in the vehicle seat bight. Repeat for other side of child restraint. See your vehicle owner's manual for more information.

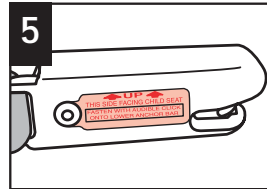

5 **NOTE:** Make sure arrows on connectors are facing up.

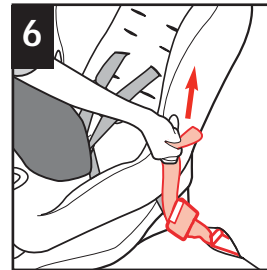

6 Place one knee in the child restraint and push down firmly while pulling up on loop end of the LATCH belt to tighten.

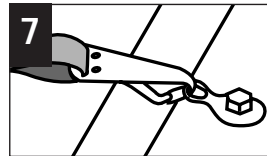

7 With knee still in child restraint, attach hook to anchor in vehicle. Push down firmly and tighten top anchorage strap. To adjust top anchorage strap: See "Adjusting Top Anchorage Strap" section.

39 continued on next page.

Forward-Facing Use: 22-40 lbs. (10.1-18 kg), 34-43" (85.1-110 cm), Over 1 year of age.

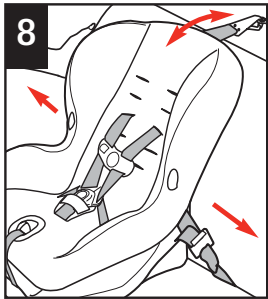

With weakest hand at belt path, tilt and push the child restraint forward and back, and from side to side. If the LATCH belts do not loosen, your child restraint should be secure.

**NOTE:** Some "play" from front to back or about an inch from side to side is acceptable.

If the child restraint does not remain tight, do not use the child restraint in this seating location with this LATCH system.

**⚠ WARNING**

**LATCH hooks MUST be securely fastened. Failure to do this can result in serious injury or death.**



After checking for hot seat and buckles, place child in child restraint. See "Securing Your Child in the Child Restraint" section.

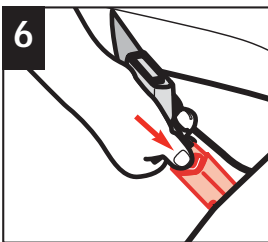

**To Release LATCH:**  
Remove LATCH from vehicle anchors by pressing the red release button on each connector.

40

**Adjusting the Top Anchorage Strap**

The top anchorage strap is used for the forward-facing position only.

Most vehicles made after 9/1/99 already have the anchor hardware for a top anchorage strap. Refer to your owner's manual or call your dealer.

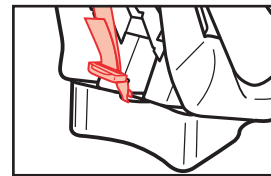

**Storage of Top Anchorage Strap:**  
Hook the top anchorage strap hook to the recline foot in either forward-

facing or rear-facing mode of use.

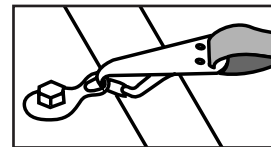

**To Attach Top Anchorage Strap:**  
Put knee in child restraint and push down; attach hook to anchor in vehicle.

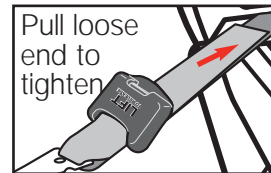

**To Adjust Top Anchorage Strap:**  
To tighten; pull on free end of top anchorage strap.

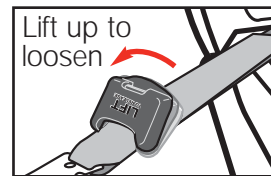

To loosen; lift up on top anchorage lock and push lock toward top anchorage hook.

41

Forward-Facing Use: 22-40 lbs. (10.1-18 kg), 34-43" (85.1-110 cm), Over 1 year of age.

## Removing Seat Pad for Cleaning

### **⚠ WARNING**

**Do not use this child restraint without the seat pad. Failure to do this can result in serious injury.**

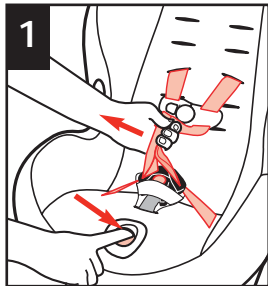

1 Loosen harness by pushing down on the harness release lever while pulling out on the harness. Undo harness retainer and unbuckle the buckle.

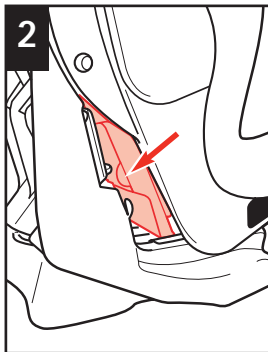

2 Place the child restraint into the reclined position. Locate the harness guard door and open it by pressing in on the door's tab.

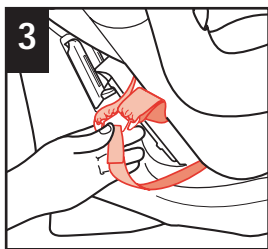

3 Pull out the harness and splitter plate.

42

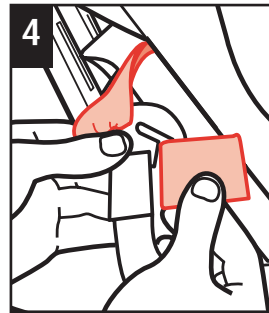

4 Remove harness from splitter plate.

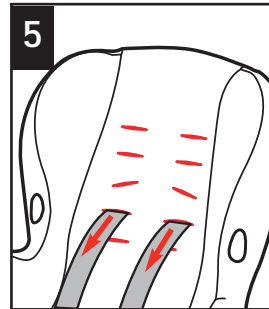

5 From the front, pull harness out of shell and pad.

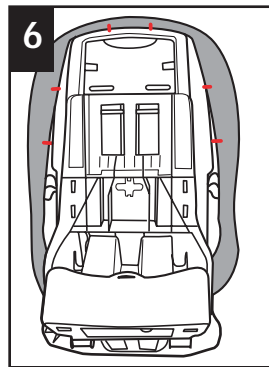

6 From the back of the restraint, pull pad out from the tabs (shown in red).

43 *continued on next page.*

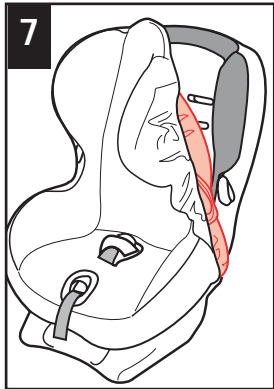

7 From the front, pull pad off the shell, starting at the top. Lift pad over the harness strap holders and work the pad around the harness adjustment cover.

Hand wash with warm sudsy water, rinse clean and air dry. Do not use bleach or other harsh cleaners. Do not dry clean.

Spot clean harness straps. Do not machine wash.

Replace pad by reversing order. Reinstall harness (see "Preparing Child Restraint to Fit Your Child" section).

## Troubleshooting

### ✓1. If your child restraint is not held securely by the belt:

Press down firmly on the child restraint and remove all the slack in the belt. Make sure the belt buckle is not up against the child restraint where the belt cannot be tightened. Review "Locking Clip" and "Adjusting the Top Anchorage Strap" sections. If you cannot secure the child restraint tightly, move it to another seating location.

### ✓2. If the child restraint buckle or harness adjustment lever sticks or you cannot get the straps tight enough around child:

DO NOT LUBRICATE. Check around buckle and harness release lever for dropped food, sticky spilled drinks, dirt, leaves, etc. Clean with warm water and/or remove object with tweezers. If you cannot get the harness to adjust and remain tight with the buckle securely locked, do not use the child restraint.

### ✓3. If your harness twists or ropes:

Straighten the harness each time you put your child in the seat to help prevent twisting. Lock the buckle and tighten harness and it will be ready for next use.



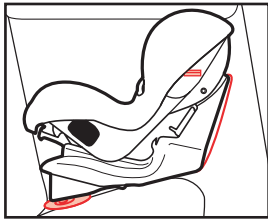

✓4. If your infant sits too upright in the rear-facing position: If your vehicle seat slopes so much that your infant is sitting upright, you may place a rolled towel under the front of the

child restraint so that the level line on the shell's side is level (horizontal). Check often to be sure padding is still in place and the vehicle belt is tight.

### ⚠ WARNING

Using padding that tilts the base of the child restraint farther back than the level-to-ground line can result in serious injury or death.

## Warranty

Dorel Juvenile Group, Inc. (DJG) warrants this product to the original retail purchaser as follows:

This product is warranted against defective materials or workmanship for one year from the date of original purchase. **An original receipt is required to validate your warranty.** DJG will, at its option, provide replacement parts or replace this product. DJG reserves the right to substitute if the part or model has been discontinued.

To make a claim under this warranty you may contact us at [www.maxi-cosi.com](http://www.maxi-cosi.com), fax us at 1-800-207-8182 24 hours a day, write to DJG, Consumer Relations Department, P. O. Box 2609, Columbus, IN 47202-2609, or call 1-800-951-4113 from 7:00 a.m. to 6:00 p.m. EST Monday through Thursday and from 7:00 a.m. to 4:30 p.m. on Friday. **Proof of purchase is required and shipping charges are the responsibility of the consumer.**

### Warranty Limitations:

This warranty does not include damages which arise from misuse or abuse of this product.

### Limitation of Damages:

The warranty and remedies as set forth are exclusive and in lieu of all others, oral or written, expressed or implied. In no event will DJG or the dealer selling this product be liable to you for any damages, including incidental or consequential damages, arising out of the use or inability to use this product.

### Limitation of warranties and other warranty terms and state law rights:

Any implied warranties, including implied warranties of the merchantability and fitness for a particular purpose, shall be limited to the duration and terms of the express written

warranty. Some states do not allow limitations as to how long an implied warranty lasts or the exclusion or limitation of incidental or consequential damages, so the above limitations may not apply to you. This warranty gives you specific legal rights, and you may have other rights, which vary from state to state. Neither DJG nor the dealer selling this product authorized any person to create for it any other warranty, obligation, or liability in connection with this product.

PLEASE COMPLETE AND MAIL THE PRE-ADDRESSED OWNER REGISTRATION CARD WITHIN (30) DAYS OF PURCHASE TO EXPEDITE WARRANTY CLAIMS AND TO VERIFY THE ORIGINAL DATE OF PURCHASE.

## Replacement Parts Order Form

Complete the form below. Your model number with color code and manufacturer date code **MUST** be included on the form to ensure proper replacement parts. Your model number with color code and the date code can be found on a sticker on the bottom of the child restraint. Payment in U.S. dollars must accompany your order. Choose parts needed from the list on the next page. Return the form with payment to:

**Dorel Juvenile Group, Inc.**  
**Consumer Relations Department**  
**P.O. Box 2609**  
**Columbus, IN 47202-2609**

Fax orders to: 1-800-207-8182

Please make money orders payable to Dorel Juvenile Group, Inc. Fill in the area below to charge to Visa or Mastercard. We do not accept personal checks or Discover Card. All outside of U.S. and Canada **MUST** use credit card.

Ship To (Please Print): \_\_\_\_\_

Name: \_\_\_\_\_

Address: \_\_\_\_\_

City: \_\_\_\_\_

State/Province: \_\_\_\_\_ Zip: \_\_\_\_\_

Telephone: \_\_\_\_\_

Email Address: \_\_\_\_\_

**We **MUST** have this information to process your order:**

**Model Number**

**(5 digits & 3 letters):** \_\_\_\_\_

**Manufacture Date (mm/dd/yyyy):**

\_\_\_\_\_

## Free Manuals Download Website

<http://myh66.com>

<http://usermanuals.us>

<http://www.somanuals.com>

<http://www.4manuals.cc>

<http://www.manual-lib.com>

<http://www.404manual.com>

<http://www.luxmanual.com>

<http://aubethermostatmanual.com>

Golf course search by state

<http://golfingnear.com>

Email search by domain

<http://emailbydomain.com>

Auto manuals search

<http://auto.somanuals.com>

TV manuals search

<http://tv.somanuals.com>