



# mellerware®

TRENDS FOR LIFE

Aromatic Coffee Bean Grinder



complies with  
INTERNATIONAL  
IEC60355  
SAFETY SPECIFICATIONS

**m**  
120 W

**CE**  
2 YEAR  
GUARANTEE

Model:  
29105

**PLEASE READ ALL INSTRUCTIONS BEFORE USE**

**2 year guarantee**



## GENERAL DESCRIPTION

- A. Main unit
- B. On/off switch
- C. Mill beaker
- D. Blades
- E. Main cord
- F. Cover
- G. Cord storage

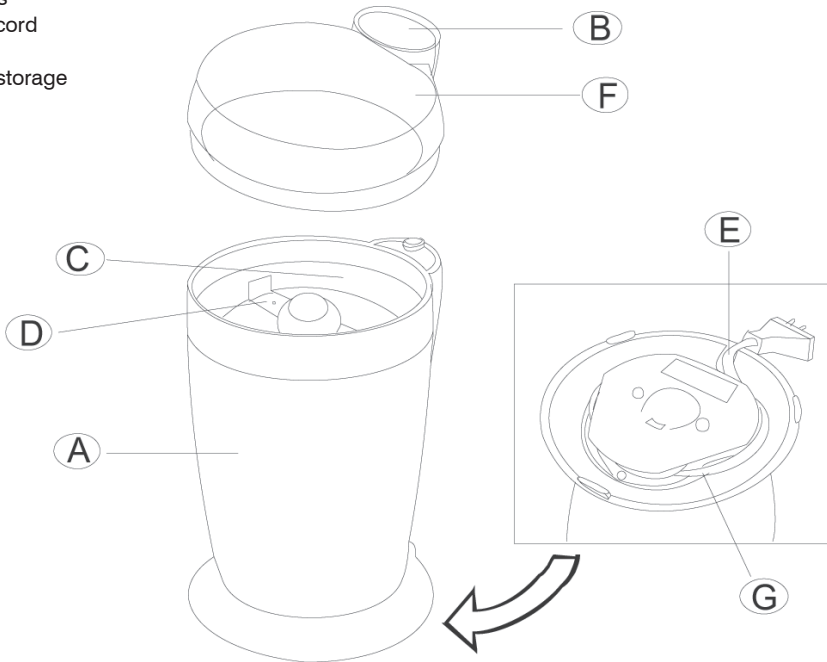

## IMPORTANT SAFETY INSTRUCTIONS

When using electrical appliances, basic safety precautions should always be followed to reduce the risk of fire, electrical shock and personal injury.

- Read all instructions carefully.
- To protect against electrical shock, do not immerse cord, plug or unit in water or other liquid.
- For domestic use only. Do not use outdoors.
- Make sure the power cord is placed in a safe way so no one can trip over it.
- In the case of damage to the appliance or the power cord, we recommend you discontinue using it and return it to the store. A damaged power cord can only be repaired by the repair service.
- Keep an eye on the grinder when children are in the vicinity.
- Do not let cord hang over edge of table or counter, or touch hot surfaces, including the stove.

- Do not place on or near a hot gas or electric burner, or a heated oven.
- To disconnect, turn power select switch to "0" (OFF), then remove plug from wall outlet.
- This product is intended for household use only. Industrial or commercial use invalidates the warranty.

## CLEANING

- First unplug the appliance
- Clean the appliance after every use.
- Never use caustic or abrasive cleaning agents.
- The motor base and stainless steel cup can be wiped clean with a damp cloth.

## NEVER SUBMERGE THE MOTOR BASE UNDER WATER OR ANY OTHER LIQUID.



## IMPORTANT

1. Please read the instructions for use carefully in conjunction with the illustrations before using the appliance.
2. Check if the voltage indicated on the appliance corresponds to the mains voltage in your home.
3. The coffee mill cannot be switched on until the cover has been placed in position.
4. Do not take off the cover before the blades have come to a complete standstill.
5. Clean the mill beaker regularly. But ensure never to immerse the appliance in water or other liquids. Do not rinse either. You can clean the appliance with a damp cloth after removing the plug from the mains socket.
6. Do not operate the coffee mill for longer than 1 minute continuously as this could cause overheating. Let the motor cool down (for 10-15 mins) after long operation before you continue.
7. Switch off the appliance before changing accessories or approaching parts which move in use;
8. Do not fill water and any other liquid into the mill beaker.
9. If the supply cord is damaged, it must be replaced by the manufacturer or its service agent or a similarly qualified person in order to avoid a hazard.
10. This appliance is not intended for use by children or other persons without assistance or supervision if their physical, sensory or mental capabilities prevent them from using it safely. Children should be supervised to ensure that they do not play with the appliance.

## HOW TO OPERATE

1. Fill the mill beaker (fig. 2)

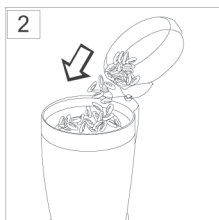

Do not fill higher than two or three millimeters below the rim. You may use the cover for this purpose.

A maximum filling results in a quantity of ground coffee which is enough for about 10 cups.

2. Place the cover (fig. 3)

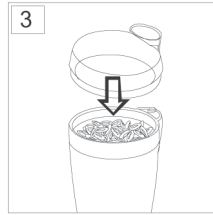

3. Insert the main plug into a wall socket.
4. Holding the coffee mill with both hands, press and hold switch (B) (fig. 4)



With a maximum filling the operation takes about 30 seconds. The longer you continue the operation, the finer the results will be. (Note: do not over-process!)

5. Release switch (B)
6. Remove the main plug from the wall-socket.
7. Tap the cover to remove ground coffee sticking to it (fig. 5). Then open the coffee mill (fig. 6).

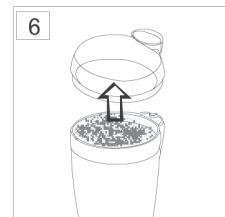
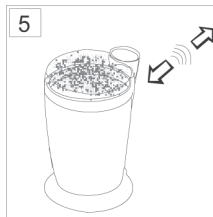

## CORD STORAGE

You can store excess main cord by winding around the bottom of the main unit. (Fig. 7).





## creative housewares

27 Nourse Avenue Epping 2 Cape Town  
P.O. Box 975 Eppindust 7475 South Africa  
Tel: +27 21 534 8114 Fax: +27 21 534 8086  
Service Centre Share Call: 086 111 5006  
web: [www.creativehousewares.co.za](http://www.creativehousewares.co.za)

## Free Manuals Download Website

<http://myh66.com>

<http://usermanuals.us>

<http://www.somanuals.com>

<http://www.4manuals.cc>

<http://www.manual-lib.com>

<http://www.404manual.com>

<http://www.luxmanual.com>

<http://aubethermostatmanual.com>

Golf course search by state

<http://golfingnear.com>

Email search by domain

<http://emailbydomain.com>

Auto manuals search

<http://auto.somanuals.com>

TV manuals search

<http://tv.somanuals.com>