

mellerware®

makes life easier

SMOOTH MOVES
epilator
& shaver



2-in-1 Rechargeable
epilator/shaver

2 Speed settings

Charging stand



complies with
INTERNATIONAL
IEC60335
SAFETY REGULATIONS



2 YEAR
GUARANTEE

Model:
20610

GENERAL DESCRIPTION

- A. Sensitive area cap
- B. Massaging element
- C. Epilating head
- D. Release button
- E. Fashionable LED light
- F. Switch

- G. Body
- H. Indicator light
- I. Transparent cover
- J. Shaving head
- K. Cleaning brush
- L. Adaptor
- M. Charging base

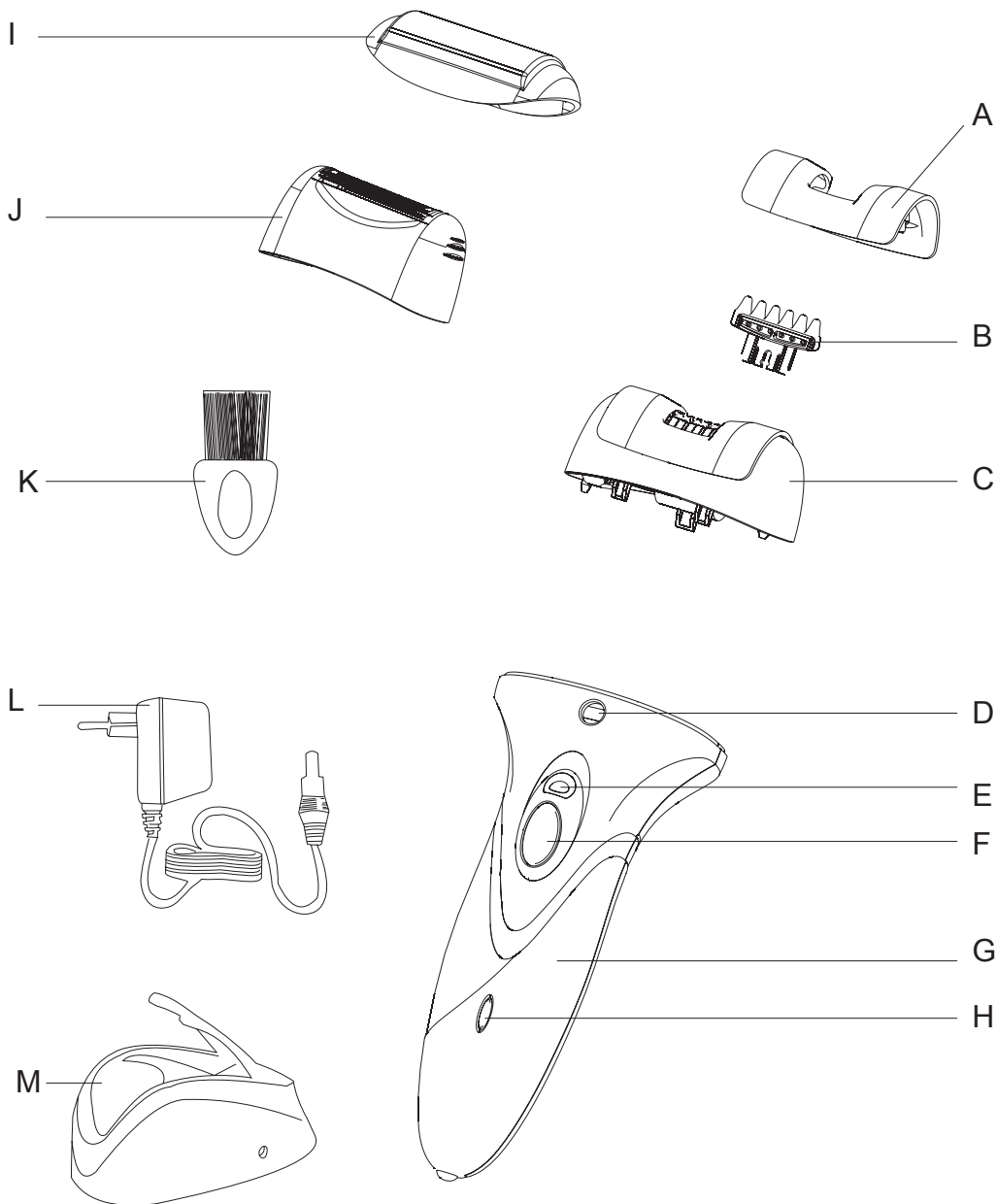

Important

Read this user manual carefully before you use the appliance and save it for future reference.

Danger

Keep the appliance and adaptor dry.
Do not use the appliance near or over a wash-basin or bath filled with water.
Do not use the appliance in the bath or in the shower.

WARNING

Check if the mains voltage indicated on the appliance corresponds to the local mains voltage before you connect the appliance.

Only use the appliance in combination with the adaptor supplied.

Do not use the appliance if the adaptor or the appliance itself is damaged.

This appliance is not intended for use by persons (including children) with reduced physical, sensory or mental capabilities, or lack of experience and knowledge, unless they have been given supervision or instruction concerning use of the appliance by a person responsible for their safety.

Children should be supervised to ensure that they do not play with the appliance.

Caution

1. Only epilate the underarms and bikini line with the sensitive area cap attached.
2. To prevent damage, and injuries, keep the running appliance away from scalp hair, eyebrows, eyelashes, clothes, threads, cords, brushes, etc.
3. Do not use the appliance on irritated skin or skin with varicose veins, rashes, spots, moles (with hair) or wounds without consulting your doctor first. People with a reduced immune response or people who suffer from diabetes mellitus, haemophilia or immunodeficiency should also consult their doctor first.
4. Your skin may become a little red and irritated the first few times you use the epilator. This phenomenon is absolutely normal and quickly disappears. As you use the appliance more often, your skin gets used to epilation, skin irritation decreases and regrowth becomes thinner and softer. If the irritation has not disappeared within three days, we advise you to consult a doctor.

5. Always check the shaving head before you use the appliance. Do not use the shaving head if the foil is damaged, as this may cause injury.
6. This appliance contains NIMH rechargeable batteries. So you should dispose it properly in order not to harm the environment.
7. Do not expose the appliance to temperatures lower than 5°C or higher than 35°C
8. Regular cleaning and proper maintenance ensure optimal results and a long life for the appliance.

CHARGING

1. The appliance can be directly charged from the adaptor (Fig.2), it can be also charged from the adaptor putting on the charging base (Fig.3).
2. Charge the batteries at least 10 hours before you use the appliance for a cordless operating time of up to 40 minutes.
3. Do not charge the appliance for more than 24 hours. Make sure the appliance is switched off while charging.

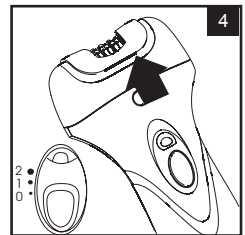
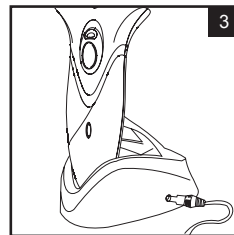
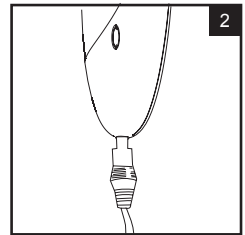
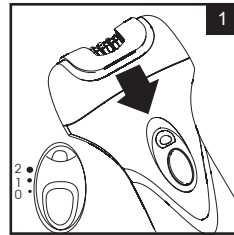

USING THE APPLIANCE

EPILATION

1. Epilation is easier just after a bath or shower. Make sure your skin is completely dry when you start to epilate.
2. When you use the appliance for the first time, we advise you to try it out on an area

with only light hair growth. This helps you get accustomed to the epilation process.

3. For optimal epilating results, the hair should not be longer than 10mm.

To epilate longer hair:

Shorten the hair to a maximum length of 10mm with a trimmer. In this case, you can start to epilate right away.

Epilating the underarms and bikini line:

This epilator comes with a sensitive area cap that reduces the number of active epilating discs. This makes the appliance ideal for epilating the more delicate areas of the body, such as the underarms and bikini line.

1. Put the sensitive area cap on the epilating head (Fig.6)
2. Switch on the appliance (select speed 2)
3. Stretch the skin with your free hand.
4. Place the appliance perpendicularly onto your skin, with the on/off slide pointing in the direction in which you are going to move the appliance.
5. Move the appliance slowly over the skin, against the direction of the hair growth. Epilate your bikini line as shown in the figure (Fig.8) Epilate your underarms as shown in the figure (Fig.7)
6. Remove the sensitive area cap from the epilator after use.

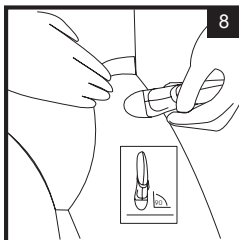
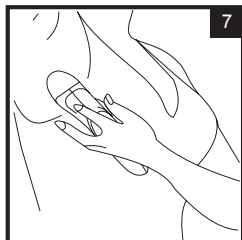
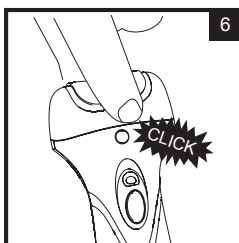
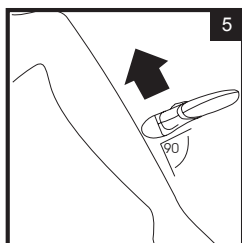

SHAVING

You can use the shaving head to shave sensitive body parts, such as your underarms and bikini line. With the shaving head, you obtain a smooth result in a comfortable and gentle way.

1. Press the release button and pull the epilating head off the appliance (Fig.9).
2. Place the shaving head on the appliance and press it onto the appliance until it snaps home ("click").
3. Switch on the appliance.
4. Placing the shaving head onto your skin and move the appliance slowly and smoothly against the direction of hair growth.

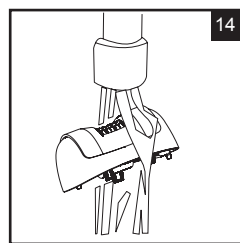
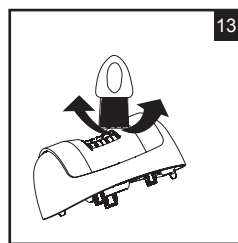
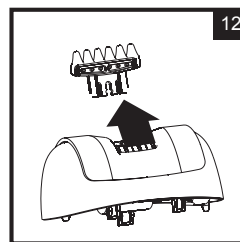
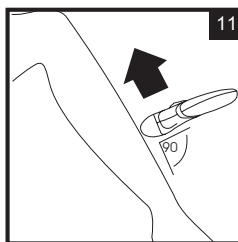
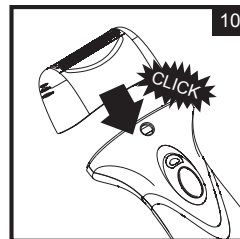
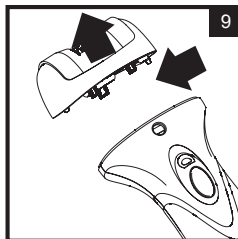

CLEANING AND MAINTENANCE

Never put the adaptor or the appliance itself into the water.

Do not use any corrosive detergents, scouring pads or cloths, petrol, acetone etc. to clean the appliance.

Cleaning the epilating head and shaving head

Clean the epilating head and shaving head

after every use.

1. Make sure the appliance is switched off and disconnected from the mains.
2. Remove the epilating head and shaving head.
3. Clean all accessible parts, including the bottom of the epilating head and the epilating discs, with the brush (Fig.13)
4. You can also rinse the epilating head (not the appliance) and shaving head (not the appliance) under the tap to clean it more thoroughly (Fig.14).
5. Do not exert pressure on the shaving foil to avoid damage.

ENVIRONMENT

Do not throw away the appliance with the normal household waste at the end of its life, but hand it in at an official collection point for recycling. By doing this, you help to preserve the environment.

1. Remove the adaptor from the wall socket and let the appliance run until the batteries are empty.
2. Remove the battery as per the figures (Fig.20 to Fig.23) Do not try to reassemble the appliance in order to run it from the mains. This is dangerous.

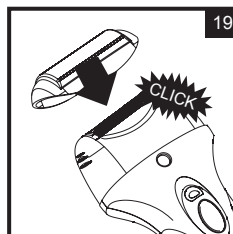
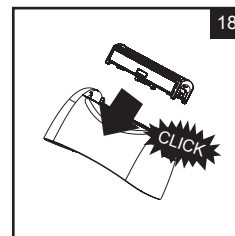
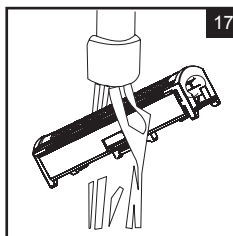
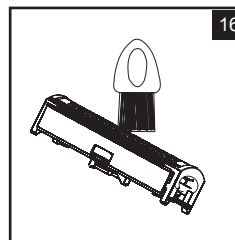
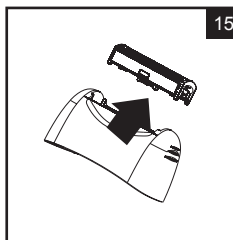

creative housewares

 20 Tekstiel Street, Parow, Cape Town, 7493, South Africa

 P.O. Box 6156 Parow East, 7501, South Africa

 +27 21 931 8117  +27 21 931 4058

Service Centre Helpline: 086 111 5006

 www.creativehousewares.co.za

Free Manuals Download Website

<http://myh66.com>

<http://usermanuals.us>

<http://www.somanuals.com>

<http://www.4manuals.cc>

<http://www.manual-lib.com>

<http://www.404manual.com>

<http://www.luxmanual.com>

<http://aubethermostatmanual.com>

Golf course search by state

<http://golfingnear.com>

Email search by domain

<http://emailbydomain.com>

Auto manuals search

<http://auto.somanuals.com>

TV manuals search

<http://tv.somanuals.com>