



myPDFmanuals

You can read the recommendations in the user guide, the technical guide or the installation guide for MIELE KM 344G MASTERCHEF GAS COOKTOP. You'll find the answers to all your questions on the MIELE KM 344G MASTERCHEF GAS COOKTOP in the user manual (information, specifications, safety advice, size, accessories, etc.). Detailed instructions for use are in the User's Guide.

User manual MIELE KM 344G MASTERCHEF GAS COOKTOP
User guide MIELE KM 344G MASTERCHEF GAS COOKTOP
Operating instructions MIELE KM 344G MASTERCHEF GAS COOKTOP
Instructions for use MIELE KM 344G MASTERCHEF GAS COOKTOP
Instruction manual MIELE KM 344G MASTERCHEF GAS COOKTOP

Miele

Installation Instructions

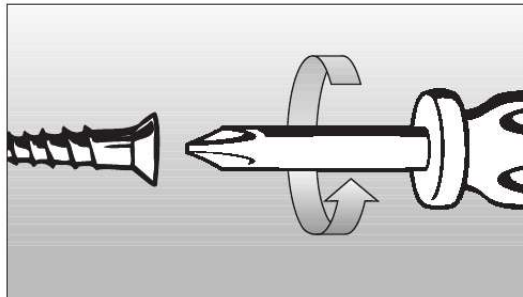

Gas Cooktop
KM 342
KM 344



USA CDN

To prevent accidents and machine damage, read these instructions **before** installation or use.

M.-Nr. 05 649 320



[Your user manual](#)
[MIELE KM 344G MASTERCHEF GAS COOKTOP](#)

Manual abstract:

The minimum distance of combustible surfaces located above and to the sides of the cooktop, e, is 18" (457 mm). If the cabinet manufacturer recommends a greater distance, follow that manufacturer's recommendation. When installing the cooktop under a venting hood, always observe the minimum distance recommended by the hood manufacturer. Keep this instruction book in a safe place for reference and pass it on to any future user. Appliance dimensions KM 342 a Built-in depth KM 342 (stainless steel) 2 5/16" (58 mm) b Built-in depth KM 342 (black or white) 3 3/8" (86 mm) ^ Remember to maintain the minimum safety distances to combustible surfaces: - 2 3/4" (70 mm) between the cut-out and the back wall and - 12" (305 mm) between the cut-out and a side wall or tall unit to the right or left of the cut-out. (See "Important Safety instructions"). 6 Appliance dimensions KM 344 a Built-in depth KM 344 (stainless steel) 2 5/16" (58 mm) b Built-in depth KM 344 (black or white) 3 3/8" (86 mm) ^ Remember to maintain the minimum safety distances to combustible surfaces: - 2 3/4" (70 mm) between the cut-out and the back wall and - 12" (305 mm) between the cut-out and a side wall or tall unit to the right or left of the cut-out. (See "Important Safety instructions"). 7 Installation Setting the cooktop into place Securing the cooktop ^ Secure the cooktop with the included fixing bracket.

Countertop 13/16" (20 mm) d c ^ After removing the protective backing, d, stick the supplied seal, c, under the edge of the cooktop.

^ Screw the gas regulator onto the nipple underneath the cooktop. (See "Gas Connection - Gas pressure regulator".) ^ Feed the power cord through the cut-out to the power outlet. ^ Set the cooktop in the cut-out and center it. Install the appliance so that the power cord and gas piping does not come in contact with any portion of the cooktop which may become hot during use.

Countertop 1 9/16" (40 mm) 8 Installation Important The cooktop must not be permanently sealed into the countertop when installed. The sealing strip under the edge of the cooktop provides a sufficient seal. If the cooktop is sealed into position, the countertop or appliance may be damaged if the cooktop needs to be removed for maintenance or service. 9 Electrical connection This appliance must be electrically grounded according to local or national codes. All electrical work should be performed by a qualified electrician in accordance with local codes and the: National Electrical Code ANSI / NFPA No.

70 for the USA To guarantee the electrical safety of this appliance, continuity must exist between the appliance and an effective grounding system. It is imperative that this basic safety requirement be met. If there is any doubt, have the electrical system of the house checked by a qualified electrician. The manufacturer cannot be held responsible for damages caused by the lack, or inadequacy, of an effective grounding system. Note to the installer: Please leave these instructions with the consumer or the appliance. This appliance is equipped with a three-prong grounding plug to prevent shock hazards. It should be plugged directly into a properly grounded outlet. Do not cut or remove the grounding prong from the plug. If the plug does not fit the outlet, have a proper outlet installed by a licensed electrician. or - Canadian Electrical Code Part I for Canada (CSA Standard C 22.

1). WARNING: Disconnect the appliance from the main power supply before installation or service. To reduce the risk of electric shock, make sure that the appliance is properly grounded after installation. Power supply: The automatic ignition requires that the cooktop be connected to a 120 VAC, 60 Hz power supply. The supply line should be protected by a 15A fuse. Actual power consumption (during ignition only) is 25W. This appliance is equipped with a 4 ft. (1.2 m) long power cord that is ready for connection to the appropriate outlet. Please place the power outlet so that it is accessible after the appliance has been installed in the countertop.



[Your user manual](#)

[MIELE KM 344G MASTERCHEF GAS COOKTOP](#)

Free Manuals Download Website

<http://myh66.com>

<http://usermanuals.us>

<http://www.somanuals.com>

<http://www.4manuals.cc>

<http://www.manual-lib.com>

<http://www.404manual.com>

<http://www.luxmanual.com>

<http://aubethermostatmanual.com>

Golf course search by state

<http://golfingnear.com>

Email search by domain

<http://emailbydomain.com>

Auto manuals search

<http://auto.somanuals.com>

TV manuals search

<http://tv.somanuals.com>