



SERVICE PARTS LIST

BUL. 54-16-0500

DIAMOND DRILL

REVISED BUL 6157-1 DATE Feb. '68
WIRING INSTR.

MODEL NO. **D-214**

Starting Serial No. **157-1001**

Both Model and Serial No. must be furnished to obtain correct parts.

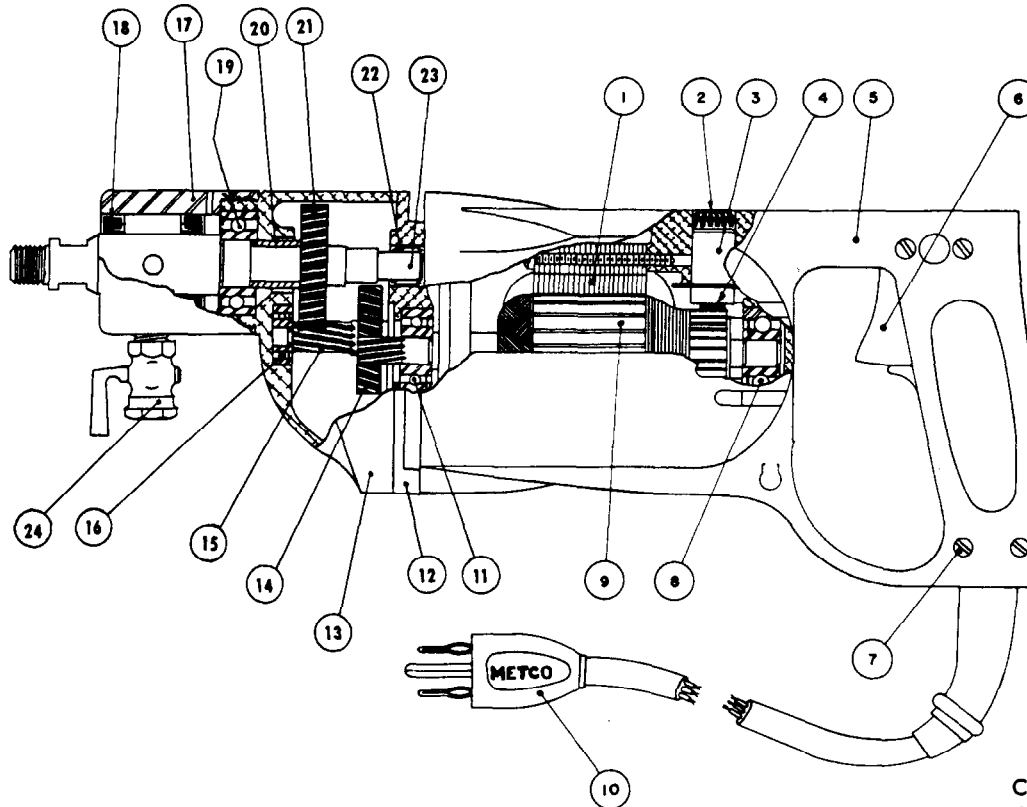

CORRECTS & SUPERCEDES SERVICE BULLETIN 6157-1 DATED 11-28/58

ILLUSTRATED PARTS

FIG.	PART NO.	DESCRIPTION OF PART	FIG.	PART NO.	DESCRIPTION OF PART
1	12D-700A	Field Assembly	13	12D-3	Gear Case
2	44D-40	Brush Retaining Screw (2)	14	12D-14A	Intermediate Gear
3	44D-320	Brush Holder Assembly (2)	15	26S-13	Intermediate Pinion
4	44D-370	Carbon Brush Assembly (2)	16	ND36	Ball Bearing
5	14DS-1	Motor Housing	17	14WS-4	Swivel Housing
6	CH8909K144	Switch	18	63-175	Garlock Seals (2)
7	14DS1-1	Cord Retaining Screws (2)	19	ND8502	Ball Bearing
8	NH9009D	Ball Brg. (Comm. End)	20	42S8-1	Spindle Spacer
9	38SF-600B	Armature Assembly	21	26S-11	Spindle Gear
10	18G-8SR2	Cord Set	22	MNB-31	Needle Bearing
11	WC8039	Ball Brg. (Pinion End)	23	8P-8	Spindle
12	12D-2	Diaphragm	24	14WS-9	Valve

MISCELLANEOUS PARTS (NOT SHOWN)

SIZE OR PART NO.	DESCRIPTION OF PART	SIZE OR PART NO.	DESCRIPTION OF PART
6-32x1/4" Rd. Hd.	(Brass) Ground Screw	#212	Woodruff Keys
8-32x1" Fil. Hd.	Gear Case Screw	3-48x3/16" Rd. Hd.	Name Plate Screws (2)
8-32x1-3/4" Fil. Hd.	Gear Case Screws (2)	D214-1	Name Plate
8-32x1-3/4" Fil. Hd.	Field Screws (2)	6-32x1/4" Washer Hd.	Switch Bracket Screws (2)
1/8"x1/2"	Type 5 Groove Pin	6-32x1/4" Oval Hd.	Switch Locating Screws (2)
44D-34 Brush Holder	Insul. Washer (Fiber) (2)	12D-23	Switch Bracket
1/4-20x1/2" Hd'less	Brush Holder Set Scs. (2)	#207	Woodruff Key
M-471	Needle Bearing (1)	3PA-1	Attachment Plug Adapter

Free Manuals Download Website

<http://myh66.com>

<http://usermanuals.us>

<http://www.somanuals.com>

<http://www.4manuals.cc>

<http://www.manual-lib.com>

<http://www.404manual.com>

<http://www.luxmanual.com>

<http://aubethermostatmanual.com>

Golf course search by state

<http://golfingnear.com>

Email search by domain

<http://emailbydomain.com>

Auto manuals search

<http://auto.somanuals.com>

TV manuals search

<http://tv.somanuals.com>