

Panasonic

Operating Instructions

AAC WMA MP3 CD Player/Receiver
Model: **CQ-RX400N/CQ-RX300N**

WMA MP3 CD Player/Receiver
Model: **CQ-RX200N/CQ-RX103N/ CQ-RX102N/CQ-RX101N**

* Please read these instructions carefully before using this product and keep this manual for future reference.

Accessories	
Instruction kit	Q'ty
Operating Instructions (English: YFGM286051) (Deutsch: YFGM286052) (Français: YFGM286053) (Nederlands: YFGM286054) (Svenska: YFGM286055) (Italiano: YFGM286056) (Español: YFGM286057) (Dansk: YFGM286058) (Polski: YFGM286059) (Český: YFGM286060) (Magyar: YFGM286061)	1 set
Lock Cancel Plate	1 set
Mounting Bolt (5 mm φ)	1 set
Mounting Collar (YEFX21263A)	1
Trim Plate (YFGS01023)	1
Power Connector (KHY1Y3Y0002)	1
Remote Control Unit (includes a battery) (EUR7641010)	1
Removable Face Plate Case (YGF134302)	1

Notes:

- The number in parentheses under each accessory part name is the part number for maintenance and service.
- Accessories and their part numbers are subject to modification without prior notice due to improvements.
- Mounting Collar and Trim Plate are mounted on the main unit at shipment.

Specifications	
General	
Power supply	DC 12 V (11 V ~ 16 V DC), test voltage 14.4 V, negative ground Less than 2 A (at 500 Hz)
Current consumption	CD mode: 0.5 W × 4 channels SD mode: 1.1 W × 4 channels (at 1 kHz) Volume control maximum
Maximum power output	22 W × 4 channels (at 4 Ω) SQ Low/Bass: ±12 dB
Power output	(at 60 Hz, 80 Hz, 100 Hz, 200 Hz) SD High/Treble: ±12 dB (at 10 kHz, 12 kHz, 15 kHz, 18 kHz) -4 ~ 8 dB
Tone/SQ adjustment range	2.0 V (CD mode, 1 kHz, 0 dB) Pre-amp output impedance: 200 Ω
Speaker impedance	4 Ω
Pre-amp output voltage	2.0 V (CD mode, 1 kHz, 0 dB)
Pre-amp output impedance	200 Ω
USB Connector	CA-RX400N CA-RX300N
USB Standard Compatibility	1.1, 2.0 Full Speed
Maximum Supply Current	500 mA
Front AUX input	Input impedance: 2.0 kΩ Allowable external input Connector: 3.5 mm φ Stereo mini-pin Dimensions (W × H × D): 178 × 50 × 160 mm Weight: 1.2 kg
Disc Player	
Sampling frequency	3.8 times over-sampling
DA converter	1-bit DAC System
Pick-up type	Asigma 3-beam
Light source	Semiconductor laser
Wave length	780 nm
Frequency response	20 Hz ~ 20 kHz (±1 dB)
Signal to noise ratio	96 dB
Total harmonic distortion	<0.01% (1 kHz)
Wow and flutter	Below measurable limits
Channel separation	85 dB

Direct Sales at Panasonic UK

- Order accessories and consumable items for your product with ease and confidence by phoning our Customer Care Centre Monday - Thursday, 9.00am - 5.30pm, Friday 9.30am - 5.30pm. (Excluding public holidays).
- Or go on line through our Internet Accessory ordering application at www.panasonic.co.uk
- Most major credit and debit cards accepted.
- All enquiries, transactions and distribution facilities are provided directly by Panasonic UK Ltd.
- It couldn't be simpler!
- Also available through our Internet direct shopping for a wide range of finished products, so take a browse on our website for further details.

Customer Care Centre

- For customers within the UK: 0844 844 3852
- For customers within the Republic of Ireland: 01 289 8333
- Visit our website for product information www.panasonic.co.uk
- E-mail: customer.care@panasonic.co.uk

Matsushita Electric Industrial Co., Ltd.
Web Site: <http://panasonic.net>

Printed in China

Safety Information

- Read the operating instructions for the unit and all other components of your car audio system carefully before using the system. They contain instructions about how to use the system in a safe and effective manner. Panasonic assumes no responsibility for any problems resulting from failure to observe the instructions given in this manual.
- Warning:** This pictograph intends to alert you to the presence of important operating instructions and installation instructions. Failure to heed the instructions may result in severe injury or death.
- Caution:** This pictograph intends to alert you to the presence of important operating instructions and installation instructions. Failure to heed the instructions may result in injury or material damage.

Warning

Observe the following warnings when installing. Disconnect the lead from the negative (-) battery terminal before installation. Wiring and installation with the negative (-) battery terminal connected may cause electrical shock and injury due to a short circuit. Some cars equipped with the electrical safety system have specific procedures of battery terminal disconnection. **FAILURE TO FOLLOW THE PROCEDURE MAY LEAD TO THE UNINTENDED ACTIVATION OF THE ELECTRICAL SAFETY SYSTEM RESULTING IN DAMAGE TO THE VEHICLE AND PERSONAL INJURY OR DEATH.**

Do not take apart this unit or attempt to make any changes yourself. This unit is a very intricate device that uses a laser pickup to retrieve information from the surface of compact discs. The laser is carefully shielded so that its rays remain inside the cabinet. Therefore, never try to disassemble the player or alter any of its parts since you may be exposed to laser rays and dangerous voltages.

Information on Disposal for Users of Waste Electrical & Electronic Equipment (private households)

This symbol on the products and/or accompanying documents means that used electrical and electronic products should not be mixed with general household waste. For proper treatment, recovery and recycling, please take these products to designated collection points, where they will be accepted on a free of charge basis. Alternatively, in some countries you may be able to return your products to your local retailer upon the purchase of an equivalent new product. Disposing of this product correctly will help to save valuable resources and prevent any potential negative effects on human health and the environment which could otherwise arise from inappropriate waste handling. Please contact your local authority for further details of your nearest designated collection point. Penalties may be applicable for incorrect disposal of this waste, in accordance with national legislation.

For business users in the European Union

If you wish to discard electrical and electronic equipment, please contact your dealer or supplier for further information. **Information on Disposal in other Countries outside the European Union**

This symbol is only valid in the European Union. If you wish to discard this product, please contact your local authorities or dealer and ask for the correct method of disposal.

Label Indications and Their Locations

CAUTION LASER RADIATION WHEN OPEN. DO NOT STARE INTO BEAM.

CLASS 1 LASER PRODUCT (Bottom of the unit)

Caution Label

Do not take apart this unit or attempt to make any changes yourself.

Deck Assy (in the unit, upper side)

Caution

Do not take apart this unit or attempt to make any changes yourself.

Do not disassemble, modify the unit or attempt to repair the product yourself. If the product needs to be repaired, consult your dealer or an authorized Panasonic Service Centre.

Do not use the unit when it is out of order. This product is designed for operation with a negative grounded 12 V DC battery system. Never operate this product with other battery systems, especially a 24 V DC battery system.

Keep batteries and insulation film out of reach of infants. Batteries and insulation film can be ingested, so keep them out of the reach of infants. If an infant ingests a battery or insulation film, please seek immediate medical attention.

Protect the Deck Mechanism. Do not insert any foreign objects into the slot of this unit.

Do not disassemble or modify the unit. Do not disassemble, modify the unit or attempt to repair the product yourself. If the product needs to be repaired, consult your dealer or an authorized Panasonic Service Centre.

Do not use the unit when it is out of order. If the unit is out of order (no power, no sound) or in an abnormal state (has foreign objects in it, is exposed to water, is smoking or smells), turn it off immediately and consult your dealer.

The remote control unit should not lie about in the car. If the remote control unit lies about, it could fall on the floor while driving, get wedged under the brake pedal, and lead to a traffic accident.

Refer fuse replacement to qualified service personnel. When the fuse blows out, eliminate the cause and have it replaced with the fuse prescribed for this unit by a qualified service engineer. Incorrect replacement of the fuse may lead to smoke, fire, and damage to the product.

Request for use of the Removable Face Plate Case:

- To avoid trouble and ensure safety, use the optional Removable Face Plate Case (YGF134302).

Features

SQ (Sound Quality)

You have 6 preset modes (FLAT, ROCK, POP, VOCAL, JAZZ, CLUB). You can customize your settings for these and save them for instant recall.

SQ3 (3-Band Sound Quality)

Center frequency and level are adjustable in each of 3 bands. This lets you fine-tune sound quality for each genre to suit car-interior acoustics and your personal preferences. (→ "Sound Control")

USB Connector

The USB Connector is equipped on the front panel. (→ System Upgrade Guidebook)

By connecting a USB memory (not included) to USB connector via a USB extension cable (USB 2.0, not included), you can enjoy MP3/WMA/AAC files stored on the USB memory (not included) in your car.

AUX (AUX1) Input Terminal

The AUX input terminal is equipped on the front panel. Your mobile audio player and other devices are connectable to this unit without any difficulty.

Before Reading These Instructions

Panasonic welcomes you to our constantly growing family of electronic products owners. We endeavor to give you the advantages of precise electronic and mechanical engineering, manufactured with carefully selected components, and assembled by people who are proud of the reputation their work has built for our company. We know this product will bring you many hours of enjoyment, and after you discover the quality, value and reliability we have built into it, you too will be proud to be a member of our family.

Differences Among 6 Models

This operating instruction manual is for 6 models: CQ-RX400N, CQ-RX300N, CQ-RX200N, CQ-RX103N, CQ-RX102N and CQ-RX101N. All illustrations throughout this manual represent model CQ-RX400N unless otherwise specified. The following table describes the differences among 6 models.

Features	Models	CQ-RX400N	CQ-RX300N	CQ-RX200N	CQ-RX103N	CQ-RX102N	CQ-RX101N
Removable Face Plate Case	Included	Included	Not included	Not included	Not included	Not included	Not included
Remote Control Unit	Included	Included	Not included	Not included	Not included	Not included	Not included
System Upgrade Guidebook	Included	Included	Included	Included	Not included	Not included	Not included
System-up Connector	Supported	Supported	Supported	Not Supported	Not Supported	Not Supported	Not Supported
Preamp Out Connector	2 (Front/Rear)	2 (Front/Rear)	1 (Rear)	1 (Rear)	1 (Rear)	1 (Rear)	1 (Rear)
USB Connector	Supported (USB iPod)	Supported	Not Supported	Not Supported	Not Supported	Not Supported	Not Supported
AAC playback	Supported	Supported	Not Supported	Not Supported	Not Supported	Not Supported	Not Supported
Button logo colour	Blue	Red	Red	Blue	Green	Red	Red

Maintenance/Fuse

Your product is designed and manufactured to ensure the minimum of maintenance. Use a dry, soft cloth for routine exterior cleaning. Never use benzene, thinner, or other solvents.

Warning

- Use fuses of the same specified rating (15 A). Using substitutes or fuses with higher ratings, or connecting the unit directly without a fuse could cause fire or damage to the unit. If the replaced fuse fails, contact your nearest authorized Panasonic Service Centre.

If the fuse blows out, consult your dealer, or your nearest authorized Panasonic Service Centre.

Anti-Theft System

This unit is equipped with a removable face plate. Removing this face plate makes the unit totally inoperable.

Notes:

- Do not touch the contacts on the face plate and the main unit, this may result in poor electrical contact.
- If dirt or other foreign substances get on the contacts, wipe them off with a clean and dry cloth.

Removing

- Turn off the power.
- Press [▲]. The face plate will open.
- Pull it out toward you.
- Put the face plate in the case.

Mounting

- Slide the left side of the face plate in place.
- Press the right end of face plate until a "click" is heard.

Notes on Discs

If you use commercial CDs, they must have either of these labels shown at right. Some copy-protected music CDs are not playable.

How to hold the disc

- Do not touch the underside of the disc.
- Do not scratch on the disc.
- Do not bend the disc.
- When not in use, keep disc in the case.

Disc Insert

The surface of new discs tend to be slippery. Therefore, when using such a disc for the first time, it may not load satisfactorily even when it has been inserted into the unit. At a time like this, insert the disc into the unit as far as it will go until it is loaded properly.

When inserting a disc into or ejecting and removing it straight out in parallel with the unit. Observe, the disc may be scratched or marked in the process.

When inserting a disc, do not put one disc on another. Failure to observe this may cause the discs to be jammed.

Do not leave discs in the following places:

- Direct sunlight
- Near car heaters
- Dirty, dusty and damp areas
- On seats and dashboards

Disc cleaning

- Use a dry, soft cloth to wipe from the center outward.
- Do not attach any seals or labels to your discs.
- Do not write on the disc label in a heavy pen or ballpoint pen.

Notes on CD-ROM, CD-R, CD-RW

- Partly or wholly transparent disc
- Wholly transparent disc
- Wholly semi-transparent disc may not be played back.
- Discs with adhered labels, etc. on them
- Disc with adhered stickers or tape
- Labels created by a printer
- Discs with cracks, scratches or parts missing
- Discs with burrs
- Please remove the burrs before use.

Notes on CD-Rs/RWs

- You may have trouble playing back some CD-RW discs recorded using CD recorders (CD-RW drives), either due to their recording characteristics or dirt, fingerprints, scratches, etc. on the disc surface.
- CD-RW discs are less resistant to high temperatures and high humidity than ordinary music CD. Leaving them inside a car for extended periods may damage and make playback impossible.
- The unit may not successfully playback a CD-R/W, that was made by the combination of writing software, a CD recorder (CD-R/W drive) and a disc if they are incompatible with one another.
- This player cannot play the CD-R/W discs if the session is not closed.
- Be sure to observe the handling instructions of CD-R/W discs.
- This player cannot play CD-RW discs which contain other than CD-DA or MP3/WMA/AAC data (Video CD, etc.).

YFGM286051A FT1007-1117

Preparation

First Time Power-On

- 1 Set your car's ignition switch to the ACC or ON position.
- 2 Press [SRC] (PWR: Power).



Cancellation of Demonstration

[SRC] (PWR: Power)
The demonstration message appears for initial use.

- 1 Set your car's ignition switch to the ACC or ON position.
- 2 Press [SRC] (PWR: Power).



Battery Installation

[CO-RX400N CO-RX300N]
Pull the insulation film out from the backside of the remote control gently.

Note: Battery Information:
Battery Type: Panasonic Lithium battery (CR2025) (Included in the remote control)
Battery Life: Approximately 6 months under normal use (at room temperature)

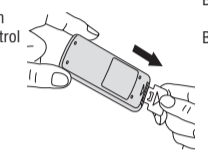

Clock Setting

The 24-hour system is used for the clock.

- 1 Select the radio AM mode. (→ "Radio (AM [LW/MW]/FM)")
- 2 Press [DISP].
- 3 Hold down [DISP] for more than 2 seconds.
- 4 Adjust the hour.
- 5 Press [DISP].
- 6 Adjust the minute.
- 7 Press [DISP].

Remote Control Unit

- [0] to [9]** selects a preset station (1 to 6), presets the current station (Hold it down for more than 2 seconds).
- [#] (NUMBER)** executes the direct selection.
- [RANDOM] [SCAN] [REPEAT]** toggles on/off each play mode.
- [<] [>]** down/up the frequency (Hold it down for more than 0.5 seconds and release it for seek tuning).
- [↔] [↔]** skip to the previous/next track/file in player mode. Hold it down for fast reverse/fast forward.

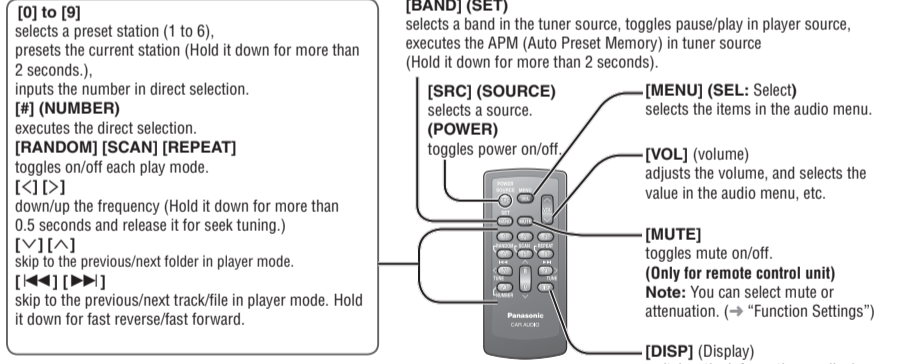

- [BAND] (SET)** selects a band in the tuner source, toggles pause/play in player source, executes the APM (Auto Preset Memory) in tuner source (Hold it down for more than 2 seconds).
- [SRC] (SOURCE)** selects a source.
- [POWER] (PWR)** toggles power on/off.
- [MUTE]** toggles mute on/off.
- [DISP] (Display)** switches the information on display, and exits the audio menu.

- Put a battery in the case with (+) side facing up.
- Put the case back.

- Warning:** Keep batteries and insulation film out of reach of infants. Batteries and insulation film can be ingested, so keep them out of the reach of infants. If an infant ingests a battery or insulation film, please seek immediate medical attention.

- Caution:** Remove and dispose of an old battery immediately. Do not disassemble, heat or short a battery. Do not throw a battery into a fire or water. Follow local regulations when disposing of a battery. Improper use of batteries may cause overheating, an explosion or ignition, resulting in injury or a fire.

- Battery Replacement:** Remove the battery holder with the remote control unit placed on a flat surface. Stick your thumb/nail into the groove, and push the holder in the direction of the arrow, and at the same time. Pull it out in the direction of the arrow using a tough pointed object.

General

[CO-RX400N CO-RX300N CO-RX200N]
Note: For information about connectable devices, refer to the System Upgrade Guidebook or the instruction manual for each device.



- [SRC] (Source)** selects a source.
- [PWR] (Power)** toggles power on/off.
- [TA/AF]** (→ "Radio Data System (RDS) in FM Broadcasting")
- [AUX1] Connector** (3.5 mm φ stereo) Note: The connector is labeled "AUX1", but it appears on the display as "AUX IN". (→ Below)

Caution: Set the volume level to low enough before the AUX connection is completed. Failure to observe this, the loud noise may come out and damage your speakers and your hearing.

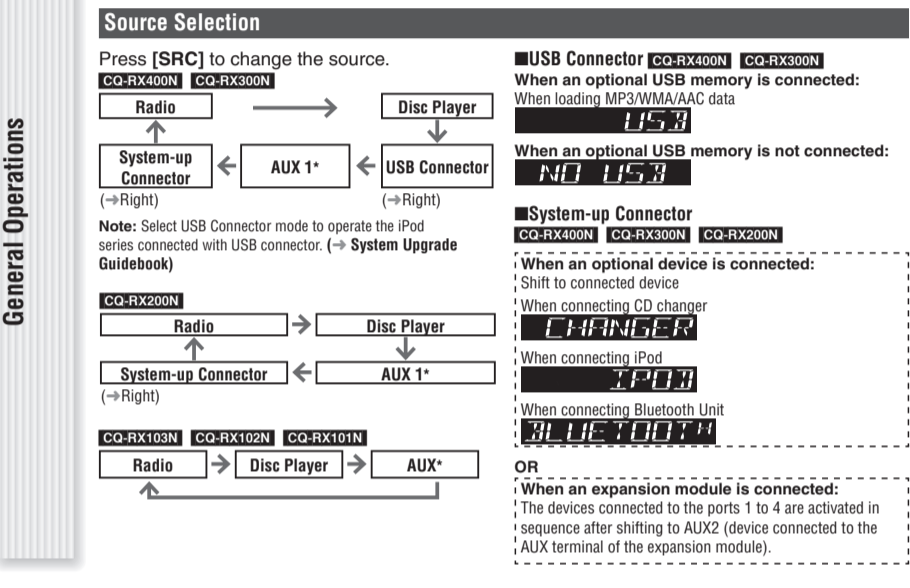

Radio Data System (RDS) in FM Broadcasting

- AF (Alternative Frequency)** The following functions are available when the AF mode is active (LED lights).
 - When receiving conditions become bad, a station with better receiving conditions is automatically tuned in to.
 - When executing APM, only RDS stations are selected.
 - When calling up a preset station, a best receiving station is selected automatically. (BSR: Best Stations Research)
- PTY (Programme Type)** The following functions are available when the PTY mode is active (LED lights).
 - The PTY of receiving station appears.
 - Programs can be searched for by PTY.
 - Note: PTY language can be selected. (→ "Function Settings")
- Other functions of RDS**
 - CT (Clock Time)** The clock is automatically adjusted.
 - PS (Programme Service Name)** As well as the frequency, the name of the broadcast station appears.
 - EON (Enhanced Other Network)** RDS information is updated constantly in response to the current position.
 - EON-TA** Traffic information from the current and other network stations can be received.
 - Emergency Announcement Reception** Emergency announcement automatically appears on the display when it is received.

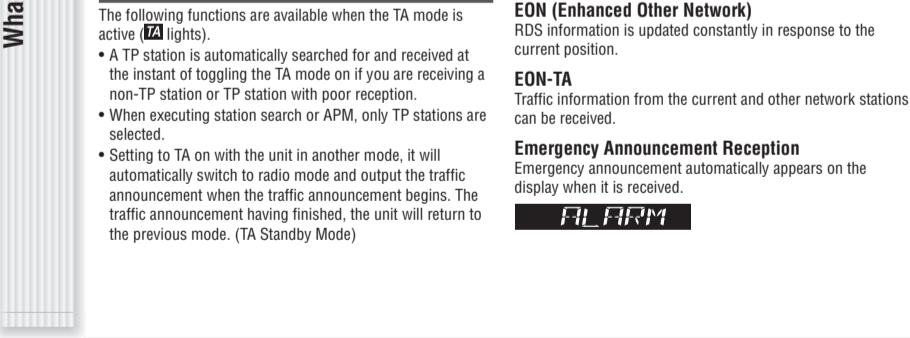

- AF Level:** Hold down [TA] (AF) for more than 2 seconds to select AF level.
 - Low level AF operating sensitivity. (Default)
 - High level AF operating sensitivity.
- PI Seek (Programme Identification Seek):** If reception becomes poor when tuning in a preset station, "NONE" is displayed. A preset PTY appears for 5 seconds. Preset contents are changeable.

Radio (AM [LW/MW]/FM)

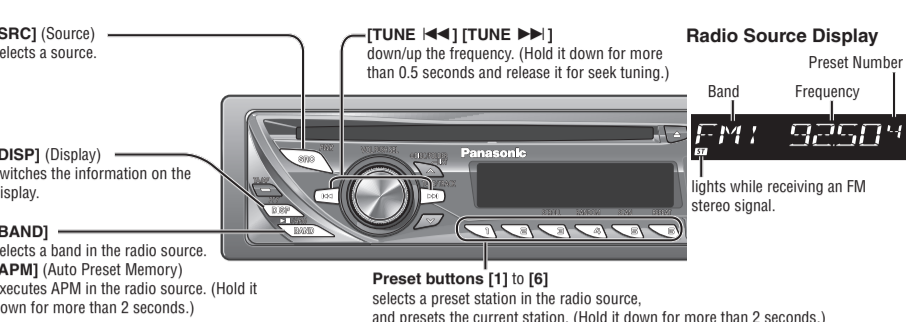

- [SRC] (Source)** selects a source.
- [TUNE] (◀|▶)** (TUNE) down/up the frequency. (Hold it down for more than 0.5 seconds and release it for seek tuning.)
- [DISP] (Display)** switches the information on the display.
- [BAND]** selects a band in the radio source.
- [APM] (Auto Preset Memory)** selects APM in the radio source. (Hold it down for more than 2 seconds.)
- Frequency Adjustment:** [TUNE] (◀|▶) Lower, [TUNE] (▶|▶) Higher. Note: Hold down for 0.5 sec. or more and release for station search.
- Preset Station Selection:** Press the corresponding preset button from [1] to [6] to tune in a preset station.
- Auto Preset Memory (APM):** Up to 6 stations can be preset in AM, FM1, FM2, and FM3 respectively. Preset stations can be simply called up by pressing [1] to [6].
- Manual Station Preset:** 1 Tune into a station. 2 Hold down one of the preset buttons from [1] to [6] for more than 2 seconds. (blinks once)

Audio Settings

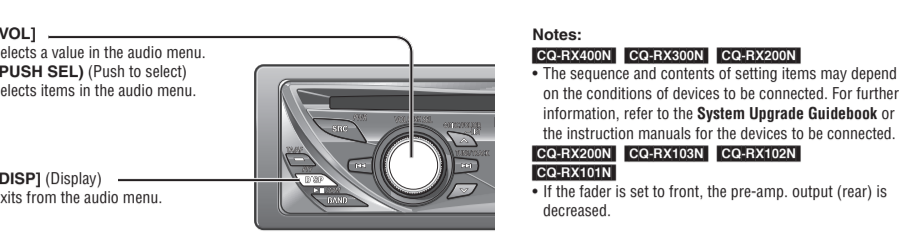

- [VOL]** selects a value in the audio menu. (PUSH SEL) (Push to select) selects items in the audio menu.
- [DISP] (Display)** exits from the audio menu.
- Notes:**
 - The sequence and contents of setting items may depend on the conditions of devices to be connected. For further information, refer to the System Upgrade Guidebook or the instruction manuals for the devices to be connected.
 - If the fader is set to front, the pre-amp. output (rear) is decreased.
- 1 Press [VOL] (PUSH SEL) to open the audio menu.** Note: If no operation takes place for more than 5 seconds in audio setting (2 seconds in the volume adjustment, 10 seconds in the SQ adjustment), the display returns to the regular mode.
- 2 Press [VOL] (PUSH SEL) to select a mode to be adjusted.**
- 3 Turn [VOL] clockwise or counterclockwise to adjust.**
- Bass:** (Setting Range: -12 dB to +12 dB, Default: 0 dB)
- Treble:** (Setting Range: -12 dB to +12 dB by 2 dB, Default: 0 dB)
- SQ (Sound Quality):** (Setting Range: FLAT/ROCK/POP/VOCAL/JAZZ/CLUB, Default: FLAT)
- SQ Adjustment:** (Tone/SQ adjustable range: -12 dB to +12 dB (by 2 dB))
 - Setting range: ±12 dB (at 60 Hz, 80 Hz, 100 Hz, 200 Hz)
 - SQ Low/Bass: ±12 dB (at 60 Hz, 80 Hz, 100 Hz, 200 Hz)
 - SQ Mid: ±12 dB (at 500 Hz, 1 kHz, 2 kHz, 3 kHz)
 - SQ High/Treble: ±12 dB (at 10 kHz, 12 kHz, 15 kHz, 18 kHz)
- BALANCE:** (Setting Range: 15 levels each, Default: CNT (centre))
- FADER:** (Setting Range: 15 levels each, Default: CNT (centre))
- Notes:**
 - The volume can also be adjusted directly using [VOL] on the main unit. (→ "General")
 - For further information on SQ (Sound Quality) settings, refer to "Sound Control".
 - Do not activate SQ and Bass/Treble at the same time to avoid causing sound distortion.

Sound Control

- You have 6 preset modes (FLAT, ROCK, POP, VOCAL, JAZZ, CLUB). You can customize your settings for these and save them for instant recall.
- SQ (Sound Quality):**
 - 1 Press [VOL] (PUSH SEL): Select to open the audio menu.
 - 2 Press [VOL] (PUSH SEL): Select to select SQ.
 - 3 Turn [VOL] to select the sound type as follows.
- SO3 (3-Band Sound Quality):** Center frequency and level are adjustable in each of 3 bands. This lets you fine-tune sound quality for each genre to suit car-interior acoustics and your personal preferences. Tone/SQ adjustable range: -12 dB to +12 dB (by 2 dB). SQ Low/Bass: ±12 dB (at 60 Hz, 80 Hz, 100 Hz, 200 Hz). SQ Mid: ±12 dB (at 500 Hz, 1 kHz, 2 kHz, 3 kHz). SQ High/Treble: ±12 dB (at 10 kHz, 12 kHz, 15 kHz, 18 kHz). The bass/treble control level of each frequency is fixed to the frequency that has been selected for SQ.
- To return an adjusted SQ to the default setting:**
 - Select the SQ which is to be returned to the default setting. (Follow steps 1 to 3 in "SQ Changerover". → Above)
 - Hold down [BAND] for 2 sec. or more.
- Notes:**
 - You cannot save any SQ presetting value in [1] button.
 - Any SQ adjustments will not change the call up screen names such as ROCK and JAZZ.
 - Do not activate SQ and Bass/Treble at the same time to avoid causing sound distortion.
- SO Changerover:**
 - 1 Press [VOL] (PUSH SEL): Select to open the audio menu.
 - 2 Press [VOL] (PUSH SEL): Select to select SQ SET.
 - 3 Adjust each band.
 - 4 Hold down the numeric button [2] to [6] for 2 sec. or more.
- Notes:**
 - If the fader is set to front, the pre-amp. output (rear) is decreased.

Function Settings

- [VOL]** selects a value in the function menu. (PUSH SEL) (Push to select) selects items in the function menu.
- [DISP] (Display)** exits from the function menu.
- 1 Hold down [VOL] (PUSH SEL) for 2 sec. or more to open the function menu.** Note: If no operation takes place for more than 5 seconds in function setting, the display returns to the regular mode.
- 2 Press [VOL] (PUSH SEL) to select a mode to be adjusted.**
- 3 Turn [VOL] clockwise or counterclockwise to adjust.**
- FM MONO:** FM Monaural [FM]
- FM LOCAL:** FM Local [FM]
- AM LOCAL:** AM Local [AM]
- REGION:** Region [OFF]
- PTY LANG:** PTY Language [RDS]
- AUX1 Skip:** On (Skip disabled), Off (Skip enabled)
- AUX2 Skip:** On (Skip disabled), Off (Skip enabled)
- AUX3 Skip:** On (Skip disabled), Off (Skip enabled)

Player (Disc Player)

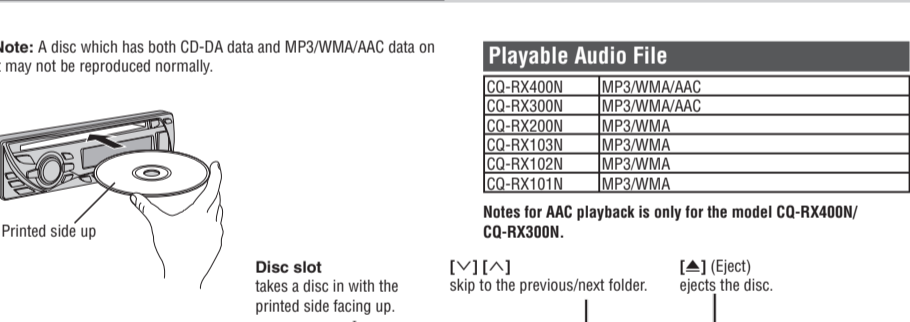

- CD-DA Mode Display:** Lights when the disc is loaded.
- MP3/WMA/AAC Mode Display:** Lights when folder random/scan is on.
- Play Mode Indicators:** Track number, Play time.
- Disc Slot:** Disc slot takes disc in with the printed side facing up.
- Playable Audio File:** CO-RX400N MP3/WMA/AAC, CO-RX300N MP3/WMA/AAC, CO-RX200N MP3/WMA/AAC, CO-RX103N MP3/WMA, CO-RX102N MP3/WMA, CO-RX101N MP3/WMA.
- Notes:**
 - A disc which has both CD-DA data and MP3/WMA/AAC data on it may not be reproduced normally.
 - Do not insert a disc when the CD-DA indicator lights.
 - Refer to the section of "Notes on Discs" and "Notes on MP3/WMA/AAC".
 - This unit does not support 8 cm discs.
- Programme Search by PTY:** Press [1] to [6] to select PTY in the PTY menu.
- PTY Preset Change:** Original PTY presets can be changed as you like.
- 1 Select a PTY that you would like to preset.**
- 2 Follow the procedure of ordinary presetting. (→ "Station Preset" in "Radio (AM [LW/MW]/FM)")**

CD-DA Mode Display

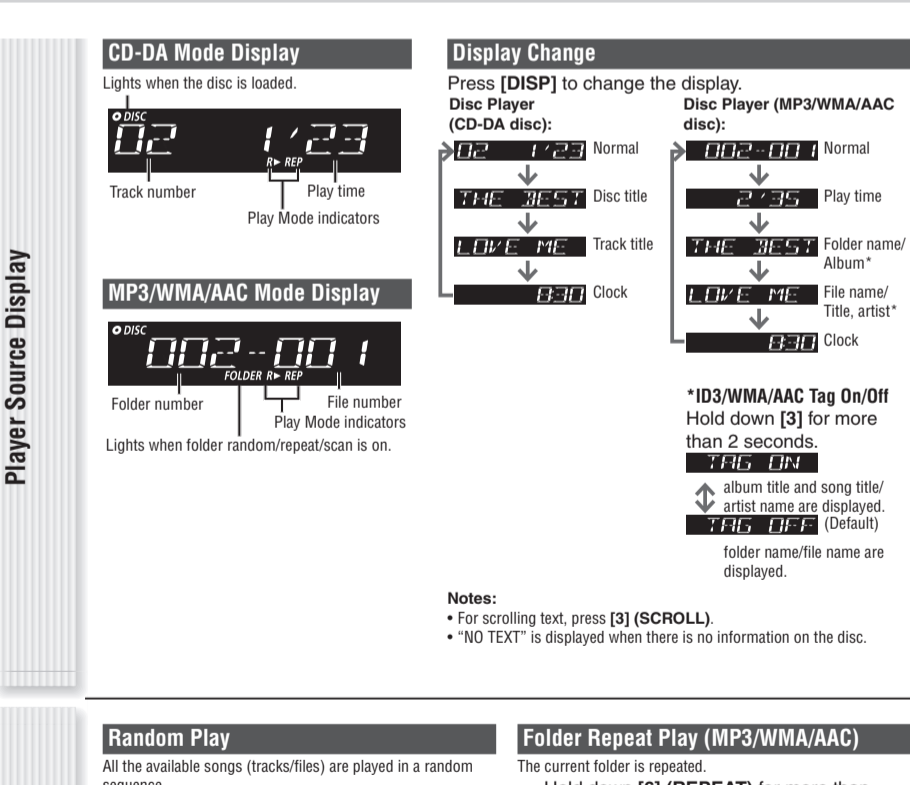

- Display Change:** Press [DISP] (Display) to change the display. Disc Player (CD-DA disc), Disc Player (MP3/WMA/AAC disc).
- MP3/WMA/AAC Mode Display:** Folder number, Play Mode indicators.
- Folder Repeat Play (MP3/WMA/AAC):** The current folder is repeated. Press [4] (RANDOM). Press again to cancel. Hold down again to cancel.
- Scan Play:** The first 10 seconds of each song (tracks/files) is played in sequence. Press [5] (SCAN). Press again to cancel.
- Folder Scan Play (MP3/WMA/AAC):** From the next folder, the first 10 seconds of the first file in each folder is played in sequence. Hold down [5] (SCAN) for more than 2 seconds. Hold down again to cancel.
- Repeat Play:** The current song (track/file) is repeated. Press [6] (REPEAT). Press again to cancel.
- Track/File Selection:** Press [↔] / [↔]. Note: To perform fast forward/reverse, hold down either of them.
- Disc Player (CD-DA disc):** Previous/next track.
- Disc Player (MP3/WMA/AAC disc):** Previous/next file.
- Folder Selection (MP3/WMA/AAC):** Press [↔] / [↔].
- Pause:** Press [BAND] (▶|▶). Press again to cancel.

Function Menu

- MEMO:** On (Default), Off.
- MUTE/KEY:** Mute/Attenuation. You can select mute or attenuation.
- AUX1 Skip:** On (Skip disabled), Off (Skip enabled).
- AUX2 Skip:** On (Skip disabled), Off (Skip enabled).
- AUX3 Skip:** On (Skip disabled), Off (Skip enabled).
- Notes:**
 - To return to the regular mode, press [DISP].
 - The sequence and contents of setting items may depend on the conditions of devices to be connected. For further information, refer to the System Upgrade Guidebook or the instruction manuals for the devices to be connected.

Free Manuals Download Website

<http://myh66.com>

<http://usermanuals.us>

<http://www.somanuals.com>

<http://www.4manuals.cc>

<http://www.manual-lib.com>

<http://www.404manual.com>

<http://www.luxmanual.com>

<http://aubethermostatmanual.com>

Golf course search by state

<http://golfingnear.com>

Email search by domain

<http://emailbydomain.com>

Auto manuals search

<http://auto.somanuals.com>

TV manuals search

<http://tv.somanuals.com>