

MTX Blueprint[®] series

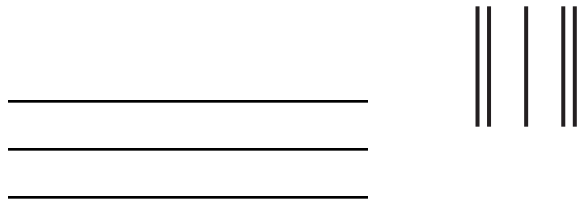
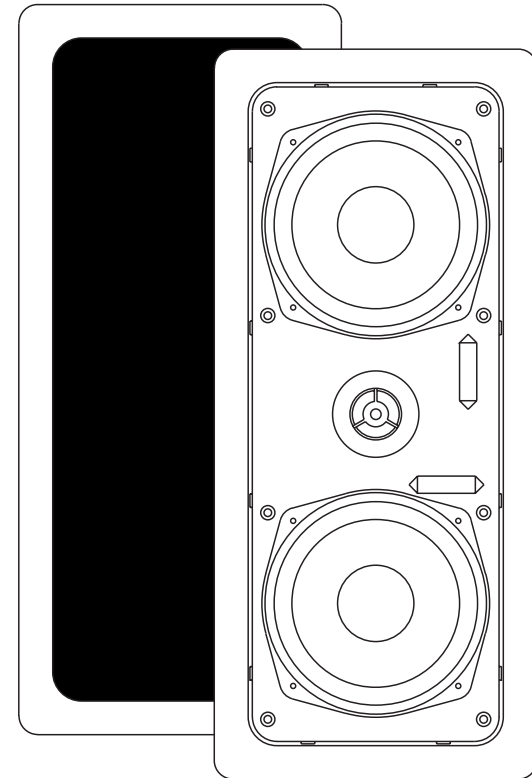

FIRST
CLASS
STAMP
HERE

MTX
4545 E BASELINE RD
PHOENIX AZ 85040-6400

MODEL 525W

IN-WALL HOME THEATER SPEAKER OWNERS MANUAL



CONGRATULATIONS

We appreciate your choice of the MTX Model 525W. Properly installed and operated, you should be able to enjoy years of worry free listening. It's important that you follow each step in this guide carefully to insure proper installation. If you have any questions regarding MTX In-Wall Loudspeakers, please call us at 1-800-223-5266.

SPECIFICATIONS

| | |
|----------------------------|--------------|
| Frequency Response | 64-20kHz |
| Impedance | 8 Ohms |
| Nom. Power Handling | 50 Watts |
| Peak Power Handling | 160 Watts |
| Sensitivity | 88dB@1W/1m |
| Woofer Diameter | (2) 5-1/4" |
| Tweeter | 1" Soft Dome |
| Mounting Depth | 2.938" |

PAINTING YOUR MTX IN-WALLS

MTX In-Walls are designed to accept all types of interior and exterior paints. Spray or roller application should provide excellent results. A paint shield is included with all Blueprint Series In-Walls to protect the speakers during the painting process.

WARRANTY

MTX Blueprint Series In-Wall Loudspeakers are guaranteed against defects in parts and workmanship for a period of ten (10) years from the date of purchase. Speakers found defective during that period will be repaired by MTX without charge for parts.

This warranty is void if it is determined that unauthorized parties have attempted repairs or alterations of any nature. Before assuming that a defect is present in the loudspeakers, be certain that all associated equipment is operating properly.

If a defect is present, your authorized MTX dealer may be able to effect repairs. If not, you are responsible for providing transportation to the factory. Your MTX dealer can recommend the safest method of transportation. Proof of purchase is required when requesting service, so please retain your sales slip.

Specifications subject to change without notice.

(Cut out on dotted line and mail to address on reverse side.)

WARRANTY REGISTRATION

To register your purchase and insure your investment, please fill out and return this card.

NAME _____ AGE _____

ADDRESS _____

MODEL PURCHASED: MODEL 525W

DATE PURCHASED _____

DEALER NAME _____

PURPOSE: Main Music Listening Background Video/surround

Other _____

ROOM(S) INSTALLED _____

INSTALLED BY _____

HOW DID YOU FIRST LEARN OF MTX IN-WALLS?

Dealer Friend Magazine Radio Newspaper Other

COMMENTS _____

STEP 4

Attach loudspeakers wires to speaker terminals, observing correct polarity (positive to positive and negative to negative), and position panel and frame assembly to hole as shown. Insert top of mounting frame into hole at top. By moving bottom of frame upwards, you should now be able to insert bottom of frame into hole at bottom. Be careful not to pinch loudspeaker wires in the process. Tighten long screws. Use the integral bubble levels during tightening to insure straightness of final position.

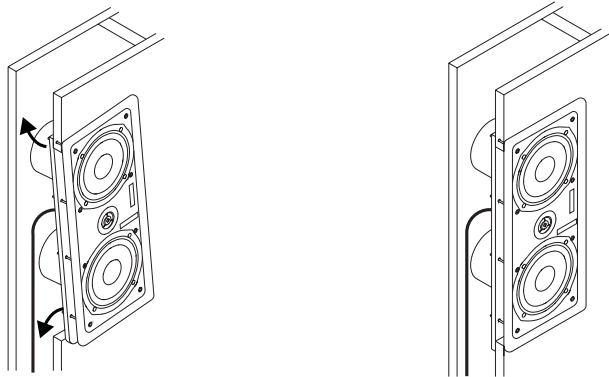

STEP 5

After speaker panel is secured tightly, test for sound.

STEP 6

When you are satisfied the speaker is operational, "aim" the tweeter, and affix grill. As grill is designed for a snug fit, you'll need to position one edge into the slot first, and press or squeeze around perimeter of the grill, while pushing the leading edge into the grill slot.

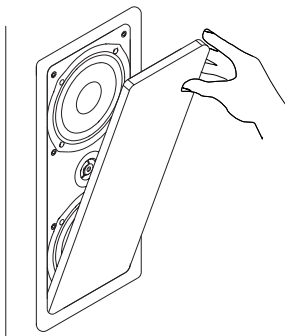

LOUDSPEAKER PLACEMENT

The Model 525W was designed to work within almost any interior decorating scheme. It can be installed in virtually any location where flush mounting is possible. For a quick, easy installation there are integral bubble levels located on the baffle to insure perfect horizontal or vertical alignment. Additionally, the Model 525W is magnetically shielded and can be safely mounted near TV's for use in Home Theaters.

LEFT/RIGHT FRONT SPEAKERS

For best stereo reproduction, the two loudspeakers should be placed an equal distance from your listening position and separated so that the angle between them at the listening position is between 40 and 60 degrees. *Note: Although the speaker can be mounted either horizontally or vertically, the MTM design used in the Model 525W will produce a more evenly distributed sound throughout the listening area if mounted vertically.*

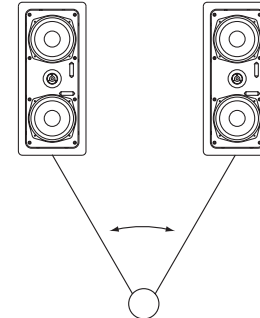

For best stereo imaging, we recommend that the units be placed so that the tweeters are as close as possible to the ear level of a seated listener. As this is not always possible in keeping with aesthetic design of a particular room, the Model 525W loudspeaker is designed with a pivoting tweeter which rotates to allow you to "aim" the high frequencies toward the listening position.

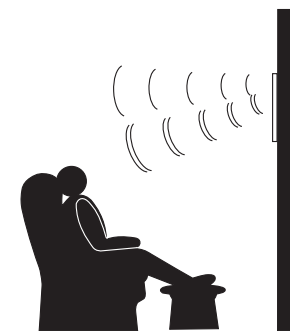

(Normal Dispersion

((Dispersion After Tweeter Adjustment

CENTER CHANNEL

One of the most important parameters for the center channel placement is height. Ideally, the center channel is positioned so that its tweeter is on the same horizontal plane as the left/right speakers. This establishes a firm image height when special audio effects are panned from one side to the other, such as a speeding car moving across the screen. When a large discontinuity occurs between the heights of the center and left/right front speakers, the image of the moving object becomes confused and somewhat unnatural due to shifts in image height. *Note: Although the speaker can be mounted either horizontally or vertically, the MTM design used in the Model 525W will produce a more evenly distributed sound throughout the listening area if mounted vertically.*

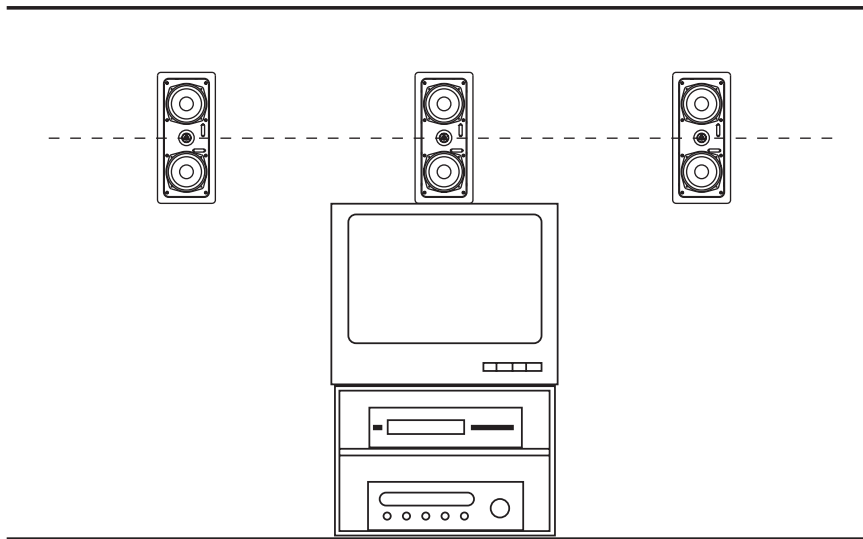

STEP 1

Using a stud finder (available at low cost at most hardware stores) or other accurate method, locate center point between two studs and mark. Using template provided, trace hole pattern on surface of wall.

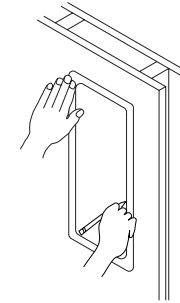

STEP 2

Using a sabre saw, keyhole saw or very sharp utility knife, cut hole in wall, following traced pattern.

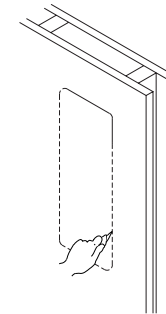

STEP 3

Run loudspeaker wires to sound source location. There are several methods you can use to accomplish wiring, depending on the construction characteristics of the room or house. You can add a professional touch to your installation by using a speaker terminal plate at the source location. Leave sufficient amount of wire at speaker location (8 to 10 inches) to complete connection.

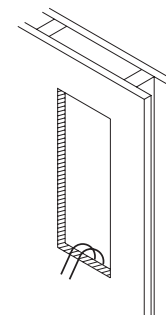

Free Manuals Download Website

<http://myh66.com>

<http://usermanuals.us>

<http://www.somanuals.com>

<http://www.4manuals.cc>

<http://www.manual-lib.com>

<http://www.404manual.com>

<http://www.luxmanual.com>

<http://aubethermostatmanual.com>

Golf course search by state

<http://golfingnear.com>

Email search by domain

<http://emailbydomain.com>

Auto manuals search

<http://auto.somanuals.com>

TV manuals search

<http://tv.somanuals.com>