



DKW-1 GT OPERATING INSTRUCTIONS

Congratulations on your purchase. The Nady DKW-1 GT is the perfect entry level professional wireless, and delivers clear, transparent audio for your instrument. Although offered at a breakthrough new low price for a professional wireless, this system is loaded with features:

- High-band VHF (170-216 MHz) operation for interference-free performance
- Full frequency response from 40 –20,000 Hz
- 250 ft. typical, up to 500 ft. line-of-sight operating range
- DKW-1 receiver with unique vertical space-saving mini portable design and jumbo LED indicators for power ON, transmitter ON and audio peak. Special added circuitry eliminates transmitter ON/OFF "pop" noise.
- All the advantages of wireless operation without cumbersome cords
- Easy to use — simply plug in instead of your cord
- Excellent high fidelity and dynamic range — perfect for wireless guitar, bass, and other instruments with pickups

OPERATION

A. DKW-1 RECEIVER

1. Plug the AC/DC adapter (provided) into the **12VDC INPUT JACK (3)** on the back of the receiver. Then plug the power supply into an AC outlet. Slide the **POWER SWITCH (1)** to the ON position. The **POWER ON LED (6)** will now light and the receiver is operational.

2. Rotate and extend **ANTENNA (7)** to the full vertical position.

3. The 1/4" **AUDIO OUTPUT JACK (2)** provides a fixed, unbalanced MIC level audio output for connection to your mixer with the 3 ft. 1/4" to 1/4" cord supplied. As when making any connection, make sure the mixing board's volume is at the minimum level before plugging in the receiver to avoid possible sound system damage.

B. WGT BODYPACK TRANSMITTER

1. Snap open the **BATTERY COMPARTMENT (8)** and insert a fresh alkaline **9V BATTERY (9)**, observing the correct polarity. Close the compartment. The WGT is provided with a **3.5 mm LOCKING JACK (13)** for connecting the **INSTRUMENT CABLE (14)**. To secure the connection, turn the metal slip ring on the plug clockwise to thread it on to the jack. To unplug, reverse the process. Slip the transmitter into a pocket or clip on to your clothes or instrument strap. (Note: As the cord to the instrument also serves as the antenna, be sure to extend it fully for maximum range. Rolling up or shortening the cord may reduce the effective operating range.)

2. Turn on the WGT by sliding the **OFF/MUTE/ON SWITCH (10)** to the MUTE position (transmitter on, audio muted) or the ON position (transmitter and audio both on). The **BATTERY INDICATOR LED (11)** will give a single quick flash, indicating usable battery strength. In the case of a dead or low battery, the LED either will not go on at all or will stay on continuously, indicating that the battery should be replaced with a fresh one.

3. The WGT is now ready to use. The **TRANSMITTER SIGNAL RECEIVED LED (5)** on the DKW-1 receiver should now be lit. When ready to perform, slide the transmitter switch to the ON position and adjust the mixing board volume level as needed. (Note: Turning down the input gain too much can compromise the signal-to-noise ratio and is not recommended. Set for the maximum possible gain and headroom without noticeable distortion on the high level peaks).

The **AUDIO PEAK LED (4)** on the DKW-1 receiver will light up with loud audio. Occasional flickering on and off during use of this top red LED indicator display is normal, however if the red LED stays on continuously, turn down the instrument volume or adjust the **INPUT LEVEL CONTROL (12)** on the WGT transmitter, or noticeable distortion may result.

(Note: Scratchy noises can sometimes occur when some electric guitars/basses with dirty pots or connections are used with any wireless system. For this reason, the supplied **INSTRUMENT CORD (14)** has a factory installed capacitor inside the 1/4" plug. This capacitor provides first order filtering of the RF signal from the cord into the guitar and eliminates virtually all scratchy noises. Should your equipment still

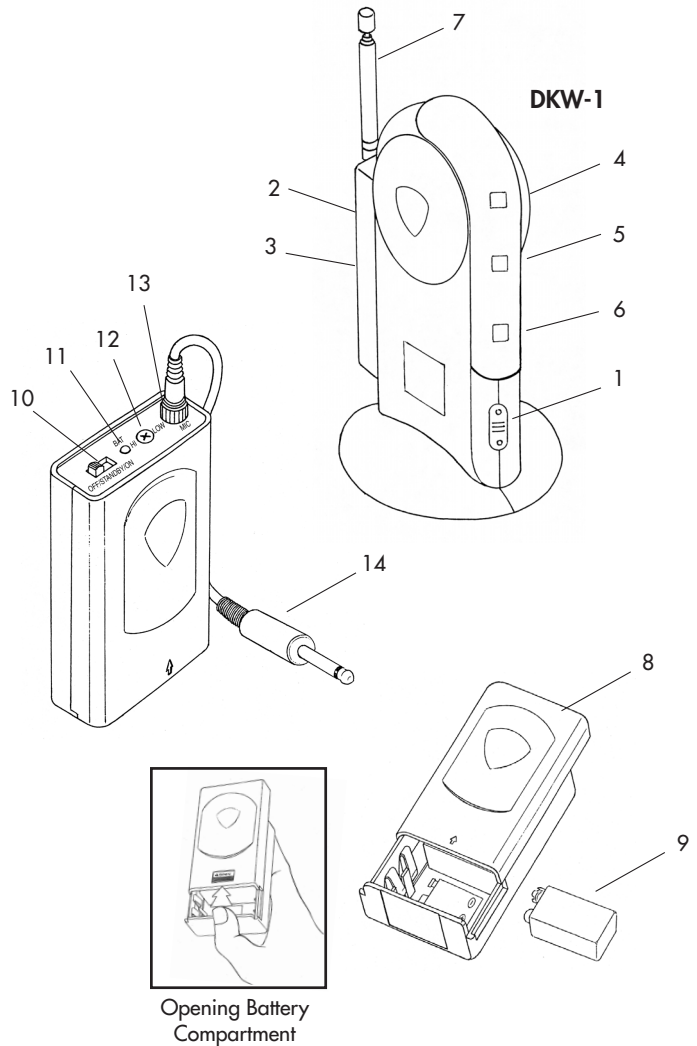

give you scratchy noises, we suggest these steps to eliminate them:

- 1) Make sure all guitar volume and tone pots are clean and all contacts are solid – this is very important.
- 2) Provide extra filtering with a 220 pF capacitor soldered across the hot to ground terminals of the guitar's volume and tone pots.)

SERVICE

(U.S.) Should your Nady DKW-1 Wireless Microphone System require service, please contact the Nady Customer Service Department via telephone: (510) 652-2411 or e-mail: service@nady.com.

(INTERNATIONAL) For service, please contact the Nady distributor in your country through the dealer from whom you purchased this product.

The warranty card supplied with this system provides valuable warranty and service information. Store it in a safe place for future reference. Do not attempt to service this unit yourself as it will void your warranty.



NADY SYSTEMS, INC.

6701 Shellmound Street • Emeryville, CA 94608 • Tel: 510.652.2411 • Fax: 510.652.5075 • www.nady.com

Download from www.Somanuals.com. All Manuals Search And Download.

© NADY SYSTEMS, INC. 2004

Free Manuals Download Website

<http://myh66.com>

<http://usermanuals.us>

<http://www.somanuals.com>

<http://www.4manuals.cc>

<http://www.manual-lib.com>

<http://www.404manual.com>

<http://www.luxmanual.com>

<http://aubethermostatmanual.com>

Golf course search by state

<http://golfingnear.com>

Email search by domain

<http://emailbydomain.com>

Auto manuals search

<http://auto.somanuals.com>

TV manuals search

<http://tv.somanuals.com>