

NADY[®] AUDIO

Features, Instructions & Technical Data



P-Cab™ Powered Speaker

PCS-12

Powered Full Range Speaker

Congratulations!

You have just purchased one of the finest powered speakers on the market today. The P-Cab Series™ was developed using the expertise of professional sound engineers and working musicians. You will find your new NADY AUDIO powered speaker has superior performance and greater flexibility than any other powered speakers in its price range.

We recommend that you read this instruction sheet carefully to get the most out of your new unit. Thanks for selecting NADY AUDIO and the PCS-12 as your choice in powered speakers.

Powerful 2-way active speakers with superior performance, state-of-the-art versatile design, unprecedented affordability, and perfect for all small venue application.

FEATURES AND SPECIFICATIONS

- Full-range, 2-way 400W Peak (200W RMS) powered speaker utilizing a 12" woofer and titanium horn
- Durable yet lightweight molded high-impact, mineral-loaded polypropylene trapezoid speaker enclosures, designed to deflect bumps and scrapes and perfectly balanced for ease of portability and set-up; built-in handles for carrying
- Ultimate flexible design-flyable, stackable, pole mountable, or can be used as a floor monitor when laid on its side with supplied brace mounts
- Internal power system delivers 200W RMS to the speaker providing high quality audio performance in a conveniently combined package.
- Easy to use built-in 3 channel mixer with XLR and 1/4" balanced Mic/Line inputs; gain, Treble, Mid, and Bass EQ's
- Channel and Master Level controls; and amp Clipping LED
- Fused IEC power cord jack and a 115VAC(60Hz) / 230VAC(50Hz) Select switch.
- Full top-end speaker features, wide-angle, short throw, high-frequency dispersion horn (90°H x 60°V) with 1" diameter precision titanium compression driver, 20Hz - 20KHz frequency range, and high SPL output capability
- Optional padded zippered vinyl carrying case available

WARNINGS IMPORTANT SAFETY INSTRUCTIONS

When using this speaker, basic precautions should always be taken, including the following:

- Read all instructions before using the product.
- This product may be capable of producing sound levels that could cause permanent hearing loss. Do not operate for a long period of time at a high volume level or at a level that is uncomfortable. If you experience any hearing loss or ringing in the ears, you should consult an audiologist.
- To avoid damage to the drivers, never overload the speaker.
- To avoid the risk of fire, do not ever expose the speaker to a source of naked flames. Also, it should be located away from heat sources such as radiators, heat vents, or other devices (including amplifiers) that produce heat.
- The product should be positioned so that proper ventilation is maintained.
- This speaker is designed for indoor use only. Do not expose to weather or high humidity, rain, etc.
- Care should be taken so that objects do not fall into, and liquids are not spilled through, the enclosure's openings. Do not place containers of liquids on the speaker.
- Don't place any heavy appliance or object (>130lbs/60kg) on the speaker enclosure.
- This unit is to be installed by qualified personnel only.
- This speaker is only to be used with power amplifiers complying with the safety requirement of EN or IEC60065.
- This product should be serviced by qualified service personnel if:
 - A. Objects have fallen into, or liquid has been spilled onto the product.
 - B. The product has been exposed to rain.
 - C. The product does not appear to operate normally or exhibits a marked change in performance.
 - D. The product has been dropped, or the enclosure damaged.
- Do not attempt to service this unit. All servicing should be referred to qualified service personnel.

SPECIFICATIONS TECHNICAL DATA

(1) POWER ON/OFF SWITCH

(2) AC POWER CORD IEC CONNECTOR w/ internal fuse holder

Connects to the AC power cable. Fuse: 115VAC ~ 5A 250V 20mm glass tube
230VAC ~ 3A 250V 20mm glass tube

(3) AC SELECTOR SWITCH

Before plugging in the power cord, check to see that this switch is set to the proper voltage for your area: ~115V (60Hz) or ~230V (50Hz).

Note: Units damaged due to powering up with the wrong voltage are not covered under warranty.

(4) POWER ON LED

(5) CLIPPING LED

This LED turns red when the output signal is clipping. It is acceptable if the red LED lights occasionally. If the red LED lights more than occasionally, you should turn down the volume to avoid audible distortion and damage to the speaker.

Note: Speakers damaged due to hard clipping are not covered under warranty.

(6) MIC INPUTS

Balanced XLR and 1/4" TRS inputs for use with a mic level input signal.

(7) MIC LEVEL CONTROL

(8) LINE 1 INPUTS

Balanced XLR and 1/4" TRS inputs for use with a line level input signal.

(9) LINE 1 LEVEL CONTROL

(10) LINE 2 INPUTS

Balanced XLR and dual RCA inputs for use with line level input signals.

(11) LINE 2 LEVEL CONTROL

(12) LINE OUTPUTS

Balanced XLR and 1/4" TRS outputs. Master Volume/Bass/Treble controls do not effect these outputs.

(13) MASTER VOLUME CONTROL

This controls the volume sent to the speaker. Make sure to turn this

(14) TREBLE EQ

Adjusts treble frequencies +/-12dB.

(15) BASS EQ

Adjusts bass frequencies +/-12dB.

SPECIFICATIONS

Frequency Range: <20 Hz - 20 kHz (0dB/-10 dB)

Frequency Response: 20 Hz - 12 kHz (± 3 dB)

Treble EQ: ± 12 dB @ 6 kHz

Bass EQ: ± 12 dB @ 55 Hz

LF Driver: 15" (380 mm) driver

HF Driver: Titanium compression driver 1" voice coil

Amplifier Power: 400W Peak (200 W RMS) @8 ohms

Speaker Power Handling: 600W Peak (300 W RMS)

Max SPL: 102dB @1M

Sensitivity (1W/1M): 96dB

Total THD: <5%

Weight: 50.1 lbs (22.7 Kg)

Dimensions (WDH): 17.3" x 26.6" x 13.6" (43.9 cm x 67.6 cm x 34.5 cm)

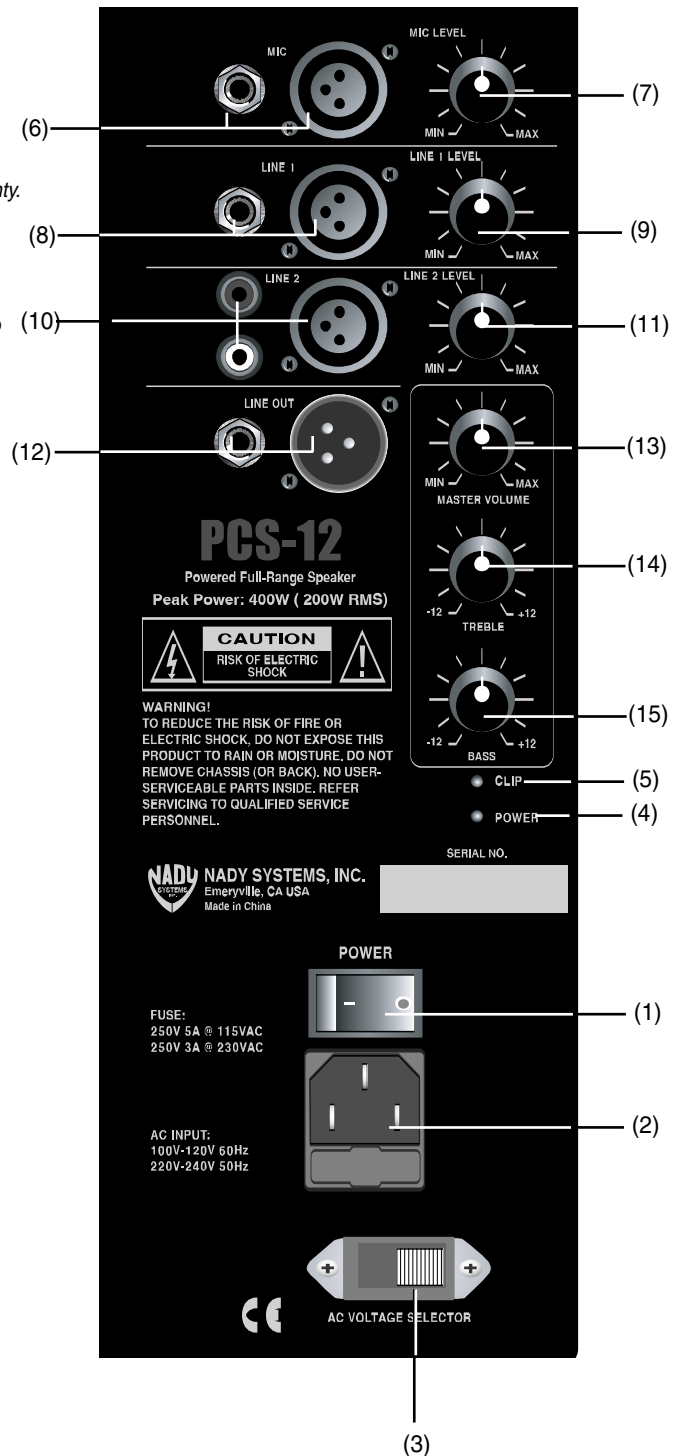

SERVICE FOR YOUR NADY AUDIO PRODUCT

(U.S.) Should your NADY AUDIO product require service, please contact the Nady Service Department via telephone at (510) 652-2411 or e-mail at service@nady.com.

(International) For service, please contact the NADY AUDIO distributor in your country through the dealer from whom you purchased this product.



NADY SYSTEMS, INC. • 6701 SHELLMOUND STREET, EMERYVILLE, CA 94608
Tel: 510.652.2411 • Fax: 510.652.5075 • www.nady.com

Free Manuals Download Website

<http://myh66.com>

<http://usermanuals.us>

<http://www.somanuals.com>

<http://www.4manuals.cc>

<http://www.manual-lib.com>

<http://www.404manual.com>

<http://www.luxmanual.com>

<http://aubethermostatmanual.com>

Golf course search by state

<http://golfingnear.com>

Email search by domain

<http://emailbydomain.com>

Auto manuals search

<http://auto.somanuals.com>

TV manuals search

<http://tv.somanuals.com>