



NESPRESSO®

**C 290
D 290**

Instruction Manual



Read this Instruction Manual and the safety instructions (pages 8 and 9) before operating the appliance!
Download from www.Somanuals.com. All Manuals Search And Download.

Start up



Verify that the voltage indicated on the technical specifications plate on the bottom of the unit corresponds to your electrical installation.

1

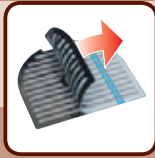

Remove protective foil



Refill with fresh water



Insert water tank

2

Rinse

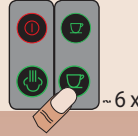

3

Rinse



Daily care and cleaning



Remove the capsule used



Empty used capsule container



Empty



Refill with fresh water

Functions

Closing h

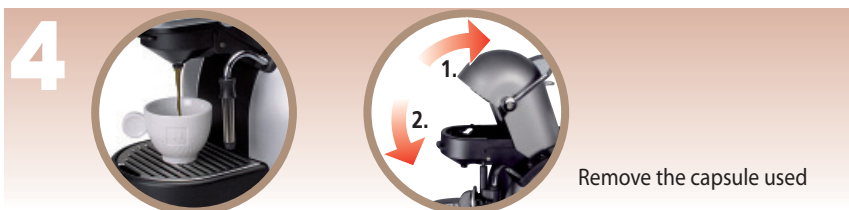
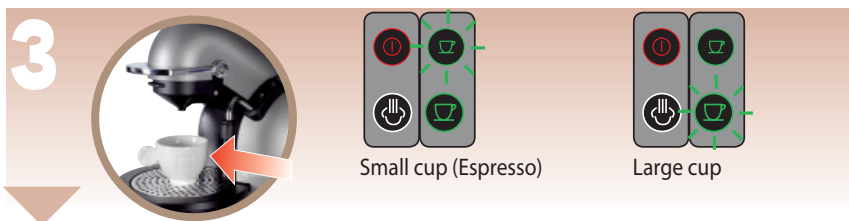
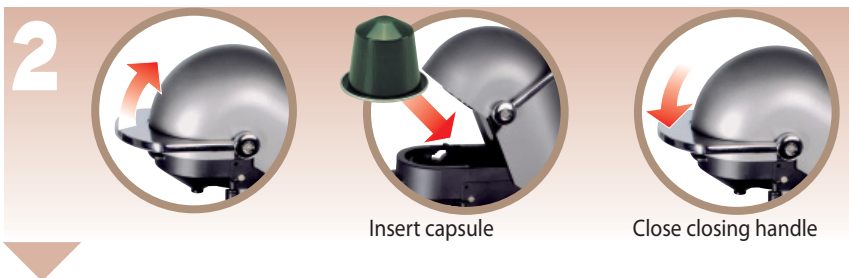
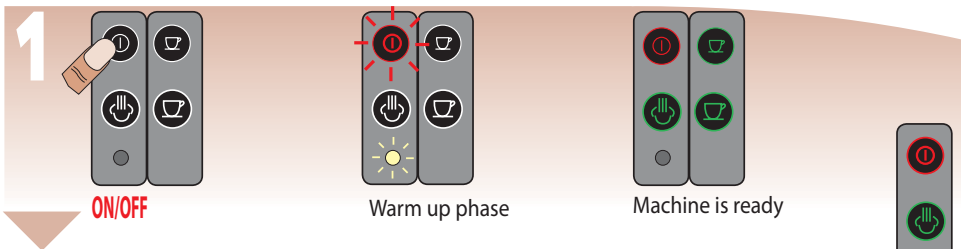

Programming the fill-up level

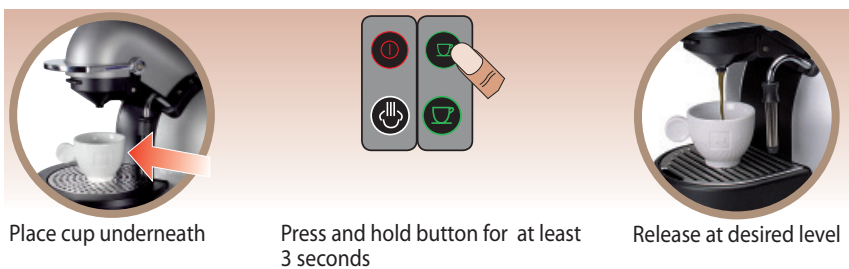

CAPPUCCINO – CAF



Steam nozzle is very hot

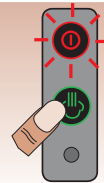

Warm up phase

Milk foam

Hot milk

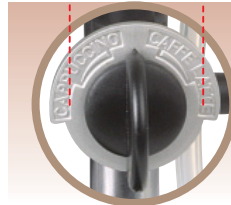

Temp ~ 55°C

Switch position CAPPUCCINO or CAFFELATTE

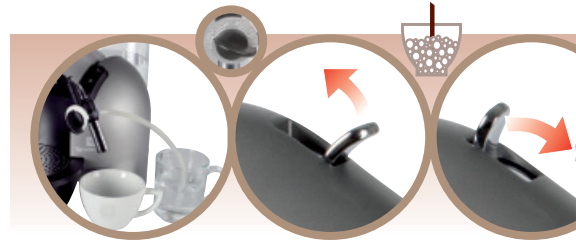

Steam rises from

Automatic cool down (If not manually activated, cool down starts automatically after 2 minutes)



CAPPUCCINO – CAFFELATTE

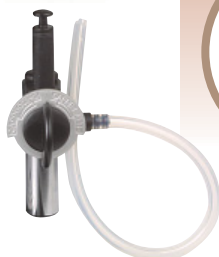

ESPRESSO®

CAPPUCCINO – CAFFELATTE:

FELATTE:

Clean after each use

1



Machine is ready

 Steam nozzle is very hot

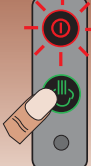
 ~ 30 s

Warm up phase

 Machine is ready



Refill with fresh water

2

Temperature change
-75°C

 Steam rises from the drip tray



Rinse for at least 10 s

 Automatic cool down

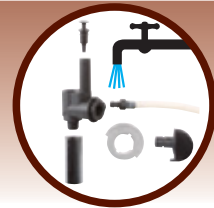

Remove and clean nozzle once weekly

3

STOP

Hot water



4

from the drip tray

Heat up beverages

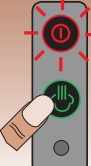
 ~ 30 s

Warm up phase

 Machine is ready



 Do not touch the bottom of the cup

5



 Steam nozzle is very hot



 Automatic cool down

Descaling

Decalcifier: aggressive to the surface of the casing

Never use vinegar!

| Water hardness | | Descalce after |
|----------------|----|----------------|
| fH | dH | |
| 36 | 20 | 300 |
| 18 | 10 | 600 |
| 0 | 0 | 1200 |

1 Preparation

Remove steam nozzle

100 ml decalcifier + 500 ml water

min 1 h

2a Descaling water system

Warm up phase

~30s

Press simultaneously 3 s

Flush out the entire tank

STOP

2b Descaling coffee system

Reuse decalcifier

Warm up phase

~30s

Press simultaneously 3 s

Decalcify coffee system

~5x

Waste solution

3 Rinse

Clean and rinse with a lot of water. Refill with fresh water.

Rinse coffee system

~5x

Flush residue from the tank

STOP

4 Clean

OFF

Clean

Machine is ready

Alerts

Empty used capsule container:



3 X beep



Machine is not ready:



1 X beep



Drip tray is not properly placed.



No coffee flows when the container is full.

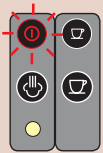

1 X beep



Temperature is too high or too low.



wait ~ 30 seconds

Problems / Solutions

No control-LEDs turn on



Check plug, mains switch and fuses

Coffee not hot enough



Preheat cup (hot water without capsule), descale if necessary

Lower/upper jaws leak



Call the NESPRESSO Club

No hot water/steam



Remove steam nozzle and clean, descale if necessary

Milk does not froth



Check the switch position CAPPUCCINO – CAFFELATTE. Clean it if needed.

Noisy pump



Fill tank



Optional accessories



NESPRESSO descaling kit
Art. 3035/C290



Service-Kit 1b
Baseplate, ejector



Service-Kit 2
Capsule cage, capsule cage key

Spare parts



Water tank



Cover

Technical data



Environment



Packaging is made of recyclable materials.



Environment protection first!

Your appliance contains valuable materials which can be recovered or recycled.
Leave it at a collection point.



Warranty according to the enclosed certificate of guarantee.

Date of purchase

Dealer's stamp / Signature

The guarantee becomes void if incorrectly connected.
The manufacturer cannot be held liable for damages caused
by unintended purpose or by improper operation.



Safety advice

- Read these instructions carefully before using your new coffee machine for the first time. Keep them in a place where you can find and refer to them later on. Improper use of the machine releases Nespresso from any liability.
- Emergency: Immediately remove plug from power socket.
- This product has been designed for domestic use only.
- Hot water, steam and the hot water/steam nozzle are very hot. Danger of burns!
- Never direct the stream of hot water or steam towards body parts. Danger of burns!
- Remove plug from socket if not in use for long periods, holiday etc.
- Children should never use the appliance without close adult supervision.
- Check that the voltage quoted on the rating plate is the same as your voltage.
- Connect the appliance only to power sockets with an earth. The use of incorrect connection voids warranty.
- To heat up beverages: immerse steam nozzle as deeply as possible into the beverage, otherwise steam and the beverage may splash out.
- Attention: Do not draw off hot water when the green lamp is flashing fast. A strong jet of steam would shoot out instead of hot water - risk of burns!
- Always close the jaw with the handle.
- Before cleaning and servicing, remove the plug from the mains socket and let the machine cool down.
- Place on a flat, stable, heat-resistant surface away from water splashes and any heat sources
- Do not use the machine if it is not operating perfectly or if there is evidence of damage. In such cases inform Nespresso Club.

- Do not place power cord by hot parts or sharp edges, etc.
- In case of damage, do not use the appliance. In order to avoid danger have repairs and replacement of power cord only by authorised service centre.
- Never clean wet or immerse plug, cord or appliance in any fluid.
- Keep the cable out of reach of children.
- All operations other than normal use, cleaning and care must be performed by approved service centre.
- For your own safety, you should use only parts and accessories from Nespresso that are made for your machine.
- Never use the machine without the drip tray or the base grid.

Free Manuals Download Website

<http://myh66.com>

<http://usermanuals.us>

<http://www.somanuals.com>

<http://www.4manuals.cc>

<http://www.manual-lib.com>

<http://www.404manual.com>

<http://www.luxmanual.com>

<http://aubethermostatmanual.com>

Golf course search by state

<http://golfingnear.com>

Email search by domain

<http://emailbydomain.com>

Auto manuals search

<http://auto.somanuals.com>

TV manuals search

<http://tv.somanuals.com>