

Error Codes

I L b	Ink Low: black	Make sure you have a replacement cartridge.
I L c	Ink Low: color	Make sure you have a replacement cartridge.
E r r I E b	Ink Empty: black	Replace the black ink cartridge.
E r r I E c	Ink Empty: color	Replace the color ink cartridge.
E r r P E	Paper End	Load (or reload) paper and press the maintenance button.
E r r P J	Paper Jam	Press the maintenance button to eject the jammed paper. (If you're using roll paper, press and hold the roll paper button.) If you still see the error, turn off the printer, open the printer cover, and remove all paper, including any torn pieces. Then reload paper, turn the printer on, and press the maintenance button to continue.
E r r I C	Install Cartridge	One of the ink cartridges is missing or not installed correctly. Remove the cartridge and reinstall it.
E r r S r	Service Required	Turn the printer off, wait a few seconds, and turn it back on. If you still see the error, contact EPSON as described in <i>Printer Basics</i> .
E r r C E	Card Error	The memory card is damaged or the data is corrupted. Try reformatting the card in your camera.
E r r F E	Fatal Error	Turn the printer off, wait a few seconds, and turn it back on. If you still see the error, contact EPSON as described in <i>Printer Basics</i> .



Printing Without a Computer

Here's how to use the control panel:

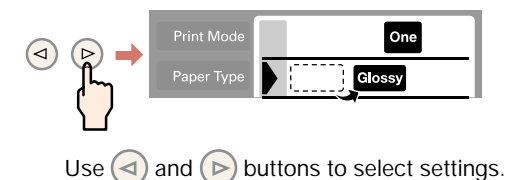
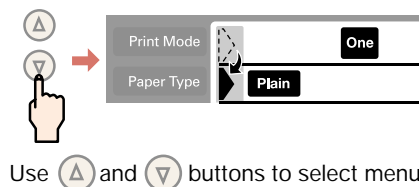
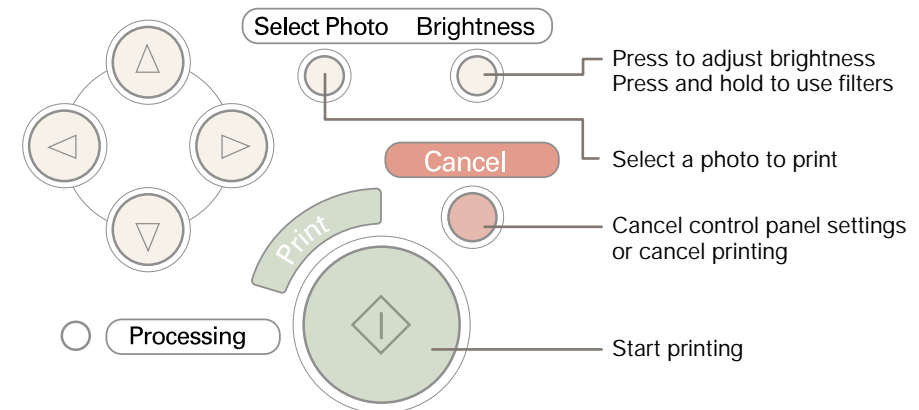
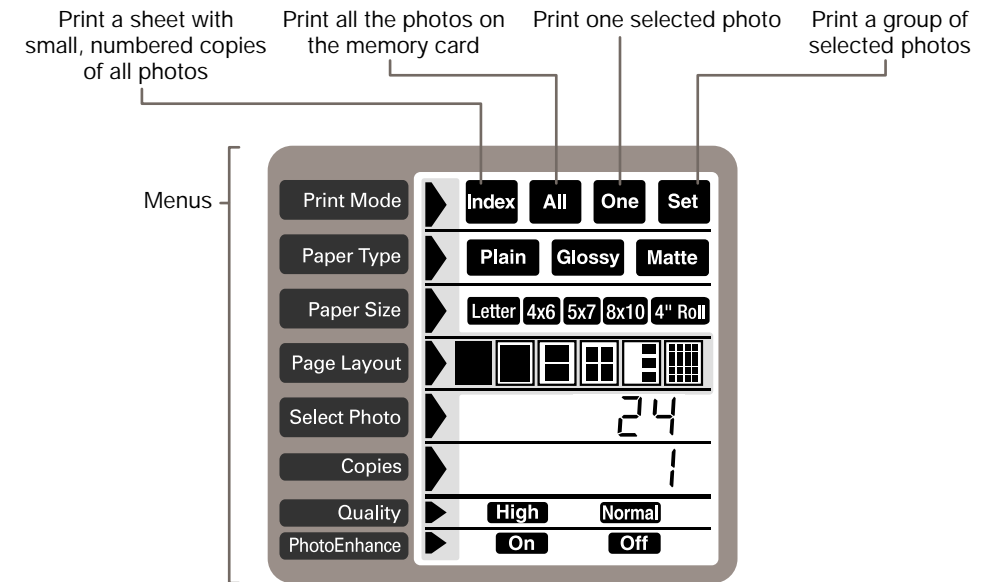

Inserting a Memory Card

1. Insert your memory card into the adapter.

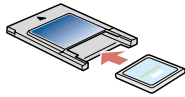

2. Insert the adapter into the card slot. Push it in firmly so the button pops out.

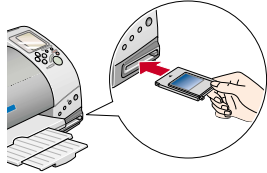

Printing an Index

An index print includes small, numbered copies of all the pictures on the memory card.

1. Load plain paper.

Place the paper against the right side of the feeder.

Slide the edge guide against the paper.

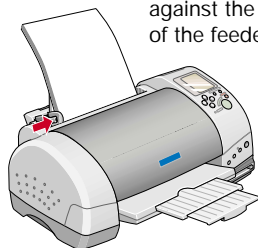

2. Make sure these settings appear on the control panel:

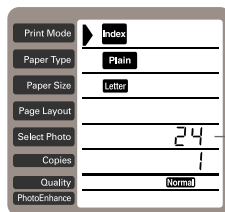

Number of photos on the card

3. Press the **Print** button.

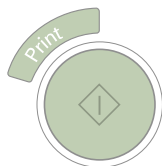

Your index is printed. Use it to select photos for reprinting and enlarging.



Printing Snapshots

1. Load EPSON Borderless Photo Paper 4"x 6".

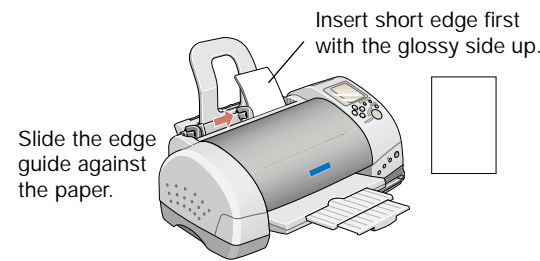

Slide the edge guide against the paper.

2. In the Print Mode menu, select **Set**.

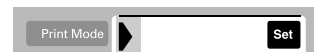

3. In the Paper Type menu, press the \leftarrow button and hold it for several seconds until **PP** (photo paper) flashes on the Select Photo menu.

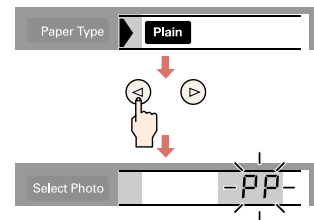

When you move to other menus, the **PP** disappears. But photo paper is still selected.

4. In the Paper Size menu, select **4x6**.

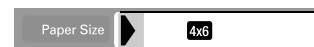

5. In the Page Layout menu, select \blacksquare for borderless prints, or \square for white borders.

6. In the Select Photo menu, choose the number of the photo you want to print.



7. Press the round **Select Photo** button.

8. Repeat steps 6 and 7 for each photo you want to print.

9. Press the **Print** button.

Adjusting Brightness

1. Press the round **Brightness** button.



2. Press the \ominus button once or twice to make your pictures 1 or 2 steps lighter.

Press the \oplus button once or twice to make them 1 or 2 steps darker (-1 or -2 is displayed).

3. Press the **Brightness** button again.

Printing With Filters

See your *Printer Basics* book for instructions. Your printer comes with filters shown below:

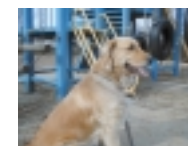

no filter

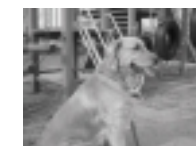

1. black and white



2. sepia

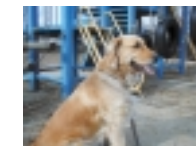

3. high contrast

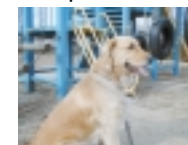

4. 1 level brighter

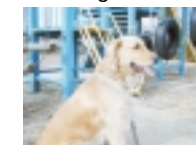

5. 2 levels brighter

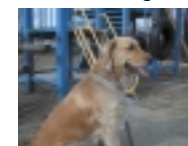

6. 1 level darker

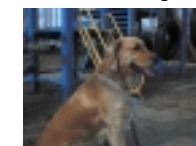

7. 2 levels darker

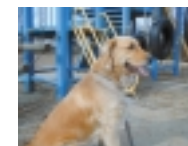

8. more vivid

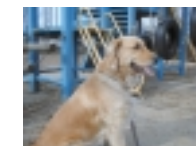

9. sharper

Printing Special Layouts

You can print \blacksquare 2, \square 3, \blacksquare 4, or \blacksquare 20 photos per page by selecting these settings on the Page Layout menu.

You can also...

Turn a normal landscape into a panoramic photo.



Take a portrait and print 8 different sizes on one sheet of paper.



Turn your favorite picture into photo stickers.

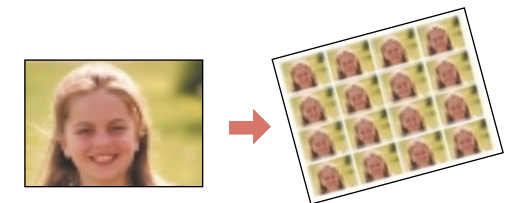

See your *Printer Basics* book for instructions.

Free Manuals Download Website

<http://myh66.com>

<http://usermanuals.us>

<http://www.somanuals.com>

<http://www.4manuals.cc>

<http://www.manual-lib.com>

<http://www.404manual.com>

<http://www.luxmanual.com>

<http://aubethermostatmanual.com>

Golf course search by state

<http://golfingnear.com>

Email search by domain

<http://emailbydomain.com>

Auto manuals search

<http://auto.somanuals.com>

TV manuals search

<http://tv.somanuals.com>