

nextar

N7-110

User's Manual



Digital Photo Frame

Introduction

Thank you very much for choosing our Digital Photo Frame.

Before you begin using this device, please read this manual thoroughly and keep it available for future reference. This manual will present you with the exciting features provided by our Digital Photo Frame.

With our Digital Photo Frame, you can easily and quickly view photos directly from your digital camera's memory card. You can even create a slideshow with multiple transition effects. No computer, digital camera, or Internet connection is required.

Our Digital Photo Frame is compatible with the following memory cards and ports: SD, MultiMedia Card, Memory Stick, and Memory Stick PRO.

Main Features

- ★ This device can display digital pictures (JPEG).
- ★ Compatible with Secure Digital Card (SD), MultiMedia Card (MMC), Memory Stick and Memory Stick Pro.
- ★ Handy remote control
- ★ Automatic slide show with multiple transition effects and clock display.
- ★ User-friendly on-screen display allows you to access all functions easily.

Safety Precautions and Maintenance

- ★ For indoor use only.
- ★ To reduce the risk of fire or electric shock, do not expose this appliance to rain or moisture.
- ★ To prevent overheating, never block any vents on the back of the digital photo frame.
- ★ Keep your Digital Photo Frame out of direct sunlight. Direct sunlight may cause damage.
- ★ Always use the buttons built in to the memory card slots to remove memory cards from the device.
- ★ Do not disassemble the Digital Photo Frame, otherwise it may result in electric shock and void your warranty. No user-serviceable parts inside.
- ★ Protect the device from condensation, which could damage your Digital Photo Frame.

How to Clean LCD Screen

- ★ Wipe the screen gently. The screen is made of glass and may be easily scratched or broken.
- ★ To clean fingerprints and dust from the LCD screen, a soft, non-abrasive cloth such as a camera lens cleaning cloth is recommended.
- ★ Do not apply cleaning liquid directly to the LCD screen if using LCD screen cleaning kits available at retail outlets. Moisten the cleaning cloth with the cleansing solution, then wipe the LCD screen with the damp cloth.

Screen Saver

- ★ Without a memory card, or when the appliance is in 「STOP」 or 「PAUSE」 mode, a screen saver program will automatically start after 10 minutes. Pressing any buttons will return the appliance to the main screen.



WARNING:

Please STOP the device before you insert or remove any memory card or USB device. Doing otherwise may cause damage to the card/USB and the device.

To Remove and Replace the Picture Frame Color Panel:

Photo 1

With both hands on the picture frame panel, place thumbs on the upper portion of the frame and index fingers at the corners. Lift the corners with the index finger.

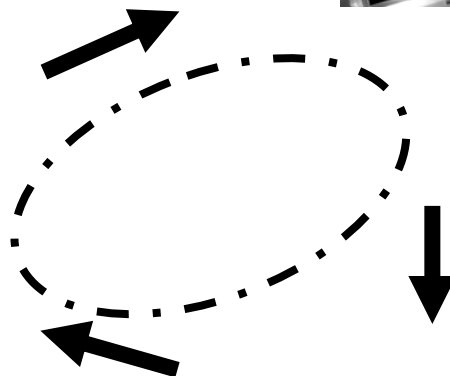
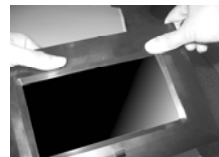

Photo 3

To change panel, simply place the panel over the frame and press down with thumbs and index fingers.

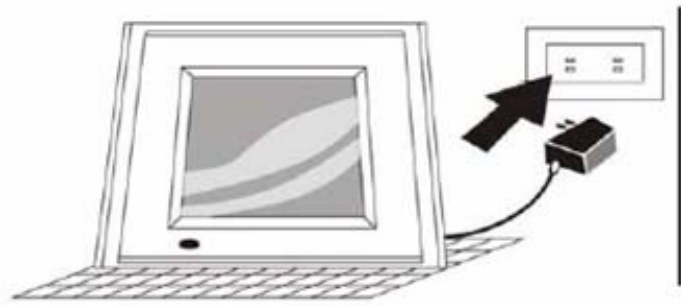

Photo 2

Frame will lift off.

Preparation

1. Install the support bracket for the device. Plug the Digital Photo Frame power adaptor into a working electrical outlet.



2. Turn on the main power using the switch on the back of the Digital Photo Frame. Then press the 「POWER」 button on the remote control or on the top of the Digital Photo Frame.

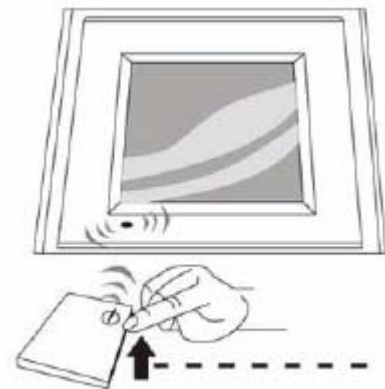

How to Insert Memory Cards

Your Digital Photo Frame is compatible with the following memory cards:

- ★ Secure Digital Card (SD)
- ★ Multimedia Card (MMC)
- ★ Memory Stick and Memory Stick Pro

Insert the memory card with its label facing up. Do not try to force a memory card into the slot. If it is difficult to insert the card, you may be inserting the card incorrectly.

Note: Only JPEG-format digital image files can be read by the Digital Photo Frame. The device may fail to read image files in other for

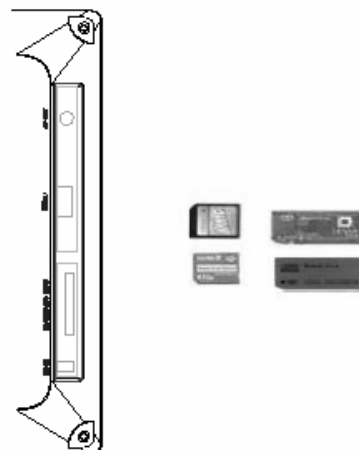

Key Features and Remote Control

Key Functions:

- 1.MENU 2.ENTER
- 3.LEFT 4.RIGHT
- 5.UP 6.DOWN
- 7.DC IN
- 8.SD/MMC/MS CARD

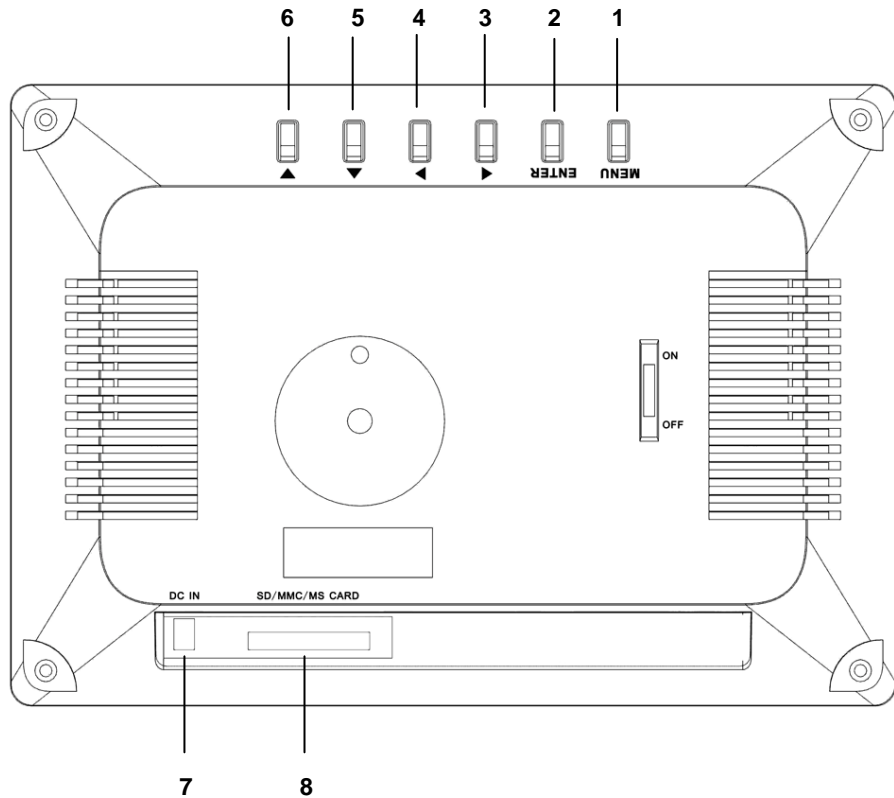

Remote Control



Note: before you use the remote control, please remove all plastic strips.

POWER: Press this button to turn the device on/off.

PHOTO: Press this button to enter Slide Show Mode available on the main menu.

CLOCK: Press this button to set up the time and the calendar.

SETUP: Press this button to display the device's setup menu.

16:9/4:3: Press this button to choose the TFT LCD aspect ratios between 4:3 and 16:9.

ZOOM: Press this button to enlarge the picture in increments of 2, 3, 4, 1/2, 1/3, 1/4, OFF.

MENU: Press this button to display the main menu.

SYSTEM SETUP

Press the **Right** and **Left** arrow keys to navigate through the Setup Categories. Press the **Up** and **Down** arrow keys to navigate through setup function items. Press the **Right** and **Left** arrow keys to modify settings, and then press **ENTER** to confirm the settings.

Operation:

OSD LANGUAGE: OSD language settings.

DEFAULT: Restores your Digital Photo Frame back to the factory default settings.

S/W VERSION: Shows the current version of the software.

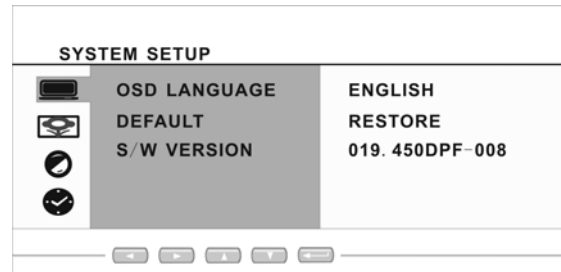
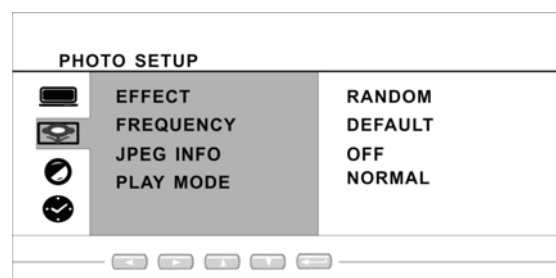

PHOTO SETUP:

EFFECT: Allows you to activate or deactivate the photo display effects. Press the **Right** or **Left** arrow keys and the **ENTER** button to turn OFF or ON (16 effects in total).

FREQUENCY: Allows you to set the interval frequency with which the display will change the photos. Press the **Right** or **Left** arrow keys and the **ENTER** button to set the frame to DEFAULT and the interval: 10SECOND, 30SECOND, 1MINUTE, 30MINUTE, 1HOUR

JPEG INFO: Allows you to adjust the JPEG photo ON/OFF settings. Press the **Right** or **Left** arrow keys and the **ENTER** button to turn ON or OFF.



PLAY MODE: Allows you to adjust the order the photos will be displayed in. Press the **Right** or **Left** arrow keys and the **ENTER** button to switch the mode between NORMAL or RANDOM mode.

CLOCK SETUP

Function:

DATE SETUP: Press arrow keys and **ENTER** button to set the date.

TIME SETUP: Press arrow keys and **ENTER** button to set the time.

POWER ON: Press arrow keys and **ENTER** to set the time to power on the device.

POWER OFF: Press arrow keys and **ENTER** to set the time to power off the device.

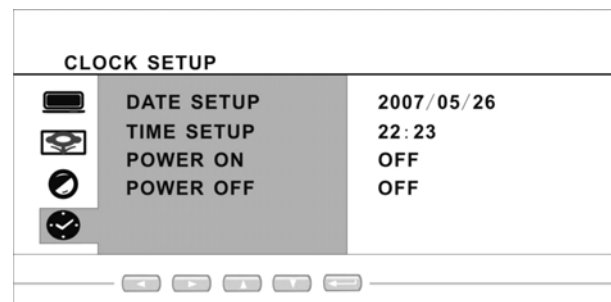

How to Set the Clock

Set the local time and calendar

Press the **Up** and **Down** arrow keys to select functions.

Press the **Right** and **Left** arrow keys to select desired settings.

Press the **ENTER** key to confirm settings.



Specifications

Display: 7" TFT LCD 480 X 234 (RGB)

Power: AC Adapter; Input 100-240V; Output 12V 1-1.5A

Environmental Requirements

Operation: 0~35°C, Humidity 0~85%

Storage: -20~60°C, Humidity 10~90%

Accessories:

AV Adapter

Remote Control

Warranty Card

Registration Card

Return Card

Manual

Free Manuals Download Website

<http://myh66.com>

<http://usermanuals.us>

<http://www.somanuals.com>

<http://www.4manuals.cc>

<http://www.manual-lib.com>

<http://www.404manual.com>

<http://www.luxmanual.com>

<http://aubethermostatmanual.com>

Golf course search by state

<http://golfingnear.com>

Email search by domain

<http://emailbydomain.com>

Auto manuals search

<http://auto.somanuals.com>

TV manuals search

<http://tv.somanuals.com>