

# Instruction Manual

## Underwater Case

# PT-022

For the digital camera  
CAMEDIA C-760 Ultra Zoom/  
C-770 Ultra Zoom

- Thank you for buying the Underwater Case PT-022.
- Please read this instruction manual carefully and use the product safely and correctly.  
Please keep this instruction manual for reference after reading it.
- Wrong use may cause damage to the camera on the inside from water leakage, and repair may not be possible.
- Before use, perform an advance check as described in this manual.

## Introduction

- Unauthorized copying of this manual in part or in full, except for private use, is prohibited.  
Unauthorized reproduction is strictly prohibited.
- OLYMPUS CORPORATION shall not be responsible in any way for lost profits or any claims by third parties in case of any damage occurring from unsuitable use of this product.
- OLYMPUS CORPORATION shall not be responsible for damage, lost profits, etc. caused by loss of image data because of defects, disassembly, repair or modification of this product by people other than third parties specified by OLYMPUS CORPORATION, or for other reasons.

## Please read the following items before use

- This Case is a precision device designed for use at a water depth within 40 m. Please handle it with sufficient care.
- Please use the Case correctly after sufficient understanding of the contents of this manual in regard to handling of the Case, checks before use, maintenance, and storage after use.
- OLYMPUS CORPORATION shall in no way be responsible for accidents involving immersion of a digital camera in water.
- OLYMPUS CORPORATION shall not pay any compensation for accidents (injuries or material damage) at the time of use.
- Before use, be sure to read the precautions printed on the package.

## For safe use

This instruction manual uses various pictographs for correct use of the product and to prevent danger to the user and other persons as well as property damage. These pictographs and their meanings are shown below.

### **WARNING**

This indicates contents for which the possibility of human death or severe injury in case of handling under disregard of this indication can be assumed.

### **CAUTION**

This indicates contents for which the possibility of human injury or the possibility of material damage in case of handling under disregard of this indication can be assumed.

## **⚠ WARNING**

1. Keep this product out of the reach of babies, infants, and children. There is the possibility of occurrence of the following types of accidents.
  - Injury by dropping onto the body from a height.
  - Injury from parts of the body getting caught in parts which open and close.
  - Swallowing of small parts. Please consult a physician immediately if any parts have been swallowed.
  - Triggering of the flash in front of the eyes may cause permanent vision impairment etc.
2. Do not store with a battery in the digital camera housed in this product. Storage with a battery inserted may lead to leakage of the battery liquid and fire.
3. If leakage of water should occur with a camera installed in this product, quickly remove the battery from the camera. There is the possibility of ignition and explosion from generation of hydrogen gas.
4. This product is made of resin. There is the possibility that injuries may be caused when it becomes broken because of strong impact with a rock or other hard objects. Please handle with sufficient care.
5. The silica gel and the grease for silicone O-rings for this product are not edible.

## **⚠ CAUTION**

1. Do not disassemble or modify this product. This may cause water leakage or trouble. In case of disassembly or modification by persons other than those appointed by OLYMPUS CORPORATION, the guarantee shall not apply.
2. Do not place this product at locations with abnormally high or abnormally low temperatures or at locations with extreme temperature changes. The product may deteriorate.
3. Opening and closing at locations with much sand, dust, or dirt may impair the waterproof characteristic and cause water leakage. This should be avoided.
4. This product has been designed and manufactured for use at a water depth within 40 m. Please note that diving to a depth in excess of 40 m may cause permanent deformation or damage to the Case and the camera inside the Case or may lead to water leakage.

5. Jumping into the water with the Case in your pocket or in your hand, throwing the Case from a boat or ship into the water, and other rough handling may cause water leakage. Please handle with sufficient care, when handing it over from hand to hand etc.
6. If the camera on the inside should become wet because of water leakage etc., immediately wipe off all moisture and confirm the operation.
7. Please remove the O-ring when traveling by air. Otherwise air pressure may make it impossible to open the Case.
8. For safe use of the digital camera in this product, please read the "Instruction Manual" for the digital camera carefully.
9. When sealing this product, take sufficient care that no foreign matter gets caught at the O-ring and the contact surfaces.

## Batteries

- Always use lithium ion battery packs manufactured by Olympus and bearing the Olympus brand. For more details, refer to your camera's instruction manual.
- Take care that the battery electrodes do not become wet. This may cause trouble or accidents.
- Carefully read the instruction manual for the camera about other cautions regarding batteries.

## For Prevention of Water Leakage Accidents

When water leakage occurs while this product is being used, repair of the camera housed in this product may become impossible. Please observe the following cautions for use.

1. When sealing this product, make sure that no hairs, fibers, sand particles or other foreign matter stick not only to the O-ring, but also to the contact surface (flat part of the front cover). Even a single hair or a single grain of sand may cause water leakage. Please check with special care.

### <Examples for foreign matter sticking to the O-ring>

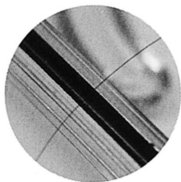

**Hair**



**Fibers**

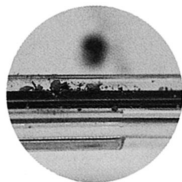

**Grains of sand**

2. The O-ring is a consumption product. Please replace it at least once a year by new one. Also perform maintenance for every use.
3. Deterioration of the O-ring will progress according to the use conditions and the storage conditions. Immediately replace the O-ring by a new one if it is damaged, shows cracks, or has lost its elasticity.
4. At the time of O-ring maintenance, clean the inside of the O-ring groove and confirm the absence of dirt, dust, sand, and other foreign matter.
5. Apply the specified silicone O-ring grease to the O-ring.
6. The waterproof function is not effective when the O-ring is not installed correctly. When installing the O-ring, take care that it does not project from the groove and that it is not twisted. Also, when sealing the Case, close the lid after confirming that the O-ring has not come out of the groove.
7. This product is an airtight construction made of plastic (polycarbonate). When it is left for a long time in a car, on a boat, at the beach, or at other places reaching a high temperature, or when it is subjected for a long time to uneven external force, it may be deformed and the waterproof function may be lost. Pay sufficient attention to temperature control. Also do not place heavy objects onto the product during storage or transport, and avoid unreasonable storage.

8. When the O-ring contact surface is pressed strongly from the outside of the Case, or when the Case is twisted, the waterproof function may be lost. Take care not to exert excessive force.
9. Please use the Case after performing the advance test and the final check.
10. If you should notice drops of water or other signs of water leakage while taking pictures, immediately stop the dive, remove any water from the camera and the product, test according to the item "Final check", and confirm whether leakage has occurred or not.

## Handling the Product

- Use or storage of the product at the following locations may cause defective operation, defects, trouble, damage, fire, internal clouding, or water leakage. Always avoid these locations.
  - Locations reaching high temperatures such as those under direct sunlight, in an automobile, etc.
  - Locations with open fire
  - Water depths in excess of 40 m
  - Locations subject to vibrations
  - Locations with high temperatures and much dust or with severe temperature changes
  - Locations with volatile substances
- This product is made of polycarbonate resin with excellent impact resistance, but it may be damaged by scraping against rocks etc. It also may break when it hits hard objects or is dropped.
- This product is not a case to soften impacts to the camera inside the product. When this product with a digital camera inside it is subjected to impacts or heavy objects are placed onto it, the digital camera may become damaged. Please handle the product with sufficient care.
- When the product is not used for a long time, the waterproof performance may drop because of deterioration of the O-ring etc. Before use, always perform the advance test and the final check.
- Do not apply excessive force to the TTL cable connector or tripod socket.
- When a flash is used while the Case is being used, shadows may appear at the edges of the picture. This is especially notable when taking pictures in macro mode on the wide-angle side. Please use a flash after image confirmation.

- Do not use the following chemicals for cleaning, corrosion prevention, prevention of fogging, repair or other purposes. When these are used for the Case directly or indirectly (with the chemicals in vaporized state), they may cause cracking under high pressure or other problems.

Chemicals which cannot be used	Explanation
Volatile organic solvents, chemical detergents	Do not clean the Case with alcohol, gasoline, thinner or other volatile organic solvents or with chemical detergents etc. Pure water or lukewarm water is sufficient.
Anticorrosion agent	Do not use anticorrosion agents. The metal parts use stainless steel or brass, and washing with pure water is sufficient.
Commercial defogging agents	Do not use commercial defogging agents. Always use the specified desiccant silica gel.
Grease other than specified silicone grease	Use only the specified silicone grease for the silicone O-ring, as otherwise the O-ring surface may deteriorate and water leakage may be caused.
Adhesive	Do not use adhesive for repairs or other purposes. When repair is required, please contact a dealer or a service station of OLYMPUS CORPORATION.

- Do not perform operations other than specified in this instruction manual, do not remove or modify parts other than specified, and do not use parts other than specified.  
Any troubles in taking pictures or with the equipment resulting from the above actions shall be outside the guarantee.
- OLYMPUS CORPORATION shall be in no way responsible for accidents involving immersion of a digital camera in water.
- OLYMPUS CORPORATION shall not pay any compensation for accidents (injury or material damage) at the time of use.
- When the enclosure of the balance weight breaks, the metal on the inside may corrode. Take care not to damage the enclosure.
- After use, wash the balance weight with pure water and wipe off all moisture sufficiently.

# Contents

Introduction .....	E-1
Please read the following items before use .....	E-1
For safe use .....	E-1
Batteries .....	E-3
For Prevention of Water Leakage Accidents.....	E-4
Handling the Product.....	E-5

## Contents ..... E-7-8

### 1.Preparations ..... E-9

Check the contents of the package. ....	E-9
Names of the parts.....	E-10
Install the strap. ....	E-11
Master the basic operation. ....	E-11
Holding the Case .....	E-11
How to Press the Shutter.....	E-12
How to Use the Mode Dial .....	E-12
How to Use the Zoom Lever .....	E-12
Setting the Zoom Lever .....	E-13
How to switch the power ON .....	E-13
Flash operation procedure.....	E-15
Removing the TTL cable connector cap .....	E-16
Removing the hot shoe cable cap .....	E-17
Cleaning the TTL connector.....	E-17

### 2.Advance Check of the Case ..... E-18

Advance test before use .....	E-18
Advance Test.....	E-18

### 3.Install the digital camera. .... E-19

Check the digital camera. ....	E-19
Battery Confirmation .....	E-19
Confirmation of the Remaining Number of Pictures to be Taken.....	E-19
Removing the carrying strap and lens cap from the digital camera....	E-19
Loading in the Case .....	E-19
Which digital cameras can be loaded? .....	E-19
Check the operation of the camera. ....	E-20
Open the Case. ....	E-20
Pull up the mode dial of the case. ....	E-20
Load the digital camera. ....	E-20
Set the mode dial. ....	E-21
Insertion of silica gel .....	E-21



Check the loading status. ....	E-22
Seal the Case. ....	E-22
Install the special balance weight. ....	E-22
Installation and Removal of the LCD Hood .....	E-23
Installation .....	E-23
Removal.....	E-23
Mounting and Removing the Lens Cap.....	E-24
Perform the final checks. ....	E-24
Visual Inspection .....	E-24
Set the power to 'ON'. ....	E-24
Try to move the mode dial. ....	E-24
Final Test .....	E-25
<b>4.Taking Pictures Under Water.....</b>	<b>E-26</b>
How to Use the Hand Strap .....	E-26
Take pictures carefully. ....	E-26
Confirm the picture on the LCD monitor. ....	E-26
Quietly press the shutter lever. ....	E-26
Cautions when using the flash.....	E-26
<b>5.Handling After Shooting .....</b>	<b>E-27</b>
Wipe off any waterdrop. ....	E-27
Take out the digital camera. ....	E-28
Wash the Case with pure water. ....	E-29
Dry the Case. ....	E-29
<b>6.Maintaining the Waterproof Function.....</b>	<b>E-30</b>
Remove the O-ring. ....	E-30
Remove any sand, dirt, etc. ....	E-30
Install the O-ring. ....	E-32
How to Apply Grease to the O-ring .....	E-32
Maintenance of the threaded sections on the TTL cable and TTL cable connector.....	E-33
Maintenance of the TTL Connector Cap .....	E-33
Replace consumable products. ....	E-34
<b>7.Appendix .....</b>	<b>E-35</b>
Q & A on the use of the PT-022 .....	E-35
After-sale Service .....	E-40
Specifications .....	E-41
Diver's Insurance Guide .....	E-41

# 1. Preparations

## Check the contents of the package.

Check that all accessories are in the box.

Contact your dealer if accessories should be missing or damaged.

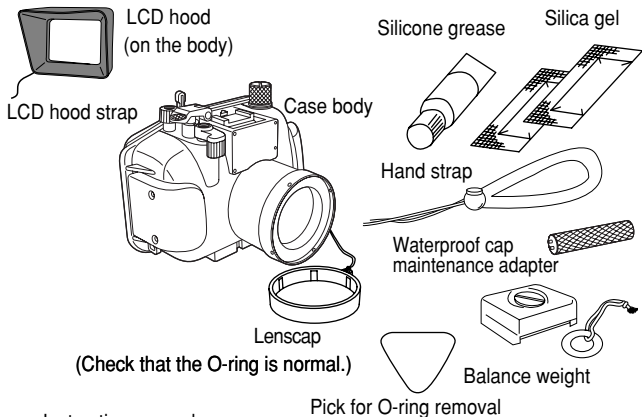

Instruction manual  
(this manual)



Warranty card



Diver's insurance guide



Information disc



## Names of the parts

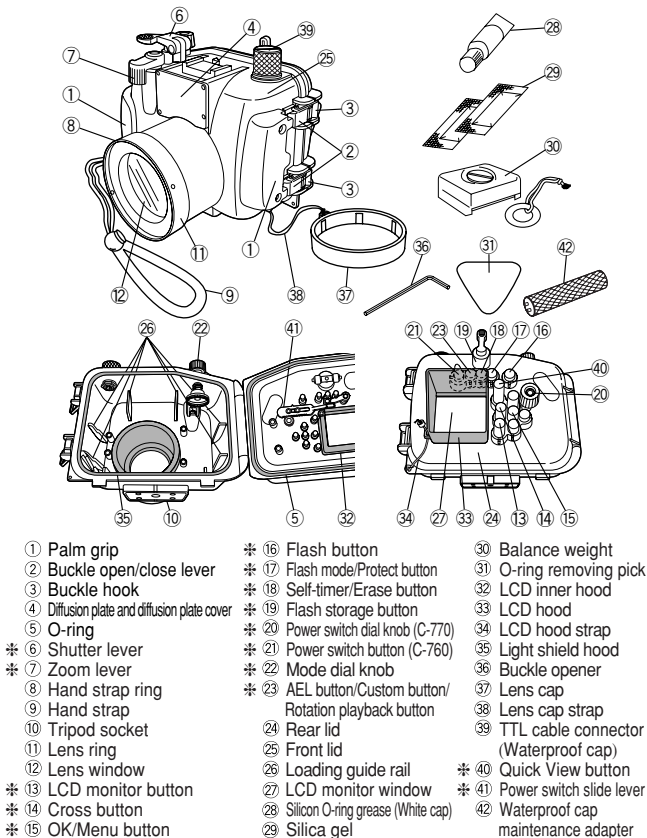

**Note :** The Case operation parts marked by\* corresponds to the operation parts of the digital camera. When the operation parts of the Case are operated, the corresponding functions of the digital camera will operate. For details of the functions, refer to the instruction manual for the digital camera.

## Install the strap.

Install the strap on the Case body.

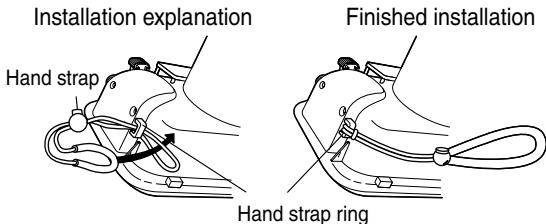

**CAUTION** : Please install the strap correctly as shown above. OLYMPUS CORPORATION shall bear no responsibility for damage etc. caused by dropping the Case because of incorrect installation of the strap.

## Master the basic operation.

Please master the basic operation of the Case before taking pictures.

### Holding the Case

Hold the Case securely with both hands, keep your elbows close to your body, and hold the Case so that you can confirm the picture on the LCD monitor of the digital camera through the LCD monitor window of the Case.

Good example

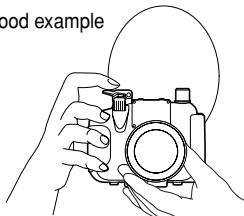

Bad example

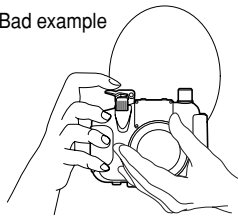

**CAUTION** : • Do not exert excessive force onto the lens window or the lens ring.  
• Take care not to put your fingers etc. over the lens window and the flash diffuser.

**Note** : • Use the LCD monitor to confirm your picture. The viewfinder cannot be used.

## How to Press the Shutter

When pressing the shutter lever, press it gently, so that there will be no movement of the camera.

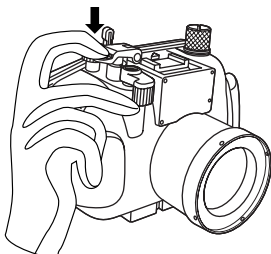

Note: • For detailed operation of the shutter, refer to the instruction manual for the digital camera.

## How to Use the Mode Dial

This Case is equipped with a mode dial knob which permits operation of the mode dial of the loaded digital camera from the outside. After loading the digital camera into the Case, seal the Case and confirm that the mode dial can be operated.

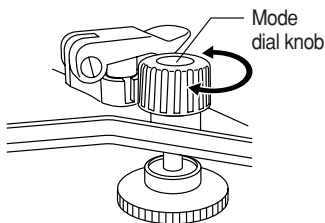

Advice • Please confirm that the mode dial knob has been set securely to the mode dial of the digital camera. If the mode of the digital camera does not change when the mode dial knob is operated, turn the dial while pushing it lightly.

## How to Use the Zoom Lever

Zoom operation is possible by operating the zoom lever of this Case corresponding to the zoom lever of the digital camera in the Case.

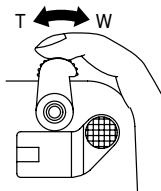

## Setting the Zoom Lever

When loading the digital camera in the Case, fit the projecting part of the zoom lever of the digital camera into the recessed part of the zoom lever on the inside of the Case.

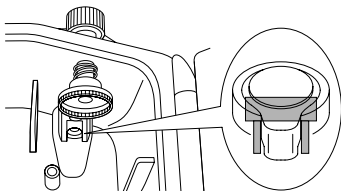

- CAUTION :**
- When loading the camera, confirm that the projecting part of the zoom lever of the camera is properly set to the recessed part of the zoom lever of the Case.
  - When the setting is insufficient, the loading of the camera becomes imperfect and it may not be possible to seal the Case or zooming may not function. Insufficient sealing will cause water leakage.

## How to switch the power ON

The method of turning this product ON is variable depending on the camera in use (C-760 Ultra Zoom/C-770 Ultra Zoom). See the following procedures for details.

### C-760 Ultra Zoom

- 1) Gently turn the power switch dial knob clockwise until it stops.

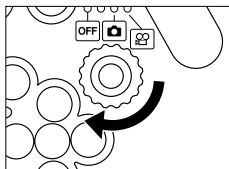

- 2) Turn the power switch button clockwise and, when a click sound is heard, press the power switch button to turn the camera ON.

Pressing the power switch button again turns the camera OFF.

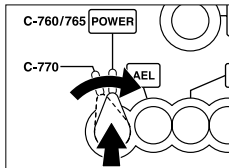

## C-770 Ultra Zoom

- 1) Turn the power switch button counterclockwise until it clicks.

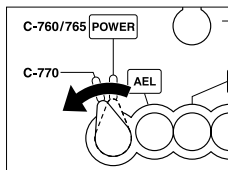

- 2) Before closing the rear lid of the case, turn the power switch dial knob counterclockwise so that the index on the power switch slide lever (located on the inner side of the case) comes on the OFF position.

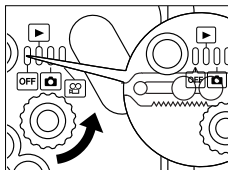

- 3) Make sure that the extremity of the power switch slide lever fits into the power switch of the camera.

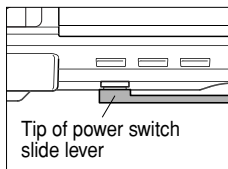

- 4) Turn the power switch dial knob to turn the camera ON/OFF.  
(The power switch slide lever functions according to the operation of the power switch dial knob.)

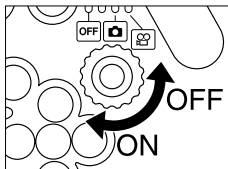

**Note:** • When the set time (initial setting: 3 minutes) passes without any operation while the digital camera is installed in shooting mode, the camera enters into sleep mode (standby status) and the operation stops.

To cancel sleep mode (return to operation status), press the shutter button or any other button.

For details, refer to the instruction manual for the digital camera.

## Flash operation procedure

Press the flash button to raise the flash out of the camera.  
Moving the flash storage button again to store the flash inside the camera.

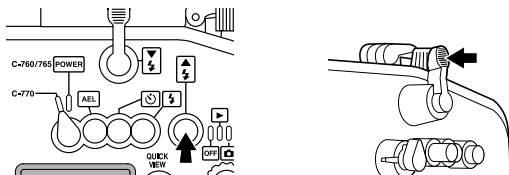

**Note:** • For details about using the flash for taking pictures, refer to the instruction manual for the camera.



## Removing the TTL cable connector cap

TTL flash shooting by combining this case (PT-022) and the case for FL-20 flash (optional PFL-01):

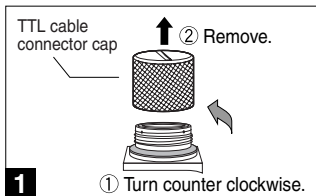

**1** Remove the TTL cable connector cap from this case.

\* The PFL-01 can be used only with the C-770 Ultra Zoom.

**2** Connect the underwater TTL cable connector, provided with the PFL-01, to the TTL cable connector on this case.

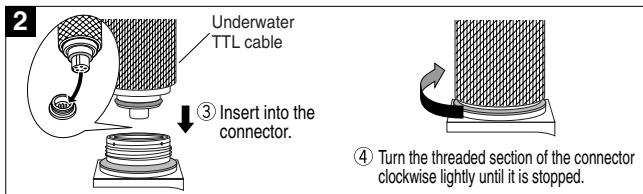

### ---- How to attach the TTL cable connector cap to the case ----

Make sure there is no foreign matter attached to the O-rings inside the cap and on the TTL cable connector. To secure the cap, gently turn it clockwise until it stops.

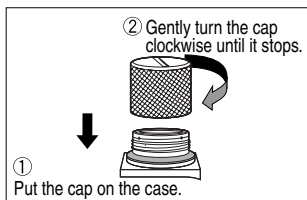
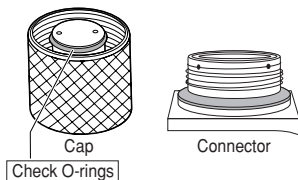





**⚠ CAUTION :** • If the TTL cable connector cap is loose, water penetration may result. Be sure to gently turn the cap until it stops to make sure it is firmly secured. Do not turn or tighten the TTL cable too hard. If it is too tight, it may be difficult to loosen and remove it.

\* Refer to the optional PFL-01's instruction manual for detailed instructions on using the TTL cable and hot shoe cable.

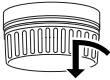
## Removing the hot shoe cable cap

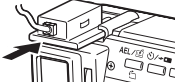
To perform TTL flash shooting when this case is used, connect the hot shoe cable provided with the optional PFL-01 between the connector on this case and the C-770 Ultra Zoom's hot shoe.

1	Turn the hot shoe cable connector cap inside the case counterclockwise to remove it.	
2	Insert the connector of the hot shoe cable into the case's connector and turn the connector screws all the way clockwise to connect them firmly.	
3	Insert the cable's hot shoe into the C-770 Ultra Zoom's hot shoe.	
4	When not using the hot shoe cable, attach the hot shoe cable cap to the hot shoe cable connector inside the case and turn the cap all the way clockwise to attach it firmly.	

**CAUTION :** • Be sure to remove the camera from the case when inserting the connector of the hot shoe cable into the case's connector.

## Cleaning the TTL connector

If the threaded sections of the TTL cable and TTL cable connector stick to each other, the cable may disconnect from the connector. To prevent this, apply O-ring silicon grease (provided with this case) to the threaded sections.

For details, see the maintenance description on page E-33 of this manual.

**CAUTION :** • If you cannot disconnect the TTL cable, do not use force to disconnect it. Contact Olympus for support.

## 2. Advance Check of the Case

### Advance test before use

This Case has been the subject of thorough quality control for the parts during the manufacturing process and thorough function inspections during the assembly. In addition, a water pressure test is performed with a water pressure tester for all products to confirm that the performance conforms to the specifications. However, depending on the carrying and storage conditions, the maintenance status, etc., the waterproof function may be damaged.

Before diving, always perform the following advance test and the water leakage test after installation of the camera.

### Advance Test

1. Before installing the digital camera in the Case, immerse the empty Case to the intended water depth to confirm that there is no water leakage.
2. Main causes of water leakage are as follows.
  - The O-ring has not been installed.
  - A part of the O-ring or the entire O-ring is outside the specified groove.
  - O-ring damage, cracks, deterioration or deformation.
  - Sand, fibers, hair or other foreign matter sticking to the O-ring, the O-ring groove or the O-ring contact surface on the front lid.
  - Damage to the O-ring groove or the O-ring contact surface on the front lid.
  - When closing the Case, check for catching of the hand strap and silica gel after the above causes have been eliminated.

**⚠ CAUTION :** • The most suitable method for checking water leakage is to immerse the Case to the intended water depth. When this is difficult, water leakage also can be checked at a shallow depth with no water pressure. Do not feel that this is troublesome, but perform this test.

- If the advance test should show water leakage with normal handling, stop using the Case and contact your dealer or an Olympus service station (listed on the rear page of this instruction manual).

### 3. Install the digital camera.

#### Check the digital camera.

Check the digital camera before loading it in the Case.

#### Battery Confirmation

As the LCD monitor is used for picture confirmation while taking pictures under water, the battery life becomes short.

Confirm that the remaining battery capacity is sufficient.

Do not use alkaline batteries, as it is quite possible that they will become unusable during a dive.

**Note:** • In order to avoid losing shutter chances due to an exhausted battery, you should always replace a battery with a fully charged battery before each dive.

#### Confirmation of the Remaining Number of Pictures to be Taken

Confirm that the image storage has a sufficient remaining number of pictures to be taken.

#### Removing the carrying strap and lens cap from the digital camera

If the digital camera has a carrying strap and lens cap attached, be sure to remove them before inserting the digital camera into the case.

**⚠ CAUTION :** • If the digital camera is inserted into the case without removing the carrying strap and lens cap, the case cannot be closed properly and water penetration may result.  
• Be careful when removing the carrying strap and lens cap from the digital camera. Olympus will not assume any liability for any damage that may result from dropping the camera.

#### Loading in the Case

#### Which digital cameras can be loaded?

This product (PT-022) is exclusively used for the CAMEDIA C-760 Ultra Zoom/C-770 Ultra Zoom.

## Check the operation of the camera.

Confirm the operation according to the instruction manual for the digital camera.

## Open the Case.

Insert the buckle opener of the accessory into the buckle opening lever as shown in the figure (in direction ①). Pull the buckle opener slowly (in direction ②). When not using the buckle opener, hold the buckle opening lever with your thumb and index finger from the side and pull it up slowly.

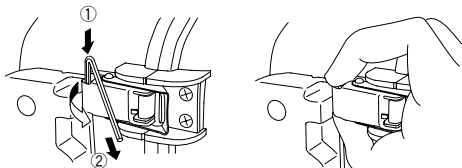

## Pull up the mode dial of the case.

Pull up the mode dial of the case until it stops, so that it does not interfere with the mode dial of the digital camera.

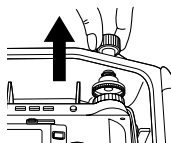

## Load the digital camera.

Quietly load the digital camera into the Case, taking care that the projecting part of the zoom lever of the digital camera properly fits into the recessed part of the zoom lever of the Case.

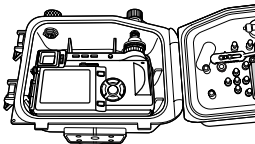

- CAUTION:**
- Make sure that the flash is closed when loading the digital camera.
  - Confirm that the projecting part of the zoom lever of the digital camera is set securely to the zoom lever notch on the inside of the case. When the setting is not secure, the loading of the digital camera is not complete and closing of the rear lid of the case may not be possible or zoom does not function even when the zoom lever is operated, so that caution is required. Insufficient sealing will cause water leakage.

## Set the mode dial.

After the digital camera has been loaded, push down the mode dial of the case from the upper surface of the case and set it so that the lower part of the mode dial of the case on the inside of the case fits properly onto the upper part of the mode dial of the digital camera.

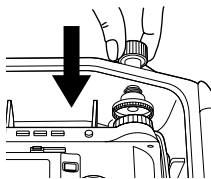

**Advice** • After setting the mode dial of the case, set the power of the digital camera to 'OFF', and before sealing the case, operate the mode dial and confirm that the mode of the digital camera is switched.

## Insertion of silica gel

Before sealing the Case, insert the accessory silica gel bag for prevention of fogging between the bottom of the camera and the Case. Insert the bag with the glued longer side to the inside.

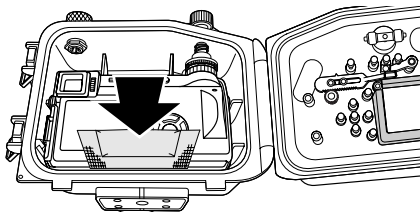

Pay attention to the orientation.

- CAUTION** :
- Insert the silica gel all the way at the specified location and with the specified orientation. When the orientation is not correct, the silica gel bag will be caught when the Case is sealed and water leakage will be caused.
  - When it is tried to seal the Case with the bag inserted only part of the way, the silica gel bag will be caught by the O-ring and water leakage will be caused.
  - Once silica gel has been used, the moisture absorption performance will be impaired. Always exchange the silica gel when the Case is opened and closed.

## Check the loading status.

Always perform the following final checks before sealing the Case.

- Has the digital camera been loaded so that the zoom lever operates properly?
- Has the silica gel been inserted all the way at the specified position?
- Has the O-ring at the Case opening part been installed properly?
- Are the O-ring and the O-ring contact surface on the front lid free of dirt and other foreign matter?

## Seal the Case.

When the rear lid is closed (quietly, so that the O-ring will not come out of the groove), the buckles are engaged with the edge of the rear lid, and the buckle lock levers are pushed down in arrow direction, the Case will be sealed airtight.

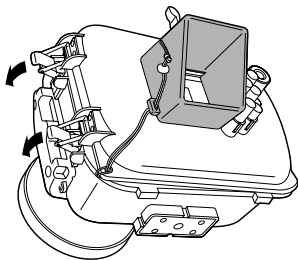

**CAUTION:** • Seal the Case by turning both buckle lock levers down in arrow direction. When one of the buckles is left open, the Case will not be sealed and water leakage will be caused.

## Install the special balance weight.

Install the special balance weight to the tripod mounting thread at the bottom of the case. Install the balance weight securely by tightening the accessory screw of the balance weight.

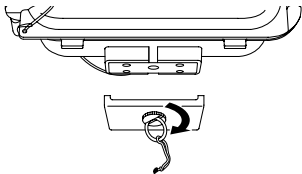

## Installation and Removal of the LCD Hood

### Installation

Strongly push the mounting projections of the LCD hood as shown in the figure into the guides above and below the LCD monitor window.

### Removal

Remove the mounting projections of the LCD hood from the guides above and below the LCD monitor window by widening the LCD hood.

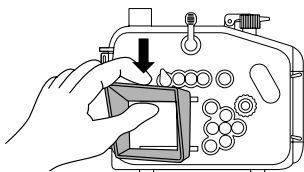
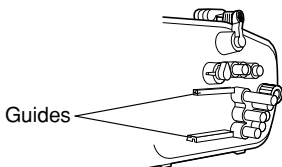

Installation

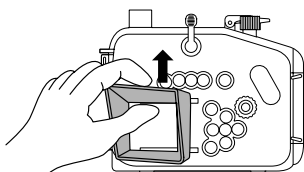

Removal



## Mounting and Removing the Lens Cap

Fit the lens cap onto the lens ring as shown in the figure. Be sure to remove the lens cap before shooting.

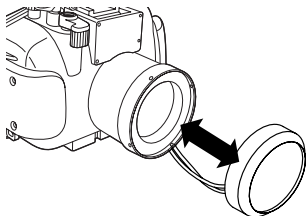

## Perform the final checks.

### Visual Inspection

After sealing the Case, check the sealing part of front and rear lid visually to confirm that the O-ring is not twisted or out of the groove and that no foreign matter has been caught.

**CAUTION:** • Hairs, fibers, and other narrow items are not very apparent, but they may cause entry of water, so that special attention is required.

### Set the power to 'ON'.

Move the power switch and confirm that the camera power can be switched ON and OFF.









### Try to move the mode dial.

After sealing, turn the mode dial knob and confirm that the mode dial of the camera is switched.

**CAUTION:** • After loading the camera into the Case, confirm that the mode dial moves. If it does not move, there is the possibility that oil or fat has been attached to the mode dial. Please wipe it clean.

## Final Test

The final test after loading the camera is explained below. This is the only way to eliminate worry about possible entry of water! Always perform this test. It can be performed easily in a water tank or a bathtub. The required time is about five minutes.

	Simple water immersion test	Explanatory image	Hints
1	Place the Case slowly into the water.		As the Case is transparent, waterdrops entering into it can be confirmed easily.
2	At first, immerse the Case for only three seconds.		In case of trouble with the O-ring, three seconds are enough for water to enter. Are there air bubbles coming out between the lids? Please check carefully.
3	Check that no water has entered into the Case.		Remove the Case from the water and check that no water has accumulated at the bottom of the Case. Is there any water trickling down?
4	Next, immerse the Case for 30 seconds.		Check carefully for air bubbles! Do not perform any operation yet, but just observe.
5	Check that no water has entered.		Remove the Case from the water and check that no water has accumulated at the bottom of the Case. Perform very careful confirmation.
6	Next, check by immersing for three minutes.		Check carefully for air bubbles! Try operation of the buttons used frequently. Check carefully for air bubbles! If there is still no entry of water, everything is OK!
7	This is the final check. Has the silica gel become moist?		This is very important! Has the silica gel become moist? Please check carefully! As the inside can be seen, the inspection for entry of water also can be made securely!
8	Now everything is all right. Do not forget the balance weight.		Now everything is all right! Have a nice dive! Did you remember to attach the balance weight?

## 4. Taking Pictures Under Water

### How to Use the Hand Strap

Pass your hand through the accessory hand strap and adjust the length with the stop button.

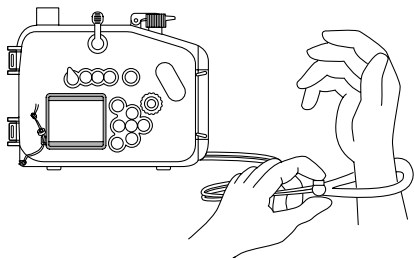

### Take pictures carefully.

#### Confirm the picture on the LCD monitor.

This Case uses the LCD monitor to confirm the picture. The viewfinder cannot be used.

#### Quietly press the shutter lever.

When pressing the shutter lever, hold the Case securely with both hands and operate the lever quietly to prevent camera shake.

#### Cautions when using the flash

When taking macro pictures on the wide-angle side, the flash light may be missing in some parts or the light volume may not be uniform.

Flash reaching range (Land shooting)	C-760	W : Approx. 0.3 m to 4.5 m
	Ultra Zoom	T : Approx. 1.2 m to 3.5 m
	C-770	W : Approx. 0.3 m to 4.5 m
	Ultra Zoom	T : Approx. 1.2 m to 5.2 m

During underwater shooting, shooting conditions (water clarity, suspended matter, etc.) can have a significant effect on the range of the flash.

Always check your pictures on the LCD monitor after shooting.

(Pressing the quick view button engages the playback mode. Pressing the button once more restores the shooting mode.)

## 5. Handling After Shooting

### Wipe off any waterdrop.

After completing the shooting and returning to land, wipe off any waterdrop sticking to the Case. Use air or a soft cloth not leaving any fibers to thoroughly wipe any waterdrop etc. from the joint between the front and rear lid, the shutter lever, the palm grips, and the buckles.

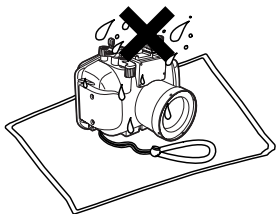

- ⚠ CAUTION :**
- Especially when waterdrops remain between the front and the rear lid, they may spill to the inside when the Case is opened. Take special care to wipe off all waterdrops.
  - When opening the Case, take sufficient care that no water will drop from your hair or body onto the Case and the camera.
  - Before opening the Case, make sure that your hands or gloves are free of sand, fibers, etc.
  - Do not open or close the Case at locations where water or sand is to be sprayed. When this cannot be avoided because you have to exchange the battery or the image storage, place a sheet downwind from some object and take care that no water or sand is sprayed.
  - Take care not to touch the digital camera or the battery with hands wet with sea water.

**Note :**

- Moisten a towel etc. in advance with pure water and keep it in a plastic bag, so that you can wipe the salt from your hands and fingers before handling the camera.

## Take out the digital camera.

Open the case carefully, pull up the mode dial from the upper surface of the case to disengage it from the mode lever of the camera, and then remove the digital camera from the case.

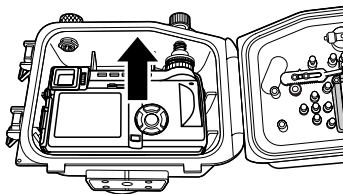

- ⚠ CAUTION :**
- Always place the opened Case with the O-ring side facing up. When the Case is placed with the O-ring side facing down, dirt or other foreign matter may be attached to the O-ring or the O-ring contact surface and may cause water leakage during the next dive.
  - Please read the operation manual for the digital camera for the storage of pictures etc.
  - Take special care so that no water drops get onto the camera.

## Wash the Case with pure water.

After use, seal the Case again after taking out the camera and wash it sufficiently in pure water as soon as possible. After use in sea water, it is effective to immerse it for a fixed time in pure water to remove any salt.

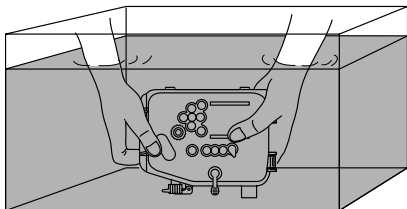

- CAUTION** :
- Water leakage may be caused when a high water pressure is applied locally. Before washing the Case with water, take out the digital camera from it.
  - Operate the shutter lever and various buttons of this product in pure water to remove salt adhering to the shaft. Do not disassemble for cleaning.
  - Drying the Case with adhering salt may impair the function. Always wash off any salt after use.

## Dry the Case.

After washing with pure water, use a soft cloth without any salt on it and not causing any fibers to wipe off any waterdrop and dry the Case completely at a well ventilated location in the shade.

- CAUTION** :
- Do not use hot air from a hair drier or the like for drying and do not expose the Case to direct sunlight, as this may accelerate deterioration and deformation of the Case and deterioration of the O-ring, leading to leakage of water. When wiping the Case, take care not to cause scratches.

## 6. Maintaining the Waterproof Function

### Remove the O-ring.

Open the Case and remove the O-ring from the Case.

Removal of the O-ring

- ① Insert the O-ring removal pick between the O-ring and the wall of the O-ring groove.
- ② Move the tip of the inserted pick under the O-ring. (Take care not to damage the O-ring groove with the tip of the pick.)
- ③ Hold the O-ring with your fingertips after it has come out of the groove and remove it from the Case.

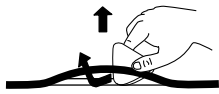

### Remove any sand, dirt, etc.

After visually checking that dirt has been removed from the O-ring, checking for attached sand and other foreign matter, as well as for damage and cracks can be done by squeezing the entire circumference of the O-ring lightly with your fingertips.

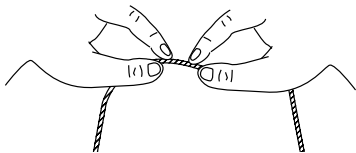

Using a clean cloth free of fibers, dirt, etc., a piece of lint-free tissue paper or a soft toothbrush, remove any foreign matter attached to the grooves of the O-rings. Also remove sand and dirt particles attached to the O-ring contact surfaces on the case.

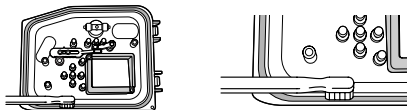





- CAUTION** :
- When a mechanical pencil or a similar other sharp object is used to remove the O-ring or to clean the inside of the O-ring groove, the Case and the O-ring may be damaged and water leakage may be caused.
  - When the O-ring is checked with the fingertips, take care not to stretch the O-ring.
  - Never use alcohol, thinner, benzene or similar solvents or chemical detergents to clean the O-ring. When such chemicals are used, it is to be feared that the O-ring will be damaged or that its deterioration will be accelerated.



## Install the O-ring.

Confirm that no foreign matter is attached, apply a thin coat of the accessory grease to the O-ring, and fit the O-ring into the groove. At this time, confirm that the O-ring does not stick out from the groove.

## How to Apply Grease to the O-ring

1	Apply the exclusive lubricant to each O-ring.		Make sure that your fingers and the O-ring are free of dirt, and squeeze about 5 mm of lubricant onto a finger. (5 mm is the most appropriate amount.)
2	Spread the lubricant all over the O-ring.		Surround the lubricant with three fingers and spread it over the ring. Be careful not to use excessive force as this may stretch the O-ring.
3	Check that the O-ring is free of scratch or unevenness.		After spreading the lubricant, check visually and by touch that the O-ring is not scratched and that its surface is flat. If it is damaged in any way, replace it with a brand-new O-ring.
4	Apply lubricant on the O-ring contact surface.		Use the lubricant remaining on the fingers to clean and lubricate the case's contact surface.

- ⚠ CAUTION :**
- Always perform maintenance of the waterproof function even when the Case has been opened to exchange the battery or the image storage during shooting. Neglecting this maintenance may become the cause of water leakage.
  - When the Case is not to be used for a long time, remove the O-ring from the groove to prevent deformation of the O-ring, apply a thin coat of silicone grease, and store it in a clean plastic bag or the like.
  - When drying is done with salt attached, it is likely that a function impairment will be caused. After use, always wash off any salt.

## Maintenance of the threaded sections on the TTL cable and TTL cable connector

If the threaded sections used to connect the TTL cable to the TTL cable connector are not maintained properly, salt and other seawater residue may adhere the TTL cable and prevent it from being disconnected.

After use in seawater, clean off any salt, sand, or other residue as soon as possible, then dry the equipment thoroughly. Clean the threaded sections with a cotton swab and apply a thin, uniform layer of O-ring silicon grease (provided with this case).

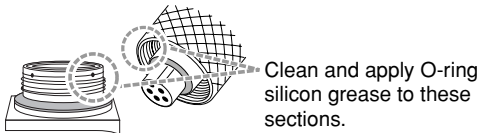



## Maintenance of the TTL Connector Cap

After removing the TTL connector cap from the waterproof cap, be sure to clean and grease the O-ring.

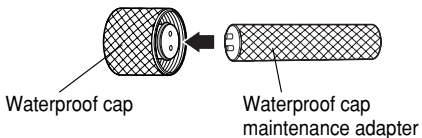
Use the waterproof cap maintenance adapter to remove the O-ring unit from the waterproof cap.

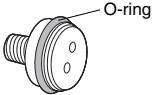

1	Insert the adapter by aligning its pin with the hole on the cap.	
2	Turn the adapter counterclockwise to remove the O-ring unit.	
3	After removing the O-ring attached to the O-ring unit, clean the O-ring groove and apply silicon grease to the O-ring. Then, re-attach the O-ring to the O-ring unit.	

✳ Reverse the removal procedure to re-attach the O-ring unit to the waterproof cap.

## Replace consumable products.

- The O-ring is a consumable product. Independent of the number of times the Case is used, it is recommended that the O-ring should be replaced by a new one at least once a year.
- Deterioration of the O-ring is accelerated by the use conditions and the storage conditions. Replace the O-ring even before a year has passed if it shows signs of damage, cracking or loss of elasticity.

**Note:** • Please use original Olympus products for the silicone O-ring grease, the silica gel, and the O-ring. These consumable products also can be purchased at an Olympus service station.

## 7. Appendix

### Q & A on the use of the PT-022

Q1 : Which digital cameras can be used?

A1 : The PT-022 is only for the models C-760 Ultra Zoom/C-770 Ultra Zoom.

Q2 : What cautions must be observed when loading the digital camera into the Case?

A2 : Pay special attention to the following items when loading the camera into the Case.

- (1) Check that the remaining capacity of the battery in the digital camera is sufficient.

This should be checked as the LCD monitor is used under water, and the battery consumption becomes faster.

- (2) Check the remaining number of pictures on the image storage.  
Please use a card with a sufficient remaining number in order to reduce the number of times the Case has to be opened and closed.
- (3) Remove the strap from the digital camera.  
When the camera is loaded without removing the strap, the strap may get caught when the Case is sealed and this will cause water leakage.
- (4) Before sealing the Case, confirm that the O-ring has been installed properly in the groove in the rear lid of the Case.
- (5) Confirm that the O-ring and the O-ring contact surface on the front lid are free of dirt, hairs, and other foreign matter.
- (6) Insert the silica gel for defogging. Please use silica gel for the Olympus Case.
- (7) Finally install the special balance weight to the tripod mounting thread.

Q3 : What cautions must be observed when using and storing the Case?

A3 : Pay special attention to the following items.

- (1) When the O-ring contact surface is pressed strongly from the outside of the Case, or when the Case is twisted, the waterproof function may be impaired and water leakage may be caused.
- (2) When the Case is used, left or stored at the following locations, defective operation or trouble may be caused. Always avoid such locations.
  - (a) Places where the Case can reach high temperatures under direct sunlight or in a car, places with extremely low temperatures, and places with extreme temperature variations
  - (b) Places with open fire
  - (c) Places with volatile substances
  - (d) Places with vibrations

- (3) In case of the following handling with a camera loaded into the Case, trouble or breakage may be caused for the Case and/or the loaded camera. Always avoid such handling.
- (a) Hitting other objects
  - (b) Dropping
  - (c) Placing heavy objects on top of the Case
- (4) When the Case is not used for a long time, trouble from formation of mold etc. may be caused. Before use, confirm the operation of all operation parts and perform the advance test and the final test.

Q4 : What cautions must be observed when opening and closing the Case?

A4 : Pay special attention to the following items.

- (1) Do not open and close the Case at locations with water spray or sand spray.
- (2) Wipe off all waterdrops from the gap between the front lid and the rear lid and around projections and recesses such as the buckles. When this is not done, entry of waterdrops into the Case is to be feared at the time of opening and closing.
- (3) When opening the Case, take care that no water will drip from your hair or body into the Case or onto the camera.
- (4) When the Case is open, check that there is no attachment of sand, fibers or other foreign matter to the O-ring and the O-ring contact surface on the front lid.
- (5) Do not touch the camera or the image storage with your hands to which sea water is sticking.
- (6) If you should detect waterdrops or other signs of water leakage while shooting, immediately end the dive, perform the water leakage test again, and confirm that there is no leakage. If the camera is wet, wipe off any moisture and check the operation.

Q5 : How should the Case be handled after use?

A5 : After use, take out the camera as soon as possible and wash the Case with pure water. In case of use in the ocean, it is effective to immerse the Case for a certain time in pure water to remove any salt. Operate the buttons and levers under water to turn the shafts and wash off any salt. After washing, use a dry cloth without any salt on it to wipe off any moisture and dry the Case in the shade. Do not use hot air from a hair drier or the like and do not dry the Case under direct sunlight. Exposure to high temperatures or direct sunlight may cause deformation, discoloration or breakage of the Case and deterioration of the O-ring. Wipe the inside of the Case with a soft cloth not causing any fibers. Remove the O-ring, wipe off any salt, sand, dust, etc., and also clean the O-ring groove and the O-ring contact surface in the same way and then

dry them. When an object with a sharp tip is used to remove the O-ring from the groove, the O-ring may be damaged and water leakage may be caused. Always use the accessory pick for O-ring removal.

Q6 : How should I take pictures under water?

A6 : Please observe the following items for shooting under water.

- (1) Fix the case with the accessory hand strap to your wrist.
- (2) When you place a finger onto the lens window, the finger will appear in the photo. Pay attention to the position of your fingers when holding the Case.
- (3) When pressing the shutter lever, hold the Case securely with both hands and operate the lever quietly to prevent camera shake.
- (4) Look through the LCD monitor window on the rear of the Case to confirm the picture and then press the shutter lever. Please note that the viewfinder cannot be used, When the LCD monitor is used, the battery is exhausted earlier. In order to avoid losing shutter chances due to an exhausted battery, please always replace a battery with a fully charged battery before each dive.

Q7 : How can I check for water leakage?

A7 : For confirmation, perform the advance test and the final test after loading the camera. The advance test with immersing the Case without the camera to the intended use depth to check for water leakage is the most accurate test, but when this is difficult, it is safer to perform this test even at a depth of 1 m or in a bathtub. The final test also can be performed in a bathtub or a bucket.

Q8 : What are the causes for entry of water?

A8 : The main causes for the entry of water are shown below. Please check them most carefully.

- (1) Forgetting to install the O-ring
- (2) The O-ring is partly or completely outside the groove.
- (3) Damage, deterioration, or deformation of the O-ring
- (4) Sand, fibers, hair or other foreign matter on the O-ring
- (5) Sand, fibers, hair or other foreign matter on the O-ring groove or the O-ring contact surface
- (6) Catching of the strap, the bag of silica gel, etc. at the time of sealing the Case
- (7) Throwing the Case from a boat into the water, jumping with the Case into the water, or other sudden application of strong forces onto the Case. When entering the water, hand the Case over quietly or avoid impacts in other ways.

Q9: What are the important points for O-ring maintenance?

A9: Please observe the following items.

- (1) Never use alcohol, thinner, benzene or similar organic solvents or chemical detergents to clean the O-ring. When such chemicals are used, it is to be feared that the O-ring will be damaged or that its deterioration will be accelerated.
- (2) Use the original Olympus silicone O-ring grease (white cap). The grease attached to Cases up to PT-008 (red cap) and the grease of other companies are not suitable for this silicone O-ring, and use of such grease may cause deterioration of the surface and impairment of the waterproof function.
- (3) In order to avoid deformation of the O-ring when the Case is not used for a long time, remove the O-ring from the Case, apply a thin coat of the special grease, and store the O-ring in a clean plastic bag. For reuse, confirm that the O-ring is free of damage and cracks, that it has sufficient elasticity, that the surface is free of stickiness and other abnormalities, and use it after applying a thin coat of the special grease. Excessive application of grease does not improve the waterproof function or the permissible withstand pressure. However, it may facilitate attachment of sand, dirt, etc.  
A thin, uniform coat produces the best result.
- (4) The O-ring is a consumable product. Replace it at least once a year.
- (5) Deterioration of the O-ring is accelerated by the use conditions and the storage conditions. Replace the O-ring immediately by a new one if it shows signs of damage, cracking or loss of elasticity.

Q10: What are the important points for Case maintenance?

A10: Please observe the following items.

- (1) Never use the following chemicals for cleaning, corrosion protection, defogging, repair or other purposes.
  - Never use alcohol, thinner, benzene or similar volatile organic solvents or chemical detergents to clean the Case. Pure water or lukewarm water is sufficient for cleaning.
  - Do not use anticorrosion agents on the metal parts. The metal parts are made of aluminum, brass or stainless steel. Cleaning with pure water is sufficient.
  - Do not use commercial defogging agents. Always use the original Olympus defogging silica gel.
  - Do not use adhesive for repairs or other purposes. When repair is required, please contact a service station of OLYMPUS CORPORATION or your dealer.

Q11: Please tell me about repairs.

A11: Please contact a service station of OLYMPUS CORPORATION or your dealer, if repair should be necessary. Do not try to repair, disassemble or modify the Case yourself. Repair, disassembly or modification by you or third parties not authorized by Olympus invalidates the guarantee.

Q12: What are the model numbers and the prices of the PT-022 accessories?

A12: The following accessories are being sold.

- (1) O-ring for the PT-022 body (POL-022/¥1,050 with tax): This is a silicone rubber O-ring packing to be installed in the PT-022 body to make it waterproof. O-rings for other Case models cannot be used.
- (2) Silicone O-ring grease (PSOLG-1/¥840 with tax): This is a special grease for silicone O-ring maintenance.
- (3) Silica gel (SILCA-5/¥525 with tax): This is a desiccant used to prevent fogging of the glass parts of the Case. The quantity is five bags.
- (4) LCD hood (PFUD-04/¥1,050 with tax): This hood is installed on the LCD monitor window of the Case to make it easier to see the LCD monitor of the camera.
- (5) Balance weight for PT-022 (PWT-022/¥2,625 with tax): This is a weight intended to bring the Case close to neutral buoyancy in sea water. Under consideration of the environment, no lead is used.

\* You can order in large computer shops and camera mass sale stores.

\* Please contact your dealer or a service station of OLYMPUS CORPORATION when replacement is required. Replacement will be made against payment.

Q13: How can I take good underwater photos?

A13: Olympus's ZUIKO CLUB online school website has a page describing underwater shooting techniques. You can access this page at the following link:

URL: <http://www.olympus-zuiko.com/school/index.html>



## After-sale Service

- You will receive the guarantee card from your dealer. Please make sure that the dealer's name, the date of purchase, etc. have been entered. If they have not been entered, immediately ask your dealer to have them entered. Read the guarantee conditions carefully and keep the guarantee card at a safe location.
- Please contact your dealer or one of the service stations of OLYMPUS CORPORATION listed in this instruction manual for questions on after-sale service for this product or in case of defects. In case of a defect of this product, occurring within one year after the date of purchase and with handling according to this instruction manual, repair based on the conditions specified in the guarantee card is performed free of charge.  
Payment is required for repairs after expiration of the guarantee period and for trouble caused by problematic handling by the customer even during the guarantee period.
- OLYMPUS CORPORATION keeps repair parts for this product for approximately five years after the end of production of the product. Accordingly, in principle repairs are accepted during this period. As repair may be possible even after this period, please contact your dealer or a service station in your neighborhood.
- Warranty, repair, and service for this product are valid only in Japan. Repair is not possible overseas.
- Incidental damages from defects of this product (expenses required for diving, shooting expenses, loss of profit from photos, etc.) shall be excluded from the guarantee. In addition, transport expenses etc. related to repair shall be paid by the customer, independent of whether they are incurred during or after the guarantee period.

## Specifications

Available models	Olympus digital camera CAMEDIA C-760 Ultra Zoom/C-770 Ultra Zoom
Pressure resistance	Depth of up to 40 m
Main materials	Body: Transparent polycarbonate Buckles: Stainless steel Grip/Shutter lever: Red polycarbonate Lens window: FL glass Lens ring: Aluminum Operation buttons: Stainless steel Nickel-plated brass
Dimensions	Width 151 mm x height 126 mm x thickness 150 mm (projections not included)
Weight	Approx. 620 g (LCD hood not included)

\* We reserve the right to change the external appearance and the specifications without notice.

### Diver's Insurance Guide

We recommend to subscribe to diver's insurance for water leakage.  
For details, refer to the enclosed Diver's Insurance Guide.

---

MEMO

---

## Free Manuals Download Website

<http://myh66.com>

<http://usermanuals.us>

<http://www.somanuals.com>

<http://www.4manuals.cc>

<http://www.manual-lib.com>

<http://www.404manual.com>

<http://www.luxmanual.com>

<http://aubethermostatmanual.com>

Golf course search by state

<http://golfingnear.com>

Email search by domain

<http://emailbydomain.com>

Auto manuals search

<http://auto.somanuals.com>

TV manuals search

<http://tv.somanuals.com>